

3/31/2010

K:\ATWC\CIVIL\State\INDOT\TH 212 of CR 5\CRADD\PLAN SHEETS\cadd\101387_1101.dgn

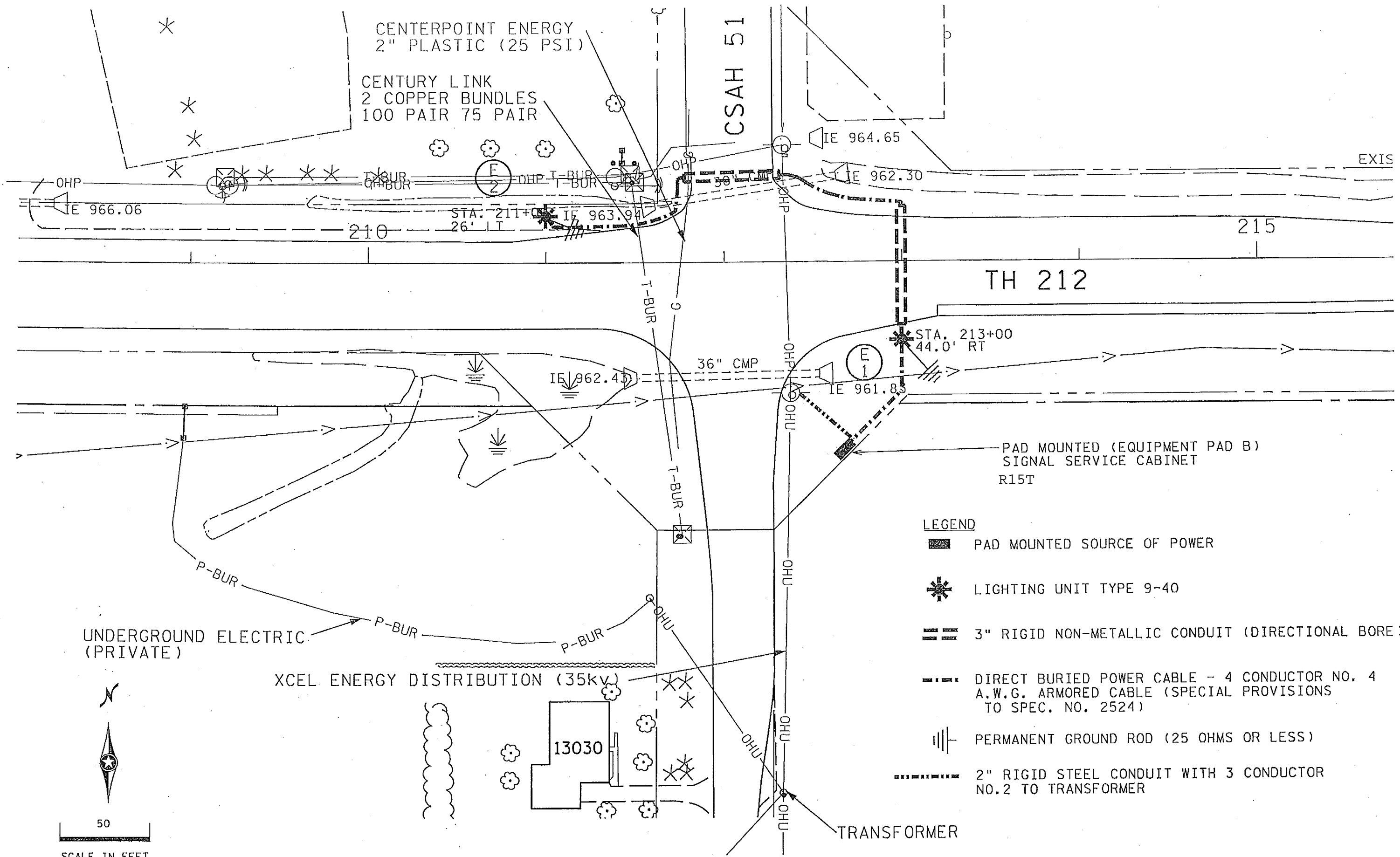

- LEGEND**
- PAD MOUNTED SOURCE OF POWER
 - LIGHTING UNIT TYPE 9-40
 - 3" RIGID NON-METALLIC CONDUIT (DIRECTIONAL BORE)
 - DIRECT BURIED POWER CABLE - 4 CONDUCTOR NO. 4 A.W.G. ARMORED CABLE (SPECIAL PROVISIONS TO SPEC. NO. 2524)
 - PERMANENT GROUND ROD (25 OHMS OR LESS)
 - 2" RIGID STEEL CONDUIT WITH 3 CONDUCTOR NO.2 TO TRANSFORMER



3/31/2010

K:\ATWC_Civil\State\MDOT\TH 212 of CR 5\ACADD\PLAN SHEETS\cd101387_1102.dgn

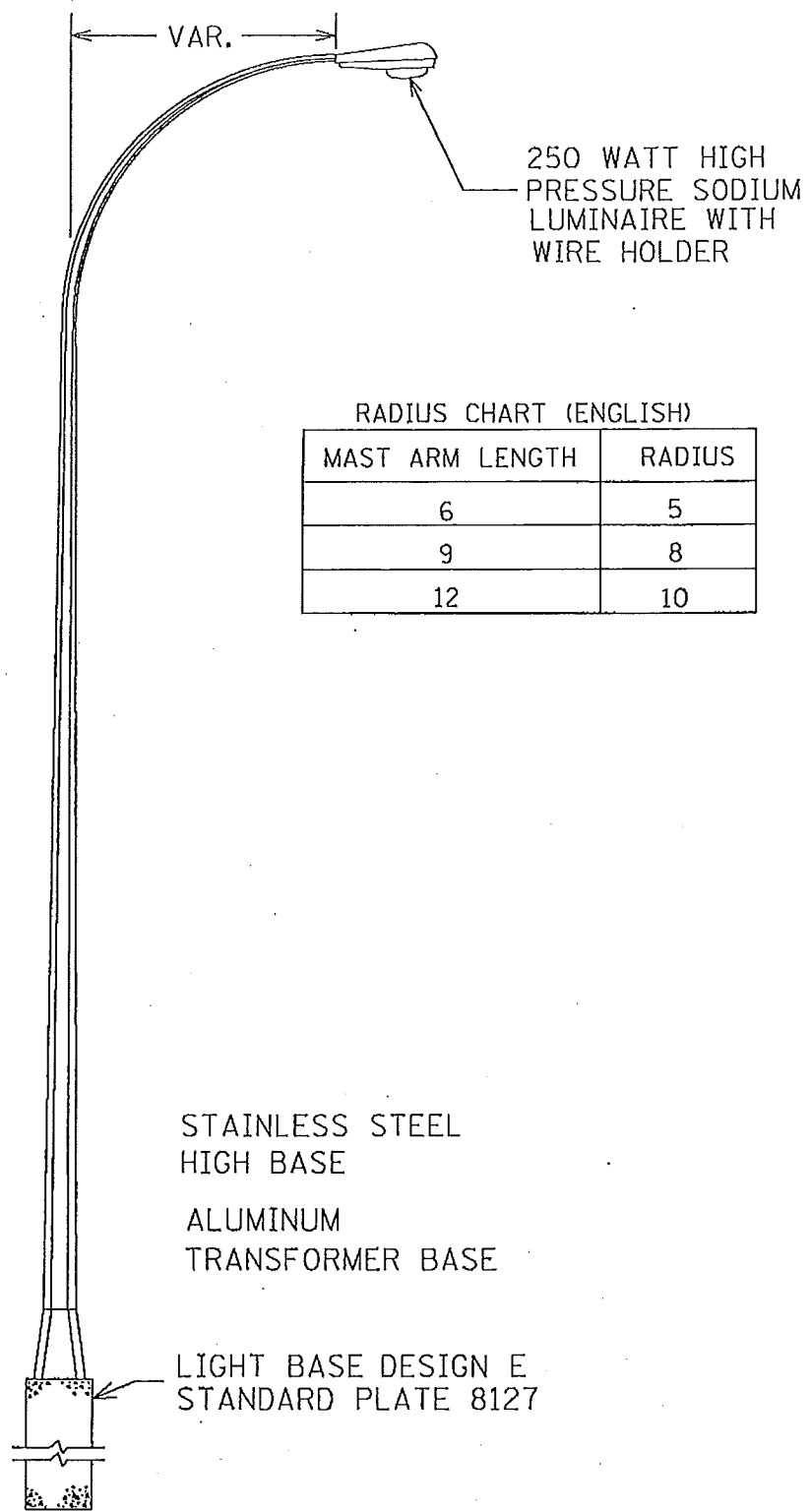

RADIUS CHART (ENGLISH)

MAST ARM LENGTH	RADIUS
6	5
9	8
12	10

LIGHTING UNIT TYPE 9-40
(BREAKAWAY)

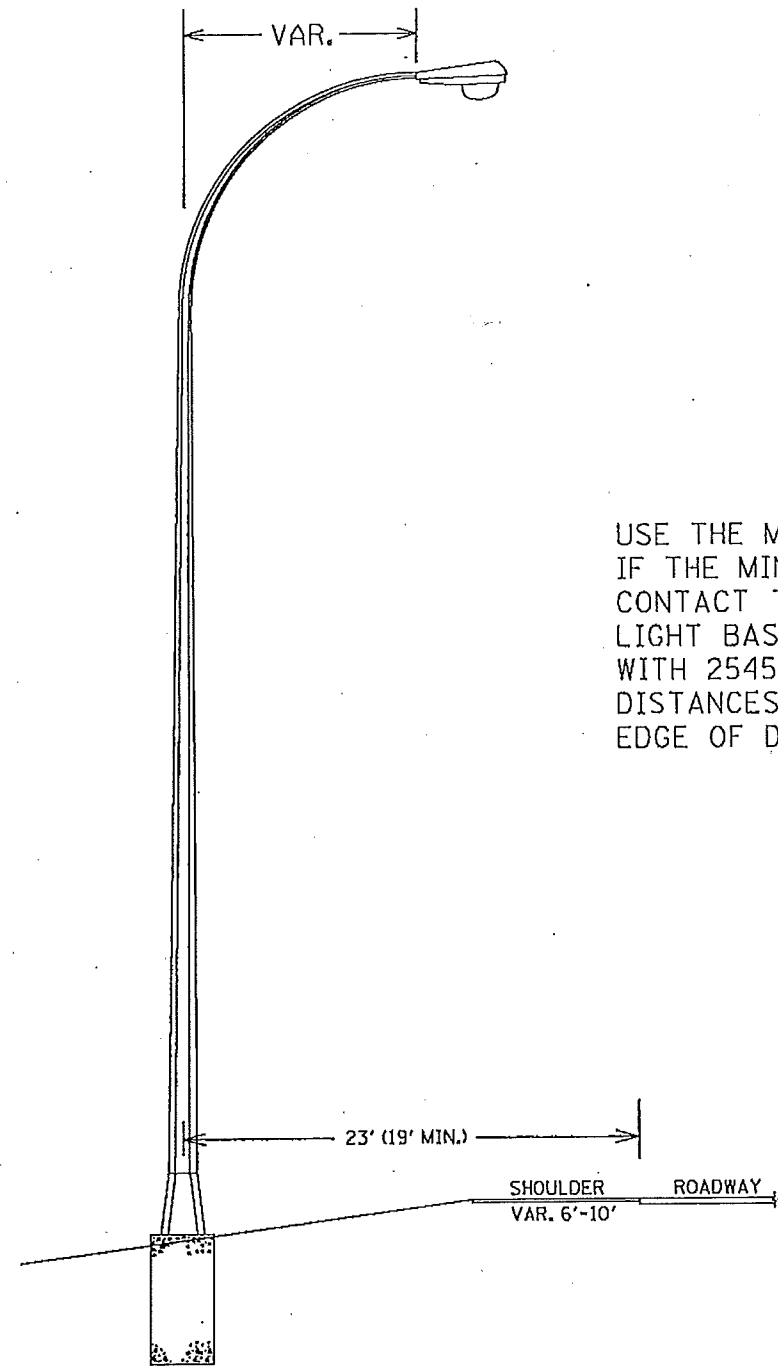

LIGHTING UNIT TYPE 9-40

USE THE MAXIMUM DISTANCE WHENEVER POSSIBLE,
IF THE MINIMUM DISTANCE CANNOT BE OBTAINED
CONTACT THE DISTRICT/DIVISION TRAFFIC ENGINEER
LIGHT BASES SHALL BE INSTALLED IN ACCORDANCE
WITH 2545.3F2.
DISTANCES SHALL BE MEASURED FROM THE
EDGE OF DRIVING LANE OR TURN LANE.

LIGHTING PLAN

DRAWN BY: RBC

CHECKED BY: DJC

CERTIFIED BY

David J. Cole
LICENSED PROFESSIONAL ENGINEER

LIC. NO. 44821

DATE 3/31/2010

STATE PROJ. NO. 1013-87 (TH 212)

SHEET NO. 64 OF 79 SHEETS

3/31/2010

K:\TWC_Civ\State\INDOT\TH 212 of CR 5\CADD\PLAN SHEETS\cd101387_1103.dgn

LIGHTING J			
ITEM NO.	ITEM	UNIT	S.P. 1013-87
			ESTIMATED QUANTITIES
2545	LIGHTING UNIT TYPE 9-40	EACH	2
2545	LIGHTING BASE DESIGN E	EACH	2
2545	3" NON-METALLIC CONDUIT (DIRECTIONAL BORE)	LIN FT	100
2545	ARMORED CABLE 4 CONDUCTOR NO.4	LIN FT	500
2545	EQUIPMENT PAD B	EACH	1
2545	SERVICE CABINET	EACH	1
2545	2" RIGID STEEL CONDUIT	LIN FT	50
2545	UNDERGROUND WIRE 3 CONDUIT #2	LIN FT	300

THE FOLLOWING STANDARD PLATES APPROVED BY THE DEPT. OF TRANSPORTATION AND THE FEDERAL HIGHWAY ADMINISTRATION SHALL APPLY ON THIS PROJECT.

STANDARD PLATES	
PLATE NO.	DESCRIPTION
8106B	EQUIPMENT PAD B
8127B	LIGHT BASE DESIGN E

LUMINAIRES

GENERAL ELECTRIC M-400, AUTO-REGULATOR BALLAST FOR 120 VOLTS CAT. NO. MSCA25SOA12GMC2U
 LUMEC - SCHREDER HELIOS HBM WITH CONSTANT WATTAGE BALLAST FOR 120 VOLTS CAT. NO. HBM250HPSMS2QTA120CWAGLS
 AMERICAN ELECTRIC SERIES 125 WITH CONSTANT WATTAGE BALLAST FOR 120 VOLT CAT. NO. 12525SCAMT1R2SGULNROPSS
 LAMPS SHALL BE 250 WATT HIGH PRESSURE SODIUM
 LUMINAIRES SHALL HAVE A TYPE II MEDIUM SEMI-CUTOFF DISTRIBUTION PER 1983 ANSI/IES STANDARDS WITH SHALLOW GLASS REFRACTOR

OR APPROVED EQUAL

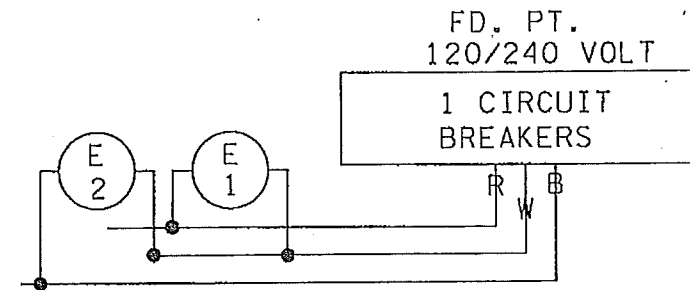

B AND R DENOTE CURRENT CARRYING CONDUCTORS
 W DENOTES NEUTRAL CONDUCTOR

LIGHTING PLAN

DRAWN BY: RBC

CHECKED BY: DJC

CERTIFIED BY

Donna J. Col
LICENSED PROFESSIONAL ENGINEER

LIC. NO. 44821

DATE 3/31/2010

STATE PROJ. NO. 1013-87 (TH 212)

SHEET NO. 65 OF 79 SHEETS