

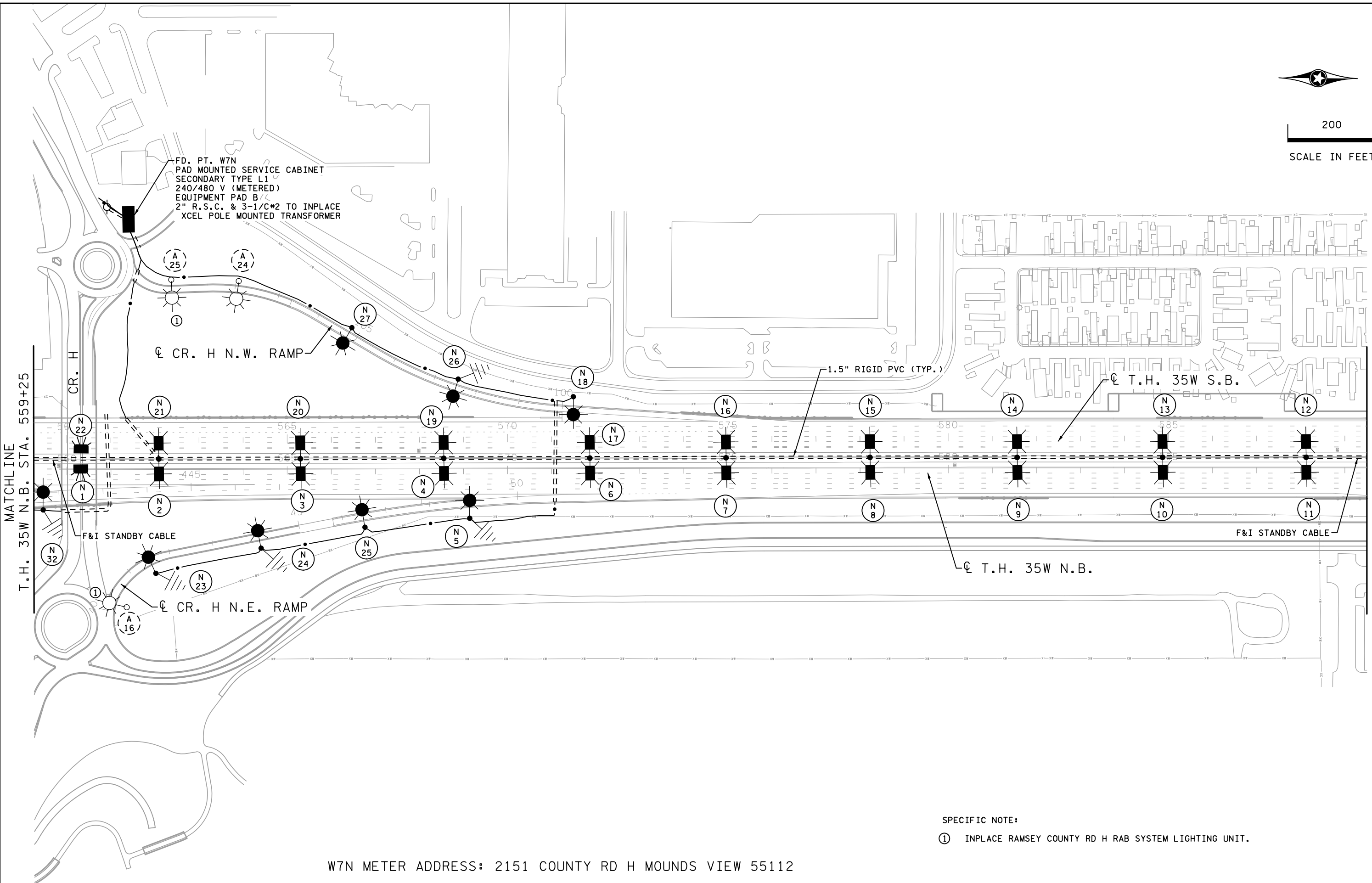

200
SCALE IN FEET

FD. PT. W7N
PAD MOUNTED SERVICE CABINET
SECONDARY TYPE L1
240/480 V (METERED)
EQUIPMENT PAD B
2" R.S.C. & 3-1/C#2 TO INPLACE
XCEL POLE MOUNTED TRANSFORMER



SPECIFIC NOTE:

- ① INPLACE RAMSEY COUNTY RD H RAB SYSTEM LIGHTING UNIT.

W7N METER ADDRESS: 2151 COUNTY RD H MOUNDS VIEW 55112

2:48:12 PM
12/3/2021
C:\Projects\2018\18005\CONSTRUCTION\Plan Sheets\cd6284180_cb_11150.dgn

3	1/14/20	LEW	MPM	RFC DP T-5
4	05/27/20	AKS	MPM	FDC 194
5	12/03/21			RECORD DRAWING
NO	DATE	DWN	CKD	REVISIONS



RECORD DRAWING NOTE: THESE RECORD DRAWINGS WERE DEVELOPED BASED ON THE PREVIOUS DRAWING REVISIONS AND INFORMATION TRANSMITTED FROM THE FIELD BY OTHERS. THE INFORMATION CONTAINED WITHIN THIS RECORD AS-BUILT PLAN REPRESENTS THE ACTUAL CONDITIONS FOR ALL CHANGES OF WHICH ALLIANT IS AWARE. FUTURE USERS OF THESE DRAWINGS SHOULD VERIFY AS-BUILT CONDITIONS IN THE FIELD IN ALL CIRCUMSTANCES.

LIGHTING PLANS
FD. PT. W7N LAYOUT

I-35W NORTH MNPASS DB (S.P. 6284-180)
SHEET NO. LL50 OF LL67 SHEETS

FEEDPOINT W7N
LIGHTING STANDARDS AND FOUNDATIONS

NO.	STATION	LT.	RT.	LOCATION	TYPE	LUMINAIRE
1	560+32	-		T.H. 35W N.B.	UNDERPASS	LED
2	562+09	-		T.H. 35W N.B.	6BD-49	5 LANE
21						5 LANE
3	565+30	-		T.H. 35W N.B.	6BD-49	5 LANE
20						5 LANE
4	568+55	-		T.H. 35W N.B.	6BD-49	5 LANE
19						5 LANE
5	48+88	-		C.R. H N.E. RAMP	9-49	49 FOOT
6	571+87	-		T.H. 35W N.B.	6BD-49	5 LANE
17						5 LANE
7	574+96	-		T.H. 35W N.B.	6BD-49	5 LANE
16						5 LANE
8	578+23	-		T.H. 35W N.B.	6BD-49	5 LANE
15						5 LANE
9	581+56	-		T.H. 35W N.B.	6BD-49	5 LANE
14						5 LANE
10	584+87	-		T.H. 35W N.B.	6BD-49	5 LANE
13						5 LANE
11	588+12	-		T.H. 35W N.B.	6BD-49	5 LANE
12						5 LANE
18	571+50	-		T.H. 35W S.B.	9-49	49 FOOT
22	560+32	-		T.H. 35W S.B.	UNDERPASS	LED
23	41+53	-		C.R. H N.E. RAMP	9-40	40 FOOT
24	44+06	-		C.R. H N.E. RAMP	9-40	40 FOOT
25	46+47	-		C.R. H N.E. RAMP	9-40	40 FOOT
26	102+48	-		C.R. H N.W. RAMP	9-40	40 FOOT
27	105+21	-		C.R. H N.W. RAMP	9-40	40 FOOT
29	435+66	-		T.H. 10 N.B.	9-40	40 FOOT
30	437+38	-		T.H. 10 N.B.	9-40	40 FOOT
31	439+21	-		T.H. 10 N.B.	9-40	40 FOOT
32	441+62	-		T.H. 10 N.B.	9-49	49 FOOT

B AND R DENOTE CURRENT CARRYING CONDUCTORS
W DENOTES NEUTRAL CONDUCTOR

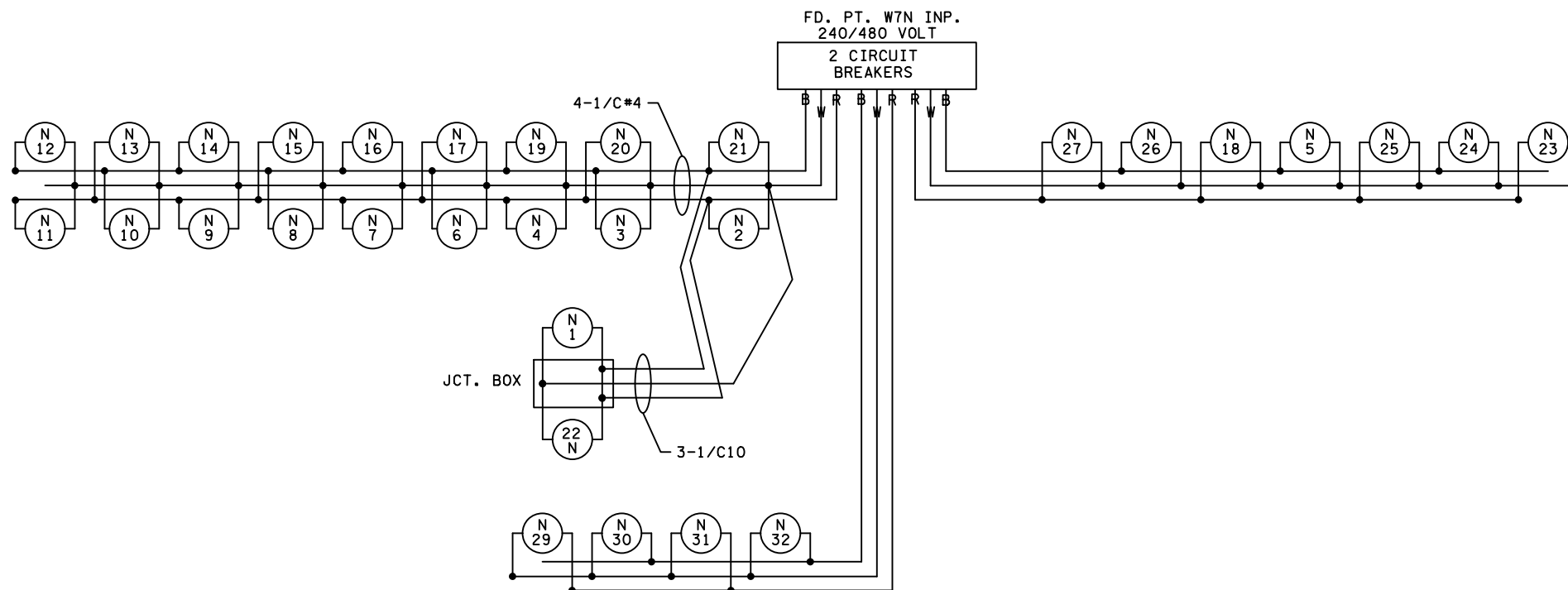

2:48:18 PM 12/3/2021 \\Projects\2018\18005\CONSTRUCTION\Plan Sheets\cd6284180_cd_11151.dgn

2	1/14/20	LEW	MPM	RFC DP T-5
3	05/27/20	AKS	MPM	FDC 194
4	12/03/21			RECORD DRAWING
NO	DATE	DWN	CKD	REVISIONS



RECORD DRAWING NOTE: THESE RECORD DRAWINGS WERE DEVELOPED BASED ON THE PREVIOUS DRAWING REVISIONS AND INFORMATION TRANSMITTED FROM THE FIELD BY OTHERS. THE INFORMATION CONTAINED WITHIN THIS RECORD AS-BUILT PLAN REPRESENTS THE ACTUAL CONDITIONS FOR ALL CHANGES OF WHICH ALLIANT IS AWARE. FUTURE USERS OF THESE DRAWINGS SHOULD VERIFY AS-BUILT CONDITIONS IN THE FIELD IN ALL CIRCUMSTANCES.

LIGHTING PLANS
FD. PT. W7N CHART & WIRING DIAGRAM

I-35W NORTH MNPASS DB (S.P. 6284-180)
SHEET NO. LL51 OF LL67 SHEETS