

- NOTES:**
- ① 1/2" NMC SCHEDULE 80 WITH (3) #4 AND (1) #4 GND
 - ② 1/2" RSC WITH (3) #4 AND (1) #4 GND
 - ③ 1" NMC SCHEDULE 80 TO SIGN BASE
 - ④ 2" NMC SCHEDULE 80 WITH (3) #1 AND (1) #6 GND

FEEDPOINT W5J LIGHTING STANDARDS AND BASES							
NO.	ROADWAY	STATION	OFFSET	LUMIN-AIRE	TYPE	BASE	ACCESS
1	I-35W NB	200+40	47' RT	400HPSIII	12-50	TRANS	180
2	I-35W NB	202+35	47' RT	400HPSIII	12-50	TRANS	180
3	I-35W NB	204+55	64' RT	400HPSIII	12-50	TRANS	180
4	I-35W NB	206+75	49.75' RT	400HPSIII	12-47.33	WALL	0-180
5	I-35W NB	208+95	49.75' RT	400HPSIII	12-47.33	WALL	0-180
6	I-35W NB	211+15	62' RT	400HPSIII	12-50	TRANS	180
7	I-35W NB	213+35	62' RT	400HPSIII	12-50	TRANS	180
8	I-35W NB	215+47.67	49.75' RT	LEDIII	12-37.33	TRANS	0
9	I-35W SB	216+55.14	49.75' RT	LEDIII	12-37.33	TRANS	0
10	I-35W SB	213+40	49.75' LT	400HPSIII	12-47.33	WALL	0-180
11	I-35W SB	211+20	62' LT	400HPSIII	12-50	TRANS	180
12	I-35W SB	209+00	62' LT	400HPSIII	12-50	TRANS	180
13	I-35W SB	206+80	75' LT	400HPSIII	12-50	TRANS	180
14	I-35W SB	204+70	47' LT	400HPSIII	12-50	TRANS	180
15	I-35W SB	202+50	47' LT	400HPSIII	12-50	TRANS	180
16	I-35W SB	200+50	47' LT	400HPSIII	12-50	TRANS	180
17	WASH SB RAMP	106+50	23' LT	250HPSII	9-40	TRANS	180
18	WASH SB RAMP	104+70	23' LT	250HPSII	9-40	TRANS	180
19	WASH SB RAMP	103+00	28' LT	250HPSII	9-40	TRANS	180
20	WASH SB RAMP	101+20	27' LT	250HPSII	9-40	TRANS	180
21	WASH NB RAMP	101+40	27' RT	250HPSII	9-40	TRANS	180
22	WASH NB RAMP	103+30	27' RT	250HPSII	9-40	TRANS	180

LEGEND

- LUMINAIRE
- COMBINATION EXPANSION/DEFLECTION FITTING
- FLEX LOOP
- RSC IN BRIDGE
- NMC SCHEDULE 40 INSIDE OF BOX
- NMC SCHEDULE 80 ELSEWHERE
- DESIGNATES FEED POINT
- DESIGNATES FIXTURE NUMBER
- JUNCTION BOX MOUNTED TO TOP OF INSIDE BOX
- LIGHTING SERVICE CABINET
- HAND HOLE
- NMC TO RSC ADAPTOR

RELEASED FOR CONSTRUCTION

TRANS = 4 BOLT ASSEMBLY
 WALL = 6 BOLT ASSEMBLY
 ACCESS = 0° IS IN DIRECTION OF DAVIT ARM

DATE: 7/17/2008 TIME: 10:41:48 AM
 FILENAME: K:\C\Fig\egrt\p\401600\NMC-032.rvt

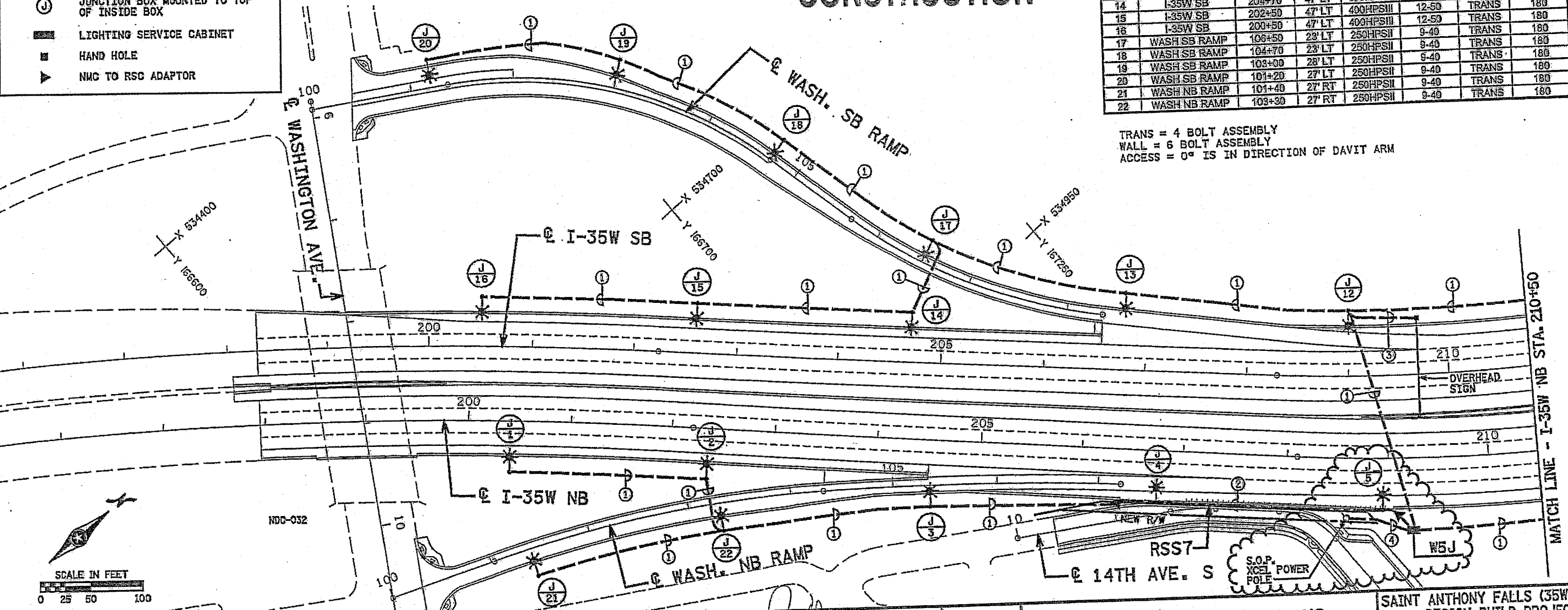

NO.	DATE	BY	DESCRIPTION OF REVISIONS
REV 0	2/22/08	JEB	RFC
NDC-032	5/25/08	JEB	GENERAL REVISIONS
NDC-072	7/17/08	JEB	ADD S.O.P. & FEEDPOINT FEEDER

DES: JEB
 DRW: SFH
 CHK: JEB

I HEREBY CERTIFY THAT THIS PLAN WAS PREPARED BY ME OR UNDER MY DIRECT SUPERVISION AND THAT I AM A FULLY LICENSED PROFESSIONAL ENGINEER UNDER THE LAWS OF THE STATE OF MINNESOTA.

SIGNATURE: *J. E. Budke*
 PRINTED NAME: J. E. BUDKE
 DATE: 7/17/2008 LIC. NO. 8943

TKDA
 ENGINEERS-ARCHITECTS-PLANNERS

RELEASED FOR CONSTRUCTION

MIN/DOT: *[Signature]*
 DATE: 7/21/08



ROADWAY LIGHTING PLANS
 I-35W NB STA. 197+95 TO STA. 210+50

SAINT ANTHONY FALLS (35W) BRIDGE
 DESIGN BUILD PROJECT
 S.P. 2783-120 (I-35W)

Sheet No. R-LII of Sheets



LEGEND

- LUMINAIRE
- COMBINATION EXPANSION/DEFLECTION FITTING
- FLEX LOOP
- RSC IN BRIDGE
- NMC SCHEDULE 40 INSIDE OF BOX
- NMC SCHEDULE 80 ELSEWHERE
- DESIGNATES FEED POINT
- DESIGNATES FIXTURE NUMBER
- JUNCTION BOX MOUNTED TO TOP OF INSIDE BOX
- LIGHTING SERVICE CABINET
- HAND HOLE
- NMC TO RSC ADAPTOR

NOTES:

- ① 1/2" NMC SCHEDULE 80 WITH (3) #4 AND (1) #4 GND
- ② 1/2" RSC WITH (3) #4 AND (1) #4 GND
- ③ 1" NMC SCHEDULE 80 TO SIGN BASE

DATE: 6/13/2008 TIME: 2:36:02 PM
FILENAME: K:\P\Fig\Edg\p1401600\Nwy-brdg\Nwy\p14r-shf\Nod2783120_r-112.dgn

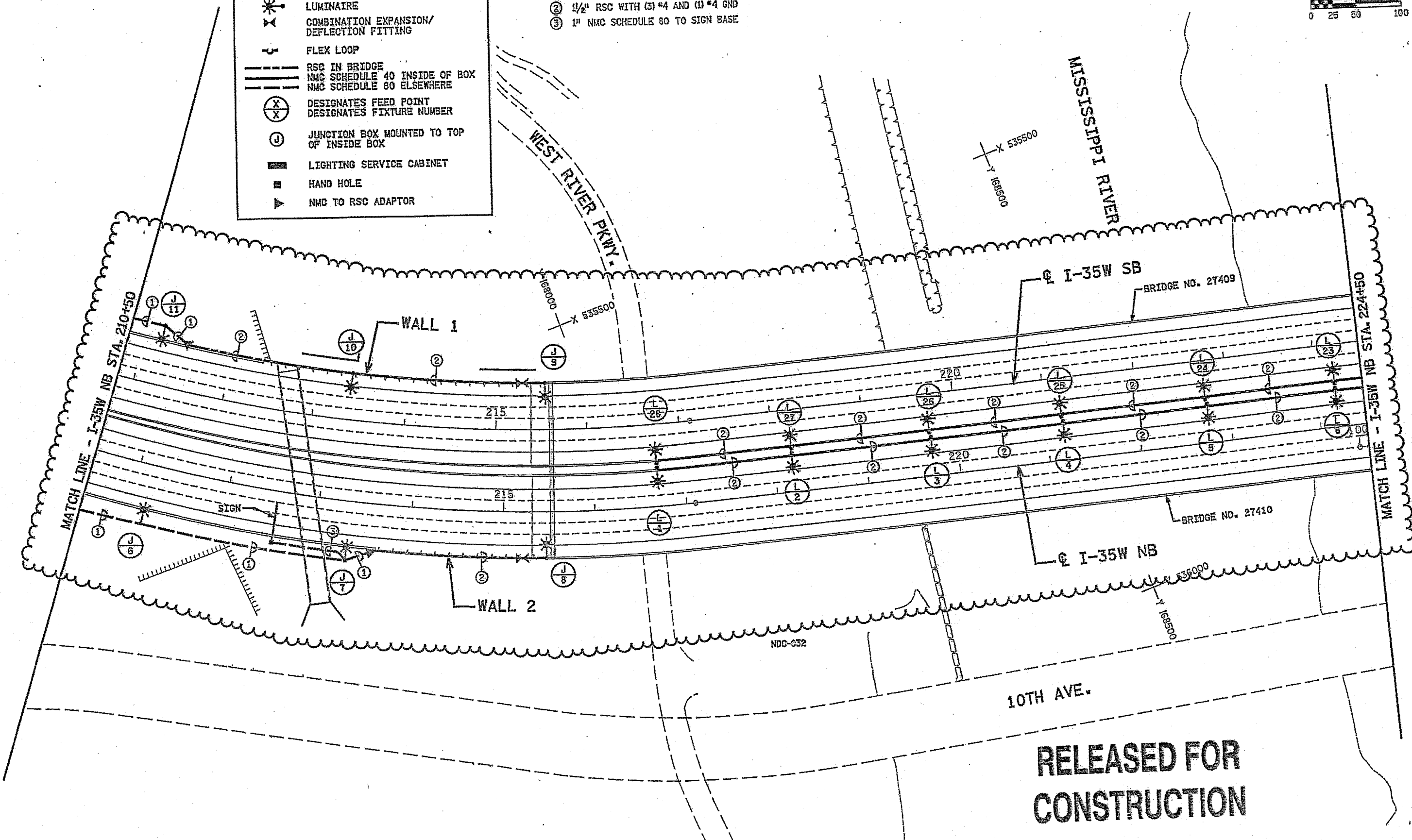

RELEASED FOR CONSTRUCTION

REV 0	2/22/08	JEB	RFC
NDC-032	6/13/08	JEB	GENERAL REVISIONS
NO.	DATE	BY	DESCRIPTION OF REVISIONS

DES: JEB
 DRW: SFH
 CHK: JEB

I HEREBY CERTIFY THAT THIS PLAN WAS PREPARED BY ME OR UNDER MY DIRECT SUPERVISION AND THAT I AM A FULLY LICENSED PROFESSIONAL ENGINEER UNDER THE LAWS OF THE STATE OF MINNESOTA.

SIGNATURE: *J. E. Budke*
 PRINTED NAME: J. E. BUDKE
 DATE: 6/13/2008 LIC. NO. 8943

RELEASED FOR CONSTRUCTION

TKDA
 ENGINEERS • ARCHITECTS • PLANNERS

Todd Ingham
 MN/DOT
 DATE: 6-27-08

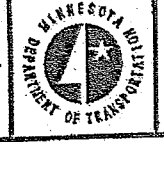

ROADWAY LIGHTING PLANS
 I-35W NB STA. 210+50 TO STA. 224+50

SAINT ANTHONY FALLS (35W) BRIDGE
 DESIGN BUILD PROJECT
 S.P. 2783-120 (I-35W)

Sheet No. R-L12 of Sheets