

HALF TOP VIEW

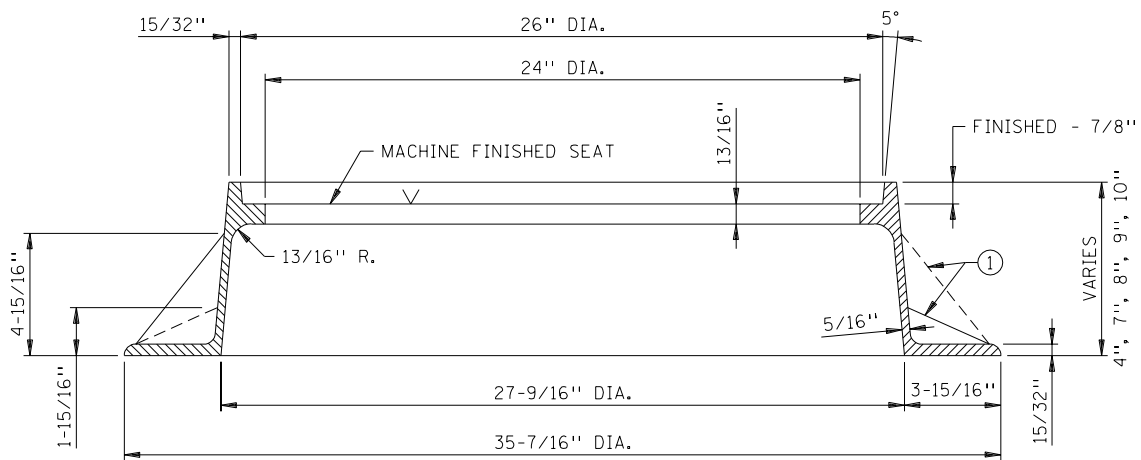

SECTION A-A
(NO. 700-7 SHOWN)

NOTES:

THIS RING CASTING TO BE USED IN CONJUNCTION WITH ANY OF THE FOLLOWING CASTINGS:
 MANHOLE COVER NO. 715 OR NO. 716
 MANHOLE OR CATCH BASIN GRATES NO. 720 OR NO. 721 .

① ALTERNATING GUSSETS (3 EACH).

4" CASTING NO. 700-4 (98 LBS.)
 7" CASTING NO. 700-7 (118 LBS.)
 8" CASTING NO. 700-8
 9" CASTING NO. 700-9
 10" CASTING NO. 700-10

APPROVED OCTOBER 25, 1996

Donald J. Robinson

STATE DESIGN ENGINEER

STATE OF MINNESOTA
 DEPARTMENT OF TRANSPORTATION

RING CASTING FOR MANHOLE
 OR CATCH BASIN

SPECIFICATION
 REFERENCE

2506

STANDARD
 PLATE
 NO.

4101D