

SEE LEGEND PAGE 457

B AND R DENOTE CURRENT CARRYING CONDUCTORS  
W DENOTES NEUTRAL CONDUCTOR

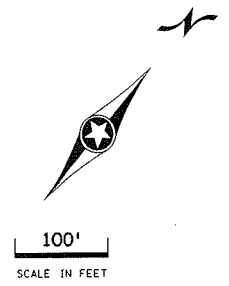

PLOTTED/REVISED: 2/23/2010

DISTRICT \*: METRO  
PLOT NAME: 6211-81\_lot-3ab  
PATH & FILENAME: c:\N\Project\15e\PW\_Working\15e\15e\6211-81\_lot-3ab.dgn

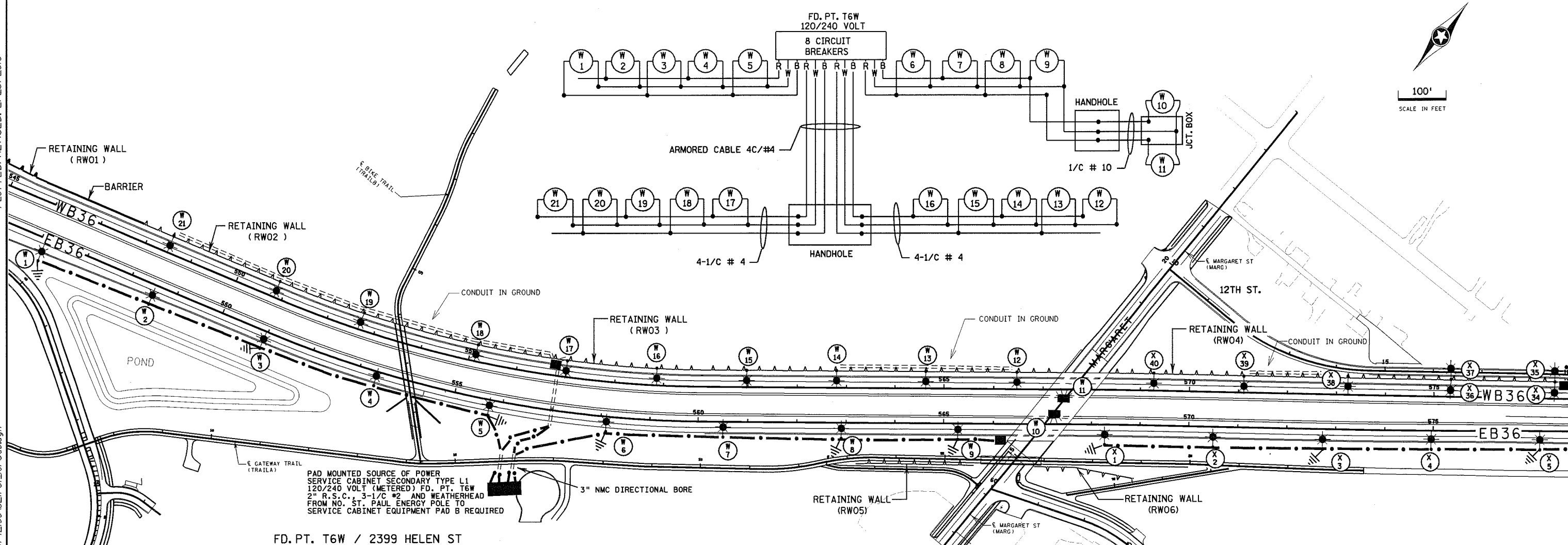

PAD MOUNTED SOURCE OF POWER  
SERVICE CABINET SECONDARY TYPE L1  
120/240 VOLT (METERED) FD. PT. T6W  
2" R.S.C., 3-1/C #2 AND WEATHERHEAD  
FROM NO. ST. PAUL ENERGY POLE TO  
SERVICE CABINET EQUIPMENT PAD B REQUIRED

FD. PT. T6W / 2399 HELEN ST

LIGHTING STANDARDS AND BASES						
NO.	STATION	LT.	RT.	LOCATION	TYPE	WATTAGE
1	546+10			EB36	9-40	250
2	548+55					
3	550+95					
4	553+40					
5	555+75					
6	558+10					
7	560+50					
8	562+90					
9	565+30				9-40	
10	567+25			EB36	L	
11	567+40			WB36	L	
12	566+45				9B-40	
13	564+65					
14	562+80					
15	561+00					
16	558+85					
17	557+00					
18	555+15					
19	552+70					
20	550+85					
21	548+50			WB36	9B-40	250

- ① LIGHTING UNITS WILL BE PLACED ON RETAINING WALLS
- ② LIGHTING UNITS WILL BE PLACED ON PILASTERS. FOR BASE DETAIL AND POLE HEIGHT SEE TABLE PAGE 447

AS-BUILT 2/2010  
FD. PT. T6W  
FD. PT. T6X

DRAWN BY: NS

CHECKED BY: GB

CERTIFIED BY

*Michael P. Delaney*  
LICENSED PROFESSIONAL ENGINEER

LIC. NO. 19863

DATE 8/24/2006

**LIGHTING LAYOUT**

STATE PROJ. NO. 6211-81 (T.H. 36 ) SHEET NO. 459 OF 562 SHEETS