

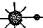

LEGEND

-  HIGH PRESSURE SODIUM LIGHTING UNIT
-  HIGH PRESSURE TWIN SODIUM LIGHTING UNIT
-  PAD MOUNTED SOURCE OF POWER
120/240 VOLT
-  ARMORED CABLE 4 CONDUCTOR NO. 4
-  3" NON-METALLIC CONDUIT UNLESS OTHERWISE NOTED
-  PERMANENT GROUND ROD (25 OHMS OR LESS)

FD. PT. T6T

LIGHTING STANDARDS AND BASES					
NO.	STATION	LT.	RT.	LOCATION	WATTAGE
1	497+70		---	EB36	9-40 250
2	500+00		---		
3	502+30		---		
4	504+55		---		
5	506+80		---		
6	509+10		---		
7	511+35		---		
8	513+55		---		
9	516+10		---		
10	518+60		---	EB36	
11	518+70		---	WB36	
12	516+20		---		
13	513+75		---		
14	511+25		---		
15	508+75		---		
16	506+25		---		
17	503+65		---		
18	501+15		---		
19	498+65		---		
20	496+10		---	WB36	9-40 250

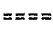
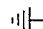

PLOTTED/REVISED: 8/24/2006

DISTRICT #: METRO
IFLOT NAME: 6211-81-101
PATH & FILENAME: S:\TRAFFIC\LIGHTING\Plans\036\6211-81\6211-81-101-3.dgn

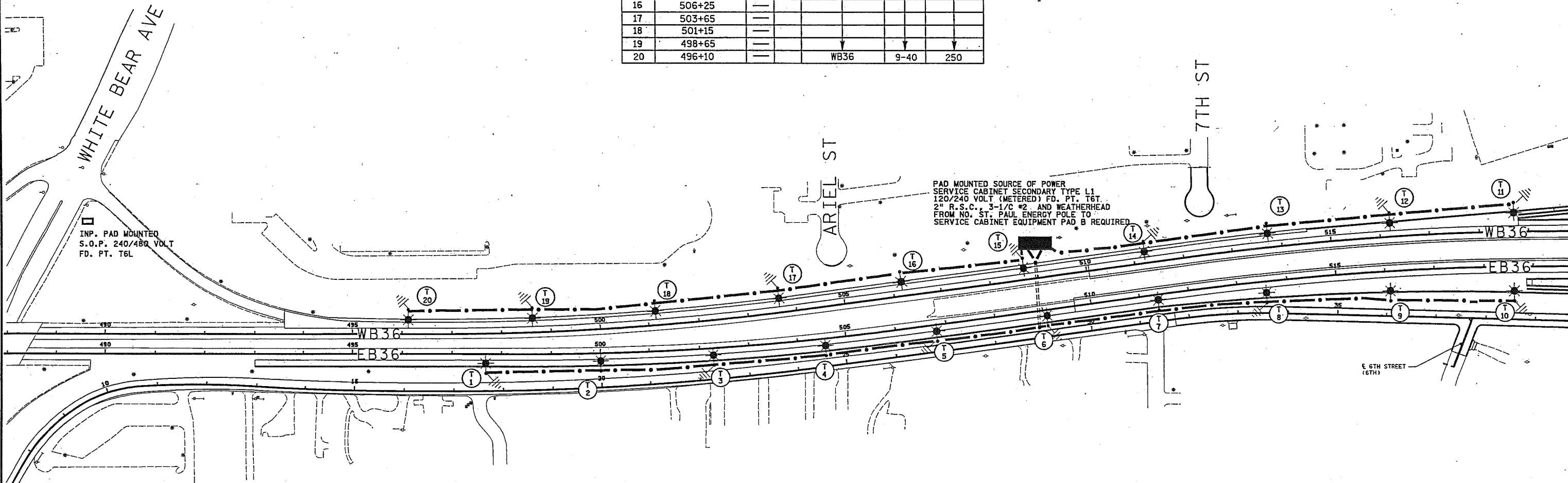

B AND R DENOTE CURRENT CARRYING CONDUCTORS
W DENOTES NEUTRAL CONDUCTOR

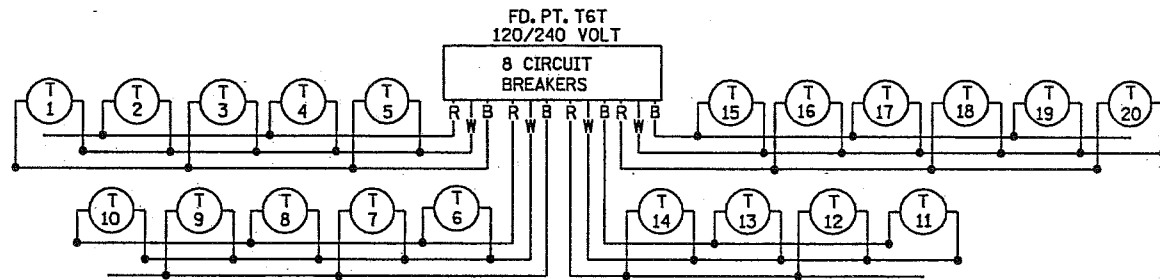

FD. PT. T6T

DRAWN BY: NS

CHECKED BY: GB

CERTIFIED BY

Michael P. Selinsky
LICENSED PROFESSIONAL ENGINEER

LIC. NO. 19863

DATE 8/24/2006

LIGHTING LAYOUT

STATE PROJ. NO. 6211-81 (T.H. 36) SHEET NO. 457 OF 562 SHEETS