

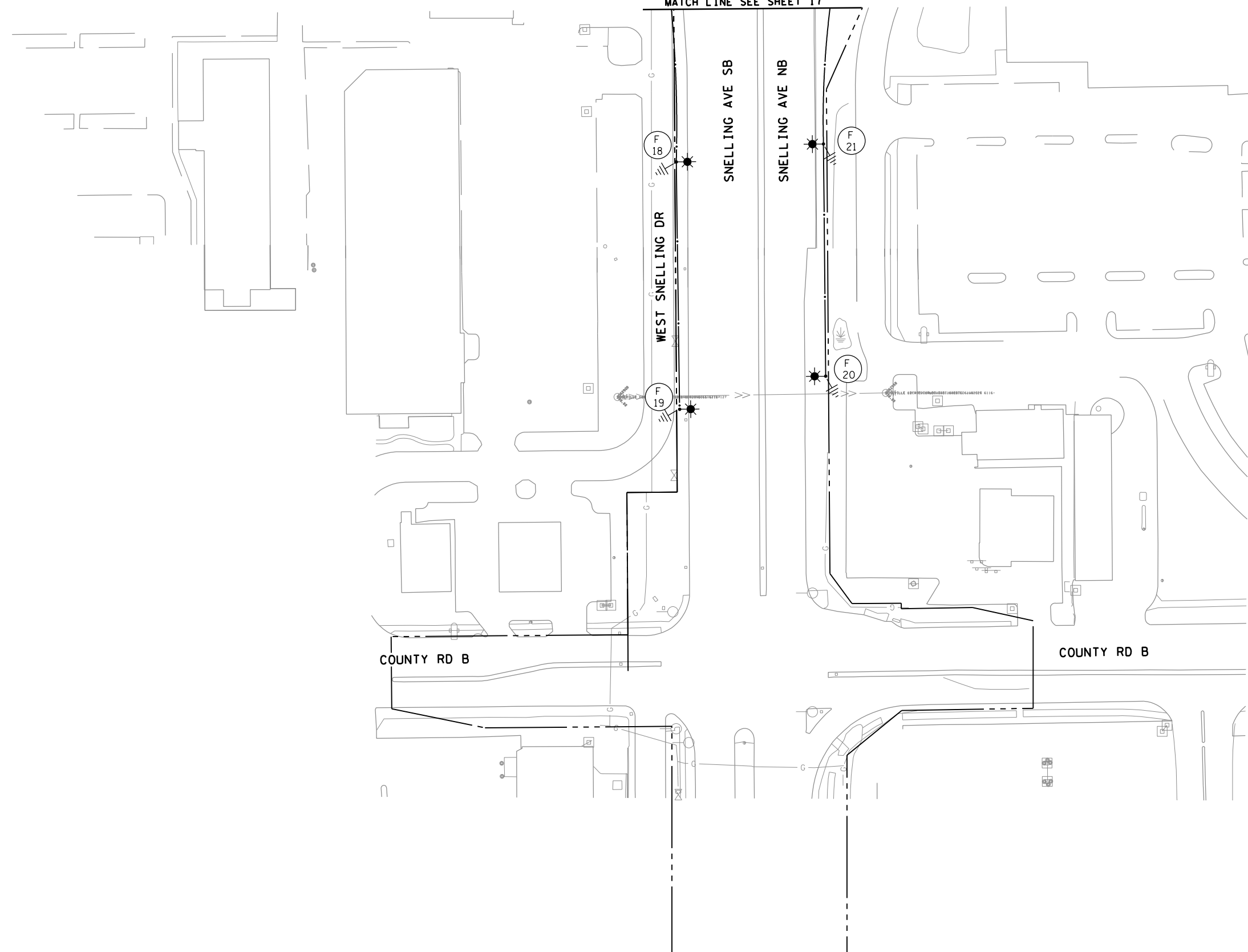

MATCH LINE SEE SHEET 17



DATE: 3/12/2018 3:09:10 PM
PATH & FILENAME: K:\1010964-000\Cad\Plan\10964-000_lp05.dgn

SEE LEGEND SHEET 14

NO.	DATE	BY	CHK	REVISIONS

Design By: ES
 Plan By: MF
 Checked By: ES
 Approved By: SD

I HEREBY CERTIFY THAT THIS PLAN WAS PREPARED BY ME OR UNDER MY DIRECT SUPERVISION AND THAT I AM A DULY LICENSED PROFESSIONAL ENGINEER UNDER THE LAWS OF THE STATE OF MINNESOTA.

Sean Delmore
 SEAN DELMORE, PE
 DATE: 03/12/18 LICENSE NO. 40845



LIGHTING REPLACEMENT ON
 TH 36 AND TH 35E
 MNDOT

SYSTEM A
 TH 36: SNELLING AVE TO TH 61
 S.P.6212-185 (TH36), SP.6211-106 (TH36),
 S.P.1982-198 (TH35E), S.P.6280-402 (TH35E)

SHEET
 18
 OF
 46
 SHEETS

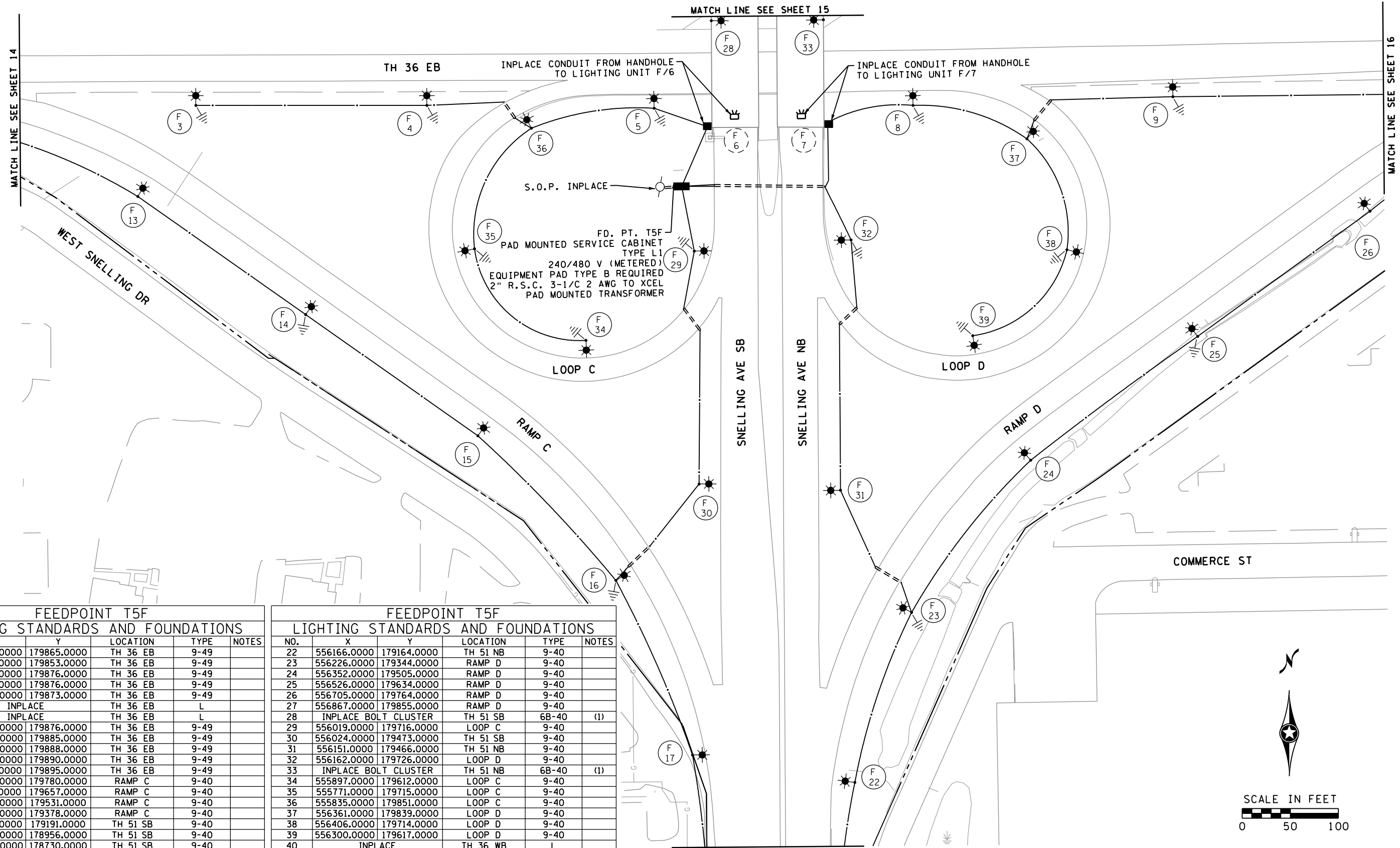

FEEDPOINT T5F LIGHTING STANDARDS AND FOUNDATIONS					
NO.	X	Y	LOCATION	TYPE	NOTES
1	555012.0000	179865.0000	TH 36 EB	9-49	
2	555251.0000	179853.0000	TH 36 EB	9-49	
3	555491.0000	179876.0000	TH 36 EB	9-49	
4	555731.0000	179876.0000	TH 36 EB	9-49	
5	555967.0000	179873.0000	TH 36 EB	9-49	
6			INPLACE	TH 36 EB	L
7			INPLACE	TH 36 EB	L
8	556236.0000	179876.0000	TH 36 EB	9-49	
9	556506.0000	179885.0000	TH 36 EB	9-49	
10	556776.0000	179888.0000	TH 36 EB	9-49	
11	557045.0000	179890.0000	TH 36 EB	9-49	
12	557315.0000	179895.0000	TH 36 EB	9-49	
13	555436.0000	179780.0000	RAMP C	9-40	
14	555611.0000	179657.0000	RAMP C	9-40	
15	555790.0000	179531.0000	RAMP C	9-40	
16	555936.0000	179378.0000	RAMP C	9-40	
17	556015.0000	179191.0000	TH 51 SB	9-40	
18	556027.0000	178956.0000	TH 51 SB	9-40	
19	556030.0000	178730.0000	TH 51 SB	9-40	
20			INPLACE FOUNDATION	TH 51 NB	9-40 (2)
21			INPLACE FOUNDATION	TH 51 NB	9-40 (2)

FEEDPOINT T5F LIGHTING STANDARDS AND FOUNDATIONS					
NO.	X	Y	LOCATION	TYPE	NOTES
22	556166.0000	179164.0000	TH 51 NB	9-40	
23	556226.0000	179344.0000	RAMP D	9-40	
24	556352.0000	179505.0000	RAMP D	9-40	
25	556526.0000	179634.0000	RAMP D	9-40	
26	556705.0000	179764.0000	RAMP D	9-40	
27	556867.0000	179855.0000	RAMP D	9-40	
28			INPLACE BOLT CLUSTER	TH 51 SB	6B-40 (1)
29	556019.0000	179716.0000	LOOP C	9-40	
30	556024.0000	179473.0000	TH 51 SB	9-40	
31	556151.0000	179466.0000	TH 51 NB	9-40	
32	556162.0000	179726.0000	LOOP D	9-40	
33			INPLACE BOLT CLUSTER	TH 51 NB	6B-40 (1)
34	555897.0000	179612.0000	LOOP C	9-40	
35	555771.0000	179715.0000	LOOP C	9-40	
36	555835.0000	179851.0000	LOOP C	9-40	
37	556361.0000	179839.0000	LOOP D	9-40	
38	556406.0000	179714.0000	LOOP D	9-40	
39	556300.0000	179617.0000	LOOP D	9-40	
40			INPLACE	TH 36 WB	L
41			INPLACE	TH 36 WB	L

(1) F&I LIGHTING UNIT ON EXISTING BOLT CLUSTER
 (2) F&I LIGHTING UNIT ON EXISTING FOUNDATION

T5F METER ADDRESS: 2195 SNELLING AVE N, ROSEVILLE, MN 55113 SEE LEGEND SHEET 14



DATE: 3/12/2018 3:09:09 PM
 PATH & FILENAME: K:\1010964-000\Cad\Plan\10964-000_lp04.dgn

NO.	DATE	BY	CHK	REVISIONS

Design By: ES
 Plan By: MF
 Checked By: ES
 Approved By: SD

I HEREBY CERTIFY THAT THIS PLAN WAS PREPARED BY ME OR UNDER MY DIRECT SUPERVISION AND THAT I AM A DULY LICENSED PROFESSIONAL ENGINEER UNDER THE LAWS OF THE STATE OF MINNESOTA.

Sean Delmore
 SEAN DELMORE, PE
 DATE: 03/12/18 LICENSE NO. 40845



LIGHTING REPLACEMENT ON
 TH 36 AND TH 35E
 MNDOT

SYSTEM A
 TH 36: SNELLING AVE TO TH 61
 S.P.6212-185 (TH36), SP.6211-106 (TH36),
 S.P.1982-198 (TH35E), S.P.6280-402 (TH35E)

SHEET
 17
 OF
 46
 SHEETS

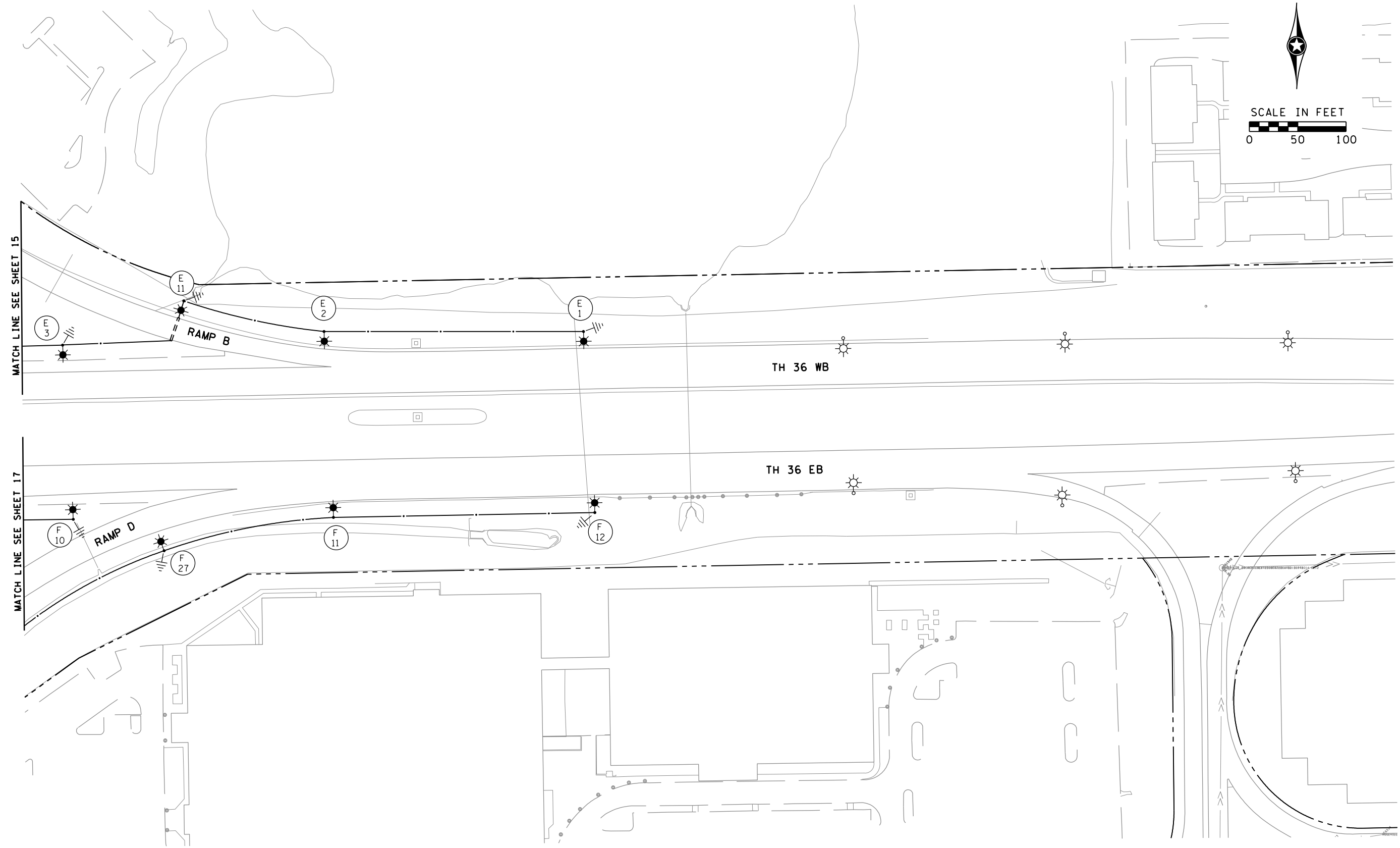

SEE LEGEND SHEET 14

DATE: 3/12/2018 3:09:08 PM
PATH & FILENAME: K:\1010964-000\Cad\Plan\10964-000_lp03.dgn

NO.	DATE	BY	CHK	REVISIONS

Design By: ES
 Plan By: MF
 Checked By: ES
 Approved By: SD

I HEREBY CERTIFY THAT THIS PLAN WAS PREPARED BY ME OR UNDER MY DIRECT SUPERVISION AND THAT I AM A DULY LICENSED PROFESSIONAL ENGINEER UNDER THE LAWS OF THE STATE OF MINNESOTA.

Sean Delmore
 SEAN DELMORE, PE
 DATE: 03/12/18 LICENSE NO. 40845



LIGHTING REPLACEMENT ON
 TH 36 AND TH 35E
 MNDOT

SYSTEM A
 TH 36: SNELLING AVE TO TH 61
 S.P.6212-185 (TH36), SP.6211-106 (TH36),
 S.P.1982-198 (TH35E), S.P.6280-402 (TH35E)

SHEET
 16
 OF
 46
 SHEETS

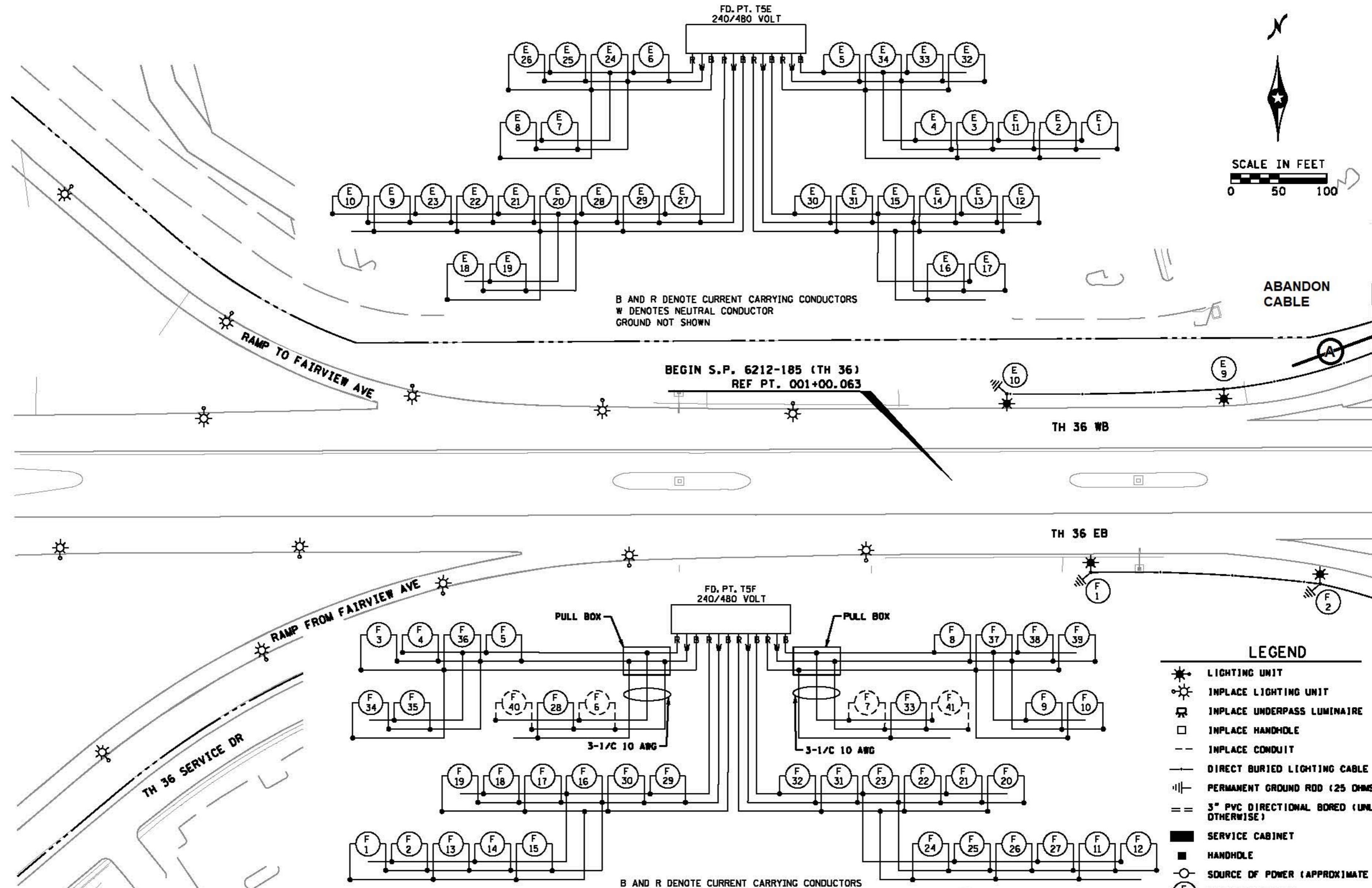
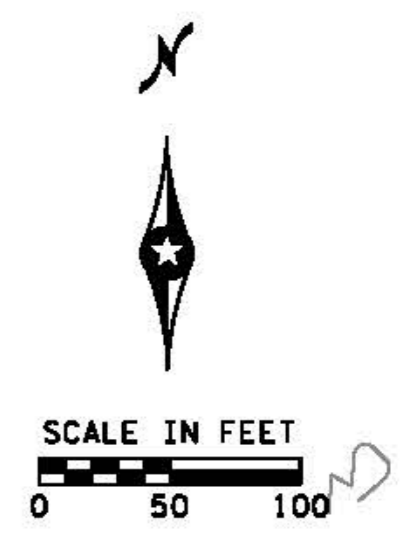

- LEGEND**
- LIGHTING UNIT
 - INPLACE LIGHTING UNIT
 - INPLACE UNDERPASS LUMINAIRE
 - INPLACE HANDHOLE
 - INPLACE CONDUIT
 - DIRECT BURIED LIGHTING CABLE 4/C 4 AWG
 - PERMANENT GROUND ROD (25 OHMS OR LESS)
 - 3" PVC DIRECTIONAL BORED (UNLESS NOTED OTHERWISE)
 - SERVICE CABINET
 - HANDHOLE
 - SOURCE OF POWER (APPROXIMATE LOCATION)
 - LIGHTING NUMBER
 - MN/DOT ROW

AS-BUILT

B AND R DENOTE CURRENT CARRYING CONDUCTORS
W DENOTES NEUTRAL CONDUCTOR
GROUND NOT SHOWN

DATE: 3/12/2018 3:09:05 PM
PATH & FILENAME: G:\1010964-000\Cad\Plan\10964-000_ip01.dgn

NO.	DATE	BY	CHK	REVISIONS

Design By: ES
 Plan By: MF
 Checked By: ES
 Approved By: SD

I HEREBY CERTIFY THAT THIS PLAN WAS PREPARED BY ME OR UNDER MY DIRECT SUPERVISION AND THAT I AM A DULY LICENSED PROFESSIONAL ENGINEER UNDER THE LAWS OF THE STATE OF MINNESOTA.

Sean Delmore
 SEAN DELMORE, PE
 DATE: 03/12/18 LICENSE NO. 40845



LIGHTING REPLACEMENT ON
TH 36 AND TH 35E
MNDOT

SYSTEM A
 TH 36: SNELLING AVE TO TH 61
 S.P.6212-185 (TH36), S.P.6211-106 (TH36),
 S.P.1982-198 (TH35E), S.P.6280-402 (TH35E)

SHEET
14
OF
46
SHEETS

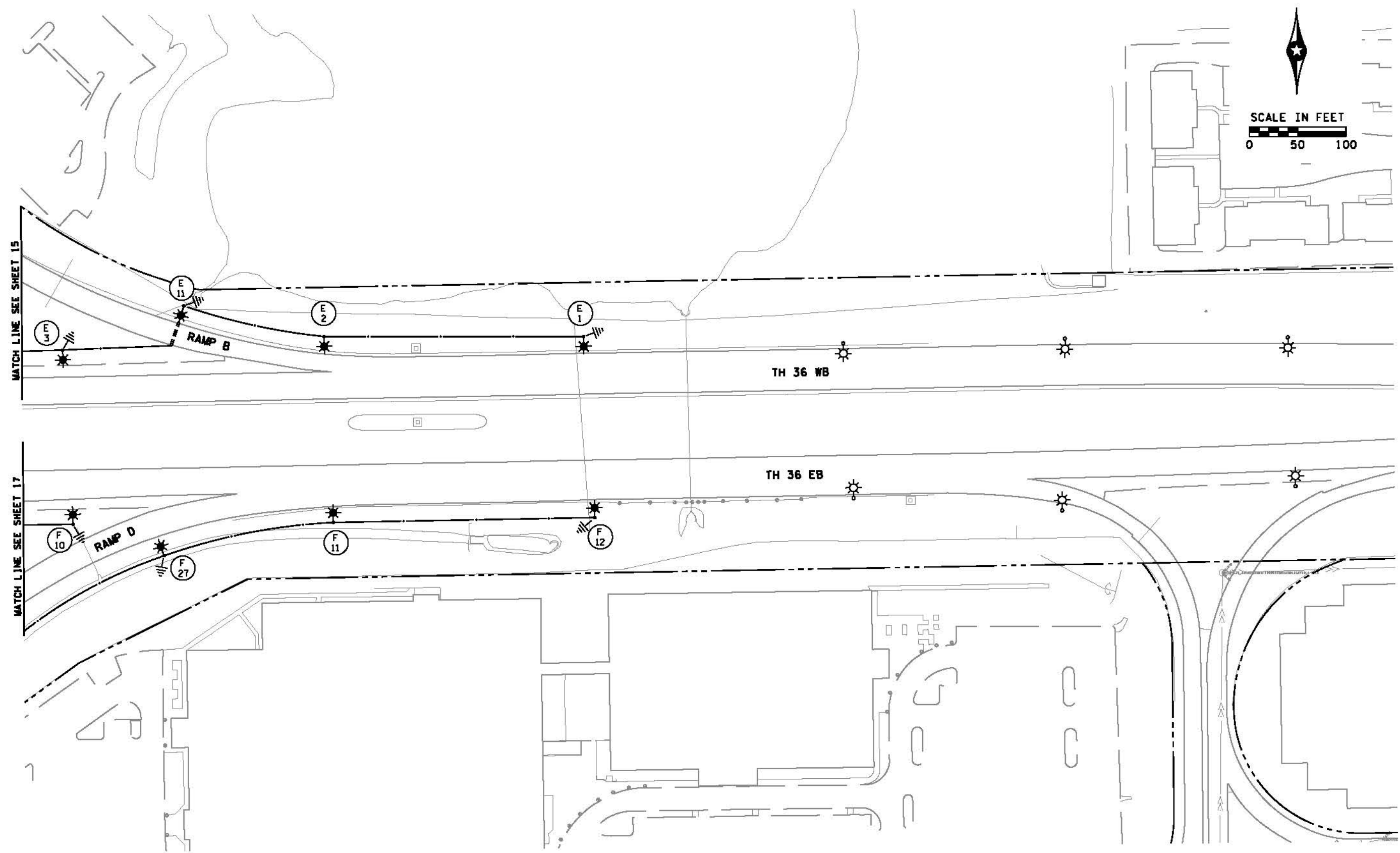
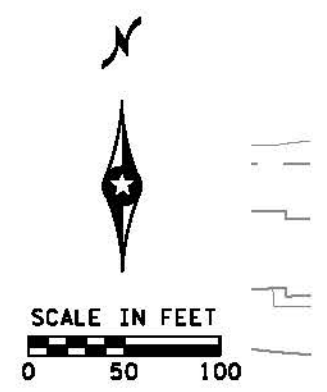

SEE LEGEND SHEET 14

DATE: 3/12/2018 3:09:08 PM
PATH & FILENAME: G:\1010964-000\Cad\Plan\10964-000_ip03.dgn

NO.	DATE	BY	CHK	REVISIONS

Design By: ES
 Plan By: MF
 Checked By: ES
 Approved By: SD

I HEREBY CERTIFY THAT THIS PLAN WAS PREPARED BY ME OR UNDER MY DIRECT SUPERVISION AND THAT I AM A DULY LICENSED PROFESSIONAL ENGINEER UNDER THE LAWS OF THE STATE OF MINNESOTA.

Sean Delmore
 SEAN DELMORE, PE
 DATE: 03/12/18 LICENSE NO. 40845



LIGHTING REPLACEMENT ON
 TH 36 AND TH 35E
 MNDOT

SYSTEM A
 TH 36: SNELLING AVE TO TH 61
 S.P.6212-185 (TH36), SP.6211-106 (TH36),
 S.P.1982-198 (TH35E), S.P.6280-402 (TH35E)

SHEET
 16
 OF
 46
 SHEETS

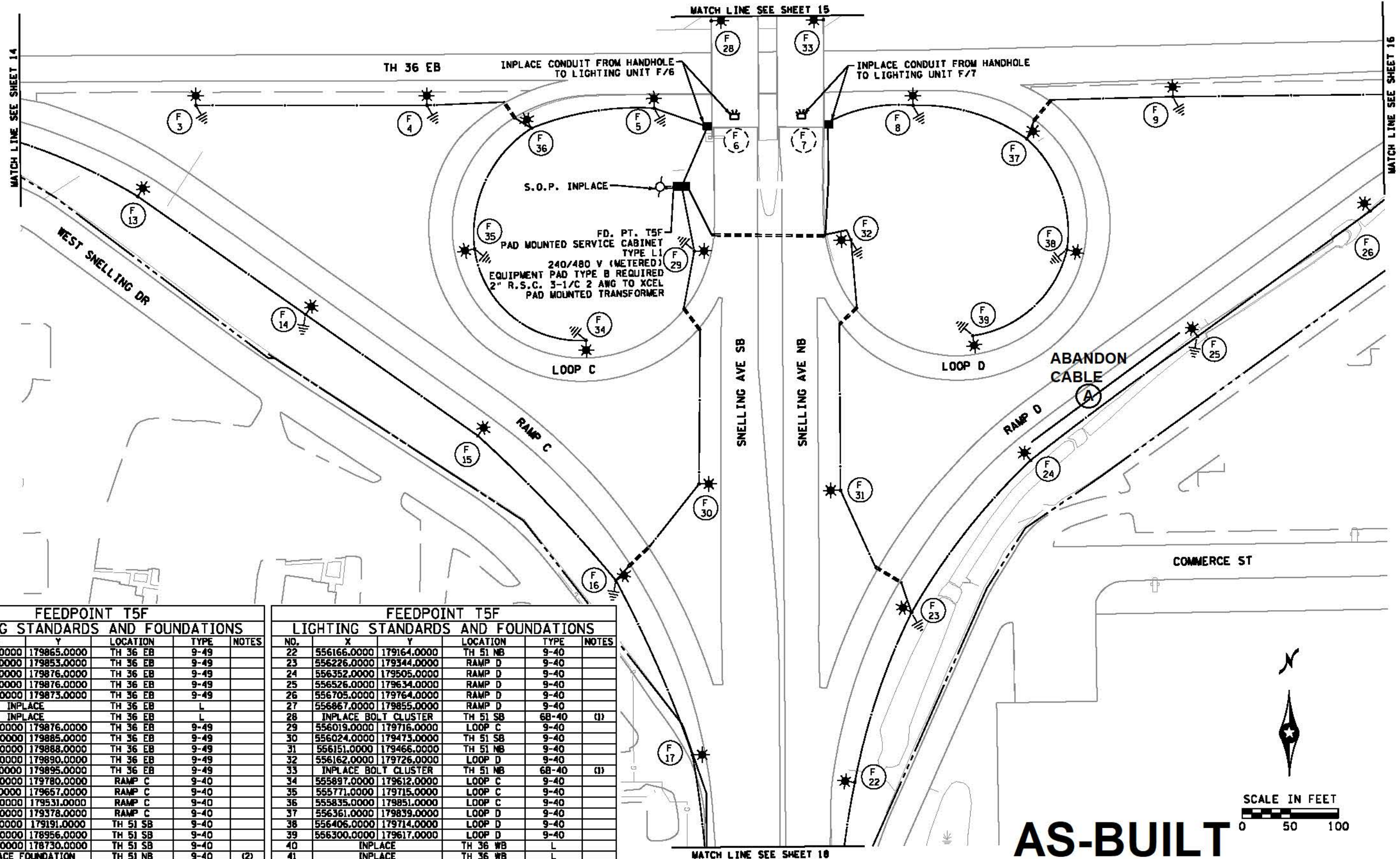

FEEDPOINT T5F LIGHTING STANDARDS AND FOUNDATIONS					
NO.	X	Y	LOCATION	TYPE	NOTES
1	555012.0000	179865.0000	TH 36 EB	9-49	
2	555251.0000	179853.0000	TH 36 EB	9-49	
3	555491.0000	179876.0000	TH 36 EB	9-49	
4	555731.0000	179876.0000	TH 36 EB	9-49	
5	555967.0000	179873.0000	TH 36 EB	9-49	
6			INPLACE	TH 36 EB	L
7			INPLACE	TH 36 EB	L
8	556236.0000	179876.0000	TH 36 EB	9-49	
9	556506.0000	179885.0000	TH 36 EB	9-49	
10	556776.0000	179888.0000	TH 36 EB	9-49	
11	557045.0000	179890.0000	TH 36 EB	9-49	
12	557315.0000	179895.0000	TH 36 EB	9-49	
13	555436.0000	179780.0000	RAMP C	9-40	
14	555611.0000	179657.0000	RAMP C	9-40	
15	555790.0000	179531.0000	RAMP C	9-40	
16	555936.0000	179378.0000	RAMP C	9-40	
17	556015.0000	179191.0000	TH 51 SB	9-40	
18	556027.0000	178956.0000	TH 51 SB	9-40	
19	556030.0000	178730.0000	TH 51 SB	9-40	
20			INPLACE FOUNDATION	TH 51 NB	9-40 (2)
21			INPLACE FOUNDATION	TH 51 NB	9-40 (2)

FEEDPOINT T5F LIGHTING STANDARDS AND FOUNDATIONS					
NO.	X	Y	LOCATION	TYPE	NOTES
22	556166.0000	179164.0000	TH 51 NB	9-40	
23	556226.0000	179344.0000	RAMP D	9-40	
24	556352.0000	179505.0000	RAMP D	9-40	
25	556526.0000	179634.0000	RAMP D	9-40	
26	556705.0000	179764.0000	RAMP D	9-40	
27	556867.0000	179855.0000	RAMP D	9-40	
28			INPLACE BOLT CLUSTER	TH 51 SB	68-40 (1)
29	556019.0000	179716.0000	LOOP C	9-40	
30	556024.0000	179473.0000	TH 51 SB	9-40	
31	556151.0000	179466.0000	TH 51 NB	9-40	
32	556162.0000	179726.0000	LOOP D	9-40	
33			INPLACE BOLT CLUSTER	TH 51 NB	68-40 (1)
34	555897.0000	179612.0000	LOOP C	9-40	
35	555771.0000	179715.0000	LOOP C	9-40	
36	555835.0000	179851.0000	LOOP C	9-40	
37	556361.0000	179839.0000	LOOP D	9-40	
38	556406.0000	179714.0000	LOOP D	9-40	
39	556300.0000	179617.0000	LOOP D	9-40	
40			INPLACE	TH 36 WB	L
41			INPLACE	TH 36 WB	L

(1) F&I LIGHTING UNIT ON EXISTING BOLT CLUSTER
 (2) F&I LIGHTING UNIT ON EXISTING FOUNDATION

T5F METER ADDRESS: 2195 SNELLING AVE N, ROSEVILLE, MN 55113 SEE LEGEND SHEET 14

AS-BUILT



DATE: 3/12/2018 3:09:09 PM PATH & FILENAME: G:\1010964-000\Cad\Plan\1010964-000_1p04.dgn

NO.	DATE	BY	CHK	REVISIONS

Design By: ES
 Plan By: MF
 Checked By: ES
 Approved By: SD

I HEREBY CERTIFY THAT THIS PLAN WAS PREPARED BY ME OR UNDER MY DIRECT SUPERVISION AND THAT I AM A DULY LICENSED PROFESSIONAL ENGINEER UNDER THE LAWS OF THE STATE OF MINNESOTA.

Sean Delmore
 SEAN DELMORE, PE
 DATE: 03/12/18 LICENSE NO.: 40845



LIGHTING REPLACEMENT ON TH 36 AND TH 35E
 MNDOT

SYSTEM A
 TH 36: SNELLING AVE TO TH 61
 S.P.6212-185 (TH36), SP.6211-106 (TH36),
 S.P.1982-198 (TH35E), S.P.6280-402 (TH35E)

SHEET 17 OF 46 SHEETS