

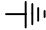





# LEGEND

-  LIGHTING UNIT
-  PERMANENT GROUND ROD (25 OHMS OR LESS)
-  DIRECT BURIED CABLE 4 CONDUCTOR NO. 4
-  HANDHOLE (HH)
-  3" PVC DIRECTIONAL BORED (UNLESS OTHERWISE NOTED)
-  INPLACE FD. PT. CABINET
-  INPLACE TYPE L LIGHTING UNIT

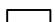

DISTRICT #: Metro  
 IPLOT NAME: 12758-74/lt-AB  
 PATH & FILENAME: Projects\DM\_ROMS\0772758\074\Traffic\Lighting\2758-74/lt-AB.dgn  
 PLOTTED/REVISED: 6-DEC-2018

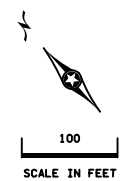
BEGIN S.P. 2758-74  
 END S.P. 1925-64  
 R.P. 006+00.168

INPLACE FD. PT. T2F  
 PAD MOUNTED SERVICE CABINET  
 TYPE L1 240/480V (METERED)  
 S.O.P. XCEL PAD MOUNTED TRANSFORMER

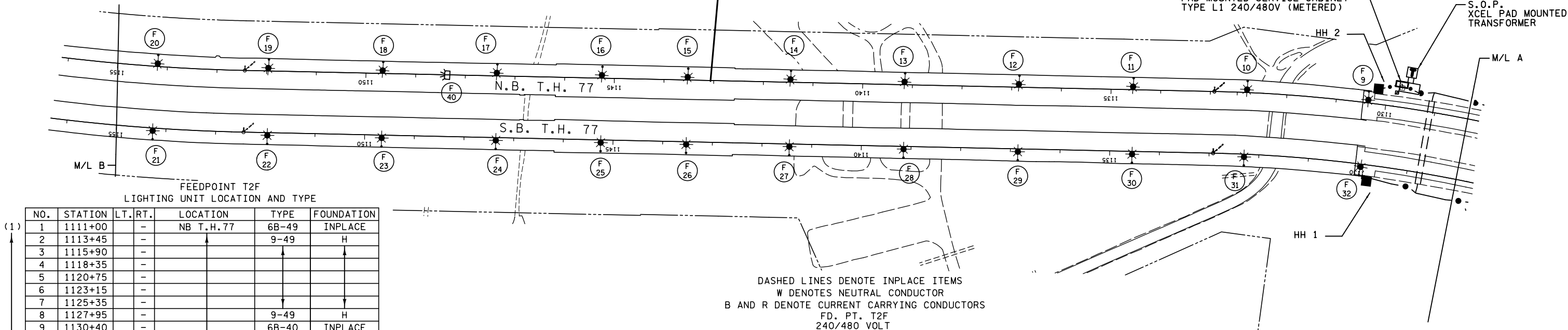

DASHED LINES DENOTE INPLACE ITEMS  
 W DENOTES NEUTRAL CONDUCTOR  
 B AND R DENOTE CURRENT CARRYING CONDUCTORS  
 FD. PT. T2F  
 240/480 VOLT

FEEDPOINT T2F LIGHTING UNIT LOCATION AND TYPE

NO.	STATION	LT.	RT.	LOCATION	TYPE	FOUNDATION
1	1111+00	-	-	NB T.H.77	6B-49	INPLACE
2	1113+45	-	-		9-49	H
3	1115+90	-	-			
4	1118+35	-	-			
5	1120+75	-	-			
6	1123+15	-	-			
7	1125+35	-	-			
8	1127+95	-	-		9-49	H
9	1130+40	-	-		6B-40	INPLACE
10	1132+80	-	-			
11	1134+55	-	-			
12	1136+85	-	-			
13	1139+15	-	-			
14	1141+45	-	-			
15	1143+50	-	-			
16	1145+25	-	-			
17	1147+35	-	-			
18	1149+65	-	-			
19	1151+95	-	-			
20	1154+25	-	-	NB T.H.77	6B-40	
21	1154+20	-	-	SB T.H.77	6B-40	
22	1151+95	-	-			
23	1149+65	-	-			
24	1147+35	-	-			
25	1145+25	-	-			
26	1143+50	-	-			
27	1141+45	-	-			
28	1139+15	-	-			
29	1136+85	-	-			
30	1134+55	-	-			
31	1132+30	-	-			
32	1129+95	-	-		6B-40	INPLACE
33	1127+35	-	-		9-49	H
34	1124+70	-	-			
35	1122+05	-	-			
36	1119+40	-	-			
37	1116+75	-	-			
38	1114+30	-	-			
39	1111+80	-	-	SB T.H.77	9-49	H
40	BR9600			PIER 14 N.B.	L	INPLACE

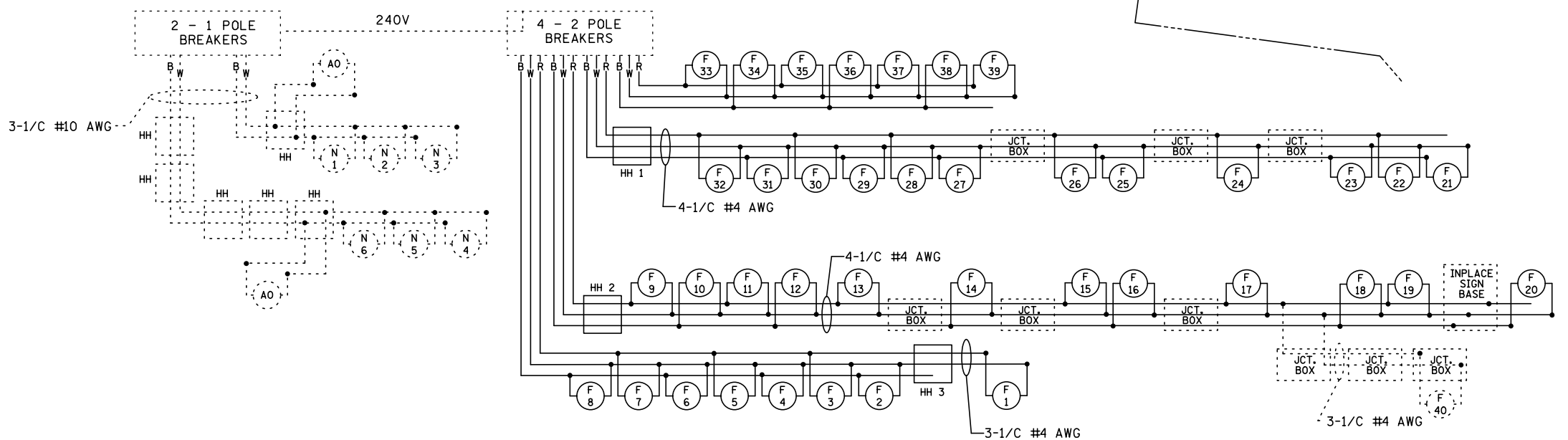

(1) INSTALL SALVAGED LUMINAIRE



## AS-BUILT

BY	DATE	REVISIONS	FEEDPOINT: T2F	LOCATION: HIGHWAY 77 SOUTH OF MN RIVER BRIDGE	<b>LIGHTING PLAN</b>
JP	12-6-18	AS-BUILT PLANS ALL COMPONENTS ARE G.P.S'd	METER ADDRESS: 3489 CEDAR AVENUE, EAGAN, MN 55337		
DRAWN BY: JC CKD BY: PB			CERTIFIED BY: <i>Michael P. Dubinsky</i>	LIC. NO. 19863	DATE: 6-DEC-2018
			STATE PROJ. NO. 2758-74 (T.H. 77)		STATE PROJ. NO. 1925-64 (T.H. 77)
					SHEET NO. 10 OF 16 SHEETS

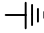
**LEGEND**

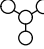
-  LIGHTING UNIT
-  PERMANENT GROUND ROD (25 OHMS OR LESS)
-  DIRECT BURIED CABLE 4 CONDUCTOR NO. 4
-  HANDHOLE (HH)
-  INPLACE TOWER

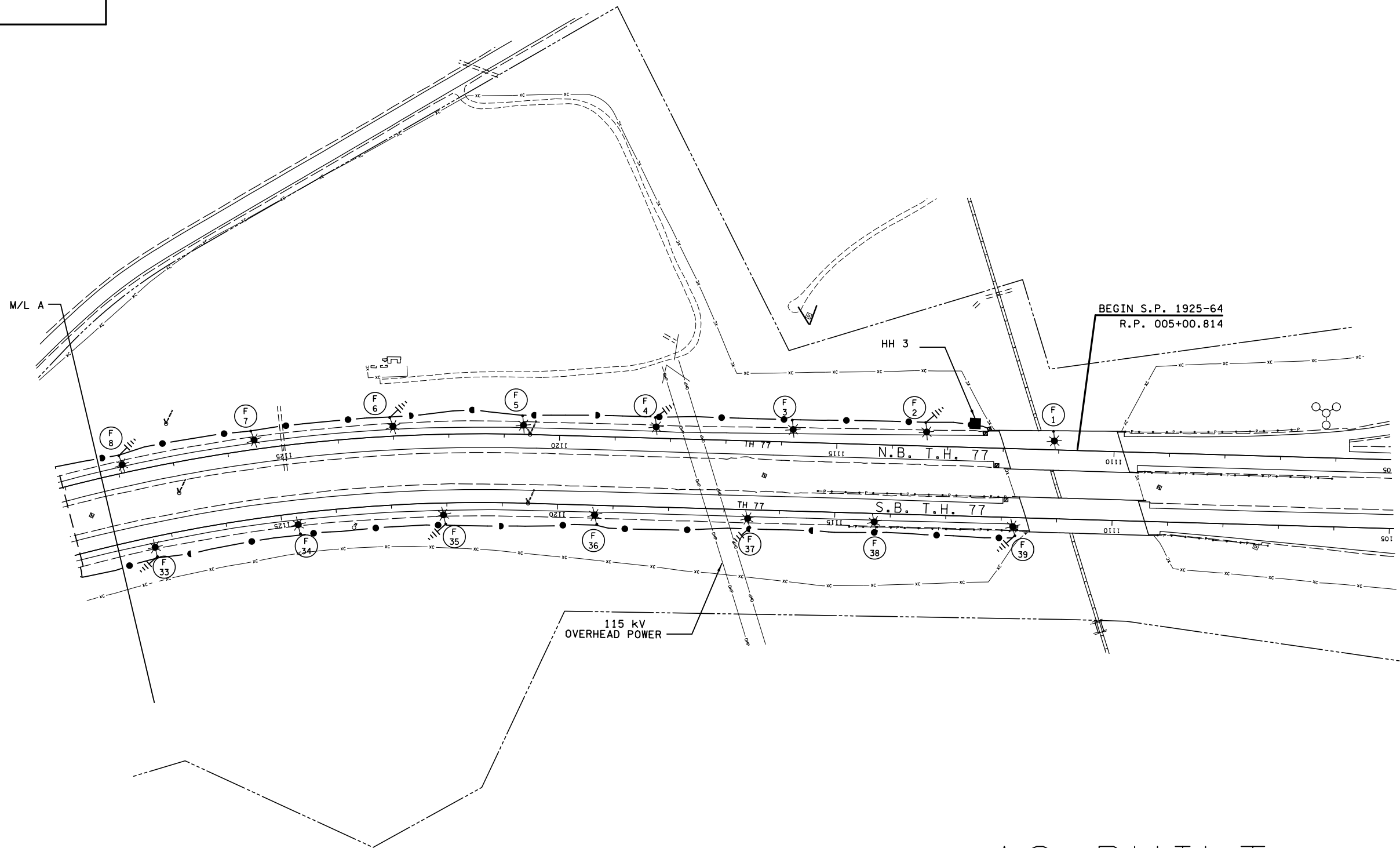

AS-BUILT

DISTRICT #: Metro  
 PLOT NAME: 12758-74.lt-AB  
 PATH & FILENAME: Projects\DM\_POS\077\2758\074\Traffic\Lighting\2758-74.lt-AB.dgn  
 PLOTTED/REVISED: 6-DEC-2018

BY	DATE	REVISIONS	FEEDPOINT: T2F    LOCATION: HIGHWAY 77 SOUTH OF MN RIVER BRIDGE	<b>LIGHTING PLAN</b>
			METER ADDRESS: 3489 CEDAR AVENUE, EAGAN, MN 55337	
JP 12-6-18 ALL COMPONENTS ARE GPS'd			CERTIFIED BY <i>Michael P. Lubinsky</i> LIC. NO. 19863    DATE: 6-DEC-2018	
DRAWN BY: JC    CKD BY: PB			STATE PROJ. NO. 2758-74 (T.H. 77) STATE PROJ. NO. 1925-64 (T.H. 77)    SHEET NO. 9 OF 16 SHEETS	