





**LEGEND**

-  LIGHTING UNIT
-  SERVICE CABINET - TYPE L
-  DIRECT BURIED LIGHTING CABLE 4/C 4AWG
-  PERMANENT GROUND ROD (25 OHMS OR LESS)
-  HANDHOLE
-  LIGHTING UNIT IDENTIFIER
-  RIGHT OF WAY
-  3" PVC DIRECTIONAL BORED (UNLESS NOTED OTHERWISE)

200  
SCALE IN FEET

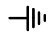

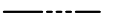
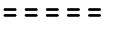
FD. PT. T01P  
SERVICE CABINET - TYPE L1  
240/480V (METERED).  
EQUIPMENT PAD TYPE B REQUIRED.  
2" R.S.C. & 3 - 1/C #2 TO DAKOTA  
ELECTRIC PAD MOUNTED TRANSFORMER.

Abandon cable

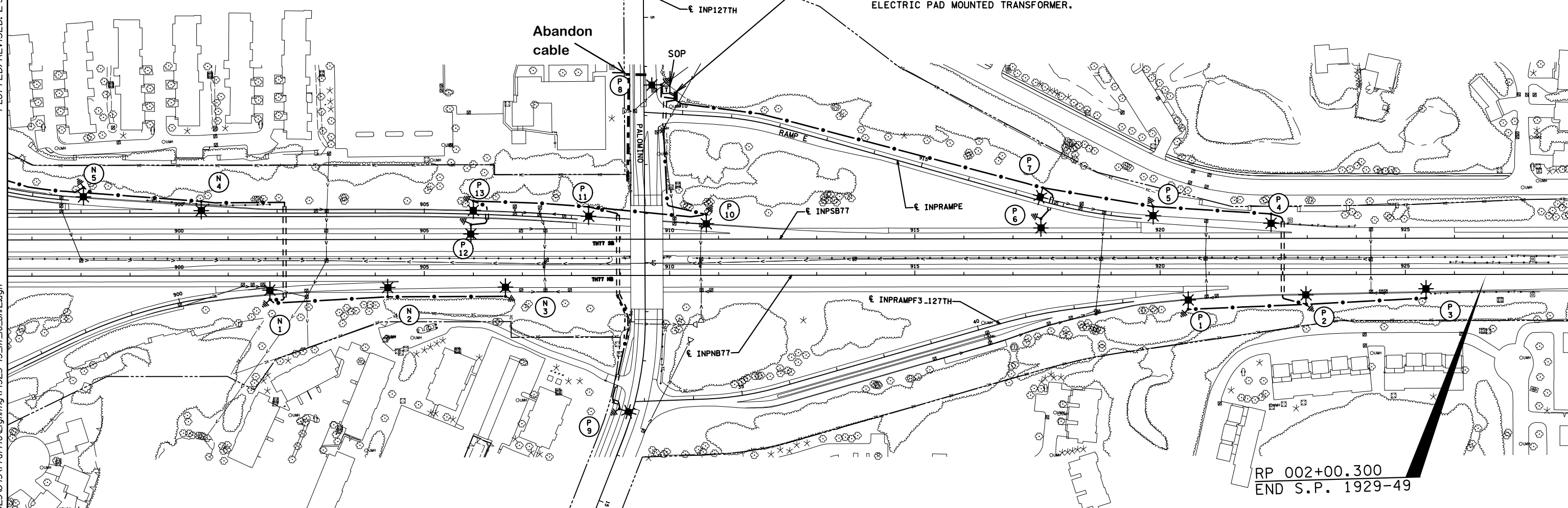

RP 002+00.300  
END S.P. 1929-49

DASHED LINES DENOTE INPLACE ITEMS  
W DENOTES NEUTRAL CONDUCTOR  
B AND R DENOTE CURRENT CARRYING CONDUCTORS  
FD. PT. T01P  
240/480 VOLT

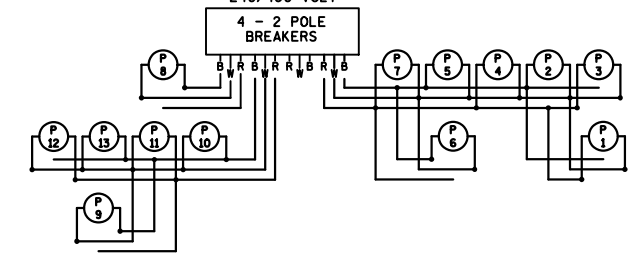

FEEDPOINT T01N						
LIGHTING UNIT LOCATION AND TYPE						
NO.	STATION	LT	RT	LOCATION	TYPE	FOUNDATION
1	901+85		X	INPNB77	9-40	DESIGN E
2	904+25		X	INPNB77	9-40	DESIGN E
3	906+65		X	INPNB77	9-40	DESIGN E
4	900+45	X		INPNB77	9-40	DESIGN E
5	898+05	X		INPSB77	9-40	DESIGN F

FEEDPOINT T01P						
LIGHTING UNIT LOCATION AND TYPE						
NO.	STATION	LT	RT	LOCATION	TYPE	FOUNDATION
1	920+57		X	INPNB77	9-40	DESIGN E
2	922+97		X	INPNB77	9-40	DESIGN E
3	925+37		X	INPNB77	9-40	DESIGN E
4	922+26	X		INPSB77	9-40	DESIGN E
5	919+86	X		INPSB77	9-40	DESIGN E
6	917+57	X		INPSB77	9-40	DESIGN E
7	917+50	X		INPRAMPE	9-40	DESIGN E
8	6+38	X		INP127TH	9-40	DESIGN E
9	13+08		X	INP127TH	9-40	DESIGN E
10	910+75	X		INPSB77	9-40	DESIGN E
11	908+35	X		INPSB77	9-40	DESIGN E
12	905+95	X		INPSB77	9-40	DESIGN E
13	906+00	X		INPPA MCAND	9-40	DESIGN E

**AS-BUILTS**

<b>BY</b>	<b>DATE</b>	<b>REVISIONS</b>	<b>FEEDPOINT: T01P</b>	<b>LOCATION: PALOMINO/127TH ST W</b>	
			<b>METER ADDRESS: 127TH STREET W APPLE VALLEY 55124</b>		
			<b>CERTIFIED BY</b> <i>Gregory Ken</i>	<b>LIC. NO.</b> 26829	<b>DATE:</b> 2-SEP-2021
<b>DRAWN BY: DDD</b>			<b>CKD BY: PB</b>	<b>STATE PROJ.NO. 1929-49 (T.H. 77) SHEET NO. 8 OF 10 SHEETS</b>	

I PLOT NAME: T1929-49\_lit\_lo\_sht2  
 PATH & FILENAME: Projects\DM\_1929\049\TrafficLighting\T1929-49\_lit\_lo\_sht2.dgn  
 PLOTTED/REVISED: 2-SEP-2021