







LEGEND

-  LIGHTING UNIT
-  SERVICE CABINET - TYPE L
-  DIRECT BURIED LIGHTING CABLE 4/C 4AWG
-  PERMANENT GROUND ROD (25 OHMS OR LESS)
-  HANDHOLE
-  LIGHTING UNIT IDENTIFIER
-  RIGHT OF WAY
-  3" PVC DIRECTIONAL BORED (UNLESS NOTED OTHERWISE)

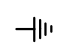
FD. PT. T01N
SERVICE CABINET - TYPE L1
240/480V (METERED).
EQUIPMENT PAD TYPE B REQUIRED.
2" R.S.C. & 3 - 1/C #2 TO DAKOTA
ELECTRIC PAD MOUNTED TRANSFORMER.

200
SCALE IN FEET

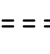

PLOTTED/REVISED: 2-SEP-2021

I/PLOT NAME: T1929-49_lit_lo_sht1
PATH & FILENAME: Projects\DM_R05\077\929\049\TrafficLighting\T1929-49_lit_lo_sht1.dgn

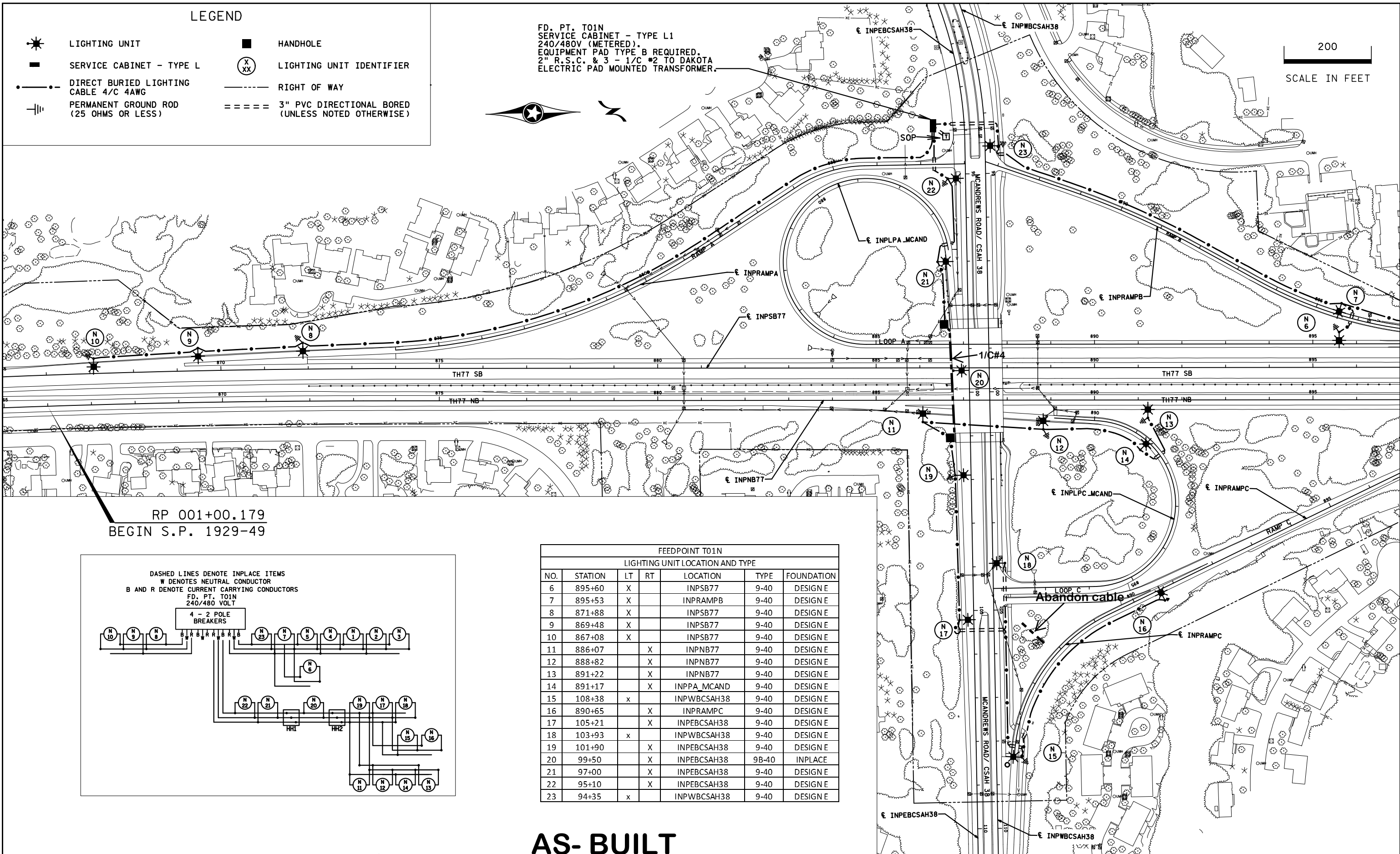

RP 001+00.179
BEGIN S.P. 1929-49

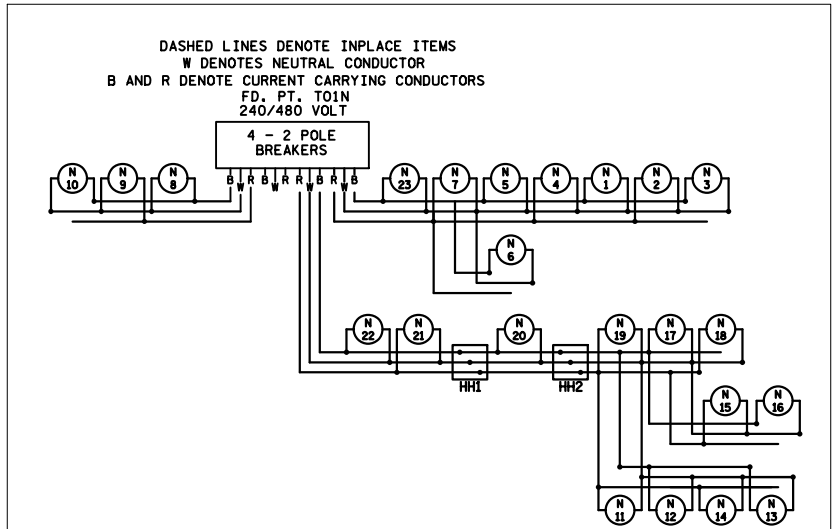

FEEDPOINT T01N						
LIGHTING UNIT LOCATION AND TYPE						
NO.	STATION	LT	RT	LOCATION	TYPE	FOUNDATION
6	895+60	X		INPSB77	9-40	DESIGN E
7	895+53	X		INPRAMPB	9-40	DESIGN E
8	871+88	X		INPSB77	9-40	DESIGN E
9	869+48	X		INPSB77	9-40	DESIGN E
10	867+08	X		INPSB77	9-40	DESIGN E
11	886+07		X	INPNB77	9-40	DESIGN E
12	888+82		X	INPNB77	9-40	DESIGN E
13	891+22		X	INPNB77	9-40	DESIGN E
14	891+17		X	INPPA_MCAND	9-40	DESIGN E
15	108+38	x		INPWBCSAH38	9-40	DESIGN E
16	890+65		X	INPRAMPC	9-40	DESIGN E
17	105+21		X	INPEBCSAH38	9-40	DESIGN E
18	103+93	x		INPWBCSAH38	9-40	DESIGN E
19	101+90		X	INPEBCSAH38	9-40	DESIGN E
20	99+50		X	INPEBCSAH38	9B-40	INPLACE
21	97+00		X	INPEBCSAH38	9-40	DESIGN E
22	95+10		X	INPEBCSAH38	9-40	DESIGN E
23	94+35	x		INPWBCSAH38	9-40	DESIGN E

AS-BUILT

BY	DATE	REVISIONS





FEEDPOINT: T01N LOCATION: MCANDREWS RD
METER ADDRESS: 7500 C.S.A.H.38 APPLE VALLEY 55124

CERTIFIED BY Gregory Kern LIC. NO. 26829 DATE: 2-SEP-2021
LICENSED PROFESSIONAL ENGINEER

LIGHTING PLAN

STATE PROJ. NO. 1929-49 (T.H. 77) SHEET NO. 7 OF 10 SHEETS

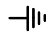
LEGEND

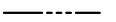
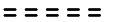
-  LIGHTING UNIT
-  SERVICE CABINET - TYPE L
-  DIRECT BURIED LIGHTING CABLE 4/C 4AWG
-  PERMANENT GROUND ROD (25 OHMS OR LESS)
-  HANDHOLE
-  LIGHTING UNIT IDENTIFIER
-  RIGHT OF WAY
-  3" PVC DIRECTIONAL BORED (UNLESS NOTED OTHERWISE)

200
SCALE IN FEET



FD. PT. T01P
SERVICE CABINET - TYPE L1
240/480V (METERED).
EQUIPMENT PAD TYPE B REQUIRED.
2" R.S.C. & 3 - 1/C #2 TO DAKOTA
ELECTRIC PAD MOUNTED TRANSFORMER.

Abandon cable

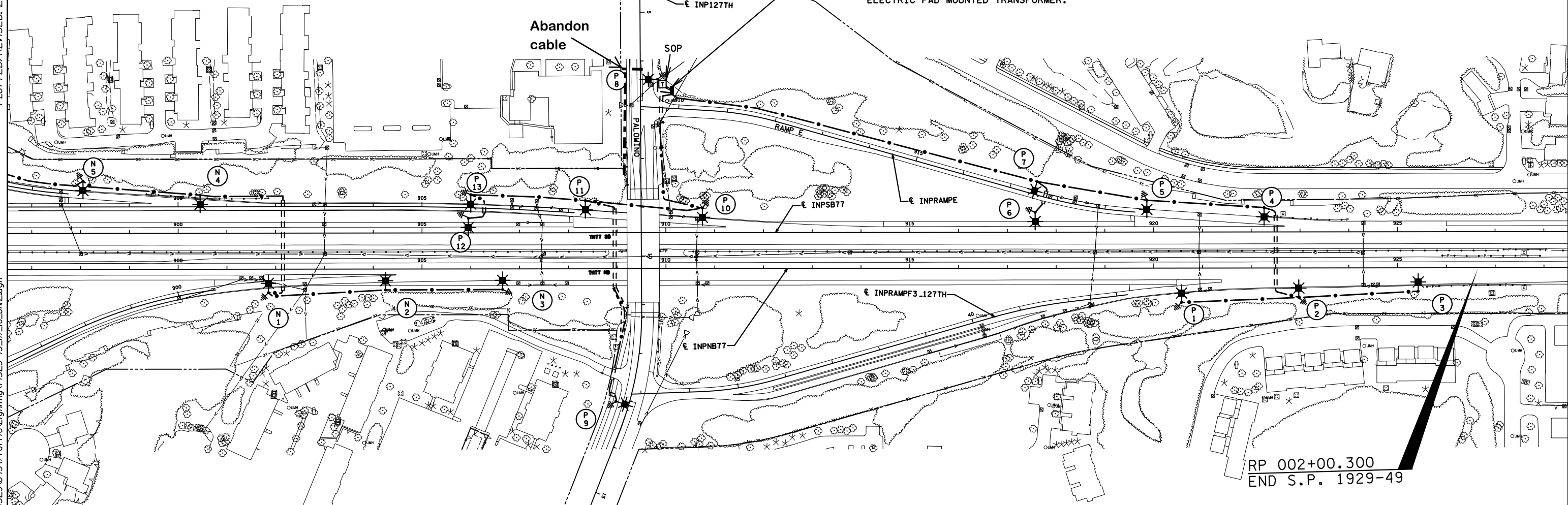

RP 002+00.300
END S.P. 1929-49

DASHED LINES DENOTE INPLACE ITEMS
W DENOTES NEUTRAL CONDUCTOR
B AND R DENOTE CURRENT CARRYING CONDUCTORS
FD. PT. T01P
240/480 VOLT

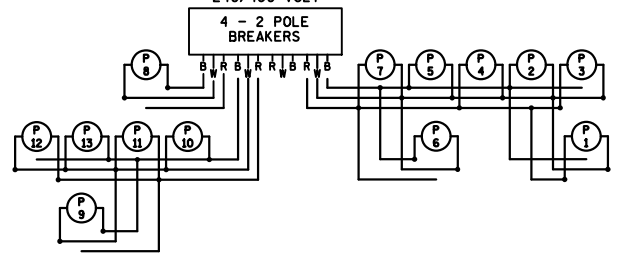

FEEDPOINT T01N						
LIGHTING UNIT LOCATION AND TYPE						
NO.	STATION	LT	RT	LOCATION	TYPE	FOUNDATION
1	901+85		X	INPNB77	9-40	DESIGN E
2	904+25		X	INPNB77	9-40	DESIGN E
3	906+65		X	INPNB77	9-40	DESIGN E
4	900+45	X		INPNB77	9-40	DESIGN E
5	898+05	X		INPSB77	9-40	DESIGN F

FEEDPOINT T01P						
LIGHTING UNIT LOCATION AND TYPE						
NO.	STATION	LT	RT	LOCATION	TYPE	FOUNDATION
1	920+57		X	INPNB77	9-40	DESIGN E
2	922+97		X	INPNB77	9-40	DESIGN E
3	925+37		X	INPNB77	9-40	DESIGN E
4	922+26	X		INPSB77	9-40	DESIGN E
5	919+86	X		INPSB77	9-40	DESIGN E
6	917+57	X		INPSB77	9-40	DESIGN E
7	917+50	X		INPRAMPE	9-40	DESIGN E
8	6+38	X		INP127TH	9-40	DESIGN E
9	13+08		X	INP127TH	9-40	DESIGN E
10	910+75	X		INPSB77	9-40	DESIGN E
11	908+35	X		INPSB77	9-40	DESIGN E
12	905+95	X		INPSB77	9-40	DESIGN E
13	906+00	X		INPPA MCAND	9-40	DESIGN E

AS-BUILTS

BY	DATE	REVISIONS	FEEDPOINT: T01P	LOCATION: PALOMINO/127TH ST W	LIGHTING PLAN
			METER ADDRESS: 127TH STREET W APPLE VALLEY 55124		
DRAWN BY: DDD			CERTIFIED BY: <i>Gregory Ken</i>		STATE PROJ. NO. 1929-49 (T.H. 77) SHEET NO. 8 OF 10 SHEETS
CKD BY: PB			LIC. NO. 26829 DATE: 2-SEP-2021		

PLOT NAME: T1929-49_lit_lo_sht2
PATH & FILENAME: Projects\DM_1929\049\TrafficLighting\T1929-49_lit_lo_sht2.dgn

PLOTTED/REVISED: 2-SEP-2021