

PLOTTED/REVISED: 1/23/2007

DISTRICT #: METRO
 IPLOT NAME: Fdpt_s9s
 PATH & FILENAME: S:\TRAFFIC\LIGHTING\Plans\494\8285\8285-88-11r.dgn

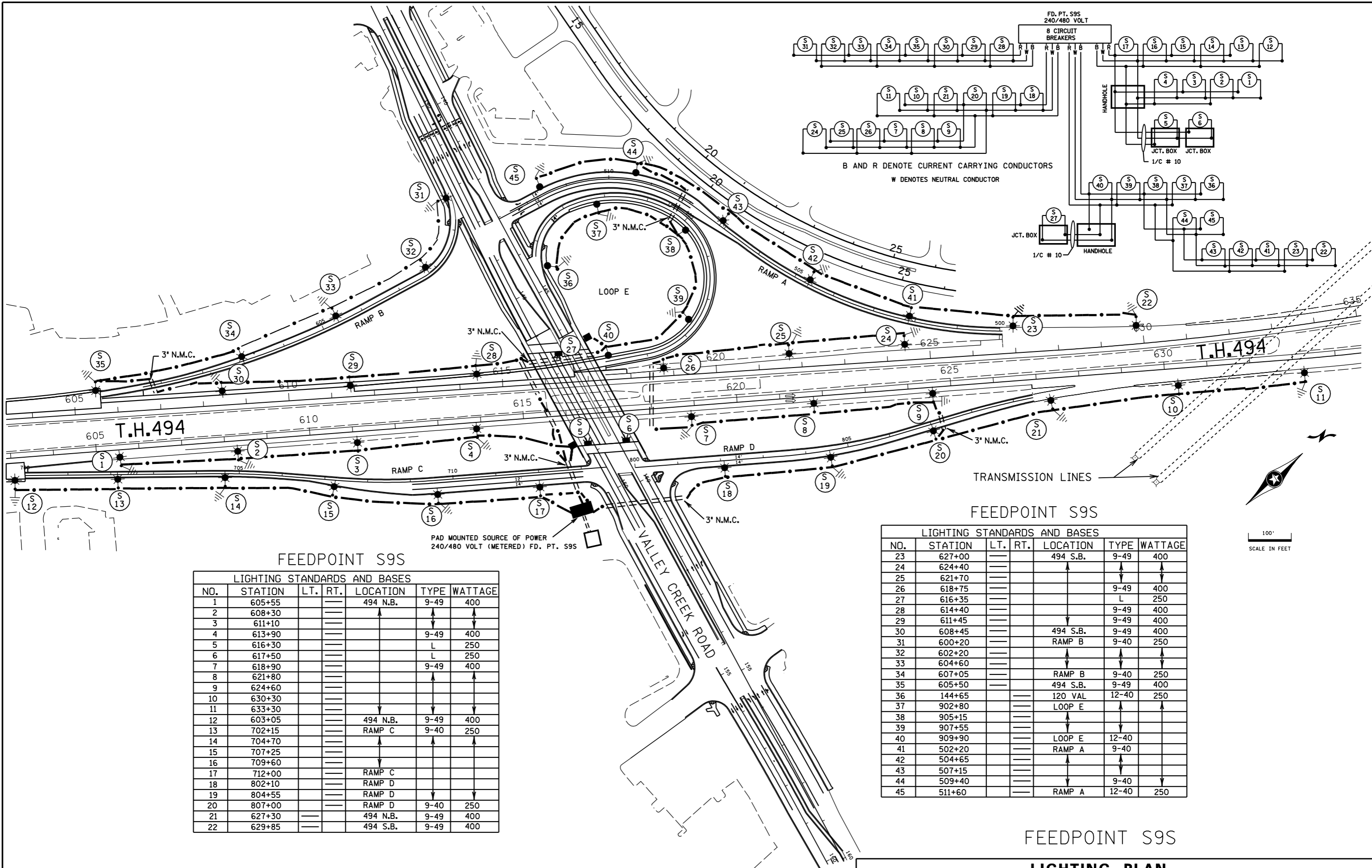

FEEDPOINT S9S

LIGHTING STANDARDS AND BASES						
NO.	STATION	LT.	RT.	LOCATION	TYPE	WATTAGE
1	605+55			494 N.B.	9-49	400
2	608+30					
3	611+10					
4	613+90				9-49	400
5	616+30				L	250
6	617+50				L	250
7	618+90				9-49	400
8	621+80					
9	624+60					
10	630+30					
11	633+30					
12	603+05			494 N.B.	9-49	400
13	702+15			RAMP C	9-40	250
14	704+70					
15	707+25					
16	709+60					
17	712+00			RAMP C		
18	802+10			RAMP D		
19	804+55			RAMP D		
20	807+00			RAMP D	9-40	250
21	627+30			494 N.B.	9-49	400
22	629+85			494 S.B.	9-49	400

FEEDPOINT S9S

LIGHTING STANDARDS AND BASES						
NO.	STATION	LT.	RT.	LOCATION	TYPE	WATTAGE
23	627+00			494 S.B.	9-49	400
24	624+40					
25	621+70					
26	618+75				9-49	400
27	616+35				L	250
28	614+40				9-49	400
29	611+45				9-49	400
30	608+45			494 S.B.	9-49	400
31	600+20			RAMP B	9-40	250
32	602+20					
33	604+60					
34	607+05			RAMP B	9-40	250
35	605+50			494 S.B.	9-49	400
36	144+65			120 VAL	12-40	250
37	902+80			LOOP E		
38	905+15					
39	907+55					
40	909+90			LOOP E	12-40	
41	502+20			RAMP A	9-40	
42	504+65					
43	507+15					
44	509+40				9-40	
45	511+60			RAMP A	12-40	250

FEEDPOINT S9S

LIGHTING PLAN