

SHEET TOTAL
14 - 250 WATT HIGH PRESSURE SODIUM LIGHTING UNITS

FD PT. S6F				
LIGHTING STANDARDS AND BASES				
NO.	STATION	LT.	RT.	LOCATION
1	848+15	-	-	494 EB
2	846+15	-	-	494 EB
3	844+15	-	-	494 EB
4	842+15	-	-	494 EB
5	840+15	-	-	494 EB
6	40+15	-	-	RAMP 2F
7	838+15	-	-	494 EB
8	38+15	-	-	RAMP 2F
9	836+15	-	-	494 EB
10	36+15	-	-	RAMP 2F
11	834+80	-	-	494 EB
12	832+80	-	-	494 EB
13	830+80	-	-	494 EB
14	828+80	-	-	494 EB
15	826+80	-	-	494 EB
16	824+80	-	-	494 EB
17	822+80	-	-	494 EB

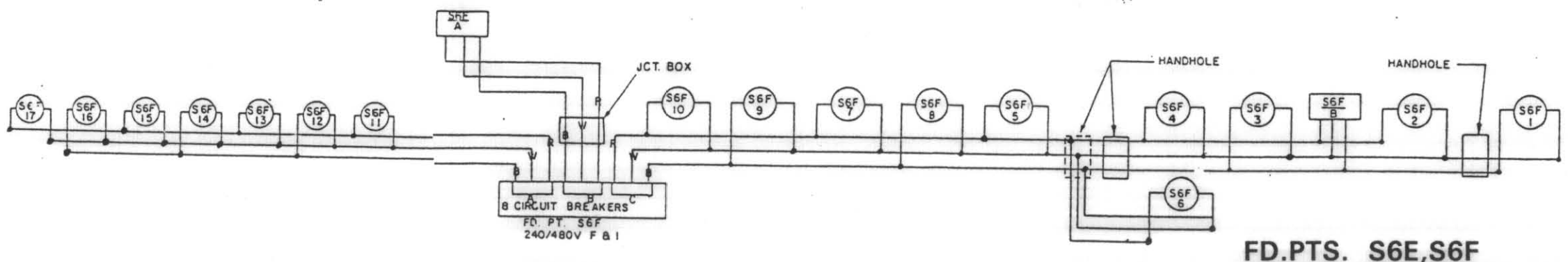
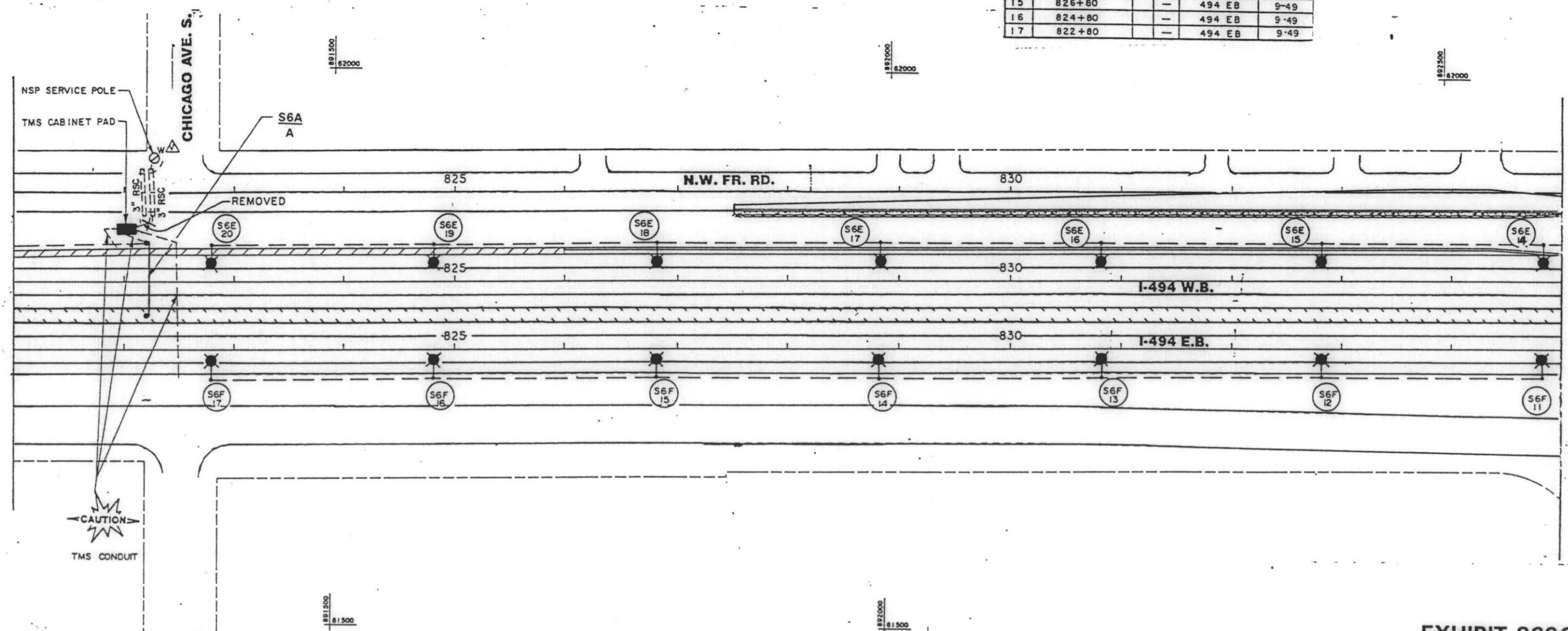
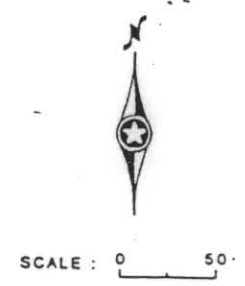

FD.PTS. S6E,S6F

EXHIBIT 269C
T.H. 494 @ CHICAGO AVE. S.
IN RICHFIELD
N.S.P.



SCALE: 50'

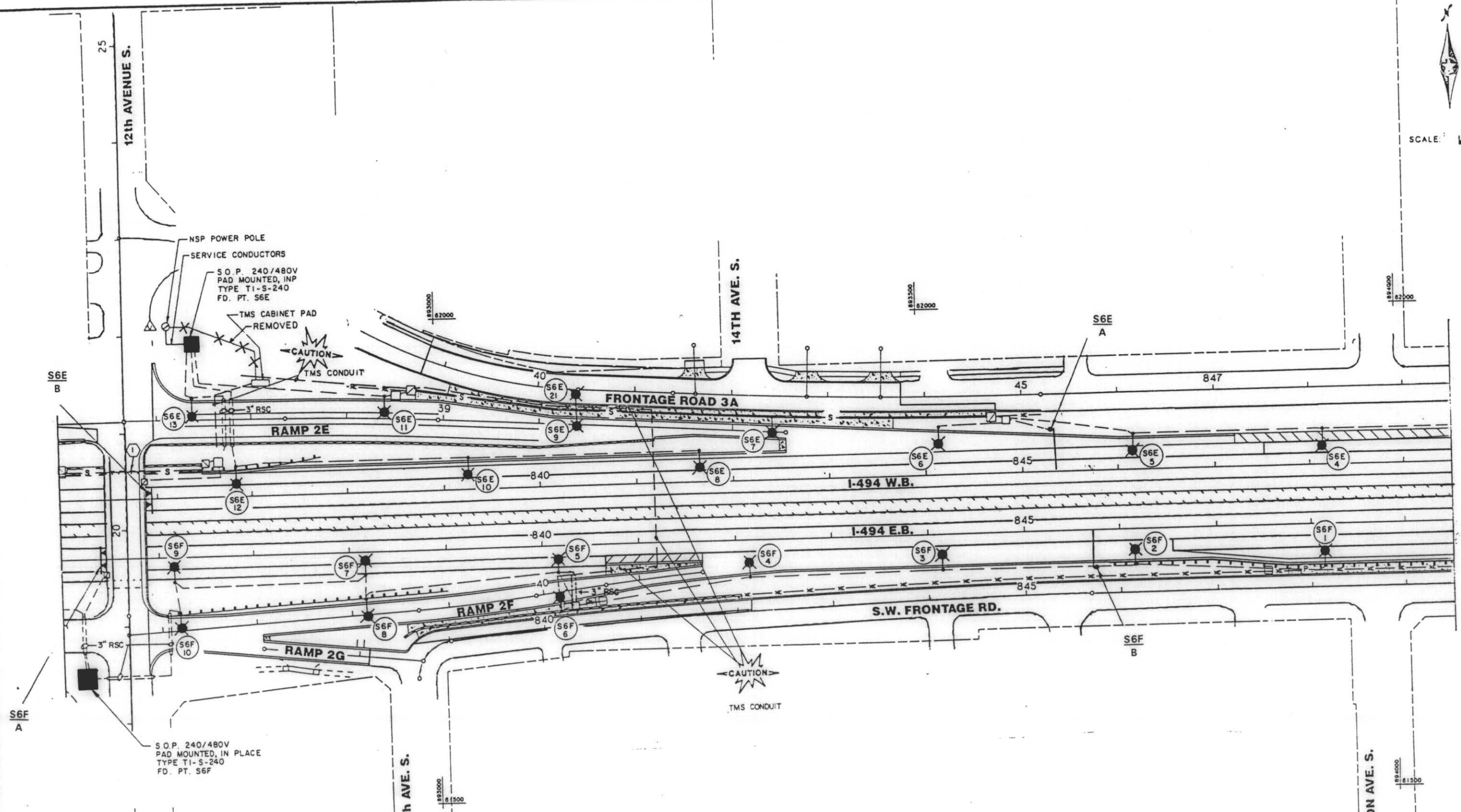

SHEET TOTAL
21 - 250 WATT HIGH PRESSURE SODIUM LIGHTING UNITS

EXHIBIT 269C
T.H. 494 & 12TH AVE. S.
IN RICHFIELD
N.S.P.

FD.PTS. S6E,S6F