

NOTES:
 1. ALL CONDUIT FOR LIGHTING SYSTEM SHALL BE 3" NMC
 (UNLESS OTHERWISE NOTED).

LEGEND

- SINGLE LIGHT UNIT - IN PLACE OR FUTURE (BY OTHERS)
- SINGLE LIGHT UNIT - F & I
- ⊕ HIGH MAST LIGHTING
- - - CONDUIT - IN PLACE OR FUTURE (BY OTHERS)
- === CONDUIT - F & I
- HANDHOLE - IN PLACE OR FUTURE (BY OTHERS)
- HANDHOLE - F & I
- · - DIRECT BURIED POWER CABLE 4 CONDUCTOR NO 4AWG ARMORED CABLE SPEC NO. 3811
- PAD MOUNTED SERVICE CABINET AND SOURCE OF POWER

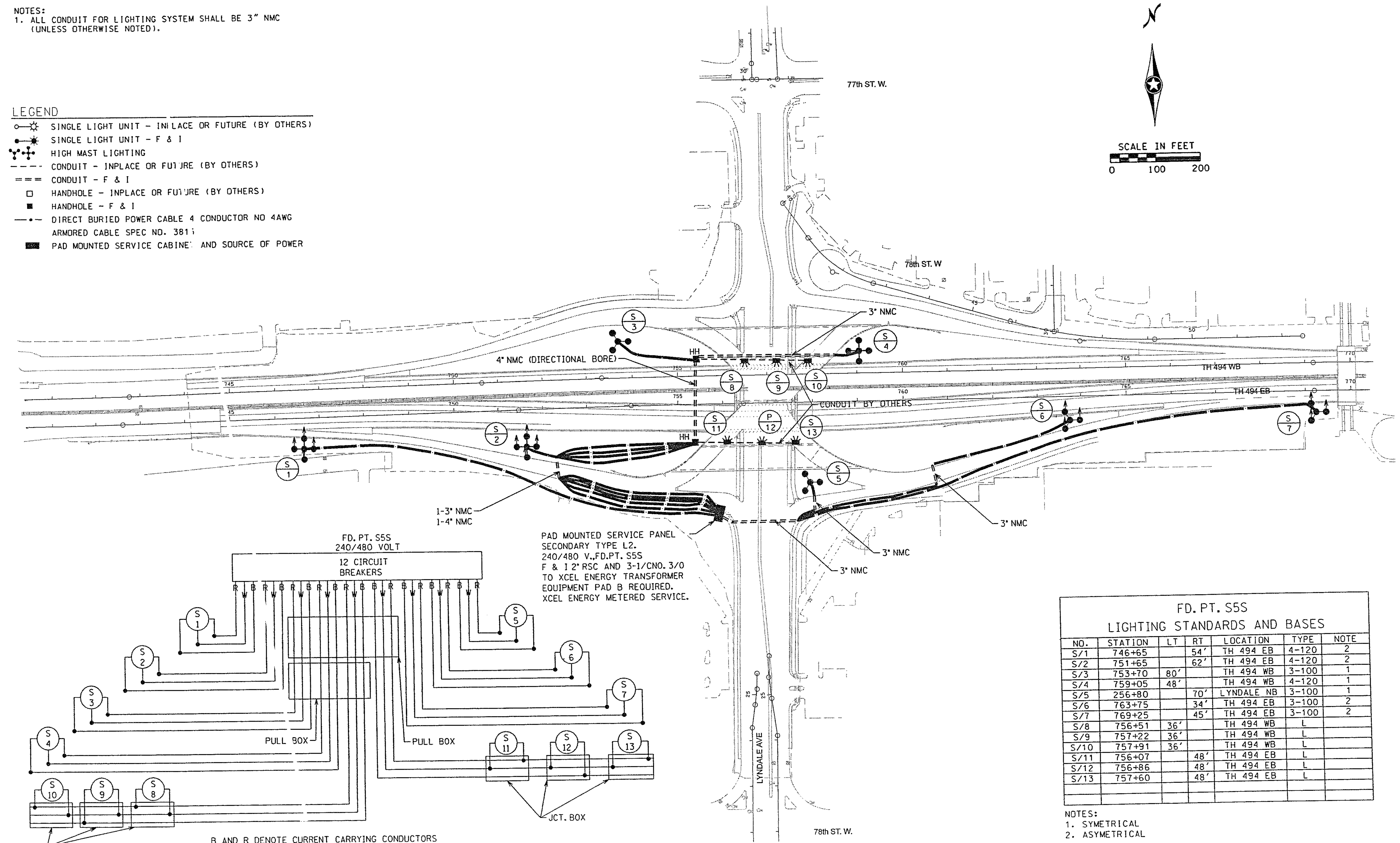

FD. PT. S5S
 240/480 VOLT
 12 CIRCUIT
 BREAKERS

PAD MOUNTED SERVICE PANEL
 SECONDARY TYPE L2.
 240/480 V., FD. PT. S5S
 F & 1 2" RSC AND 3-1/CNO. 3/0
 TO XCEL ENERGY TRANSFORMER
 EQUIPMENT PAD B REQUIRED.
 XCEL ENERGY METERED SERVICE.

FD. PT. S5S LIGHTING STANDARDS AND BASES						
NO.	STATION	LT	RT	LOCATION	TYPE	NOTE
S/1	746+65		54'	TH 494 EB	4-120	2
S/2	751+65		62'	TH 494 EB	4-120	2
S/3	753+70	80'		TH 494 WB	3-100	1
S/4	759+05	48'		TH 494 WB	4-120	1
S/5	256+80		70'	LYNDALE NB	3-100	1
S/6	763+75		34'	TH 494 EB	3-100	2
S/7	769+25		45'	TH 494 EB	3-100	2
S/8	756+51	36'		TH 494 WB	L	
S/9	757+22	36'		TH 494 WB	L	
S/10	757+91	36'		TH 494 WB	L	
S/11	756+07		48'	TH 494 EB	L	
S/12	756+86		48'	TH 494 EB	L	
S/13	757+60		48'	TH 494 EB	L	

NOTES:
 1. SYMMETRICAL
 2. ASYMMETRICAL

B AND R DENOTE CURRENT CARRYING CONDUCTORS
 W DENOTES NEUTRAL CONDUCTOR

DATE: 8/13, 9:21:53 AM
 PATH & FILENAME: k:\01532-14\Cad\Plan\CD27853-42_112.dgn

NO	DATE	BY	CHK	REVISIONS

Drawn By:
M SCHWARTZ
 Designed By:
M SCHWARTZ
 Checked By:
T WINECKI
 Approved By:
T WINECKI

I HEREBY CERTIFY THAT THIS PLAN WAS PREPARED BY ME OR UNDER MY DIRECT SUPERVISION AND THAT I AM A DULY LICENSED PROFESSIONAL ENGINEER UNDER THE LAWS OF THE STATE OF MINNESOTA.

Anthony J. Winecki
 LICENSED PROFESSIONAL ENGINEER - ANTHONY J. WINECKI, P.E.
 DATE: 12 JUNE 2008 REG NO: 23128

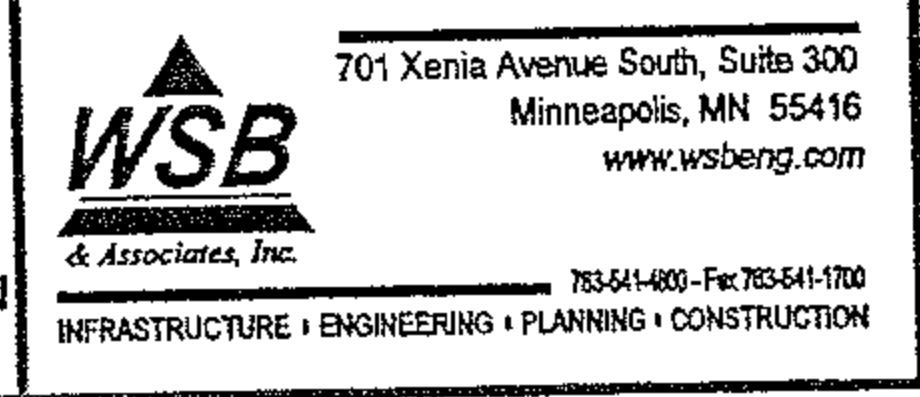

PERMANENT LIGHTING PLAN
 MAIN LINE-TH 494 & RAMPS
 SHEET 10 OF 17 SHEETS

STATE PROJ NO SP 2785-342 (TH 494) SP 157-363-19 SP 107-415-19
 CITY OF RICHFIELD PROJ NO 42000

SHEET
 420
 OF
 526
 SHEETS