

B AND R DENOTE CURRENT CARRYING CONDUCTORS
W DENOTES NEUTRAL CONDUCTOR

PAD MOUNTED SERVICE CABINET
SECONDARY TYPE L2, 240/480 V.
FD. PT. S4T (METERED), F. & I. 2'
R.S.C. AND 3-1/2" NO. 3/0 TO
XCEL ENERGY TRANSFORMER.
EQUIPMENT PAD B REQUIRED.

XCEL ENERGY PAD
MOUNTED TRANSFORMER

NORTHWEST
ATHLETIC
CLUB

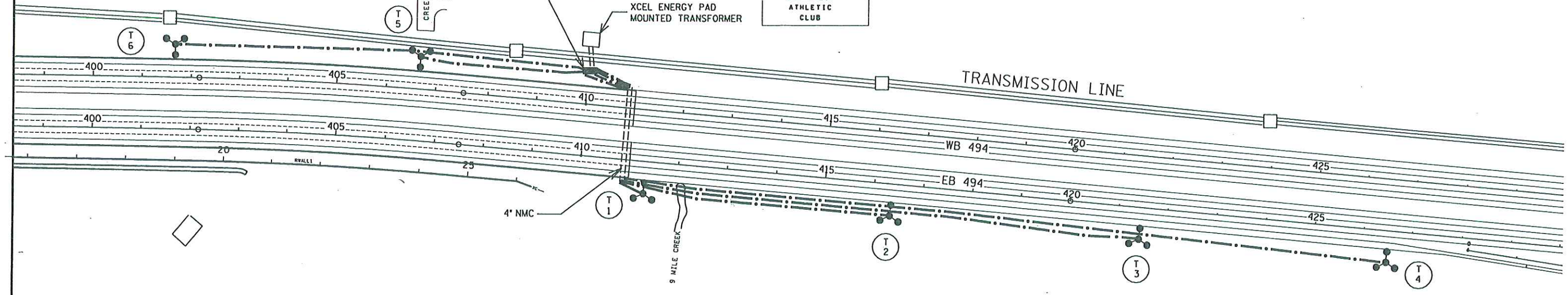

FD. PT. S4T

LIGHTING STANDARDS AND BASES					
NO.	STATION	LT.	RT.	LOCATION	TYPE
1	411+30		65'	T.H. 494 EBL	3-100
2	416+30		65'	T.H. 494 EBL	3-100
3	421+30		65'	T.H. 494 EBL	3-100
4	426+30		65'	T.H. 494 EBL	3-100
5	406+65	65'		T.H. 494 WBL	3-100
6	401+65	65'		T.H. 494 WBL	3-100

CERTIFIED BY

Sean Dehner
LICENSED PROFESSIONAL ENGINEER

LIC. NO. 40945

State Proj. No. 2785-327 (T.H. 494) Sheet No. 577 of 1080 Sheets