

\\mspdoc01\proj\as-built\design\plan_package\sheet\30_Lighting_Plan\CD277603_T24_LL07.dgn 10:22:52 AM 2/7/2013

HIGH MAST LIGHT BASE ELEVATIONS

HIGH MAST LIGHT	ROADWAY	STATION	OFFSET	TOP OF PEDESTAL ELEVATION
L2	I-494 EB	320+87	84	869.6
L3	I-494 EB	330+39	58	862.2
P3	I-494 WB	335+00	49	855.2
P4	I-494 EB	339+36	45	850.6
P1	SB TH 169	489+61	97	841.0
N1	NB TH 169	485+15	101	841.0
N6	I-494 WB	357+91	173	834.0
N2	I-494 EB	359+51	68	846.6
N5	I-494 WB	362+79	109	842.0 (1)
N3	I-494 EB	365+31	79	855.1
N4	I-494 WB	368+50	78	852.3
R1	I-494 EB	371+19	50	854.9
R9	I-494 WB	374+15	63	854.8
R2	I-494 EB	377+09	41	848.2

(1) PLACE 2" FOAM INSULATION OVER FOOTING WHEREVER THERE IS LESS THAN 5" COVER - FROM BOTTOM OF FOOTING TO TOP OF FINISHED GRADE

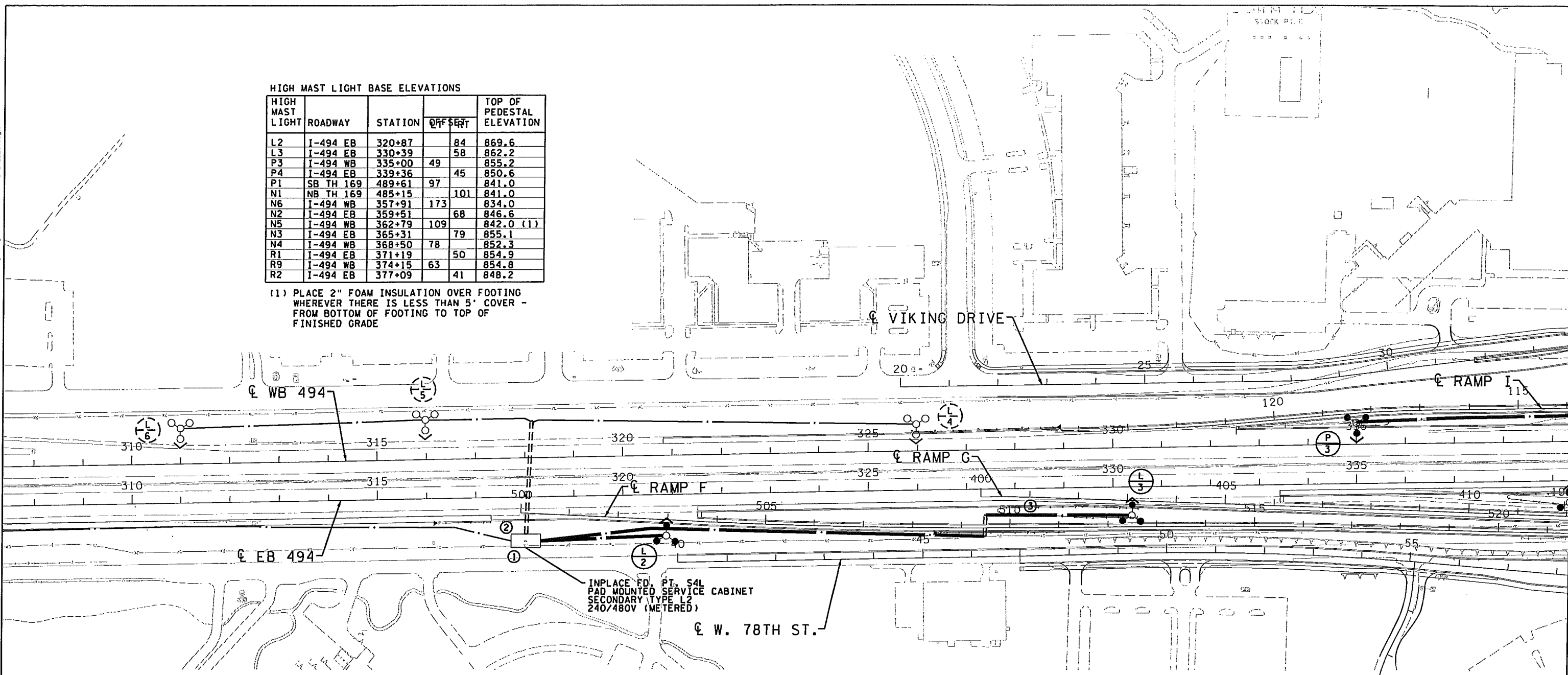

INPLACE FD. PT. S4L PAD MOUNTED SERVICE CABINET SECONDARY TYPE L2 240/480V (METERED)

W. 78TH ST.

FD. PT. S4L 240/480 VOLT

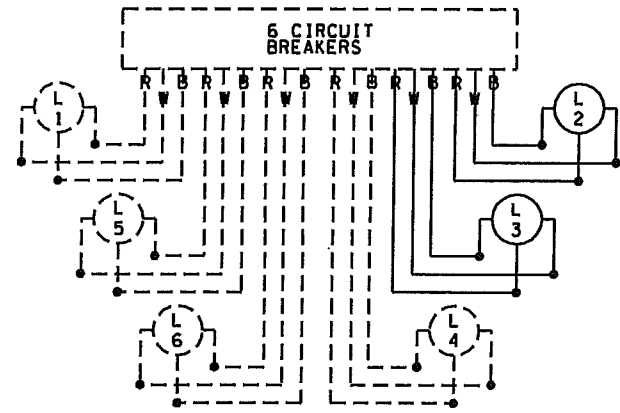

B AND R DENOTE CURRENT CARRYING CONDUCTORS W DENOTES NEUTRAL CONDUCTOR

GENERAL NOTES

REUSE EXISTING SHIELDS ON NEW LUMINAIRES OF RELOCATED HIGH MAST POLES.

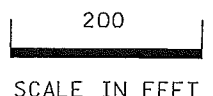

FD. PT. S4P

LIGHTING STANDARDS AND BASES				
NO.	STATION	LT.	RT.	LOCATION TYPE
3	335+00	49		I-494 WB 3-100

* RELOCATED

FD. PT. S4L

LIGHTING STANDARDS AND BASES				
NO.	STATION	LT.	RT.	LOCATION TYPE
2	320+87		84	I-494 EB 3-100
3	330.39		58	I-494 EB 3-100
4	INPLACE			I-494 WB 3-100
5	INPLACE			I-494 WB 3-100
6	INPLACE			I-494 WB 3-100

* RELOCATED

SPECIFIC NOTES

- ① REPLACE INPLACE SINGLE POLE BREAKERS WITH NEW TWO POLE BREAKERS.
- ② PROVIDE 2" NMC IN SIGN FOUNDATION AT I-494 EB STA. 317+60, 55.5RT. STUB 12" BEYOND FOUNDATION AND CAP 24" BELOW GRADE.
- ③ PROVIDE 2" NMC IN SIGN FOUNDATION AT I-494 EB STA. 328+35, 45.5RT. STUB 12" BEYOND FOUNDATION AND CAP 24" BELOW GRADE.

SHEET 7 OF 14

SIGNATURE		DATE	DESCRIPTION OF REVISION
REV	DATE	BY	AS-BUILT
	01-14-13		

MNDOT

DRAWN: TKF
CHECKED: MAH
DESIGNED: MAH
CHECKED: BML

JACOBS *MP Consultants*

C.S. McCrossan

KRAEMER

I HEREBY CERTIFY THAT THIS PLAN WAS PREPARED BY ME OR UNDER MY DIRECT SUPERVISION AND THAT I AM A DULY LICENSED PROFESSIONAL ENGINEER UNDER THE LAWS OF THE STATE OF MINNESOTA.

NAME: BEATRIZ A. MENDEZ-LORA LICENSE: 25230 DATE: 2/23/13

LIGHTING SHEET
I-494 STA. 307-339

S.P. NO. 2776-03 (T.H. 169)

SHEET NO. 1299 OF 2032 SHEETS

DESIGN PACKAGE T24

SHEET LOCATION SL_G

DRAWING NAME CD277603_T24_LL07

\\mspdac01\proj\as-built\design\plan_package\sheet\30 Lighting Plans\CD277603_T24.LL06.dgn

10/22/2013 10:22:50 AM

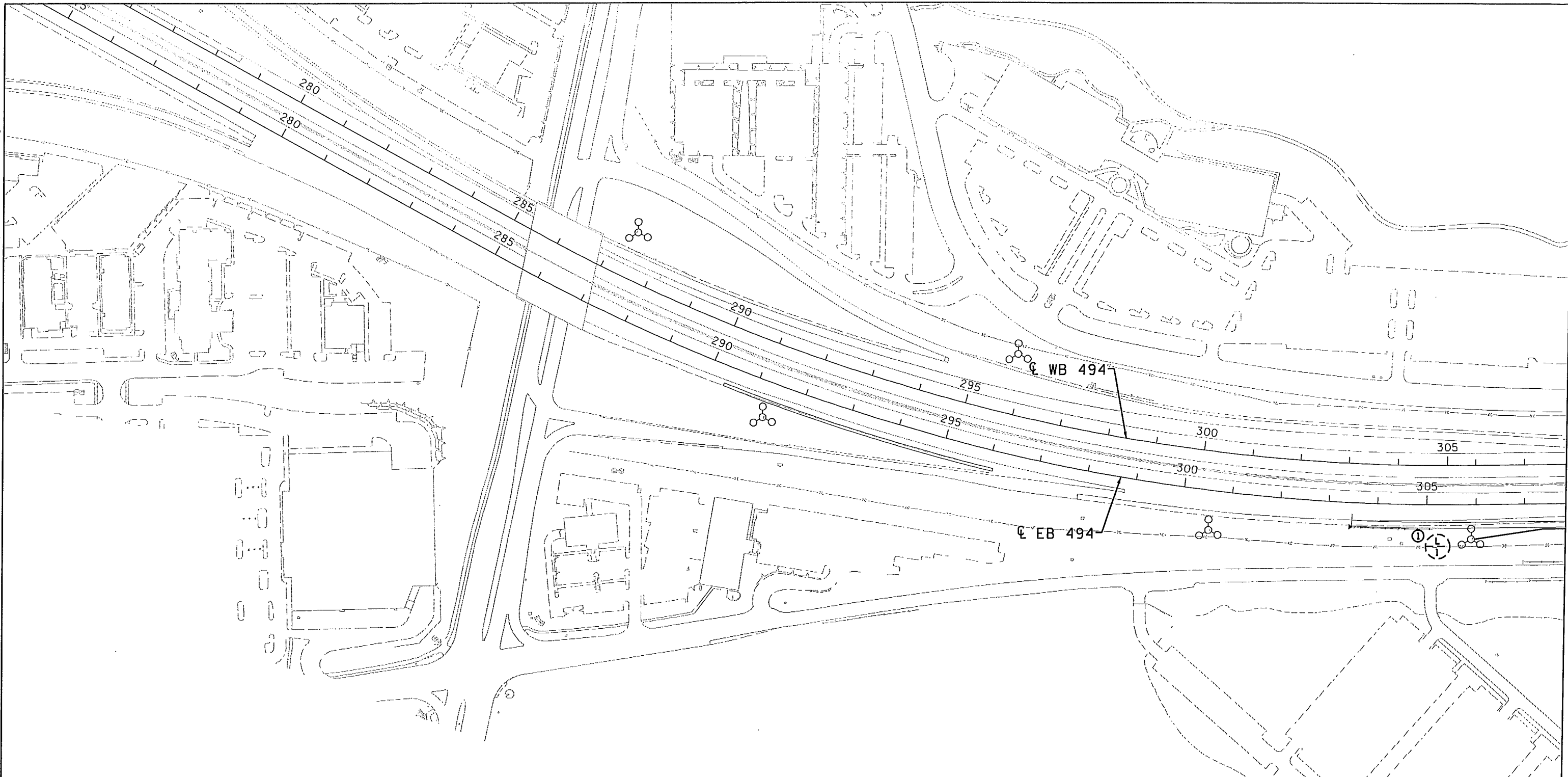

FD. PT. S4L

LIGHTING STANDARDS AND BASES				
NO.	STATION	LT.	RT.	LOCATION TYPE
1	INPLACE	-	-	I 494 EB 3-100

SPECIFIC NOTES

- ① PROVIDE 2" NMC IN SIGN FOUNDATION AT I-494 EB STA. 305+00, 55.5RT. STUB 12" BEYOND FOUNDATION AND CAP 24" BELOW GRADE.

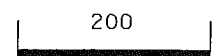

SCALE IN FEET



SHEET 6 OF 14

MNDOT			
SIGNATURE _____		DATE _____	
REV	DATE	BY	DESCRIPTION OF REVISION
	01-14-13		AS-BUILT

DRAWN: TKF
 CHECKED: MAH
 DESIGNED: MAH
 CHECKED: BML

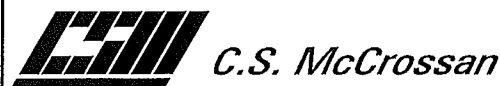

I HEREBY CERTIFY THAT THIS PLAN WAS PREPARED BY ME OR UNDER MY DIRECT SUPERVISION AND THAT I AM A DULY LICENSED PROFESSIONAL ENGINEER UNDER THE LAWS OF THE STATE OF MINNESOTA.

NAME: BEATRIZ A MENDEZ-LORA LICENSE: 25230 DATE: _____

LIGHTING SHEET
 I-494 STA. 275-307
 S.P. NO. 2776-03 (T.H. 169)
 SHEET NO. 1298 OF 2032 SHEETS

DESIGN PACKAGE T24
 SHEET LOCATION SL_F
 DRAWING NAME CD277603_T24.LL06