

- PAD MOUNTED SERVICE CABINET (TYPE L1 - SEE SHEET T7LD09)
- 3" NON-METALLIC CONDUIT
- DIRECT BURIED POWER CABLE-4 CONDUCTOR NO. 4 A.W.G. ARMORED CABLE (SPEC. NO. 3815)
- PERMANENT GROUND ROD (25 OHMS OR LESS)
- 250 WATT HPS VERTICAL MOUNT LIGHTING UNIT
- 250 WATT HPS TWIN VERTICAL MOUNT LIGHTING UNIT
- PULL BOX
- 250 W HPS UNDERPASS LIGHTING UNIT

LIGHTING STANDARDS AND BASES					
NO.	STATION	LT.	RT.	LOCATION	TYPE
1	1104+39		XX	T.H. 212 E.B.	VM-45
2	1105+90		XX	T.H. 212 E.B.	L
3	1108+42		XX	T.H. 212 E.B.	VM-45
4					
5	1110+93		XX	T.H. 212 E.B.	VMD-45
6	1123+55		XX	T.H. 212 E.B.	VM-45
7	1126+01		XX	T.H. 212 E.B.	VM-45
8	1128+51		XX	T.H. 212 E.B.	VM-45
9	1128+79	XX		T.H. 212 W.B.	VM-45
10	1126+30	XX		T.H. 212 W.B.	VM-45
11					
12	1123+70	XX		T.H. 212 W.B.	VMD-45
13	1111+49	XX		T.H. 212 W.B.	VM-45
14	1109+01	XX		T.H. 212 W.B.	VM-45
15	1107+59	XX		T.H. 212 W.B.	L
16	1105+61	XX		T.H. 212 W.B.	VM-45

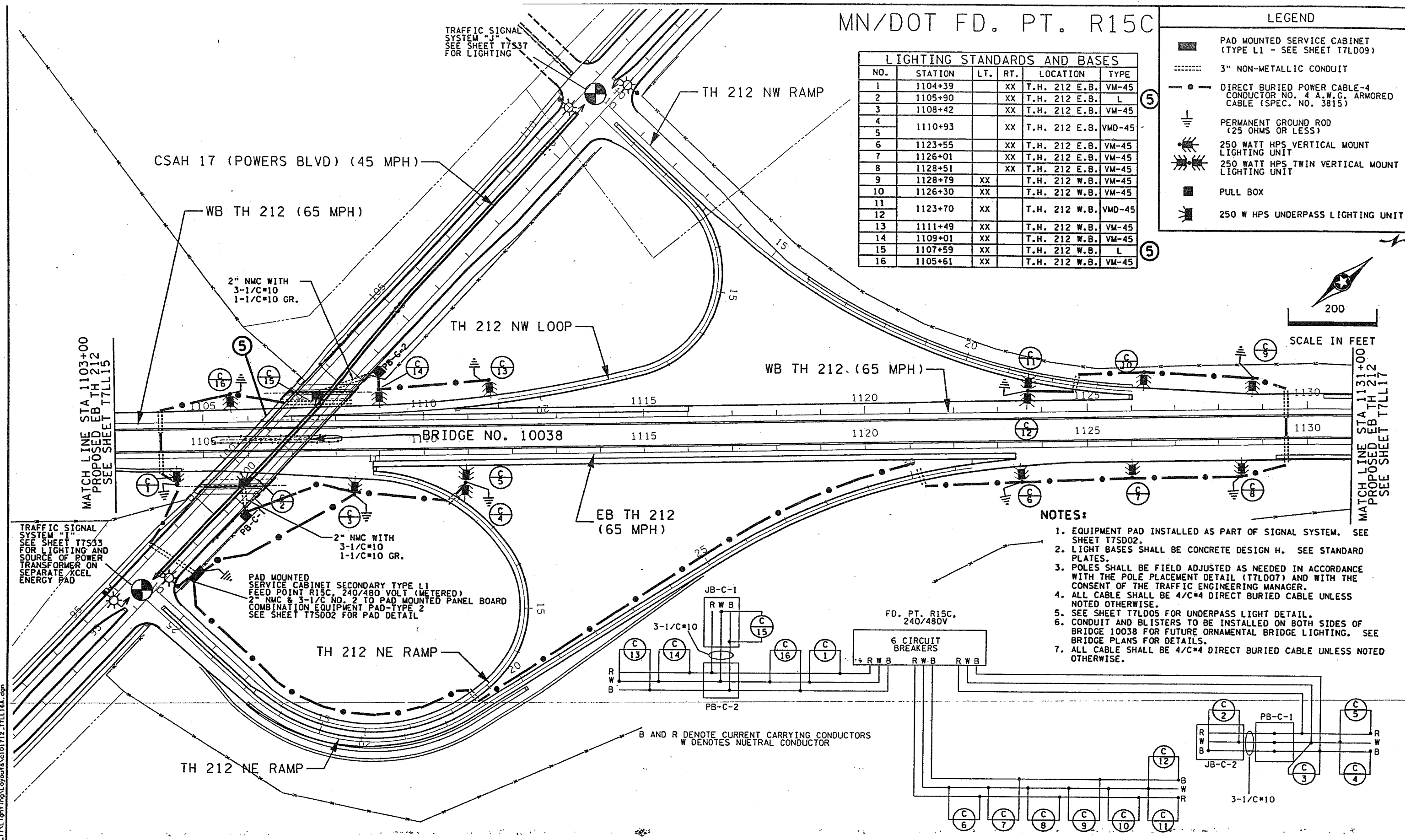

NOTES:

1. EQUIPMENT PAD INSTALLED AS PART OF SIGNAL SYSTEM. SEE SHEET T7SD02.
2. LIGHT BASES SHALL BE CONCRETE DESIGN H. SEE STANDARD PLATES.
3. POLES SHALL BE FIELD ADJUSTED AS NEEDED IN ACCORDANCE WITH THE POLE PLACEMENT DETAIL (T7LD07) AND WITH THE CONSENT OF THE TRAFFIC ENGINEERING MANAGER.
4. ALL CABLE SHALL BE 4/C=4 DIRECT BURIED CABLE UNLESS NOTED OTHERWISE.
5. SEE SHEET T7LD05 FOR UNDERPASS LIGHT DETAIL.
6. CONDUIT AND BLISTERS TO BE INSTALLED ON BOTH SIDES OF BRIDGE 10038 FOR FUTURE ORNAMENTAL BRIDGE LIGHTING. SEE BRIDGE PLANS FOR DETAILS.
7. ALL CABLE SHALL BE 4/C=4 DIRECT BURIED CABLE UNLESS NOTED OTHERWISE.

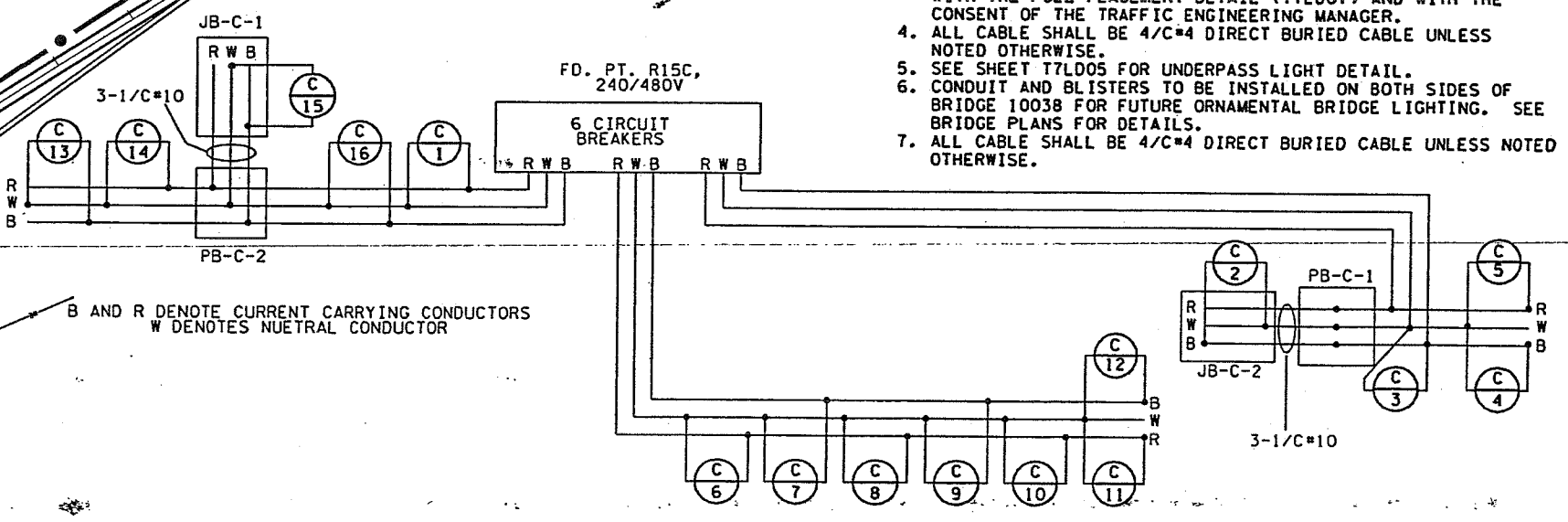

0	3/13/06	KEL	RJG	PJZ	INITIAL RELEASE FOR CONSTRUCTION
---	---------	-----	-----	-----	----------------------------------

I hereby certify that this plan, specification, or report was prepared by me or under my direct supervision and that I am a duly Licensed Professional Engineer under the laws of the State of Minnesota.
 Print Name: BAUL J. ZAGER
Baul J. Zager
 Date: 3-13-06 License # 41642

MN/DOT RELEASED FOR CONSTRUCTION
 Date: _____ MnDOT



TH 212 DESIGN BUILD (SP 1017-12)
 LIGHTING LAYOUT
 TH 212/CSAH 17 (POWERS BLVD)
 INTERCHANGE
 STA 1103+00 TO STA 1131+00

SHEET
 T7LL16
 OF
 T7LL26

10:49:26 AM
 3/13/06
 Z:\1131_00_CADD\SHEETS\DP_T7LL16.dgn