

LIGHTING STANDARDS AND BASES					
NO.	STATION	LT.	RT.	LOCATION	TYPE
1	1154+62		XX	T.H. 212 E.B.	VM-45
2	1156+71		XX	T.H. 212 E.B.	L
3	1158+83		XX	T.H. 212 E.B.	VM-45
4					
5	1161+52		XX	T.H. 212 E.B.	VMD-45
6	1177+65		XX	T.H. 212 E.B.	VM-45
7	1180+14		XX	T.H. 212 E.B.	VM-45
8	1182+65		XX	T.H. 212 E.B.	VM-45
9	1176+85	XX		T.H. 212 W.B.	VM-45
10	1174+38	XX		T.H. 212 W.B.	VM-45
11					
12	1171+78	XX		T.H. 212 W.B.	VMD-45
13	1161+59	XX		T.H. 212 W.B.	VM-45
14	1159+19	XX		T.H. 212 W.B.	VM-45
15	1158+02	XX		T.H. 212 W.B.	L
16	1156+85	XX		T.H. 212 W.B.	VM-45

- PAD MOUNTED SERVICE CABINET (TYPE L1 - SEE SHEET T7L009)
- 3" NON-METALLIC CONDUIT
- DIRECT BURIED POWER CABLE-4 CONDUCTOR NO. 4 A.W.G. ARMORED CABLE (SPEC. NO. 3815)
- PERMANENT GROUND ROD (25 OHMS OR LESS)
- 250 WATT HPS VERTICAL MOUNT LIGHTING UNIT
- 250 WATT HPS TWIN VERTICAL MOUNT LIGHTING UNIT
- PULL BOX
- 250 W HPS UNDERPASS LIGHTING UNIT

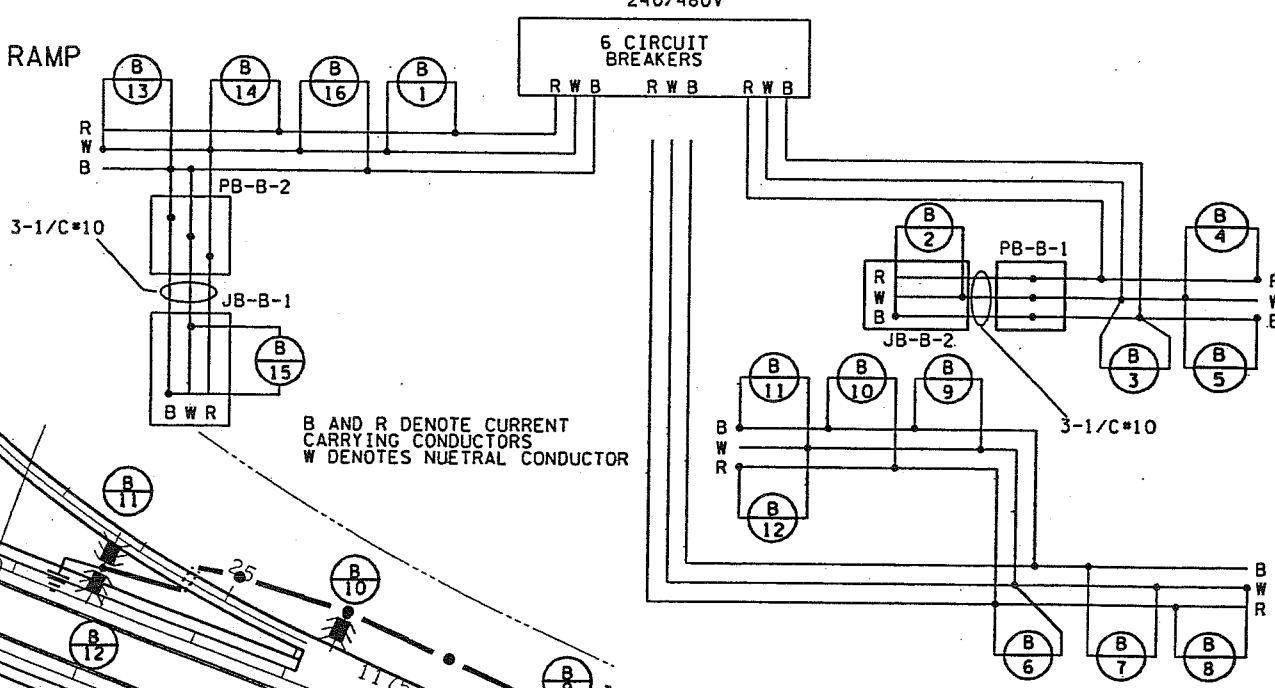
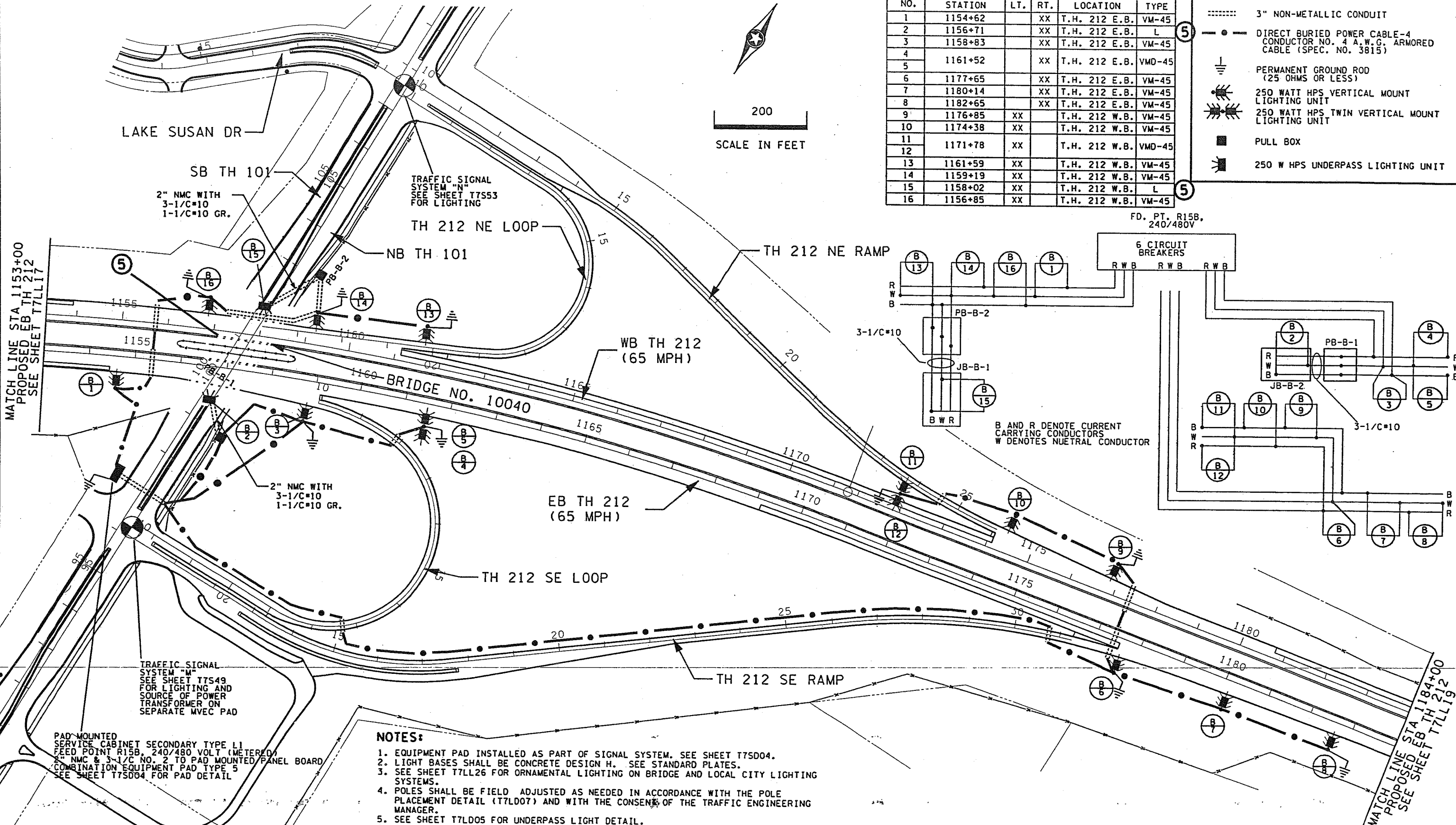
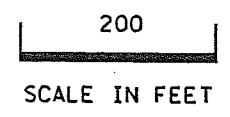

- NOTES:**
- EQUIPMENT PAD INSTALLED AS PART OF SIGNAL SYSTEM. SEE SHEET T7S004.
 - LIGHT BASES SHALL BE CONCRETE DESIGN H. SEE STANDARD PLATES.
 - SEE SHEET T7LL26 FOR ORNAMENTAL LIGHTING ON BRIDGE AND LOCAL CITY LIGHTING SYSTEMS.
 - POLES SHALL BE FIELD ADJUSTED AS NEEDED IN ACCORDANCE WITH THE POLE PLACEMENT DETAIL (T7L007) AND WITH THE CONSENT OF THE TRAFFIC ENGINEERING MANAGER.
 - SEE SHEET T7L005 FOR UNDERPASS LIGHT DETAIL.
 - ALL CABLE SHALL BE 4/C*4 DIRECT BURIED CABLE UNLESS NOTED OTHERWISE.

0	3/13/06	KEL	RJG	PJZ	INITIAL RELEASE FOR CONSTRUCTION
NO	DATE	BY	CKD	APPR	REVISION

I hereby certify that this plan, specification, or report was prepared by me or under my direct supervision and that I am a duly Licensed Professional Engineer under the laws of the State of Minnesota.

Print Name: PAUL J. ZAGER
Paul J. Zager
 Date: 3-17-06 License # 41642



10:58:38 AM 3/13/2006 Z:\13.0 CAD\SHETS\DP_T7L18.dwg T7L18.dwg T7L18.dwg