

SEE LEGEND SHEET 45

FEEDPOINT R8P

LIGHTING STANDARDS AND BASES					
NO.	STA.	LT.	RT.	LOCATION	WATTAGE
1	536+35			169NB	400
2	539+95				
3	543+05				
4	546+75				
5	550+50				
6	554+25				
7	557+95				
8	561+70			169NB	400
9	58+95			W. FR. RD.	250
10	61+20			W. FR. RD.	
11	1+70			RAMP C	
12	63+85			W. FR. RD.	250
13	534+50			169SB	400
14	538+25				
15	541+25				
16	544+85				
17	548+70				
18	552+25				
19	556+15				
20	559+85			169SB	400
21	259+30			W. FR. RD.	250
22	1+55			RAMP D	
23	3+20			RAMP D	
24	264+25			W. FR. RD.	250



MATCH TO
STA. 536+00

MATCH TO
STA. 564+00

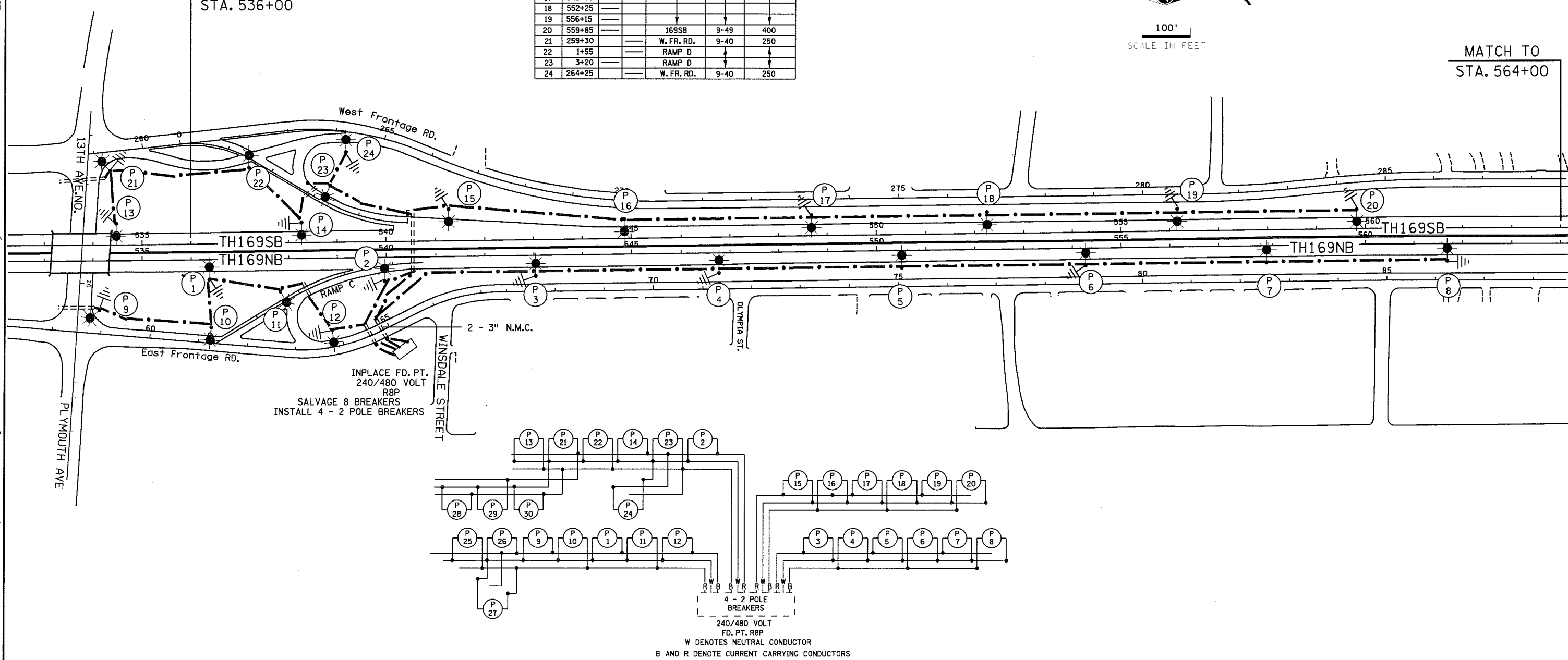

DISTRICT #: METRO
 IPLOT NAME: Ins 12772-88_0
 PATH & FILENAME: c:\Project\Wise\W...Working\Kluf\ER\nd0729680\Ins 12772-88_0\l1ab.dgn
 PLOTTED/REVISED: 2/3/2010

BY	DATE	REVISIONS
EK	2/1/10	Move 6 lights from R8L to R8P

FEEDPOINT: R8P LOCATION: WINDALE ST.
 METER ADDRESS:
 CERTIFIED BY *Michael P. Lubinsky* LIC. NO. 19863 DATE: 4/21/2009
LICENSED PROFESSIONAL ENGINEER

**AS-BUILT
FEEDPOINT R8P
LIGHTING PLANS**

STATE PROJ. NO. 2772-88 (T.H.169) SHEET NO. 63 OF 74 SHEETS

SEE LEGEND SHEET 45

FEEDPOINT R8L

LIGHTING STANDARDS AND BASES						
NO.	STA.	LT.	RT.	LOCATION	TYPE	WATTAGE
1	508+75			169NB	9-49	400
2	512+45					
3	516+15					
4	520+35					
5	524+25					
6	528+45			169NB	9-49	400
8	1+90			RAMP B	9-40	250
9	46+50			E. FR. RD.		
10	3+50			RAMP B		
11	51+00			E. FR. RD.		
12	53+10			E. FR. RD.	9-40	250
15	510+55			169SB	9-49	400
16	514+30					
17	518+60					
18	522+35					
19	526+35			169SB	9-49	400
21	524+70			SW ENT. RAMP	9-40	250
22	526+00			W. FR. RD.	9-40	250
23	528+35			W. FR. RD.	9-40	250
26	506+20			INPLACE		

FEEDPOINT R8P

LIGHTING STANDARDS AND BASES						
NO.	STA.	LT.	RT.	LOCATION	TYPE	WATTAGE
25	55+20			E. FR. RD.	9-40	250
26	57+20			E. FR. RD.	9-40	250
27	532+45			169NB	9-49	400
28	530+45			169SB	9-49	400
29	530+65			W. FR. RD.	9-40	250
30	532+95			W. FR. RD.	9-40	250

- ① USE TH169SB ALIGNMENT FOR STATIONING
- ② RENUMBER POLE - INPLACE FROM PREVIOUS PROJECT

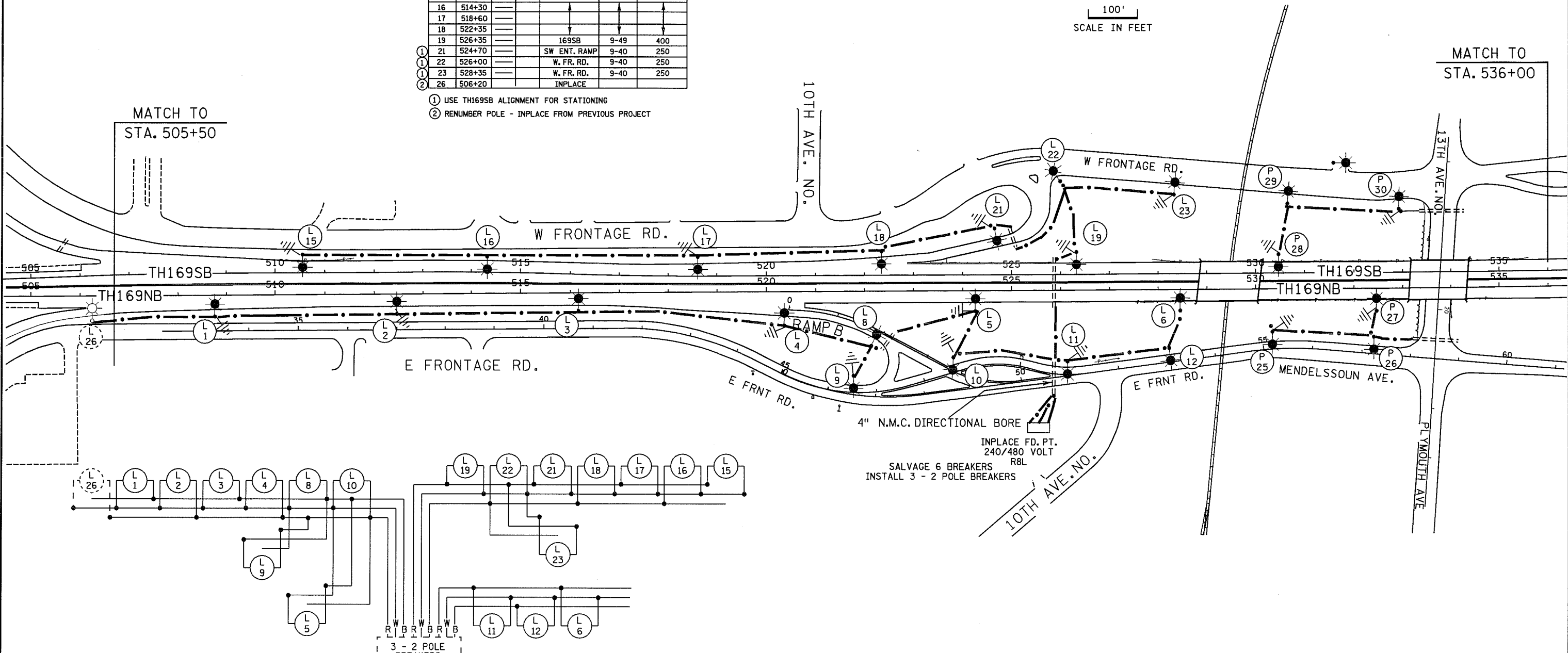
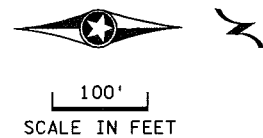

W DENOTES NEUTRAL CONDUCTOR
B AND R DENOTE CURRENT CARRYING CONDUCTORS
DASHED LINES DENOTE INPLACE ITEMS

AS-BUILT
FEEDPOINT R8L

LIGHTING PLANS

BY	DATE	REVISIONS
EK	2/01/10	Move 6 lights from R8L to R8P

FEEDPOINT: R8L LOCATION: S.E. QUADRANT 10th AVE. NO.
METER ADDRESS:
CERTIFIED BY *Michael P. Gabrusky* LIC. NO. 19863 DATE: 4/21/2009
LICENSED PROFESSIONAL ENGINEER

DISTRICT #: METRO
 IPLOT NAME: 2ns t2772-88_lo
 PATH & FILENAME: c:\Project\Wise\PW_Working\Kufi\Er\0729680\2ns t2772-88_lo\ltab.dgn
 PLOTTED/REVISED: 2/3/2010