

FD. PT. P4A

LIGHTING STANDARDS & BASES					
NO.	STATION	LT. RT.	LOCATION	TYPE	
(4)	1	28 + 50	-	RAMP W	
(4)	2	25 + 95	-	RAMP W	
(2)	3	23 + 40	-	RAMP W	6B-40
(2)	4	20 + 90	-	RAMP W	
(2)	5	18 + 80	-	RAMP B	
(2)	6	16 + 30	-	RAMP B	
(2)	7	13 + 80	-	RAMP B	
(2)	8	11 + 20	-	RAMP B	
(2)	9	1411 + 20	-	TH. 394 REV.	
(2)	10	1408 + 60	-		
(2)	11	1406 + 00	-		
(2)	12	1403 + 50	-		
(2)	13	1401 + 10	-		
(2)	14	1398 + 70	-		
(2)	15	1396 + 30	-	TH. 394 REV.	6B-40

(2) ANCHORAGE INP. F & I. 200 WATT HIGH PRESSURE SODIUM LIGHTING UNIT
 (4) INSTALL SALVAGED LIGHT STANDARD & F & I 200 WATT HIGH PRESSURE SODIUM LUMINAIRE

FD. PT. P4A

LIGHTING STANDARDS & BASES					
NO.	STATION	LT. RT.	LOCATION	TYPE	
(4)	19	23 + 80	-	RAMP B	
(2)	20	21 + 30	-	RAMP B	6B-40
(4)	31	17 + 50	-	RAMP H	
(2)	32	15 + 10	-	RAMP H	6B-40
(2)	33	12 + 50	-	RAMP H	
(2)	21	10 + 55	-	RAMP I-2	
(2)	22	13 + 05	-		
(2)	23	15 + 40	-		
(2)	24	17 + 80	-		
(2)	25	20 + 25	-		
(2)	26	22 + 70	-		
(2)	27	25 + 15	-	RAMP I-2	
(2)	28	35 + 85	-	RAMP E	
(2)	29	38 + 35	-	RAMP E	6B-40
(2)	30	40 + 90	-	RAMP E	6-40
16	1393 + 45	-	TH. 394 REV.		
17	1390 + 65	-	TH. 394 REV.		
18	1387 + 80	-	TH. 394 REV.		

LUMINAIRE P4A/16, 17 & 18 ARE PART OF LIGHTING UNITS P4F/4, 5 & 6. LUMINAIRE FOR P4A/16, 17 & 18 SHALL BE 200 WATT H.P.S.

SHEET TOTAL
 12 - 250 WATT HIGH PRESSURE SODIUM LIGHTING UNITS
 6 - 200 WATT HIGH PRESSURE SODIUM UNDERPASS LIGHTS

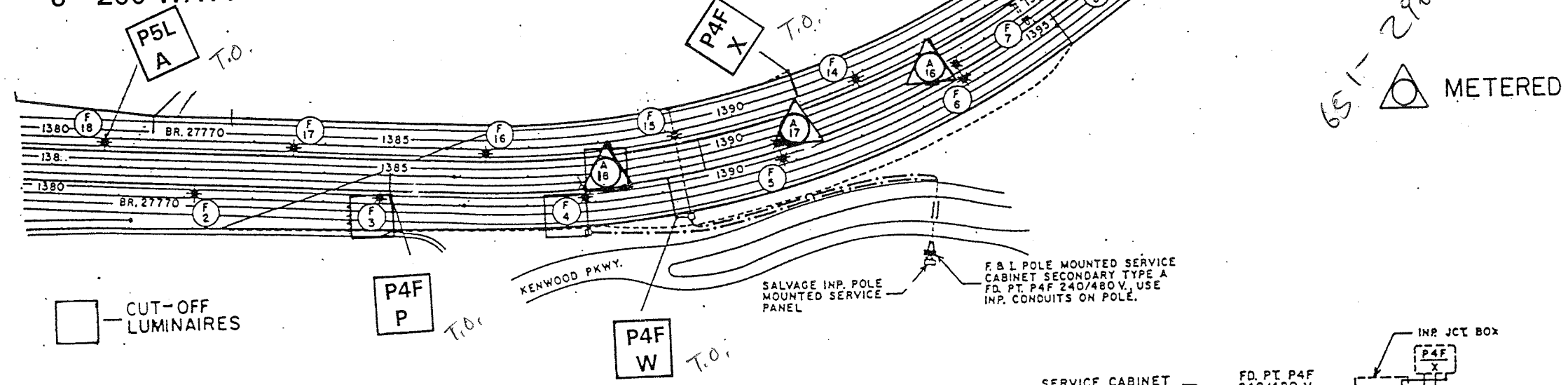

FD. PT. P4F

LIGHTING STANDARDS & BASES					
NO.	STATION	LT. RT.	LOCATION	TYPE	
(6)	1	1379 + 35	-	TH. 394 REV.	6B-49
(6)	2	1382 + 15	-		6B-49
(8)(6)	3	1384 + 85	-		6B-49
(8)(6)	4	1387 + 80	-		6B-49
(8)(6)	5	1390 + 65	-		6B-49
(8)(6)	6	1393 + 45	-	TH. 394 REV.	6B-49
7	AS SHOWN	-	TH. 394 F.B.	L	
8	AS SHOWN	-	TH. 394 F.B.	L	
9	AS SHOWN	-	TH. 394 W.B.	L	

(6) ANCHORAGE INP. F & I. 250 WATT HIGH PRESSURE SODIUM LIGHTING UNIT.
 LUMINAIRE FOR P4A/16, 17 & 18 SHALL BE 200 WATT HIGH PRESSURE.
 (8) SEE SHEET 6 FOR POLE DETAILS

FD. PT. P4F

LIGHTING STANDARDS & BASES					
NO.	STATION	LT. RT.	LOCATION	TYPE	
(7)	10	AS SHOWN		TH. 394 W.B.	L
(7)	11	AS SHOWN		TH. 394 W.B.	L
(7)	12	AS SHOWN		TH. 394 W.B.	L
(6)	13	1394 + 90	-	TH. 394 REV.	6B-49
(6)	14	1392 + 05	-		
(6)	15	1389 + 20	-		
(6)	16	1386 + 35	-		
(6)	17	1383 + 55	-		
(6)	18	1380 + 75	-		
(6)	19	1377 + 95	-	TH. 394 REV.	6B-49

(7) 200 WATT HIGH PRESSURE SODIUM UNDERPASS LIGHT

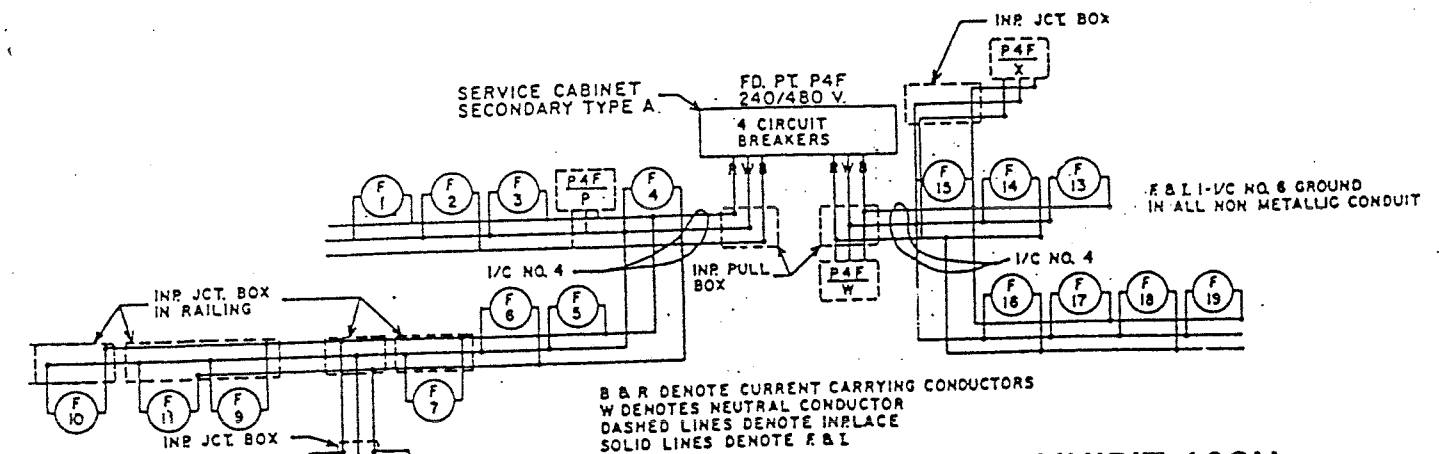

F & I. NO. 10 WIRE FROM JCT. BOX IN RAILING TO UNDERPASS LIGHTS

B & R DENOTE CURRENT CARRYING CONDUCTORS
 W DENOTES NEUTRAL CONDUCTOR
 DASHED LINES DENOTE INPLACE
 SOLID LINES DENOTE F & I

FD. PTS. P4F, P4E, P4A

EXHIBIT 103H
 T.H. 394 NEAR KENWOOD PKWY.
 IN MINNEAPOLIS

N.S.P.

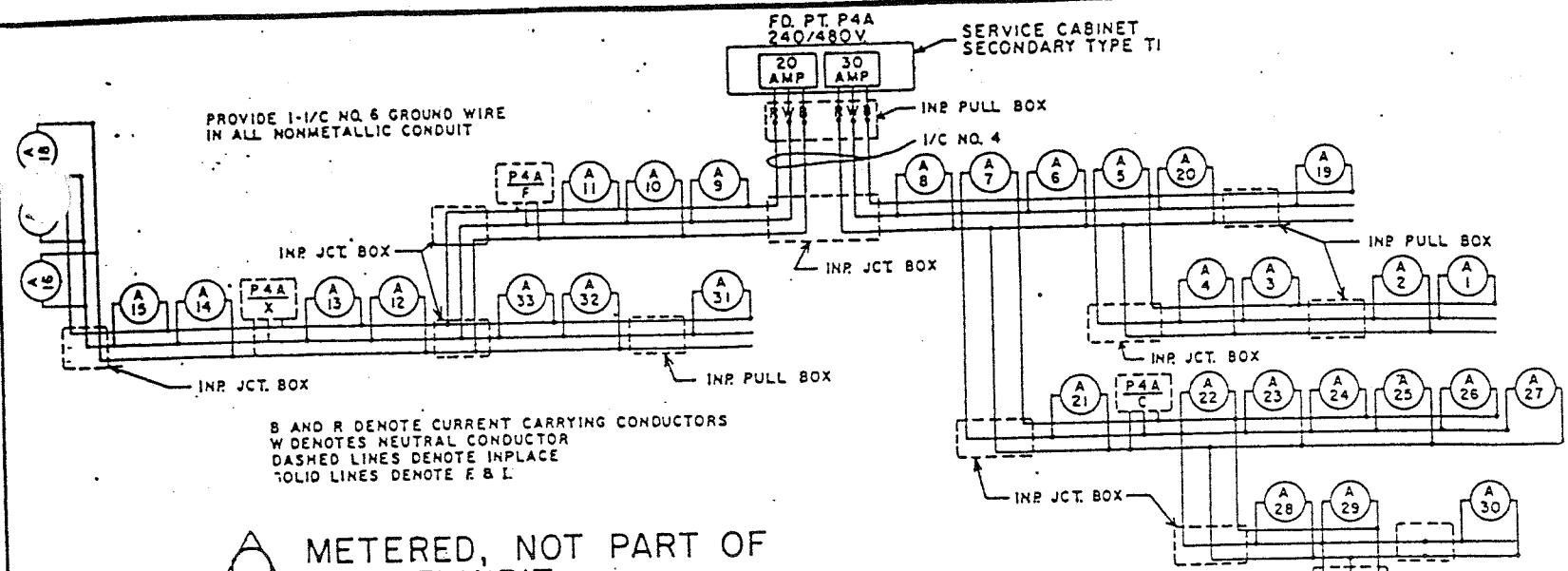

FD. PT. P3T

LIGHTING STANDARDS & BASES				
NO.	STATION	LT. RT.	LOCATION	TYPE
(2) 1	1412 + 80 W.B.	-	MEDIAN T.H. 394	68D-40
(2) 2	1415 + 20 W.B.	-		
(2) 3	1417 + 60 W.B.	-		
(2) 4	1420 + 00 W.B.	-		
(2) 5	1422 + 70 W.B.	-		
(2) 6	1425 + 40 W.B.	-		
(2) 7	1427 + 26 W.B.	-		
(2) 8	1429 + 43 W.B.	-	MEDIAN T.H. 394	68D-40

(2) ANCHORAGE INP. F & I. 200 WATT HIGH PRESSURE SODIUM LIGHTING UNIT

FD. PT. P3T

LIGHTING STANDARDS & BASES				
NO.	STATION	LT. RT.	LOCATION	TYPE
(2) 17		-	RAMP I	68-40
(2) 18		-		
(2) 19		-		
(2) 20		-		68-40
21	INP 11 + 40	-		
22	INP 13 + 80	-		
23	INP 16 + 20	-		68-40
24	INP 27 + 65	-		68-40
25	INP 30 + 05	-	RAMP I	68-40
(7) 26	AS SHOWN	-	RAMP IO	
(7) 27		-	RAMP IO	
(7) 28		-	RAMP IO	
(7) 29		-	T.H. 394 W.B.	
(7) 30		-	T.H. 394 W.B.	
(7) 31	AS SHOWN	-	T.H. 394 E.B.	

(7) 200 WATT HIGH PRESSURE SODIUM UNDERPASS LIGHT

METERED, NOT PART OF THIS EXHIBIT.

EXHIBIT 103H
T.H. 394 & WAYZATA BLVD.
IN MINNEAPOLIS
N.S.P.

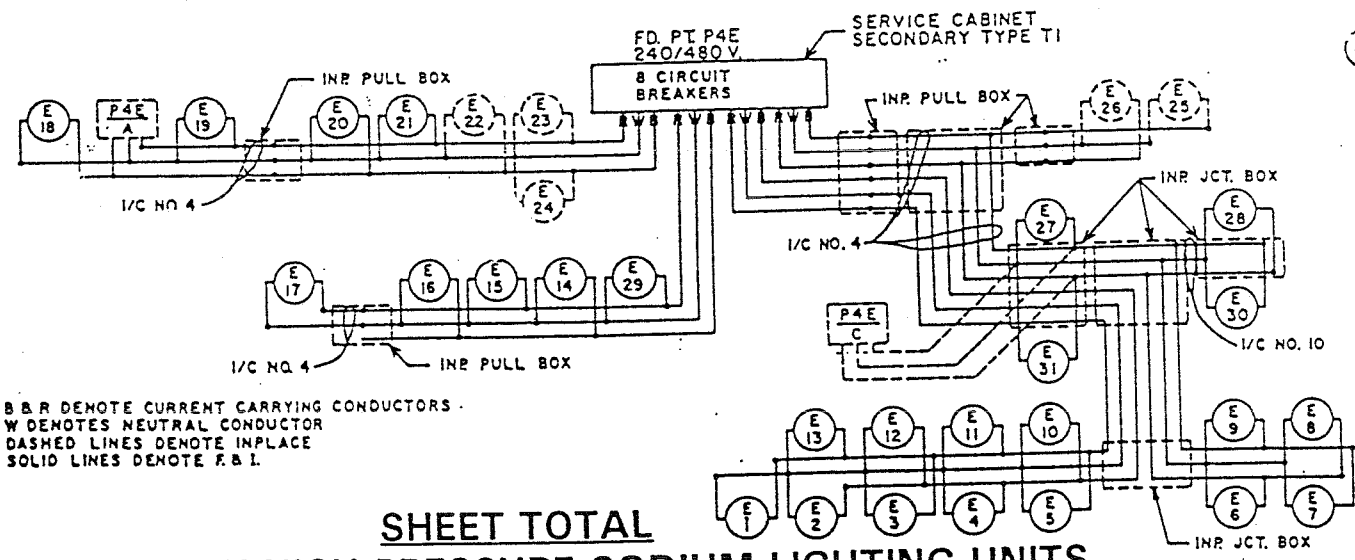
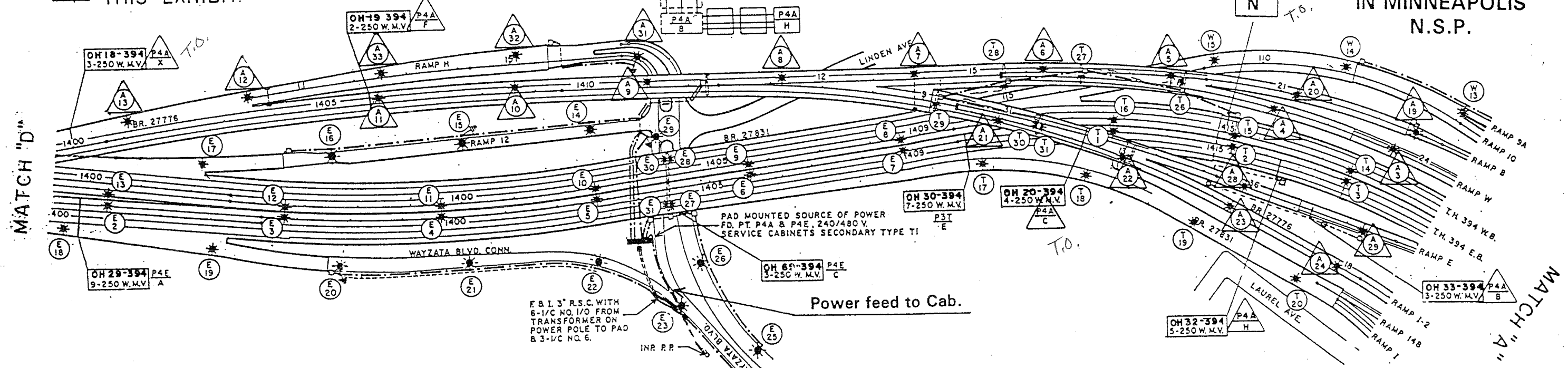

FD. PT. P4E

LIGHTING STANDARDS & BASES				
NO.	STATION	LT. RT.	LOCATION	TYPE
(6) 1	1397 + 85	-	T.H. 394 E.B.	68-49
(6) 2	1400 + 95	-		68D-49
(6) 3	1396 + 75	-		
(6) 4	1399 + 75	-		
(6) 5	1402 + 75	-		
(6) 6	1405 + 75	-		
(6) 7	1408 + 75	-	T.H. 394 E.B.	68D-49
(4) 14	AS SHOWN	-	RAMP 12	
(4) 15	AS SHOWN	-	RAMP 12	
(4) 16	AS SHOWN	-	RAMP 12	

(4) INSTALL SALVAGED LIGHT STANDARD & F & I 200 WATT HIGH PRESSURE SODIUM LUMINAIRE
(6) ANCHORAGE INP. F & I 250 WATT HIGH PRESSURE SODIUM LIGHTING UNIT
PLACE LIGHTING UNITS 9' BEHIND CURB

FD. PT. P4E

LIGHTING STANDARDS & BASES				
NO.	STATION	LT. RT.	LOCATION	TYPE
(2) 17	1402 + 15	-	T.H. 394 W.B.	68-40
(2) 18	1400 + 15	-	T.H. 394 E.B.	68-40
(2) 19	1403 + 10	-	T.H. 394 E.B.	68-40
(4) 20	AS SHOWN	-	WAYZATA CONN.	
(4) 21	AS SHOWN	-	WAYZATA CONN.	
(1) 22	INPLACE	-	WAYZATA CONN.	
(1) 23	INPLACE	-	WAYZATA CONN.	
(1) 24	INPLACE	-	WAYZATA BLVD.	
(1) 25	INPLACE	-		
(1) 26	INPLACE	-		
(7) 27	AS SHOWN	-		
(7) 28	AS SHOWN	-		
(4) 29	AS SHOWN	-		
(7) 30	AS SHOWN	-		
(7) 31	AS SHOWN	-	WAYZATA BLVD.	

(1) SALVAGE INP. LUMINAIRE & F & I 200 WATT HIGH PRESSURE SODIUM LUMINAIRE
(2) ANCHORAGE INP. F & I 250 WATT HIGH PRESSURE SODIUM LIGHTING UNIT
(7) 200 WATT HIGH PRESSURE SODIUM UNDERPASS LIGHT

- SHEET TOTAL**
- 12 - 250 WATT HIGH PRESSURE SODIUM LIGHTING UNITS
 - 27 - 200 WATT HIGH PRESSURE SODIUM LIGHTING UNITS
 - 10 - 200 WATT HIGH PRESSURE SODIUM UNDERPASS LIGHTS
 - 19 - 250 WATT MERCURY VAPOR SIGN LIGHTS

SHEET TOTAL

- 8 - 400 WATT HIGH PRESSURE SODIUM LIGHTING UNITS
- 43 - 200 WATT HIGH PRESSURE SODIUM LIGHTING UNITS
- 3 - 200 WATT HIGH PRESSURE SODIUM UNDERPASS LIGHTS
- 26 - 250 WATT MERCURY VAPOR SIGN LIGHTS
- 3 - 175 WATT MERCURY VAPOR SIGN LIGHTS

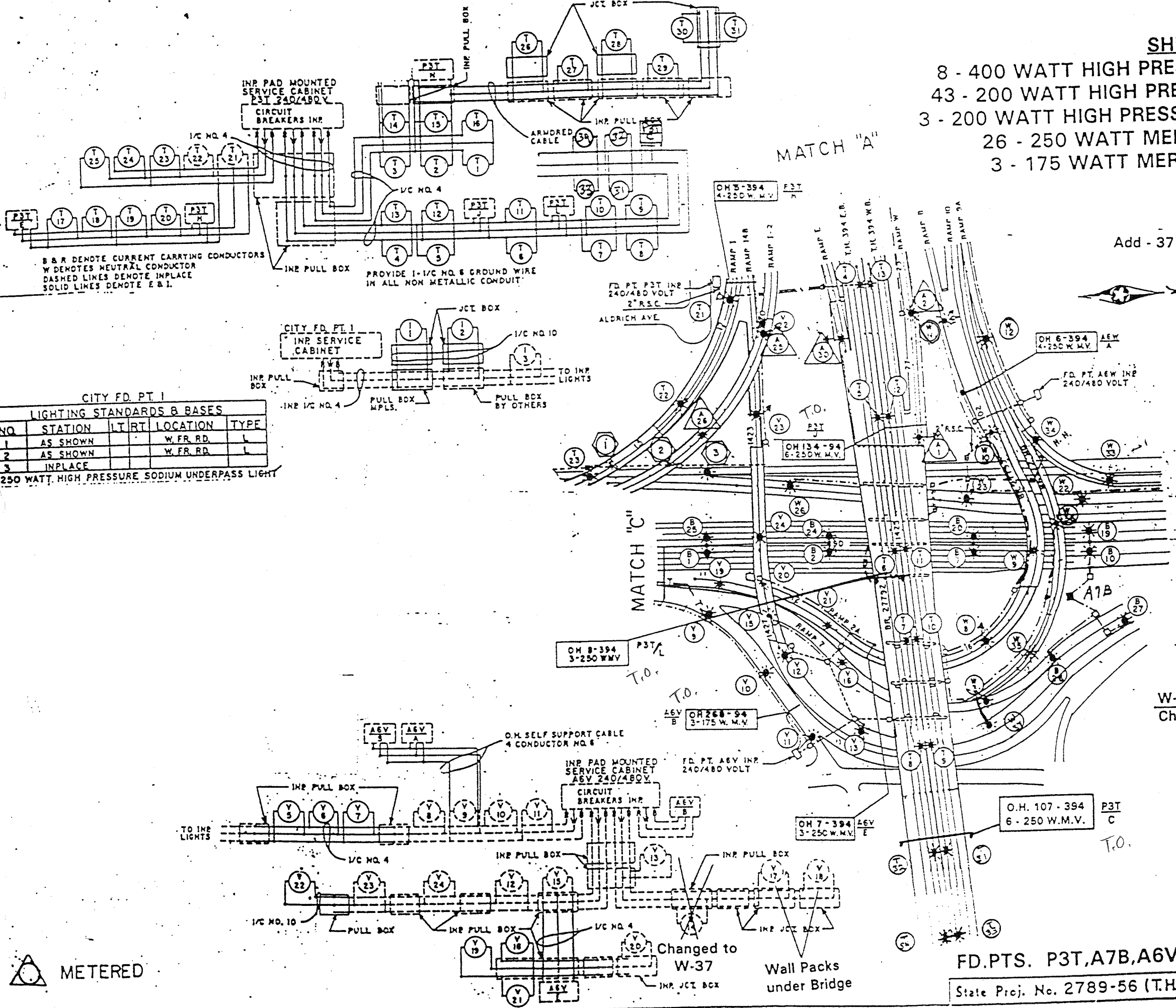

B & R DENOTE CURRENT CARRYING CONDUCTORS
W DENOTES NEUTRAL CONDUCTOR
DASHED LINES DENOTE INPLACE
SOLID LINES DENOTE E & I.

PROVIDE 1-1/2" NO. 6 GROUND WIRE
IN ALL NON METALLIC CONDUIT

Add - 37 from A6V Feedpoint FD PT A6W

CITY FD. PT. 1

NO	STATION	LT RT	LOCATION	TYPE
1	AS SHOWN		W. FR. RD.	L
2	AS SHOWN		W. FR. RD.	L
3	INPLACE			

(8) 250 WATT HIGH PRESSURE SODIUM UNDERPASS LIGHT

FD PT A6W

NO	STATION	LT RT	LOCATION	TYPE
(3)	5	5 + 50	-	RAMP 7
(2)	9	55 + 50	-	RAMP 10
(3)	10	10 + 50	-	RAMP 10
(3)	11	104 + 20	-	RAMP 10
(4)	12	51 + 50	-	RAMP 9A
(4)	13	106 + 20	-	RAMP 10
(2)	14	106 + 50	-	RAMP 10
(2)	15	110 + 50	-	RAMP 10

- (2) ANCHORAGE INP. E.B.I. 200 WATT HIGH PRESSURE SODIUM LIGHTING UNIT
- (3) INSTALL SALVAGED LIGHT STANDARD AND SALVAGED 200 WATT HIGH PRESSURE SODIUM LUMINAIRE
- (4) INSTALL SALVAGED LIGHT STANDARD B.E.B.I. 200 WATT HIGH PRESSURE SODIUM LUMINAIRE

FD PT A6V

NO	STATION	LT RT	LOCATION	TYPE
(1)	1	INP 75 + 50	-	LYNDALE N.B.
(1)	2	INP 77 + 50	-	
(1)	3	INP 78 + 20	-	
(1)	4	INP 80 + 20	-	
(2)	5	E2 + 35	-	EB-40
(2)	6	E4 + 35	-	EB-40
(2)	7	E6 + 35	-	EB-40
(1)	8	INP 88 + 50	-	
	9	INP 80 + 55	-	
	10	INP 82 + 35	-	
	11	INP 83 + 50	-	LYNDALE N.B.
(1)	12	INP 1427 + 70	-	RAMP 14
	13	INP 1428 + 70	-	RAMP 14
	14	INP 1430 + 50	-	RAMP 14
(2)	15	INP 82 + 50	-	RAMP 7
(2)	16	AS SHOWN	-	RAMP 7
	17	INP 55 + 10	-	RAMP 7
	18	INP 55 + 70	-	RAMP 7
(2)	19	AS SHOWN	-	RAMP 2A
	20	INP 84 + 55	-	RAMP 2A
(2)	21	12 + 50	-	RAMP 2A
	22	INP 1420 + 50	-	RAMP 14
	23	INP 1422 + 55	-	RAMP 14
	24	INP 1424 + 10	-	RAMP 14

- (1) SALVAGE INP. LUMINAIRE B.E.B.I. 200 WATT HIGH PRESSURE SODIUM LUMINAIRE
- (2) ANCHORAGE INP. E.B.I. 200 WATT HIGH PRESSURE SODIUM LIGHTING UNIT

W-37 Changed

Changed to W-37
Wall Packs under Bridge

FD.PTS. P3T, A7B, A6V, A6W

State Proj. No. 2789-56 (T.H. 394=107)

EXHIBIT 103H
T.H. 94 & T.H. 394
IN MINNEAPOLIS
N.S.P.

