

- LEGEND**
- INPLACE PAD MOUNTED SOURCE OF POWER
  - PAD MOUNTED SOURCE OF POWER
  - INPLACE CONDUIT
  - 2" RIGID STEEL CONDUIT
  - 2" PVC CONDUIT
  - ⊛ 200 WATT HIGH PRESSURE SODIUM TWIN MAST ARM LIGHTING UNIT
  - ⊛ HIGH PRESSURE SODIUM LIGHTING UNIT (WATTAGE AS INDICATED)
  - ⊛ 250 WATT HIGH PRESSURE SODIUM COMB. SIGNAL & LIGHTING UNIT
  - ⊛ INPLACE COMB SIGNAL & LIGHTING UNIT
  - INPLACE LIGHTING UNIT
  - ⊛ 200 WATT HIGH PRESSURE SODIUM UNDERPASS LIGHT
  - ⊛ INPLACE UNDERPASS LIGHT
  - ⊛ OVERHEAD SIGN BY OTHERS
  - PULL BOX
  - INPLACE PULL BOX
  - ← PERMANENT GROUND ROD (25 OHMS OR LESS)
  - \* PROVIDE ONE ADDITIONAL CONDUIT ELBOW

THESE 2 LIGHTS FED FROM A07S4

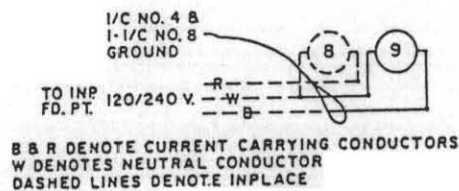
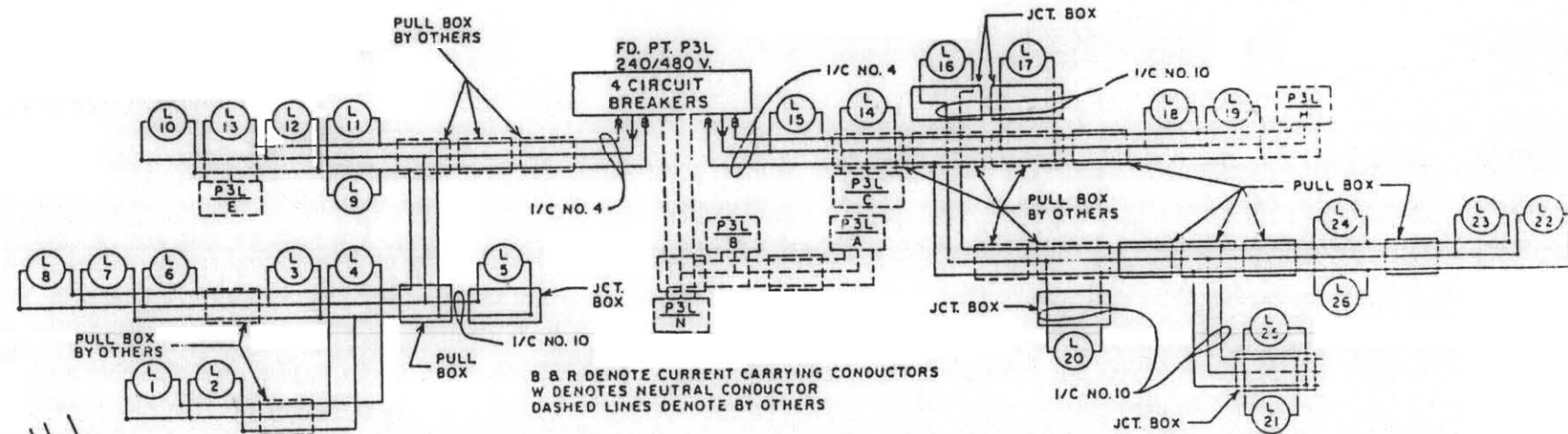
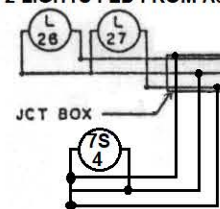

B & R DENOTE CURRENT CARRYING CONDUCTORS  
W DENOTES NEUTRAL CONDUCTOR  
DASHED LINES DENOTE INPLACE

△ THESE LIGHTS ARE MAINTAINED BY THE CITY

FD PT P3L LIGHTING STANDARDS & BASES

NO	STATION	LT. RT.	LOCATION	TYPE
1	22 + 20	-	BUS RAMP 4	5-40
2	24 + 20	-	BUS RAMP 4	5-40
3	14 + 50	-	L2OR4 RAMP	6-40
4	15 + 25	-	L2OR4 RAMP	5-40
5	17 + 00	-	L2OR4 RAMP	L
(3) 6	1453 + 50	-	TH 394 E.B.L.	63-40
(3) 7	1471 + 40	-	TH 394 E.B.L.	63-40
(3) 8	1473 + 00	-	TH 394 E.B.L.	63-40
9	1472 + 00	-	T.H.394 W.B.L.	60-40
11	1453 + 70	-	TH 394 W.B.L.	9-40
12	25 + 50	-	BUS RAMP 3	5-40
13	23 + 20	-	BUS RAMP 3	6-40
(3) 14	1475 + 55	-	TH 394 W.B.L.	63-40
15	1477 + 40	-	TH 394 W.B.L.	4-40
16	28 + 55	-	BUS RAMP 4	L
17	21 + 20	-	L2OR7 RAMP	L
18	23 + 20	-	L2OR7 RAMP	5-40
19	25 + 50	-	L2OR7 RAMP	5-40
20	21 + 00	-	L2OR4 RAMP	L
21	22 + 10	-	L2OR7 RAMP	L
22	32 + 70	-	BUS RAMP 3	5-40
23	30 + 70	-	BUS RAMP 3	6-40
(3) 24	13 + 75	-	L4OR4 RAMP	63-40
25	14 + 55	-	L4OR4 RAMP	L
(3) 26	24 + 55	-	RAMP J-1	63-40
(3) 27	24 + 55	-	RAMP J-1	63-40

(3) LIGHT ANCHORS TO BE BY OTHERS  
PLACE LIGHTING UNITS 9' BEHIND CURB OR AS DIRECTED BY ENGINEER

POLES P03L 27 & 28 FED FROM A07S4

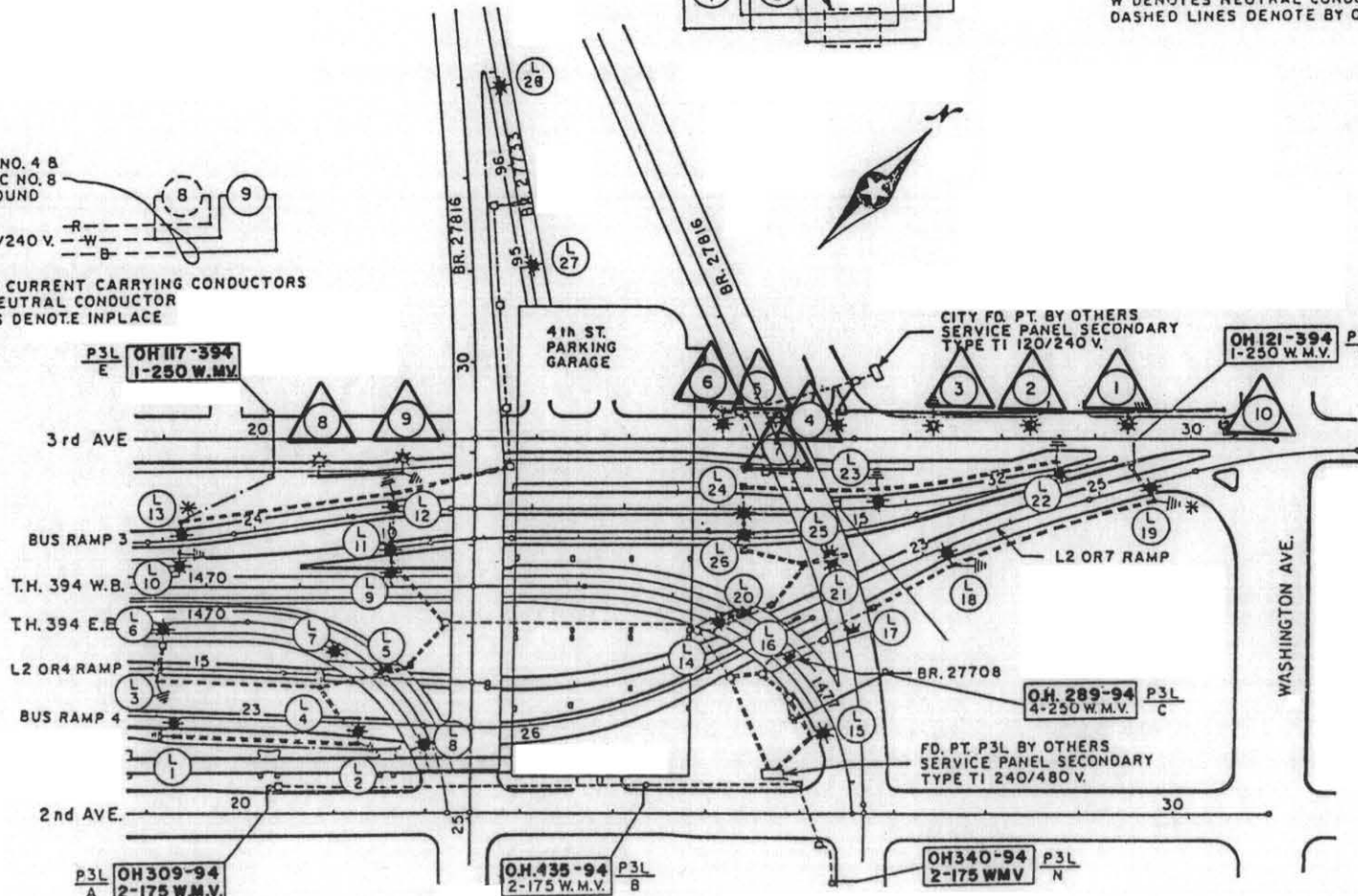

T. H. 394 BET. 5th ST & WASHINGTON AVE. IN MPLS. N.S.P.

FD.PT. P3L

State Proj. No. 2789 - 87 (T. H. 394)

Sheet No. 3 of 3 Sheets

**AS-BUILT**