

SEE LEGEND SHEET 8

DASHED LINES DENOTE INPLACE ITEMS
 W DENOTES NEUTRAL CONDUCTOR
 B AND R DENOTE CURRENT CARRYING CONDUCTORS
 FD. PT. N5A
 240/480 VOLT

FEEDPOINT N5A

LIGHTING STANDARDS AND BASES					
NO.	STATION	LT.	RT.	LOCATION	WATTAGE
1	INPLACE	-	-	WB T.H. 694	250
2		-	-		
3		-	-		
4		-	-		
5		-	-		
6		-	-		
7		-	-		
8		-	-		
9		-	-		
10		-	-		
11		-	-		
12		-	-		
13	INPLACE	-	-	WB T.H. 694	
14	11+90	-	-	NE RAMP	
15	9+75	-	-		
16	7+60	-	-		
17	5+45	-	-		
18	3+35	-	-		
19	1+20	-	-	NE RAMP	
20	7+50	-	-	NW RAMP	
21	5+10	-	-	NW RAMP	
22	2+74	-	-	NW RAMP	250



PLOTTED/REVISED: 3/5/2014

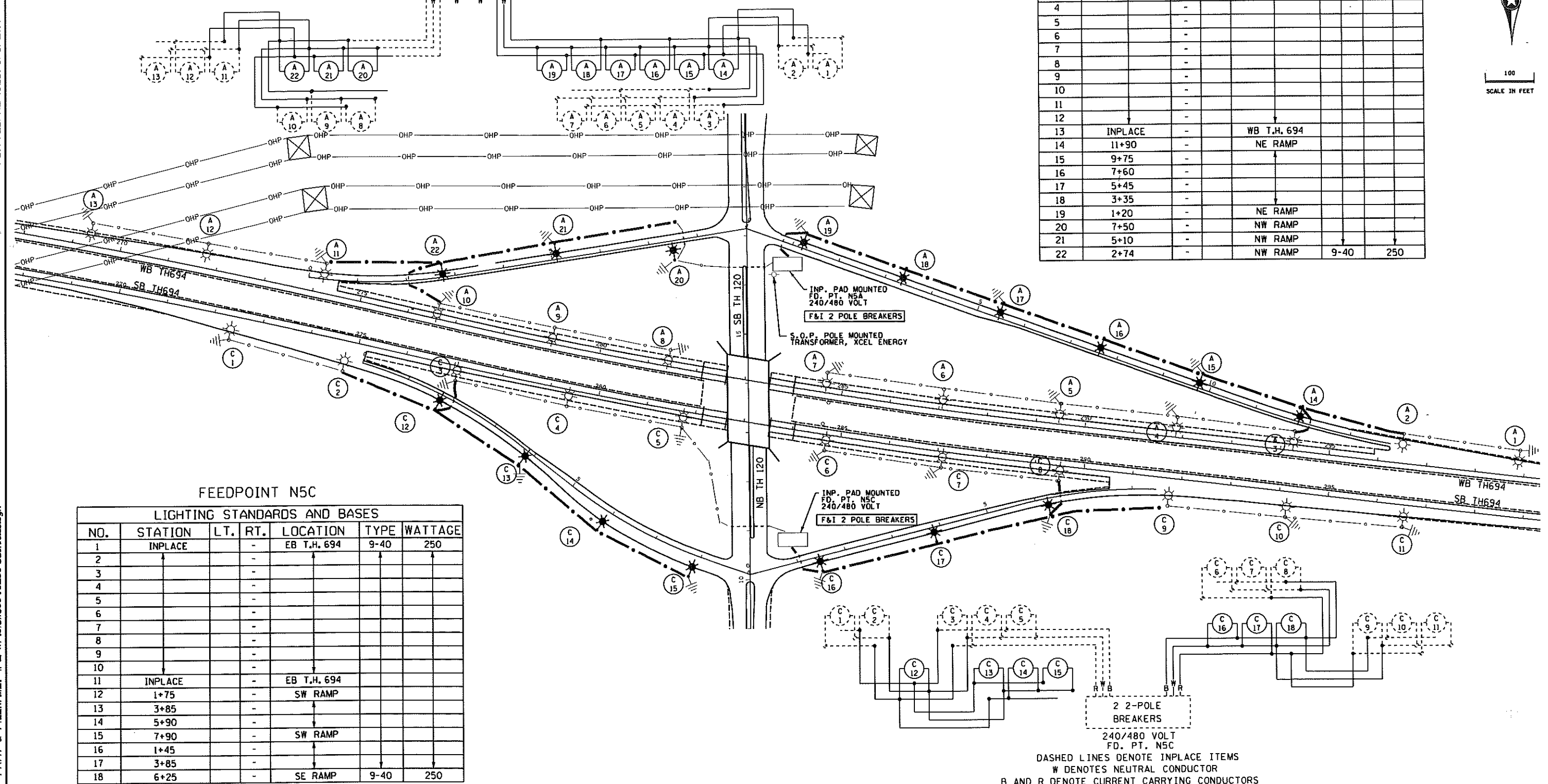

FEEDPOINT N5C

LIGHTING STANDARDS AND BASES					
NO.	STATION	LT.	RT.	LOCATION	WATTAGE
1	INPLACE	-	-	EB T.H. 694	250
2		-	-		
3		-	-		
4		-	-		
5		-	-		
6		-	-		
7		-	-		
8		-	-		
9		-	-		
10		-	-		
11	INPLACE	-	-	EB T.H. 694	
12	1+75	-	-	SW RAMP	
13	3+85	-	-		
14	5+90	-	-		
15	7+90	-	-	SW RAMP	
16	1+45	-	-		
17	3+85	-	-		
18	6+25	-	-	SE RAMP	250

DASHED LINES DENOTE INPLACE ITEMS
 W DENOTES NEUTRAL CONDUCTOR
 B AND R DENOTE CURRENT CARRYING CONDUCTORS

METER ADDRESS: N5A 2950 CENTURY AVE, MAHTOMEDI 55115
 N5C 5901 CENTURY AVE, OAKDALE 55128

Fd. Pt. N5A & N5C

BY	DATE	REVISIONS

FEEDPOINT: N5A & N5C LOCATION: T.H. 694 & Century (T.H. 120)
 METER ADDRESS: SEE ABOVE
 CERTIFIED BY *Michael P. Schwanly* LIC. NO. 19863 DATE: 3/5/2014
LICENSED PROFESSIONAL ENGINEER

LIGHTING PLAN

STATE PROJ. NO. 6286-55 (T.H. 694) SHEET NO. 11 OF 11 SHEETS

DISTRICT #: METRO
 IPLOT NAME: 16286-55/J/loab
 PATH & FILENAME: IP_PWP-P/151/599/6286-55/J/loab.dgn