

SHEET TOTAL
26 - 200 WATT HIGH PRESSURE SODIUM LIGHTING UNITS
9 - 250 WATT MERCURY VAPOR SIGN LIGHTS

- ▷ SOURCE OF POWER (POLE MOUNTED)
- ⊥ F. & I. PERMANENT GROUND ROD (25 OHMS OR LESS)
- RIGID STEEL CONDUIT INP.
- ===== F. & I. RIGID STEEL CONDUIT
- ⊙ LIGHTING UNIT INP.
- ⊙ F. & I. LIGHTING UNIT, 200 WATT HIGH PRESSURE SODIUM
- ⊙ UNDERPASS LIGHTING UNIT, TYPE M
- DIRECT BURIED POWER CABLE, 3 CONDUCTOR NO. 4 ARMORED CABLE. SEE SPEC. NO. 3804 CR 3805.
- ARMORED CABLE INP.
- PULL BOX BY OTHERS
- ⊥ OVERHEAD ILLUMINATED SIGN BY OTHERS
- ✱ F. & I. ONE ADDITIONAL 2" CONDUIT ELBOW
- △ MAINTAINED BY THE CITY OF ST. PAUL

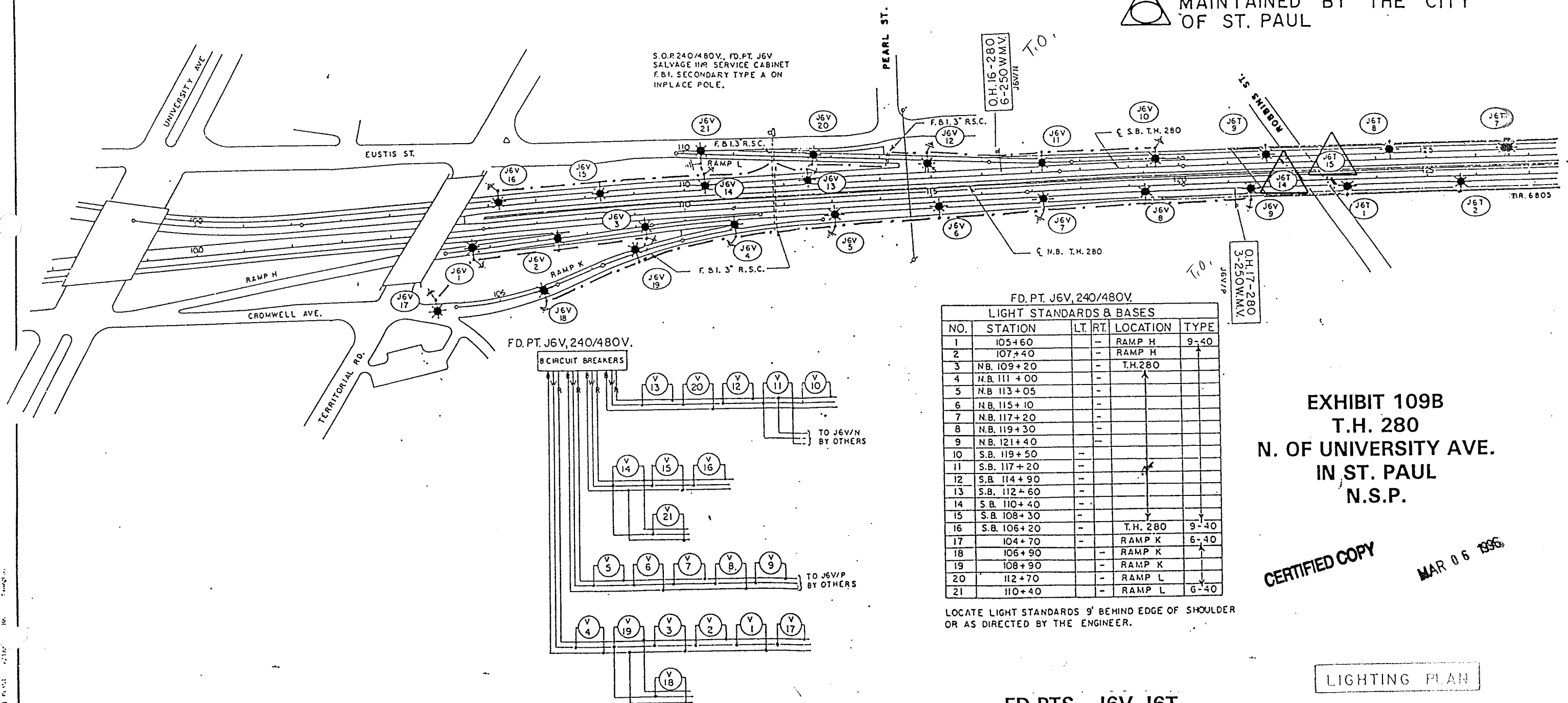

S.O.P. 240/480V, FD.PT. J6V
 SALVAGE 11R SERVICE CABINET
 F. & I. SECONDARY TYPE A ON
 INPLACE POLE.

O.H. 16-280
 6-250W/M.V.
 J6V/P

O.H. 17-280
 3-250W/M.V.
 J6V/P

FD.PT. J6V, 240/480V.

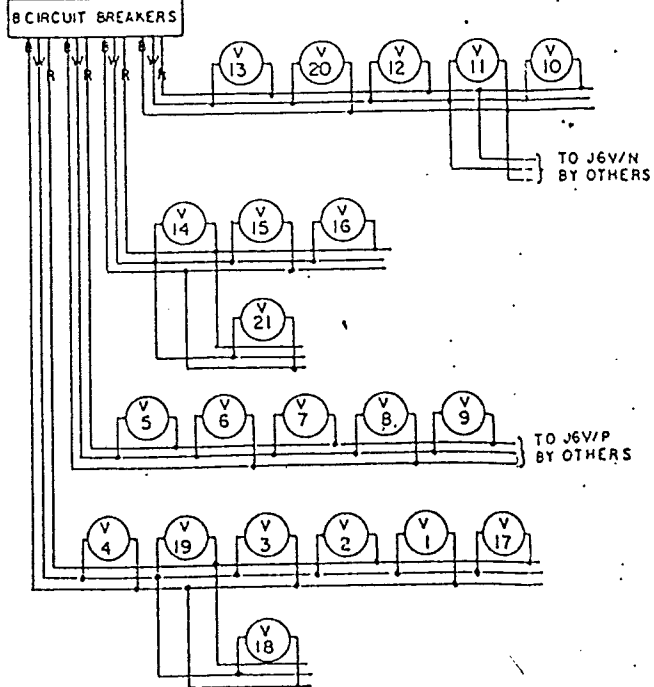

FD.PT. J6V, 240/480V.
 LIGHT STANDARDS & BASES

NO.	STATION	LT.	RT.	LOCATION	TYPE
1	105+60	-	-	RAMP H	9-40
2	107+40	-	-	RAMP H	
3	N.B. 109+20	-	-	T.H. 280	
4	N.B. 113+00	-	-		
5	N.B. 113+05	-	-		
6	N.B. 115+10	-	-		
7	N.B. 117+20	-	-		
8	N.B. 119+30	-	-		
9	N.B. 121+40	-	-		
10	S.B. 119+50	-	-		
11	S.B. 117+20	-	-		
12	S.B. 114+90	-	-		
13	S.B. 112+60	-	-		
14	S.B. 110+40	-	-		
15	S.B. 108+30	-	-		
16	S.B. 106+20	-	-	T.H. 280	9-40
17	104+70	-	-	RAMP K	6-40
18	106+90	-	-	RAMP K	
19	108+90	-	-	RAMP K	
20	112+70	-	-	RAMP L	
21	110+40	-	-	RAMP L	6-40

LOCATE LIGHT STANDARDS 9' BEHIND EDGE OF SHOULDER
 OR AS DIRECTED BY THE ENGINEER.

EXHIBIT 109B
T.H. 280
N. OF UNIVERSITY AVE.
IN ST. PAUL
N.S.P.

CERTIFIED COPY

MAR 06 1996

LIGHTING PLAN

B AND R DENOTE CURRENT CARRYING CONDUCTORS
 W DENOTES NEUTRAL CONDUCTOR