

FEEDPOINT J6H

LIGHTING STANDARDS AND BASES					
NO.	STATION	LT.	RT.	LOCATION	TYPE WATTAGE
10	40+55			TH280 NB	9-40 250
1	31+30			TH280 NB	9-40 250
2	33+70			TH280 NB	9-40 250
3	35+90			TH280 NB	9-40 250
4	38+25			TH280 NB	9-40 250
5	40+45			TH280 NB	9-40 250
6	42+65			TH280 NB	9-40 250
7	44+80			TH280 NB	9-40 250
8	47+25			TH280 NB	9-40 250
9	49+70			TH280 NB	9-40 250
11	51+95			TH280 NB	VM-49 400
12	54+30			TH280 NB	VM-49 400
13	56+50			TH280 NB	VM-49 400
14	58+55			TH280 NB	VM-49 400
15	60+85			TH280 NB	VM-49 400
16	63+20			TH280 NB	VM-49 400
17	65+50			TH280 NB	VM-49 400
18	67+90			TH280 NB	VM-49 400
19	70+30			TH280 NB	VM-49 400
20	29+25			TH280 SB	VM-49 250
21	31+55			TH280 SB	VM-49 250
22	33+85			TH280 SB	VM-49 250
23	36+23			TH280 SB	VM-49 250
24	38+60			TH280 SB	VM-49 250
25	40+90			TH280 SB	VM-49 250
26	43+20			TH280 SB	VM-49 250
27	45+55			TH280 SB	VM-49 250
28	47+85			TH280 SB	VM-49 250
29	50+10			TH280 SB	VM-49 250

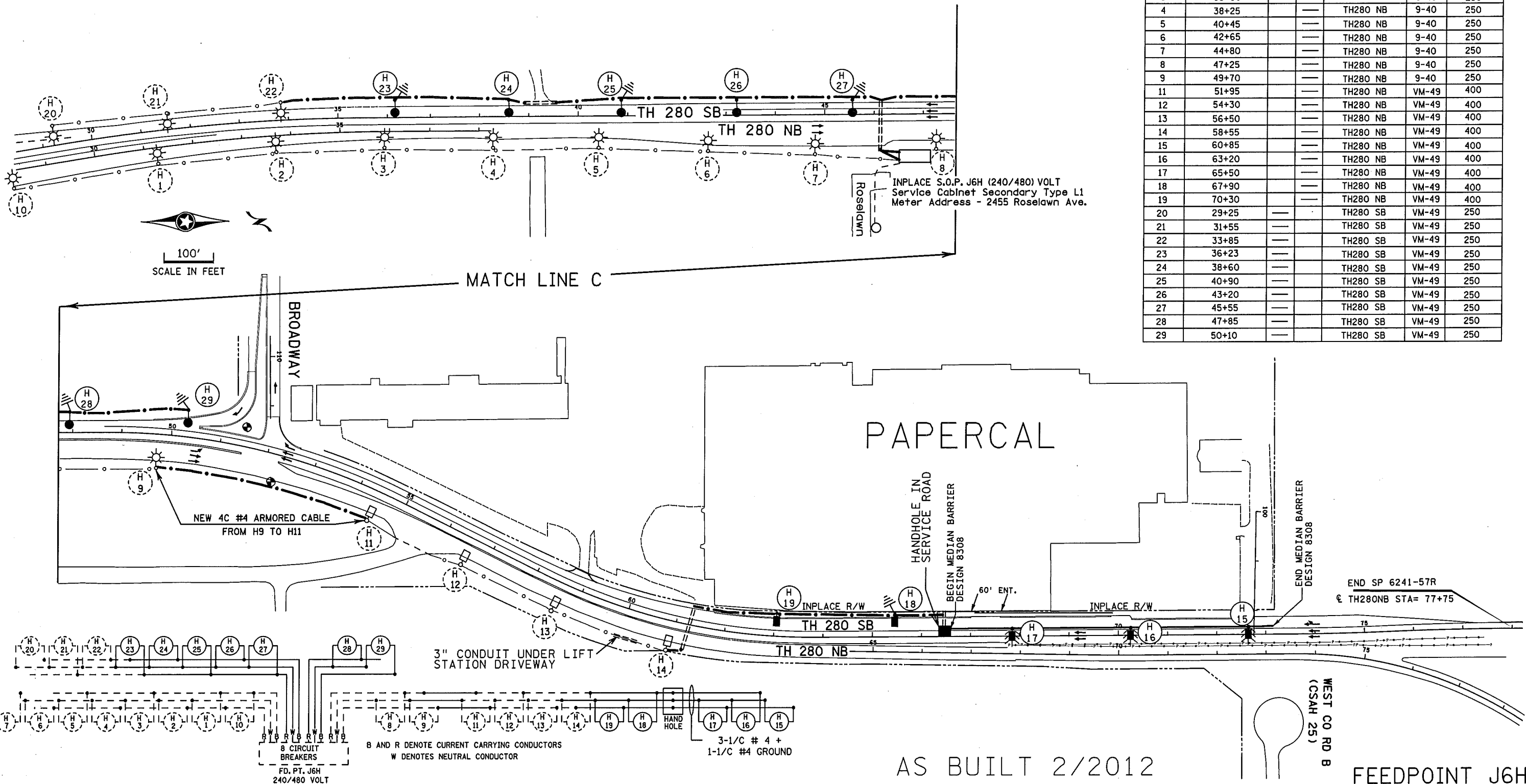

AS BUILT 2/2012

FEEDPOINT J6H

BY	DATE	REVISIONS	FEEDPOINT: J6H	LOCATION: ROSELAWN Ave.	LIGHTING PLAN
EK	12/2010	ADD CONDUIT & 2 NOTES	METER ADDRESS: 2455 ROSELAWN Ave.	ST. PAUL	
JP	2/2012	MADE FIELD CORRECTIONS	CERTIFIED BY <i>Michael P. Lubinsky</i> LIC. NO. 19863 DATE: 3/1/2012		STATE PROJ. NO. 6241-57R (T.H.280) SHEET NO. L6 OF L6 SHEETS
DRAWN BY: NS		CKD BY: GB	DATE:		

DISTRICT: METRO
 IPLOT NAME: 16241-57R_1011AB
 PATH & FILENAME: IP_FWP-d073195616241-57R_1011AB.dgn
 PLOTTED/REVISED: 3/1/2012