

SHEET TOTAL
15-200 WATT HIGH PRESSURE SODIUM LIGHTING UNITS

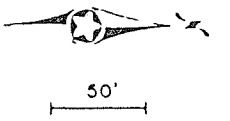

MATCH LINE
"B"
SEE SHEET 2

MATCH LINE
"C"
SEE SHEET 4

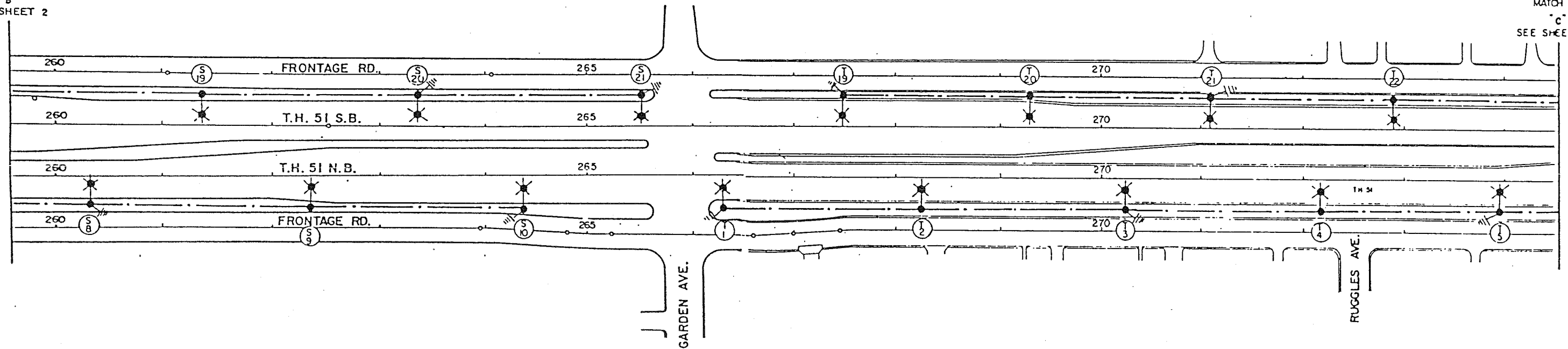
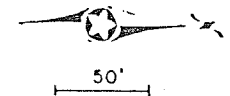

EXHIBIT 245
T.H. 51 BET. LARPENTER
AND ROSELAWN AVES.
IN ST. PAUL
N.S.P.

FEEDPOINTS H7S, H7T

STREET LIGHTING

EXHIBIT 245
T.H. 51 JCT. ROSELAWN AVE.
IN ST. PAUL
N.S.P.



MATCH LINE
C
SEE SHEET 3

MATCH LINE
D
SEE SHEET 5

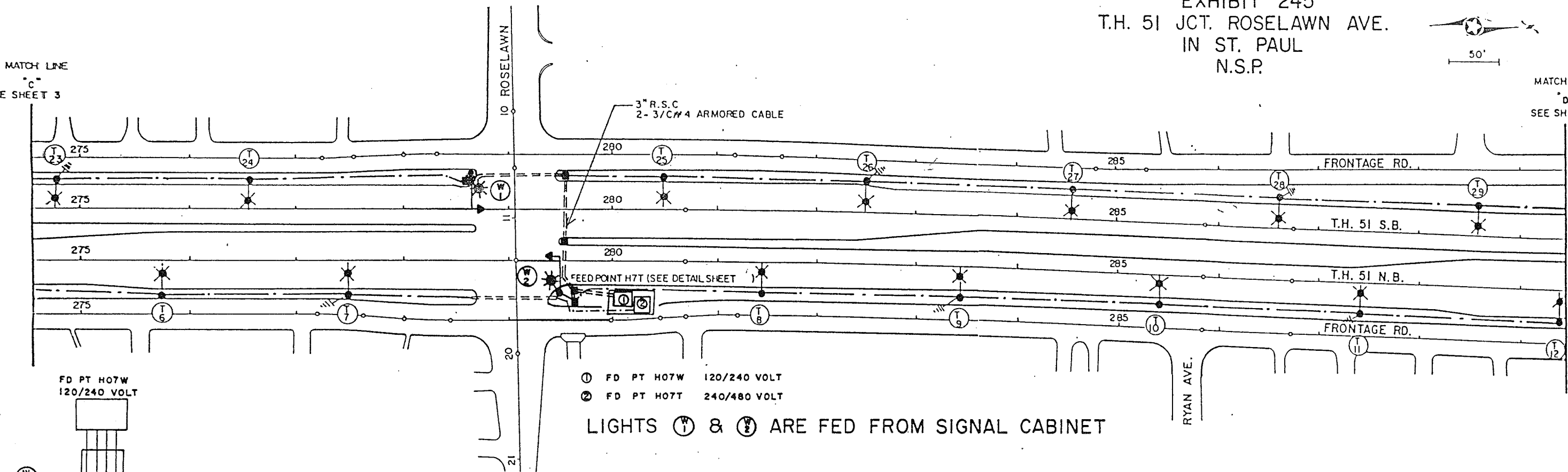

FEED POINT H7T

LIGHTING STANDARDS AND BASES

NO.	STATION	LT.	RT.	LOCATION	TYPE	NO.	STATION	LT.	RT.	LOCATION	TYPE
1	N.B. 266+30	-	-	T.H. 51	9-40	19	S.B. 267+50	-	-	T.H. 51	9-40
2	N.B. 268+30	-	-			20	S.B. 269+30	-	-		
3	N.B. 270+25	-	-			21	S.B. 271+10	-	-		
4	N.B. 272+20	-	-			22	S.B. 272+90	-	-		
5	N.B. 274+00	-	-			23	S.B. 274+75	-	-		
6	N.B. 275+75	-	-			24	S.B. 276+55	-	-		
7	N.B. 277+50	-	-			25	S.B. 280+50	-	-		
8	N.B. 281+45	-	-			26	S.B. 282+50	-	-		
9	N.B. 283+45	-	-			27	S.B. 284+55	-	-		
10	N.B. 285+40	-	-			28	S.B. 286+60	-	-		
11	N.B. 287+40	-	-			29	S.B. 288+60	-	-		
12	N.B. 289+40	-	-			30	S.B. 290+55	-	-		
13	N.B. 291+40	-	-			31	S.B. 292+55	-	-		
14	N.B. 293+40	-	-			32	S.B. 296+55	-	-		
15	N.B. 297+30	-	-			33	S.B. 298+55	-	-		
16	N.B. 299+30	-	-			34	S.B. 300+65	-	-		
17	N.B. 301+30	-	-			35	S.B. 302+65	-	-	T.H. 51	9-40
18	N.B. 303+20	-	-	T.H. 51	9-40						

ALL LUMINAIRES SHALL BE 200 WATT HIGH PRESSURE SODIUM.

SHEET TOTAL
16-200 WATT HIGH PRESSURE SODIUM LIGHTING UNITS

FEED POINT H07W

LIGHTING STANDARDS AND BASES

NO.	STATION	LT.	RT.	LOCATION	TYPE
1	S.W. CORNER	-	-	ON SIGNAL POLE	D40-9
2	N.E. CORNER	-	-		

FEEDPOINT H7T & H7W

STREET LIGHTING

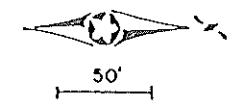

SHEET TOTAL
9-200 WATT HIGH PRESSURE SODIUM LIGHTING UNITS

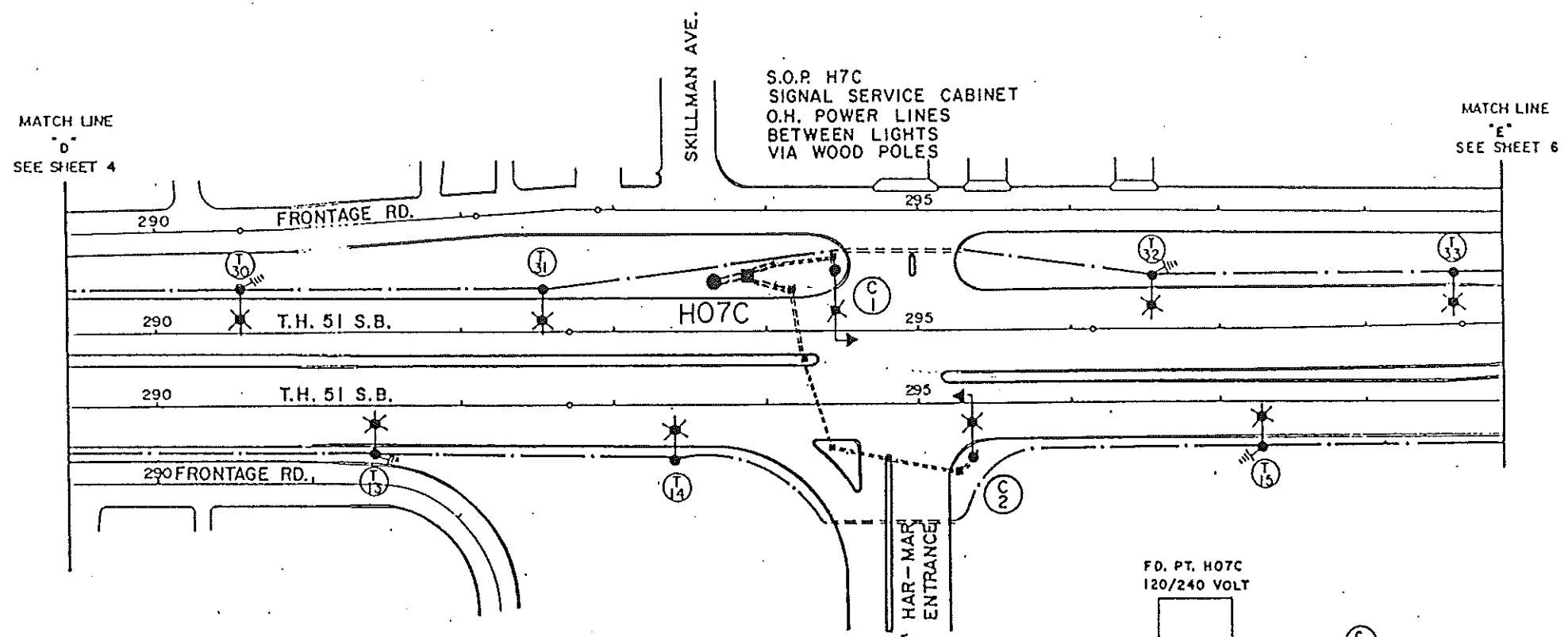

⌘ LIGHT MOUNTED ON SIGNAL POLE

FEED POINT H7C
LIGHTING STANDARDS AND BASES

NO.	STATION	LT.	RT.	LOCATION	TYPE
1	S.W. CORNER	—	—	ON SIGNAL POLE	D40-9
2	N.E. CORNER	—	—	↓	↓

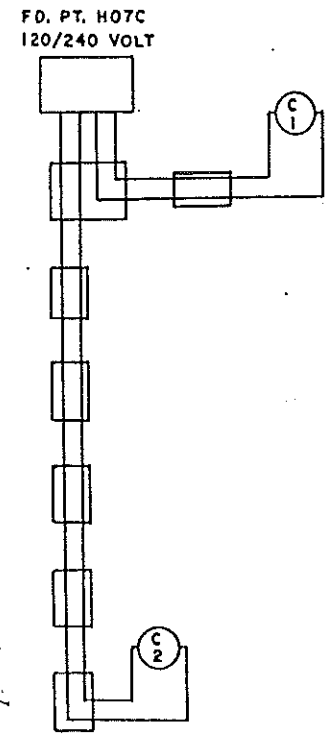
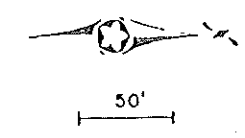

EXHIBIT 245
T.H. 51 AT HAR-MAR ENT.
IN ST. PAUL
N.S.P.

FEEDPOINT H7T, H7C
STREET LIGHTING



SHEET TOTAL
9-200 WATT HIGH PRESSURE SODIUM LIGHTING UNITS

GRAND TOTAL
70-200 WATT HIGH PRESSURE SODIUM LIGHTING UNITS

FEED POINT H7R

LIGHTING STANDARDS & BASES					
NO.	STATION	LT.	RT.	LOCATION	TYPE
1	S.W. CORNER	—	—	ON SIGNAL POLE	D40-9
2	N.W. CORNER	—	—		
3	N.E. CORNER	—	—		
4	S.E. CORNER	—	—		

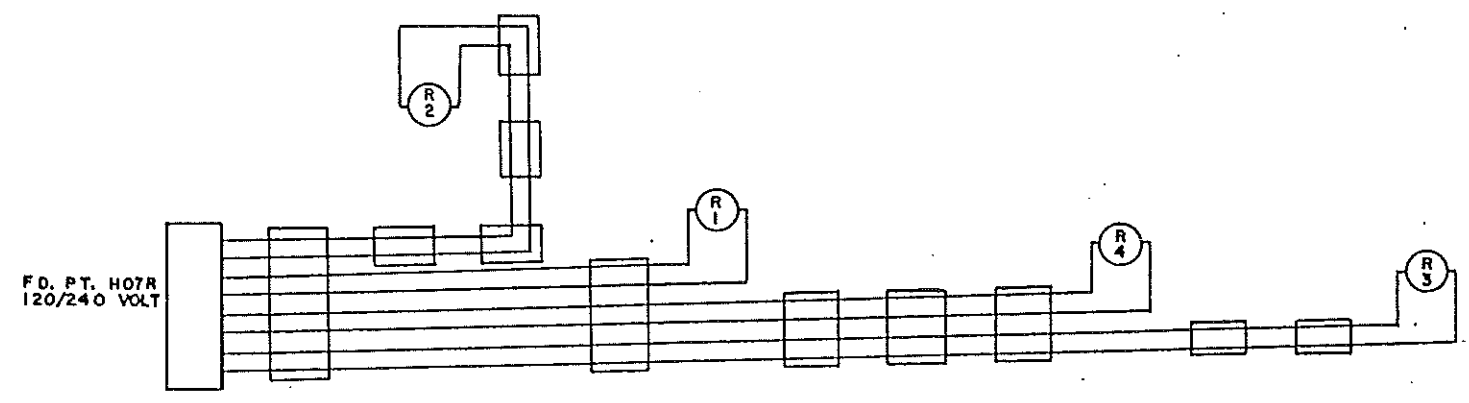
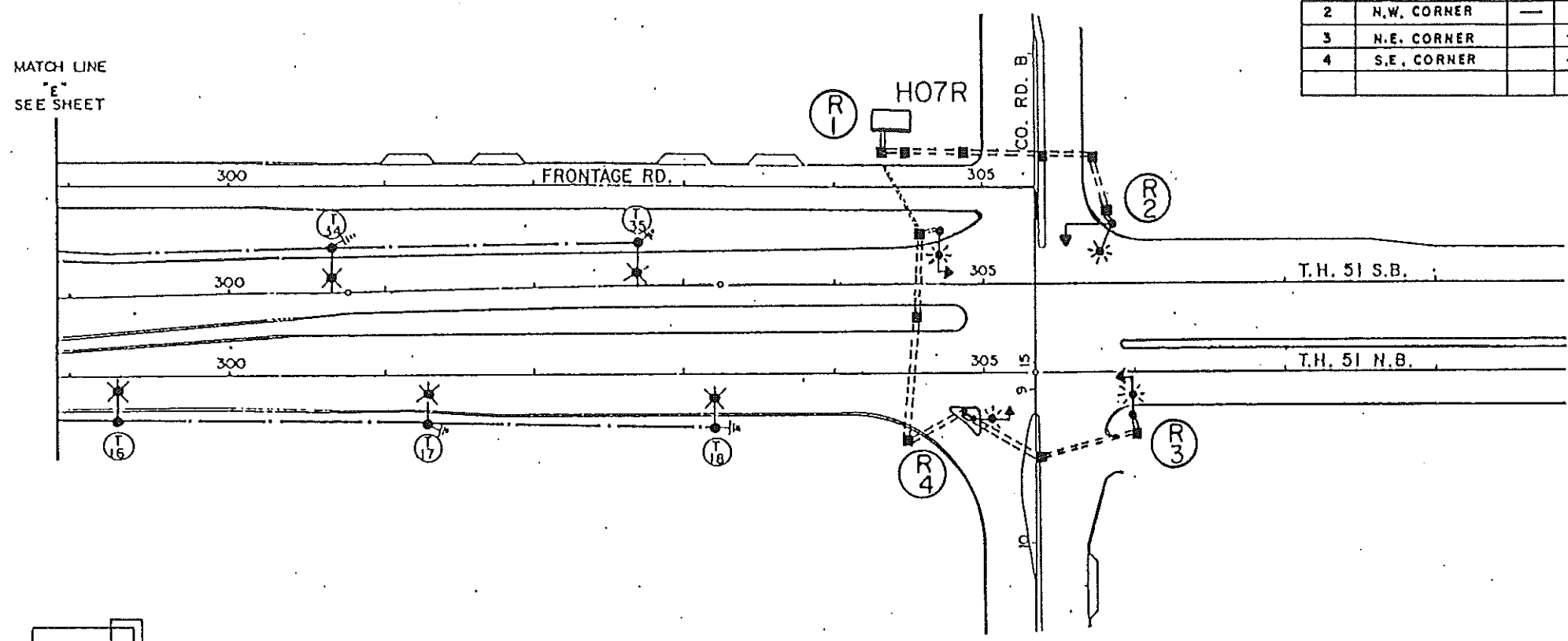

EXHIBIT 245
T.H. 51 JCT. CO. RD. B
IN ST. PAUL
N.S.P.

FEEDPOINT H7T & H7R

STREET LIGHTING

PLOTTED/REVISED: \$\$\$DATE\$\$\$

FEEDPOINT H7T

LIGHTING STANDARDS AND BASES					
NO.	STATION	LT.	RT.	LOCATION	TYPE
8	INPLACE	-	-	T.H. 51 N.B.	9-40
(1) 9	283+45	-	-		9B-40
(1) 10	285+45	-	-		
(1) 11	287+45	-	-		
(1) 12	289+45	-	-		
(1) 13	291+45	-	-		9B-40
(2) 14	293+45	-	-		9-40
(2) 15	296+90	-	-		
(2) 16	298+50	-	-		
(2) 17	301+00	-	-		
(2) 18	303+50	-	-	T.H. 51 N.B.	9-40

- (1) ANCHORAGE IN RETAINING WALL
- (2) INSTALL SALVAGED LIGHT STANDARD, F. & I. 250W HPS LUMINAIRE AND LIGHT BASE DESIGN E

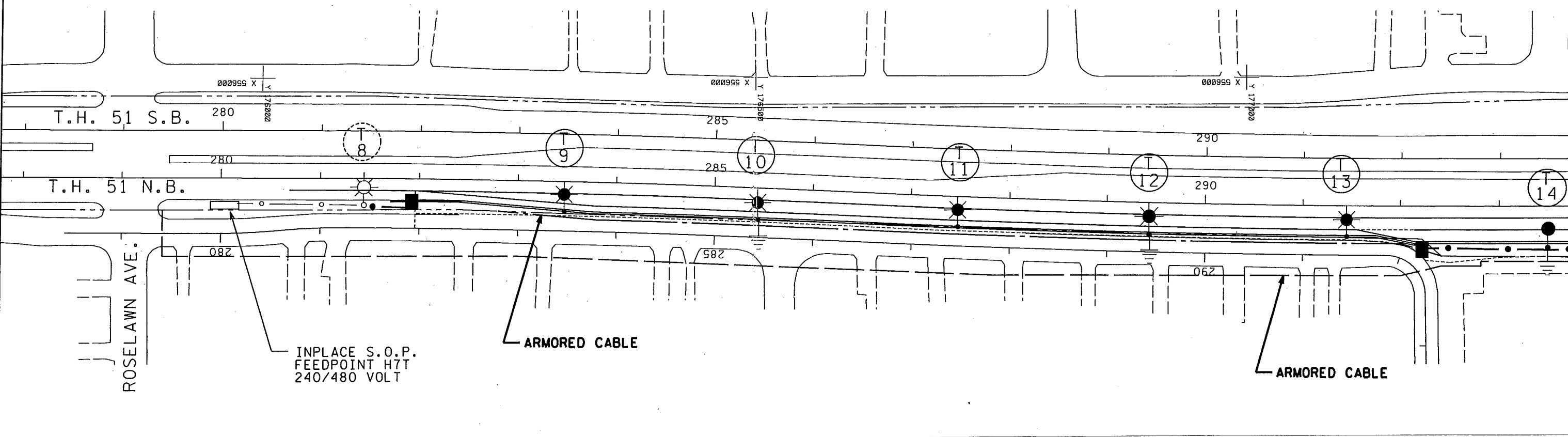
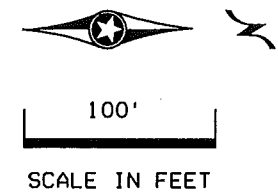

LEGEND

- INPLACE STREET LIGHT
- INSTALL SALVAGED LIGHT STANDARD, AND F. & I. LUMINAIRE AND LIGHT BASE DESIGN E
- F. & I. LIGHTING UNIT 6B-40
- F. & I. HANDHOLE
- INPLACE S.O.P.
- F. & I. 4/C # 4 ARMORED CABLE
- INPLACE ARMORED CABLE
- INPLACE 3" R.S.C.
- F. & I. 3" NON-METALLIC CONDUIT (DIRECTIONAL BORE)
- PERMANENT GROUND ROD (25 OHMS OR LESS)

B AND R DENOTE CURRENT CARRYING CONDUCTORS
W DENOTES NEUTRAL CONDUCTOR

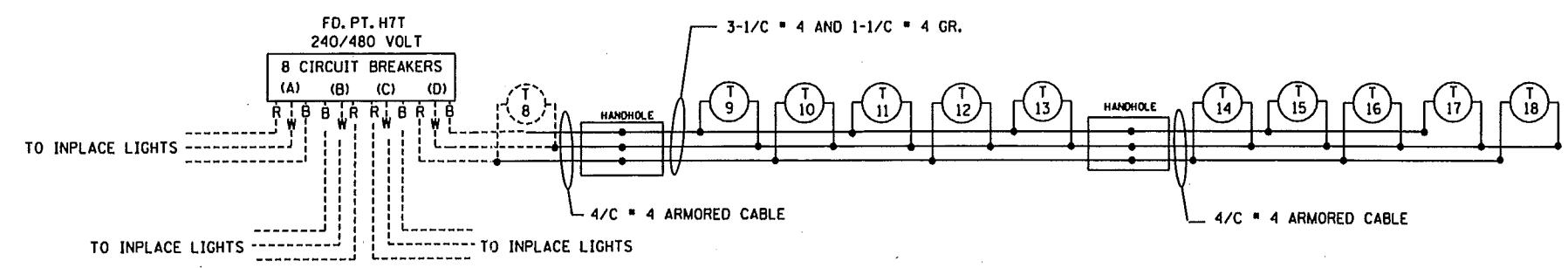

DASHED LINES INDICATE INPLACE ITEMS

AS-BUILT PLAN INFORMATION IS FURNISHED WITHOUT WARRANTY AS TO ACCURACY OR FITNESS FOR ANY PURPOSE. USERS SHOULD VERIFY LOCATIONS AND ELEVATIONS.

LAYOUT

LIGHTING PLAN

DRAWN BY: GB

CHECKED BY: NS

CERTIFIED BY

Michael P. Lubinsky
LICENSED PROFESSIONAL ENGINEER

LIC. NO. 19863

DATE \$\$\$DATE\$\$\$

STATE PROJ. NO. 6216-116 (T.H. 51) SHEET NO. 79 OF 130 SHEETS

DISTRICT #: \$\$\$DISTRICT\$\$\$
PLOT NAME: \$\$\$PLOTNAME\$\$\$
PATH & FILENAME: \$\$\$PATHFILENAME\$\$\$

SEE LEGEND ON SHEET NO. 79

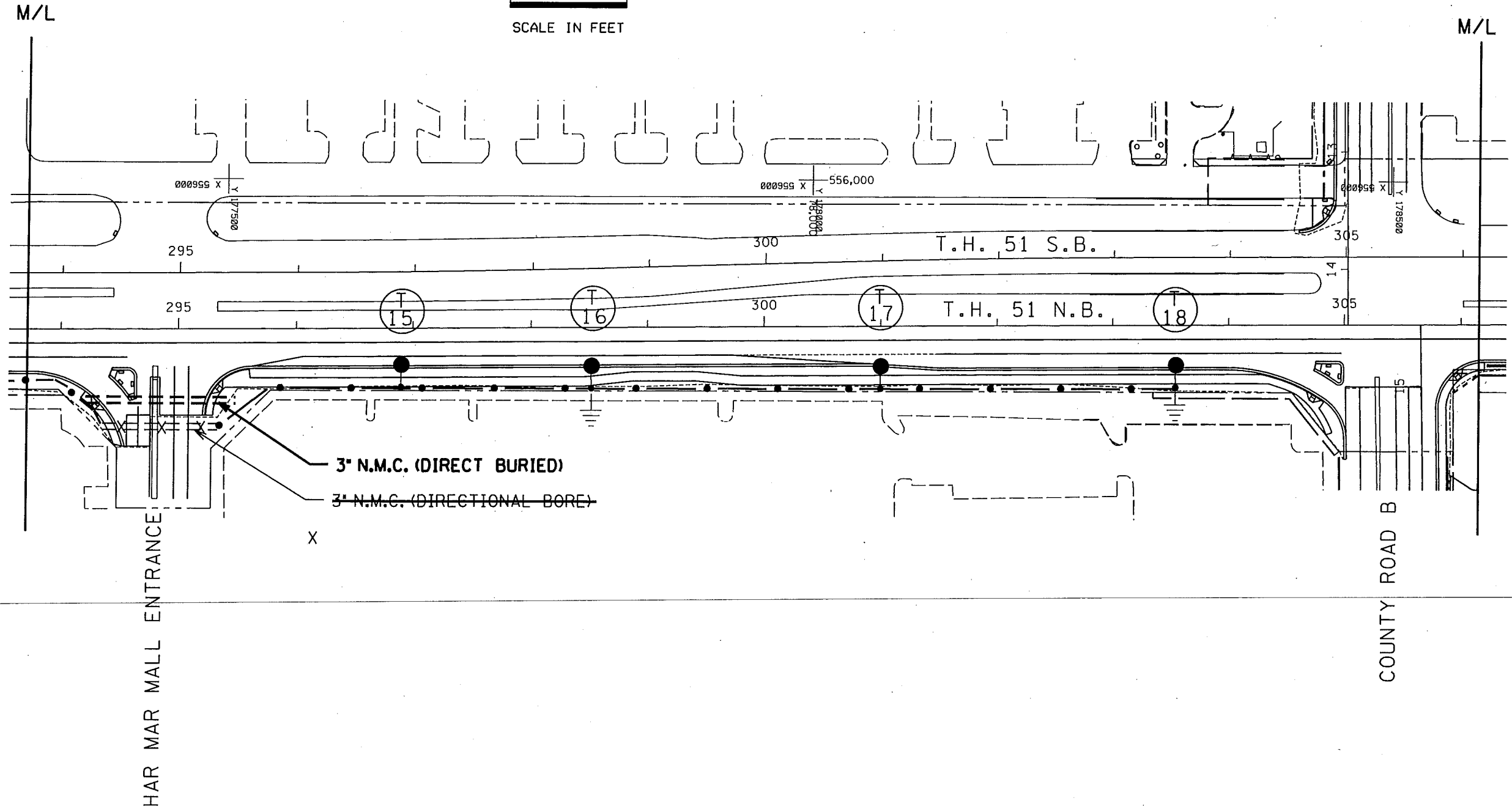
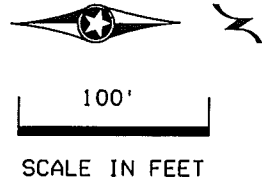

PLOTTED/REVISED: \$\$\$DATE\$\$\$

DISTRICT: \$DISTRICT\$
PLOT NAME: \$PLOTNAME\$
PATH & FILENAME: \$PATHFILENAME\$

AS-BUILT PLAN INFORMATION IS FURNISHED WITHOUT WARRANTY AS TO ACCURACY OR FITNESS FOR ANY PURPOSE. USERS SHOULD VERIFY LOCATIONS AND ELEVATIONS.

LAYOUT

LIGHTING PLAN

DRAWN BY: GB

CHECKED BY: NS

CERTIFIED BY

Michael P. Lubinsky
LICENSED PROFESSIONAL ENGINEER

LIC. NO. 19863

DATE \$DATE\$

STATE PROJ. NO. 6216-116 (T.H. 51)

SHEET NO. 80 OF 130 SHEETS