

MATCHLINE STA. NB TH 169 162+18.92  
SEE SHEET NO. #LL08

PAD MOUNTED SOURCE OF POWER  
SERVICE CABINET SECONDARY TYPE L1  
FEED POINT F6J, (METERED) 240/480 VOLT  
EQUIPMENT PAD B.  
2" NMC AND 3-1/2" #2 TO XCEL ENERGY  
CONTACT: DAN C. MAURER  
PH: 763-493-1854

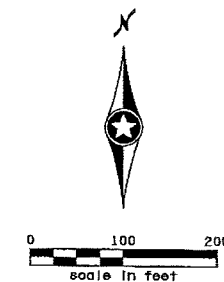

MATCHLINE STA. EB TH 610 1278+29.04  
SEE SHEET NO. 37LL05

MATCHLINE STA. EB TH 610 1308+62.73  
SEE SHEET NO. 37LL10

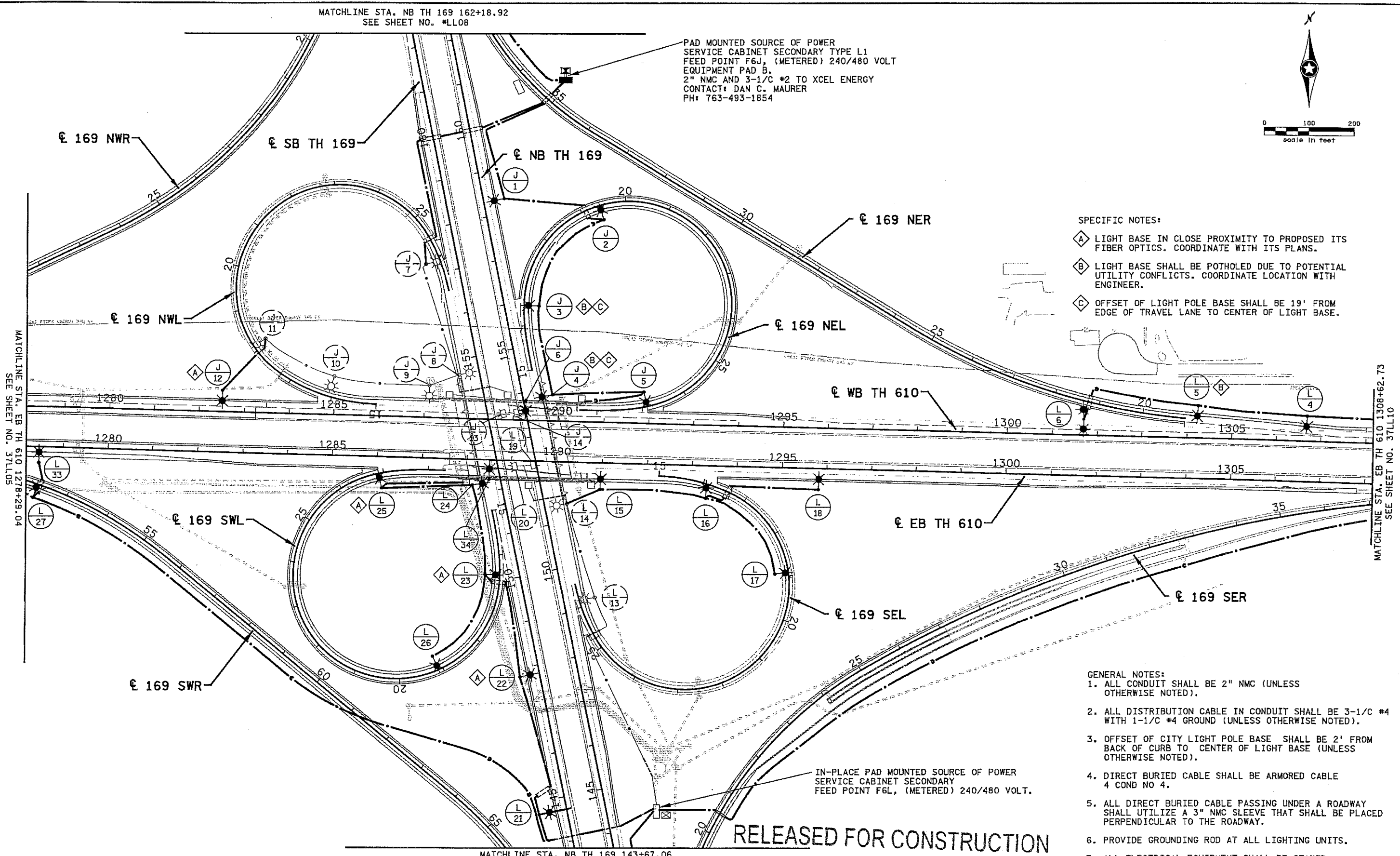

- SPECIFIC NOTES:**
- ⬢ LIGHT BASE IN CLOSE PROXIMITY TO PROPOSED ITS FIBER OPTICS. COORDINATE WITH ITS PLANS.
  - ⬢ LIGHT BASE SHALL BE POTHOLED DUE TO POTENTIAL UTILITY CONFLICTS. COORDINATE LOCATION WITH ENGINEER.
  - ⬢ OFFSET OF LIGHT POLE BASE SHALL BE 19' FROM EDGE OF TRAVEL LANE TO CENTER OF LIGHT BASE.

- GENERAL NOTES:**
1. ALL CONDUIT SHALL BE 2" NMC (UNLESS OTHERWISE NOTED).
  2. ALL DISTRIBUTION CABLE IN CONDUIT SHALL BE 3-1/2" #4 WITH 1-1/2" #4 GROUND (UNLESS OTHERWISE NOTED).
  3. OFFSET OF CITY LIGHT POLE BASE SHALL BE 2' FROM BACK OF CURB TO CENTER OF LIGHT BASE (UNLESS OTHERWISE NOTED).
  4. DIRECT BURIED CABLE SHALL BE ARMORED CABLE 4 COND NO 4.
  5. ALL DIRECT BURIED CABLE PASSING UNDER A ROADWAY SHALL UTILIZE A 3" NMC SLEEVE THAT SHALL BE PLACED PERPENDICULAR TO THE ROADWAY.
  6. PROVIDE GROUNDING ROD AT ALL LIGHTING UNITS.
  7. ALL ELECTRICAL EQUIPMENT SHALL BE STAKED AND VERIFIED BY FIELD ENGINEER.

IN-PLACE PAD MOUNTED SOURCE OF POWER  
SERVICE CABINET SECONDARY  
FEED POINT F6L, (METERED) 240/480 VOLT.

**RELEASED FOR CONSTRUCTION**

MATCHLINE STA. NB TH 169 143+67.06  
SEE SHEET NO. #LL09

11:58:48 AM  
6/15/2010  
...lan\dp\_37\CD27138\_1106.dgn

NO	DATE	BY	CHKD	APPR

I hereby certify that this plan, specification, or report was prepared by me or under my direct supervision and that I am a duly Licensed Professional Engineer under the laws of the State of Minnesota.  
Print Name: **Brian D. Holt**  
Date: **6/15/10** License #: **21428**

MN/DOT RELEASED FOR CONSTRUCTION  
Date: **6/22/10** MN/DOT



**T.H. 610 DESIGN BUILD (SP 2771-38)**  
LIGHTING LAYOUT  
T.H. 610  
DESIGN PACKAGE #37

**SHEET**  
37LL06  
OF  
37LL15

11:56:50 AM  
 6/15/10  
 P:\proj\act\6919\h1-m\ad\plan\dp\_37\CD277138\_1107.dgn

FEED POINT J					
NO.	STATION	L	R	LOCATION	LIGHT TYPE
1	158+32		X	NB TH 169	TYPE 9-40
2	19+42		X	169 NEL	TYPE 9-40
3	16+44		X	169 NEL	TYPE 9-40
4	153+82		X	NB TH 169	TYPE 9-40
5	26+89		X	169 NEL	TYPE 9-40
6	NA	X		SEE STRUCTURAL PLAN	TYPE 6B-40
7	EXISTING	X		SB TH 169	TYPE 9-40
8	EXISTING	X		SB TH 169	TYPE 9-40
9	EXISTING	X		WB TH 610	TYPE 9-40
10	EXISTING		X	169 NWL	TYPE 9-40
11	EXISTING		X	169 NWL	TYPE 9-40
12	1282+50	X		WB TH 610	TYPE 9-40
13	EXISTING		X	UNDERPASS LIGHTING	
14	EXISTING	X		UNDERPASS LIGHTING	

FEED POINT L					
NO.	STATION	L	R	LOCATION	LIGHT TYPE
4	1306+69	X		WB TH 610	TYPE 9-40
5	1304+23	X		WB TH 610	TYPE 9-40
6	1301+69	X		WB TH 610	TYPE 9D-40
13	EXISTING		X	169 SEL	TYPE 9-40
14	EXISTING		X	NB TH 169	TYPE 9-40
15	1290+97		X	EB TH 610	TYPE 9-40
16	16+15		X	169 SEL	TYPE 9-40
17	18+92		X	169 SEL	TYPE 9-40
18	1295+82		X	EB TH 610	TYPE 9-40
19	EXISTING	X		UNDERPASS LIGHTING	
20	EXISTING	X		UNDERPASS LIGHTING	
21	66+15		X	169 SWR	TYPE 9-40
22	147+81	X		SB TH 169	TYPE 9-40
23	16+44		X	169 SWL	TYPE 9-40
24	152+22	X		SB TH 169	TYPE 9-40
25	26+89		X	169 SWL	TYPE 9-40
26	19+11		X	169 SWL	TYPE 9-40
27	52+30		X	169 SWR	TYPE 9-40
33	1278+47		X	EB TH 610	TYPE 9-40
34	NA		X	SEE STRUCTURAL PLAN	TYPE 6B-40

RELEASED FOR CONSTRUCTION

NO	DATE	BY	CKD	APPR

I hereby certify that this plan, specification, or report was prepared by me or under my direct supervision and that I am a duly Licensed Professional Engineer under the laws of the State of Minnesota.  
 Print Name: BRIAN D. HOLT  
*Brian D. Holt*  
 Date: 6/15/10 License #: 21428

*T. H. 610*  
*6/22/10*



T.H. 610 DESIGN BUILD (SP 2771-38)  
 LIGHTING LAYOUT  
 T.H. 610  
 DESIGN PACKAGE #37

SHEET  
 37LL07  
 OF  
 37LL15

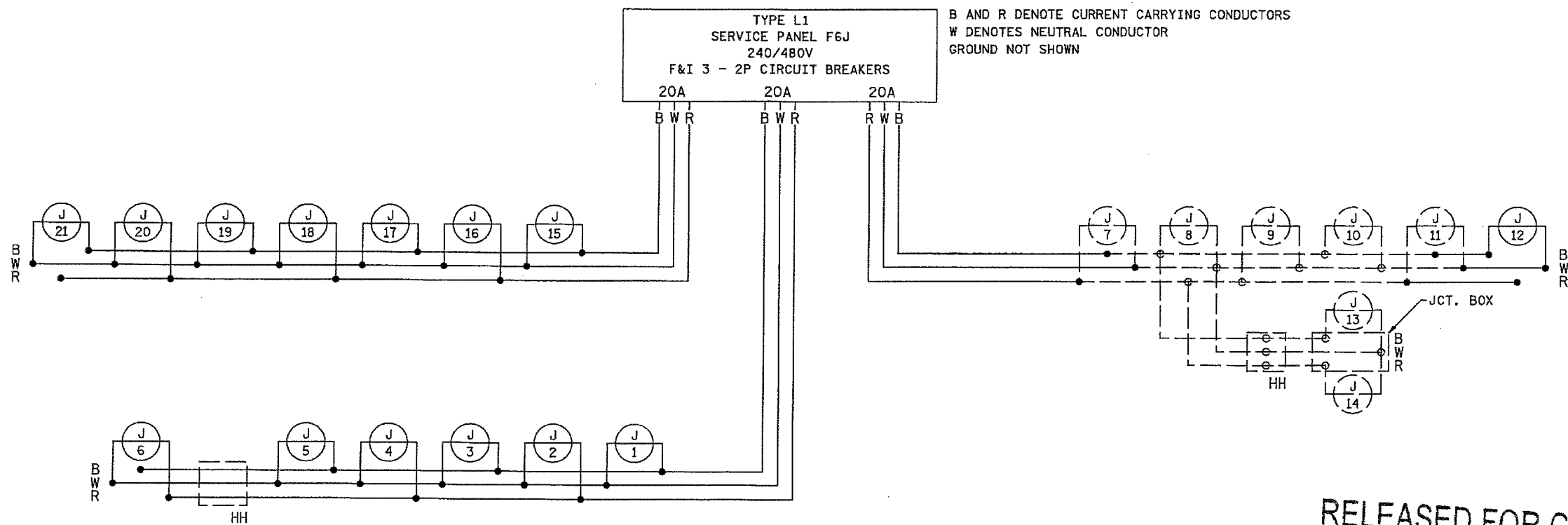

B AND R DENOTE CURRENT CARRYING CONDUCTORS  
 W DENOTES NEUTRAL CONDUCTOR  
 GROUND NOT SHOWN

RELEASED FOR CONSTRUCTION

LEGEND	
PROPOSED LUMINAIRE	
EXISTING LUMINAIRE (UNLESS OTHERWISE NOTED)	
PROPOSED HANDHOLE	
EXISTING HANDHOLE (OR F & I BY STRUCTURAL)	
PROPOSED CIRCUITRY	
EXISTING CIRCUITRY	
PROPOSED SPLICE	
EXISTING SPLICE	

11:55:00 AM  
 6/15/10  
 H:\projects\6919\1-m\p\d\m\dp\_37\CD277138\_1114.dgn

NO	DATE	BY	CKD	APPR

I hereby certify that this plan, specification, or report was prepared by me or under my direct supervision and that I am a duly Licensed Professional Engineer under the laws of the State of Minnesota.

Print Name: **BRIAN D. HOLT**  
*Brian D. Holt*  
 Date: 6/15/10 License #: 21428

MN/DOT RELEASED FOR CONSTRUCTION

*[Signature]*  
 Date: 6/22/10 MN/DOT



T.H. 610 DESIGN BUILD (SP 2771-38)

WIRING DIAGRAM  
 T.H. 610  
 DESIGN PACKAGE #37

SHEET  
 37LL14  
 OF  
 37LL15