

DATE: 1/16/2018 TIME: 11:08:33 AM  
 FILENAME: K:\g-m\mndot\6553000\04\_Production\01\_CAD\Highway\Sheets\cd02\447\_1\lhdgn

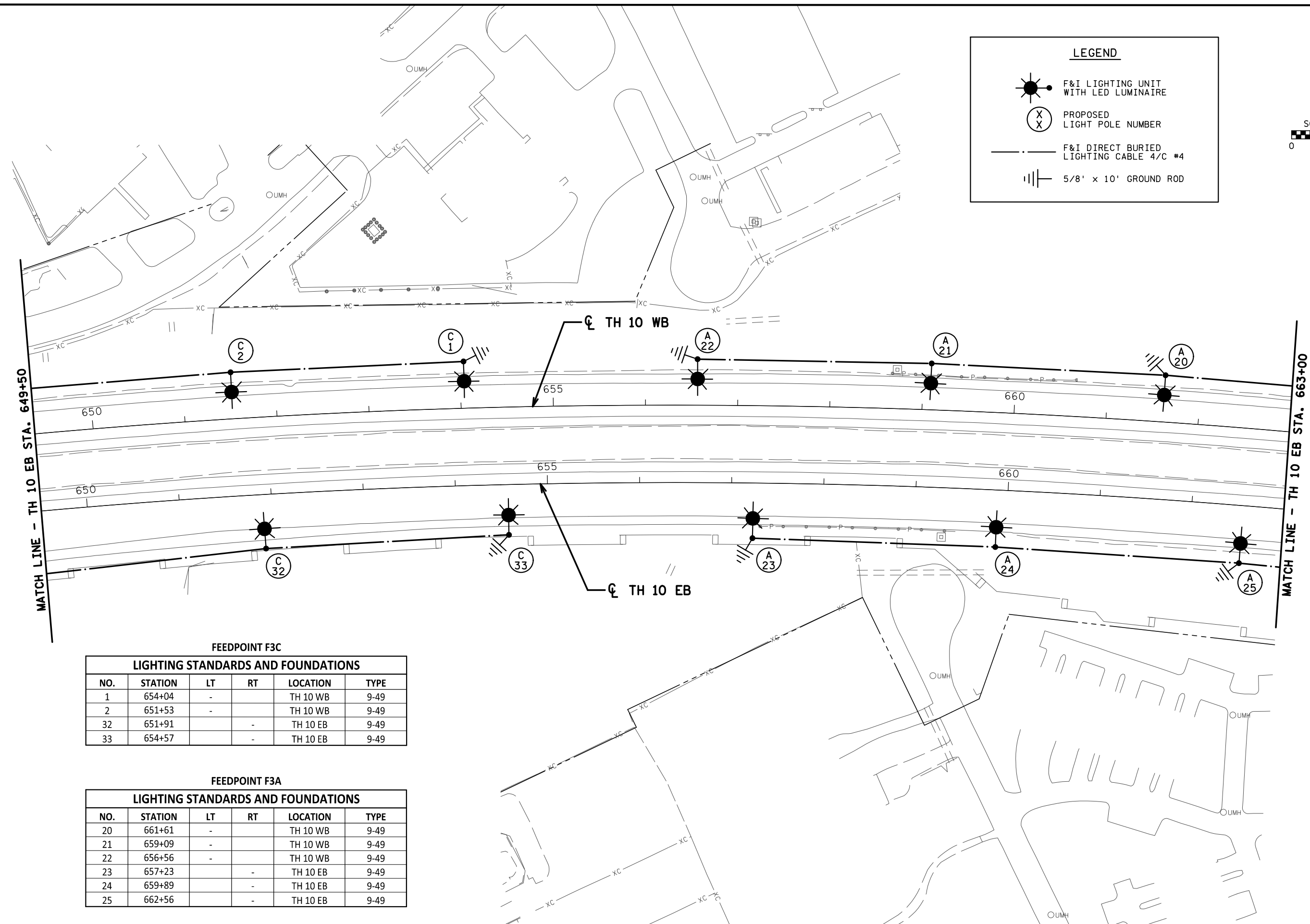

**FEEDPOINT F3C**

LIGHTING STANDARDS AND FOUNDATIONS					
NO.	STATION	LT	RT	LOCATION	TYPE
1	654+04	-		TH 10 WB	9-49
2	651+53	-		TH 10 WB	9-49
32	651+91		-	TH 10 EB	9-49
33	654+57		-	TH 10 EB	9-49

**FEEDPOINT F3A**

LIGHTING STANDARDS AND FOUNDATIONS					
NO.	STATION	LT	RT	LOCATION	TYPE
20	661+61	-		TH 10 WB	9-49
21	659+09	-		TH 10 WB	9-49
22	656+56	-		TH 10 WB	9-49
23	657+23		-	TH 10 EB	9-49
24	659+89		-	TH 10 EB	9-49
25	662+56		-	TH 10 EB	9-49

DRAWN BY: JSB  
 CHECKED BY: CJL

I HEREBY CERTIFY THAT THIS SHEET WAS PREPARED BY ME OR UNDER MY DIRECT SUPERVISION AND THAT I AM A DULY LICENSED PROFESSIONAL ENGINEER UNDER THE LAWS OF THE STATE OF MINNESOTA.





SIGNATURE: *Christopher J. Leiter*  
 PRINTED NAME: CHRISTOPHER J. LEITER  
 DATE: 1/16/2018 LIC. NO. 47889



**LIGHTING PLAN**  
 TH 10 EB STA. 649+50 TO STA. 663+00

STATE PROJ. NO. 0214-47 (TH 10)  
 Sheet No. 30 of 53 Sheets

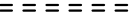
**LEGEND**

-  F&I LIGHTING UNIT WITH LED LUMINAIRE
-  PROPOSED LIGHT POLE NUMBER
-  F&I DIRECT BURIED LIGHTING CABLE 4/C #4
-  F&I CONDUIT
-  5/8' x 10' GROUND ROD

**FEEDPOINT F3A**

**LIGHTING STANDARDS AND FOUNDATIONS**

NO.	STATION	LT	RT	LOCATION	TYPE
15	674+23	-		TH 10 WB	9-49
16	671+71	-		TH 10 WB	9-49
17	669+18	-		TH 10 WB	9-49
18	666+66	-		TH 10 WB	9-49
19	664+14	-		TH 10 WB	9-49
26	665+21		-	TH 10 EB	9-49
27	667+88		-	TH 10 EB	9-49
28	670+40		-	TH 10 EB	9-49
29	672+91		-	TH 10 EB	9-49
30	674+47		-	TH 10 EB	9-49
*61	12+19		-	RAMP D	9-40
*62	14+60		-	RAMP D	9-40

\* INSTALL SALVAGED LUMINAIRE

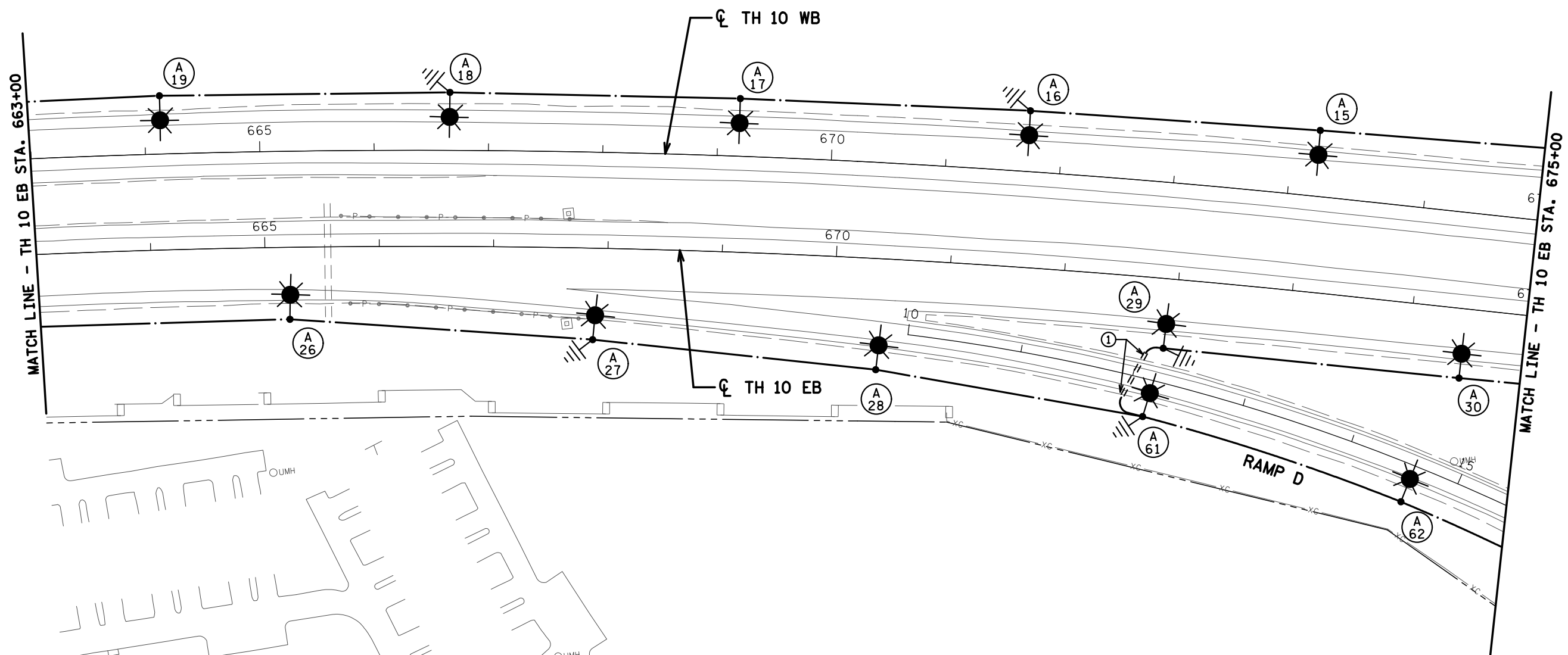
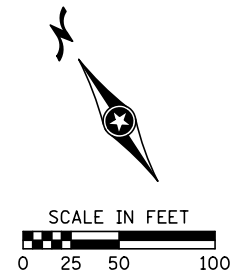

**SPECIFIC NOTES:**

- ① DIRECTIONAL BORE 3" NON-METALLIC CONDUIT UNDER ROADWAY.

DATE: 1/16/2018 TIME: 11:08:34 AM  
FILENAME: K:\g-m\mndot\6553000\04\_Production\01\_CAD\Highway\Sheets\cd02\447\_11t.dgn

DRAWN BY: JSB  
CHECKED BY: CJL

I HEREBY CERTIFY THAT THIS SHEET WAS PREPARED BY ME OR UNDER MY DIRECT SUPERVISION AND THAT I AM A DULY LICENSED PROFESSIONAL ENGINEER UNDER THE LAWS OF THE STATE OF MINNESOTA.

SIGNATURE: *Christopher J. Leiter*  
PRINTED NAME: CHRISTOPHER J. LEITER  
DATE: 1/16/2018 LIC. NO. 47889



**LIGHTING PLAN**  
TH 10 EB STA. 663+00 TO STA. 675+00

STATE PROJ. NO. 0214-47 (TH 10)  
Sheet No. 31 of 53 Sheets

**LEGEND**

- INPLACE TYPE L LIGHTING UNIT
- F&I TYPE L LIGHTING UNIT
- INPLACE LIGHT POLE NUMBER
- PROPOSED LIGHT POLE NUMBER
- 5/8" x 10' GROUND ROD
- F&I LIGHTING UNIT WITH LED LUMINAIRE
- F&I DIRECT BURIED LIGHTING CABLE 4/C #4
- F&I CONDUIT
- F&I PAD MOUNTED SERVICE CABINET
- F&I HANDHOLE

**FEEDPOINT F3A**

LIGHTING STANDARDS AND FOUNDATIONS					
NO.	STATION	LT	RT	LOCATION	TYPE
9	688+09	-		TH 10 WB	9-49
10	685+59	-		TH 10 WB	9-49
11	683+09	-		TH 10 WB	9-49
12	INPLACE	-		TH 10 WB	L
13	678+08	-		TH 10 WB	9-49
14	675+58	-		TH 10 WB	9-49

**FEEDPOINT F3A**

LIGHTING STANDARDS AND FOUNDATIONS					
NO.	STATION	LT	RT	LOCATION	TYPE
31	677+07		-	TH 10 EB	9-49
32	679+67		-	TH 10 EB	9-49
33	680+95		-	TH 10 EB	L
34	682+00		-	TH 10 EB	9-49
35	684+65		-	TH 10 EB	9-49
36	687+30		-	TH 10 EB	9-49

- SPECIFIC NOTES:**
- DIRECTIONAL BORE 3" NON-METALLIC CONDUIT UNDER ROADWAY.
  - DIRECTIONAL BORE (2) 3" NON-METALLIC CONDUIT UNDER ROADWAY.

AIRPORT RD. (93RD LANE)

FD. PT. 3A  
PAD MOUNTED SERVICE CABINET  
SECONDARY TYPE L1  
240/480 VOLT (METERED)  
EQUIPMENT PAD TYPE B REQUIRED.  
UTILIZE INPLACE UTILITY FEED  
POWER BY CONNEXUS ENERGY.

NE LOOP

RAMP C

**FEEDPOINT F3A**

LIGHTING STANDARDS AND FOUNDATIONS					
NO.	STATION	LT	RT	LOCATION	TYPE
*48	20+50	-		RAMP C	9-40
*49	18+32	-		RAMP C	9-40
*50	16+00	-		RAMP C	9-40
*51	13+77	-		RAMP C	9-40
*52	11+53	-		RAMP C	9-40
*53	24+22		-	AIRPORT RD NB	9-40
*54	23+10		-	AIRPORT RD SB	9-40

\* INSTALL SALVAGED LUMINAIRE

**FEEDPOINT F3A**

LIGHTING STANDARDS AND FOUNDATIONS					
NO.	STATION	LT	RT	LOCATION	TYPE
*55	12+66		-	NE LOOP	9-40
*56	14+89		-	NE LOOP	9-40
*57	17+01		-	NE LOOP	9-40
*58	19+28		-	NE LOOP	9-40
*59	21+50		-	NE LOOP	9-40
60	23+46		-	NE LOOP	9-49

\* INSTALL SALVAGED LUMINAIRE

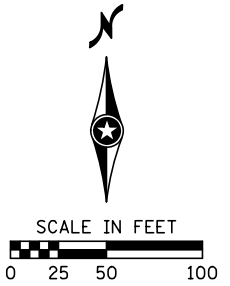

MATCH LINE - TH 10 EB STA. 675+00

MATCH LINE - TH 10 EB STA. 689+00

MATCH LINE B

BRIDGE NO. 02047

DRAWN BY: JSB  
CHECKED BY: CJL

I HEREBY CERTIFY THAT THIS SHEET WAS PREPARED BY ME OR UNDER MY DIRECT SUPERVISION AND THAT I AM A DULY LICENSED PROFESSIONAL ENGINEER UNDER THE LAWS OF THE STATE OF MINNESOTA.

SIGNATURE: *Christopher J. Leiter*  
PRINTED NAME: CHRISTOPHER J. LEITER  
DATE: 1/16/2018 LIC. NO. 47889



**LIGHTING PLAN**  
TH 10 EB STA. 675+00 TO STA. 689+00

STATE PROJ. NO. 0214-47 (TH 10)  
Sheet No. 32 of 53 Sheets

DATE: 1/16/2018 TIME: 11:08:35 AM  
FILENAME: K:\g-m\mndot\6553000\04\_Production\01\_CAD\Highway\Sheets\c021447\_11.dgn

DATE: 1/16/2018 TIME: 11:08:36 AM  
 FILENAME: K:\g-m\mndot\6553000\04\_Production\01\_CAD\Highway\Sheet\c021447\_11k.dgn

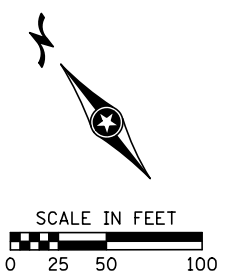
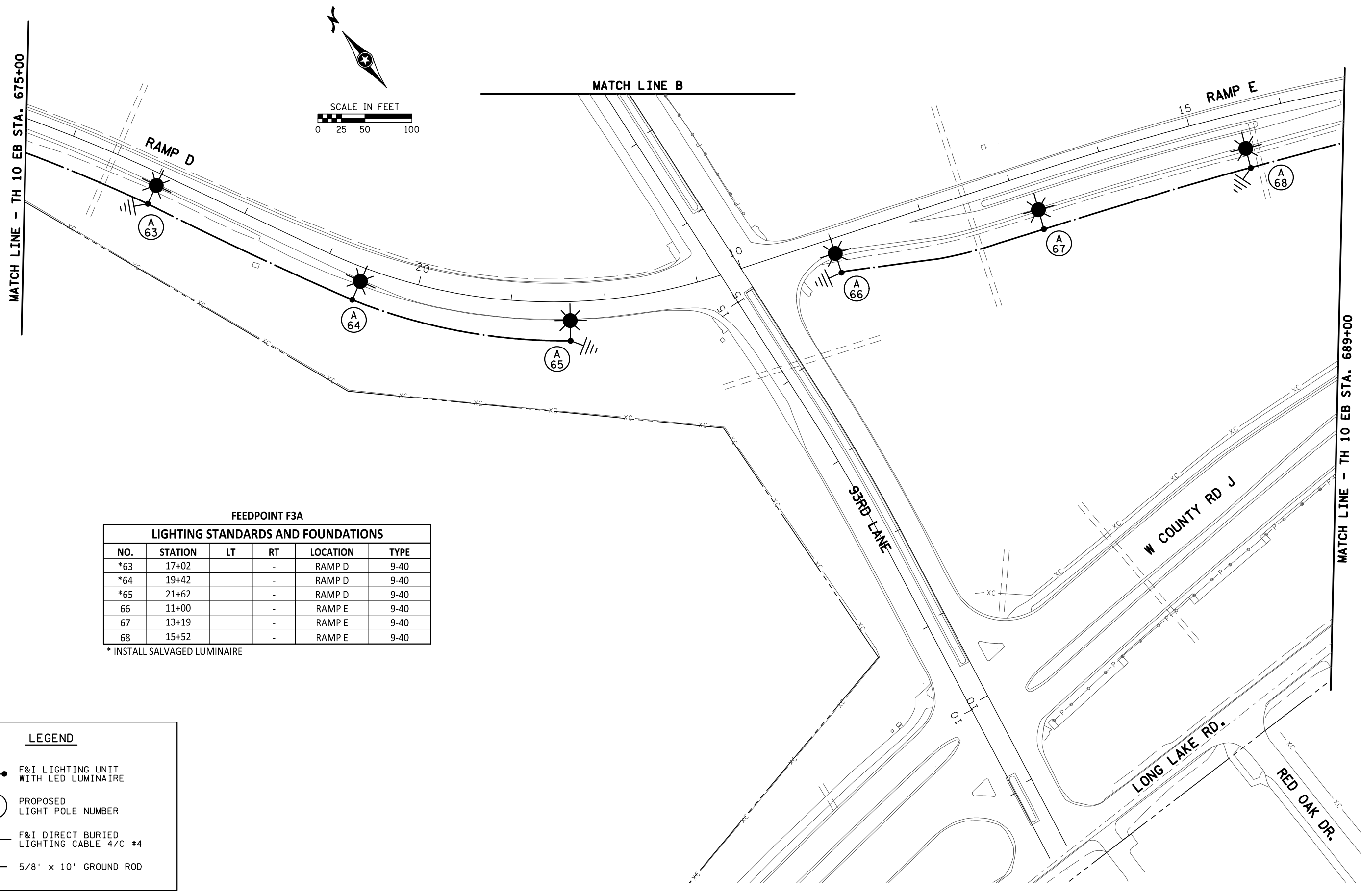

**FEEDPOINT F3A**

LIGHTING STANDARDS AND FOUNDATIONS					
NO.	STATION	LT	RT	LOCATION	TYPE
*63	17+02		-	RAMP D	9-40
*64	19+42		-	RAMP D	9-40
*65	21+62		-	RAMP D	9-40
66	11+00		-	RAMP E	9-40
67	13+19		-	RAMP E	9-40
68	15+52		-	RAMP E	9-40

\* INSTALL SALVAGED LUMINAIRE

**LEGEND**

- F&I LIGHTING UNIT WITH LED LUMINAIRE
- PROPOSED LIGHT POLE NUMBER
- F&I DIRECT BURIED LIGHTING CABLE 4/C #4
- 5/8' x 10' GROUND ROD

DRAWN BY: JSB  
 CHECKED BY: CJL

I HEREBY CERTIFY THAT THIS SHEET WAS PREPARED BY ME OR UNDER MY DIRECT SUPERVISION AND THAT I AM A DULY LICENSED PROFESSIONAL ENGINEER UNDER THE LAWS OF THE STATE OF MINNESOTA.

SIGNATURE: *Christopher J. Leiter*  
 PRINTED NAME: CHRISTOPHER J. LEITER  
 DATE: 1/16/2018 LIC. NO. 47889



**LIGHTING PLAN**  
 TH 10 EB STA. 675+00 TO STA. 689+00

STATE PROJ. NO. 0214-47 (TH 10)  
 Sheet No. 33 of 53 Sheets

DATE: 1/16/2018 TIME: 11:08:37 AM  
 FILENAME: K:\g-m\mndot\6553000\04\_Production\01\_CAD\Highway\Sheets\cd02\447\_11.dgn

**SPECIFIC NOTES:**

① DIRECTIONAL BORE 3" NON-METALLIC CONDUIT UNDER ROADWAY.

**FEEDPOINT F3A**

LIGHTING STANDARDS AND FOUNDATIONS					
NO.	STATION	LT	RT	LOCATION	TYPE
3	701+10	-	-	TH 10 WB	9-49
4	698+54	-	-	TH 10 WB	9-49
5	INPLACE	-	-	TH 10 WB	L
6	695+65	-	-	TH 10 WB	9-49
7	693+08	-	-	TH 10 WB	9-49
8	690+59	-	-	TH 10 WB	9-49
37	689+95	-	-	TH 10 EB	9-49
38	692+53	-	-	TH 10 EB	9-49
39	INPLACE	-	-	TH 10 EB	L
40	695+87	-	-	TH 10 EB	9-49
41	698+48	-	-	TH 10 EB	9-49
42	701+09	-	-	TH 10 EB	9-49
45	27+40	-	-	RAMP C	9-40
46	25+00	-	-	RAMP C	9-40
47	22+75	-	-	RAMP C	9-40
69	18+03	-	-	RAMP E	9-40

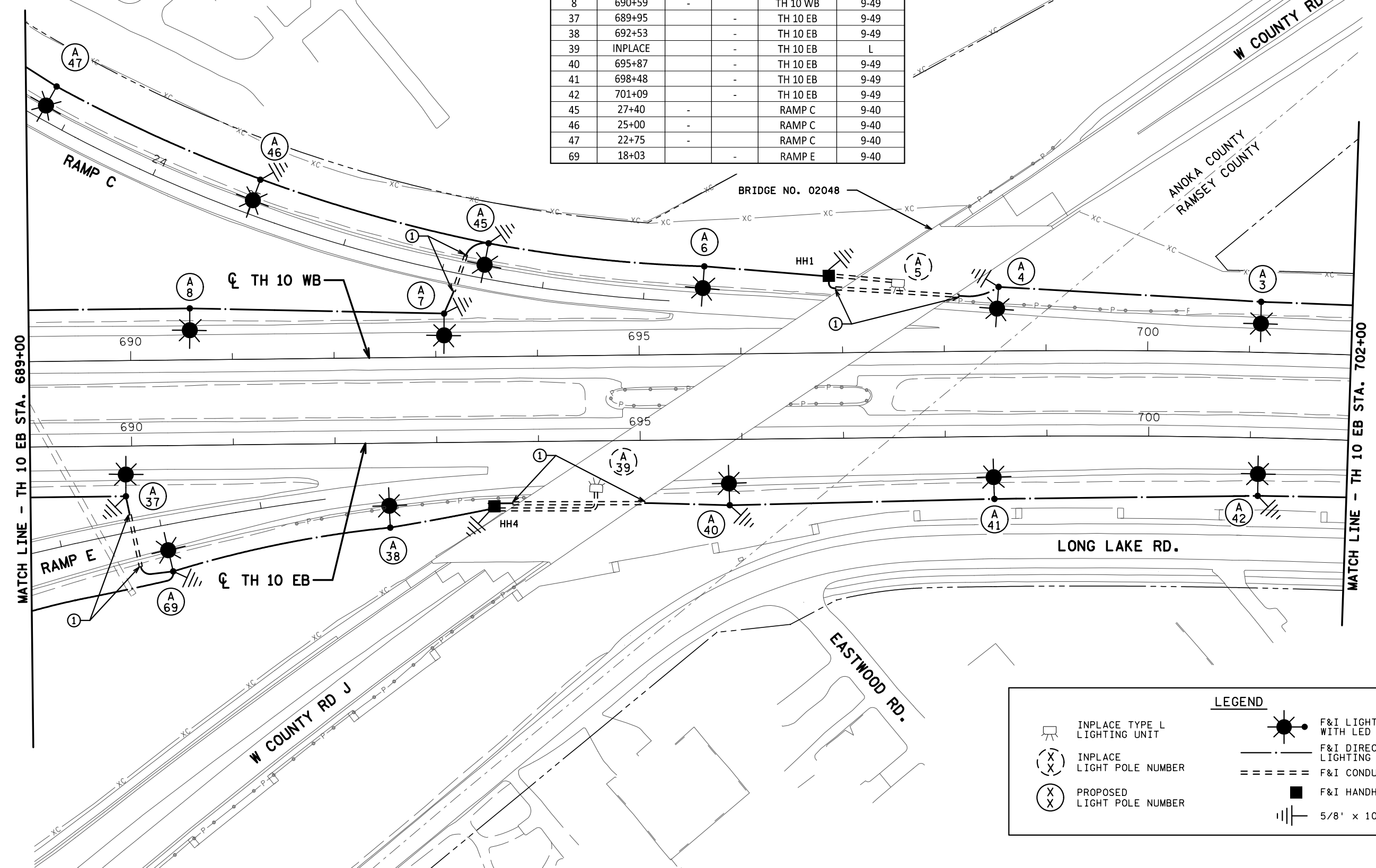
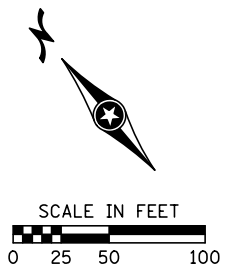

**LEGEND**

	INPLACE TYPE L LIGHTING UNIT		F&I LIGHTING UNIT WITH LED LUMINAIRE
	INPLACE LIGHT POLE NUMBER		F&I DIRECT BURIED LIGHTING CABLE 4/C #4
	PROPOSED LIGHT POLE NUMBER		F&I CONDUIT
			F&I HANDHOLE
			5/8' x 10' GROUND ROD

DRAWN BY: JSB  
 CHECKED BY: CJL

I HEREBY CERTIFY THAT THIS SHEET WAS PREPARED BY ME OR UNDER MY DIRECT SUPERVISION AND THAT I AM A DULY LICENSED PROFESSIONAL ENGINEER UNDER THE LAWS OF THE STATE OF MINNESOTA.

SIGNATURE: *Christopher J. Leiter*  
 PRINTED NAME: CHRISTOPHER J. LEITER  
 DATE: 1/16/2018 LIC. NO. 47889



**LIGHTING PLAN**  
 TH 10 EB STA. 689+00 TO STA. 702+00



STATE PROJ. NO. 0214-47 (TH 10)  
 Sheet No. 34 of 53 Sheets

DATE: 1/16/2018 TIME: 11:08:38 AM  
 FILENAME: K:\g-m\mndot\6553000\04\_Production\01\_CAD\Highway\Sheet\cd021447\_11m.dgn

FEEDPOINT F3A

LIGHTING STANDARDS AND FOUNDATIONS					
NO.	STATION	LT	RT	LOCATION	TYPE
A1	706+28	-		TH 10 WB	9-49
A2	703+69	-		TH 10 WB	9-49
A43	703+69		-	TH 10 EB	9-49
A44	706+30		-	TH 10 EB	9-49

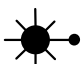
**LEGEND**

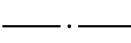
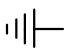
-  F&I LIGHTING UNIT WITH LED LUMINAIRE
-  PROPOSED LIGHT POLE NUMBER
-  F&I DIRECT BURIED LIGHTING CABLE 4/C #4
-  5/8' x 10' GROUND ROD



SCALE IN FEET  
 0 25 50 100

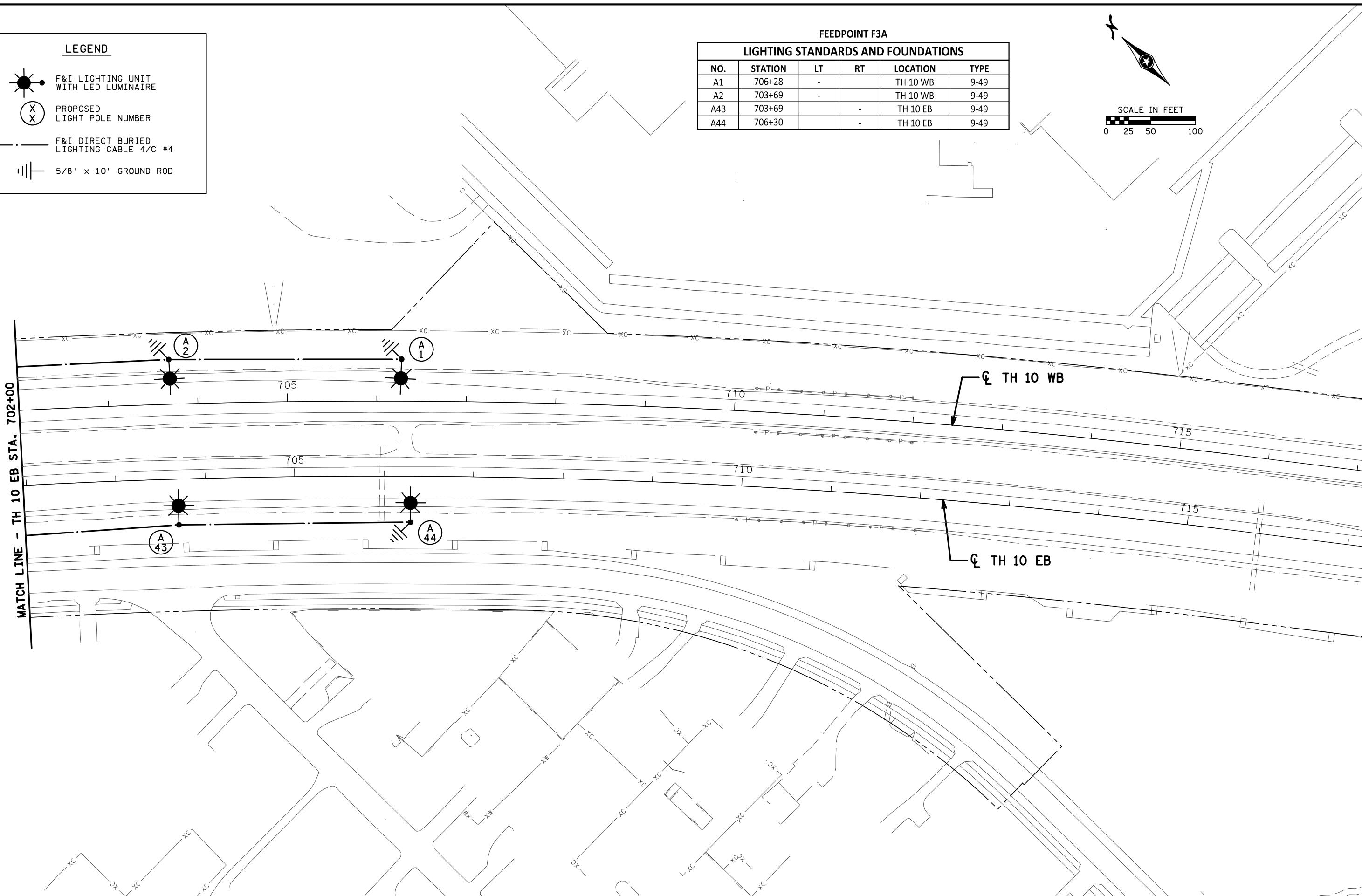

DRAWN BY: JSB  
 CHECKED BY: CJL

I HEREBY CERTIFY THAT THIS SHEET WAS PREPARED BY ME OR UNDER MY DIRECT SUPERVISION AND THAT I AM A DULY LICENSED PROFESSIONAL ENGINEER UNDER THE LAWS OF THE STATE OF MINNESOTA.

SIGNATURE: *Christopher J. Leiter*  
 PRINTED NAME: CHRISTOPHER J. LEITER  
 DATE: 1/16/2018 LIC. NO. 47889



LIGHTING PLAN  
 TH 10 EB STA. 702+00 TO STA. 717+17

STATE PROJ. NO. 0214-47 (TH 10)  
 Sheet No. 35 of 53 Sheets

DATE: 1/16/2018 TIME: 11:08:39 AM  
 FILENAME: K:\g-m\mndot\6533000\04\_Production\01\_CAD\Highway\Sheets\cd021447\_1.in.dgn

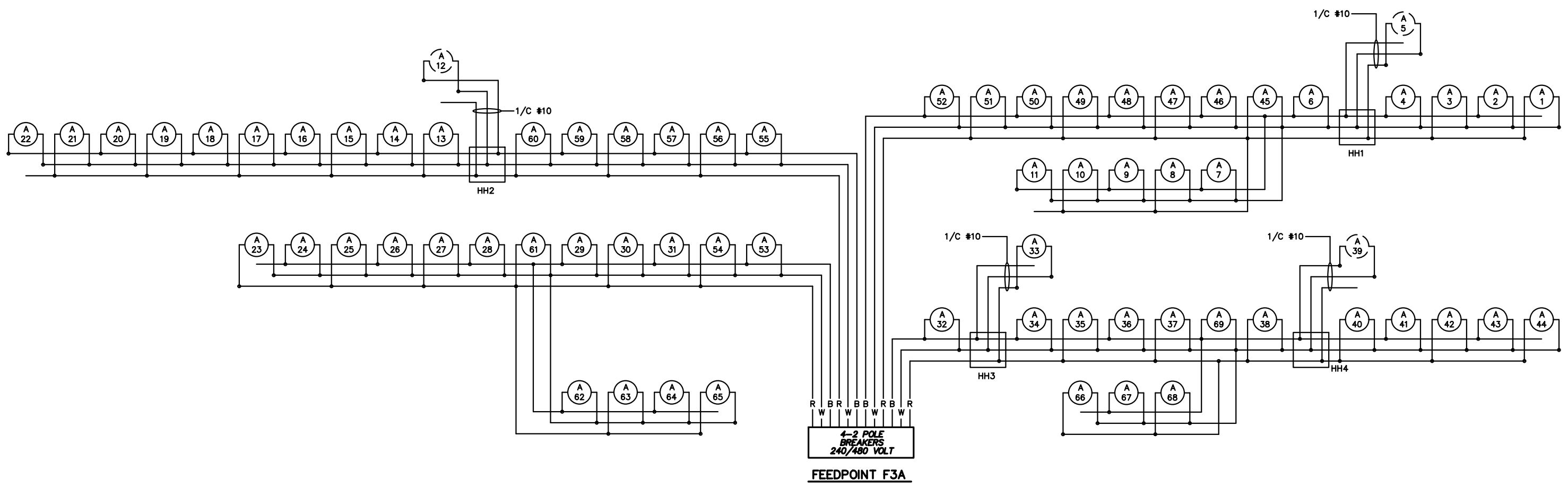

B AND R DENOTE CURRENT CARRYING CONDUCTORS  
 W DENOTES NEUTRAL CONDUCTOR  
 GROUND NOT SHOWN FOR CLARITY  
 DASHED LINES INDICATE INPLACE ITEMS TO REMAIN

DRAWN BY: LKG  
 CHECKED BY: CJL

I HEREBY CERTIFY THAT THIS SHEET WAS PREPARED BY ME OR UNDER MY DIRECT SUPERVISION AND THAT I AM A DULY LICENSED PROFESSIONAL ENGINEER UNDER THE LAWS OF THE STATE OF MINNESOTA.

SIGNATURE: *Christopher J. Leiter*  
 PRINTED NAME: CHRISTOPHER J. LEITER  
 DATE: 1/16/2018 LIC. NO. 47889



WIRING DIAGRAM  
 FEEDPOINT F3A

STATE PROJ. NO. 0214-47 (TH 10)  
 Sheet No. 36 of 53 Sheets