

FEEDPOINT F2E
LIGHTING STANDARDS AND BASES

NO.	STATION	LT.	RT.	LOCATION	TYPE	WATTAGE
1	AS SHOWN			WB CSAH 10	9-40	250
2	AS SHOWN			WB CSAH 10	9-40	250
3	AS SHOWN			WB CSAH 10	9-40	250
4	AS SHOWN			EB CSAH 10	9-40	250
5	AS SHOWN			EB CSAH 10	9-40	250
6	AS SHOWN			SW RAMP	9-40	250
7	AS SHOWN			EB CSAH 10	9-40	250
8	AS SHOWN			EB CSAH 10	9-40	250
9	AS SHOWN			EB CSAH 10	6B-40	250
10	AS SHOWN			EB CSAH 10	9-40	250
11	AS SHOWN			SE LOOP	9-40	250
12	AS SHOWN			EB CSAH 10	9-40	250
13	AS SHOWN			SB TH65	9-40	250
14	AS SHOWN			SB TH65	9-40	250
15	AS SHOWN			SB TH65	9-40	250
16	AS SHOWN			NB TH65	9-40	250
17	AS SHOWN			NB TH65	9-40	250
18	AS SHOWN			SE RAMP	9-40	250
19	AS SHOWN			NB TH65	9-40	250
20	AS SHOWN			NB TH65	9-40	250
21	AS SHOWN			SB TH65	9-40	250
22	AS SHOWN			SB TH65	9-40	250
23	AS SHOWN			SW LOOP	9-40	250
24	AS SHOWN			SB TH65	9-40	250

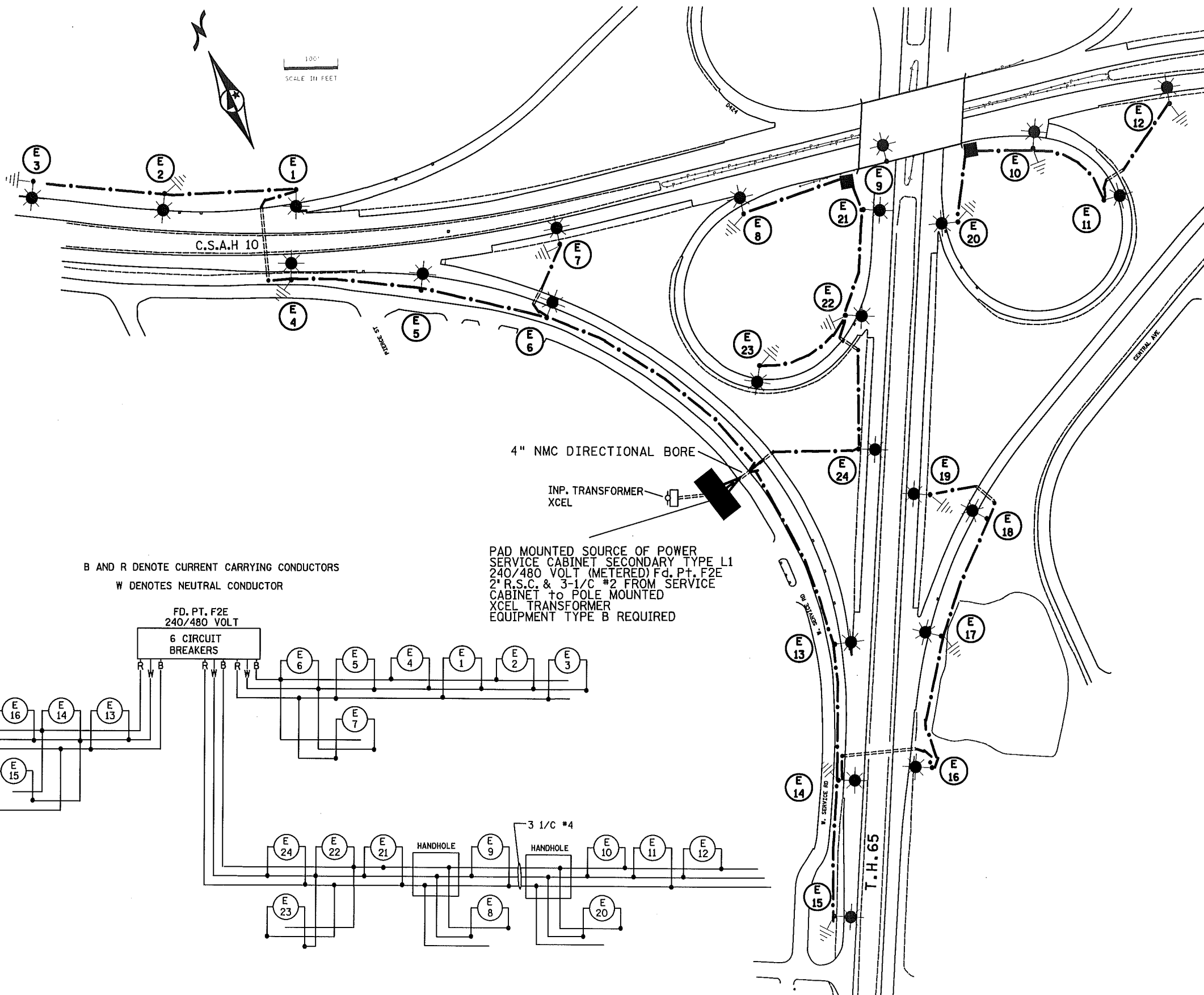

B AND R DENOTE CURRENT CARRYING CONDUCTORS
W DENOTES NEUTRAL CONDUCTOR

PAD MOUNTED SOURCE OF POWER
SERVICE CABINET SECONDARY TYPE L1
240/480 VOLT (METERED) Fd. Pt. F2E
2" R.S.C. & 3-1/2" #2 FROM SERVICE
CABINET TO POLE MOUNTED
XCEL TRANSFORMER
EQUIPMENT TYPE B REQUIRED

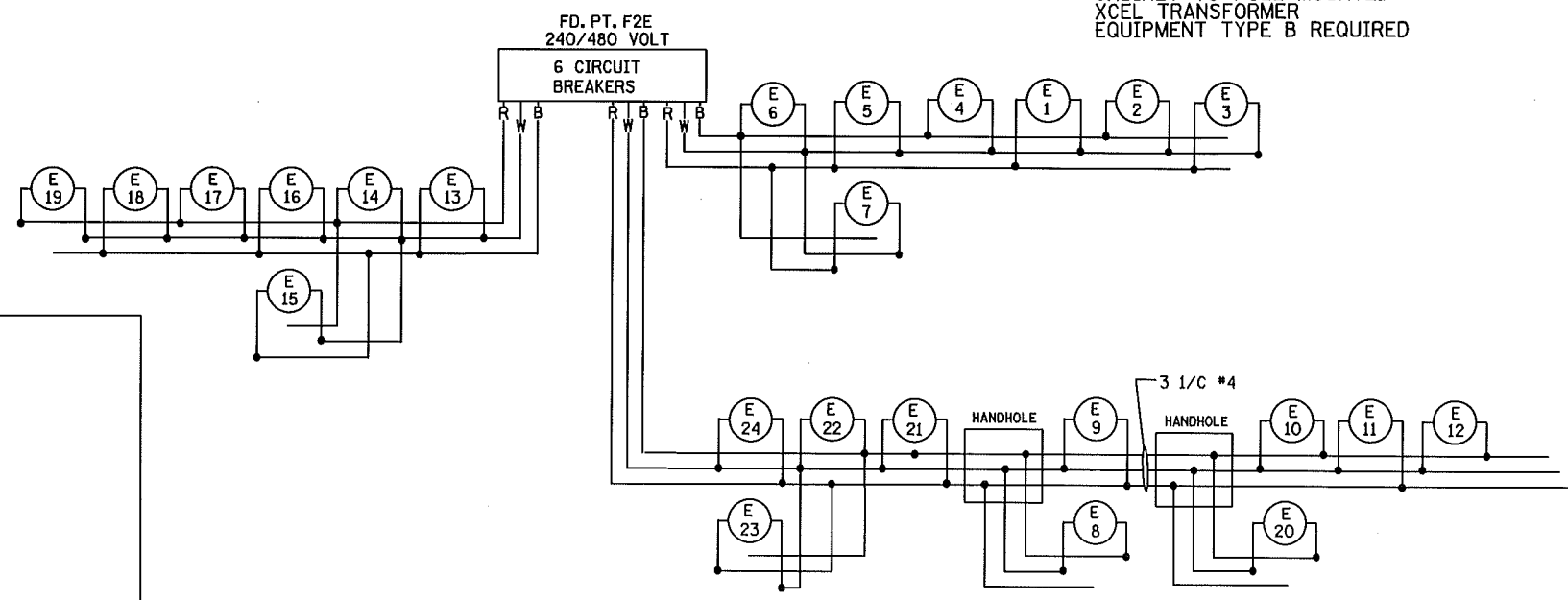

LEGEND

- HIGH PRESSURE SODIUM LIGHTING UNIT
- UNDERPASS FIXTURE
- PAD MOUNTED SOURCE OF POWER
240/480 VOLT
- ARMORED CABLE 4 CONDUCTOR NO. 4
- 3" NON-METALLIC CONDUIT (DIRECTIONAL BORE)
UNLESS NOTED OTHERWISE
- PERMANENT GROUND ROD (25 OHMS OR LESS)
- HANDHOLE

FEEDPOINT F2E
LIGHTING PLAN

BY: PB	DATE: 6-10-09	AS - BUILT	SYSTEM ID: 5388 FEEDPOINT: F2E	T.E. LOCATION: C.S.A.H. 10	STATE PROJ. NO. 0207-88 (T.H. 65)
REVISIONS			METER ADDRESS: 8500 MIDDLETOWN RD. SPRING LAKE PARK, 55432	CERTIFIED BY: <i>Michael P. Gelinsky</i>	SHEET NO. 8 OF 9 SHEETS
DRAWN BY: PB CKD BY: GB DATE:			LIC. NO. 19863	DATE: 11/25/2008	

DISTRICT #: METRO
 PLOT NAME: 0207-88.lalab
 PATH & FILENAME: IP_PWP-00971060\0207-88.lalab.dgn
 PLOTTED/REVISED: 12/4/2012