

SEE SHEET 1670 FOR LEGEND

MATCH LINE G - SEE SHEET NO. 1676

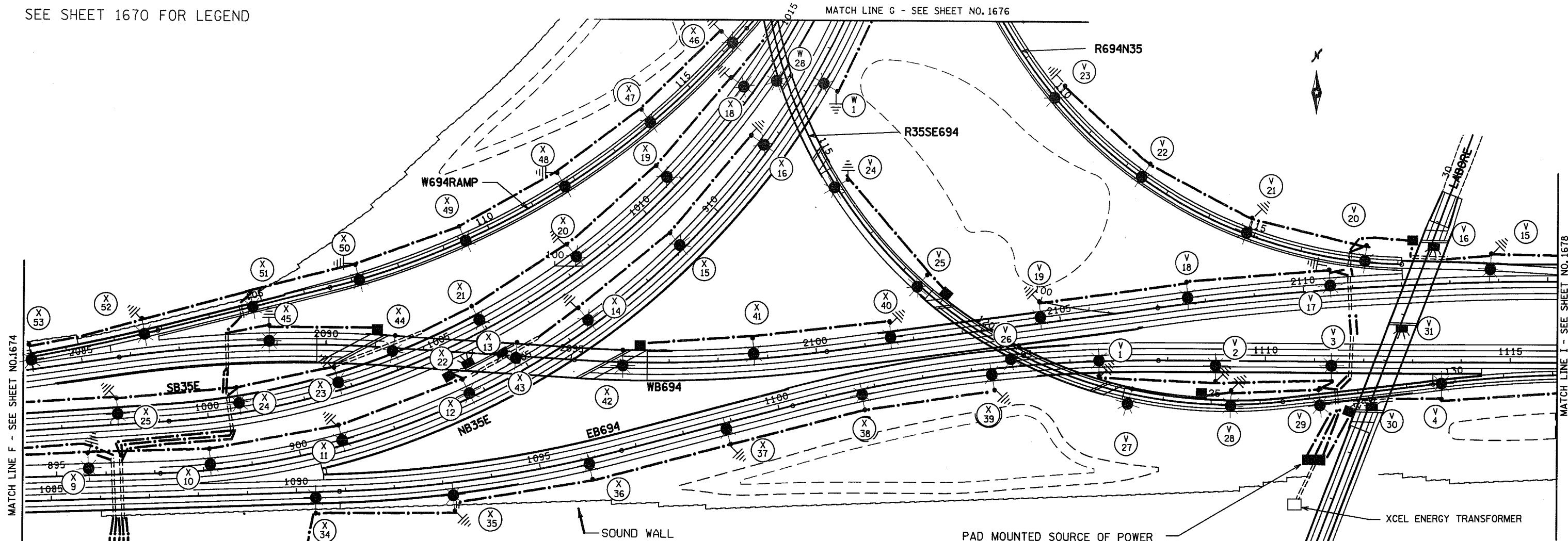

3 TRENCHES +/- 2 FT APART

PAD MOUNTED SOURCE OF POWER  
SERVICE CABINET SECONDARY TYPE L2  
240/480 VOLT, METERED FD.PT. E6X  
EQUIPMENT PAD B REQUIRED  
2" R.S.C. AND 3-1/2 # 3/0 TO  
TRANSFORMER

INPLACE XCEL ENERGY PAD  
MOUNTED TRANSFORMER

SOUND WALL

PAD MOUNTED SOURCE OF POWER  
SERVICE CABINET SECONDARY TYPE L1  
2" R.S.C. AND 3-1/2 # 2 TO TRANSFORMER  
240/480 VOLT, METERED FD.PT. E6V  
COMBINED EQUIPMENT PAD FOR LIGHTING AND TMC  
SEE PAD DETAIL ON SHEET NO. 1669

XCEL ENERGY TRANSFORMER

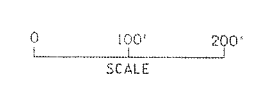
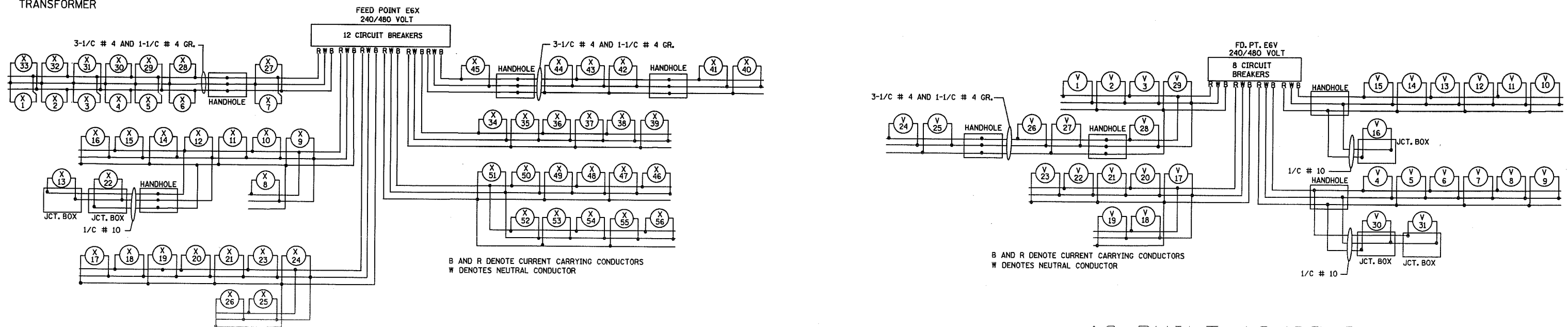

AS-BUILT 12/2010

LIGHTING PLAN

SEE SHEET 1670 FOR LEGEND

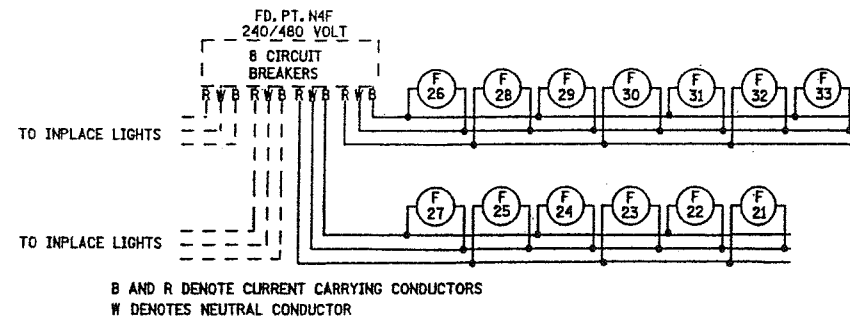

FEEDPOINT N4F

| LIGHTING STANDARDS AND BASES |         |     |     |             |      |         |
|------------------------------|---------|-----|-----|-------------|------|---------|
| NO.                          | STATION | LT. | RT. | LOCATION    | TYPE | WATTAGE |
| 21                           | 1129+90 | -   | -   | EB T.H. 694 | 9-49 | 400     |
| 22                           | 1132+65 | -   | -   | EB T.H. 694 | 9-49 | 400     |
| 23                           | 1135+35 | -   | -   | EB T.H. 694 | 9-49 | 400     |
| 24                           | 1138+05 | -   | -   | EB T.H. 694 | 9-49 | 400     |
| 25                           | 1140+80 | -   | -   | EB T.H. 694 | 9-49 | 400     |
| 26                           | 1143+60 | -   | -   | EB T.H. 694 | 9-49 | 400     |
| 27                           | 102+35  | -   | -   | SW RAMP     | 9-40 | 250     |
| 28                           | 2143+30 | -   | -   | WB T.H. 694 | 9-49 | 400     |
| 29                           | 2140+85 | -   | -   | WB T.H. 694 | 9-49 | 400     |
| 30                           | 2138+15 | -   | -   | WB T.H. 694 | 9-49 | 400     |
| 31                           | 2135+50 | -   | -   | WB T.H. 694 | 9-49 | 400     |
| 32                           | 2132+80 | -   | -   | WB T.H. 694 | 9-49 | 400     |
| 33                           | 2130+10 | -   | -   | WB T.H. 694 | 9-49 | 400     |

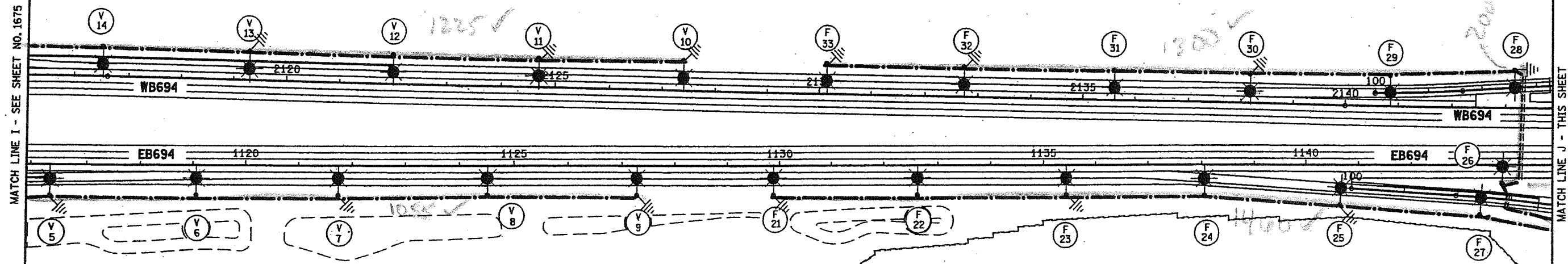

FEEDPOINT E6V

| LIGHTING STANDARDS AND BASES |         |     |     |             |       |         |
|------------------------------|---------|-----|-----|-------------|-------|---------|
| NO.                          | STATION | LT. | RT. | LOCATION    | TYPE  | WATTAGE |
| 1                            | 1106+50 | -   | -   | EB T.H. 694 | 9-49  | 400     |
| 2                            | 1109+00 | -   | -   | EB T.H. 694 | 9-49  | 400     |
| 3                            | 1111+35 | -   | -   | EB T.H. 694 | 9-49  | 400     |
| 4                            | 129+65  | -   | -   | R35SE694    | 9-49  | 400     |
| 5                            | 1116+30 | -   | -   | EB T.H. 694 | 9-49  | 400     |
| 6                            | 1119+05 | -   | -   | EB T.H. 694 | 9-49  | 400     |
| 7                            | 1121+80 | -   | -   | EB T.H. 694 | 9-49  | 400     |
| 8                            | 1124+45 | -   | -   | EB T.H. 694 | 9-49  | 400     |
| 9                            | 1127+20 | -   | -   | EB T.H. 694 | 9-49  | 400     |
| 10                           | 2127+40 | -   | -   | WB T.H. 694 | 9-49  | 400     |
| 11                           | 2124+70 | -   | -   | WB T.H. 694 | 9-49  | 400     |
| 12                           | 2122+00 | -   | -   | WB T.H. 694 | 9-49  | 400     |
| 13                           | 2119+30 | -   | -   | WB T.H. 694 | 9-49  | 400     |
| 14                           | 2116+50 | -   | -   | WB T.H. 694 | 9-49  | 400     |
| 15                           | 2113+80 | -   | -   | WB T.H. 694 | 9-49  | 400     |
| 16                           | 2112+50 | -   | -   | WB T.H. 694 | L     | 250     |
| 17                           | 2110+60 | -   | -   | WB T.H. 694 | 9-49  | 400     |
| 18                           | 2107+60 | -   | -   | WB T.H. 694 | 9-49  | 400     |
| 19                           | 2104+60 | -   | -   | WB T.H. 694 | 9-49  | 400     |
| 20                           | 117+40  | -   | -   | R694N35     | 9-40  | 250     |
| 21                           | 114+80  | -   | -   | R694N35     | 9-40  | 250     |
| 22                           | 112+40  | -   | -   | R694N35     | 9-40  | 250     |
| 23                           | 110+00  | -   | -   | R694N35     | 9-40  | 250     |
| 24                           | 115+80  | -   | -   | R35SE694    | 9-40  | 250     |
| 25                           | 118+40  | -   | -   | R35SE694    | 9-40  | 250     |
| (1) 26                       | 120+82  | -   | -   | R35SE694    | 6B-40 | 250     |
| (1) 27                       | 123+30  | -   | -   | R35SE694    | 6B-40 | 250     |
| 28                           | 125+40  | -   | -   | R35SE694    | 9-40  | 250     |
| 29                           | 127+55  | -   | -   | R35SE694    | 9-40  | 250     |
| 30                           | 128+20  | -   | -   | R35SE694    | L     | 250     |
| 31                           | 1112+80 | -   | -   | EB T.H. 694 | L     | 250     |

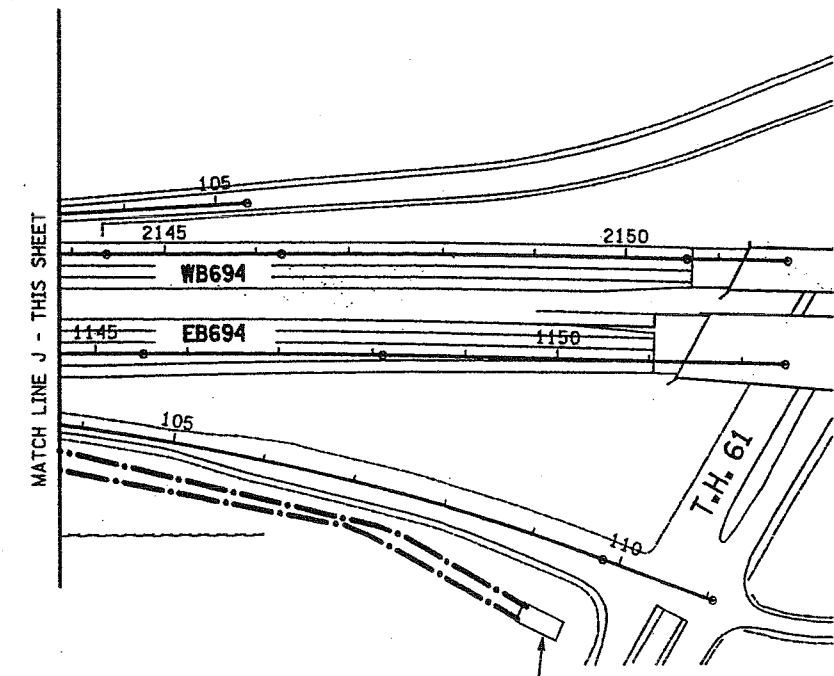

INPLACE PAD MOUNTED SOURCE OF POWER  
F. & I. SERVICE CABINET SECONDARY TYPE L1  
240/480 VOLT, METERED FD.PT. N4F

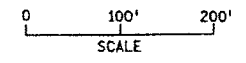

LIGHTING PLAN