

FEEDPOINT E5P
LIGHTING STANDARDS AND BASES

NO.	STATION	LT.	RT.	LOCATION	TYPE
3-5	-	-	-	T.H. 35E N.B.	12-49 (INPLACE)
6	-	-	-	T.H. 35E N.B.	12-49 (INPLACE)
7	-	-	-	T.H. 35E N.B.	12-49 (INPLACE)
8	-	-	-	T.H. 35E N.B.	12-49 (INPLACE)
17	-	-	-	T.H. 35E S.B.	12-49 (INPLACE)
18	-	-	-	T.H. 35E S.B.	12-49 (INPLACE)
19	-	-	-	T.H. 35E S.B.	12-49 (INPLACE)
20-22	-	-	-	T.H. 35E S.B.	9-40 (INPLACE)
24-29	-	-	-	MARYLAND S.E. RAMP	9-40 (INPLACE)
30	100+38	16.9'	-	MARYLAND N.E. RAMP	9-40 (SALVAGED)
31	102+34	20.2'	-	MARYLAND N.E. RAMP	9-40
32	104+60	18.1'	-	MARYLAND N.E. RAMP	9-40
33	106+77	12.0'	-	MARYLAND N.E. RAMP	9-40
35	501+36	51.0'	-	T.H. 35E S.B.	12-49
36	498+55	68.5'	-	T.H. 35E S.B.	12-49
37	106+66	15.9'	-	MARYLAND N.W. RAMP	9-40 (SALVAGED)
38	104+69	12.0'	-	MARYLAND N.W. RAMP	9-40 (SALVAGED)
39	102+35	22.7'	-	MARYLAND N.W. RAMP	9-40 (SALVAGED)
40	100+16	16.6'	-	MARYLAND N.W. RAMP	9-40 (SALVAGED)
23, 41-45	-	-	-	MARYLAND S.W. RAMP	9-40 (INPLACE)
46-47	-	-	-	T.H. 35E N.B.	L (INPLACE)
48-49	-	-	-	T.H. 35E S.B.	L (INPLACE)

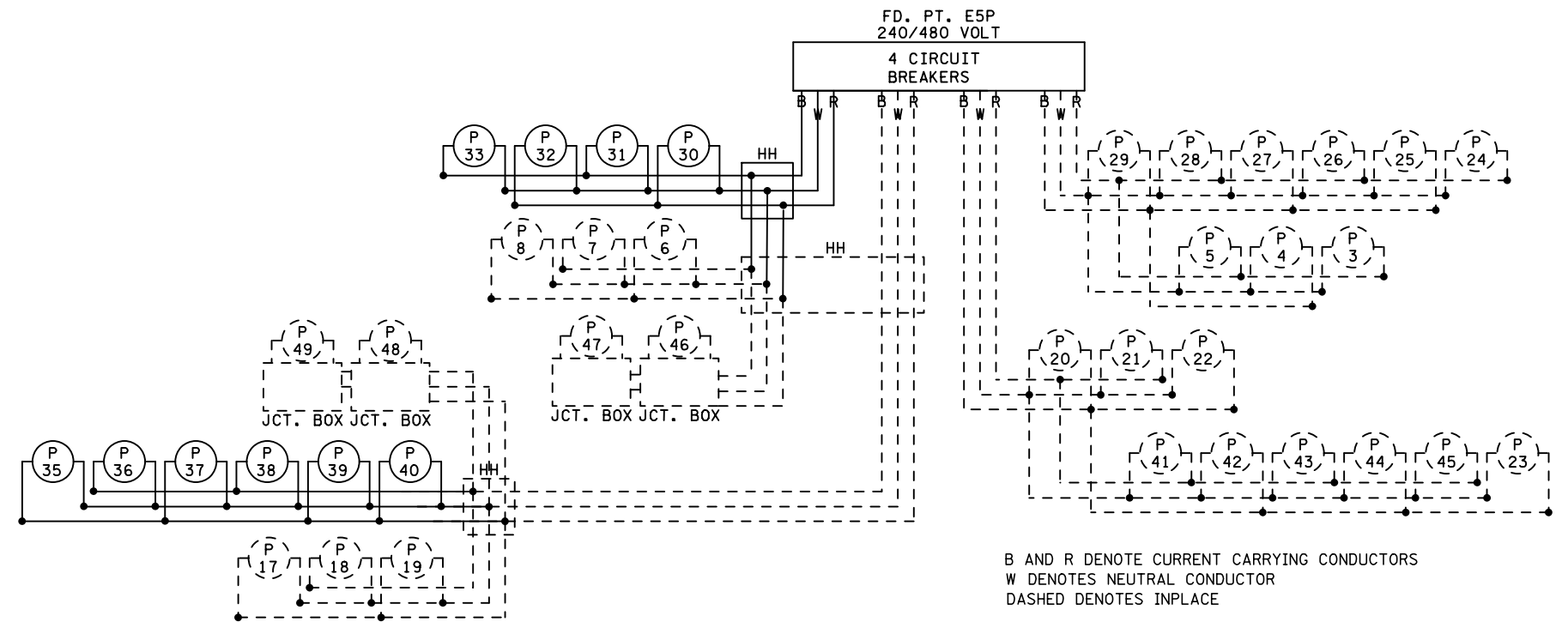

B AND R DENOTE CURRENT CARRYING CONDUCTORS
W DENOTES NEUTRAL CONDUCTOR
DASHED DENOTES INPLACE

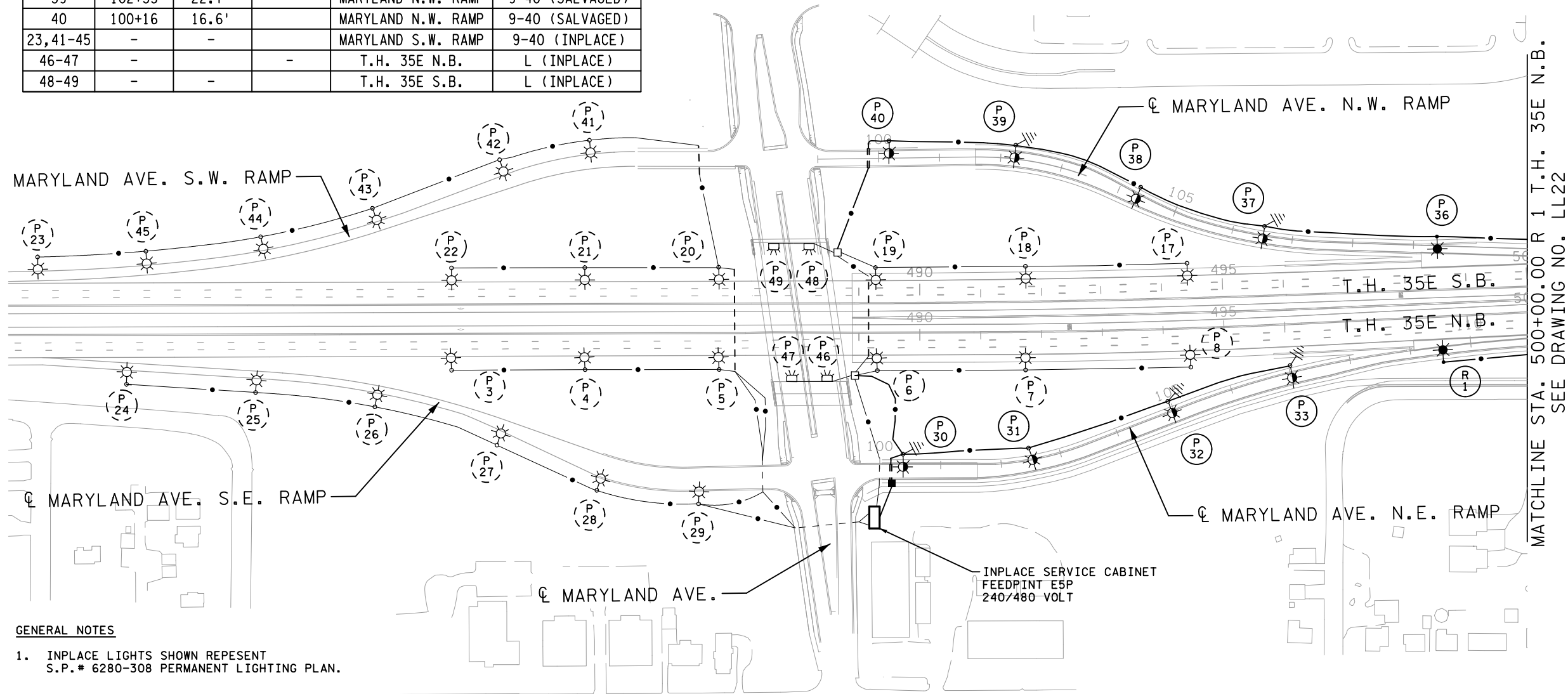
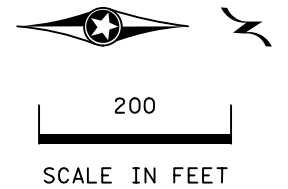

GENERAL NOTES

1. INPLACE LIGHTS SHOWN REPRESENT S.P.# 6280-308 PERMANENT LIGHTING PLAN.

NO	DATE	BY	CKD	APPR	REVISION
0	07/08/14	JJG	MPM	JWD	INITIAL RELEASE FOR CONSTRUCTION - DP T-6
1	10/03/14	JJG	MPM	JWD	NDC 022
2	03/12/15	SHS	MPM	JWD	NDC 023
3	03/01/16	SHS	MPM	JWD	RECORD PLAN

RECORD DRAWING NOTE
THESE RECORD DRAWINGS WERE DEVELOPED BASED ON THE PREVIOUS DRAWING REVISIONS AND INFORMATION TRANSMITTED FROM THE FIELD BY OTHERS. THE INFORMATION CONTAINED WITHIN THIS RECORD AS-BUILT PLAN REPRESENTS THE ACTUAL CONDITIONS FOR ALL CHANGES OF WHICH ALLIANT IS AWARE. FUTURE USERS OF THESE DRAWINGS SHOULD VERIFY AS-BUILT CONDITIONS IN THE FIELD IN ALL CIRCUMSTANCES.



I-35E MNPASS PROJECT (S.P. 6280-367)
PROPOSED MNDOT LIGHTING SYSTEM
LAYOUT

SHEET
LL21
OF

10:37:46 AM 3/1/2016 C:\work\proj\ect\l\see\mccur\dy\dms37391\c06280367_ab_1121.dgn

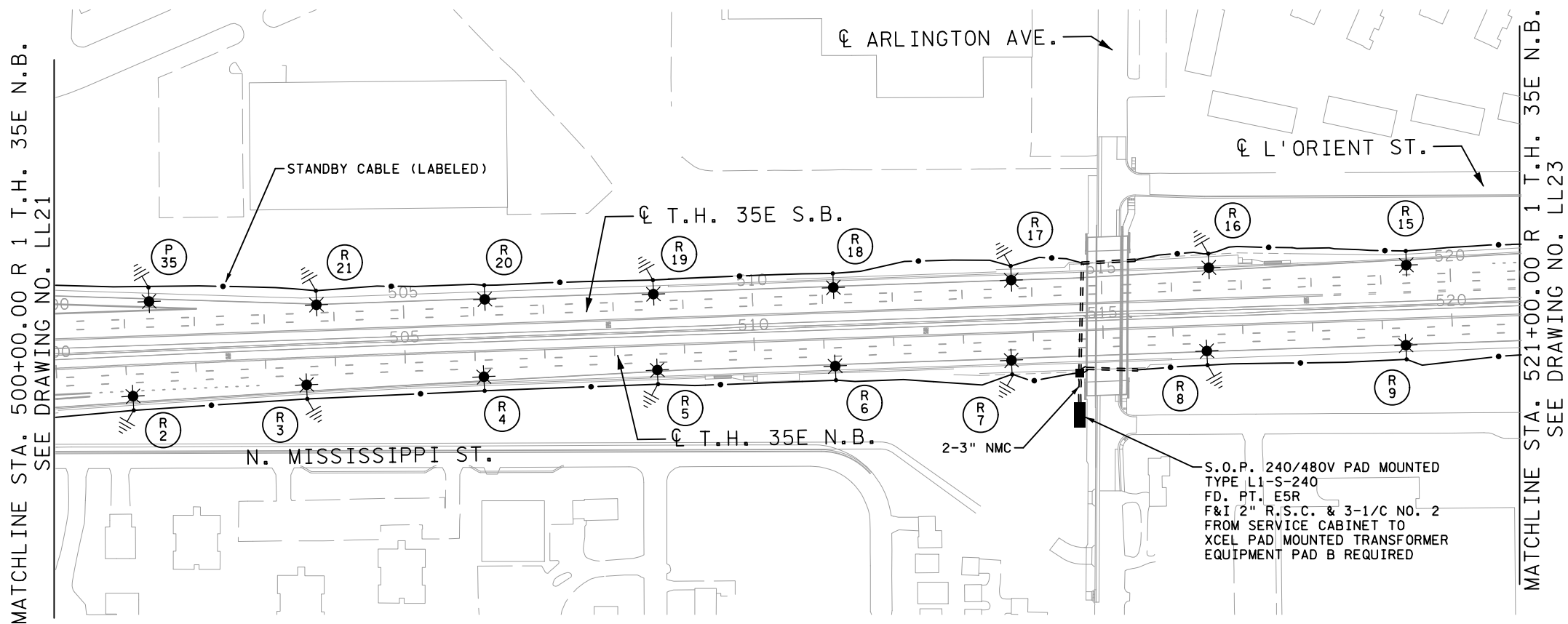
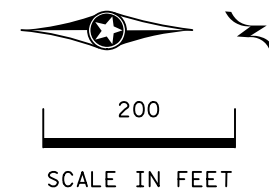

S.O.P. 240/480V PAD MOUNTED
TYPE L1-S-240
FD. PT. E5R
F&I 2" R.S.C. & 3-1/2" NO. 2
FROM SERVICE CABINET TO
XCEL PAD MOUNTED TRANSFORMER
EQUIPMENT PAD B REQUIRED

FEEDPOINT E5R
LIGHTING STANDARDS AND BASES

NO.	STATION	LT.	RT.	LOCATION	TYPE
1	498+58		61.9'	T.H. 35E N.B.	12-49
2	501+08		51.5'	T.H. 35E N.B.	12-49
3	503+58		46.0'	T.H. 35E N.B.	12-49
4	506+12		44.0'	T.H. 35E N.B.	12-49
5	508+61		43.1'	T.H. 35E N.B.	12-49
6	511+15		46.3'	T.H. 35E N.B.	12-49
7	513+68		46.9'	T.H. 35E N.B.	12-49
8	516+48		43.4'	T.H. 35E N.B.	12-49
9	519+33		45.0'	T.H. 35E N.B.	12-49
10	522+16		43.4'	T.H. 35E N.B.	12-49
11	524+88		54.0'	T.H. 35E N.B.	12-49
12	527+91		74.5'	T.H. 35E N.B.	12-49
13	525+12	68.5'		T.H. 35E S.B.	12-49
14	522+20	53.1'		T.H. 35E S.B.	12-49
15	519+37	46.1'		T.H. 35E S.B.	12-49
16	516+55	52.2'		T.H. 35E S.B.	12-49
17	513+71	44.4'		T.H. 35E S.B.	12-49
18	511+16	42.6'		T.H. 35E S.B.	12-49
19	508+58	42.3'		T.H. 35E S.B.	12-49
20	506+17	43.3'		T.H. 35E S.B.	12-49
21	503+75	43.8'		T.H. 35E S.B.	12-49

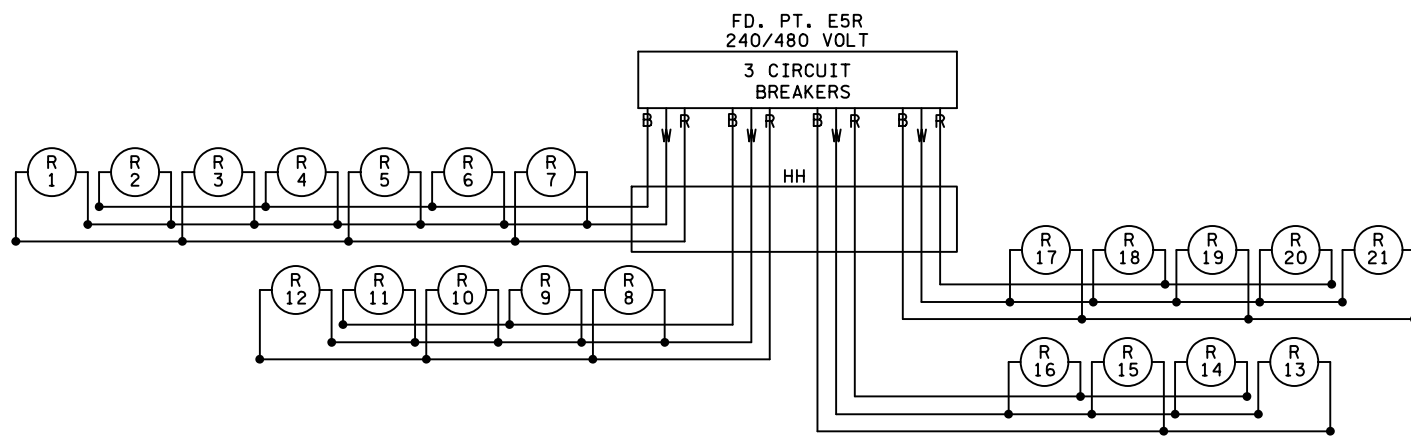

B AND R DENOTE CURRENT CARRYING CONDUCTORS
W DENOTES NEUTRAL CONDUCTOR

NO.	DATE	BY	CKD	APPR	REVISION
0	07/08/14	JJG	MPM	JWD	INITIAL RELEASE FOR CONSTRUCTION - DP T-6
1	10/03/14	JJG	MPM	JWD	NDC 022
2	03/12/15	SHS	MPM	JWD	NDC 023
3	03/01/16	SHS	MPM	JWD	RECORD PLAN

RECORD DRAWING NOTE
THESE RECORD DRAWINGS WERE DEVELOPED BASED ON THE PREVIOUS DRAWING REVISIONS AND INFORMATION TRANSMITTED FROM THE FIELD BY OTHERS. THE INFORMATION CONTAINED WITHIN THIS RECORD AS-BUILT PLAN REPRESENTS THE ACTUAL CONDITIONS FOR ALL CHANGES OF WHICH ALLIANT IS AWARE. FUTURE USERS OF THESE DRAWINGS SHOULD VERIFY AS-BUILT CONDITIONS IN THE FIELD IN ALL CIRCUMSTANCES.



I-35E MNPASS PROJECT (S.P. 6280-367)	SHEET LL22 OF
PROPOSED MNDOT LIGHTING SYSTEM LAYOUT	

10/30/16 AM 3/7/2016 10:38:01 AM C:\work\proj\ect\l\ee\mccur\dy\dms37391\cd6280367_ab_1122.dgn