

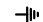



LEGEND

-  LIGHTING UNIT
-  PERMANENT GROUND ROD (25 OHMS OR LESS)
-  DIRECT BURIED CABLE 4/C 4 AWG
-  FD. PT. CABINET
-  3" PVC DIRECTIONAL BORED (UNLESS OTHERWISE NOTED)
-  LIGHTING UNIT IDENTIFIER
-  RIGHT OF WAY

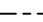
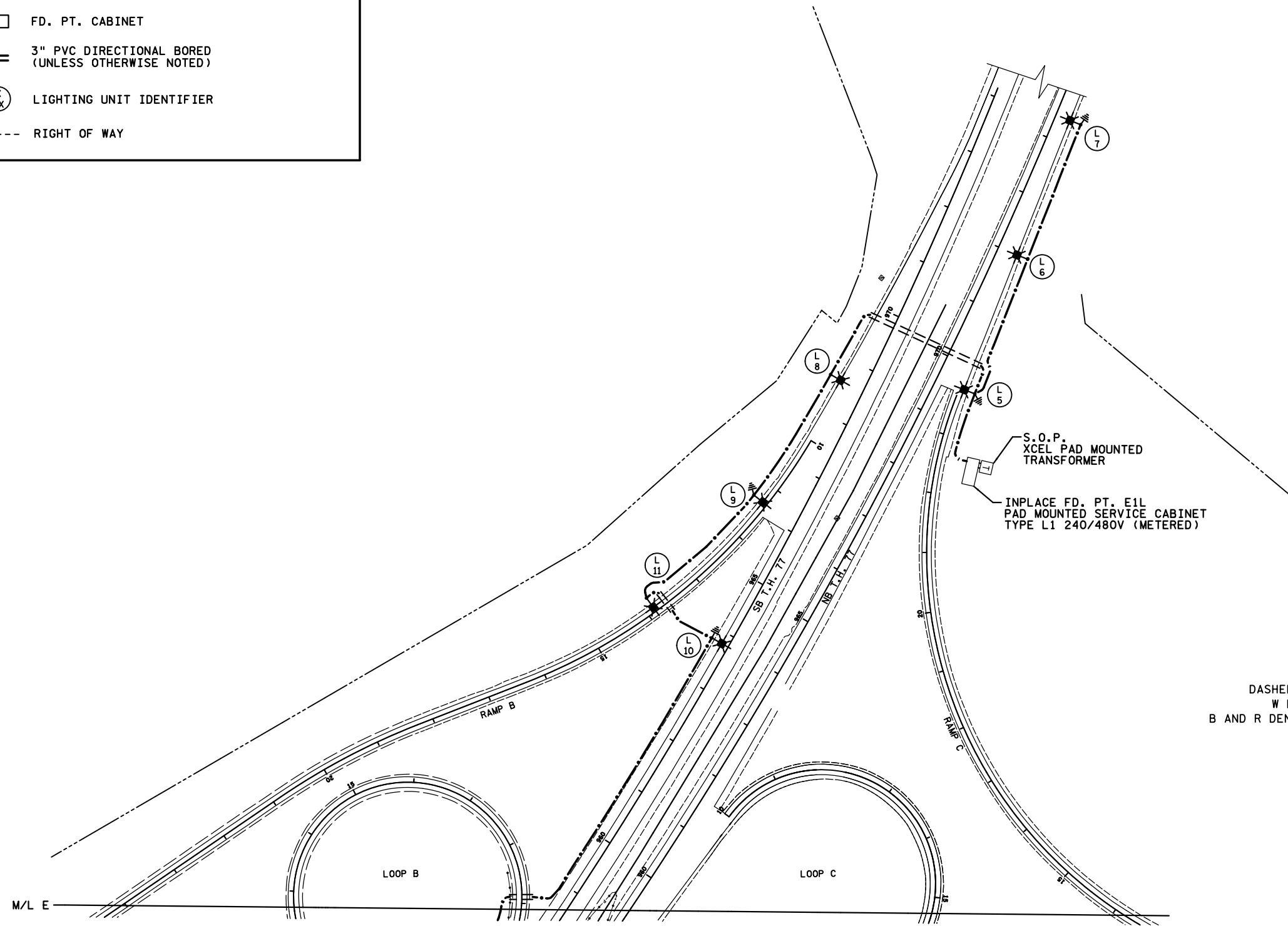
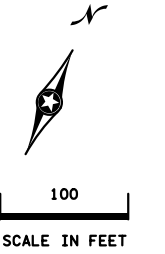

FEEDPOINT E1L
LIGHTING UNIT LOCATION AND TYPE

NO.	STATION	LT.	RT.	LOCATION	TYPE	FOUNDATION
1	321+50	-		SB T.H. 35E	L	INPLACE
2	320+40	-		SB T.H. 35E	9-40	E
3	318+00	-		SB T.H. 35E		
4	12+00	-		LOOP B		
5	969+60	-		NB T.H. 77		
6	972+00	-		NB T.H. 77		
7	974+40	-		NB T.H. 77		
8	968+60	-		SB T.H. 77		
9	966+20	-		SB T.H. 77		
10	963+80	-		SB T.H. 77		
11	13+85	-		RAMP B		
12	957+60	-		SB T.H. 77	9-40	E
13	955+60	-		SB T.H. 77	6B-40	INPLACE

(1) INSTALL SALVAGED LUMINAIRE

DASHED LINES DENOTE INPLACE ITEMS
W DENOTES NEUTRAL CONDUCTOR
B AND R DENOTE CURRENT CARRYING CONDUCTORS
FD. PT. E1L
240/480 VOLT

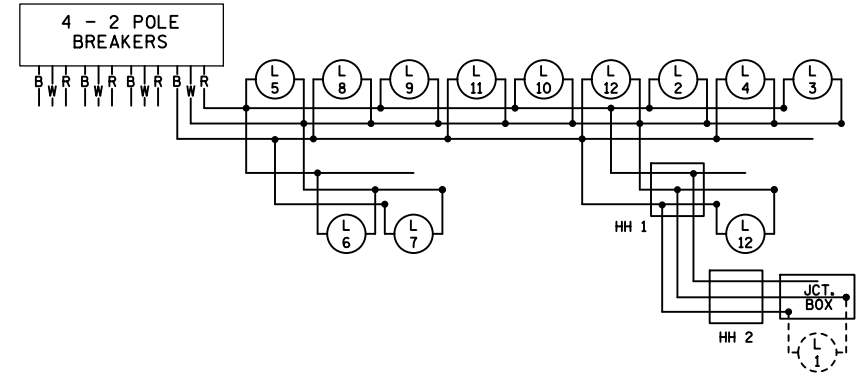

DISTRICT #: METRO
 I/PLOT NAME: T1982-188LIT.L06
 PATH & FILENAME: IP_PWP:d1893175T1982-188LIT.L0.dgn
 PLOTTED/REVISED: 11/27/2017

BY	DATE	REVISIONS	FEEDPOINT: E1L LOCATION: T.H. 77 METER ADDRESS: 4800 NICOLS RD., EGAN, MN 55122	<h2 style="margin: 0;">LIGHTING PLAN</h2>
DRAWN BY: JC CKD BY: PB			CERTIFIED BY <i>Michael P. Dubinsky</i> LIC. NO. 19863 DATE: 11/27/2017 <small>LICENSED PROFESSIONAL ENGINEER</small>	STATE PROJ. NO. 1982-188 (T.H. 35E) SHEET NO. 18 OF 28 SHEETS

PLOTTED/REVISED: 11/27/2017

DISTRICT #: METRO
 I/PLOT NAME: T1982-188LIT.L04
 PATH & FILENAME: IP_PWP-d1893175T1982-188LIT.L04.dgn

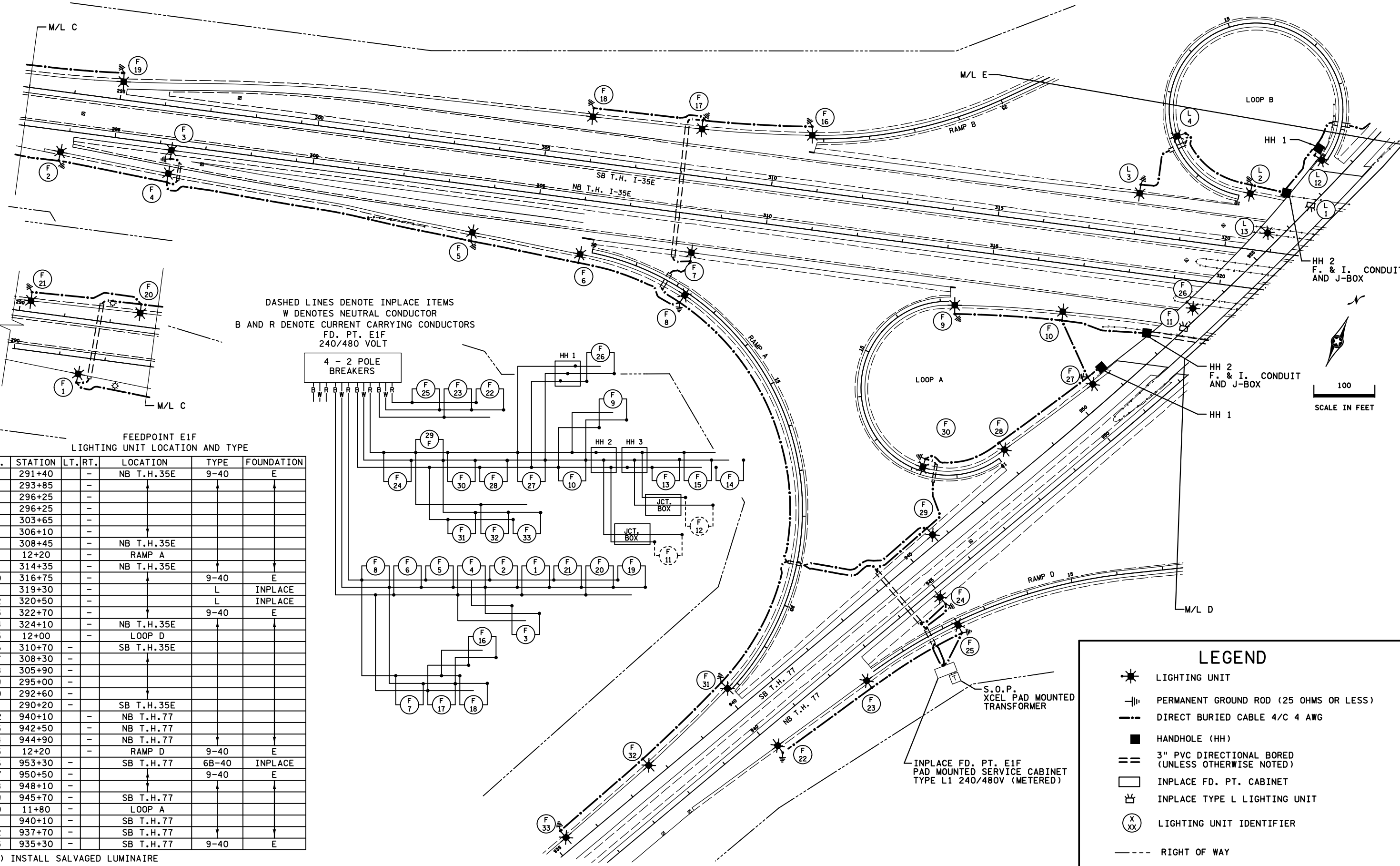

DASHED LINES DENOTE INPLACE ITEMS
 W DENOTES NEUTRAL CONDUCTOR
 B AND R DENOTE CURRENT CARRYING CONDUCTORS
 FD. PT. E1F
 240/480 VOLT

FEEDPOINT E1F
 LIGHTING UNIT LOCATION AND TYPE

NO.	STATION	LT.	RT.	LOCATION	TYPE	FOUNDATION
1	291+40	-	-	NB T.H. 35E	9-40	E
2	293+85	-	-			E
3	296+25	-	-			E
4	296+25	-	-			E
5	303+65	-	-			E
6	306+10	-	-			E
7	308+45	-	-	NB T.H. 35E		E
8	12+20	-	-	RAMP A		E
9	314+35	-	-	NB T.H. 35E		E
10	316+75	-	-		9-40	E
11	319+30	-	-		L	INPLACE
12	320+50	-	-		L	INPLACE
13	322+70	-	-		9-40	E
14	324+10	-	-	NB T.H. 35E		E
15	12+00	-	-	LOOP D		E
16	310+70	-	-	SB T.H. 35E		E
17	308+30	-	-			E
18	305+90	-	-			E
19	295+00	-	-			E
20	292+60	-	-			E
21	290+20	-	-	SB T.H. 35E		E
22	940+10	-	-	NB T.H. 77		E
23	942+50	-	-	NB T.H. 77		E
24	944+90	-	-	NB T.H. 77		E
25	12+20	-	-	RAMP D	9-40	E
26	953+30	-	-	SB T.H. 77	6B-40	INPLACE
27	950+50	-	-		9-40	E
28	948+10	-	-			E
29	945+70	-	-	SB T.H. 77		E
30	11+80	-	-	LOOP A		E
31	940+10	-	-	SB T.H. 77		E
32	937+70	-	-	SB T.H. 77		E
33	935+30	-	-	SB T.H. 77	9-40	E

(1) INSTALL SALVAGED LUMINAIRE

LEGEND

- LIGHTING UNIT
- PERMANENT GROUND ROD (25 OHMS OR LESS)
- DIRECT BURIED CABLE 4/C 4 AWG
- HANDHOLE (HH)
- 3" PVC DIRECTIONAL BORED (UNLESS OTHERWISE NOTED)
- INPLACE FD. PT. CABINET
- INPLACE TYPE L LIGHTING UNIT
- LIGHTING UNIT IDENTIFIER
- RIGHT OF WAY

BY	DATE	REVISIONS

FEEDPOINT: E1F LOCATION: T.H. 77
 METER ADDRESS: 4960 CEADER ACE., EAGAN, MN 55122

CERTIFIED BY Michael P. Dubinsky LIC. NO. 19863 DATE: 11/27/2017
LICENSED PROFESSIONAL ENGINEER

LIGHTING PLAN

STATE PROJ. NO. 1982-188 (T.H. 35E) SHEET NO. 16 OF 28 SHEETS