

SEE LEGEND SHEET 8

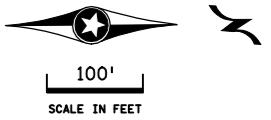

DASHED LINE INDICATES INPLACE

INP. FD. PT. B31A  
240/480 VOLT

4 CIRCUIT  
BREAKERS

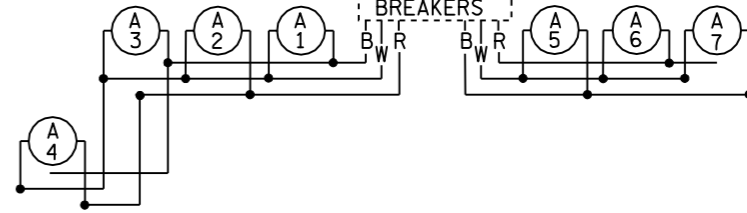

PLOTTED/REVISED: 3/6/2009

DISTRICT #: METRO  
I/PLOT NAME: 8825-209\_10-35e\_w  
PATH & FILENAME: S:\TRAFFIC\LIGHTING\Plans\035e\8825-209\8825-209\_LO.LIT.DGN

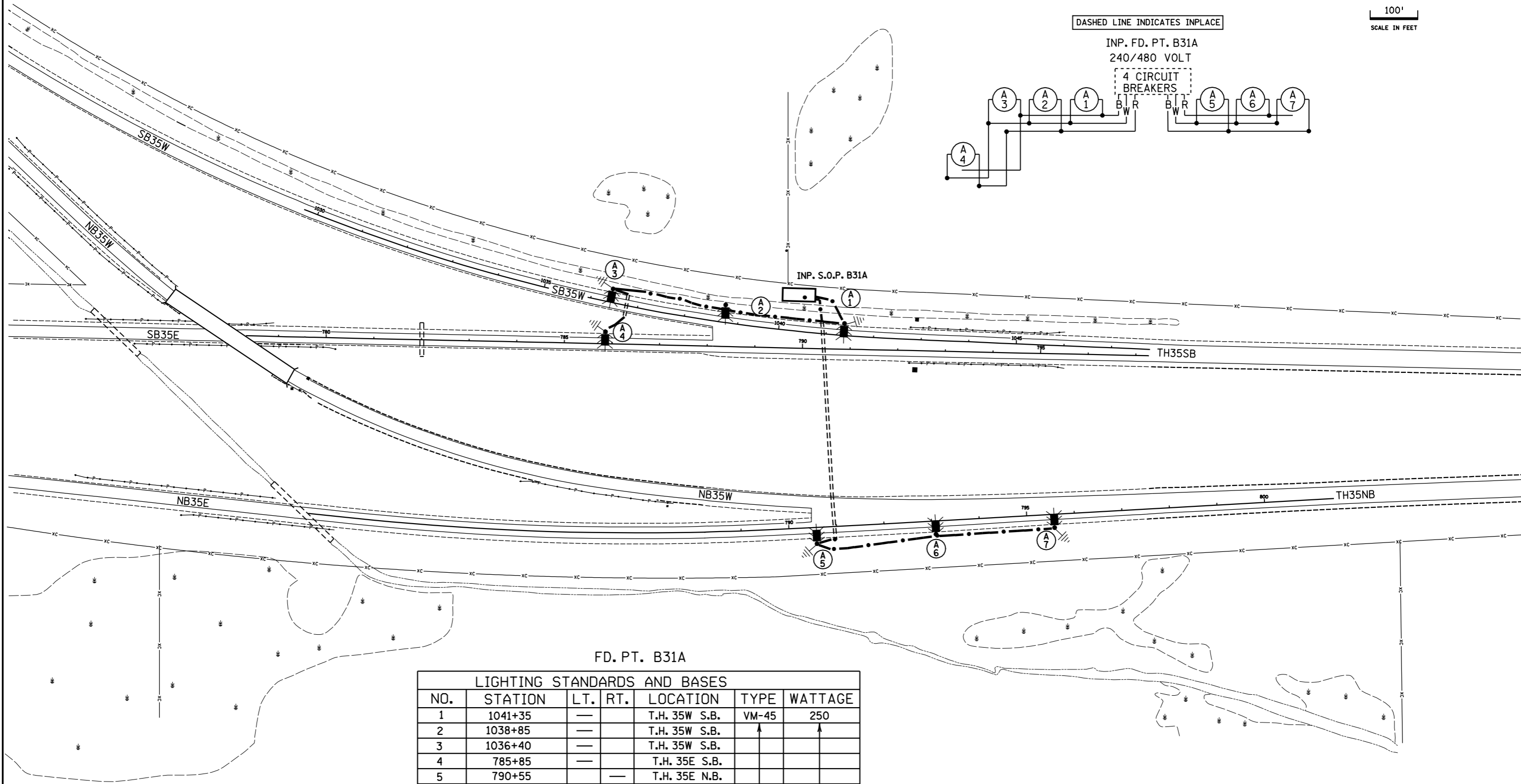

FD. PT. B31A

LIGHTING STANDARDS AND BASES						
NO.	STATION	LT.	RT.	LOCATION	TYPE	WATTAGE
1	1041+35	—	—	T.H. 35W S.B.	VM-45	250
2	1038+85	—	—	T.H. 35W S.B.	↑	↑
3	1036+40	—	—	T.H. 35W S.B.	↑	↑
4	785+85	—	—	T.H. 35E S.B.	↑	↑
5	790+55	—	—	T.H. 35E N.B.	↓	↓
6	793+05	—	—	T.H. 35E N.B.	↓	↓
7	795+55	—	—	T.H. 35E N.B.	VM-45	250

SEE DETAIL SHEET FOR LIGHT POLE PLACEMENT

AS-BUILT  
FEEDPOINT B31A  
TH 35E at TH 35W

MODIFIED 3-2009

DRAWN BY: NS

CHECKED BY: GB

CERTIFIED BY

*Michael P. Gubinsky*  
LICENSED PROFESSIONAL ENGINEER

LIC. NO. 19863

DATE 3/6/2009

**LIGHTING PLAN**

STATE PROJ. NO. 8825-209 ( T.H. 35E )

SHEET NO. 10 OF 10 SHEETS