





LEGEND

-  VERTICAL MOUNT LIGHTING UNIT
-  PAD MOUNTED SOURCE OF POWER
240/480 VOLT (INPLACE)
-  ARMORED CABLE 4 CONDUCTOR NO. 4
-  3" NON-METALLIC CONDUIT (DIRECTIONAL BORE)
UNLESS NOTED OTHERWISE
-  PERMANENT GROUND ROD (25 OHMS OR LESS)

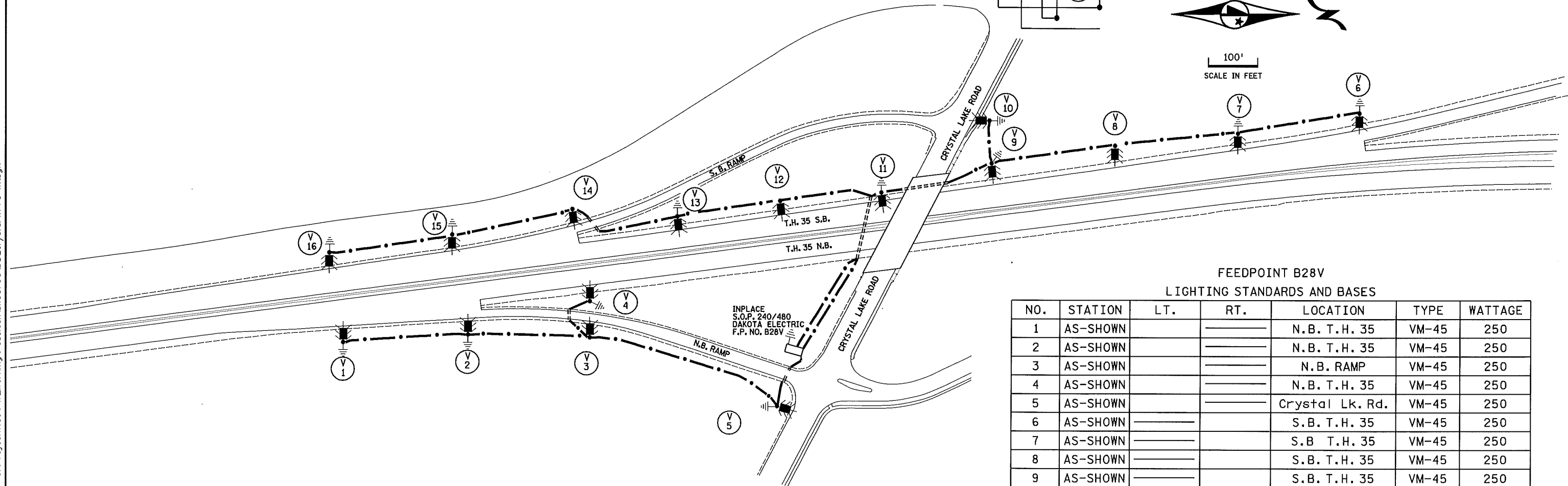
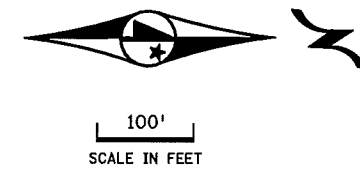
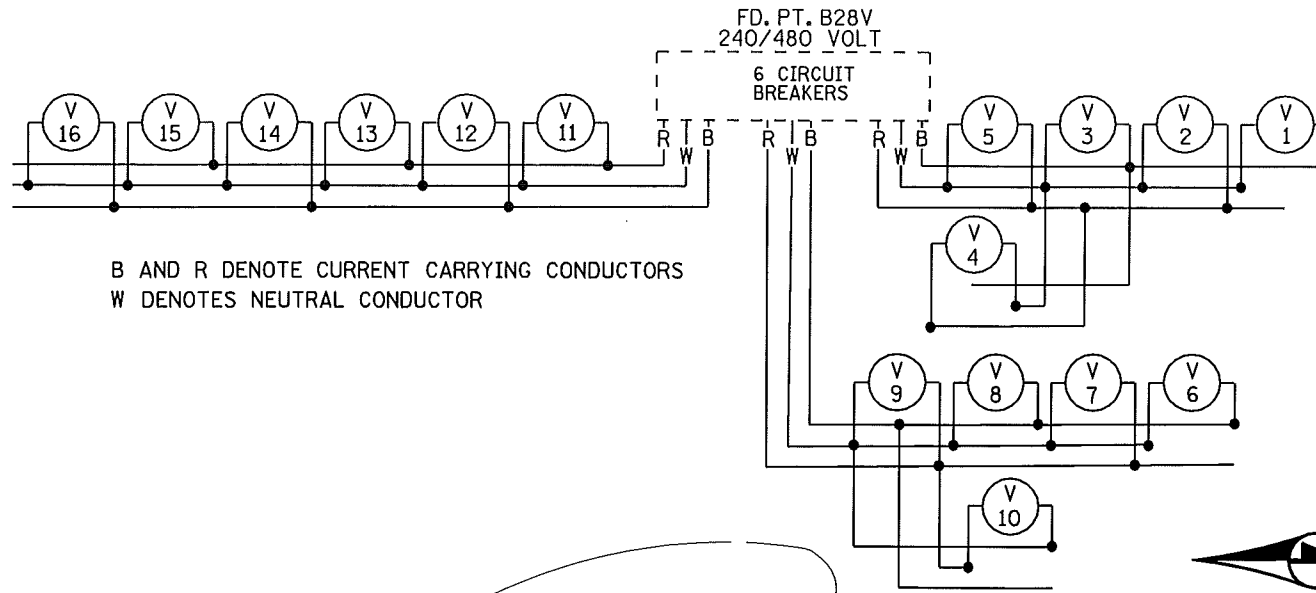

FEEDPOINT B28V
LIGHTING STANDARDS AND BASES

NO.	STATION	LT.	RT.	LOCATION	TYPE	WATTAGE
1	AS-SHOWN			N.B. T.H. 35	VM-45	250
2	AS-SHOWN			N.B. T.H. 35	VM-45	250
3	AS-SHOWN			N.B. RAMP	VM-45	250
4	AS-SHOWN			N.B. T.H. 35	VM-45	250
5	AS-SHOWN			Crystal Lk. Rd.	VM-45	250
6	AS-SHOWN			S.B. T.H. 35	VM-45	250
7	AS-SHOWN			S.B. T.H. 35	VM-45	250
8	AS-SHOWN			S.B. T.H. 35	VM-45	250
9	AS-SHOWN			S.B. T.H. 35	VM-45	250
10	AS-SHOWN			Crystal Lk. Rd.	VM-45	250
11	AS-SHOWN			S.B. T.H. 35	VM-45	250
12	AS-SHOWN			S.B. T.H. 35	VM-45	250
13	AS-SHOWN			S.B. T.H. 35	VM-45	250
14	AS-SHOWN			S.B. T.H. 35	VM-45	250
15	AS-SHOWN			S.B. T.H. 35	VM-45	250
16	AS-SHOWN			S.B. T.H. 35	VM-45	250

DISTRICT #: METRO
 IPLOT NAME: 35@crystal lk rd lit
 PATH & FILENAME: c:\Project\ise\pw_Working\pedel\ah\100706\35@crystal lk rd lit.dgn
 PLOTTED/REVISED: 3/5/2010

BY	DATE	REVISIONS	SYSTEM ID: FEEDPOINT: B28V	T.E.	LOCATION: 35 AT CRYSTAL LAKE ROAD	ELECTRIC LIGHT SYSTEM "A"
			METER ADDRESS:			
DRAWN BY: JP			CERTIFIED BY: <i>Michael P. Gubinsky</i>		STATE PROJ. NO. 8825-302	SHEET NO. 8 OF 10 SHEETS
CKD BY: NS			LIC. NO. 19863 DATE: 06/26/08			
DATE: 06/25/08			LICENSED PROFESSIONAL ENGINEER			