

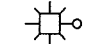

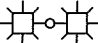

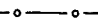



LEGEND

-  INPLACE LIGHTING UNIT
-  INPLACE LIGHTING UNIT
-  INPLACE DIRECT BURIED CABLE
-  S.O.P. XCEL ENERGY
-  FD. PT. CABINET
-  INPLACE HANDHOLE
-  INSTALL SALVAGED LIGHTING UNIT
-  DIRECT BURIED CABLE 4 CONDUCTOR NO. 4
-  PERMANENT GROUND ROD (25 OHMS OR LESS)
-  INPLACE CONDUIT
-  3" PVC (UNLESS OTHERWISE NOTED)

FEEDPOINT A3H

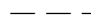
LIGHTING STANDARDS AND FOUNDATIONS					
NO.	STATION	LT.	RT.	LOCATION	TYPE
6	72+75	-	-	EB T.H. 94	9-49
23	61+60	-	-	EB T.H. 94	9-49
24	63+45	-	-	EB T.H. 94	9-49
25	65+80	-	-	EB T.H. 94	9-49
26	68+20	-	-	EB T.H. 94	9-49
27	70+50	-	-	EB T.H. 94	9-49

PLOTTED/REVISED: 10/11/2015

DISTRICT #: METRO
 I/PLOT NAME: A3H Layout
 PATH & FILENAME: IP_PWP:d1688547\6283-175\i.lodgn

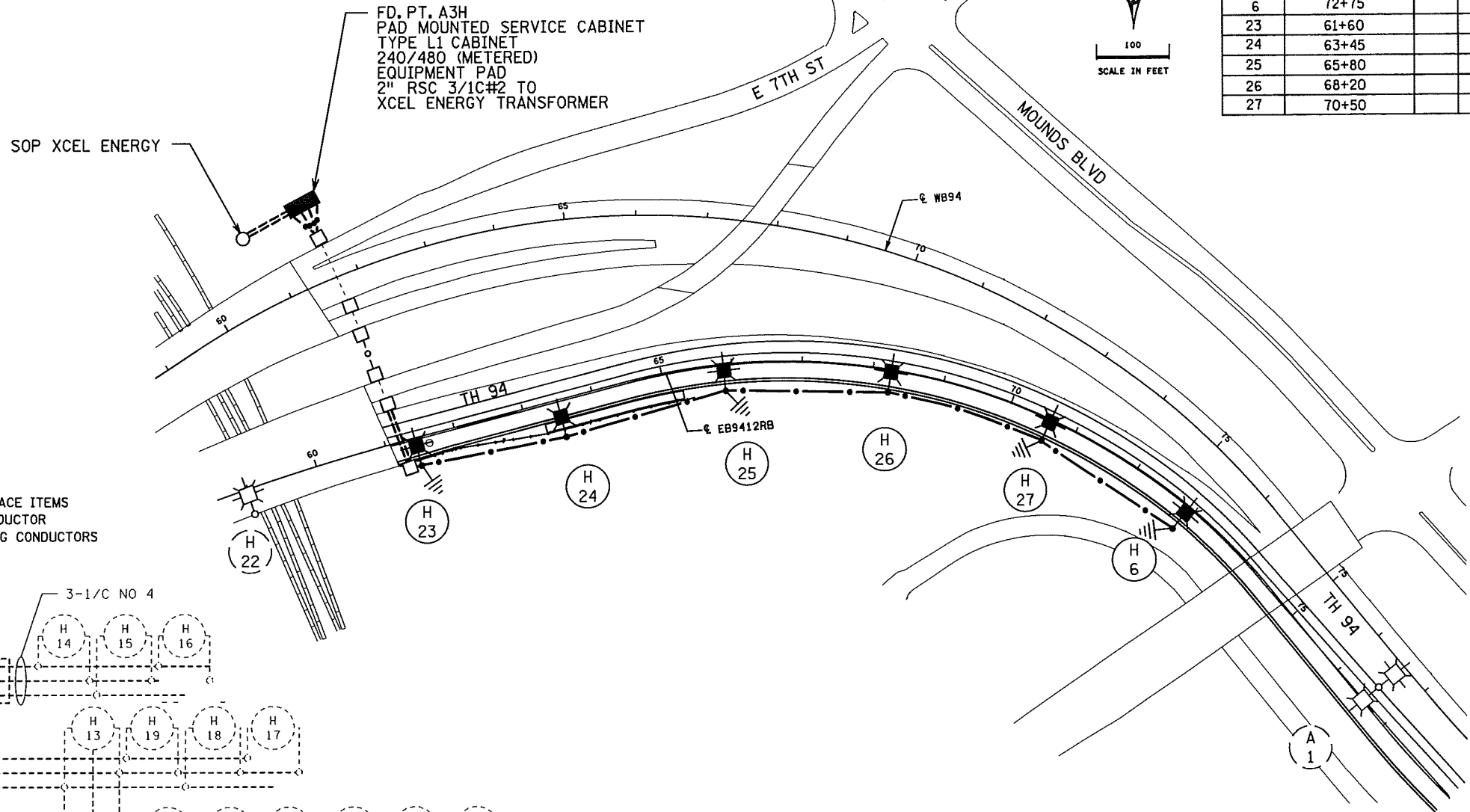

DASHED LINES DENOTE INPLACE ITEMS
 W DENOTES NEUTRAL CONDUCTOR
 B AND R DENOTE CURRENT CARRYING CONDUCTORS
 FD. PT. A3H
 240/480 VOLT

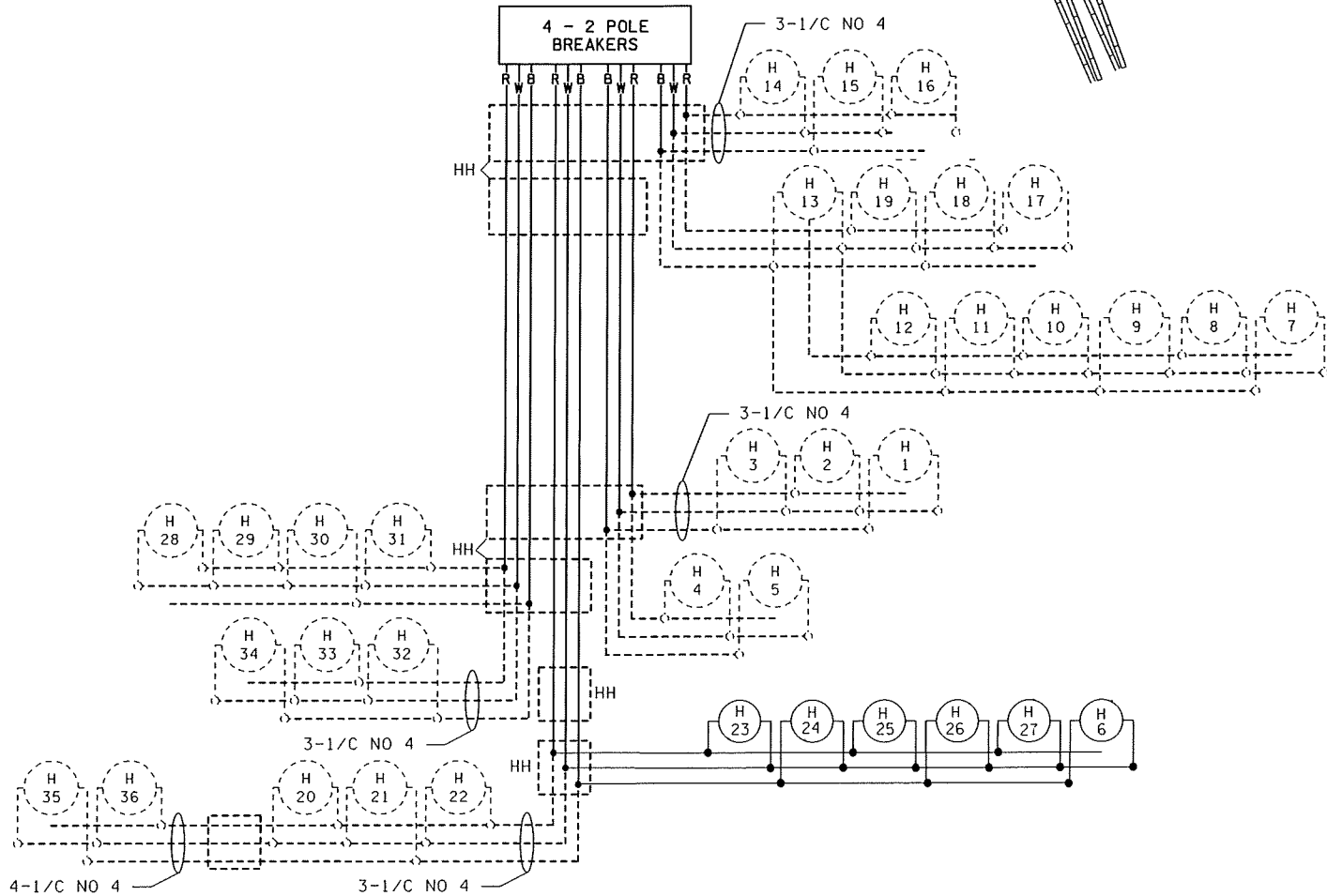

NOTE:
 1. THE EXACT LOCATION OF THE LIGHTING CABINET SHALL BE VERIFIED IN THE FIELD BY MN/DOT TRAFFIC OFFICE PERSONNEL

LIGHTING SYSTEM A FEED POINT A3H

BY	DATE	REVISIONS

FEEDPOINT: A3H LOCATION: 6TH STREET BRIDGE
 METER ADDRESS: 620 7TH ST. EAST ST. PAUL

CERTIFIED BY Michael P. Sabusky LIC. NO. 19863 DATE: 10/1/2015
LICENSED PROFESSIONAL ENGINEER

LIGHTING PLAN

STATE PROJ. NO. 6283-175 (T.H. 94) SHEET NO. SL8 OF SL10 SHEETS

DRAWN BY: SJK CKD BY: PB DATE: 07-10-15

SEE LEGEND SHEET L12

100
SCALE IN FEET

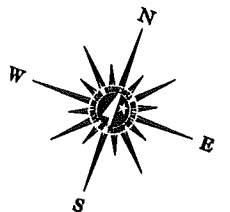

PLOTTED/REVISED: 8/19/2010

DISTRICT #: METRO
PLOT NAME: 16244-030L16
PATH & FILENAME: IP_PWP-d1236163V6244-030.dgn

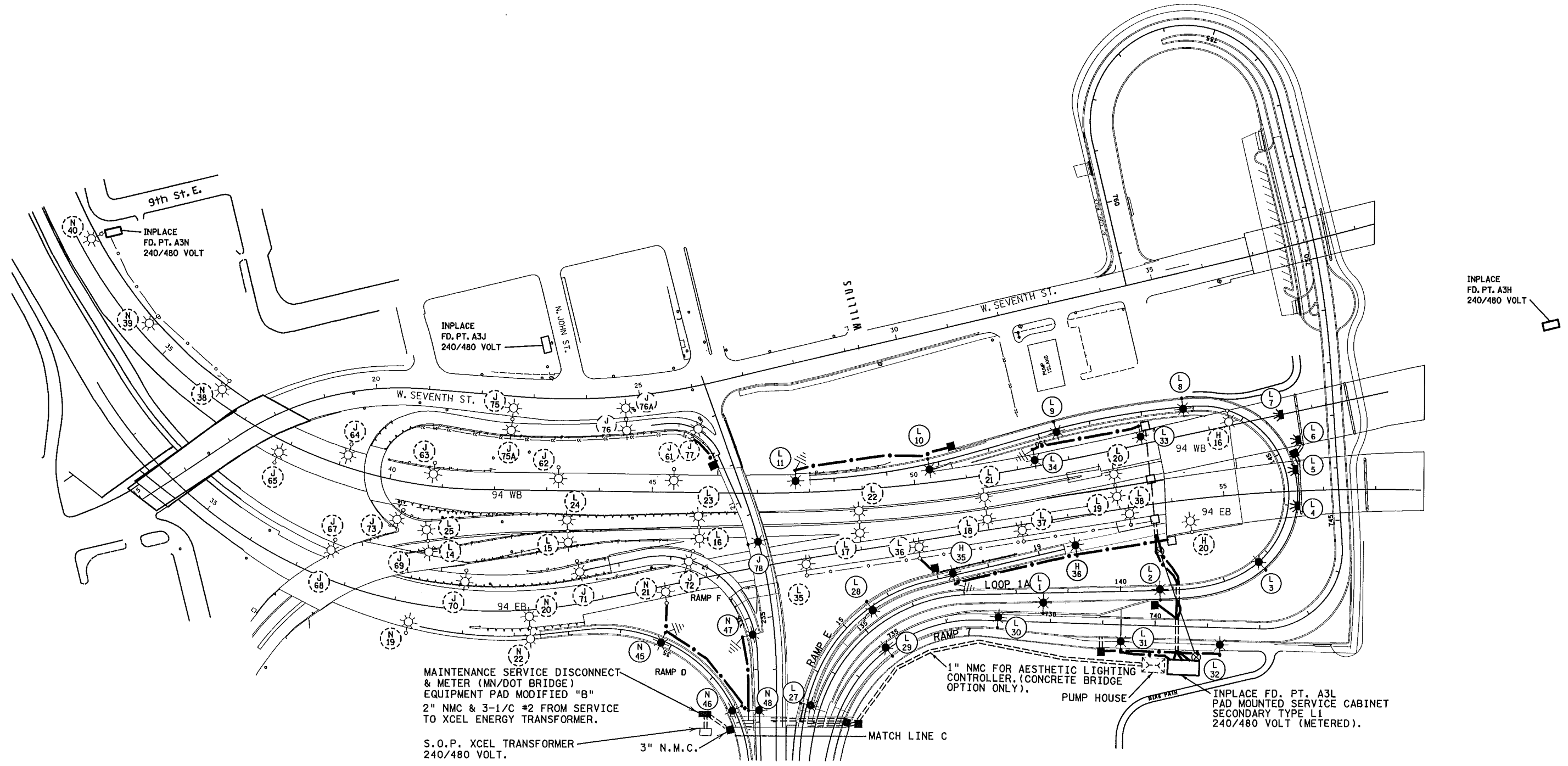

FD. PT. A3H, A3J, A3L, A3N

BY	DATE	REVISIONS	FEEDPOINT: A3H, A3J, A3L, A3N	LOCATION: T.H. 52	LIGHTING PLAN
			METER ADDRESS: A3L TBD		
DRAWN BY: PB	CKD BY: GB	DATE:	CERTIFIED BY: <i>Michael P. Lubinsky</i> LICENSED PROFESSIONAL ENGINEER	LIC. NO. 19863	DATE: 8/19/2010
			STATE PROJ.NO. 6244-30 (T.H.52)		SHEET NO. L16 OF L24 SHEETS

PLOTTED/REVISED: 5/12/2011

DISTRICT #: METRO
 IPLOT NAME: 16244-030
 PATH & FILENAME: IP_PWP-d1236163V6244-030.dgn

DASHED LINES DENOTE INPLACE ITEMS
 W DENOTES NEUTRAL CONDUCTOR
 B AND R DENOTE CURRENT CARRYING CONDUCTORS
 FD. PT. A3N
 240/480 VOLT

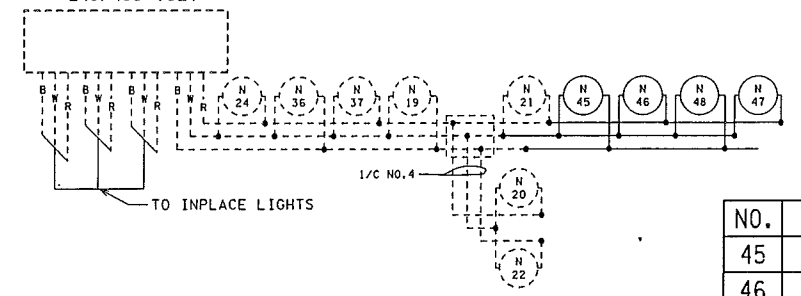

**FEEDPOINT A3N
LIGHTING STANDARDS AND BASES**

NO.	STATION	LT.	RT.	LOCATION	TYPE	WATT
45	35 + 20		X	RAMP D	9-40	250
46	33 + 25		X	RAMP D	9-40	250
47	334 + 67	X		RAMP F	9-40	250
48	333 + 22	X		RAMP F	9-40	250

**FEEDPOINT A3H
LIGHTING STANDARDS AND BASES**

NO.	STATION	LT.	RT.	LOCATION	TYPE	WATT
35	17 + 30		X	RAMP E	9-40	250
36	33 + 25		X	RAMP D	9-40	250

DASHED LINES DENOTE INPLACE ITEMS
 W DENOTES NEUTRAL CONDUCTOR
 B AND R DENOTE CURRENT CARRYING CONDUCTORS
 FD. PT. A3H
 240/480 VOLT

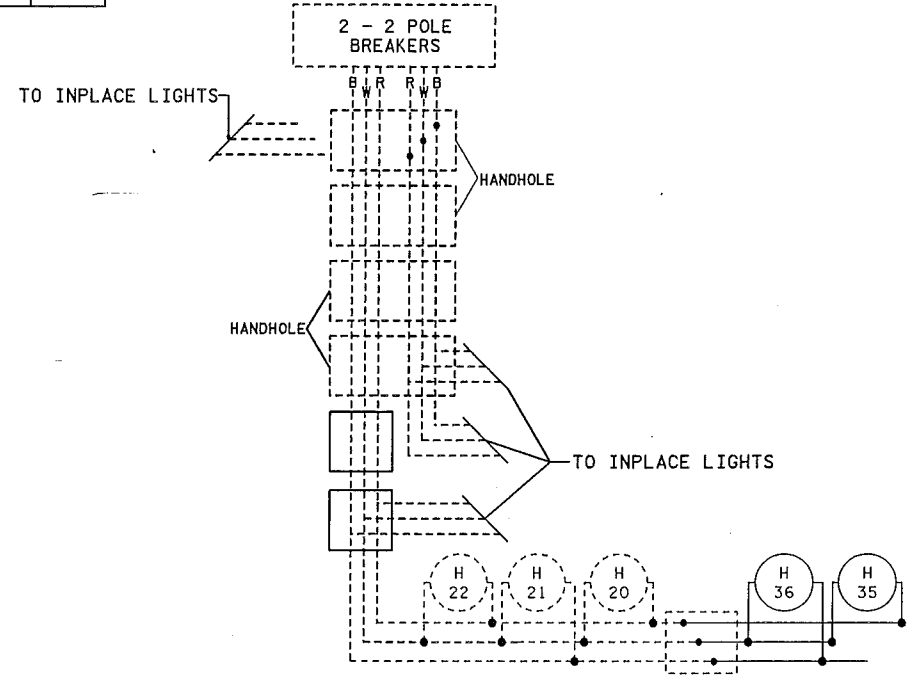

**FEEDPOINT A3L
LIGHTING STANDARDS AND BASES**

NO.	STATION	LT.	RT.	LOCATION	TYPE	WATT
(1) 1	737 + 85	X		RAMP 7	6B-40	250
(1) 2	140 + 75		X	LOOP 1A	6B-40	250
(1) 3	142 + 75		X	LOOP 1A	6B-40	250
4	144 + 00		X	LOOP 1A	L	250
5	144 + 65		X	LOOP 1A	L	250
6	145 + 10		X	LOOP 1A	L	250
7	145 + 55		X	LOOP 1A	L	250
(1) 8	147 + 20		X	LOOP 1A	6B-40	250
(1) 9	149 + 65		X	LOOP 1A	6B-40	250
10	152 + 20		X	LOOP 1A	9-40	250
11	47 + 75	X		WB TH 94	9-40	250
13	36 + 60		X	INPLACE	6BD - 40	
26						
14	41 + 10		X	INPLACE	6BD - 40	
25						
15	43 + 60		X	INPLACE	6BD - 40	
24						
16	46 + 10		X	INPLACE	6BD - 40	
23						
17	49 + 10		X	INPLACE	6BD - 40	
22						
18	51 + 60		X	INPLACE	6BD - 40	
21						
19	54 + 10		X	INPLACE	6BD - 40	
20						
(1) 27	13 + 35	X		RAMP E	6B-40	250
(1) 28	15 + 60	X		RAMP E	6B-40	250
(1) 29	734 + 75	X		RAMP 7	6B-40	250
(1) 30	737 + 00	X		RAMP 7	6B-40	250
31	739 + 35		X	RAMP 7	9-40	250
32	741 + 25		x	RAMP 7	9-40	250
33	44 + 30	X		94WB	9-40	250
34	52 + 35	X		94WB	9-40	250

(1) SEE TABLE "ACTUAL POLE HEIGHTS", DETAIL SHEET L2.

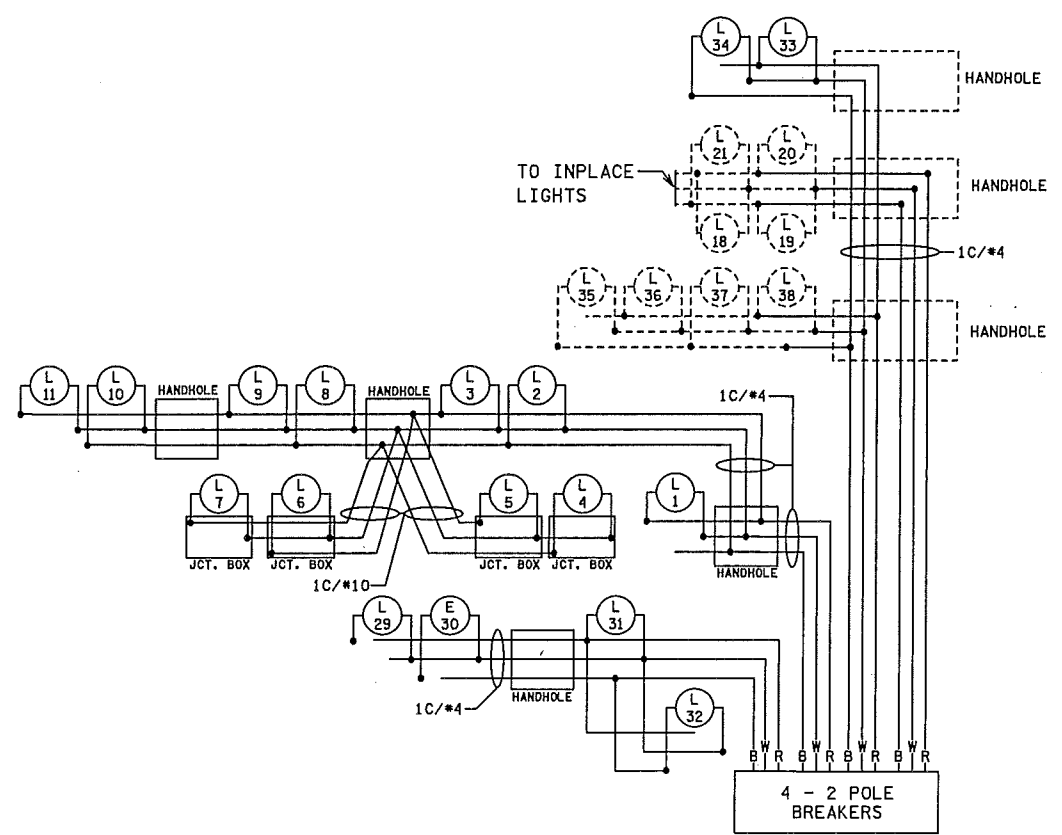

DASHED LINES DENOTE INPLACE ITEMS
 W DENOTES NEUTRAL CONDUCTOR
 B AND R DENOTE CURRENT CARRYING CONDUCTORS
 FD. PT. A3L
 240/480 VOLT

DASHED LINES DENOTE INPLACE ITEMS
 W DENOTES NEUTRAL CONDUCTOR
 B AND R DENOTE CURRENT CARRYING CONDUCTORS
 FD. PT. A3J
 240/480 VOLT

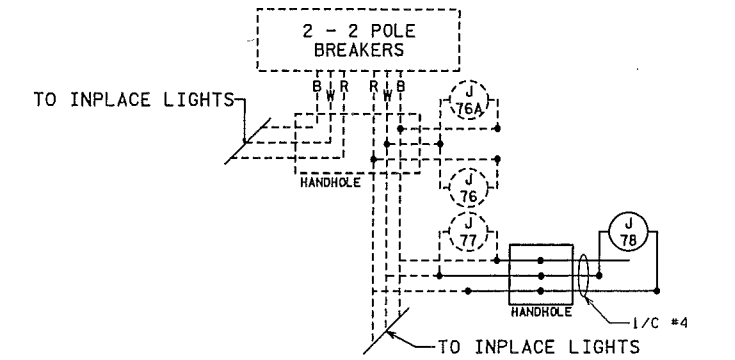

**FEEDPOINT A3J
LIGHTING STANDARDS AND BASES**

NO.	STATION	LT.	RT.	LOCATION	TYPE	WATT
(1) 77	INPLACE		X	94WB TO 52SB (W61B)	9-40	250
(1) 78	236 + 45	X		T.H. 52 SB	6B-40	250

(1) SEE TABLE "ACTUAL POLE HEIGHTS", DETAIL SHEET L2.

FD. PT. A3H, A3J, A3L, A3N

BY	DATE	REVISIONS	FEEDPOINT: A3H, A3J, A3L, A3N	LOCATION: T.H. 52	LIGHTING PLAN
PB	5/12/2011	Change pole A3L-31 to Type 9-40.	METER ADDRESS:		
DRAWN BY: PB CKD BY: GB DATE:			CERTIFIED BY: <i>Michael P. Gubinsky</i>	LIC. NO. 19863 DATE: 5/12/2011	STATE PROJ. NO. 6244-30 (T.H.52) SHEET NO. L17 OF L24 SHEETS

LEGEND

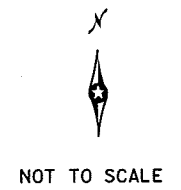
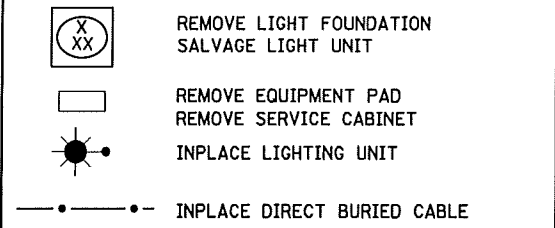

PLOTTED/REVISED: 10/11/2015

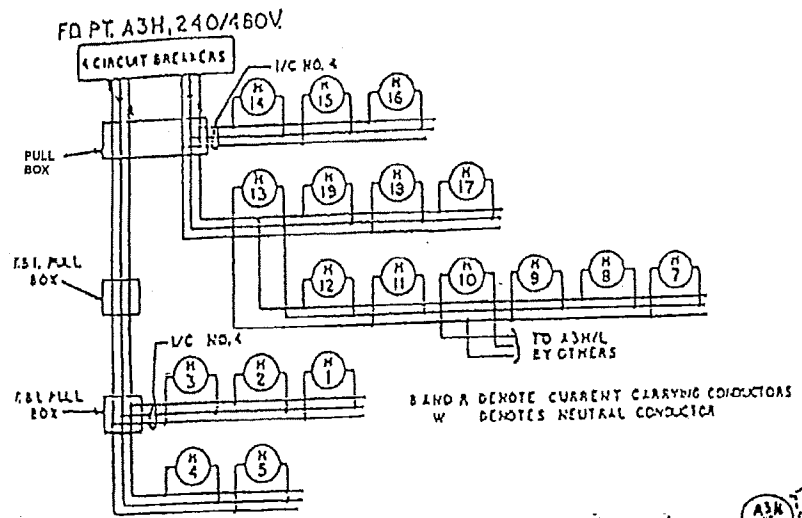

DISTRICT #: METRO
 IPLOT NAME: A3H removal sheet
 PATH & FILENAME: IP_PWP-dj6854776283-175.lj.dwg

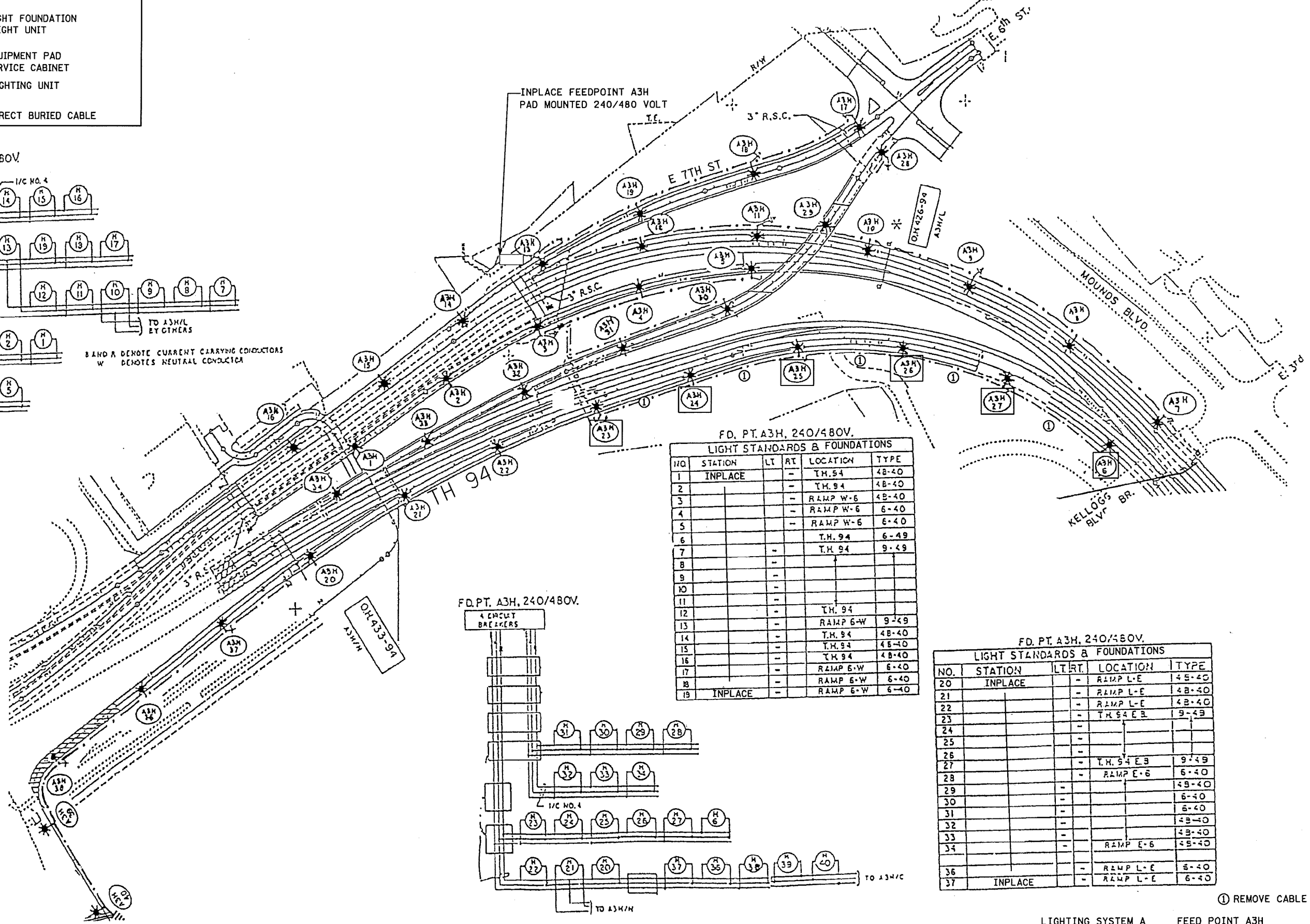

FD. PT. A3H, 240/480V.
 LIGHT STANDARDS & FOUNDATIONS

NO	STATION	LT	RT	LOCATION	TYPE
1	INPLACE	-	-	T.H. 94	4B-40
2		-	-	T.H. 94	4B-40
3		-	-	RAMP W-6	4B-40
4		-	-	RAMP W-6	6-40
5		-	-	RAMP W-6	6-40
6		-	-	T.H. 94	6-49
7		-	-	T.H. 94	9-49
8		-	-		
9		-	-		
10		-	-		
11		-	-		
12		-	-	T.H. 94	
13		-	-	RAMP 6-W	9-49
14		-	-	T.H. 94	4B-40
15		-	-	T.H. 94	4B-40
16		-	-	T.H. 94	4B-40
17		-	-	RAMP 6-W	6-40
18		-	-	RAMP 6-W	6-40
19	INPLACE	-	-	RAMP 6-W	6-40

FD. PT. A3H, 240/480V.
 LIGHT STANDARDS & FOUNDATIONS

NO.	STATION	LT	RT	LOCATION	TYPE
20	INPLACE	-	-	RAMP L-E	4B-40
21		-	-	RAMP L-E	4B-40
22		-	-	RAMP L-E	4B-40
23		-	-	T.H. 94 E 3	9-49
24		-	-		
25		-	-		
26		-	-		
27		-	-	T.H. 94 E 3	9-49
28		-	-	RAMP E-6	6-40
29		-	-		4B-40
30		-	-		6-40
31		-	-		6-40
32		-	-		4B-40
33		-	-		4B-40
34		-	-	RAMP E-6	6B-40
36		-	-	RAMP L-E	6-40
37	INPLACE	-	-	RAMP L-E	6-40

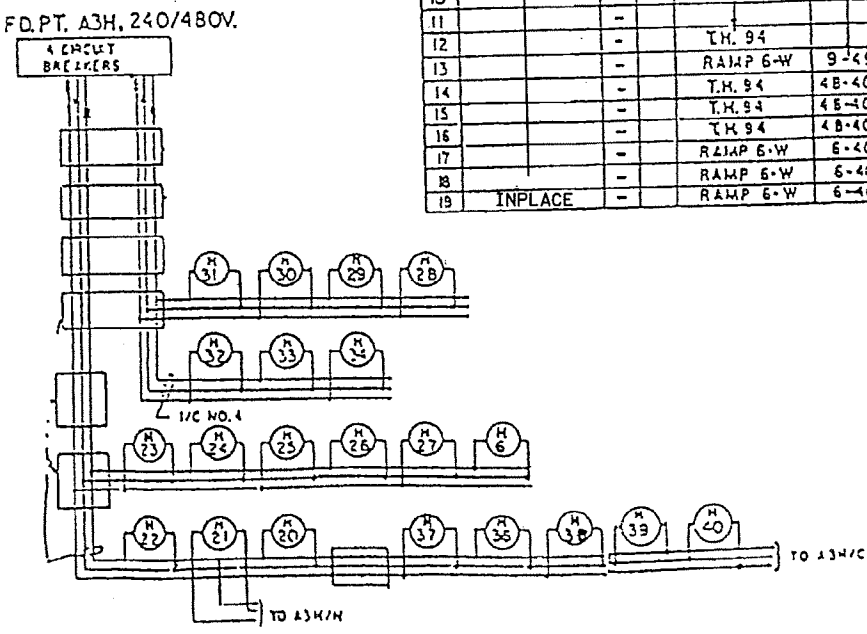

① REMOVE CABLE BETWEEN POLES

LIGHTING SYSTEM A FEED POINT A3H

BY	DATE	REVISIONS

DRAWN BY: SJK CKD BY: PB DATE: 07-10-15

CERTIFIED BY *Michael P. Lubinsky* LIC. NO. 19863 DATE: 10/1/2015
LICENSED PROFESSIONAL ENGINEER

REMOVAL PLAN

STATE PROJ. NO. 6283-175 (T.H. 94) SHEET NO. SL5 OF SL10 SHEETS