

LEGEND

- Pad mounted source of power (240/480 volt)
- ☀ 250 Watt High Pressure Sodium Lighting Unit
- ☀☀ 250 Watt Twin High Pressure Sodium Lighting Unit
- ☀☀☀ 250 Watt High Pressure Sodium Underpass Lighting Fixture
- === 3" Non-metallic Conduit Except As Noted Otherwise
- - - Direct Buried Power Cable 3 Conductor # 4 AWG
Armored Cable Spec. # 3815
- ||| Permanent Ground Rod (25 Ohms or Less)
- Handhole

Pad mounted source of power
Service Cabinet Secondary Type L1
Fd. Pt. 19L1 (240/480 Volt) - Metered
F & I 2" R.S.C. and 3-1/C #2
To Xcel Energy Transformer
Equipment Pad B Required

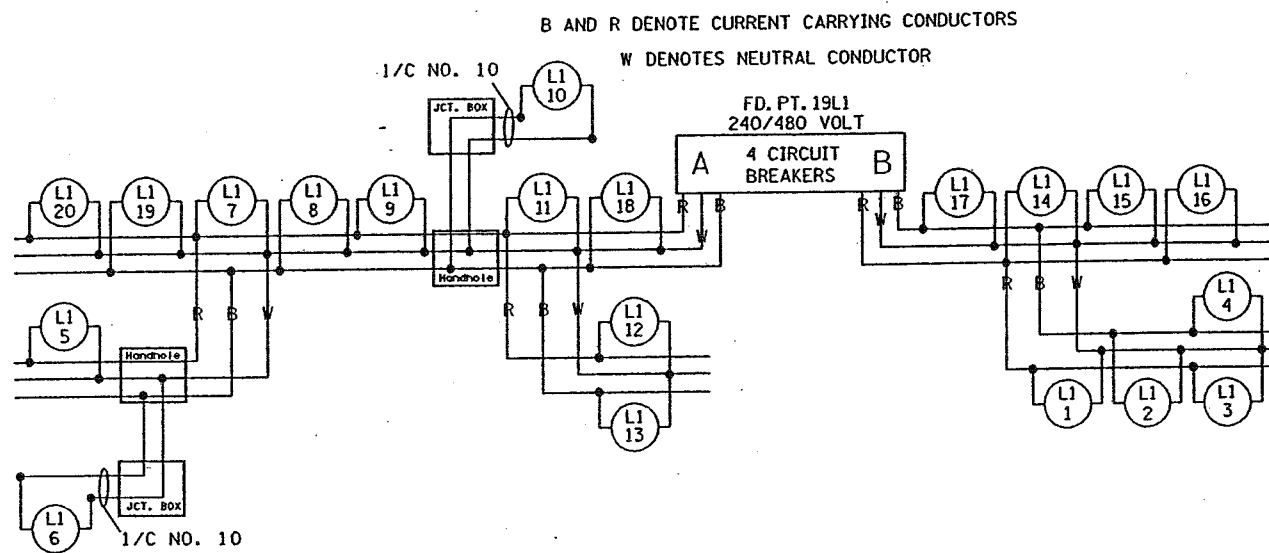
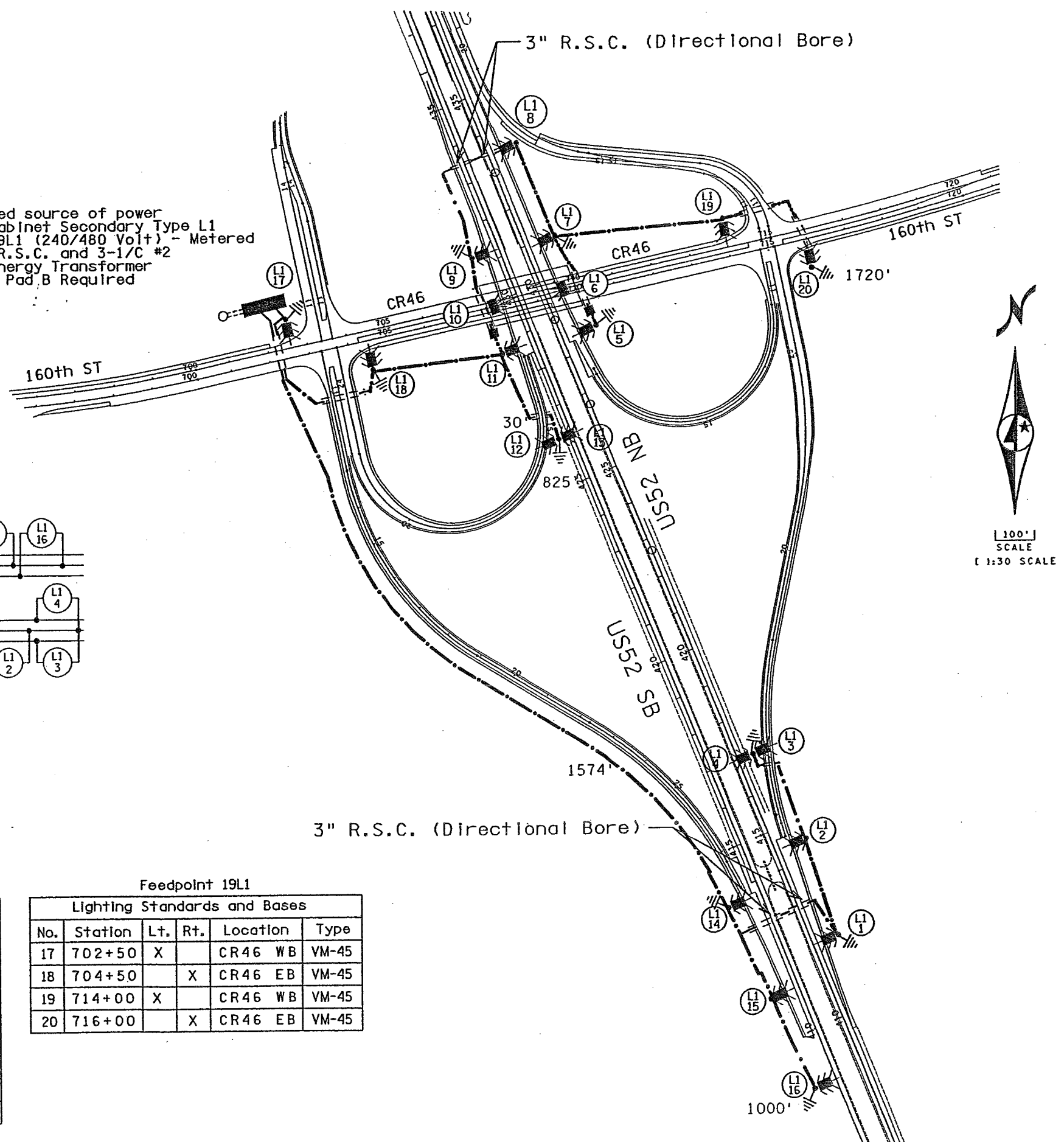

Feedpoint 19L1

Lighting Standards and Bases					
No.	Station	Lt.	Rt.	Location	Type
1	411+95		X	TH52 NB	VM-45
2	414+45		X	TH52 NB	VM-45
3	416+95		X	TH52 NB	VMD-45
4					
5	428+43		X	TH52 NB	VM-45
6	429+75		X	TH52 NB	L
7	430+93		X	TH52 NB	VM-45
8	433+43		X	TH52 NB	VM-45

Feedpoint 19L1

Lighting Standards and Bases					
No.	Station	Lt.	Rt.	Location	Type
9	431+22	X		TH52 SB	VM-45
10	429+91	X		TH52 NB	L
11	428+72	X		TH52 SB	VM-45
12	426+22	X		TH52 SB	VMD-45
13					
14	413+65	X		TH52 SB	VM-45
15	411+15	X		TH52 SB	VM-45
16	408+65	X		TH52 SB	VM-45

Feedpoint 19L1

Lighting Standards and Bases					
No.	Station	Lt.	Rt.	Location	Type
17	702+50	X		CR46 WB	VM-45
18	704+50		X	CR46 EB	VM-45
19	714+00	X		CR46 WB	VM-45
20	716+00		X	CR46 EB	VM-45

LIGHTING PLAN