

INPLACE XCEL ENERGY POLE  
F. & I. - 2" R.S.C. RISER & WEATHERHEAD  
AND 3-1/C #2

F. & I. - 2" R.S.C. & 3-1/C #2 TO  
XCEL ENERGY TRANSFORMER

FEED POINT 10A3 (METERED)  
POLE MOUNTED SOURCE OF POWER  
SERVICE CABINET SECONDARY TYPE B  
F. & I. 15 FT. WOOD POLE (CLASS 5)

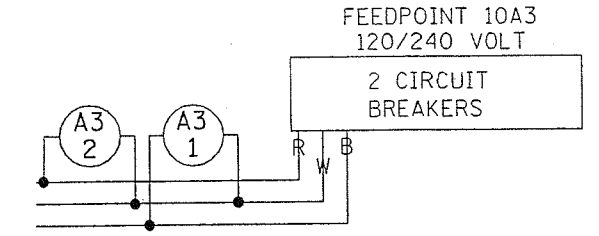

B AND R DENOTE CURRENT CARRYING CONDUCTORS  
W DENOTES NEUTRAL CONDUCTOR

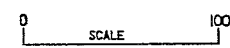
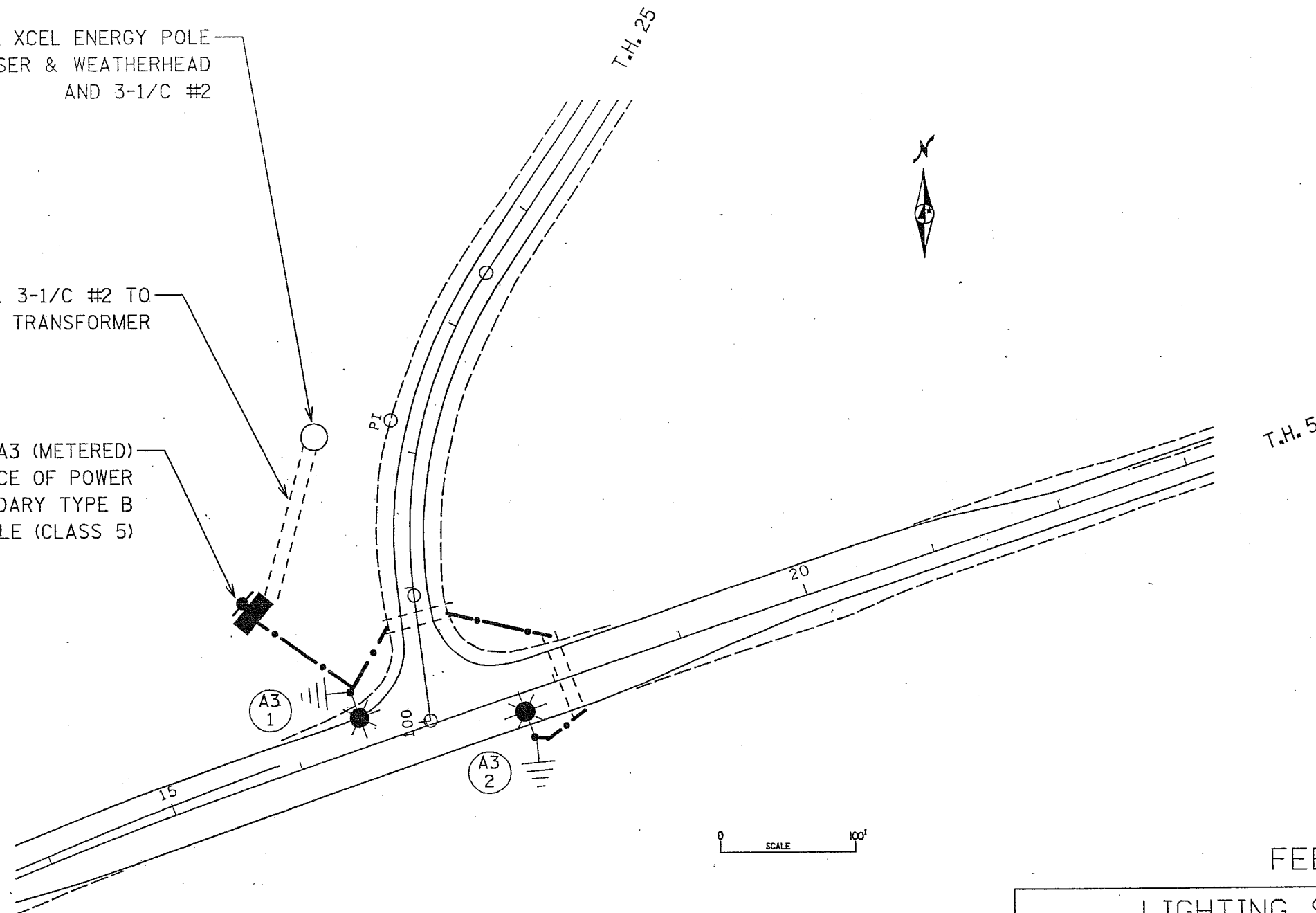





FEED POINT 10A3

LIGHTING STANDARDS AND BASES					
NO.	STATION	LT.	RT.	LOCATION	TYPE
1	16+50	-		TH 5	12-40
2	17+70		-	TH 5	12-40

SEE DETAIL FOR PLACEMENT OF LIGHTING UNITS

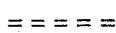
LEGEND

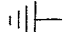
-  POLE MOUNTED SOURCE OF POWER (120/240 VOLT)
-  LIGHTING UNIT TYPE 12-40 (250W HPS)
-  3" NON-METALIC CONDUIT (DIRECTIONAL BORED)  
EXCEPT AS NOTED OTHERWISE
-  DIRECT BURIED POWER CABLE 3 CONDUCTOR NO. 4 AWG  
ARMORED CABLE SPEC. NO. 3815
-  PERMANENT GROUND ROD (25 OHMS OR LESS)

UTILITY OWNERS

- MEDIA FIBER - TV CABLE
- SPRINT - TELECOMMUNICATIONS

NO UTILITIES WILL BE AFFECTED BY THIS PROJECT  
ALL WORK IS WITHIN Mn/DOT RIGHT OF WAY

LIGHTING PLAN  
JUNCTION OF TH 25 & TH 5