



LEGEND

-  LIGHTING UNIT IDENTIFIER
-  LIGHTING UNIT 6BD-40

PLOTTED/REVISED: 9-OCT-2018

I/PLOT NAME: 62J5-6
PATH & FILENAME: Projects\DM_R0S\06\6220\083\Traffic\Lighting\6220-83.ltr.loadgn

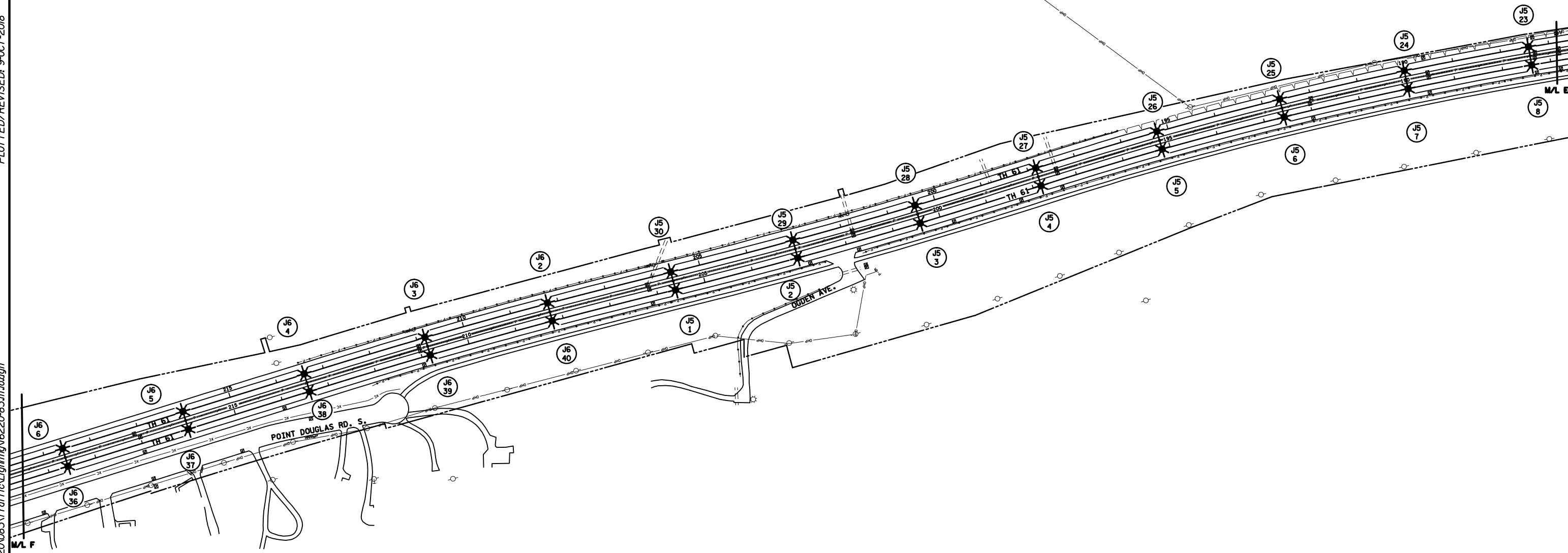

**FEEDPOINT 62J6
LIGHTING UNIT LOCATION AND TYPE**

NO.	STATION	LT.	RT.	LOCATION	TYPE	FOUNDATION
(1) 2	N.B. 208+20			T.H. 61	6BD-40	N/A
40				MEDIAN		
3	N.B. 210+80					
39						
4	N.B. 213+40					
38						
5	N.B. 216+00					
37						
6	N.B. 218+60	X		T.H. 61	6BD-40	N/A
(1) 36				MEDIAN		

(1) INSTALL SALVAGED LUMINAIRES

**FEEDPOINT 62J5
LIGHTING UNIT LOCATION AND TYPE**

NO.	STATION	LT.	RT.	LOCATION	TYPE	FOUNDATION
(1) 1	S.B. 205+70	X		T.H. 61	6BD-40	N/A
30						
2	S.B. 203+00	X				
29						
3	S.B. 200+40	X				
28						
4	S.B. 197+80	X				
27						
5	S.B. 195+20	X				
26						
6	S.B. 192+50	X				
25						
7	S.B. 190+00	X				
24						
8	S.B. 187+40	X		T.H. 61	6BD-40	N/A
(1) 23						

(1) INSTALL SALVAGED LUMINAIRES

METER ADDRESS: 62J5 1000 BATAVIA ST., ST. PAUL 55119
62J6 1320 TH 61, NEWPORT 55055

FEEDPOINT: 62J5 & 62J6 LOCATION: TH 61

LIGHTING PLAN



200

SCALE IN FEET

BY	DATE	REVISIONS











CERTIFIED BY Michael P. Dubinsky LIC. NO. 19863 DATE: 9-OCT-2018
LICENSED PROFESSIONAL ENGINEER

STATE PROJ. NO. 6220-83 (T.H. 61) SHEET NO. 17 OF 25 SHEETS

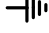
PLOTTED/REVISED: 9-OCT-2018

I/PLOT NAME: 62J6
PATH & FILENAME: Projects\DM_R05\06\6220\083\Traffic\Lighting\6220-83.ltr.dgn

LEGEND

-  LIGHTING UNIT IDENTIFIER
-  LIGHTING UNIT
-  LIGHTING UNIT 9BD-40
-  INPLACE LIGHTING UNIT
-  PERMANENT GROUND ROD (25 OHMS OR LESS)
-  DIRECT BURIED CABLE 4 CONDUCTOR NO. 4
-  FD. PT. CABINET
-  HANDHOLE
-  3" PVC (UNLESS OTHERWISE NOTED)
-  INPLACE CONDUIT

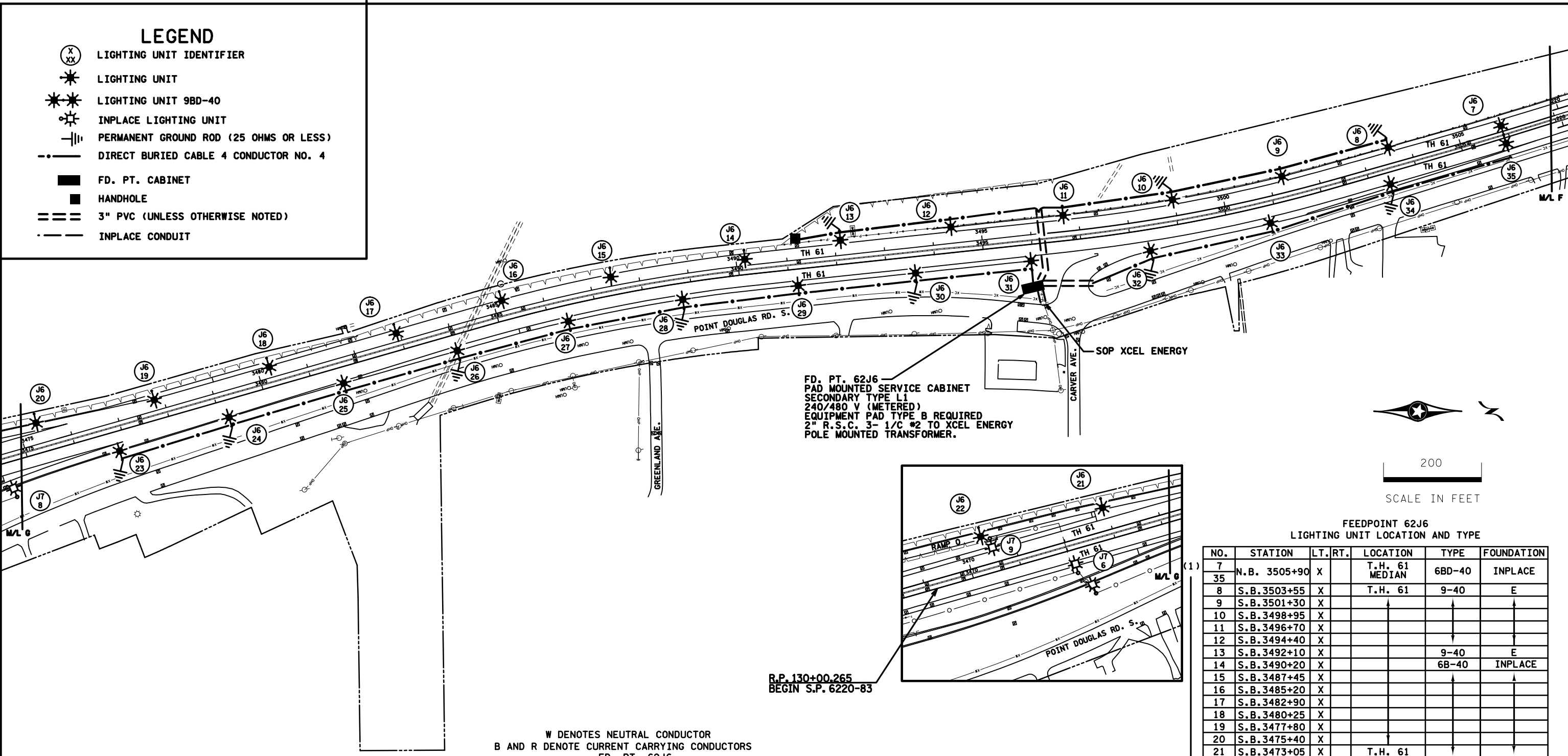

FD. PT. 62J6
PAD MOUNTED SERVICE CABINET
SECONDARY TYPE L1
240/480 V (METERED)
EQUIPMENT PAD TYPE B REQUIRED
2" R.S.C. 3- 1/C #2 TO XCEL ENERGY
POLE MOUNTED TRANSFORMER.



200
SCALE IN FEET

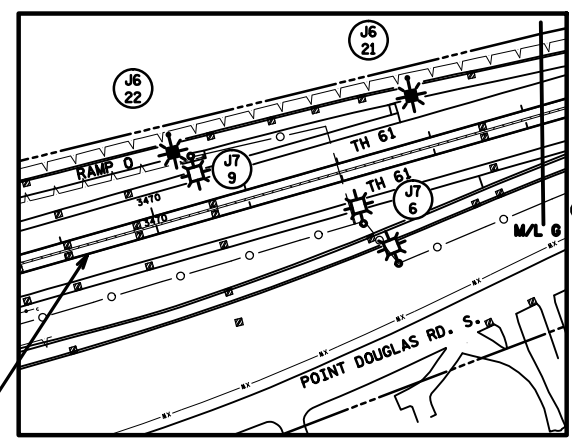

R.P. 130+00.265
BEGIN S.P. 6220-83

W DENOTES NEUTRAL CONDUCTOR
B AND R DENOTE CURRENT CARRYING CONDUCTORS
FD. PT. 62J6
240/480 VOLT

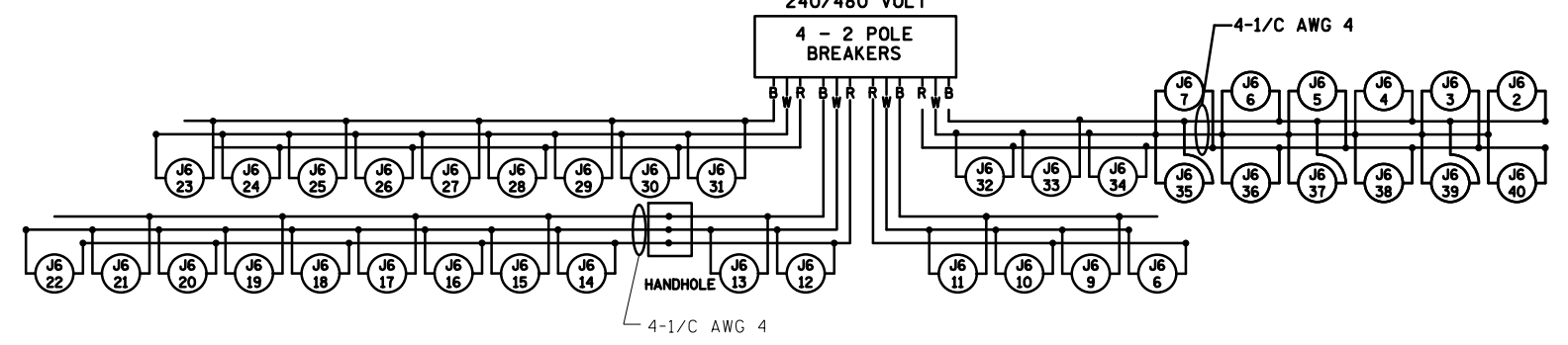

FEEPPOINT 62J6
LIGHTING UNIT LOCATION AND TYPE

NO.	STATION	LT.	RT.	LOCATION	TYPE	FOUNDATION
7	N.B. 3505+90	X		T.H. 61	6BD-40	INPLACE
35	S.B. 3503+55	X		T.H. 61	9-40	E
8	S.B. 3501+30	X				
9	S.B. 3498+95	X				
10	S.B. 3496+70	X				
11	S.B. 3494+40	X				
12	S.B. 3492+10	X			9-40	E
13	S.B. 3490+20	X			6B-40	INPLACE
14	S.B. 3487+45	X				
15	S.B. 3485+20	X				
16	S.B. 3482+90	X				
17	S.B. 3480+25	X				
18	S.B. 3477+80	X				
19	S.B. 3475+40	X				
20	S.B. 3473+05	X		T.H. 61		
21	S.B. 3471+60	X		RAMP 0	6B-40	INPLACE
22	N.B. 3476+85	X	X	T.H. 61	9-40	E
23	N.B. 3479+20	X				
24	N.B. 3481+60	X				
25	N.B. 3484+00	X				
26	N.B. 3486+40	X				
27	N.B. 3488+80	X				
28	N.B. 3491+20	X				
29	N.B. 3493+60	X				
30	N.B. 3495+95	X				
31	N.B. 3498+40	X				
32	N.B. 3500+85	X				
33	N.B. 3503+40	X	X	T.H. 61	9-40	E

(1)

(1) INSTALL SALVAGED LUMINAIRES

BY	DATE	REVISIONS	FEEPPOINT: 62J6	LOCATION: TH 61	LIGHTING PLAN
			METER ADDRESS: 1320 TH 61, NEWPORT 55055		
DRAWN BY: BAM			CERTIFIED BY: <i>Michael P. Dubinsky</i>		STATE PROJ. NO. 6220-83 (T.H. 61) SHEET NO. 18 OF 25 SHEETS
CKD BY: PB			LIC. NO. 19863 DATE: 9-OCT-2018		