

5.28.20 E.T.

10.14.20	1.12.22
1.4.21	8.31.22
9.15.21	1.26.23
	8.11.23
	1.30.24

Cell 7015 W
CELL 7005W
0-50 ft

CL Crack 500'

26+58
CL KITTRIDGE

26+50

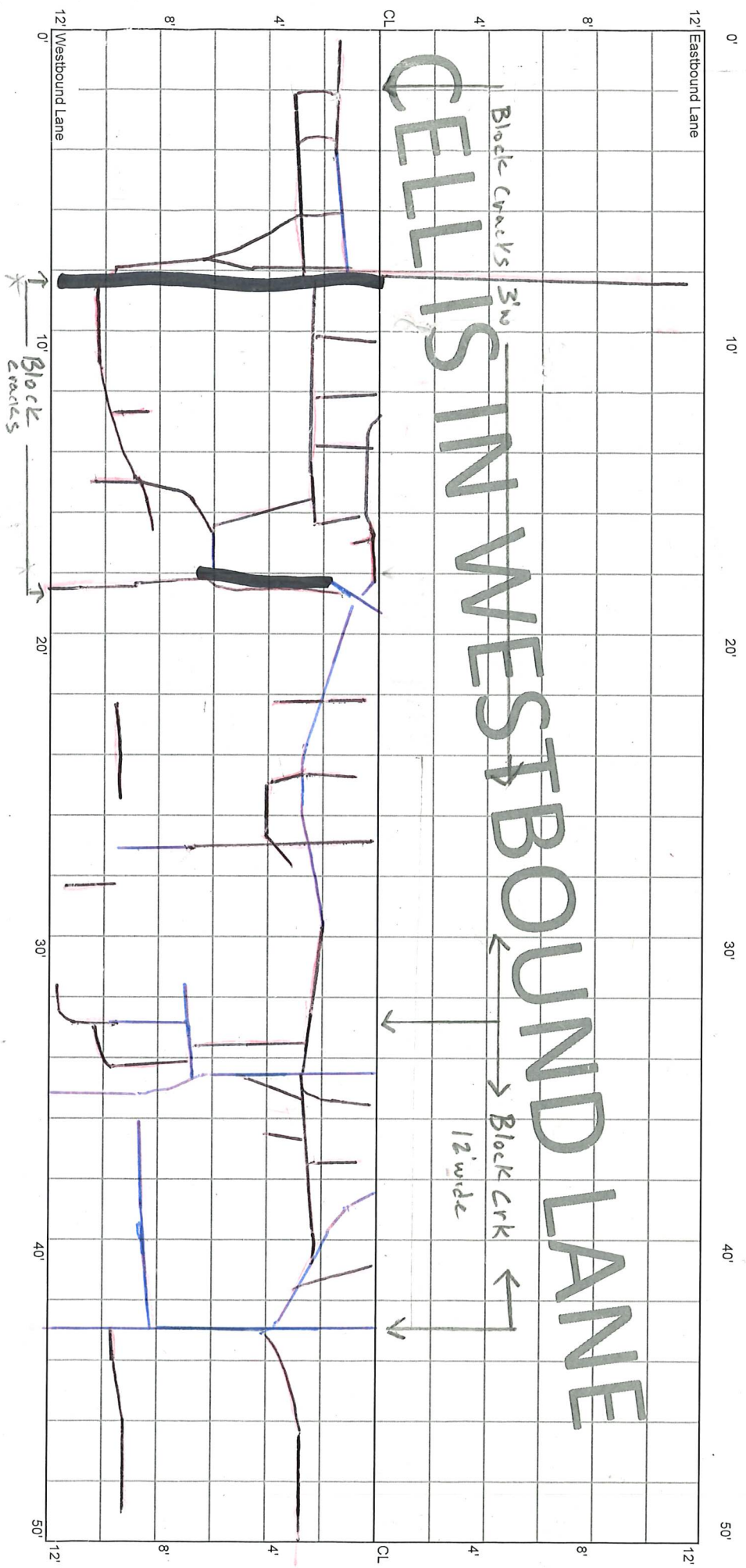

* ROAD SEAL
** 2023 Clean & Seal

CELL 7005W
50 - 100 ft

26+50

26+00

12' Eastbound Lane

12'

CELLS IN WESTBOUND LANE

12' Westbound Lane

12'



CELL 7005W
100 - 150 ft

26+00

26+50

12' Eastbound Lane

12'

12' Westbound Lane

12'

CELLS IN WESTBOUND LANE

Block Cracks

Med

Height

-B.C. →

←

B. Crk,

→

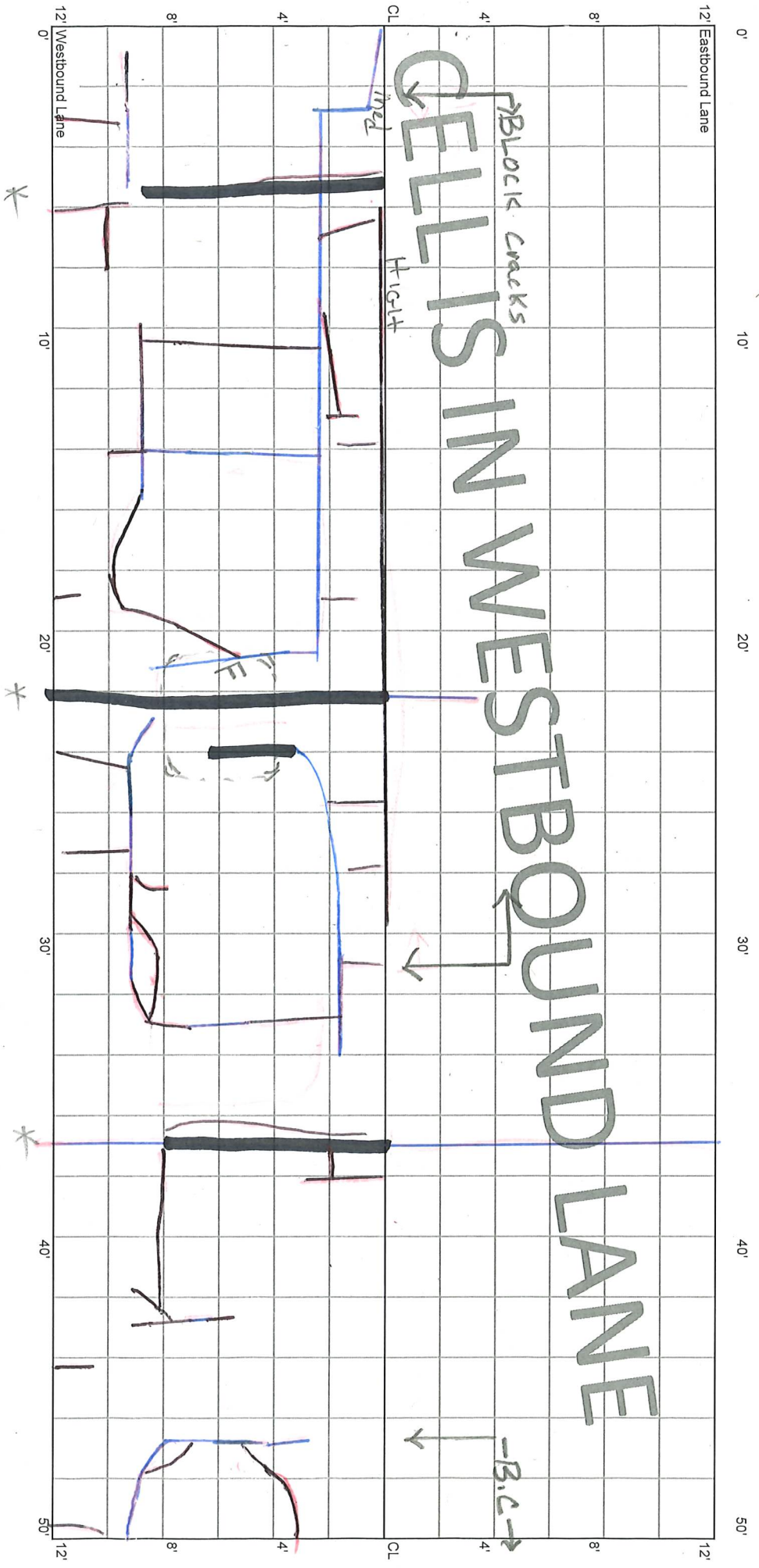

CELL 7005W
150 - 200 ft

25+50

25+00

12' Eastbound Lane

12'

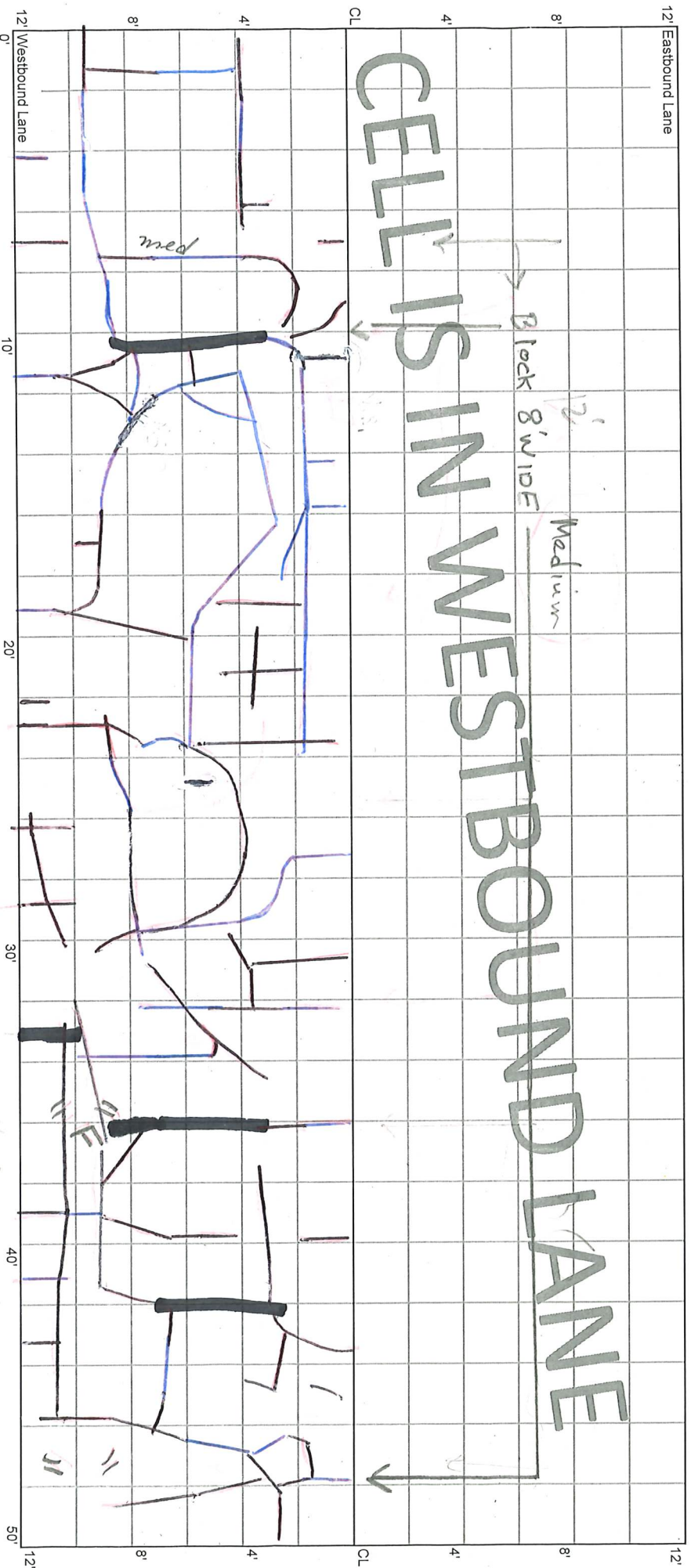

CELLS IN WESTBOUND LANE

Block 8' wide
12' Medium

med

M

G
SP

12' Westbound Lane

12'

CELL 7005W
200 - 250 ft

25+00

24+50

CELLS IN WESTBOUND LANE

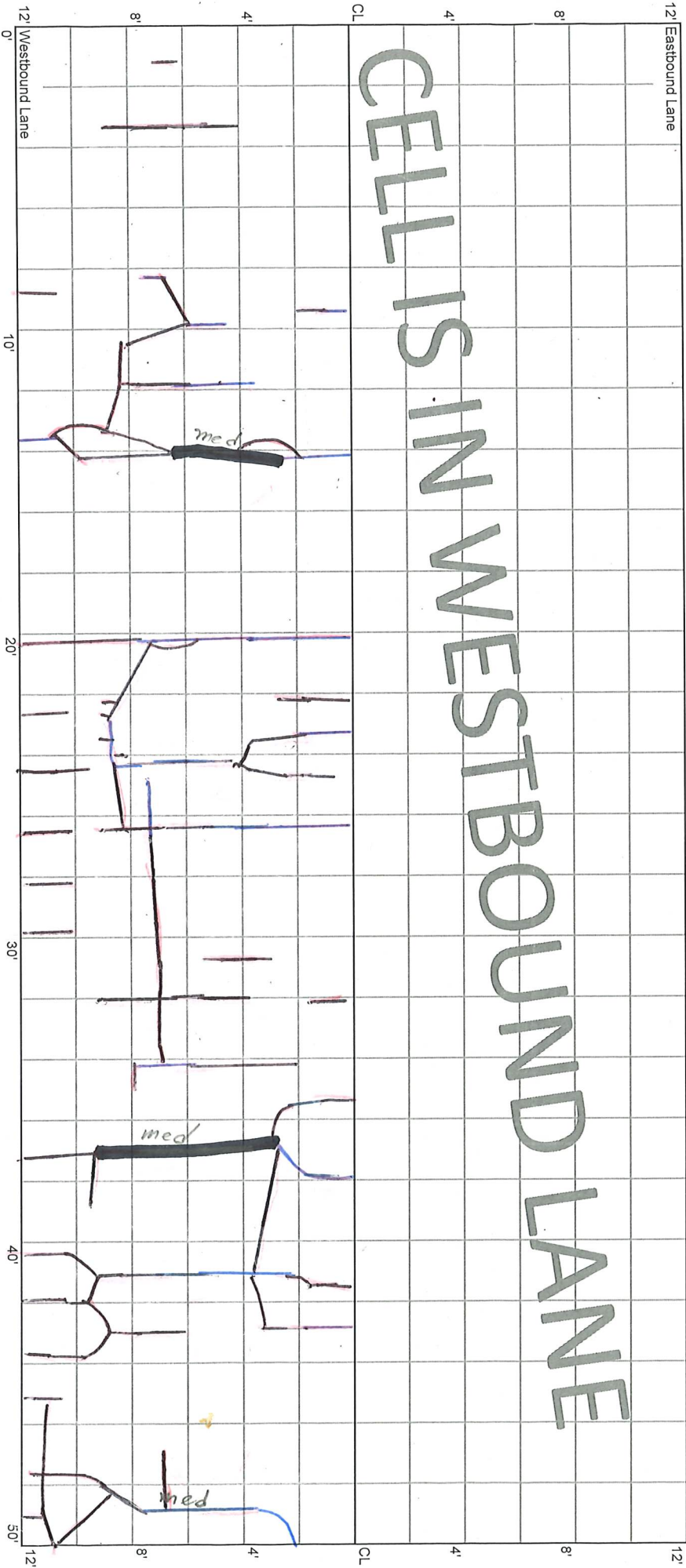

CELL 7005W
250 - 300 ft

24+50

24+00

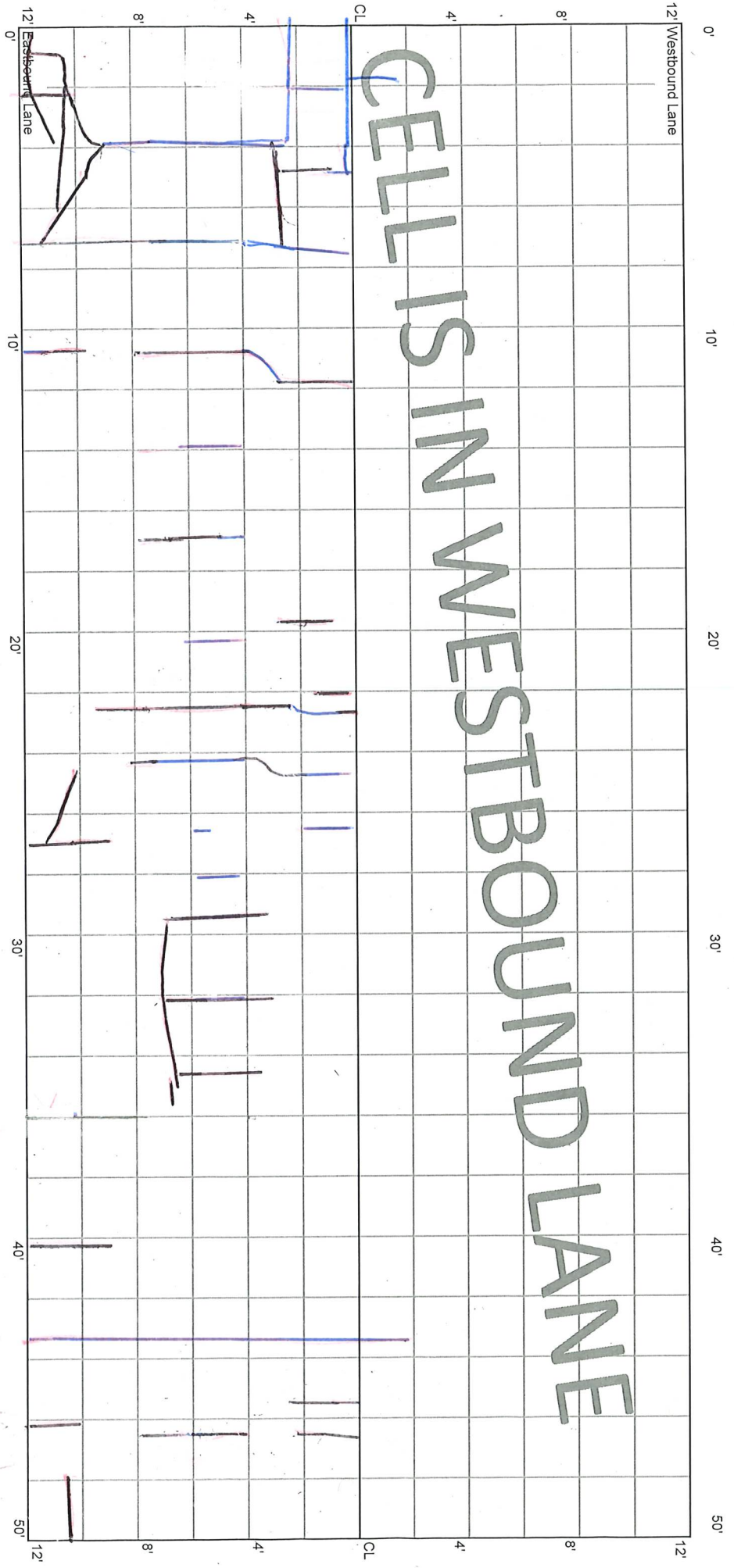

12' Westbound Lane

12' Eastbound Lane

M

CELL 7005W
300 - 350 ft

24+00

23+50

12' Eastbound Lane

0' 10' 20' 30' 40' 50'

CELLS IN WESTBOUND LANE

12' Westbound Lane 0' 10' 20' 30' 40' 50'

M

314'

319'

M

* AF

355'

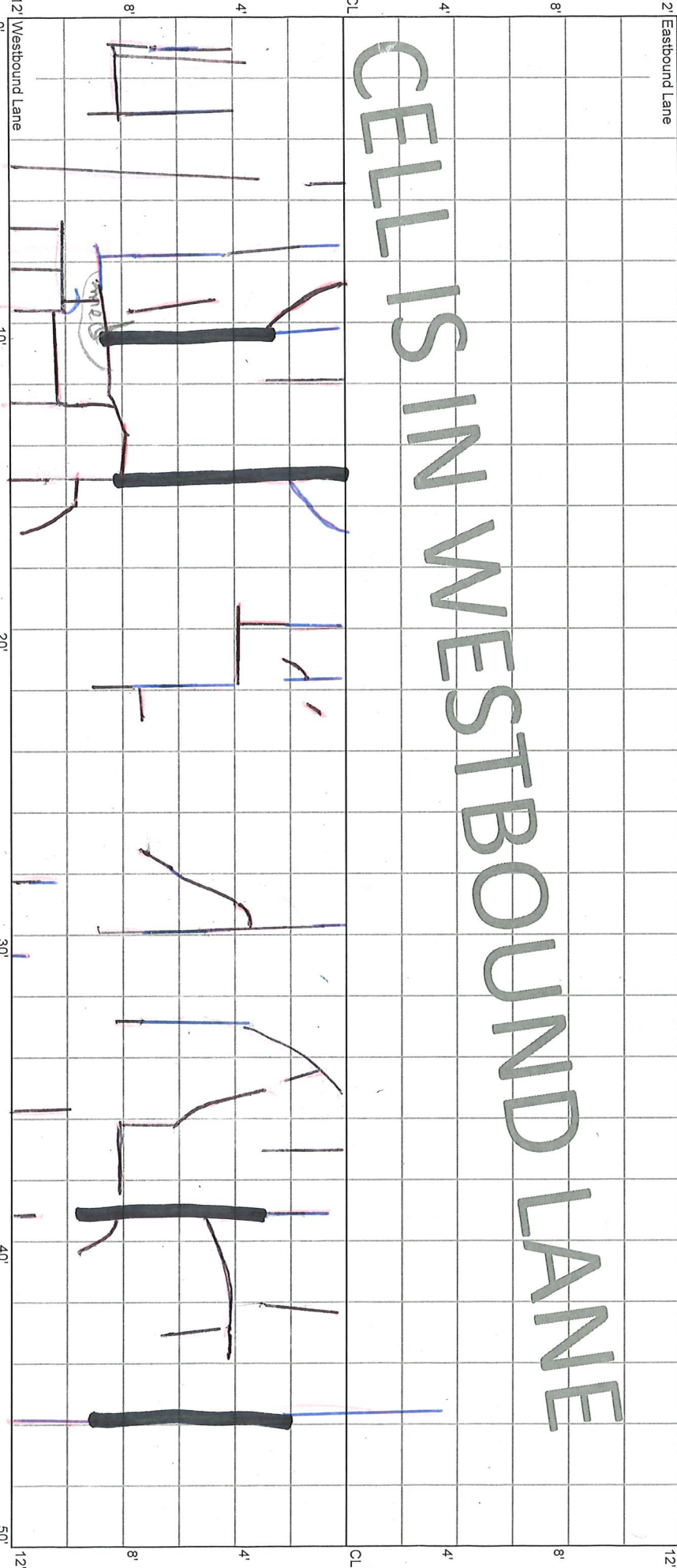

CELL 7005W
350 - 400 ft

23+50

23+00

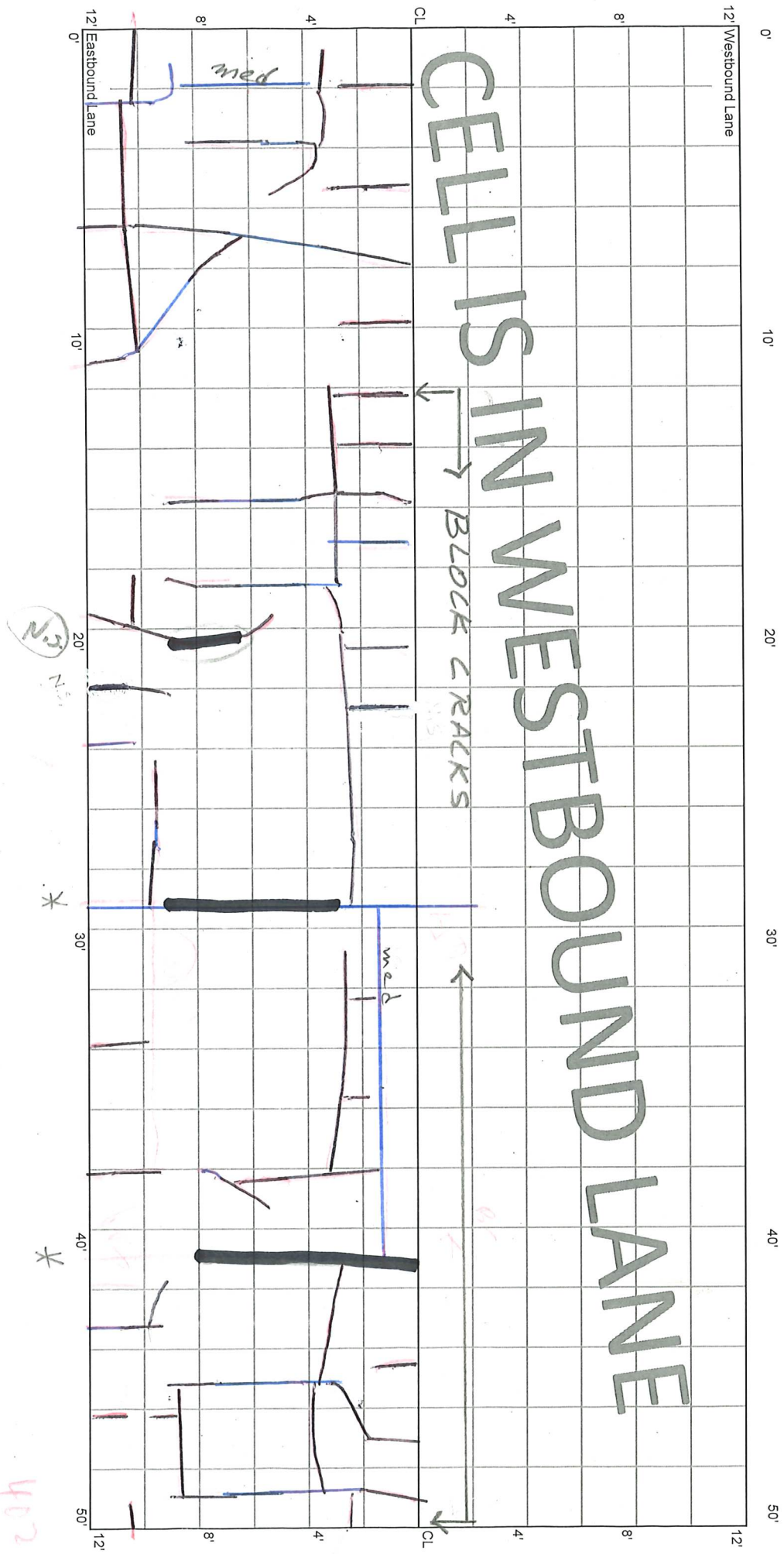

CELL 7005W
400 - 450 ft

23+00

22+50

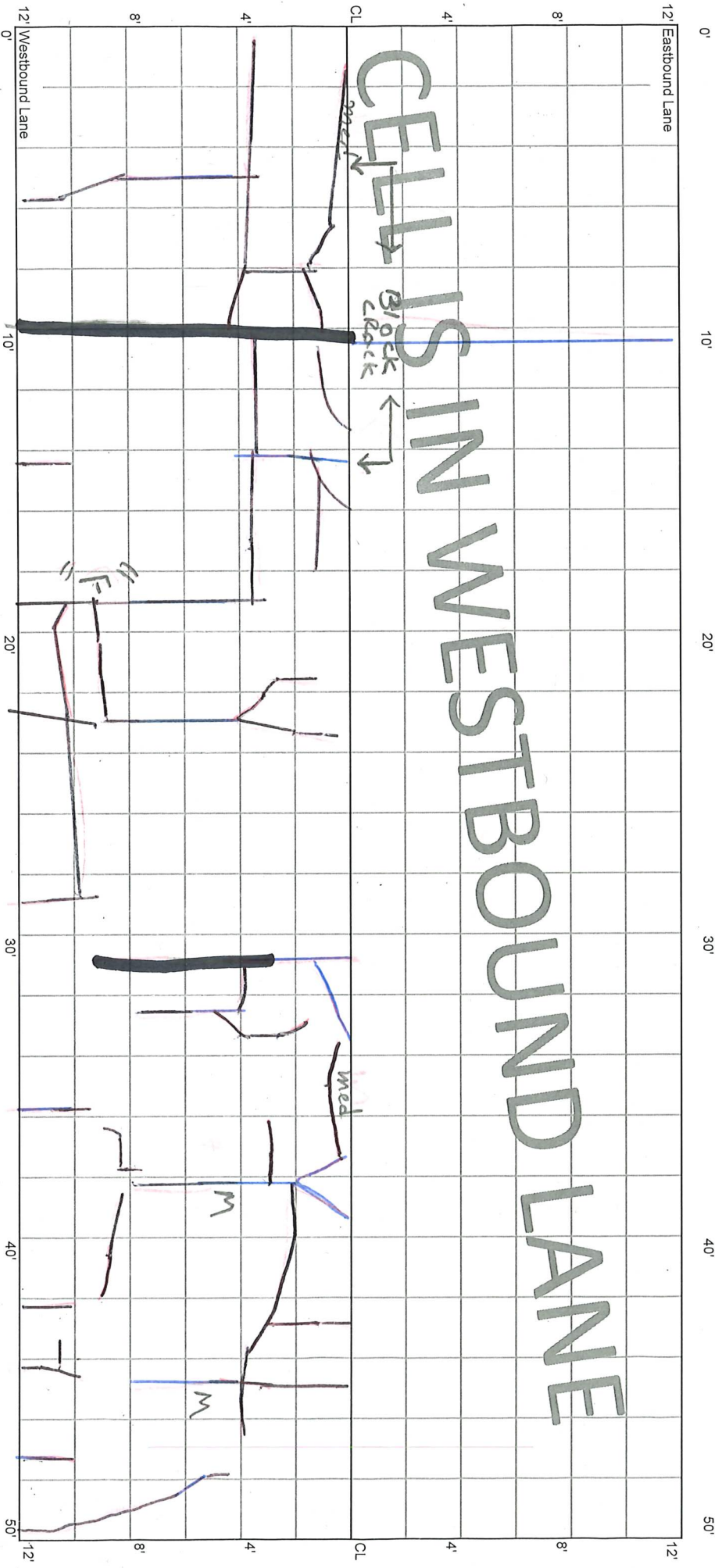

CELLS IN WESTBOUND LANE

Block Crack

med

M

M

* AF

*

CELL 7005W
500 - 550 ft

22+00

21+75

21+50

0'

10'

20'

25'

30'

40'

50'

12' Eastbound Lane

12'

8'

8'

4'

4'

CL

CL

4'

4'

8'

8'

CELL IS IN WESTBOUND LANE

END RATING: BEGIN TRANSITION TO
NEXT CELL

12' Westbound Lane

12'

10'

20'

25'

30'

40'

50'