

5.28.20 - E.S.
 10.14.20 1.11.22
 1.4.21 8.31.22
 File 70TH ST 2.2.23
 8.25.21 8.11.23
 2.21.24

CELL 7008E
 0 - 50 ft

38+50

39+00

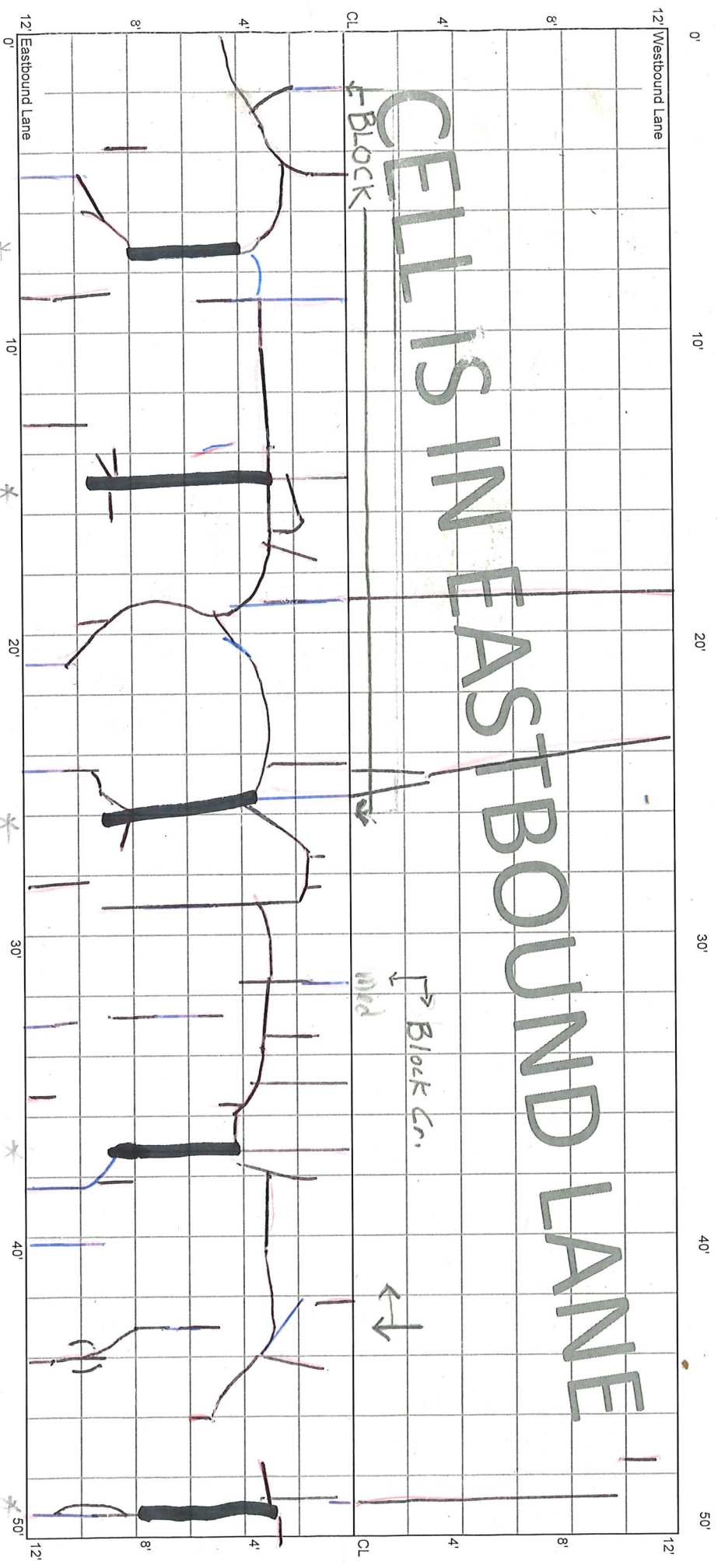

* Root & Seal
 ** 2023 Clean & Seal

* SP

* AF SP

* SP

* SP

* SP

CELL 7008E
50 - 100 ft

39+00

39+50

12' Westbound Lane

12' Eastbound Lane

CELLS IN EASTBOUND LANE

Block 3' wide →

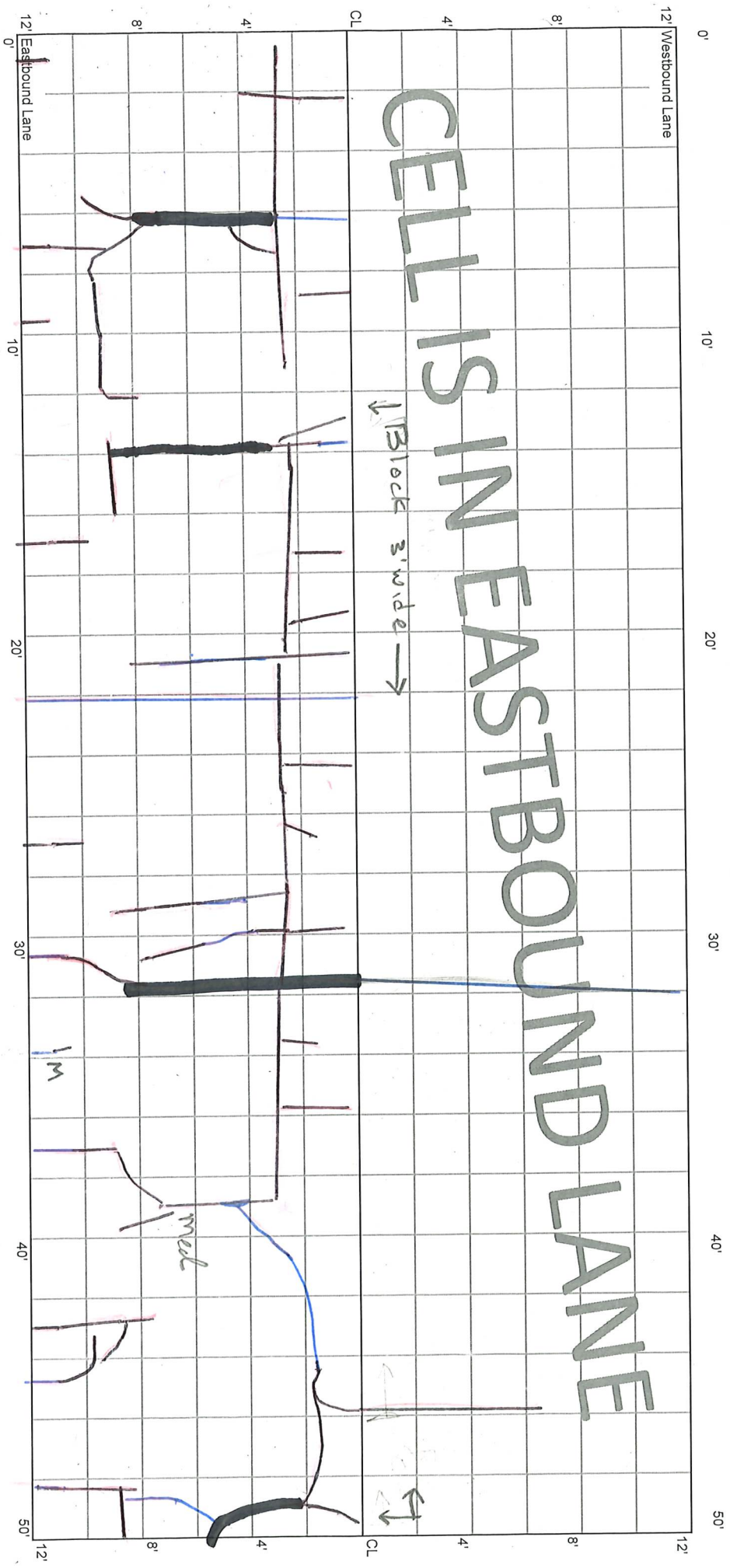

M
SP

SP

SP

1M

med

←

CELL 7008E
100 - 150 ft

39+50

40+00

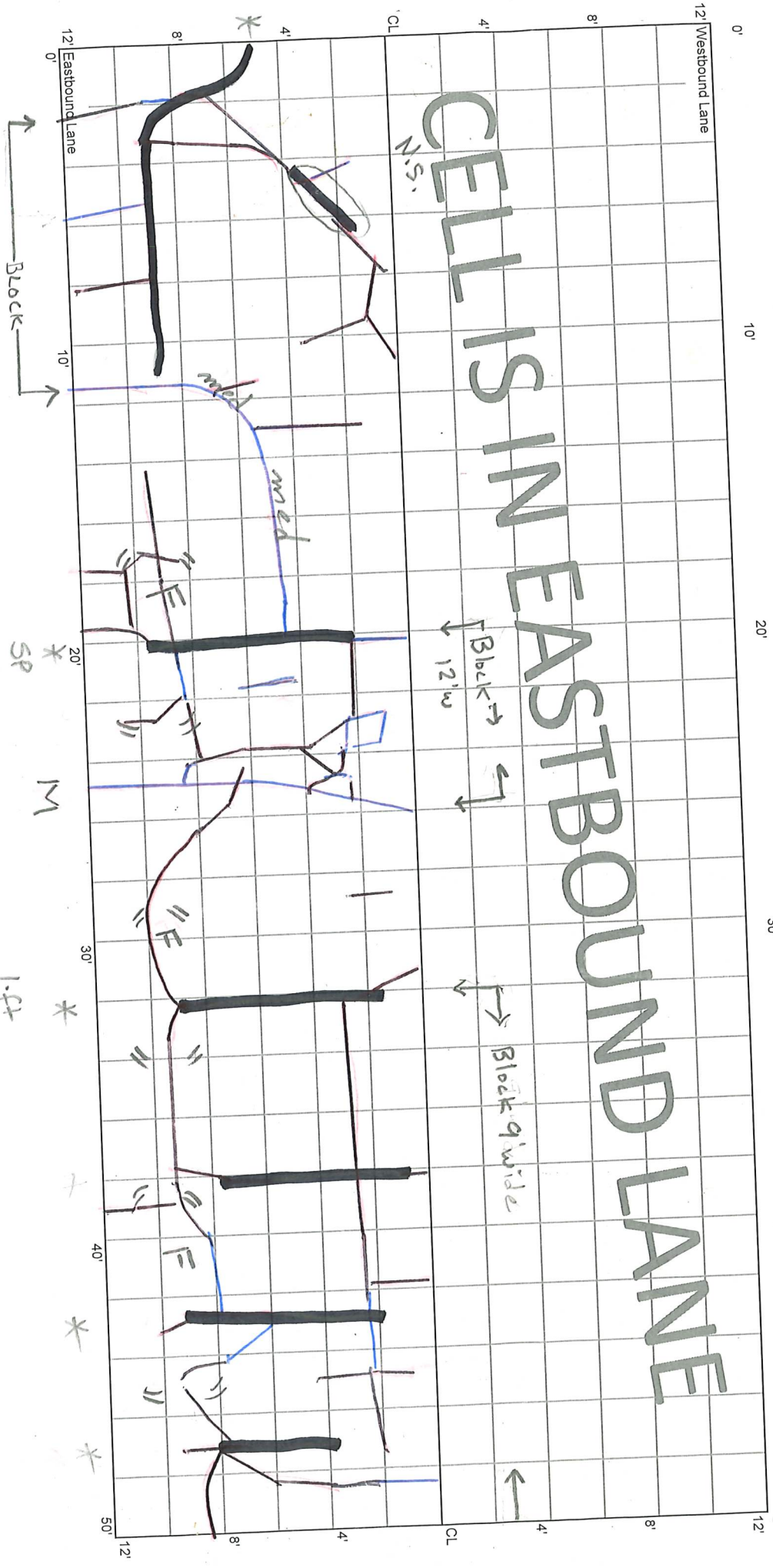

CELLS IN EASTBOUND LANE

Block

Block 12' wide

Block 9' wide

1.4 loose Seal
AF, SP

M

SP

12' Eastbound Lane

12' Westbound Lane

0'

0'

10'

20'

30'

40'

50'

0'

10'

20'

30'

40'

50'

CL

4'

8'

12'

4'

8'

4'

CL

4'

8'

12'

0'

Block

10'

20'

30'

40'

50'

CL

4'

8'

12'

CELL 7008E
150 - 200 ft

40+00

40+50

12' Westbound Lane

12' Eastbound Lane

CELLS IN EASTBOUND LANE

Block Cracks - 12' wide

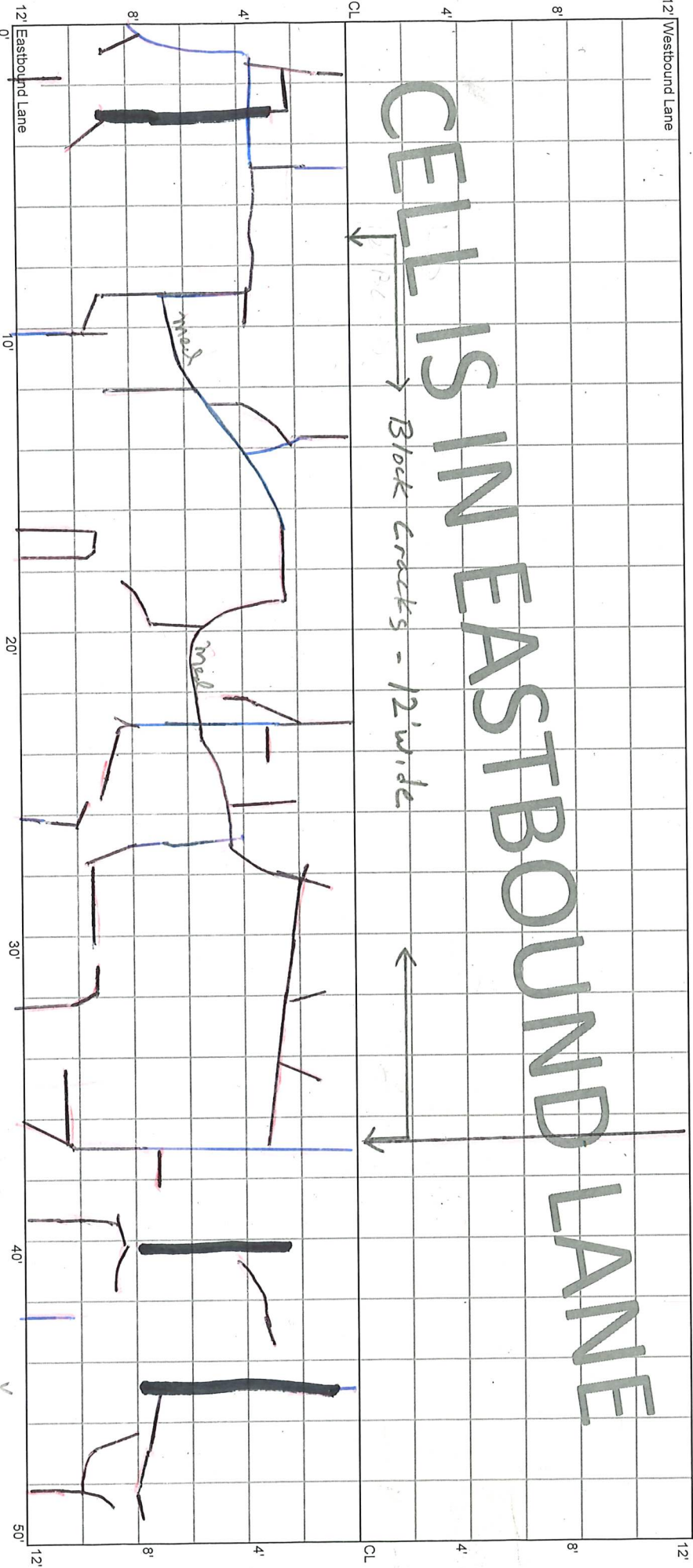

*
6' Seal

192

CELL 7008E
200 - 250 ft

40+50

41+00

CELLS IN EASTBOUND LANE

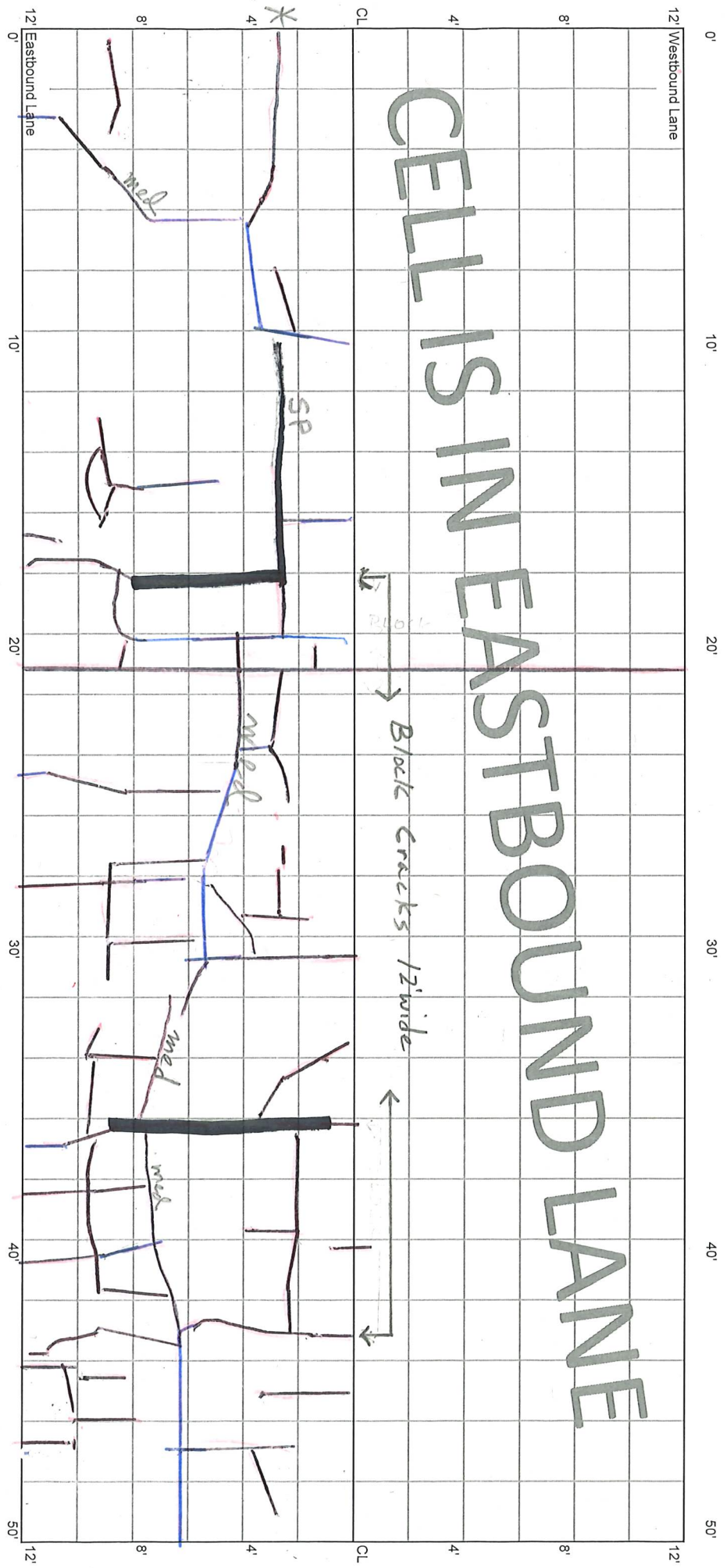

CELL 7008E
250 - 300 ft

Mailbox
at
264' EB lane
*

41+00

41+50

CELLS IN EASTBOUND LANE

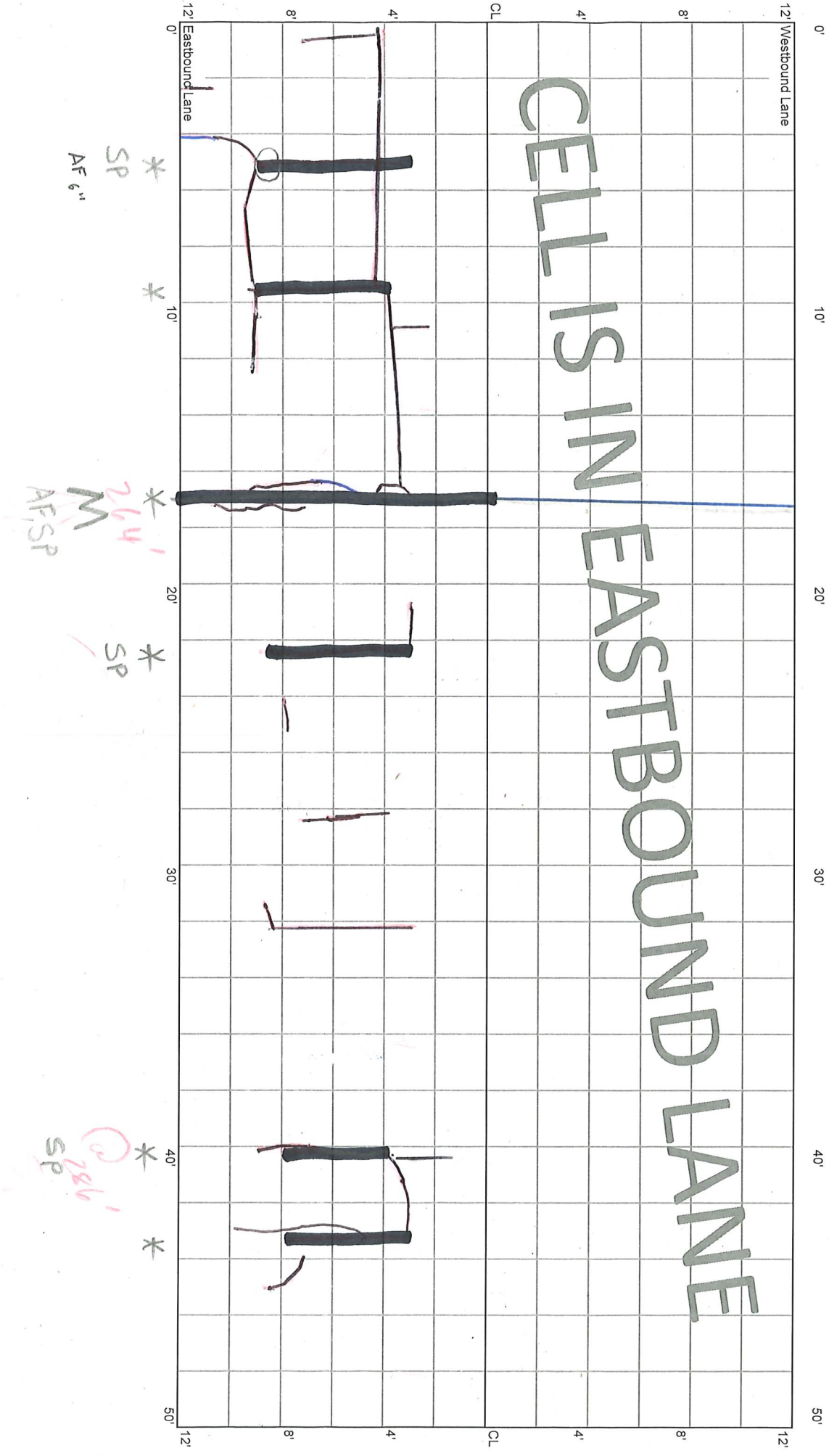

CELL 7008E
300 - 350 ft

41+50

42+00

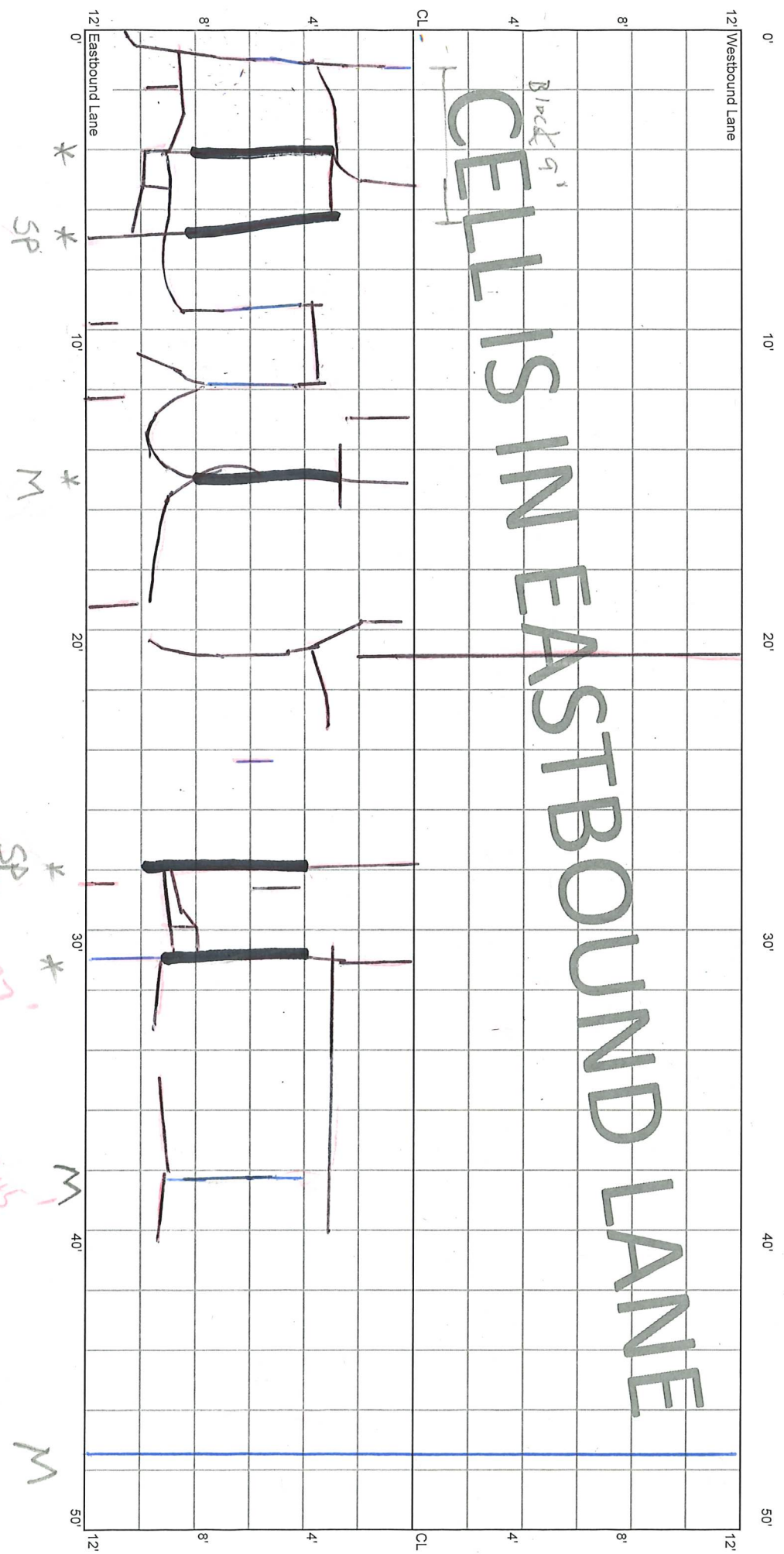

CELL 7008E
350 - 400 ft

42+00

42+50

CELL IS IN EASTBOUND LANE

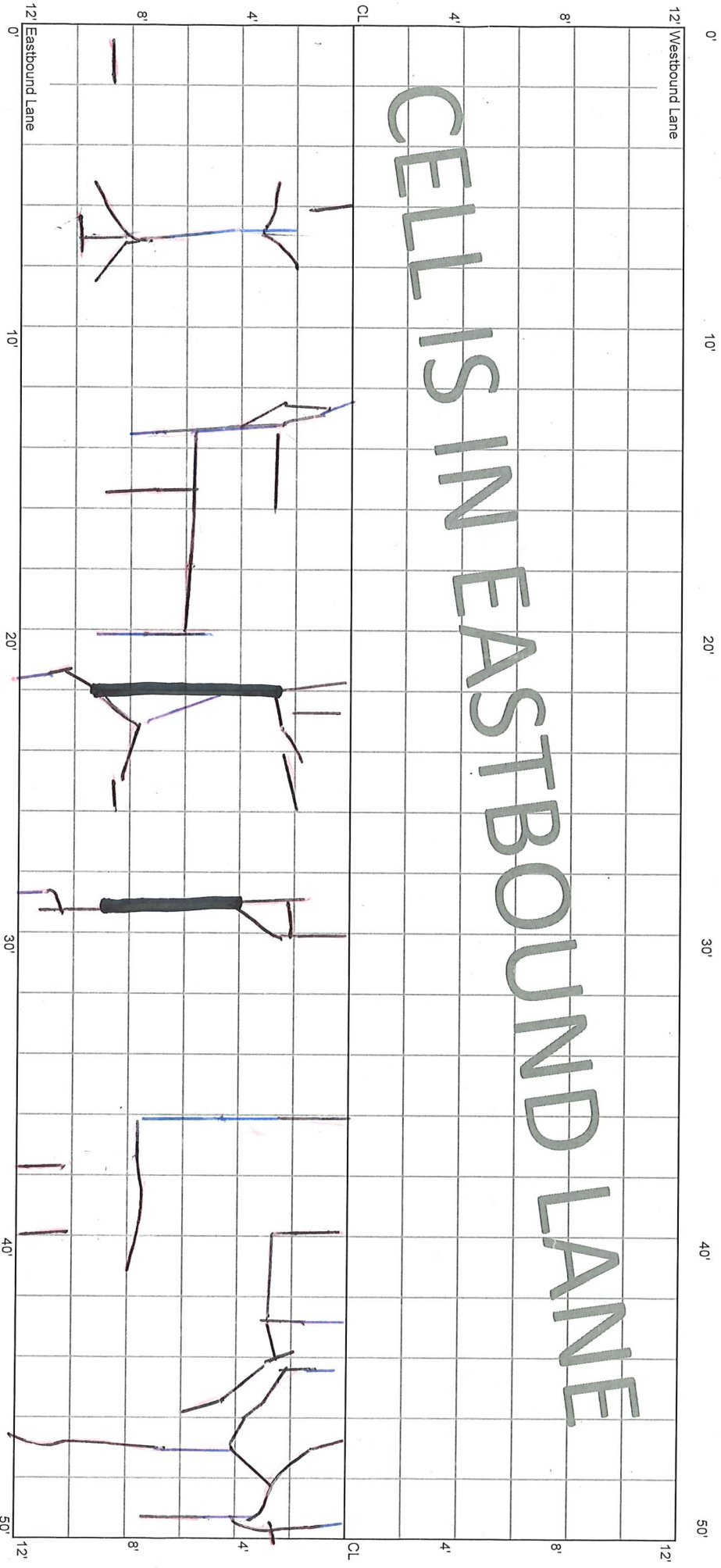

AF

*

CELL 7008E
400 - 450 ft

42+50

43+00

12' Westbound Lane

12'

0'

10'

20'

30'

40'

50'

CELL IS IN EASTBOUND LANE

4'

4'

4'

4'

8'

8'

CL

CL

12' Eastbound Lane

12'

0'

10'

20'

30'

40'

50'



SP

Block Cracks 5 1/2' wide

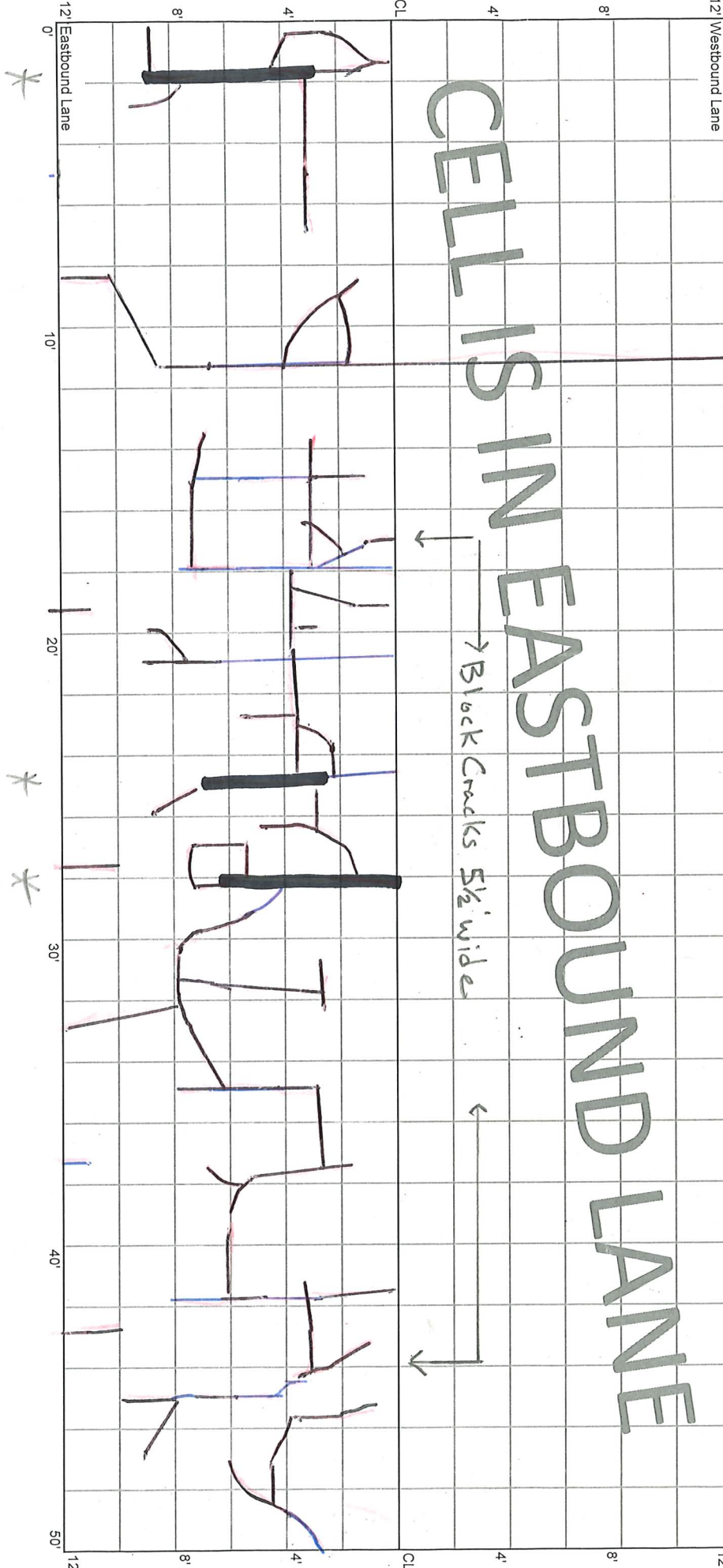

CELL 7008E
450 - 500 ft

43+00

43+50

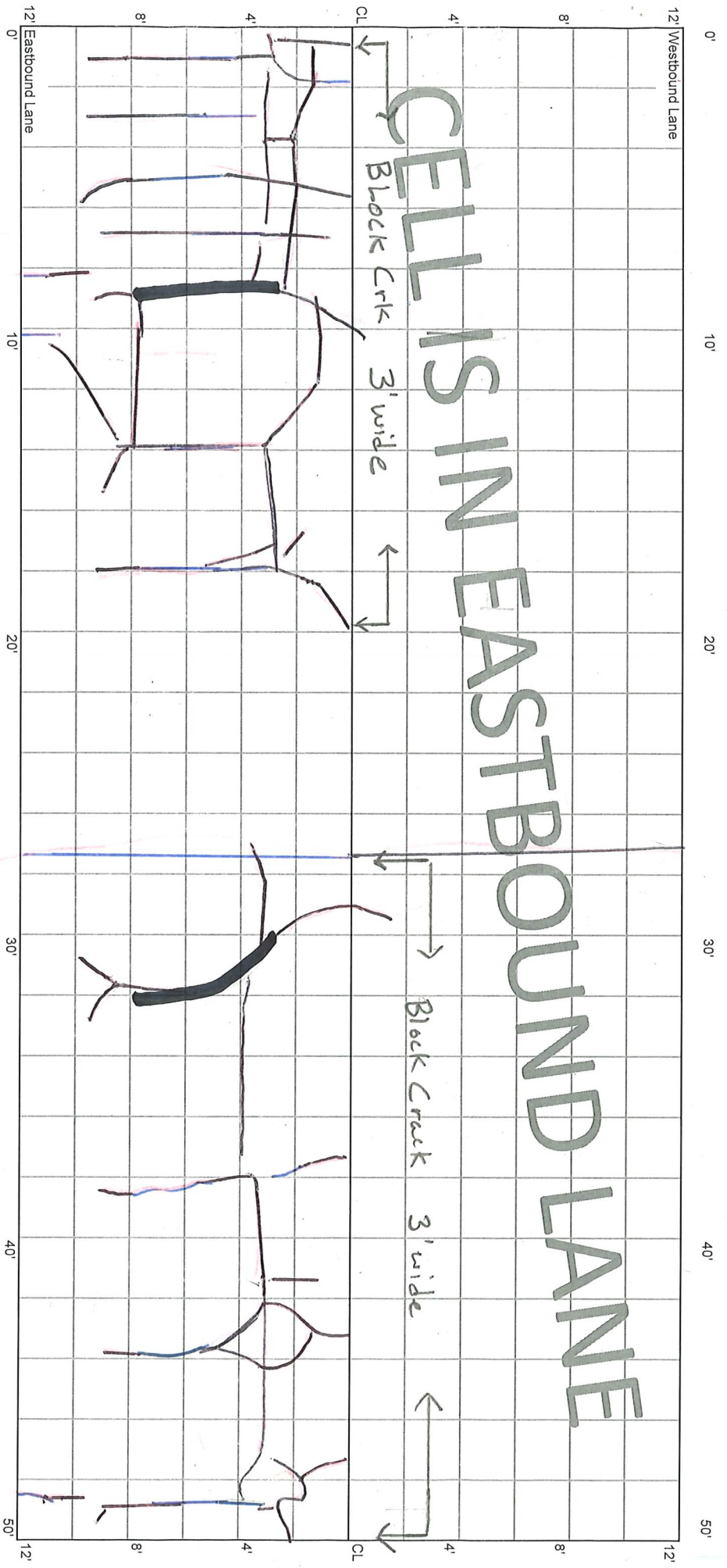

CELLS IN EASTBOUND LANE

Block Crk 3' wide

Block Crk 3' wide

12' Westbound Lane

12' Eastbound Lane

M

* M

CELL 7008E
500 - 842 ft

43+50

46+92

0'

342'

12' Westbound Lane

12'

8'

8'

4'

4'

CL

CL

4'

4'

8'

8'

12'

12'

0'

10

20

30

342'

CELL IS IN EASTBOUND LANE

END RATING: TRANSITION TO COUNTY
ROAD 19

END