

5.28.20 E.S.

10.14.20	1.12.22
1.4.21	8.31.22
File 70TH ST	1.26.23
8.25.21	8.11.23
	1.30.24

CELL 7005E
0 - 50 ft

8.25.21 - 36 Trans. cts outside
Fog line.

22+00

22+50

Ruton outside of Fogline

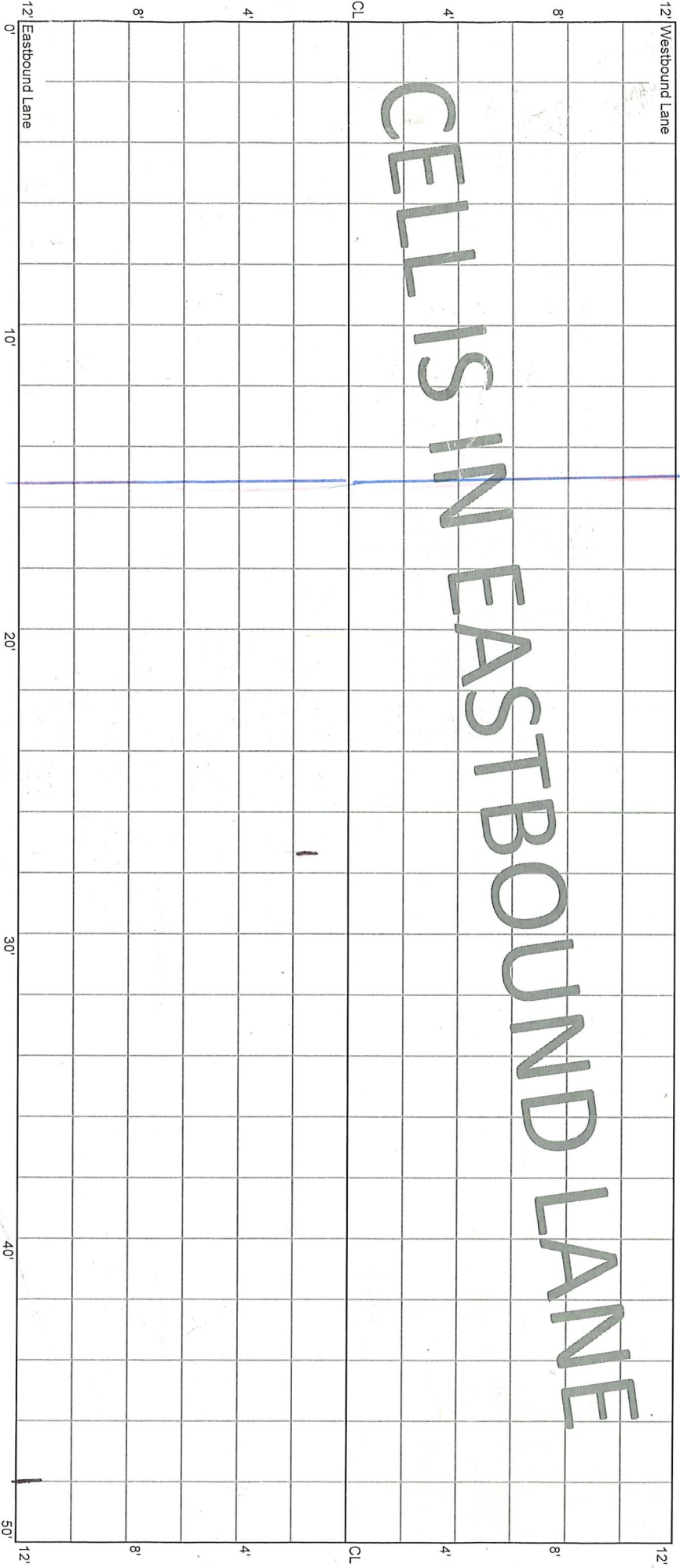

* RUT Seal
 ✓ 2023 Clean Seal

CELL 7005E
50 - 100 ft

22+50

23+00

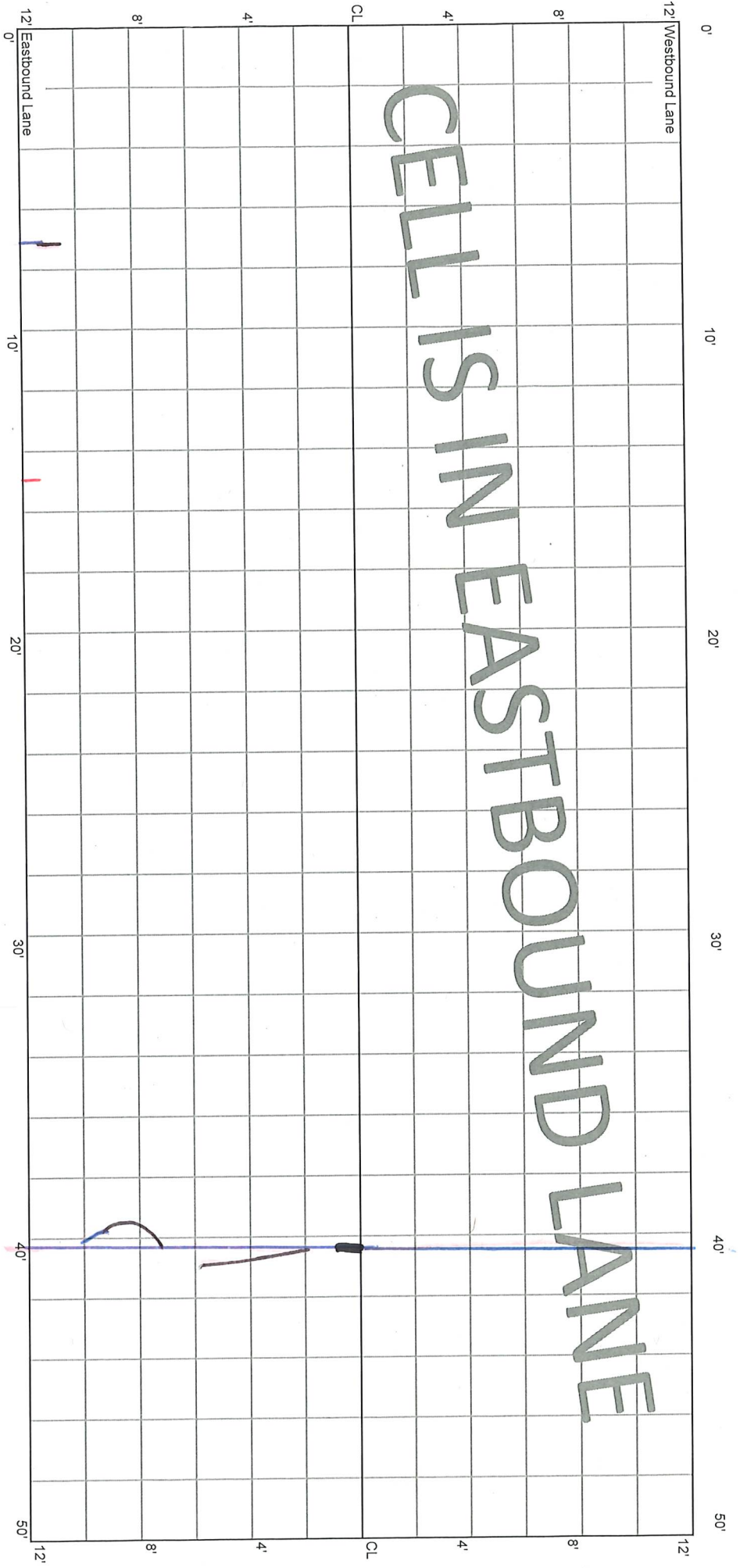

CELL IS IN EASTBOUND LANE

M

CELL 7005E
100 - 150 ft

23+00

23+50

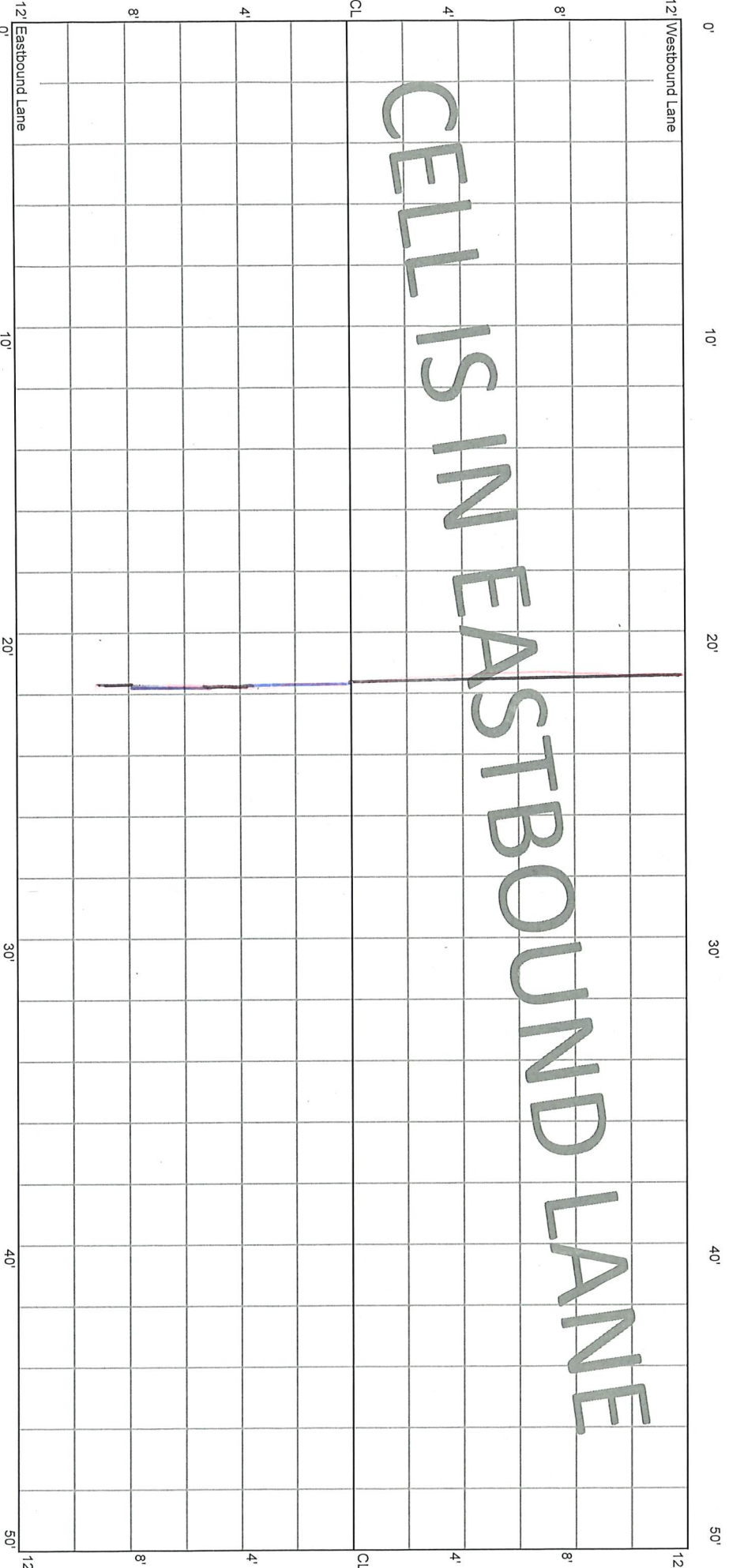

CELL 7005E
200 - 250 ft

24+00

24+50

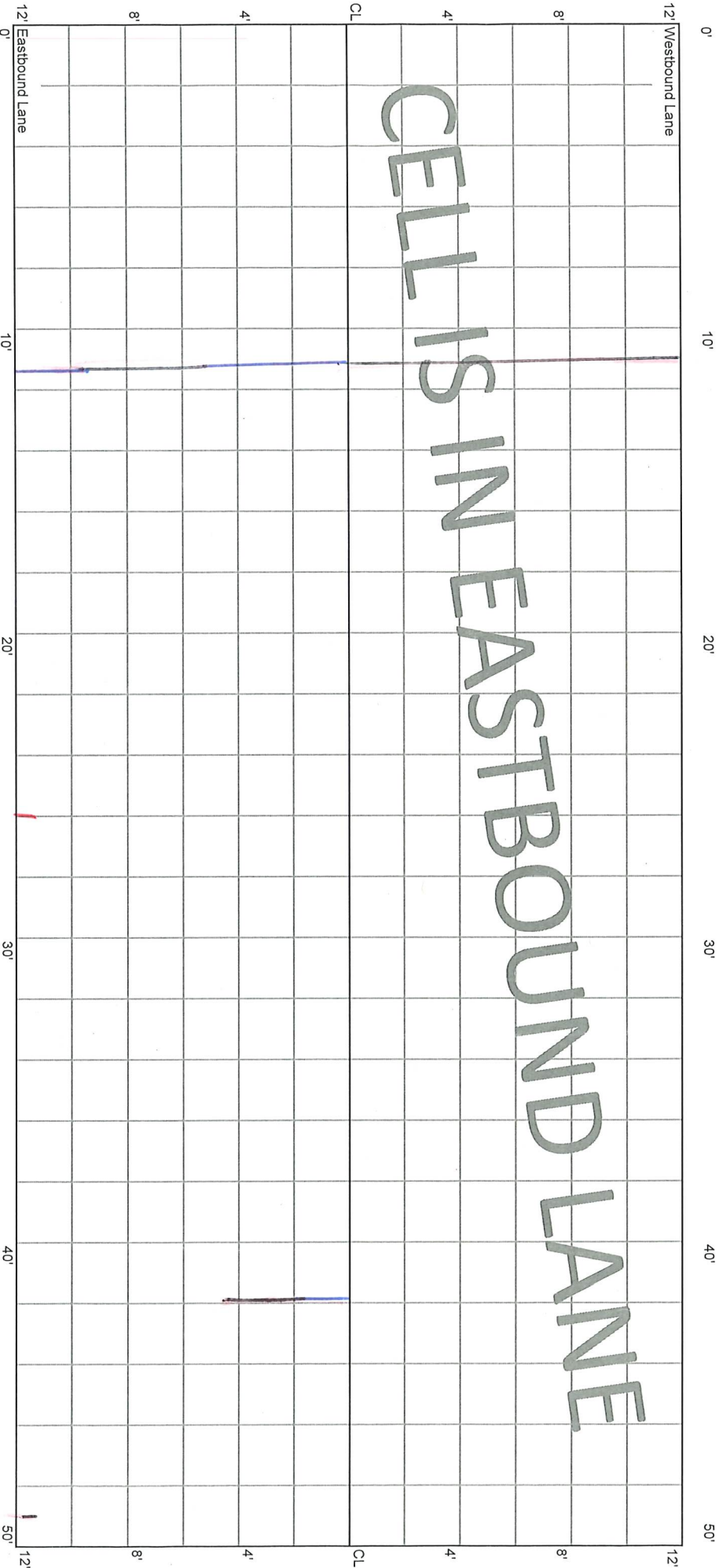

CELL IS IN EASTBOUND LANE

M

200-227
SILVER CREEK

4 1/2
5
1 1/2

CELL 7005E
250 - 300 ft

24+50

25+00

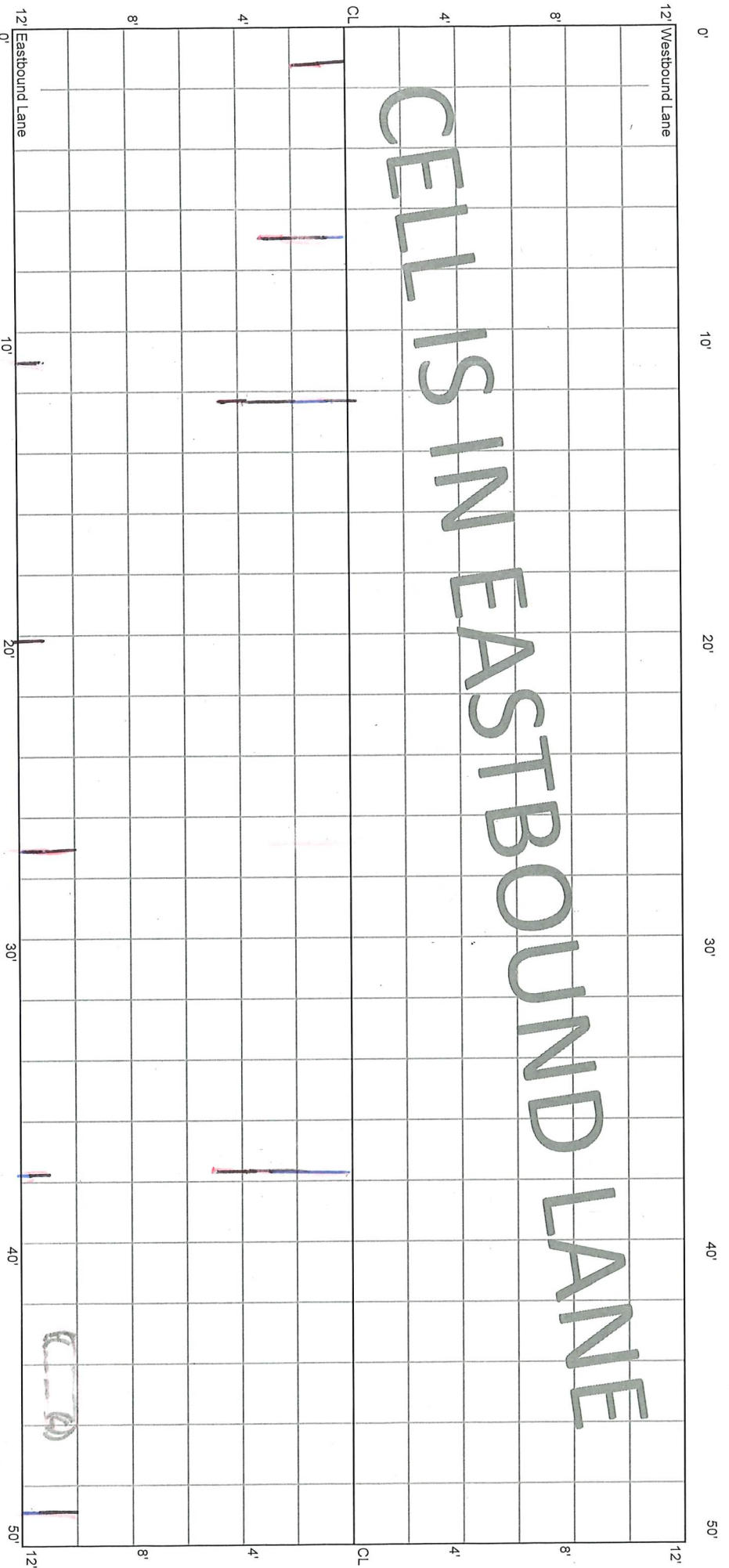

CELL IS IN EASTBOUND LANE

1/2

F + PH
Not Visible

CELL 7005E
300 - 350 ft

25+00

25+50

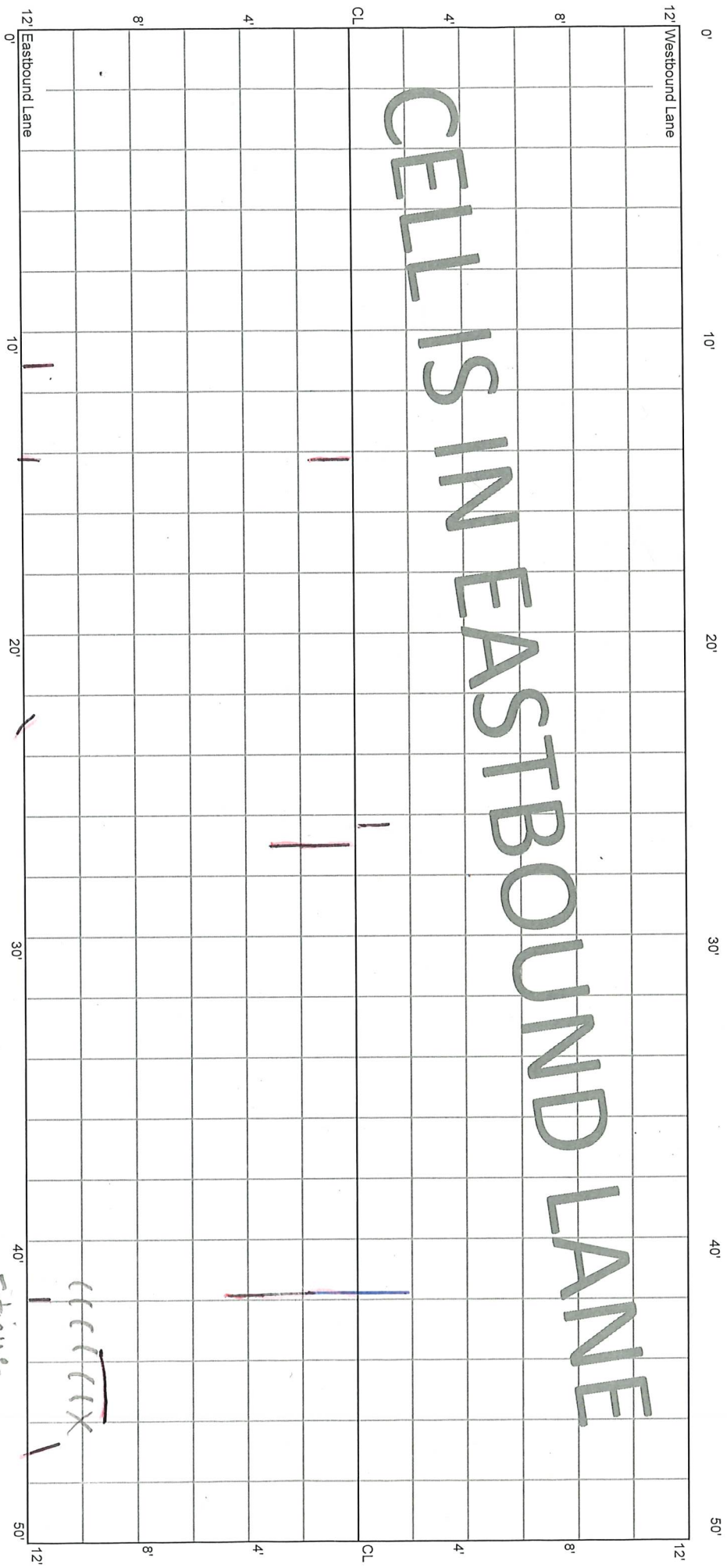

CELLS IN EASTBOUND LANE

Fatigue

x 3/4 Defect
future pothole?

CELL 7005E
350 - 400 ft

25+50

26+00

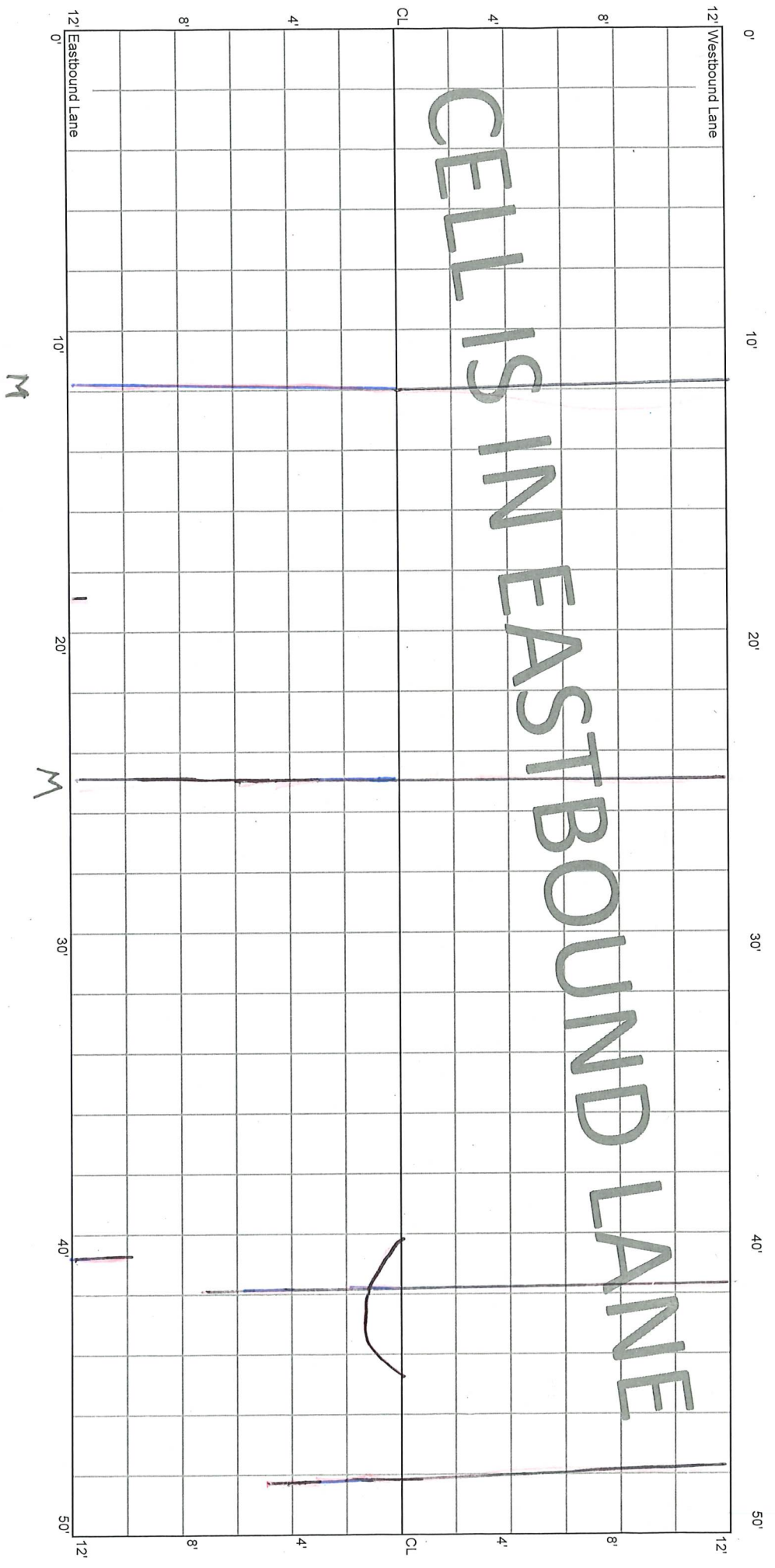

2317

CELL 7005E
400 - 450 ft

26+00

26+50

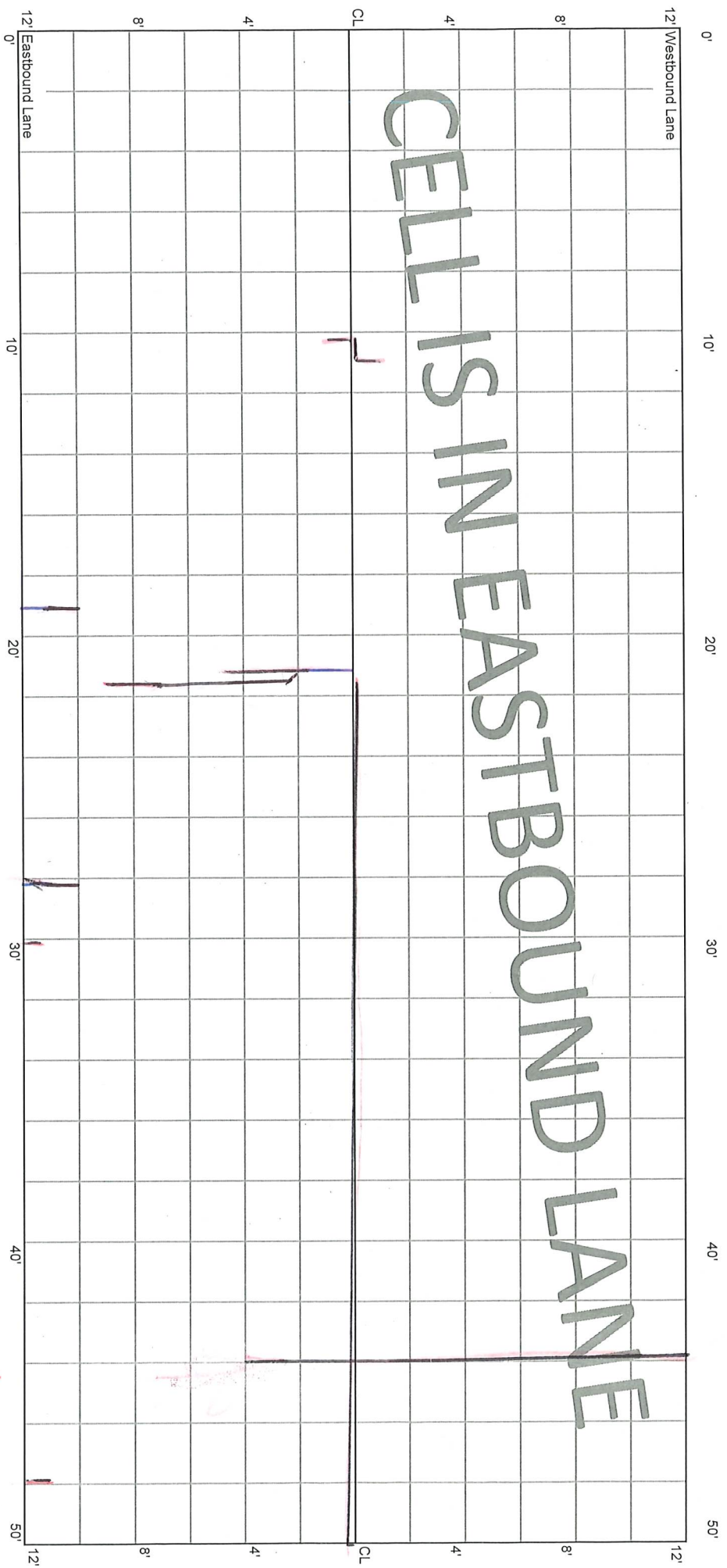

CELL 7005E
450 - 500 ft

26+50

26+58
CL KITTRIDGE

27+00

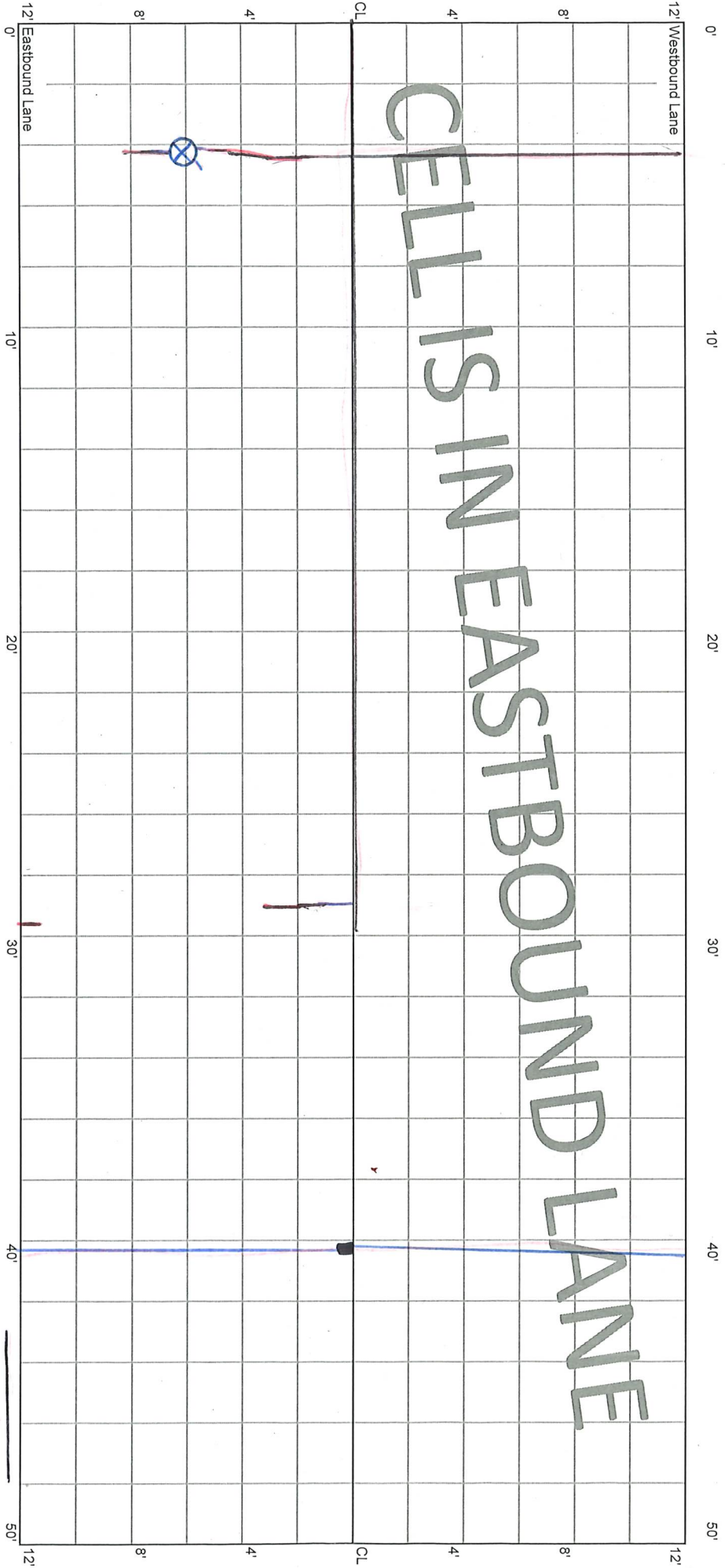

CELLS IN EASTBOUND LANE

MICHAEL
SURVEY MARKER

M

CELL 7005E
500 - 550 ft

27+00

16+25

27+50

12' Westbound Lane

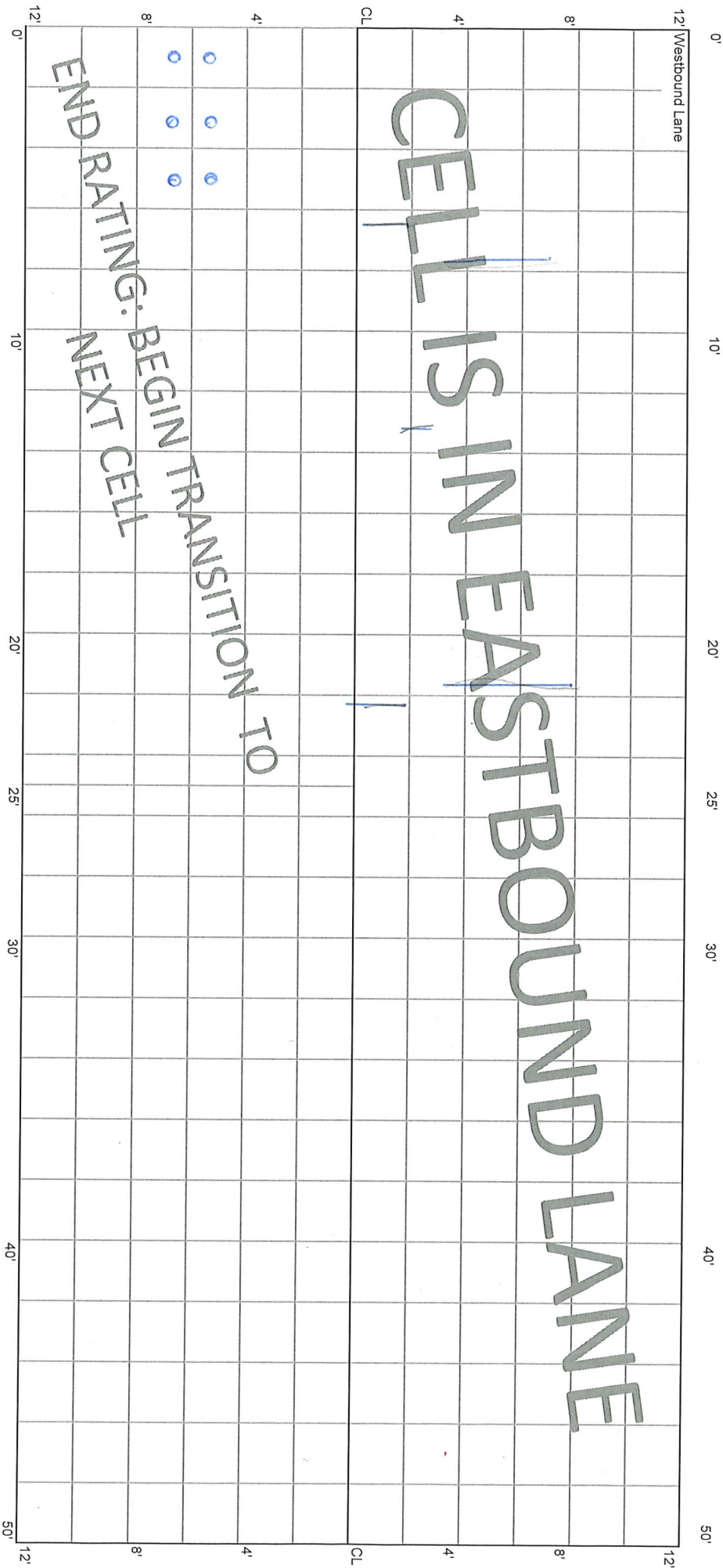

(0' oct '10)
cases