

5:28,30 E.T.

10.14.20 | 1.13.22

1.4.21 | 8.30.22

8.25.21 | 1.26.23

8.9.23

1.23.24

CELL 7001E
0 - 50 ft

Begin CL Kadler

0+00

0+50

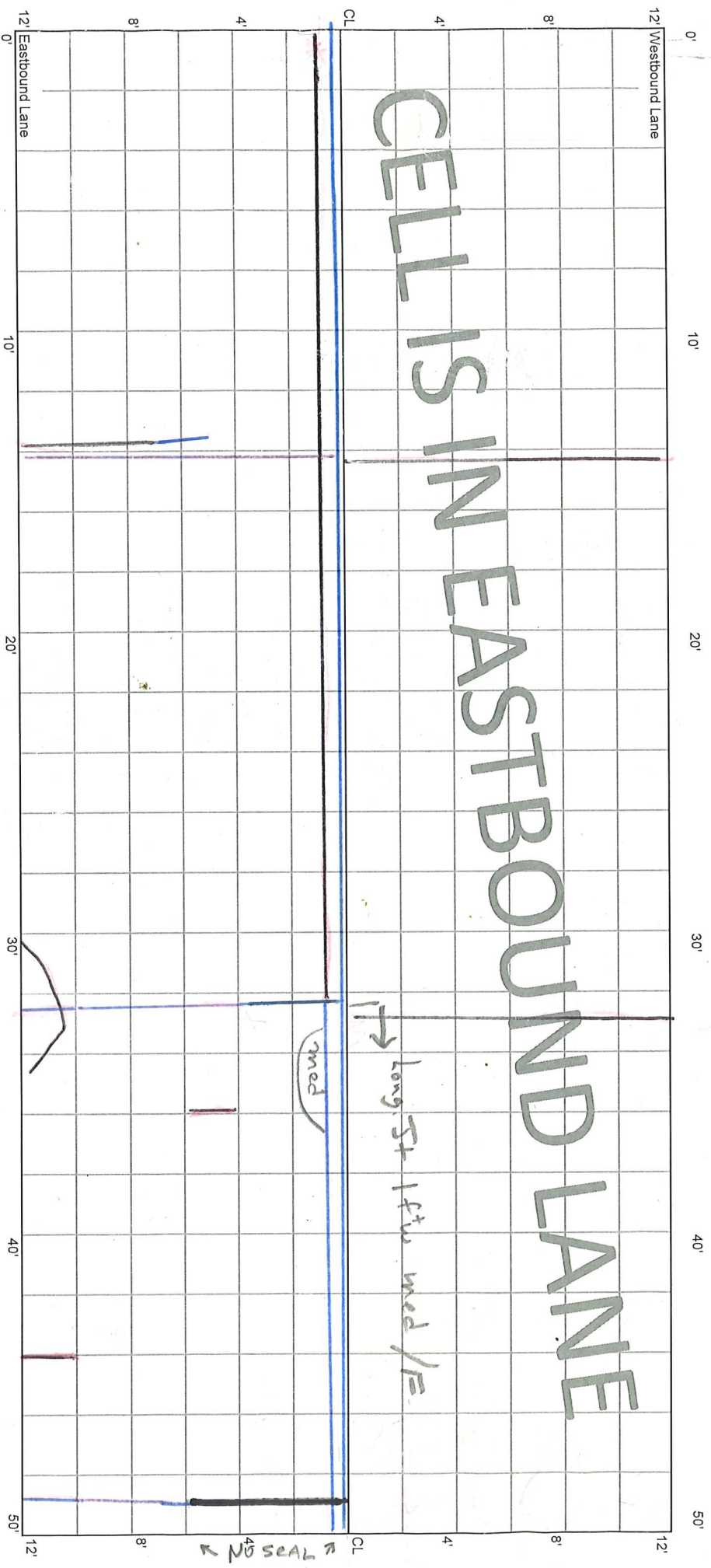

M

AF

** 2023 Clean & Seal

* Rout & Seal

8/2022 - "M" Due to multiple cracks

8/22 - Sealant + debris & many stones on mat.

CELL 7001E
50 - 100 ft

0+50

1+00

CELL IS IN EASTBOUND LANE

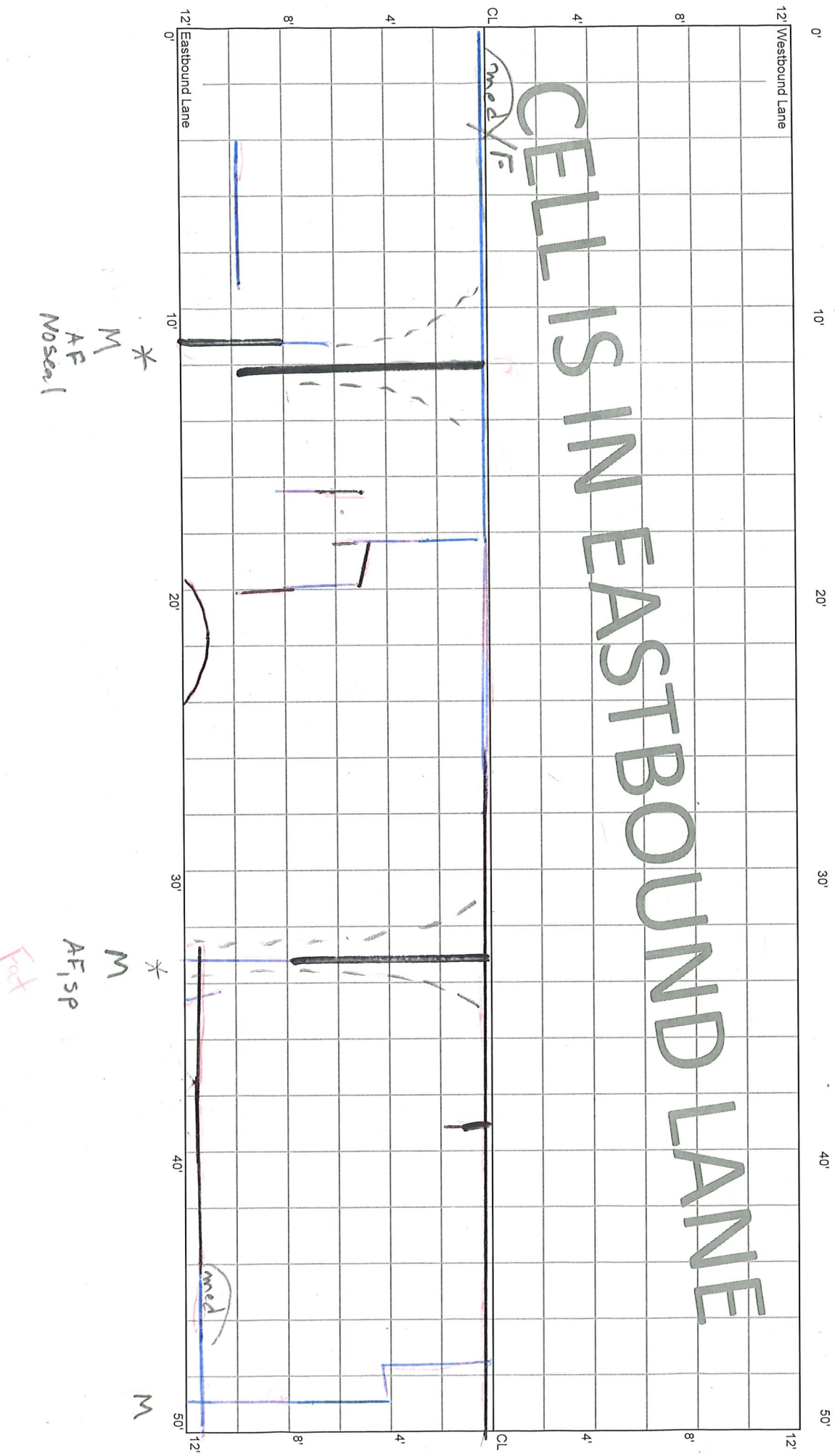

CELL 7001E
100 - 150 ft

1+00

1+50

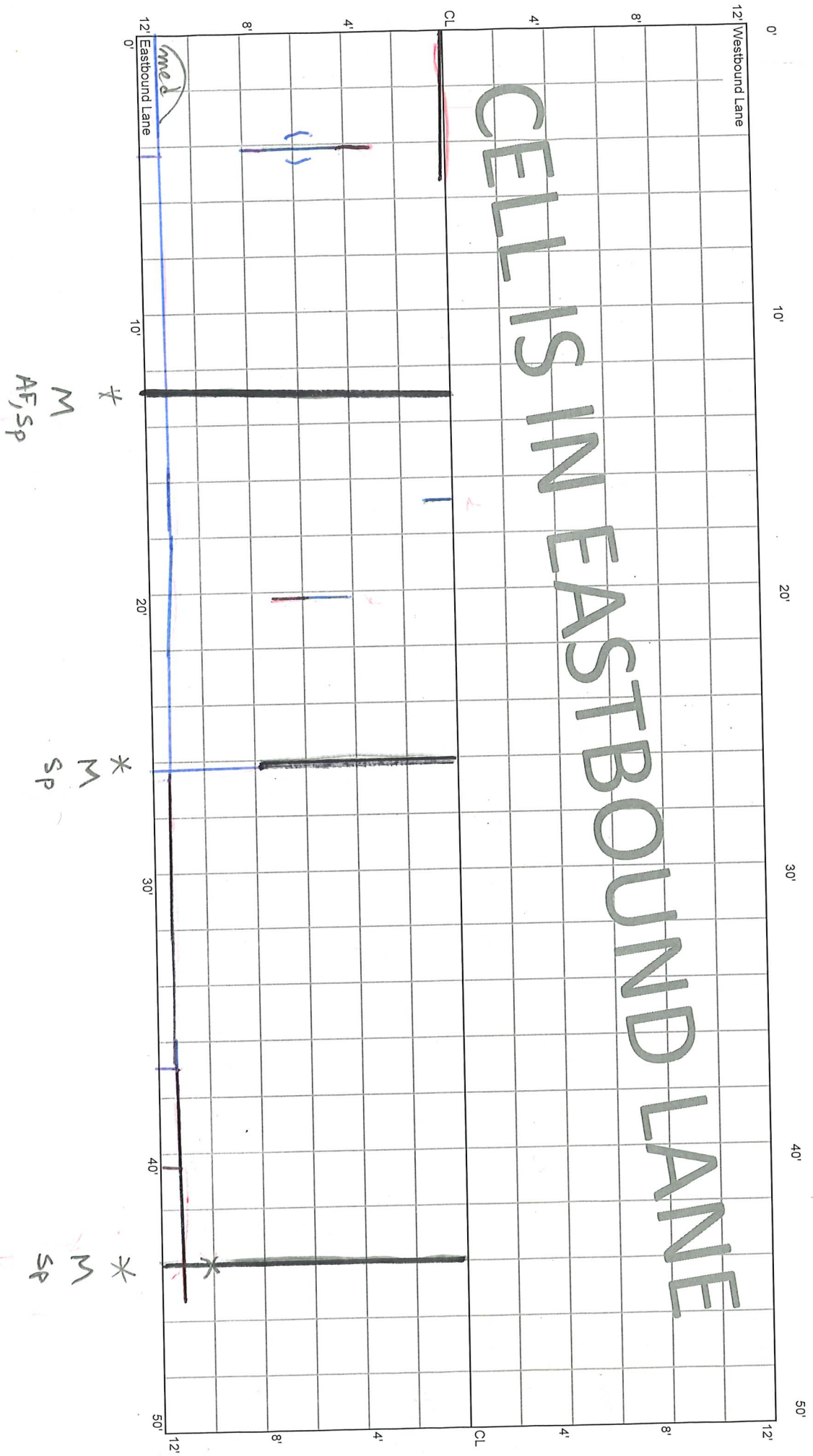

0' 10' 20' 30' 40' 50'

12' Westbound Lane 12' Eastbound Lane

M
AF, SP

* M
SP

* M
SP

med

CELL IS IN EASTBOUND LANE

CL

(S)

CELL 7001E
150 - 200 ft

1+50

2+00

CELL IS IN EASTBOUND LANE

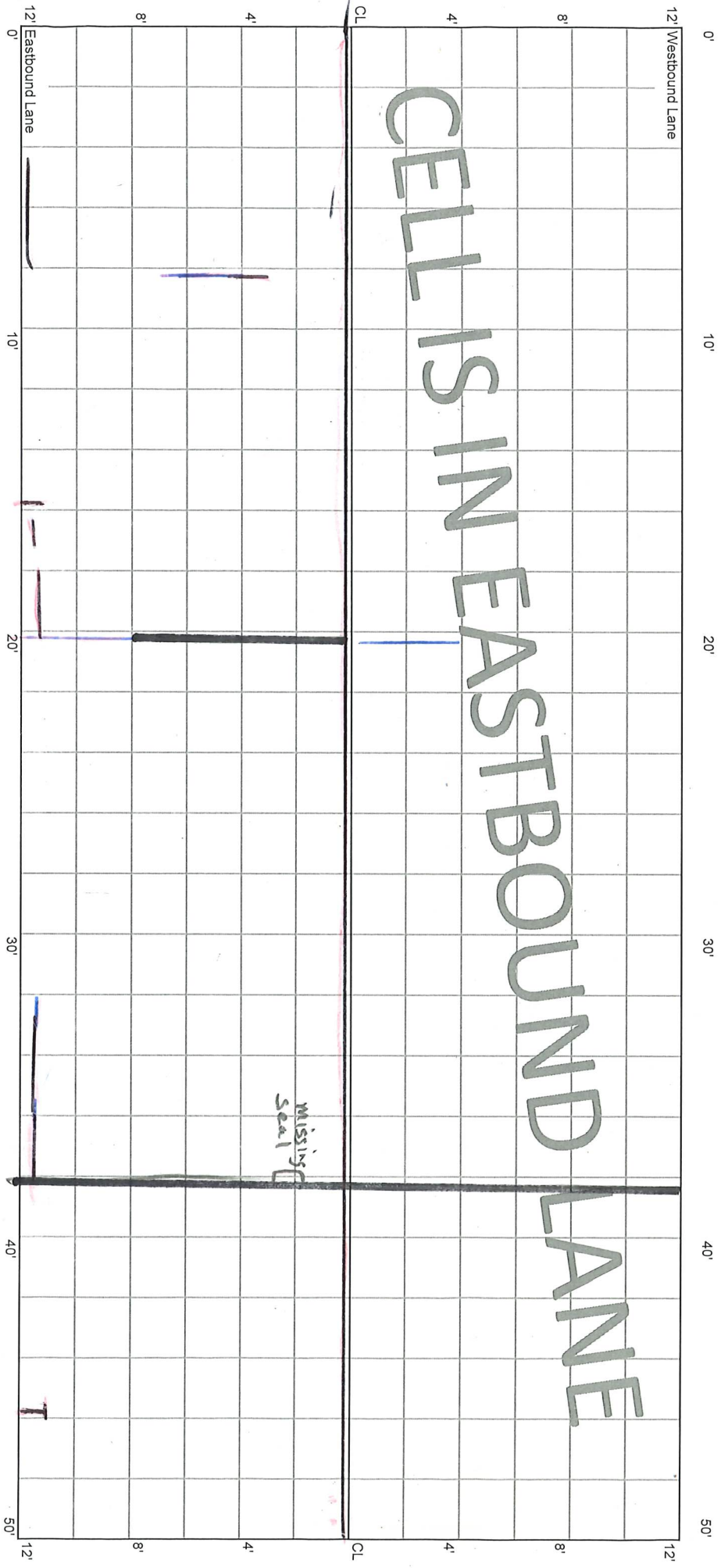

* M
8' seal
SP

* M

CELL 7001E
200 - 250 ft

2+00

2+50

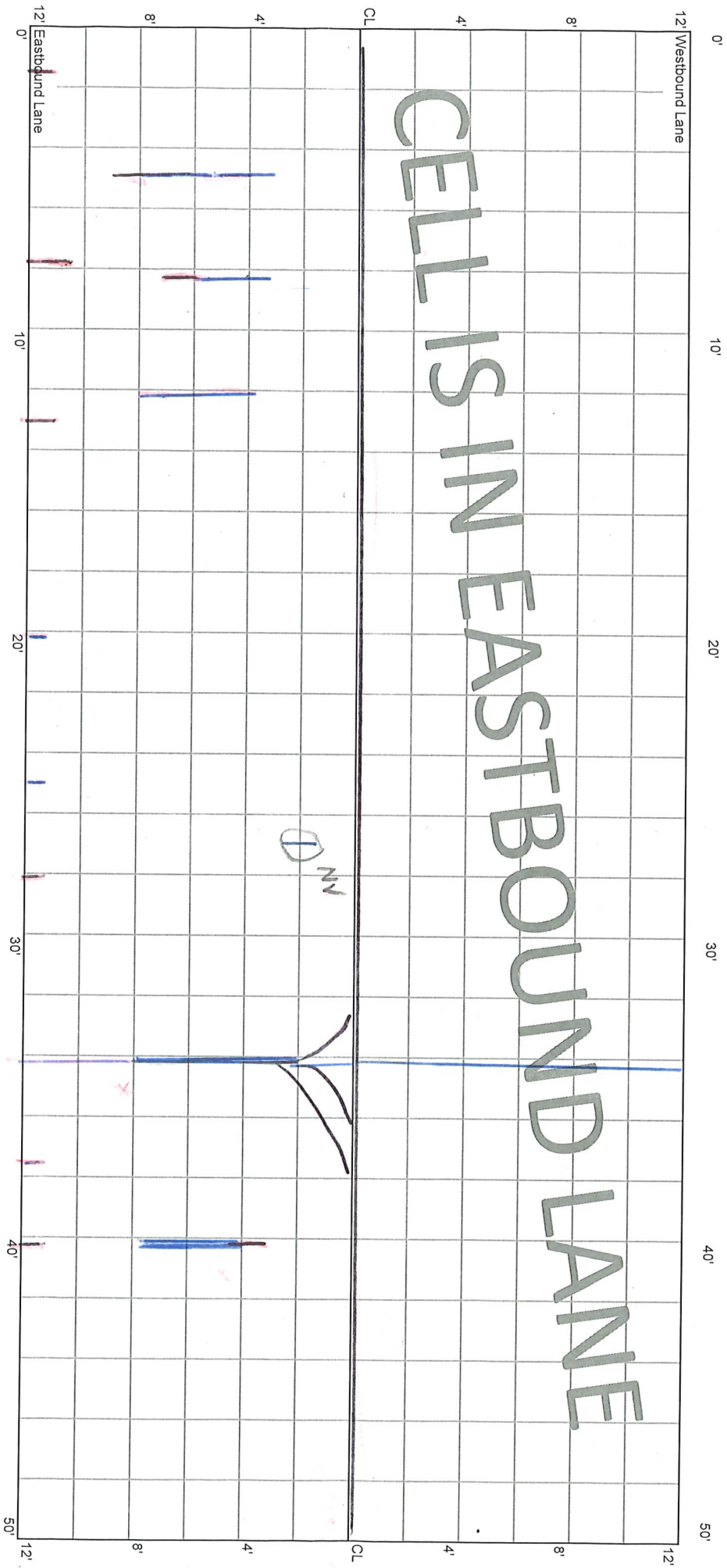

M
12'
Debris

CELL 7001E
250 - 300 ft

2+50

3+00

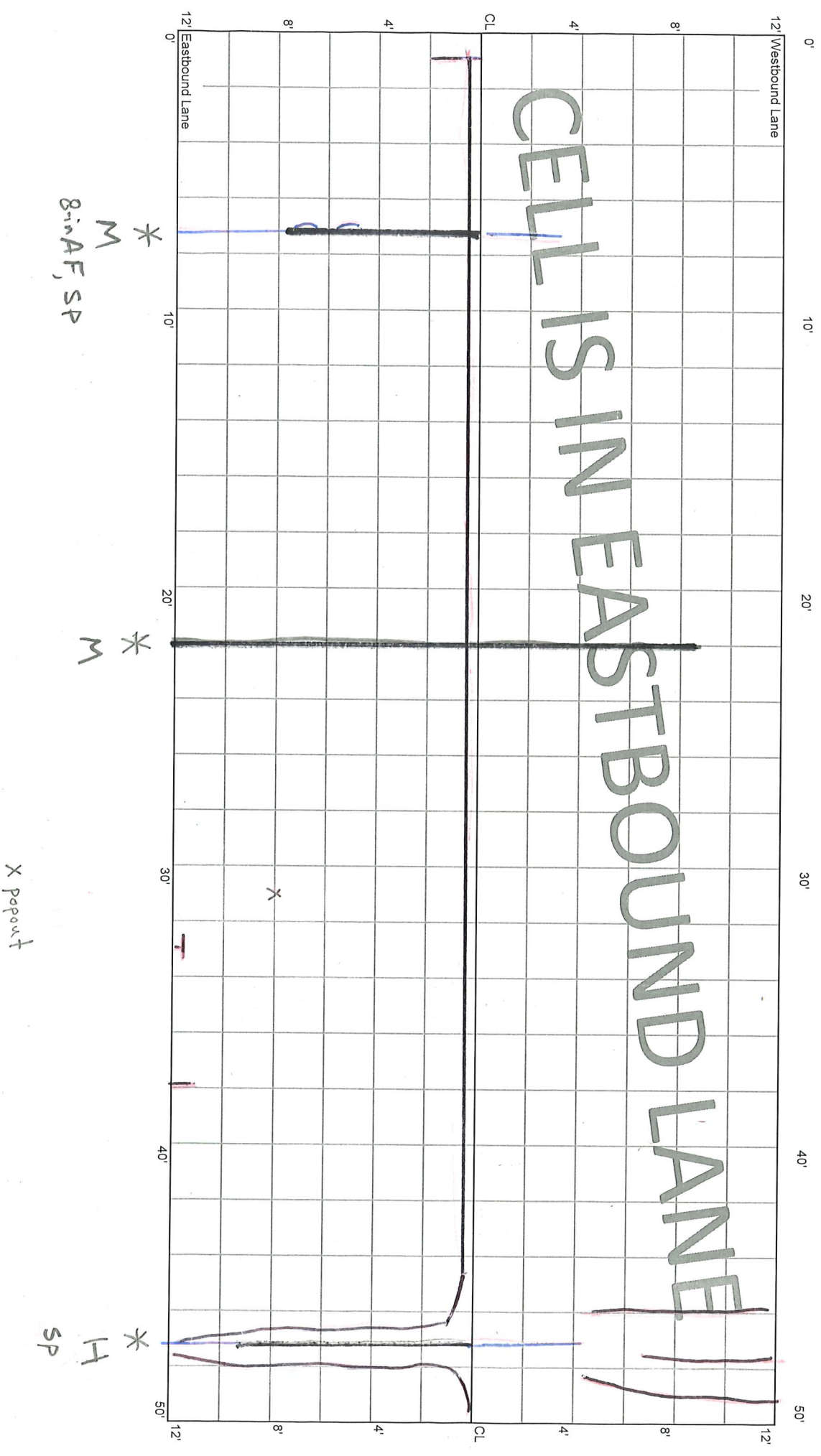

CELL 7001E
300 - 350 ft

3+00

3+50

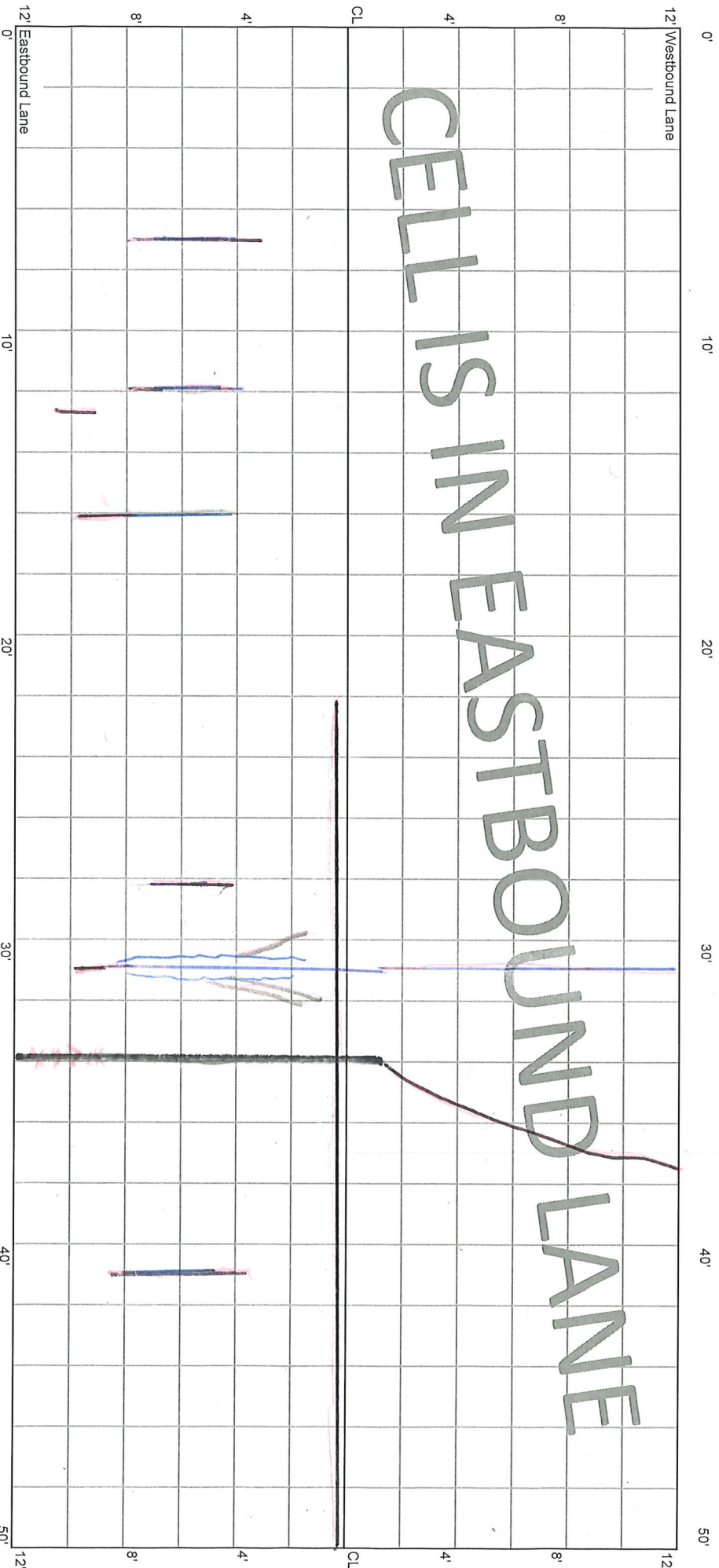

M

M

H

*
For $H_{2'w}$

M
5'

6139

Peaks

CELL 7001E
350 - 400 ft

3+50

4+00

12' Westbound Lane

0'

10'

20'

30'

40'

50'

CL

4'

8'

CL

4'

8'

12' Eastbound Lane

8'

4'

12'

8'

4'

CELLS IN EASTBOUND LANE

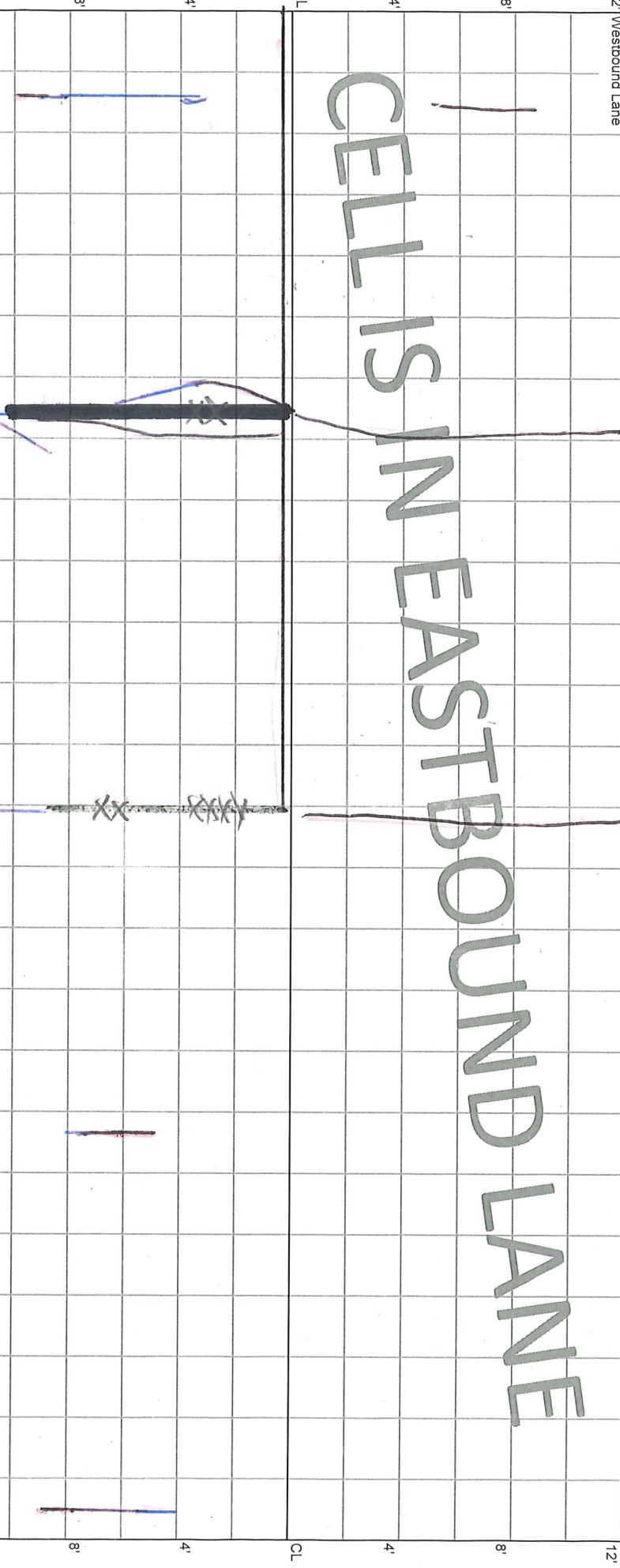

6'

* 10-ft
SP
M

*
M

CELL 7001E
400 - 450 ft

4+00

4+50

12' Westbound Lane

12' Eastbound Lane

CELL IS IN EASTBOUND LANE

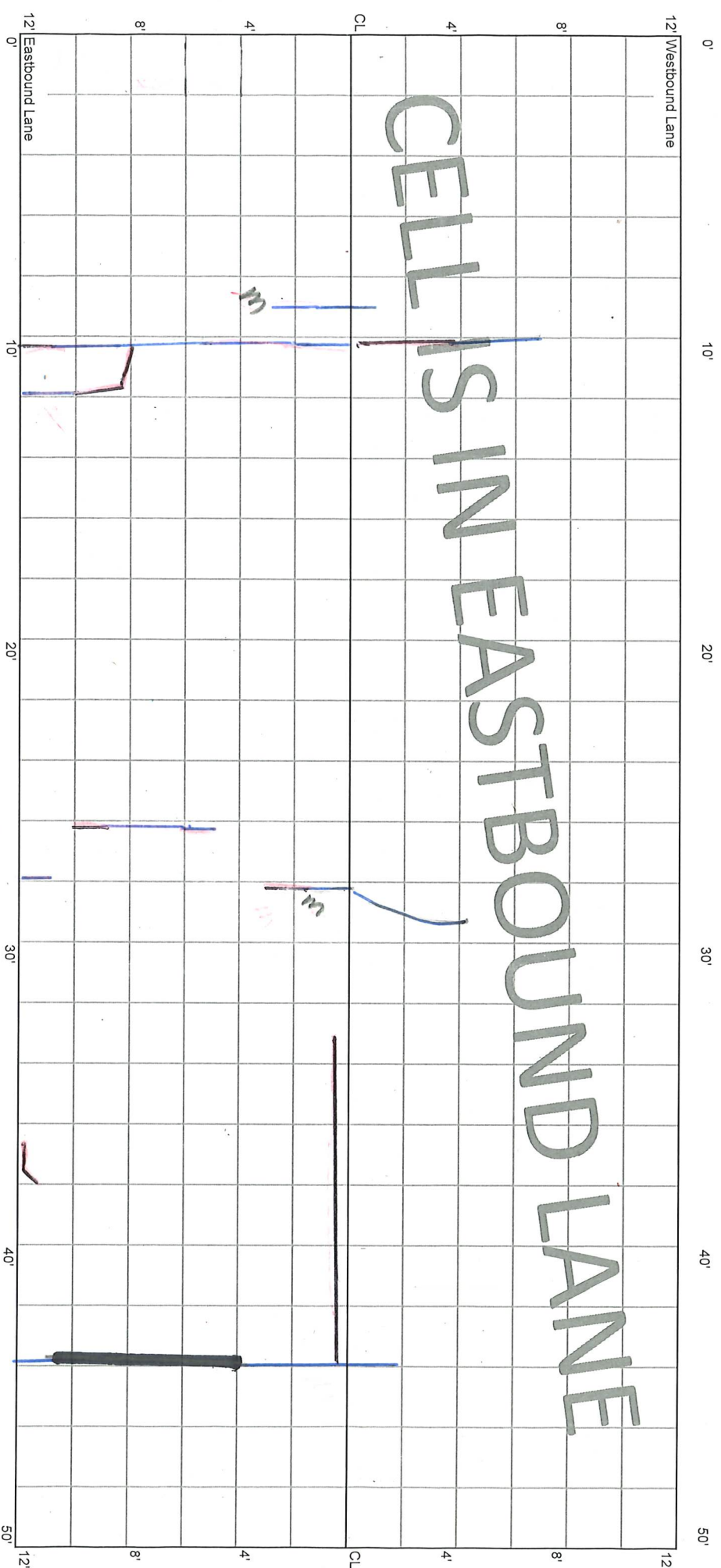

M

12' M

1/2' SP, 1/2' AF

CP (S-10-1)

CELL 7001E
450 - 500 ft

4+50

5+00

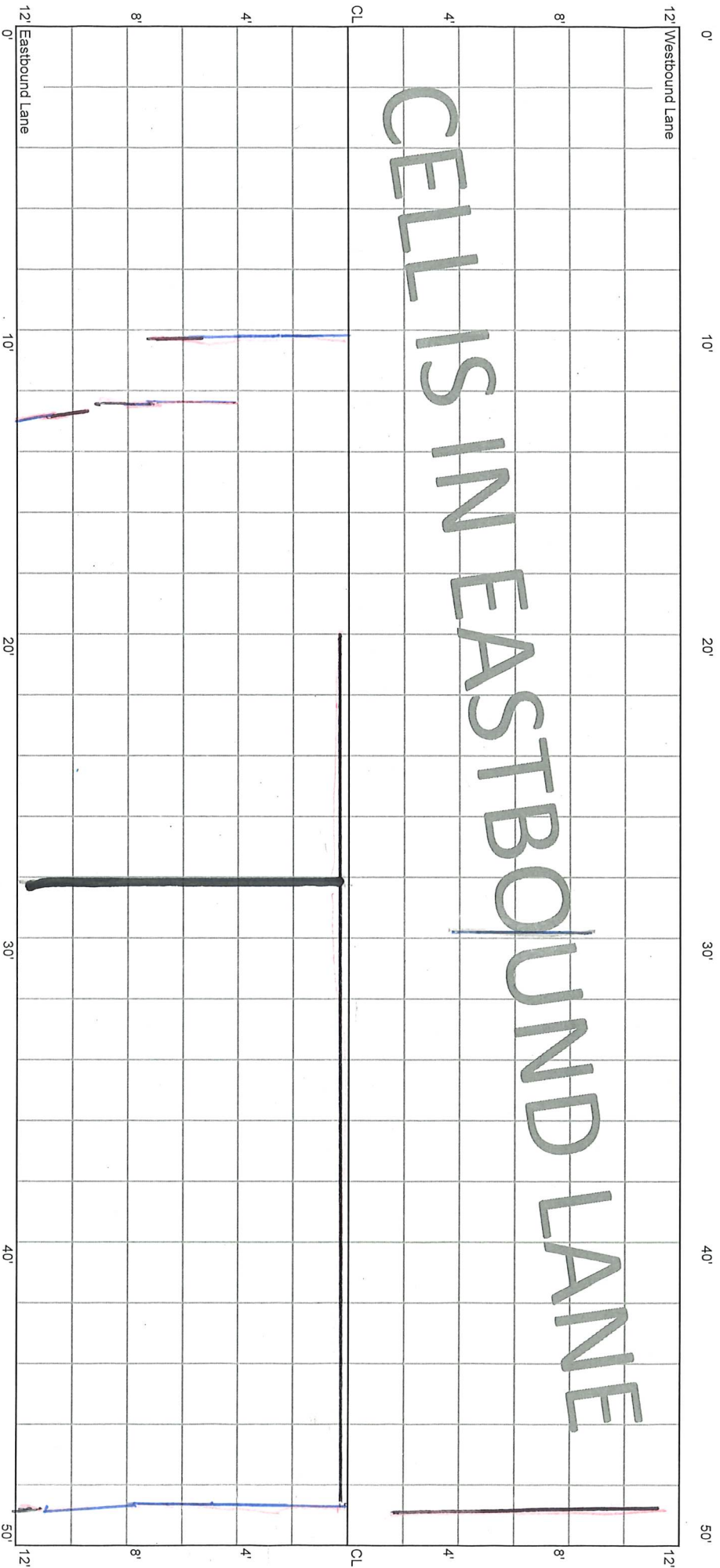

(AF, SP) - 2++

M

CELL 7001E
500 - 550 ft

5+00

5+25

5+50

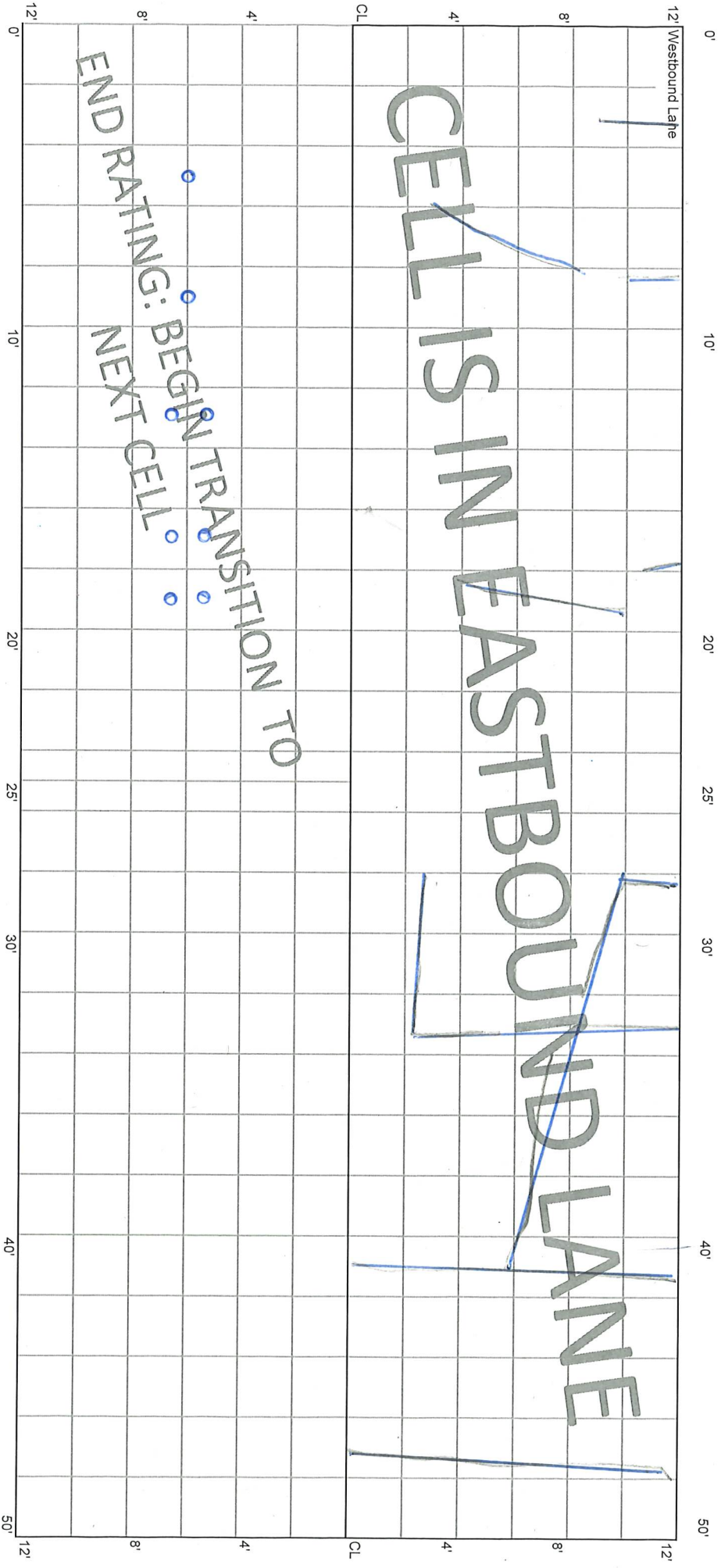

CELLS IN EASTBOUND LANE

END RATING: BEGIN TRANSITION TO NEXT CELL

0: out 20
Cores



2