

5.28.20 EJ

10.14.20 | 1.12.22

File 70TH ST

9.15.21

CELL 7004W
0 - 50 ft

21+50

21+00

CELLS IN WESTBOUND LANE

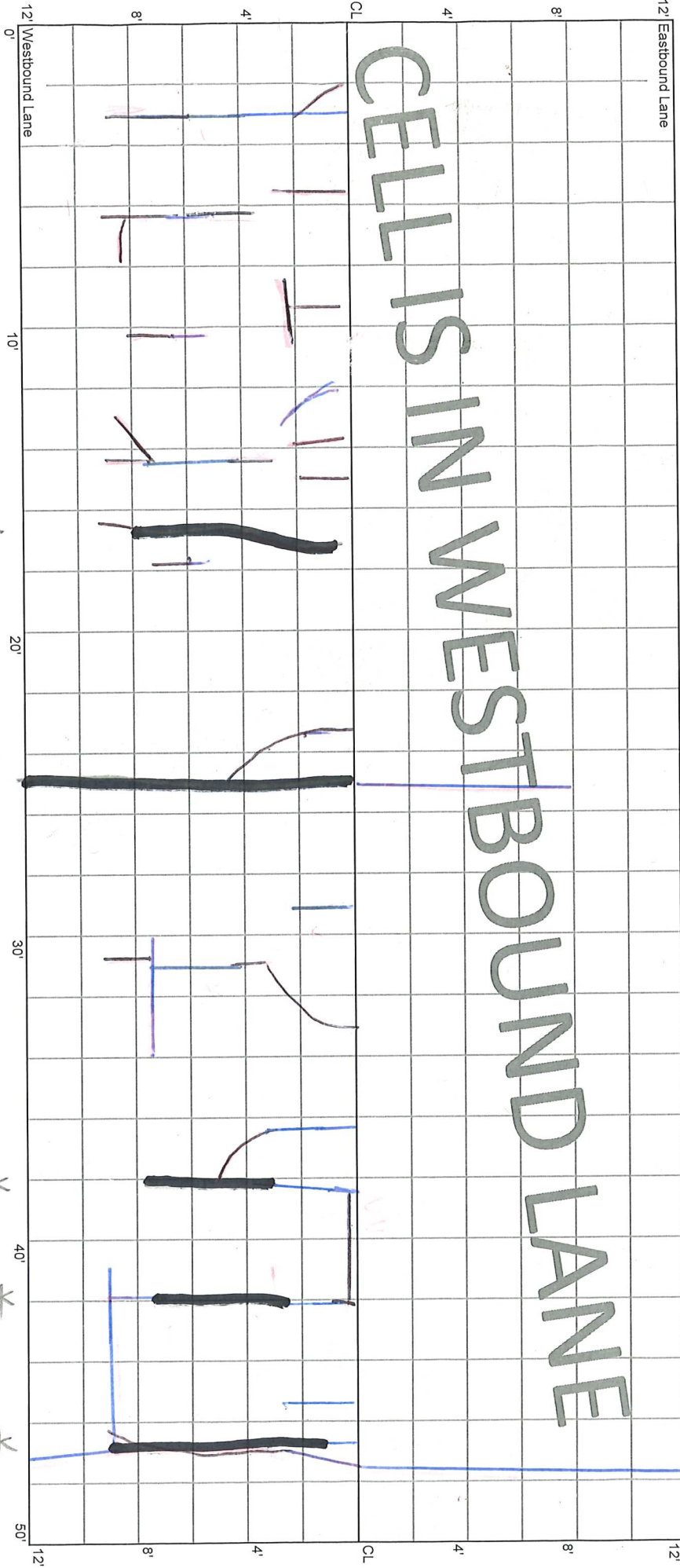

*

*

*

*

*

SPall

SP

* Road Seal

CELL 7004W
50 - 100 ft

21+00

20+50

12' Eastbound Lane

0' 10' 20' 30' 40' 50'

CELLS IN WESTBOUND LANE

12' Westbound Lane

0' 10' 20' 30' 40' 50'

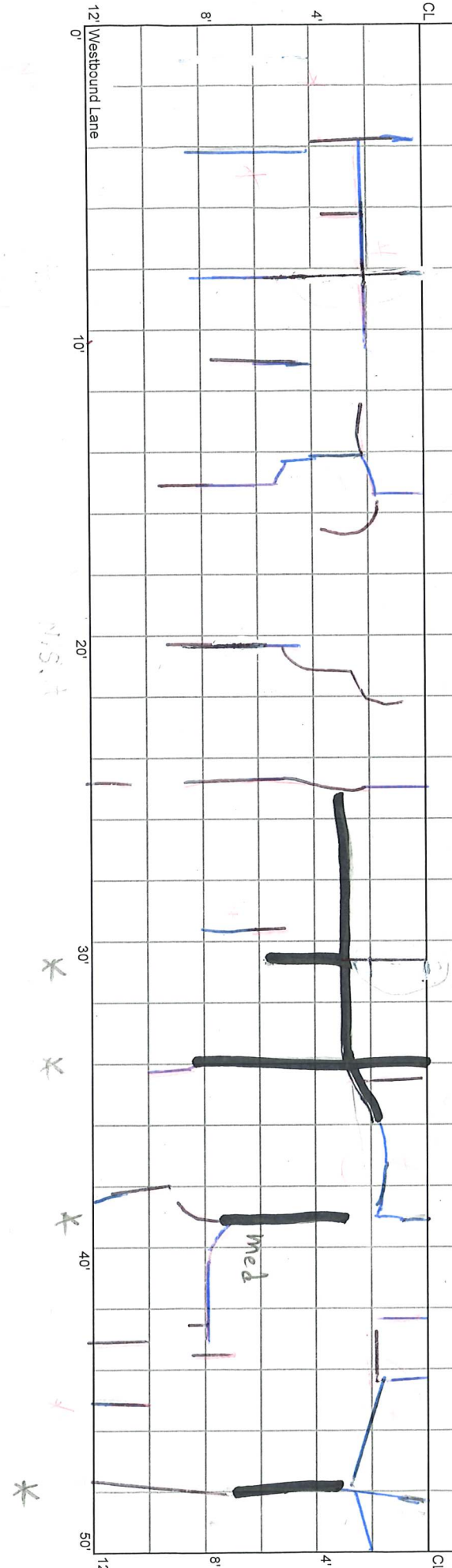

CELL 7004W
100 - 150 ft

20+50

20+00

12' Eastbound Lane

0' 10' 20' 30' 40' 50'

CELLS IN WESTBOUND LANE

12' Westbound Lane

0' 10' 20' 30' 40' 50'

*

AF.

*

*

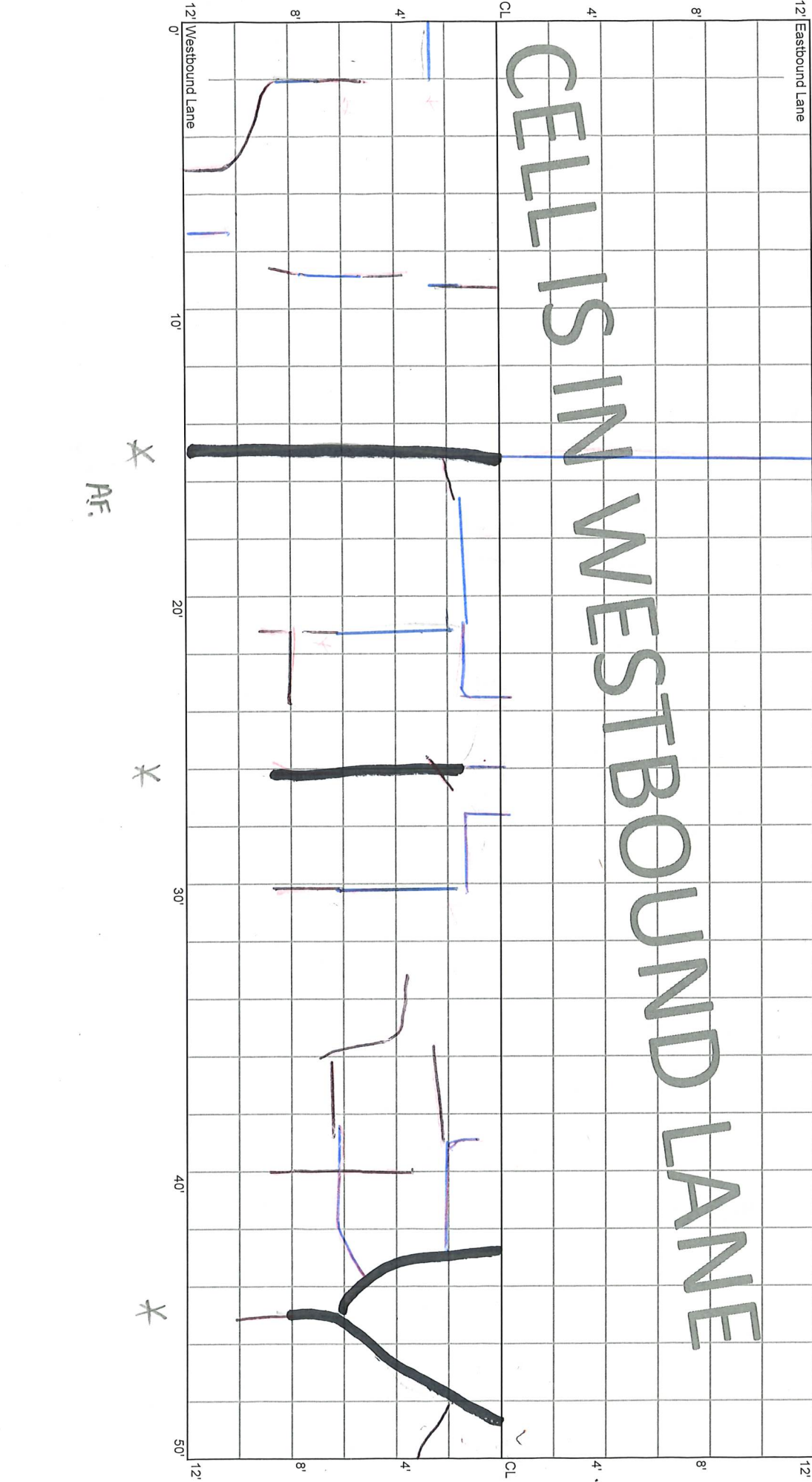

CELL 7004W
150 - 200 ft

20+00

19+50

12' Eastbound Lane

12' Westbound Lane

CELLS IN WESTBOUND LANE

Block Cracking 2 1/2' wide

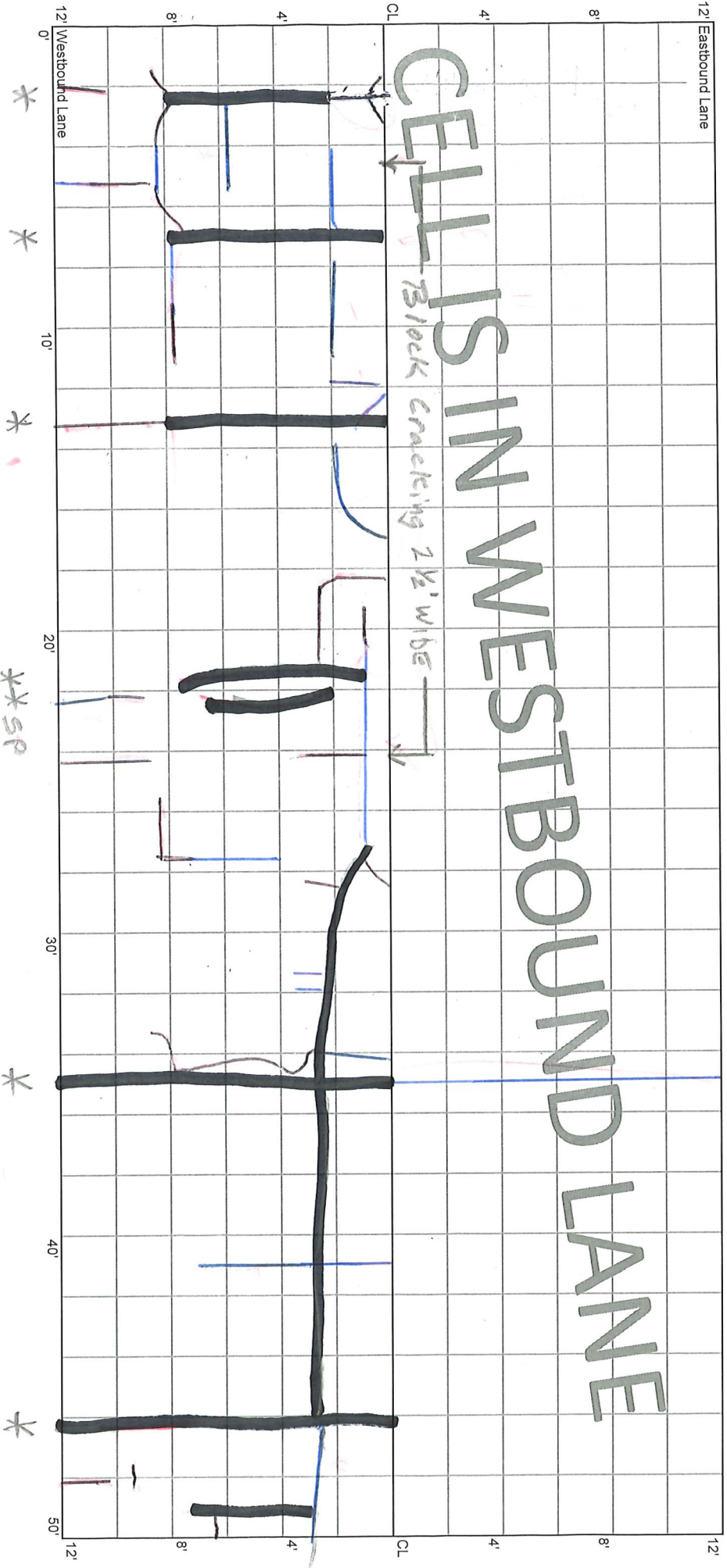

167

171

LS,
6" BWP

CELL 7004W
200 - 250 ft

19+50

19+00

12' Eastbound Lane

12'

12' Westbound Lane

12'

CELLS IN WESTBOUND LANE

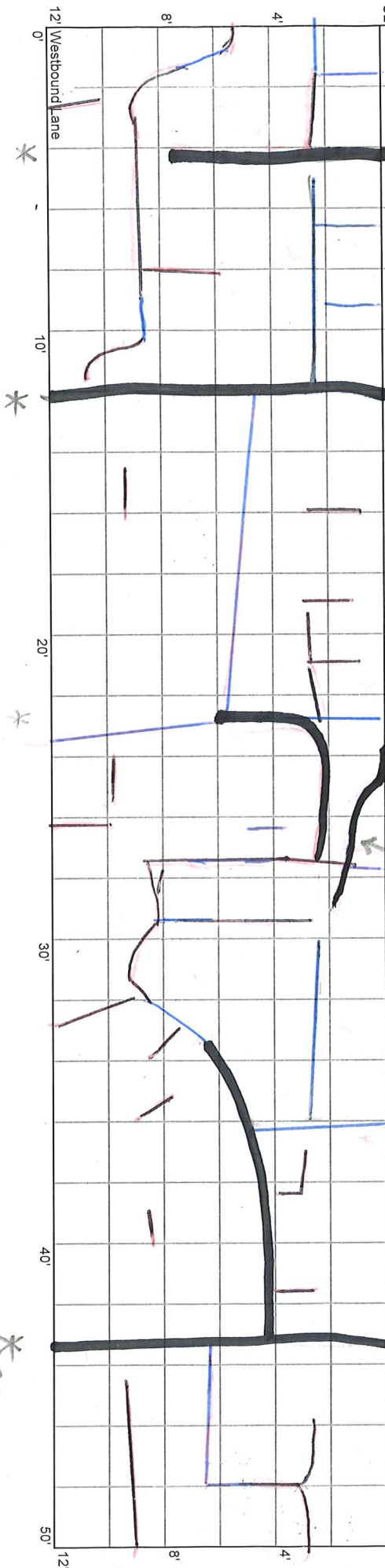

216'

CELL 7004W
250 - 300 ft

19+00

18+50

CELLS IN WESTBOUND LANE

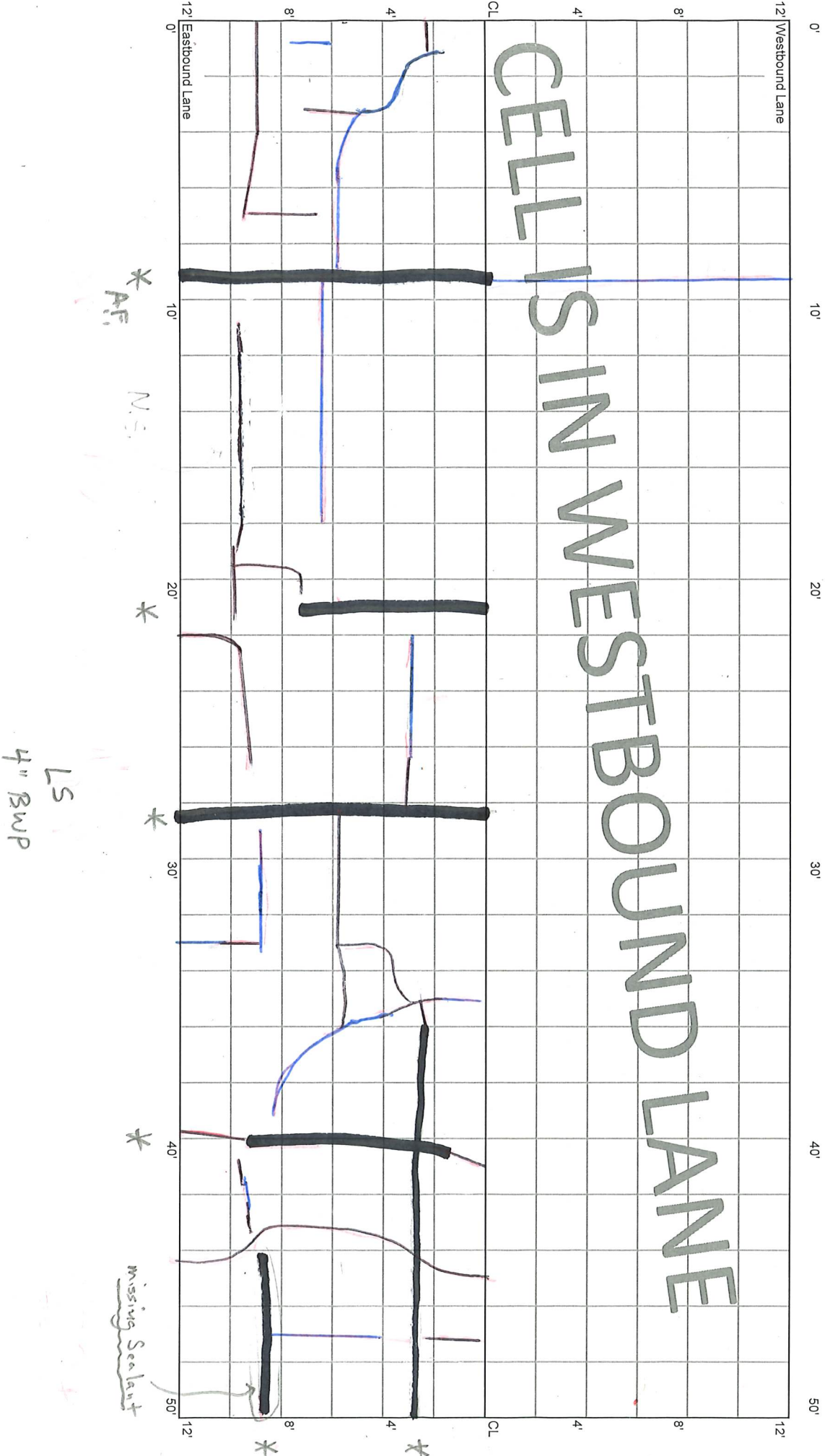

CELL 7004W
300 - 350 ft

18+50

18+00

12' Eastbound Lane

12' Westbound Lane

CELLS IN WESTBOUND LANE

Black

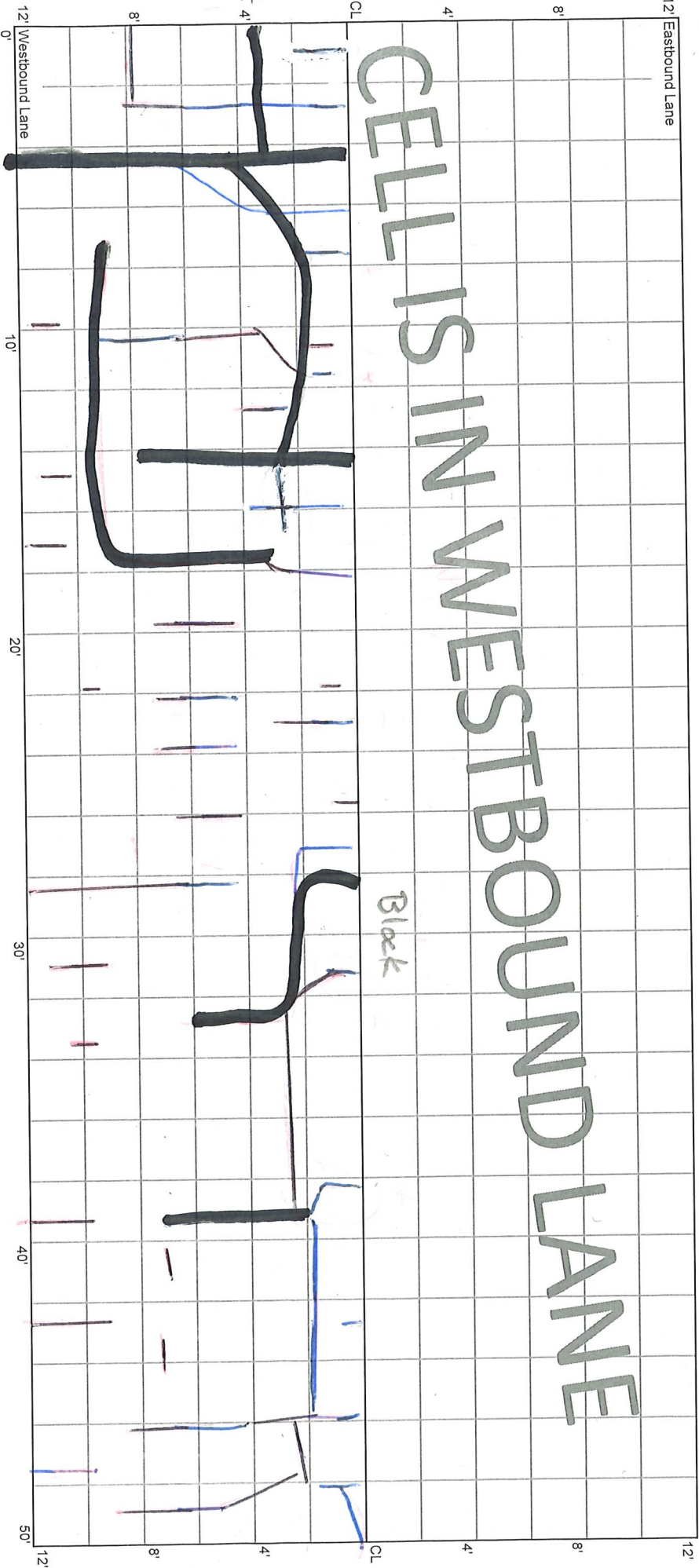

*

* AF

* SP

*

*

*

CELL 7004W
350 - 400 ft

18+00

17+50

12' Westbound Lane

12' Eastbound Lane

CELLS IN WESTBOUND LANE

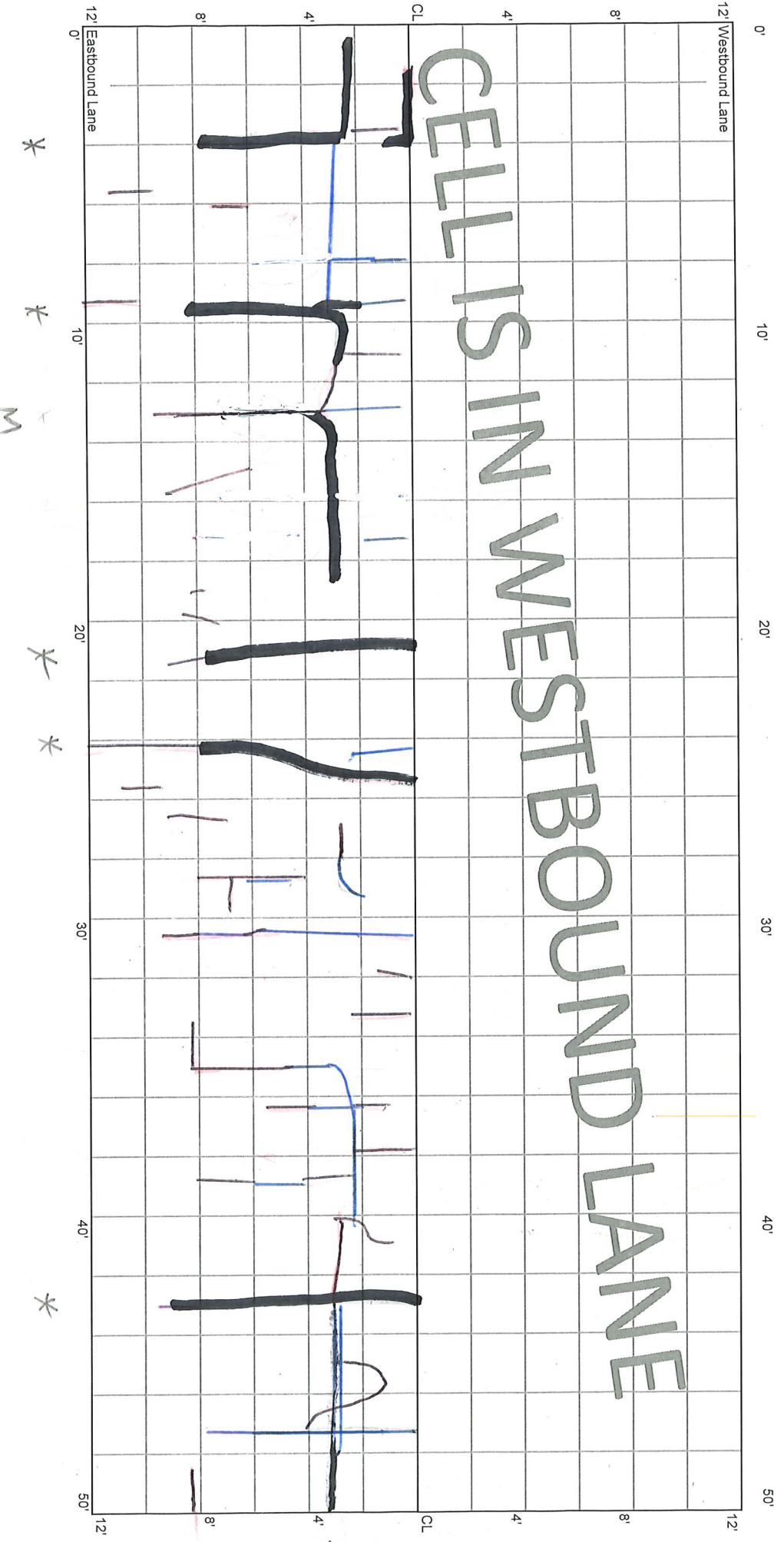

M

*

CELL 7004W
400 - 450 ft

17+50

17+00

12' Eastbound Lane

12'

12' Westbound Lane

12'

CELLS IN WESTBOUND LANE

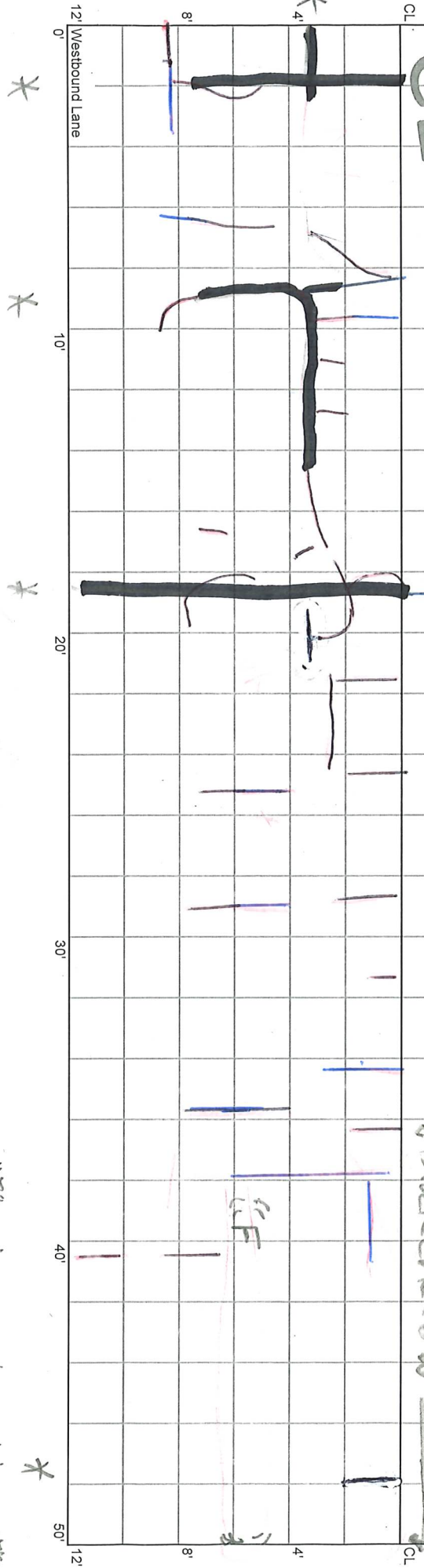

* AP

*¹⁰⁰ is long. crk & spaced trans. crks.

CELL 7004W
450 - 500 ft

17+00

18+50

12' Eastbound Lane

12'

CELLS IN WESTBOUND LANE

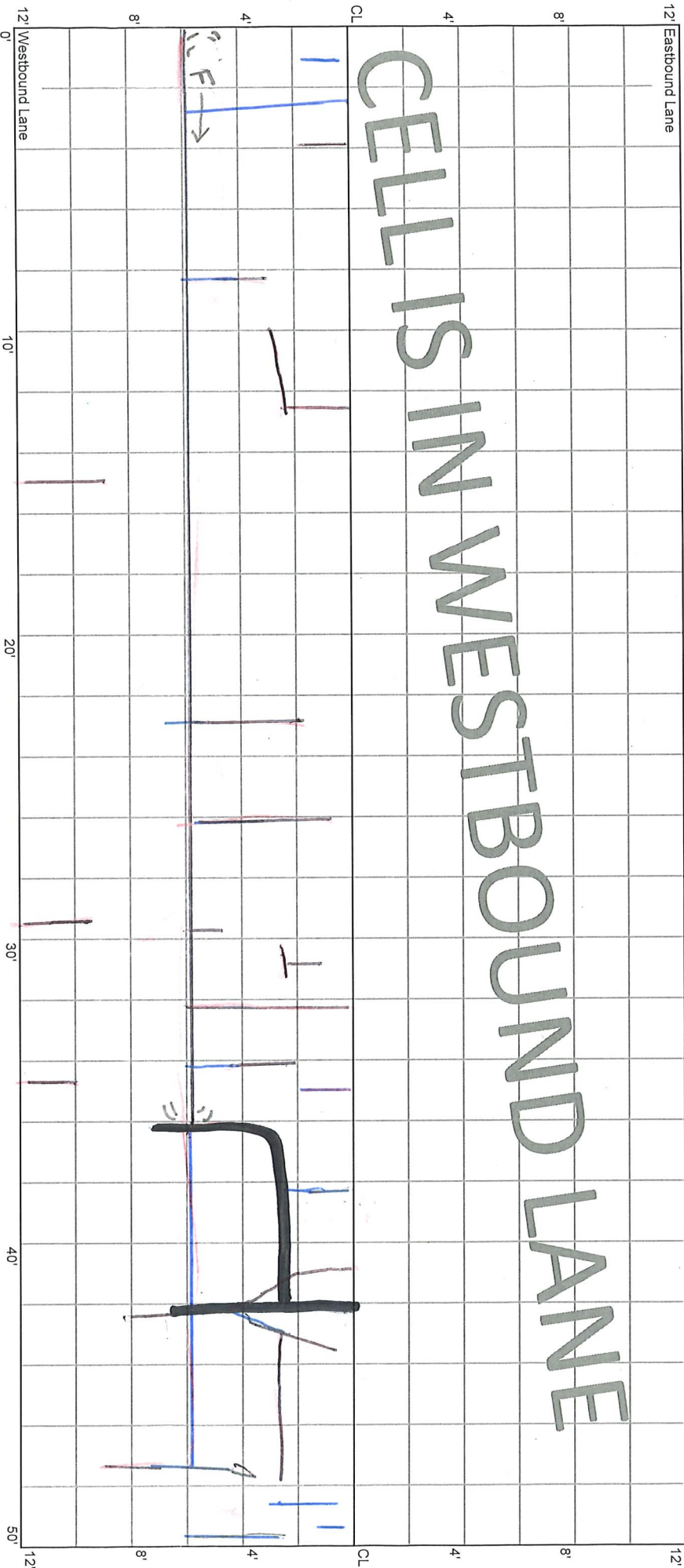

12' Westbound Lane

12'

CELL 7004W
500 - 550 ft

16+50

16+25

16+00

