

5.28.20 EST

10.14.20

1.4.21

9.15.21

CELL 7004W
0 - 50 ft

21+50

21+00

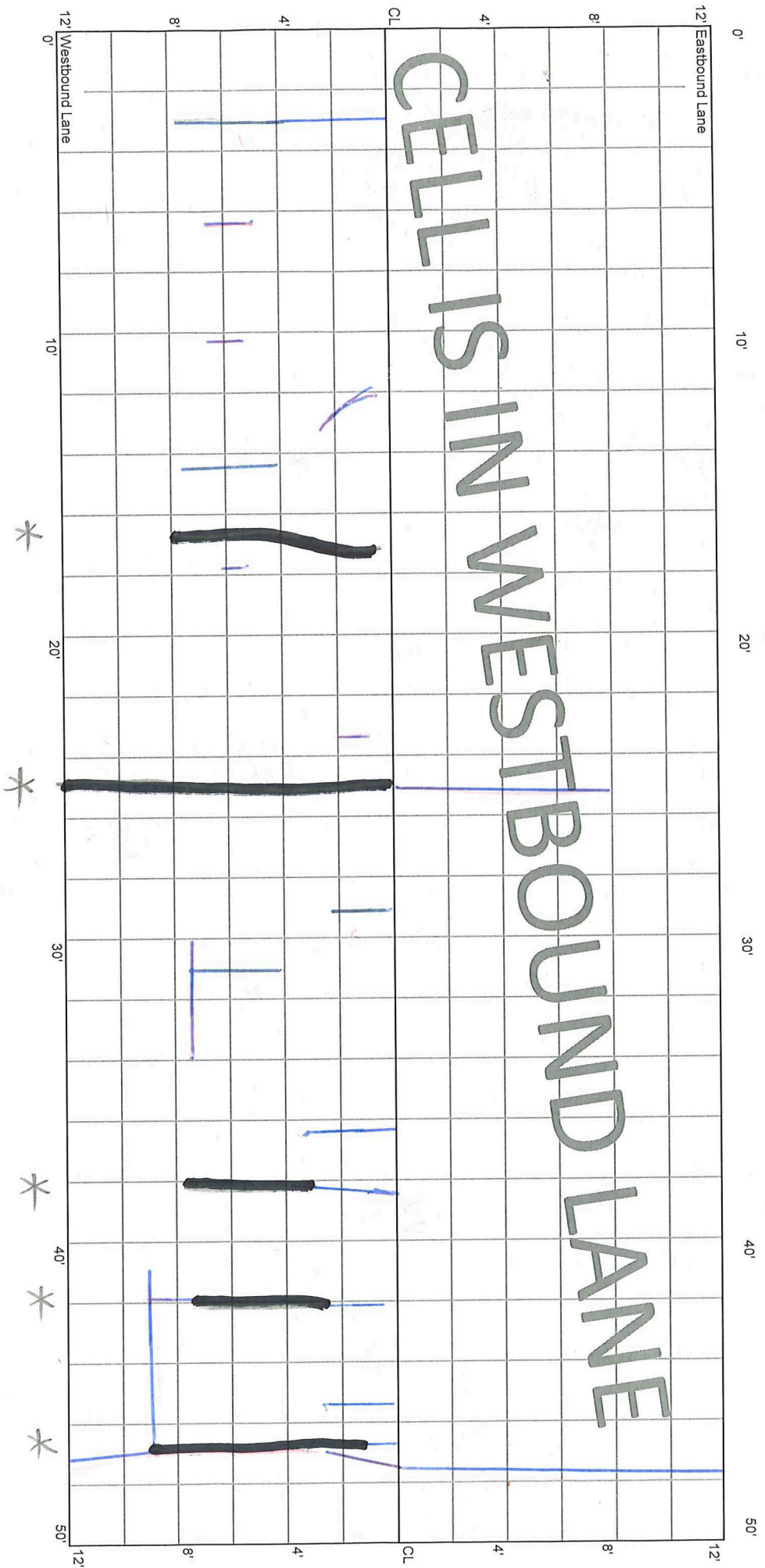

* Port & Seal

CELL 7004W
50 - 100 ft

CELL IS IN WESTBOUND LANE

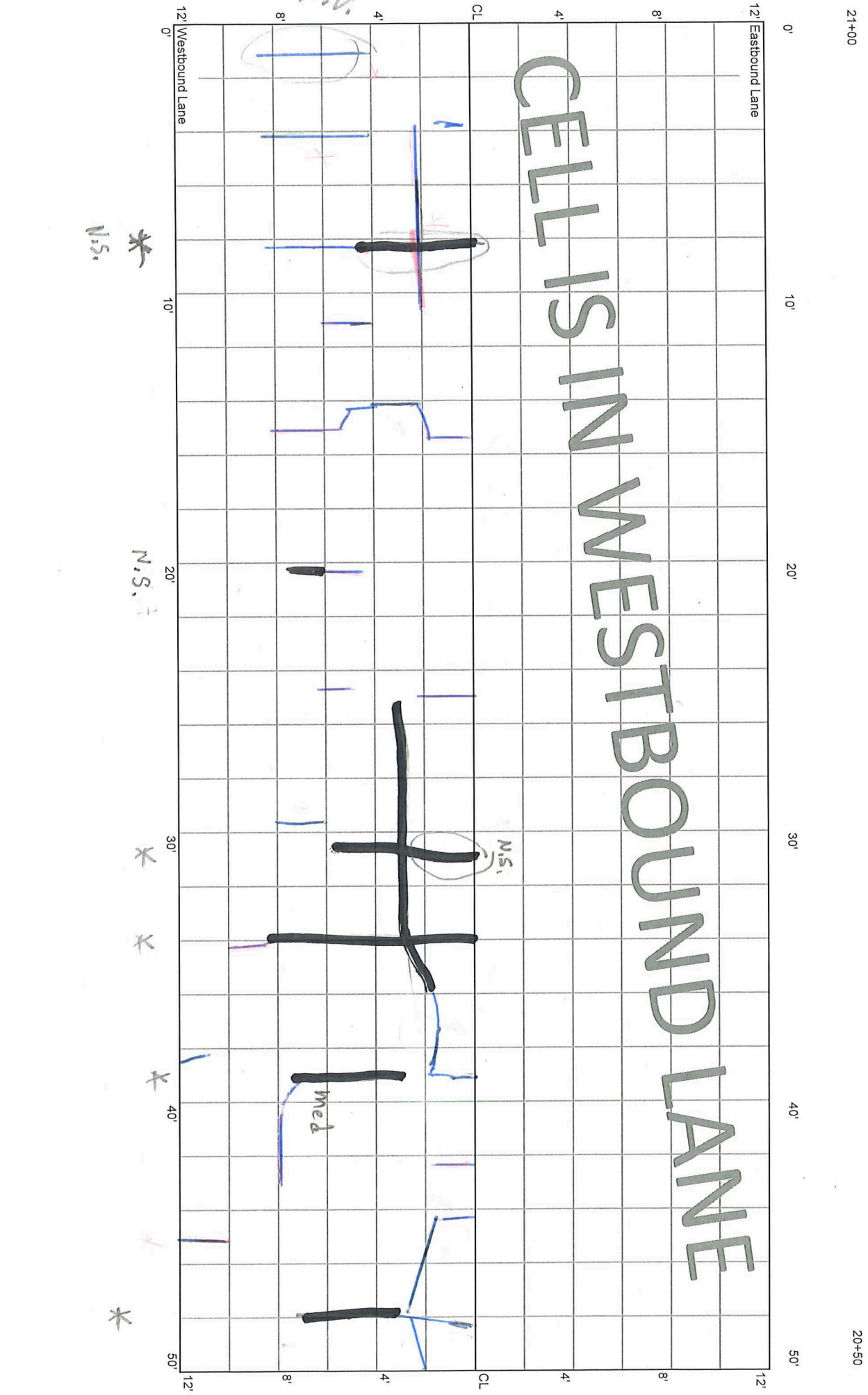

CELL 7004W
100 - 150 ft

20+50

20+00

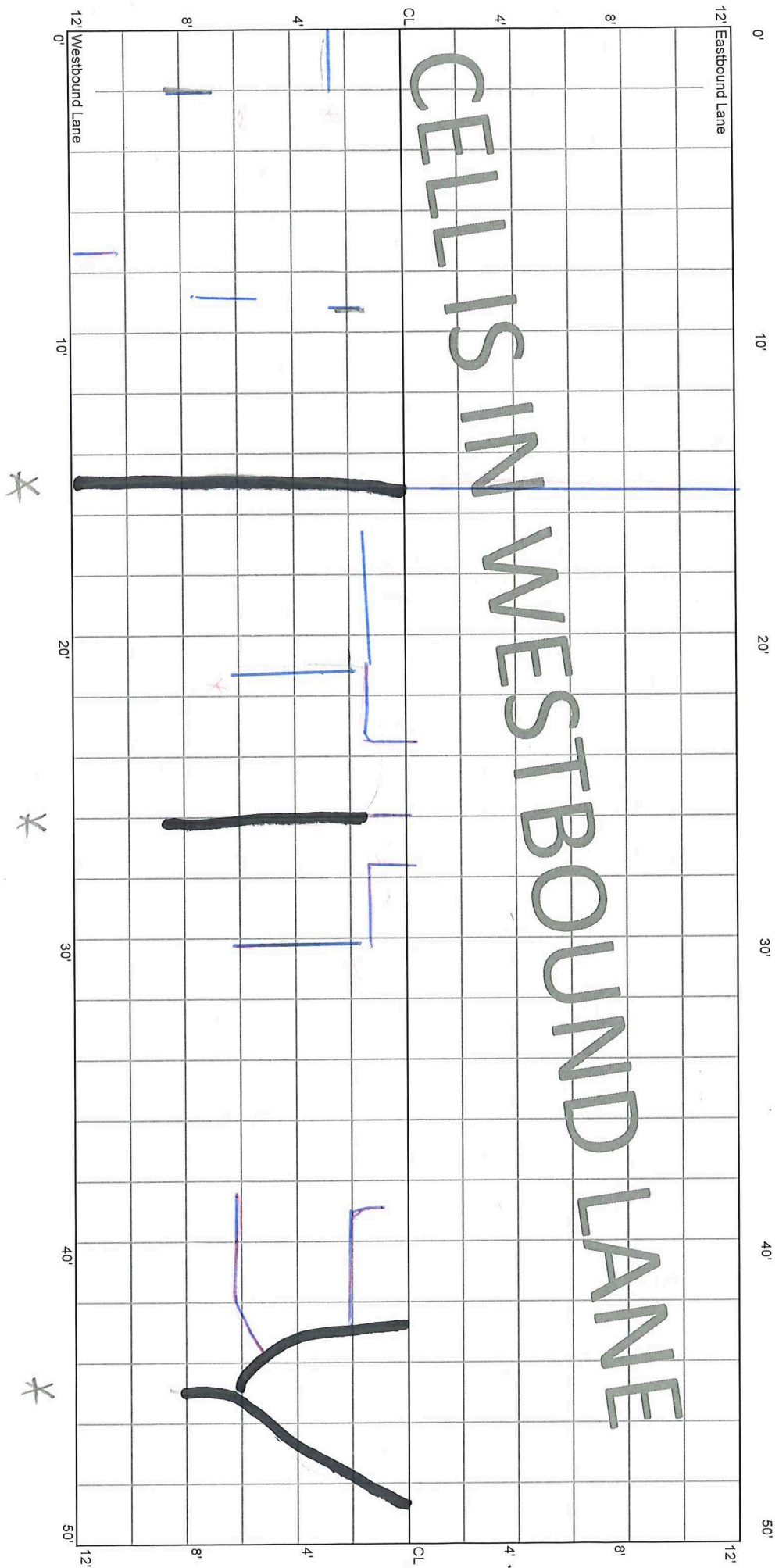

CELL 7004W
150 - 200 ft

20+00

19+50

12' Eastbound Lane

12' Westbound Lane

CELLS IN WESTBOUND LANE

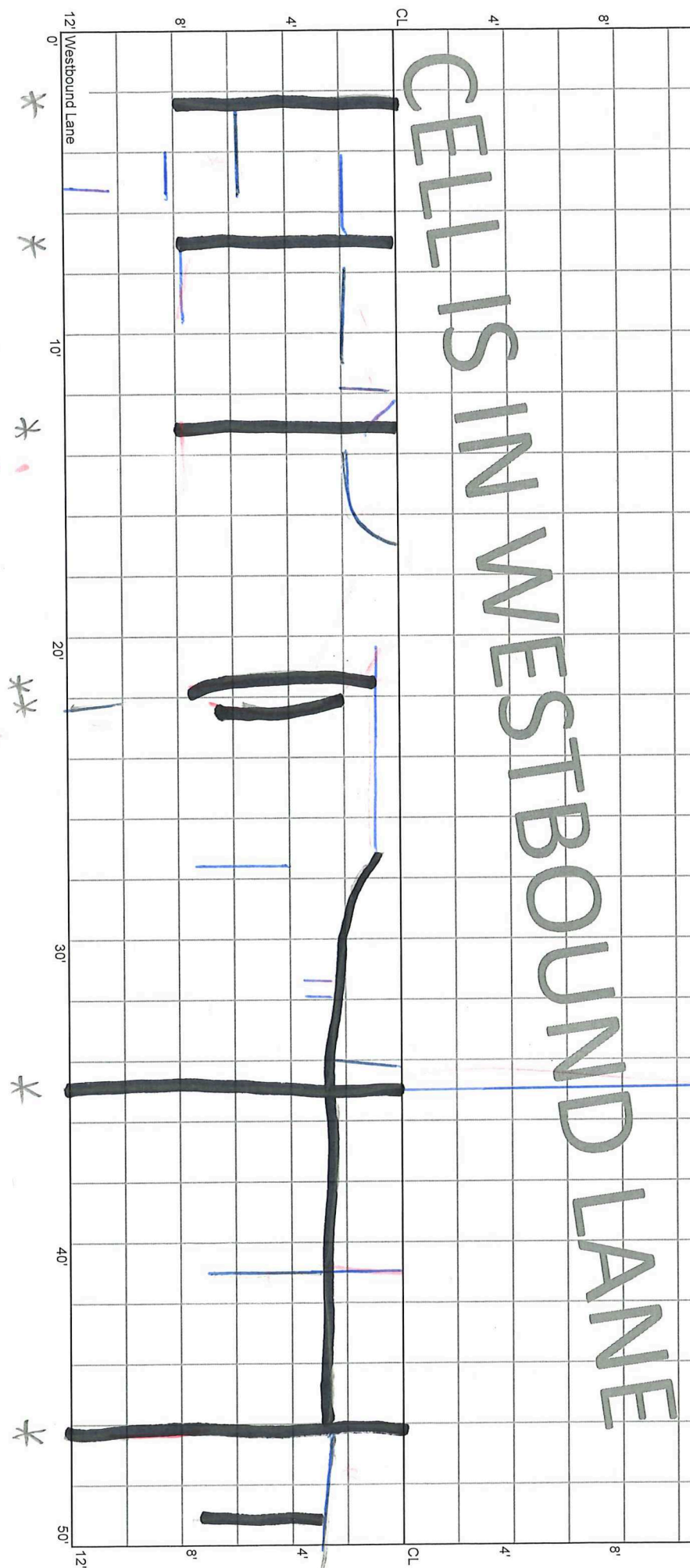

L.S.
6" BWP

CELL 7004W
200 - 250 ft

19+50

19+00

CELLS IN WESTBOUND LANE

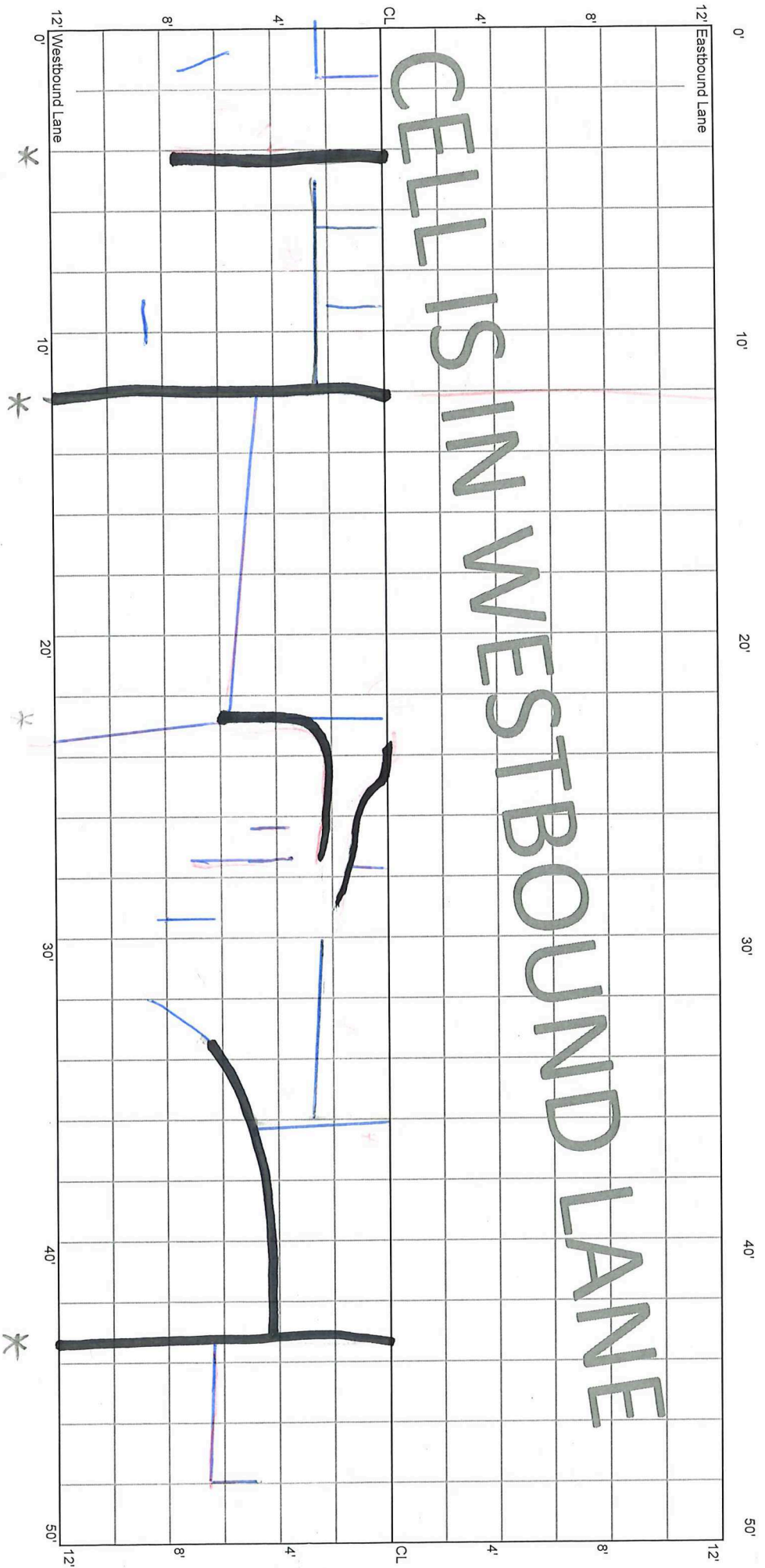

2/16'

CELL 7004W
250 - 300 ft

19+00

18+50

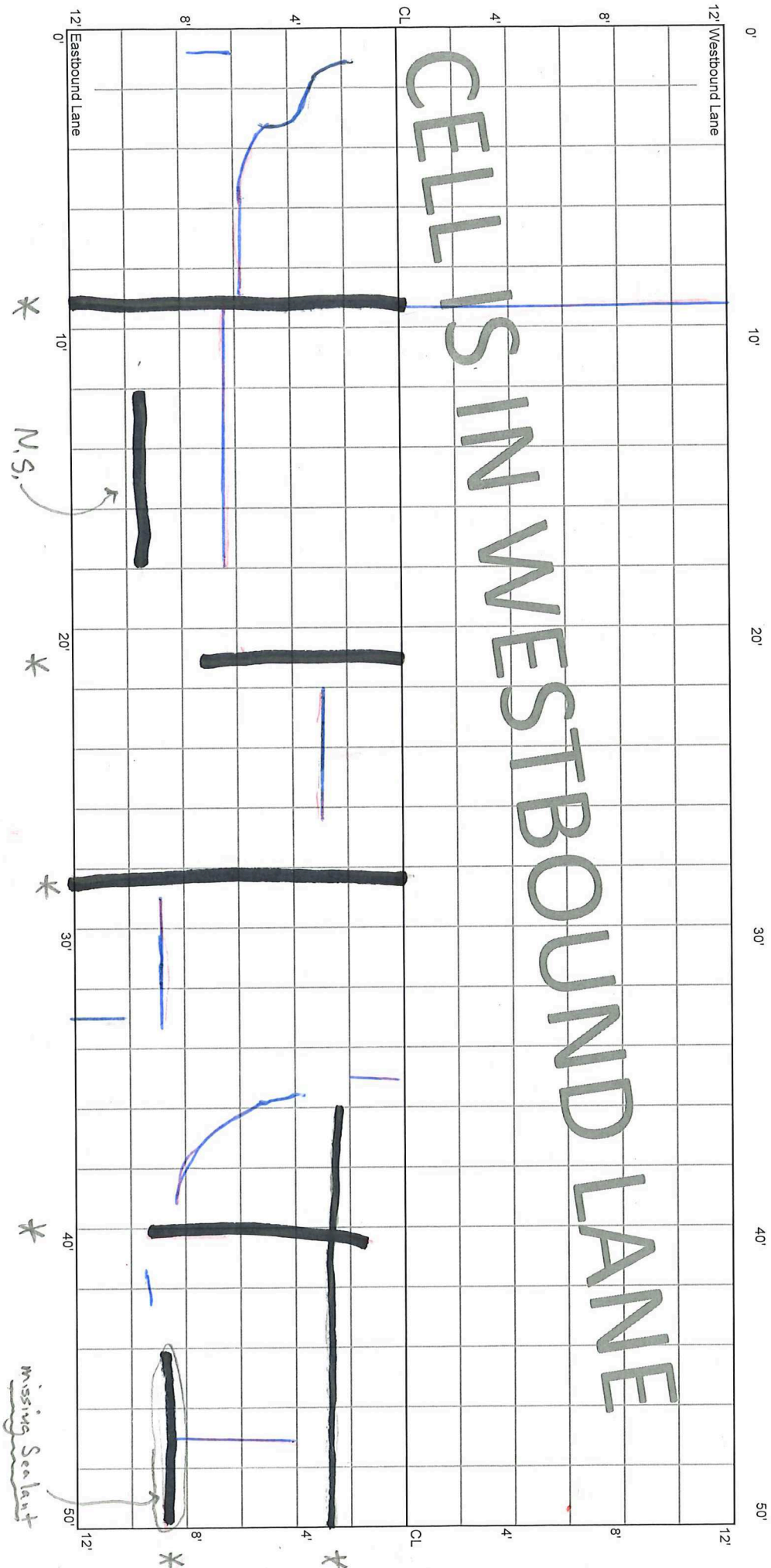

CELLS IN WESTBOUND LANE

* N.S. *

* missing Sealant *

LS
4" BWP

CELL 7004W
300 - 350 ft

18+50

18+00

12' Eastbound Lane

12'

CELLS IN WESTBOUND LANE

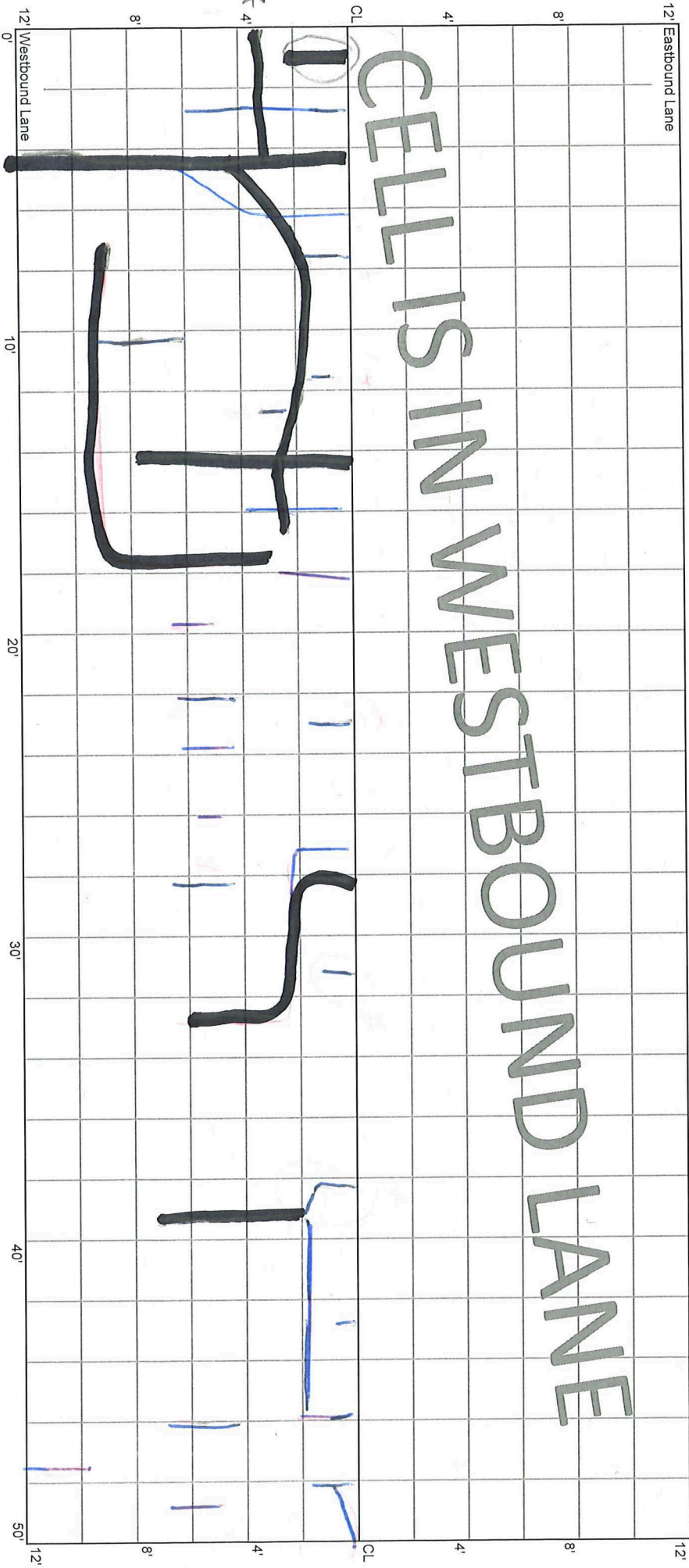

12' Westbound Lane

12'

No. 5

CELL 7004W
350 - 400 ft

18+00

17+50

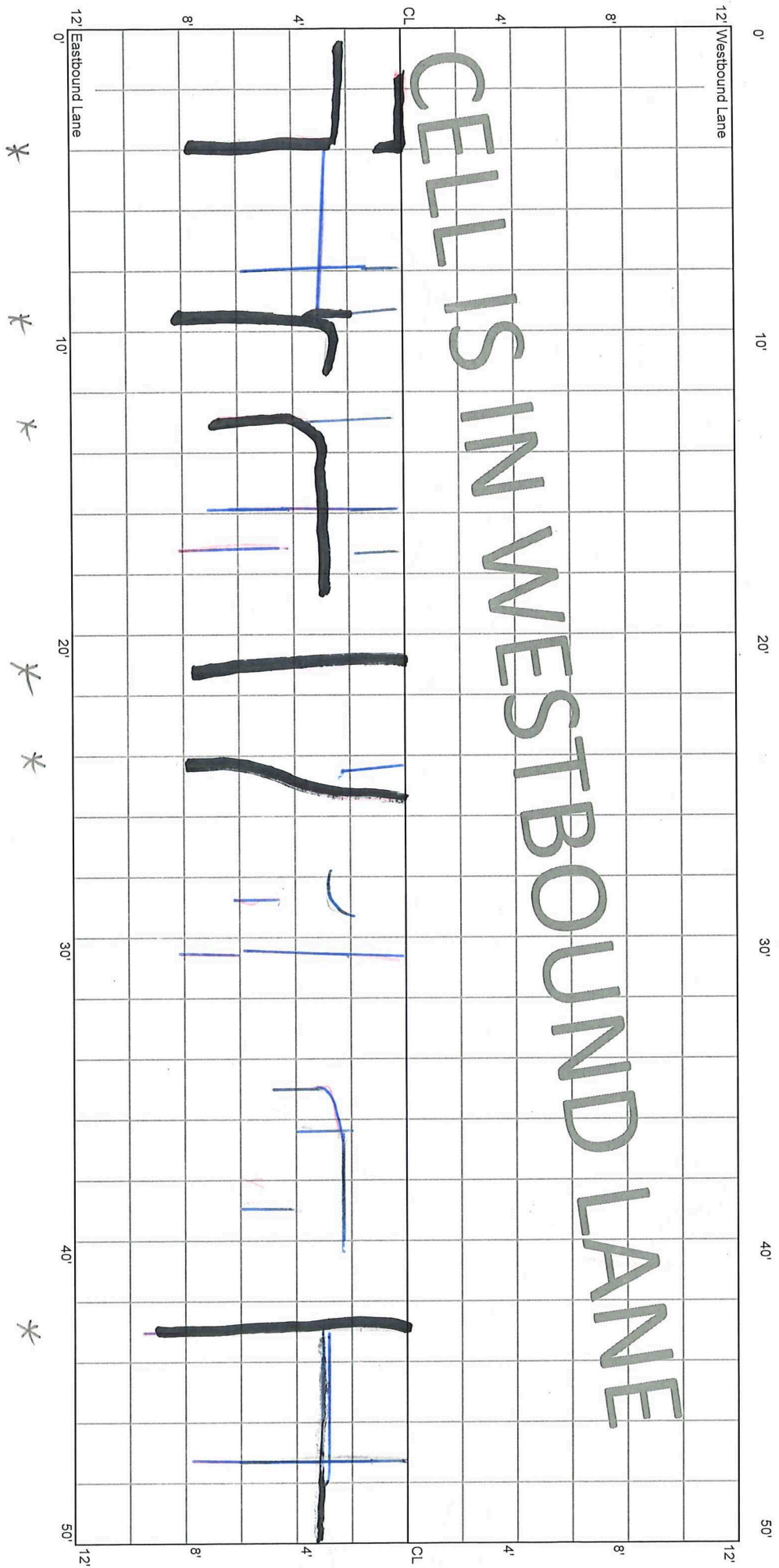

CELL 7004W
400 - 450 ft

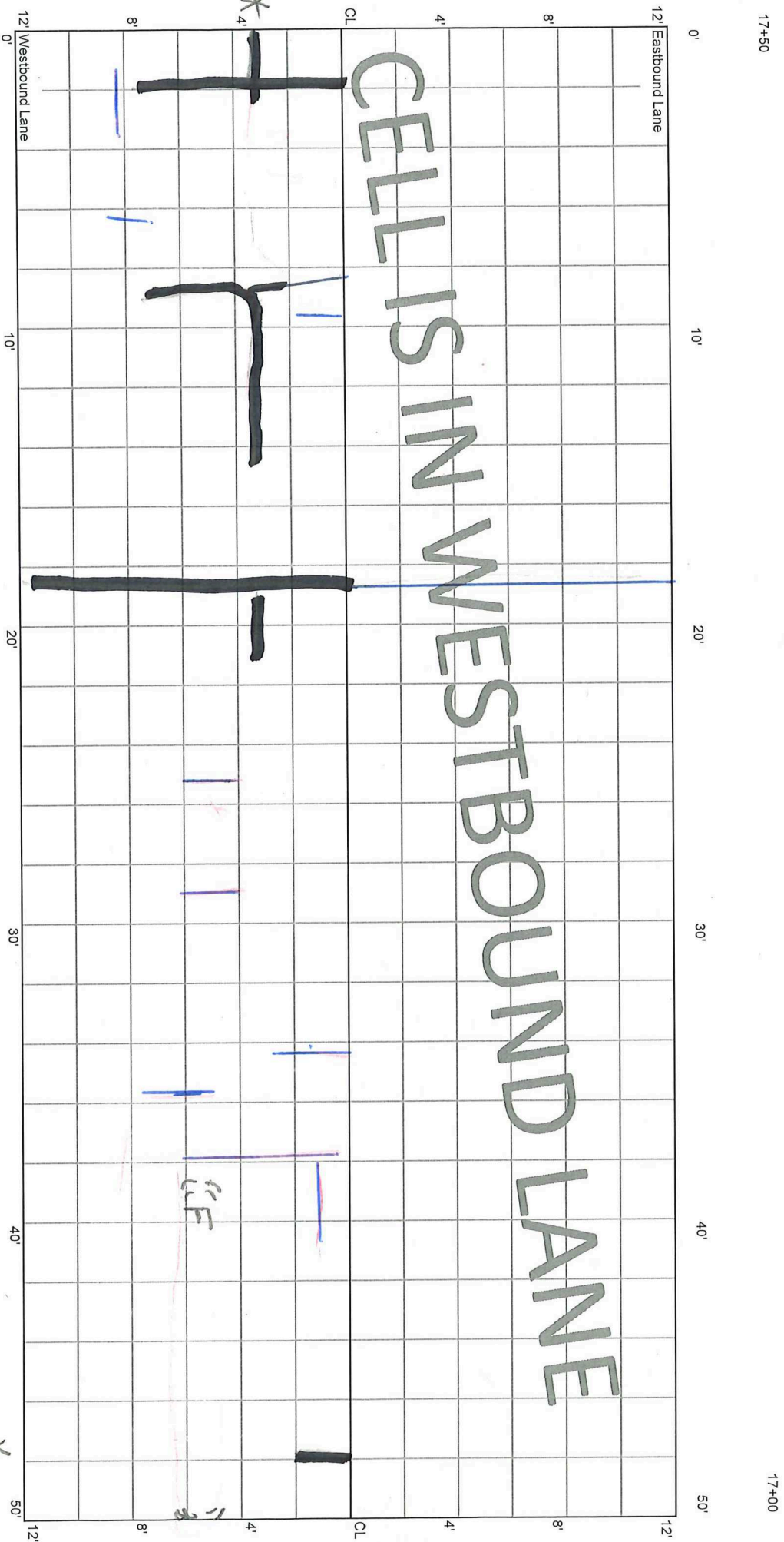

wp is long. crk & spaced trans. crks.

CELL 7004W
450 - 500 ft

17+00

16+50

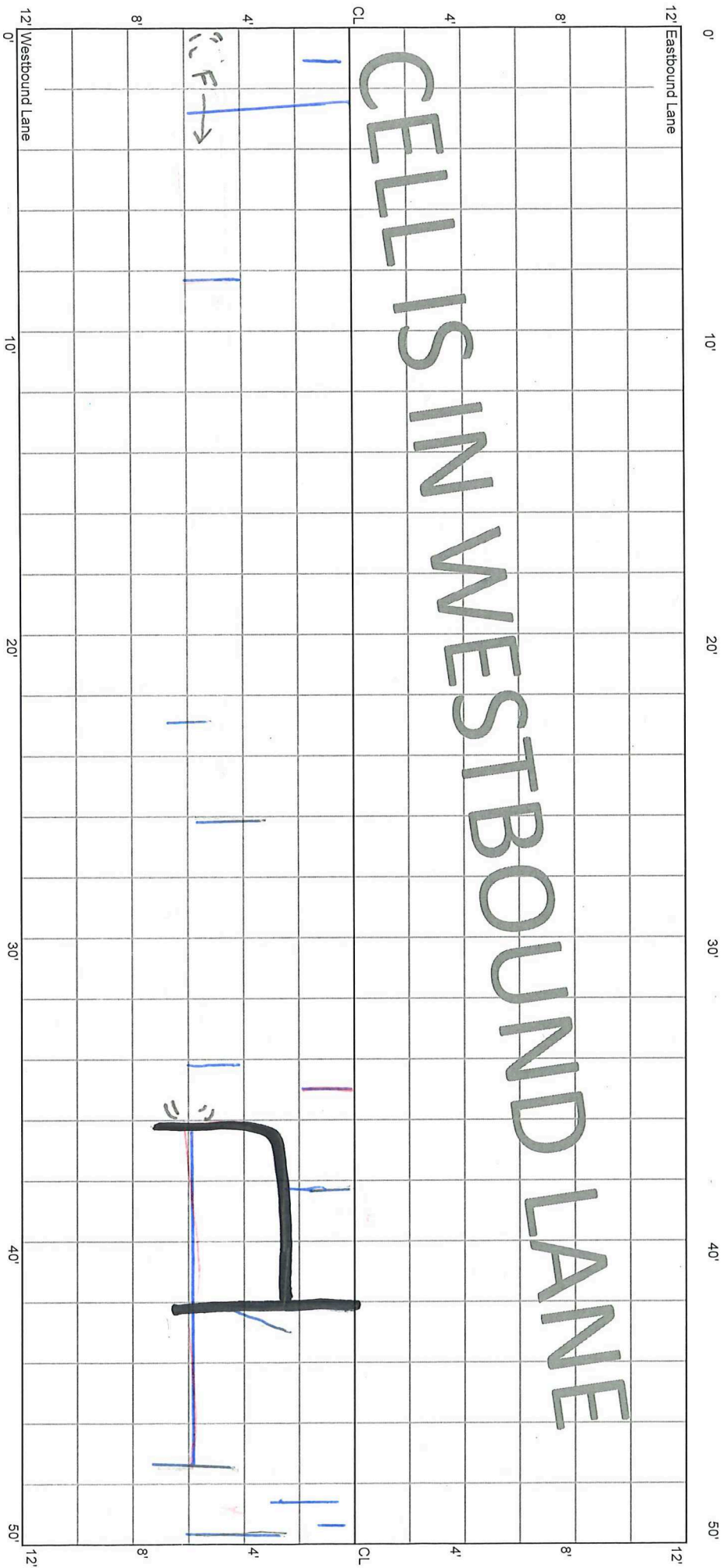

CELLS IN WESTBOUND LANE

CELL 7004W
500 - 550 ft

16+50

16+25

16+00

