

5.28.20 E.J.

10.14.20 | 1.3.22

1 - 4, 21

File 70TH ST

9.14.21

CELL 7003W
0 - 50 ft

16+00

15+50

CELLS IN WESTBOUND LANE

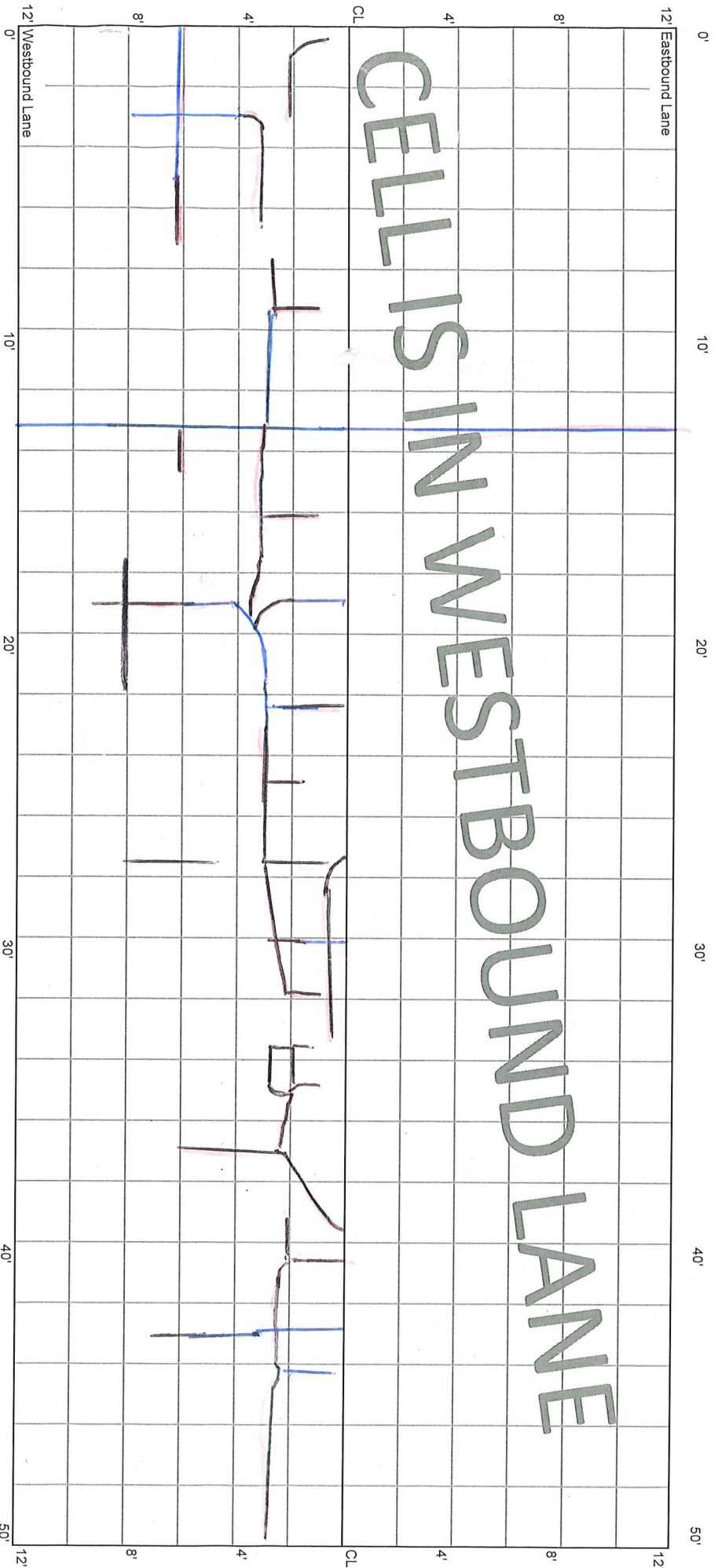

* Rout & Seal

CELL 7003W
50 - 100 ft

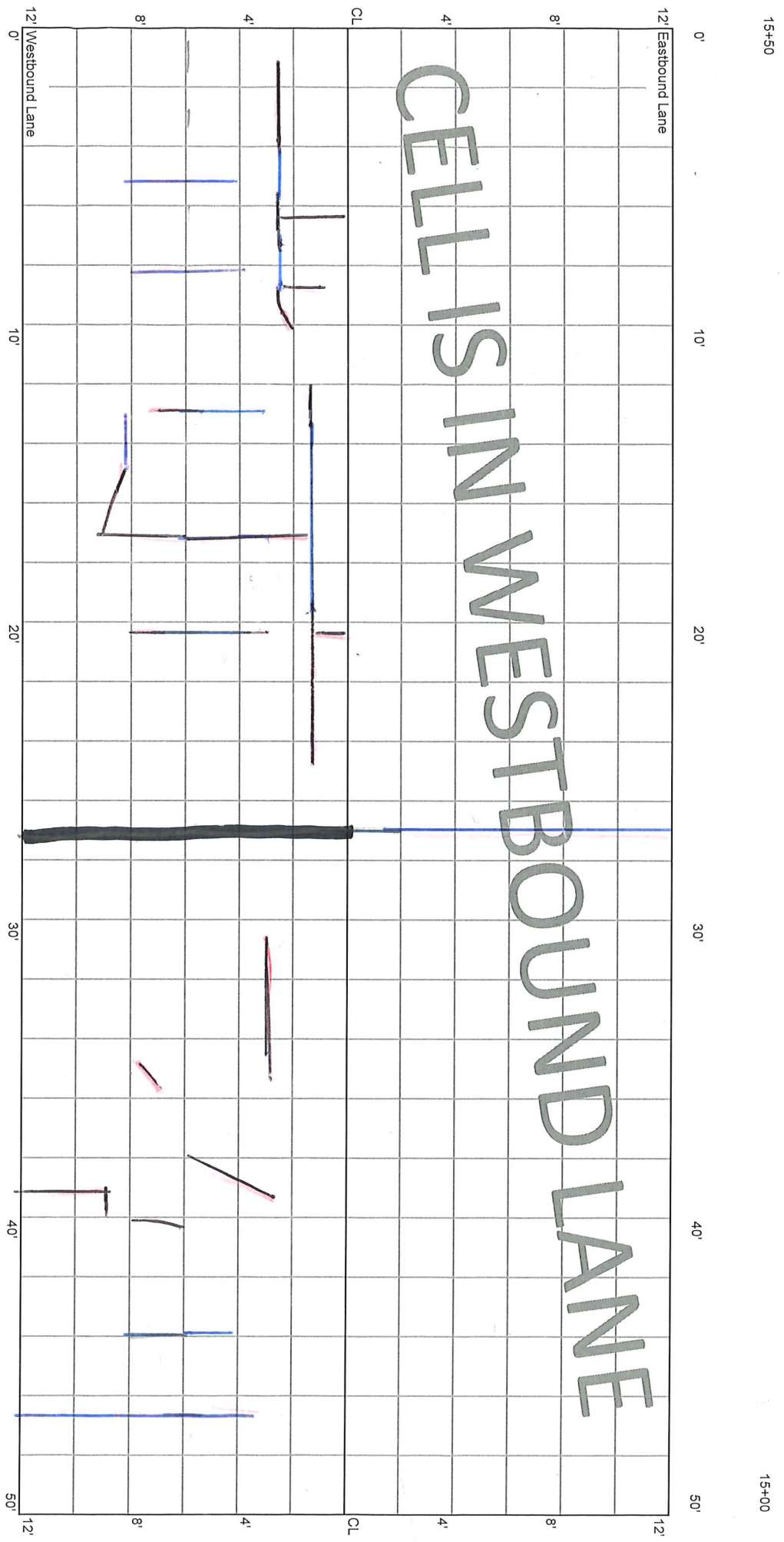

15+50

15+00

*M
AR

CELL 7003W
100 - 150 ft

15+00

14+50

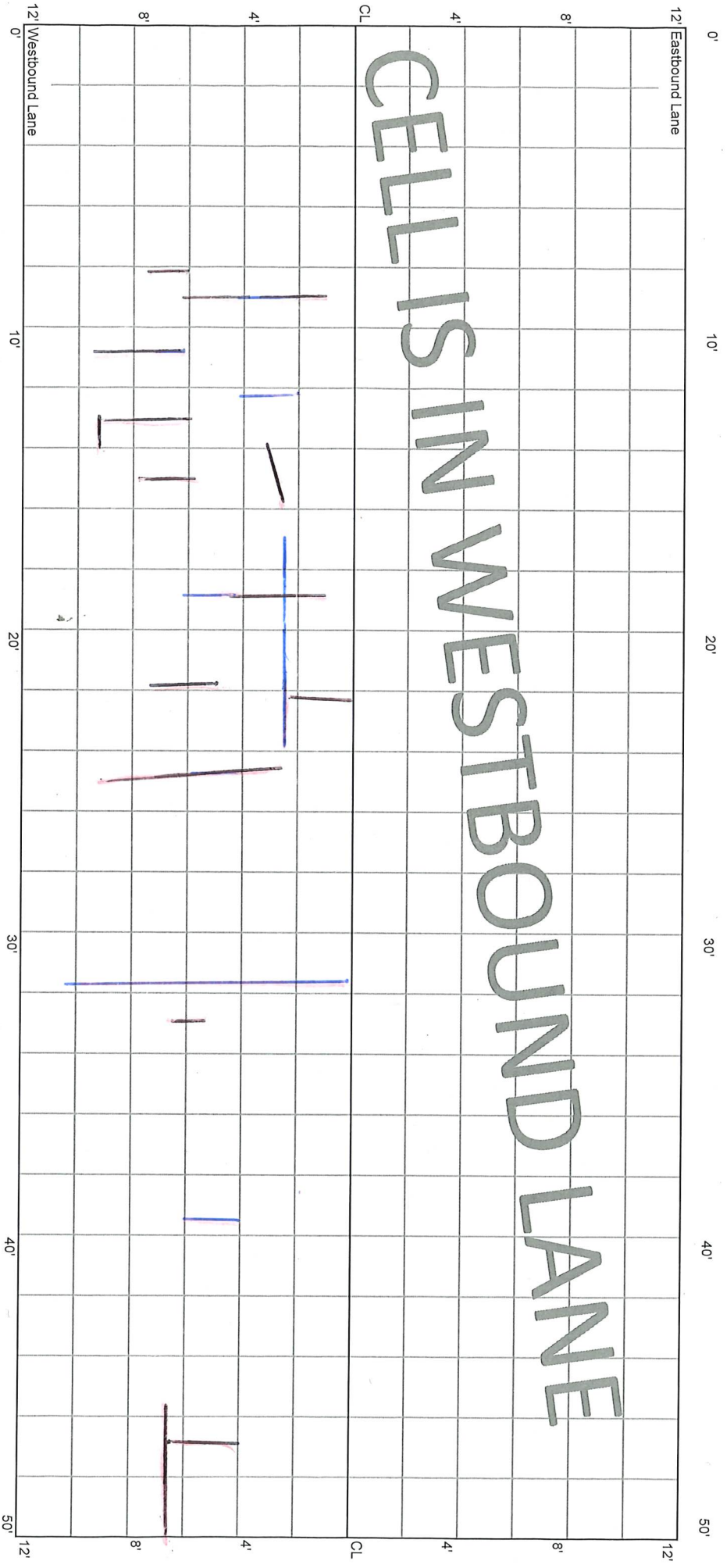

CELL 7003W
150 - 200 ft

14+50

14+00

CELLS IN WESTBOUND LANE

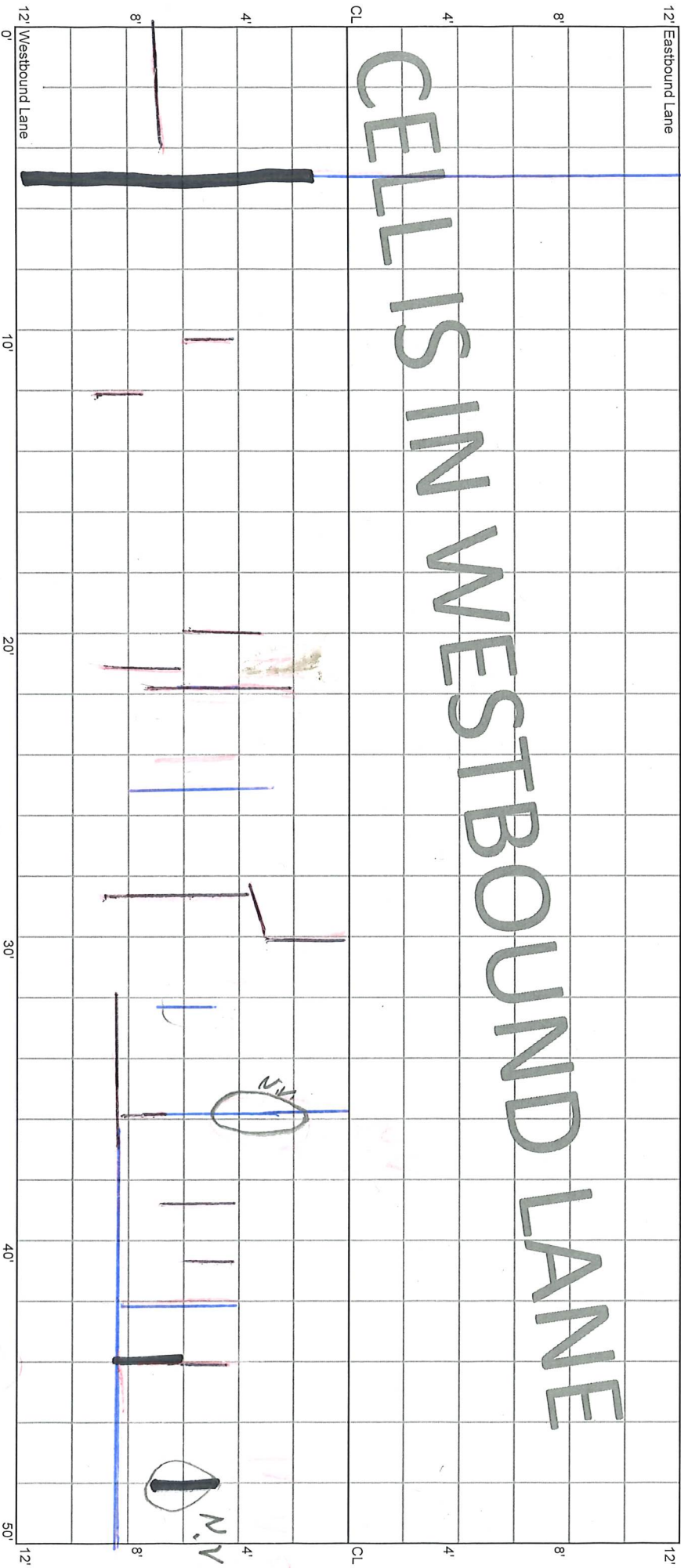

No Seal

4'

No Seal

CELL 7003W
200 - 250 ft

14+00

13+50

12' Eastbound Lane

0' 10' 20' 30' 40' 50'

CELLS IN WESTBOUND LANE

12' Westbound Lane

0' 10' 20' 30' 40' 50'

* Sealed

* AF

Lost
6" Seal BWP

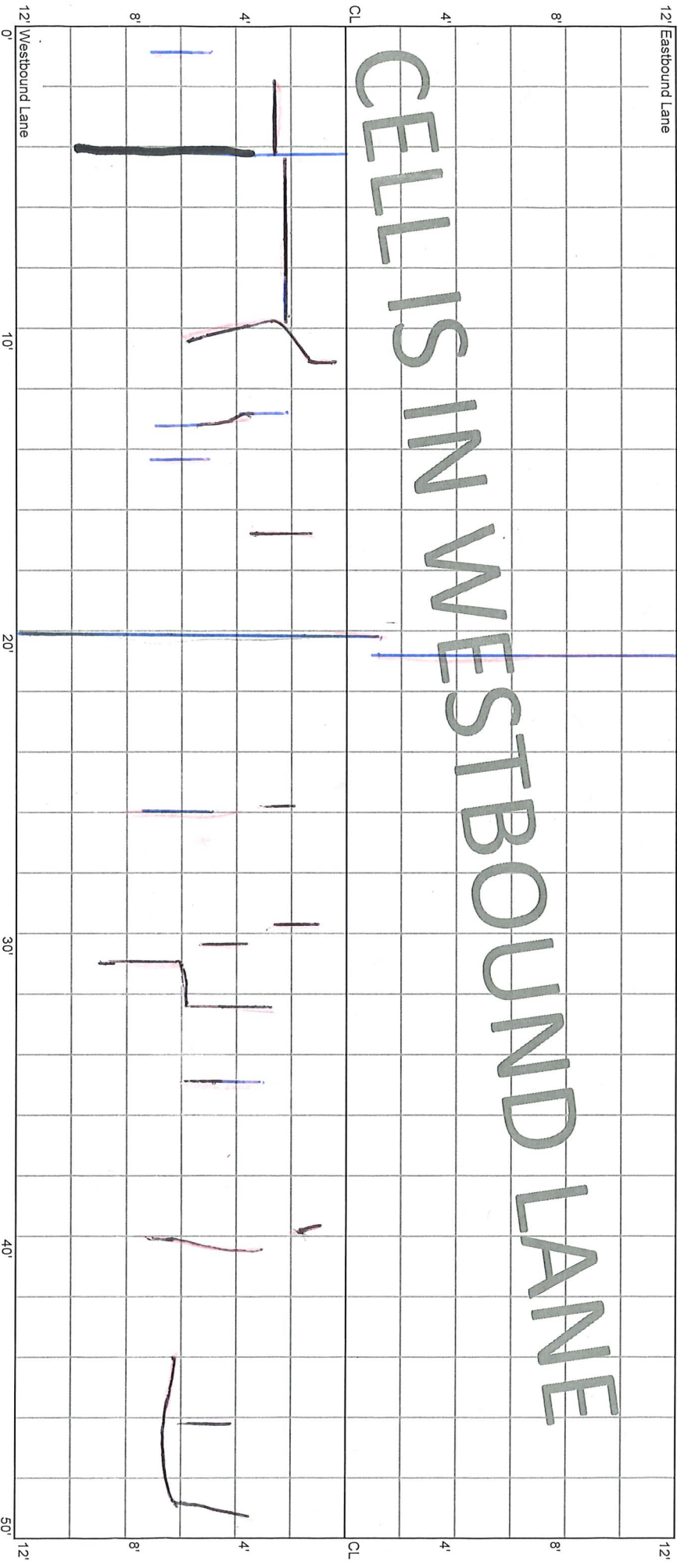

CELL 7003W
250 - 300 ft

13+50

13+00

CELLS IN WESTBOUND LANE

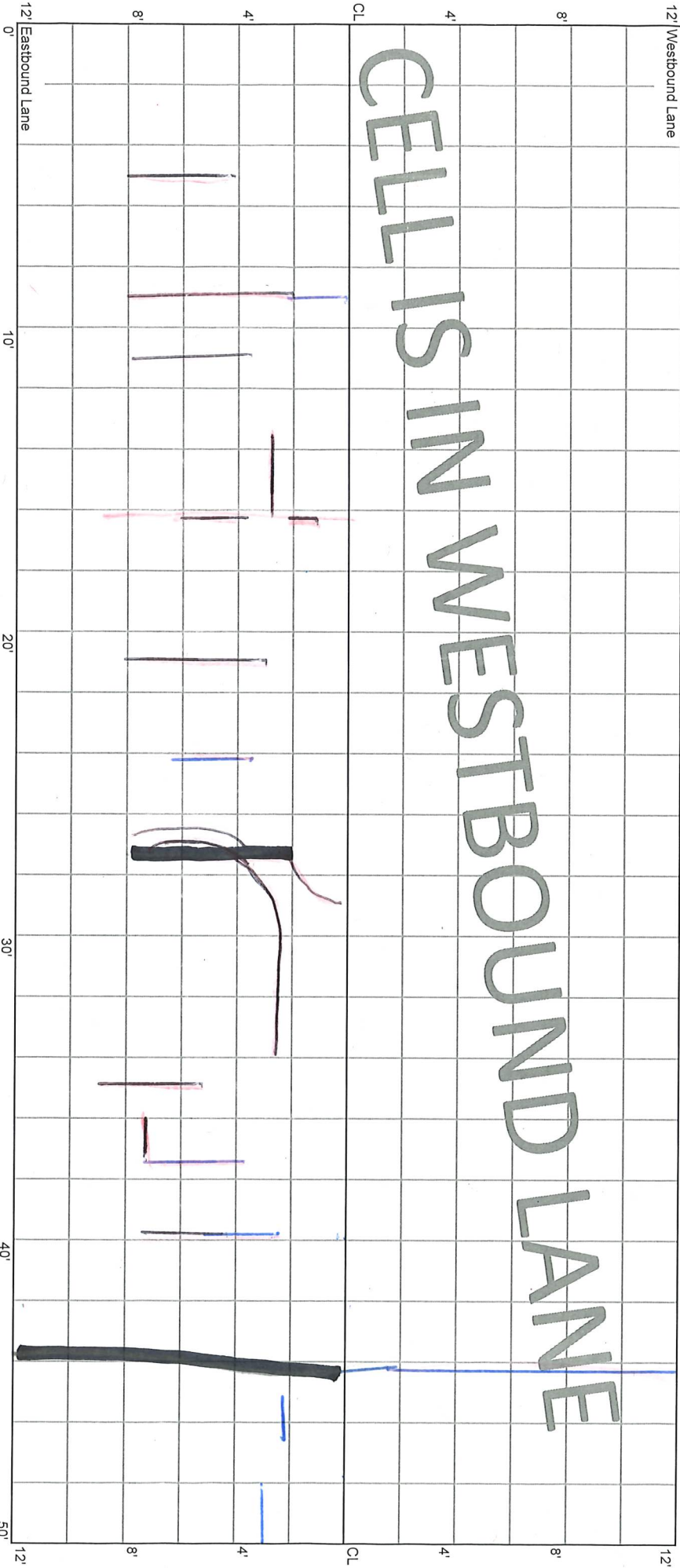

* M

* AF

5:16 PM

CELL 7003W
300 - 350 ft

13+00

12+50

12' Eastbound Lane

12' Westbound Lane

CELLS IN WESTBOUND LANE

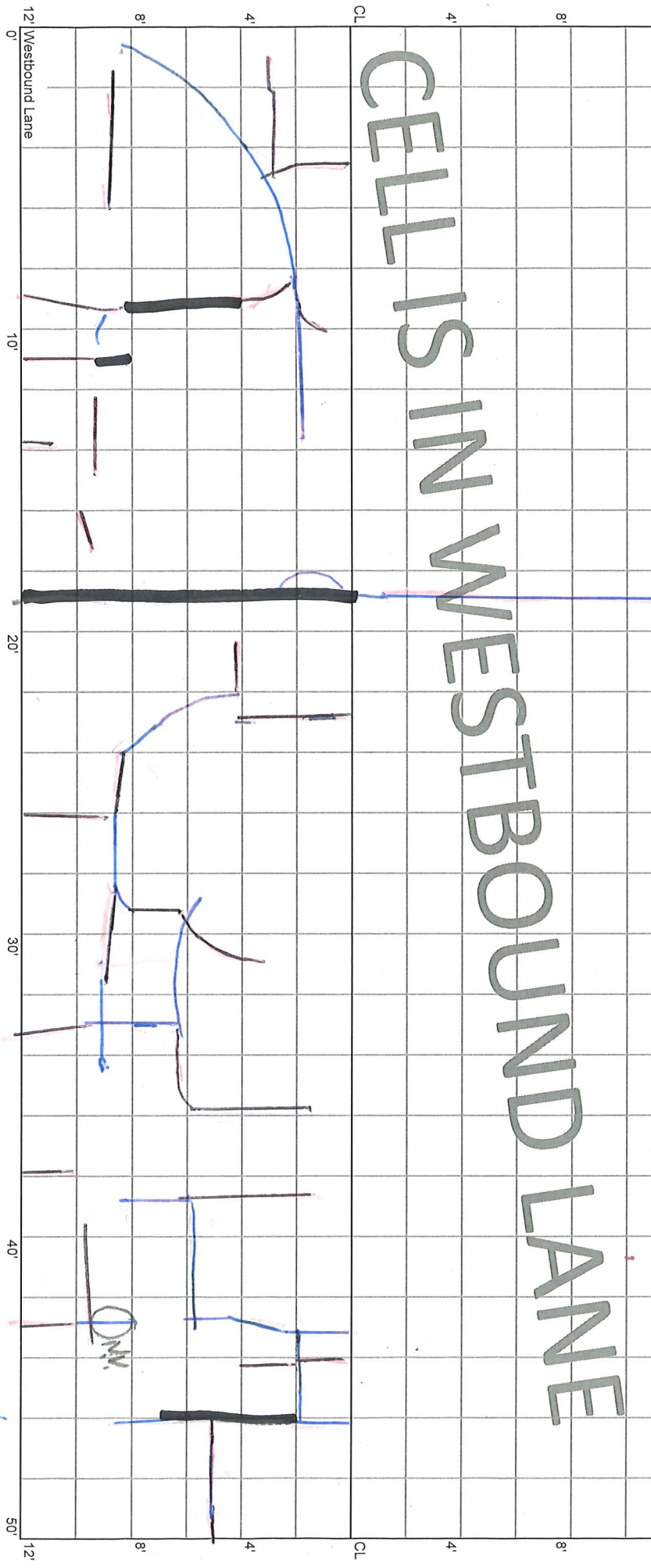

*
N.S.

*

*
N.S.

CELL 7003W
350 - 400 ft

12+50

12+00

12' Westbound Lane

12'

CELLS IN WESTBOUND LANE

12' Eastbound Lane

12'



N5.

M

N15.

Lost seal
6" BWP

CELL 7003W
400 - 450 ft

12+00

11+50

CELLS IN WESTBOUND LANE

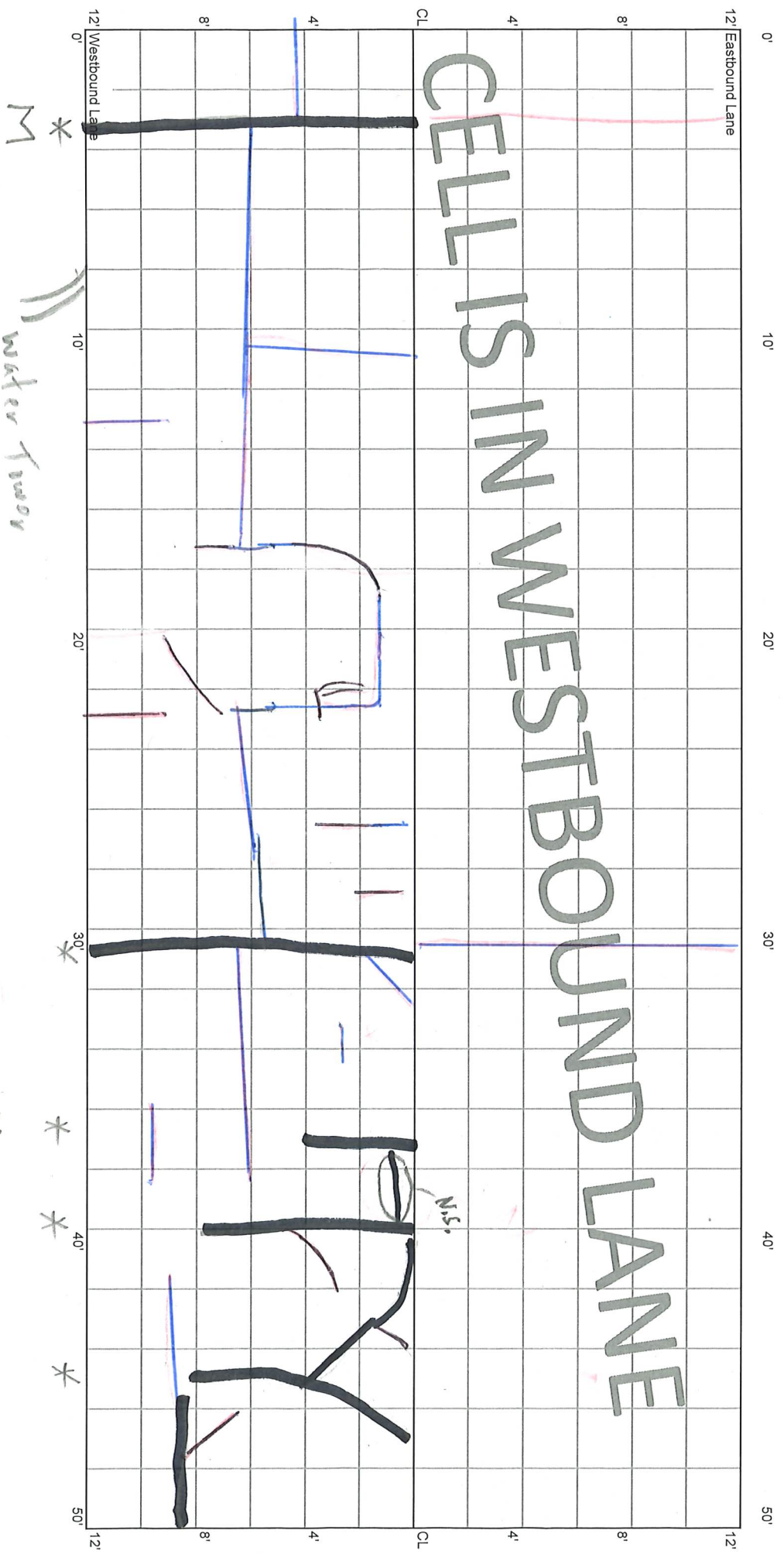

Lost Seal
6" BWP

L.S. 6" BWP

L.S. 6" LWP

- LS 6" BWP
- (2) LS 3" LWP

CELL 7003W
450 - 500 ft

11+50

11+00

CELLS IN WESTBOUND LANE

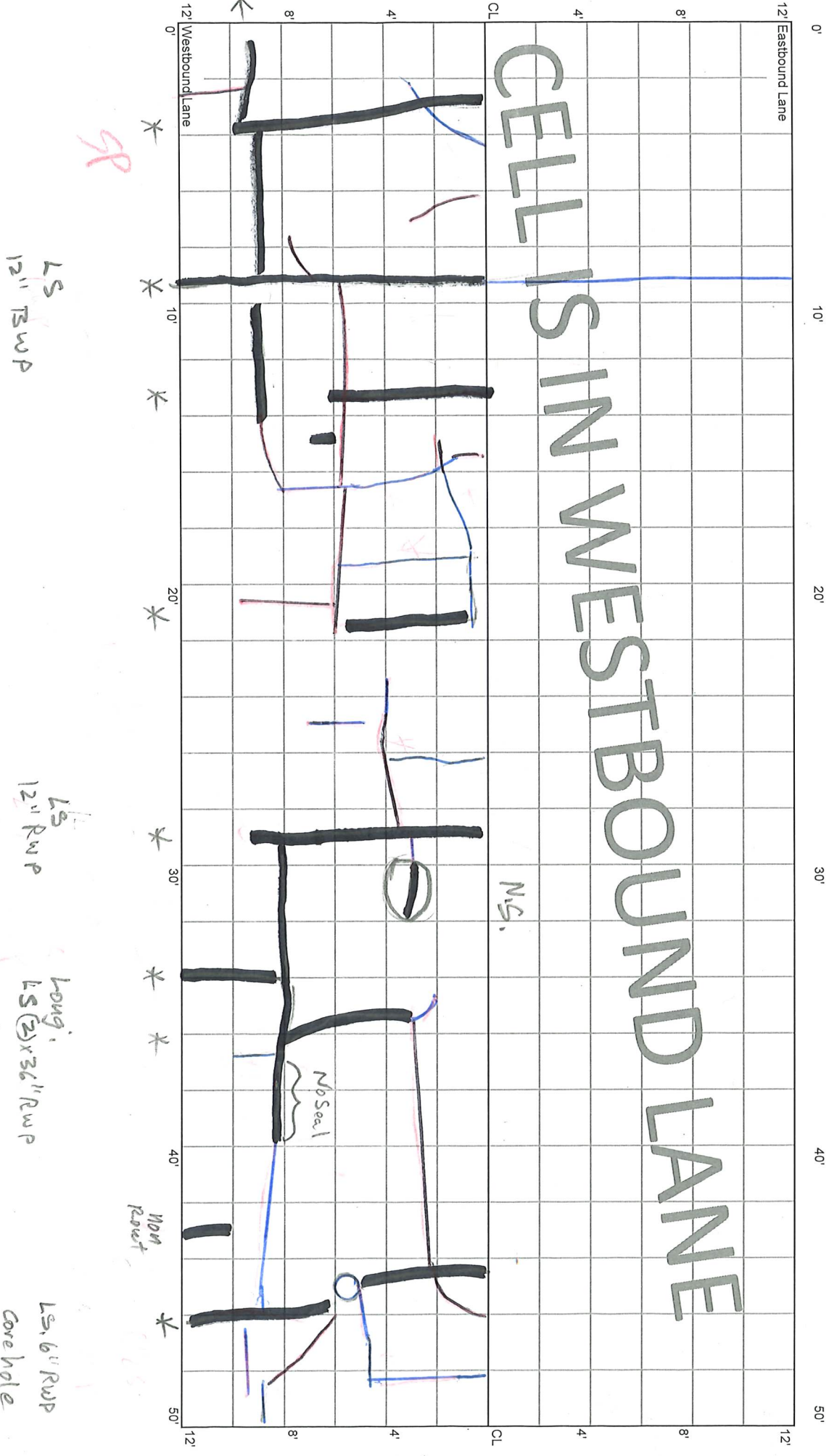

LS
12" RW P

LS
12" RW P

Long
LS (2) x 36" RW P

LS 6" RW P
Core hole

CELL 7003W
500 - 550 ft

11+00

10+75

10+50

0' 10' 20' 25' 30' 40' 50'

12' Eastbound Lane

CELLS IN WESTBOUND LANE

CL

4'

8'

END RATING: BEGIN TRANSITION TO
NEXT CELL

12' Westbound Lane

0' 10' 20' 25' 30' 40' 50'