

5.28.20 E.S.

10.14.20

1.4.21

8.25.21

File 70TH ST

CELL 7001W
0 - 50 ft

5+00

4+50

0' 10' 20' 30' 40' 50'

12' Eastbound Lane

12'

CELLS IN WESTBOUND LANE

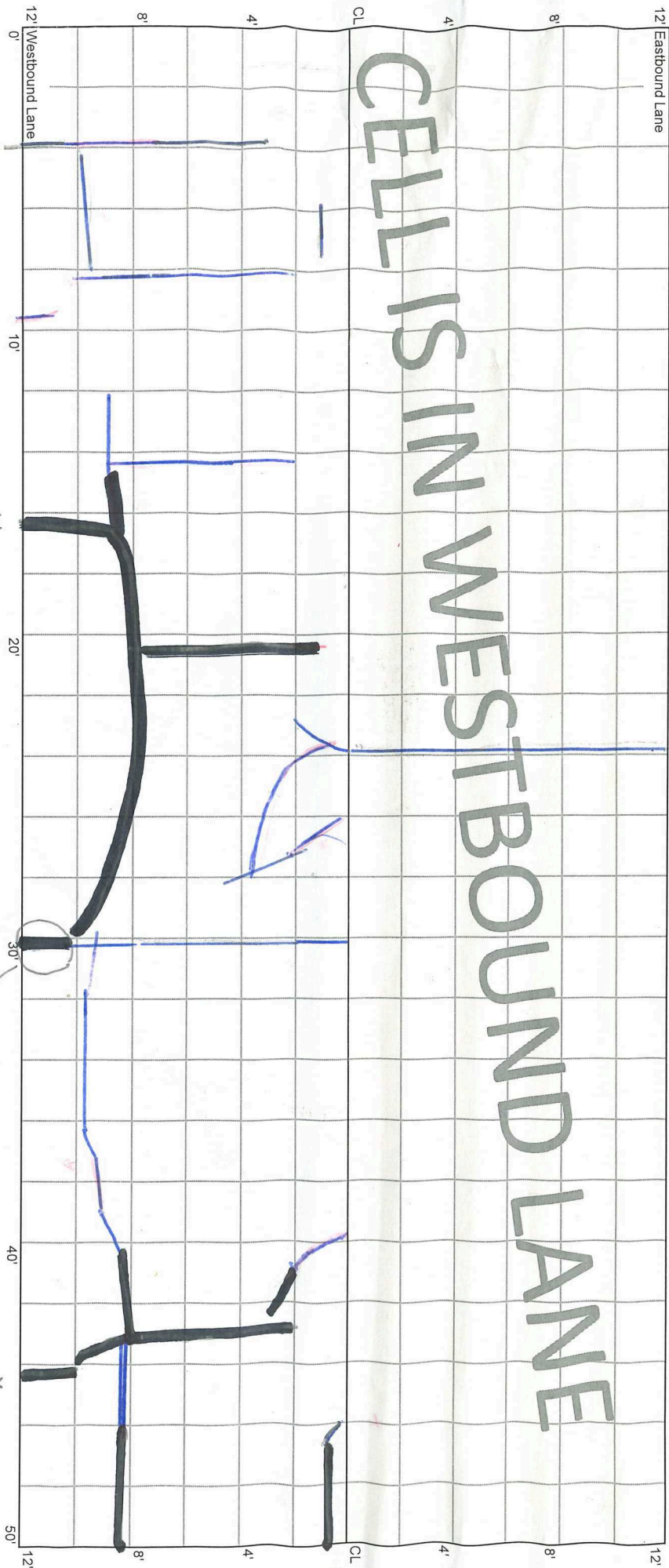

* Part 2 Seal

F-11k
R1
R2

CELL 7001W
50 - 100 ft

4+50

4+00

12' Eastbound Lane

12' Westbound Lane

CELL IS IN WESTBOUND LANE

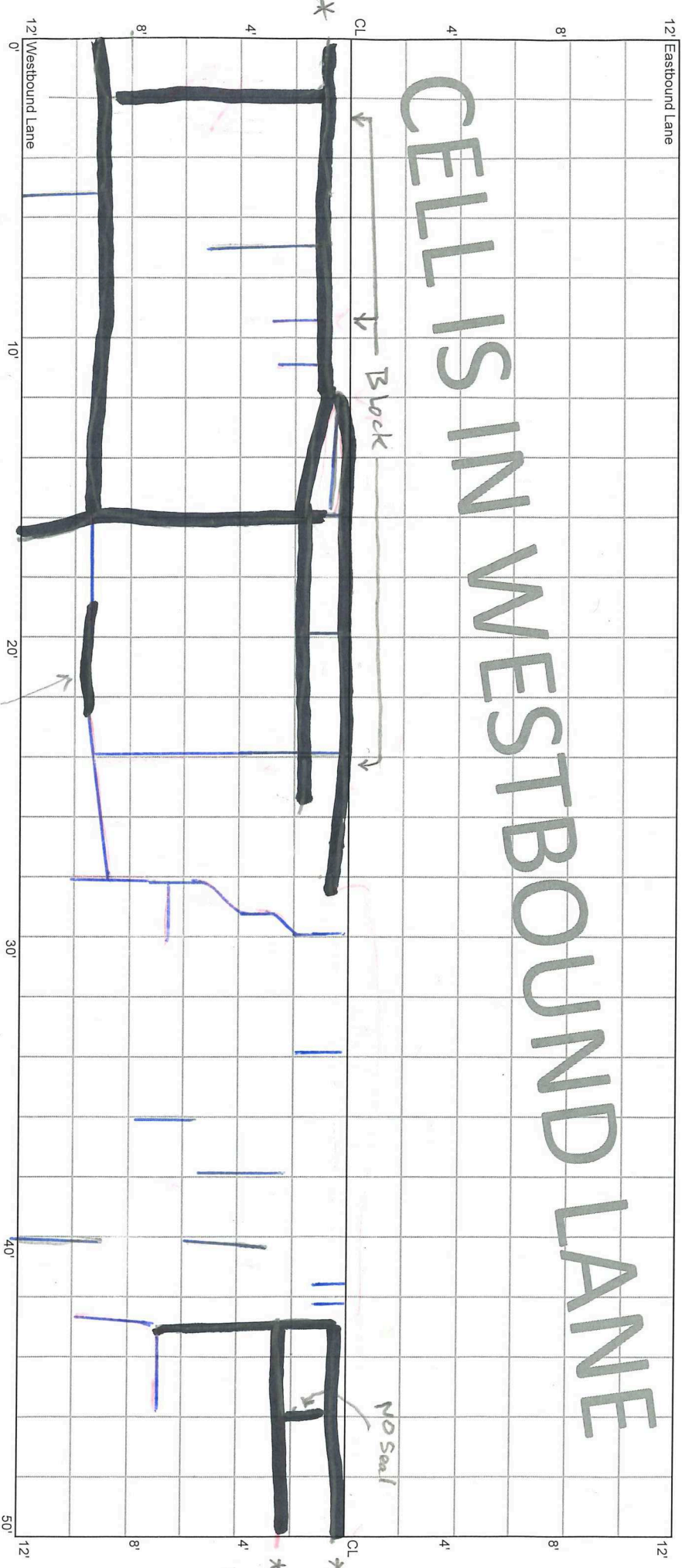

0'

10'

20'

30'

40'

50'

CL

*

4'

8'

4'

8'

12' Westbound Lane

0'

10'

20'

30'

40'

50'

CL

*

4'

8'

4'

8'

12' Westbound Lane

M

M

*

Block

No Seal

No Seal

CELL 7001W
100 - 150 ft

4+00

3+50

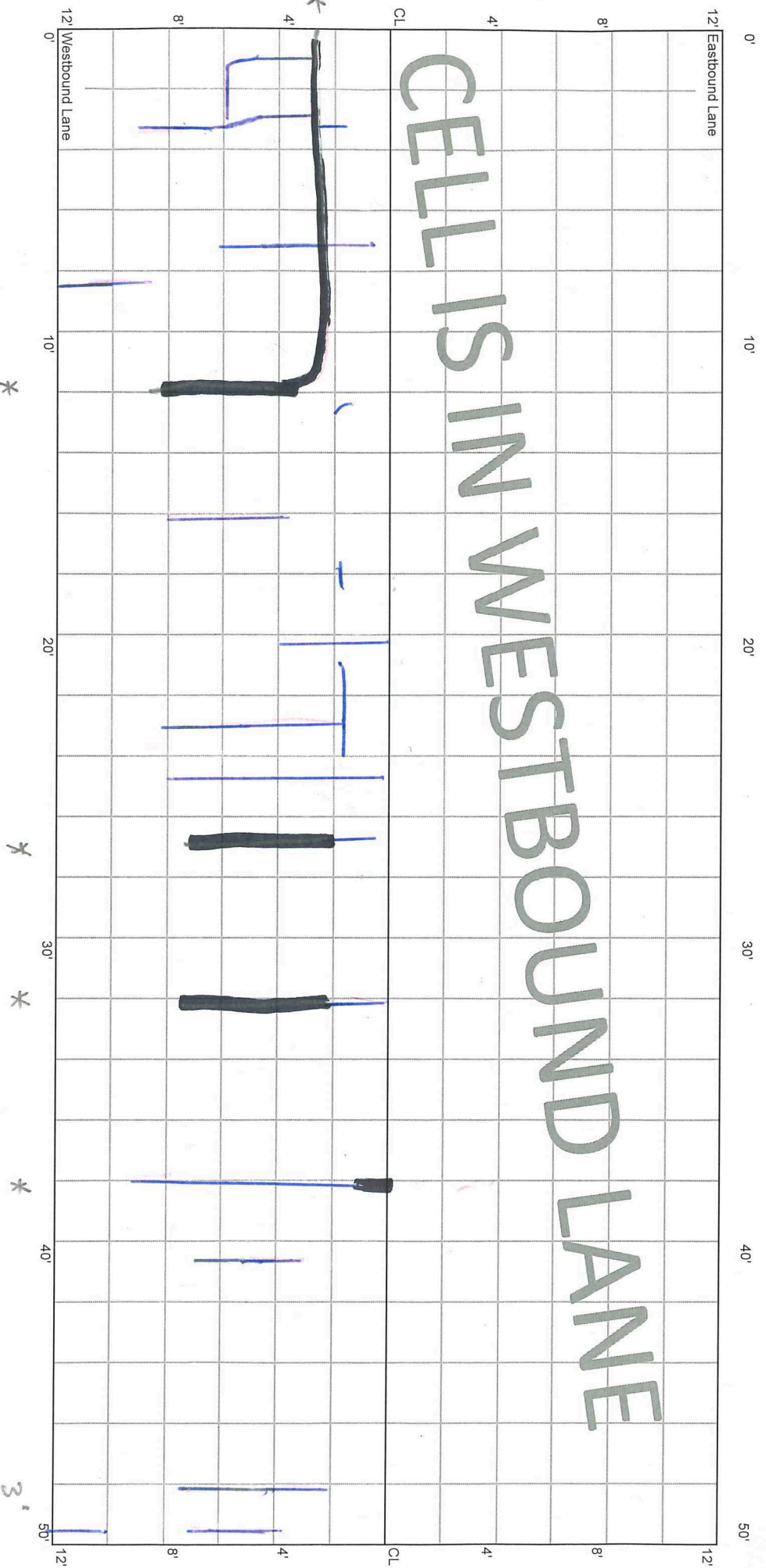

12' Eastbound Lane

12' Westbound Lane

3'

CELL 7001W
150 - 200 ft

3+50

3+00

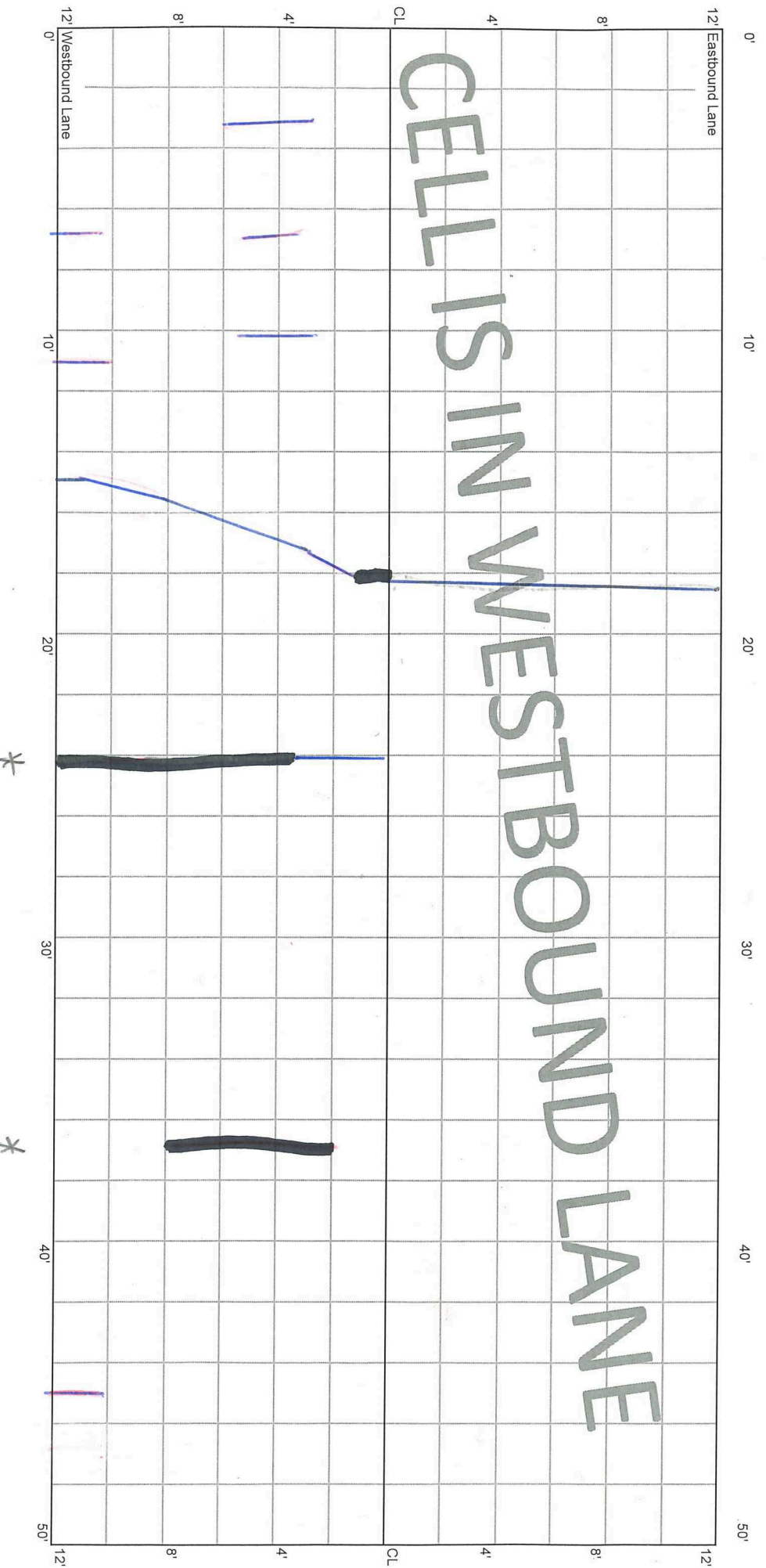

CELL IS IN WESTBOUND LANE

*

*

N.V.

CELL 7001W
200 - 250 ft

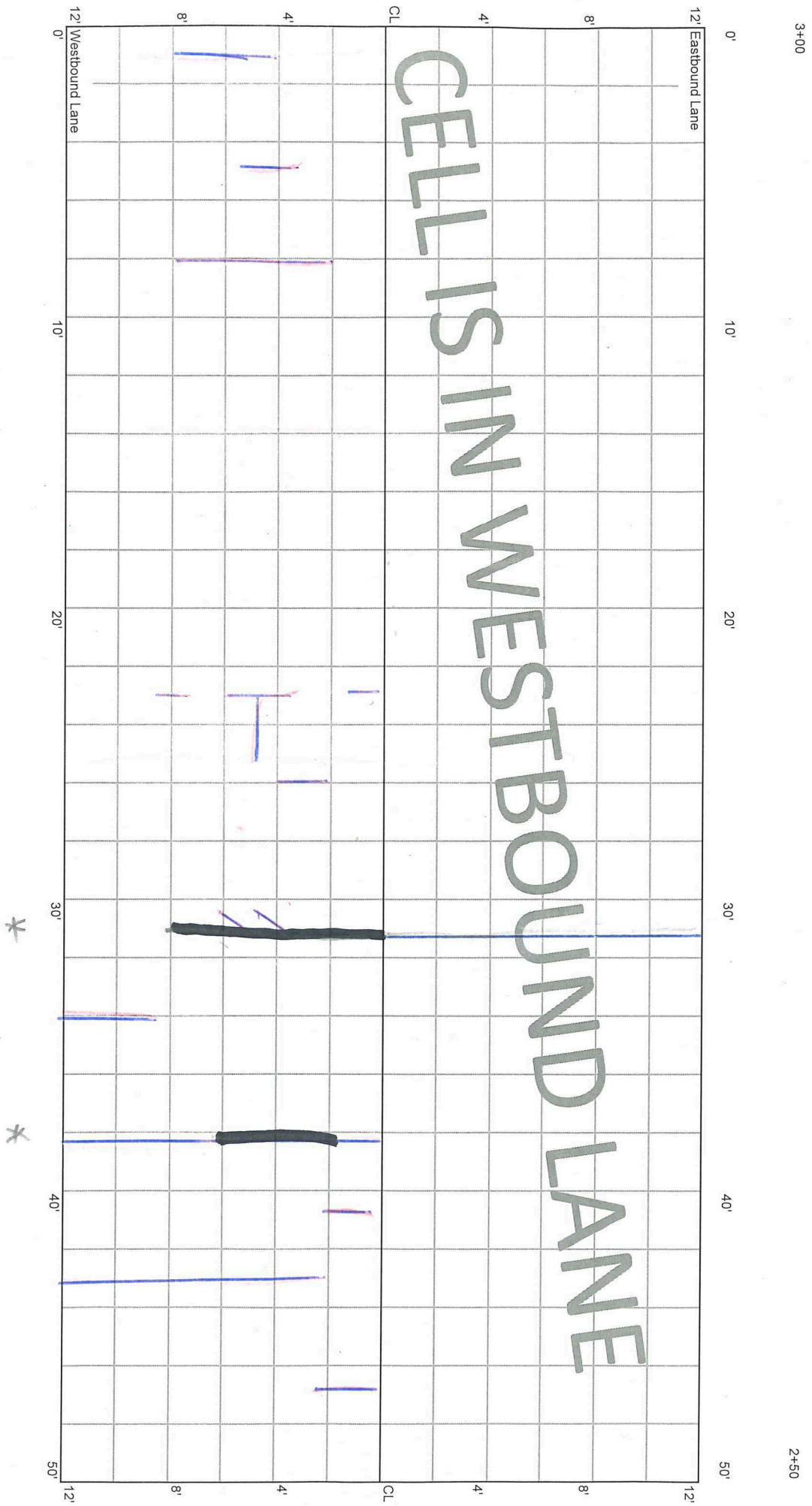

CELL 7001W
250 - 300 ft

2+50

2+00

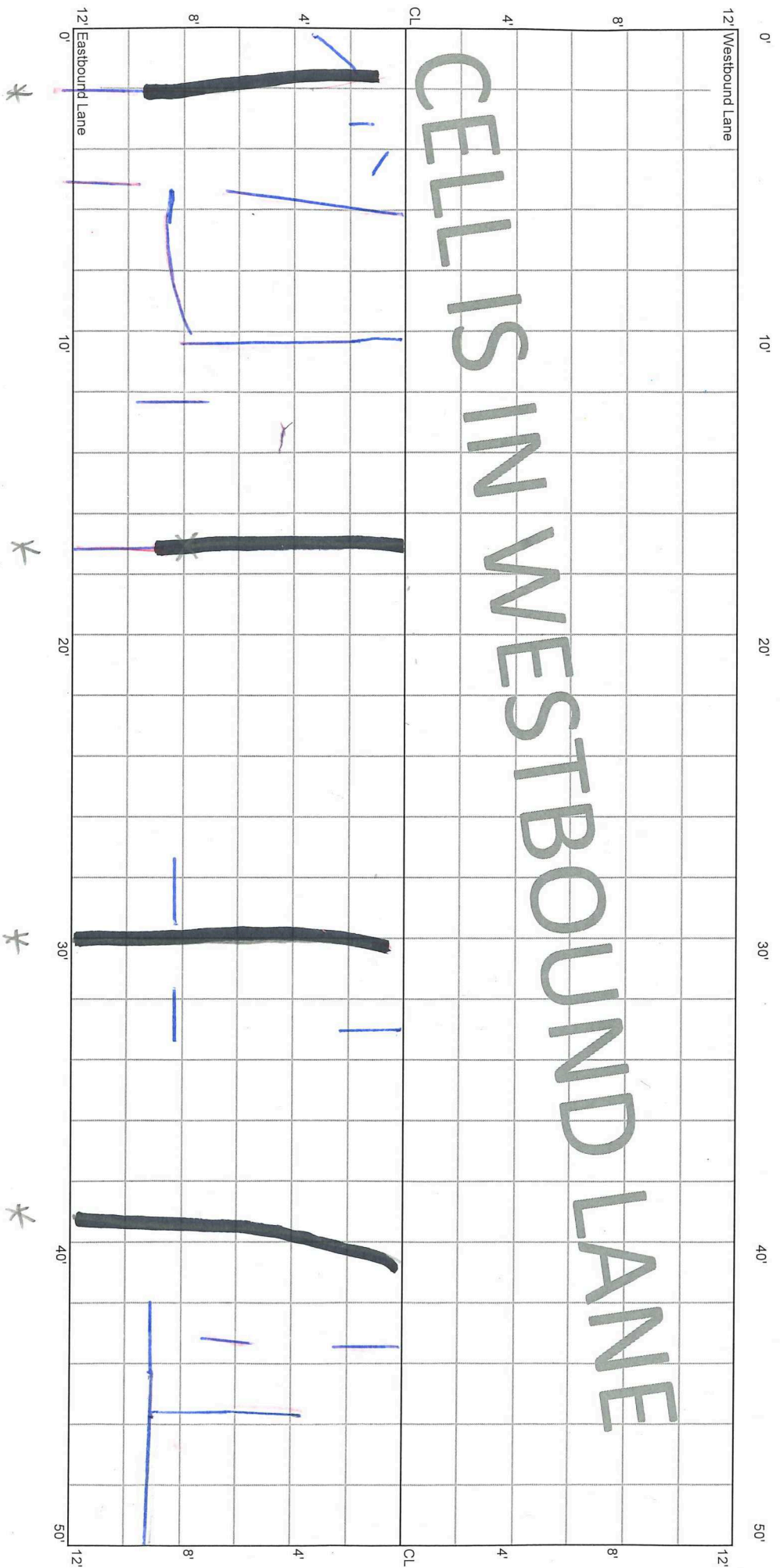

* M

X of Seal Lines

CELL 7001W
300 - 350 ft

2+00

1+50

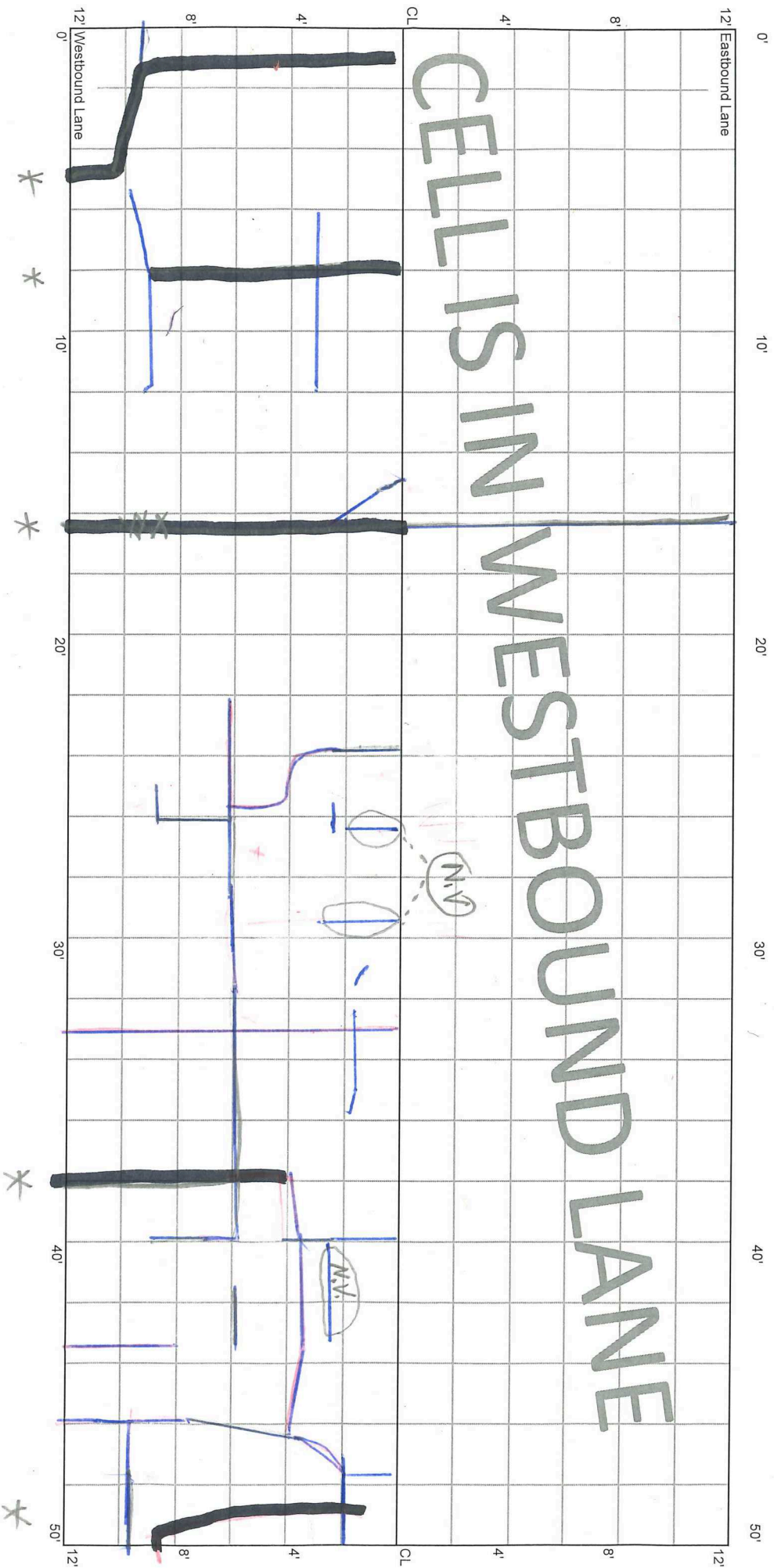

X Dobry/stones

CELL 7001W
350 - 400 ft

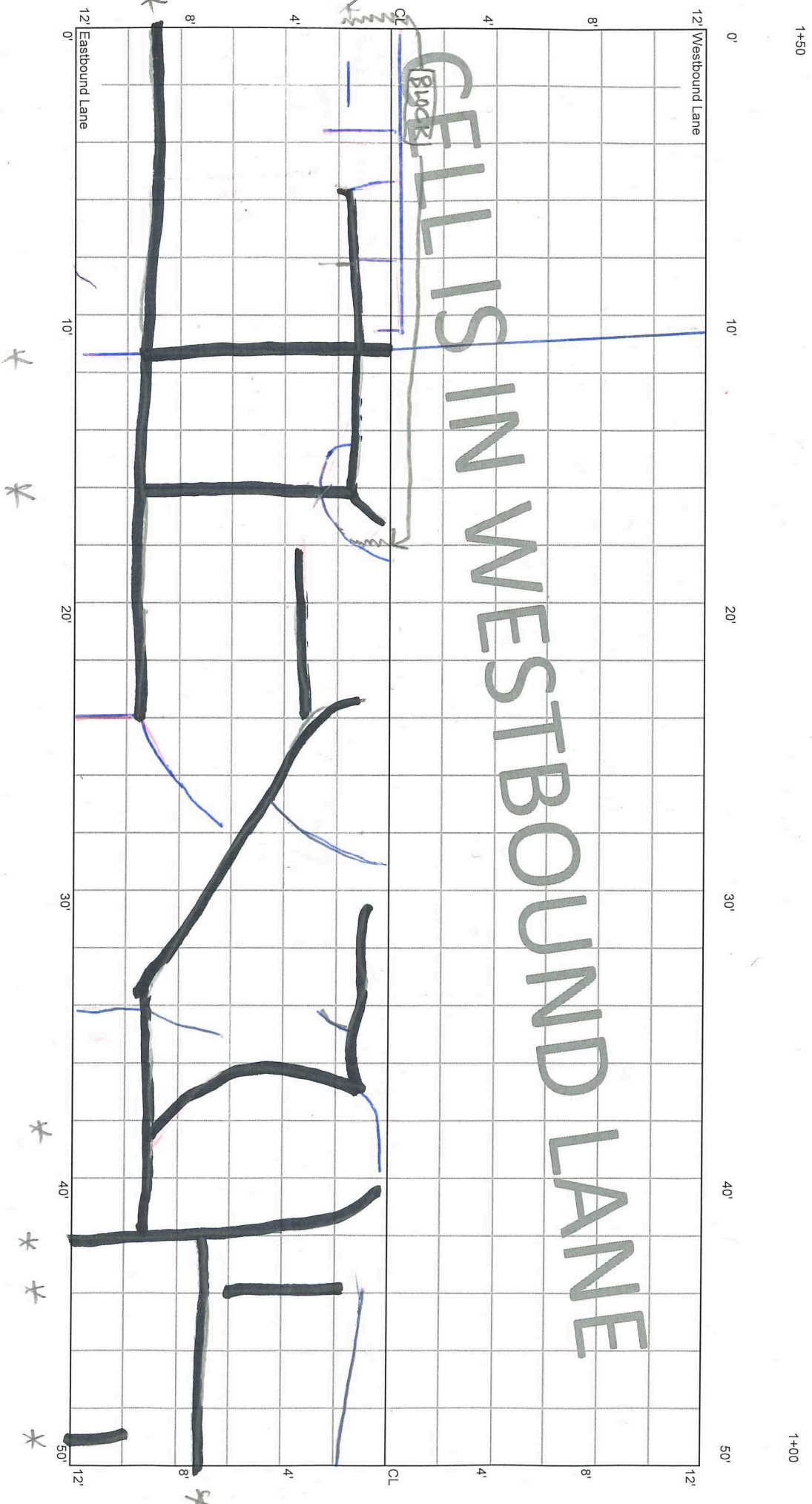

1+50

1+00

CELL 7001W
400 - 450 ft

1+00

0+50

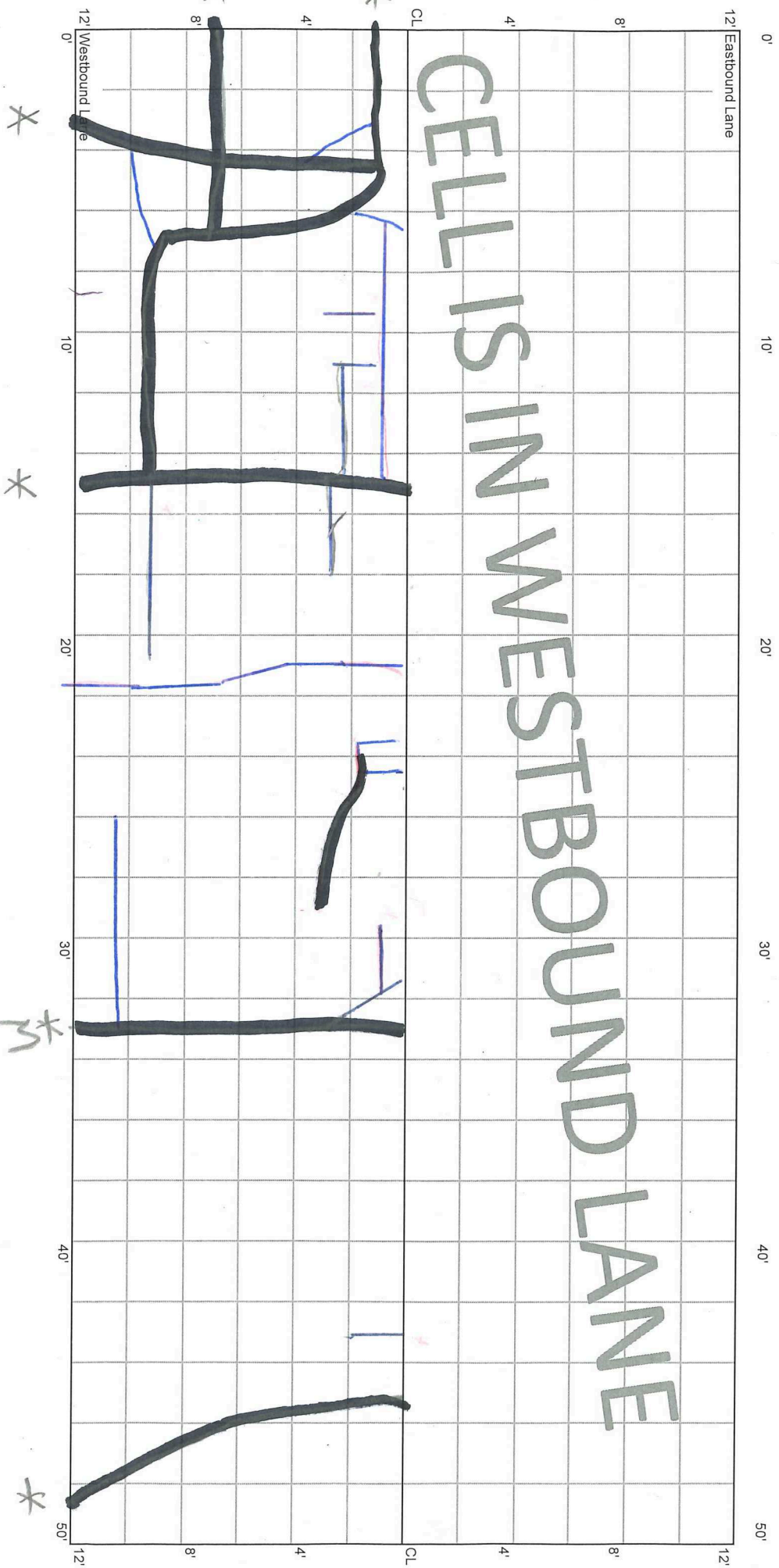

CELL 7001W
450 - 500 ft

End CL Kadler

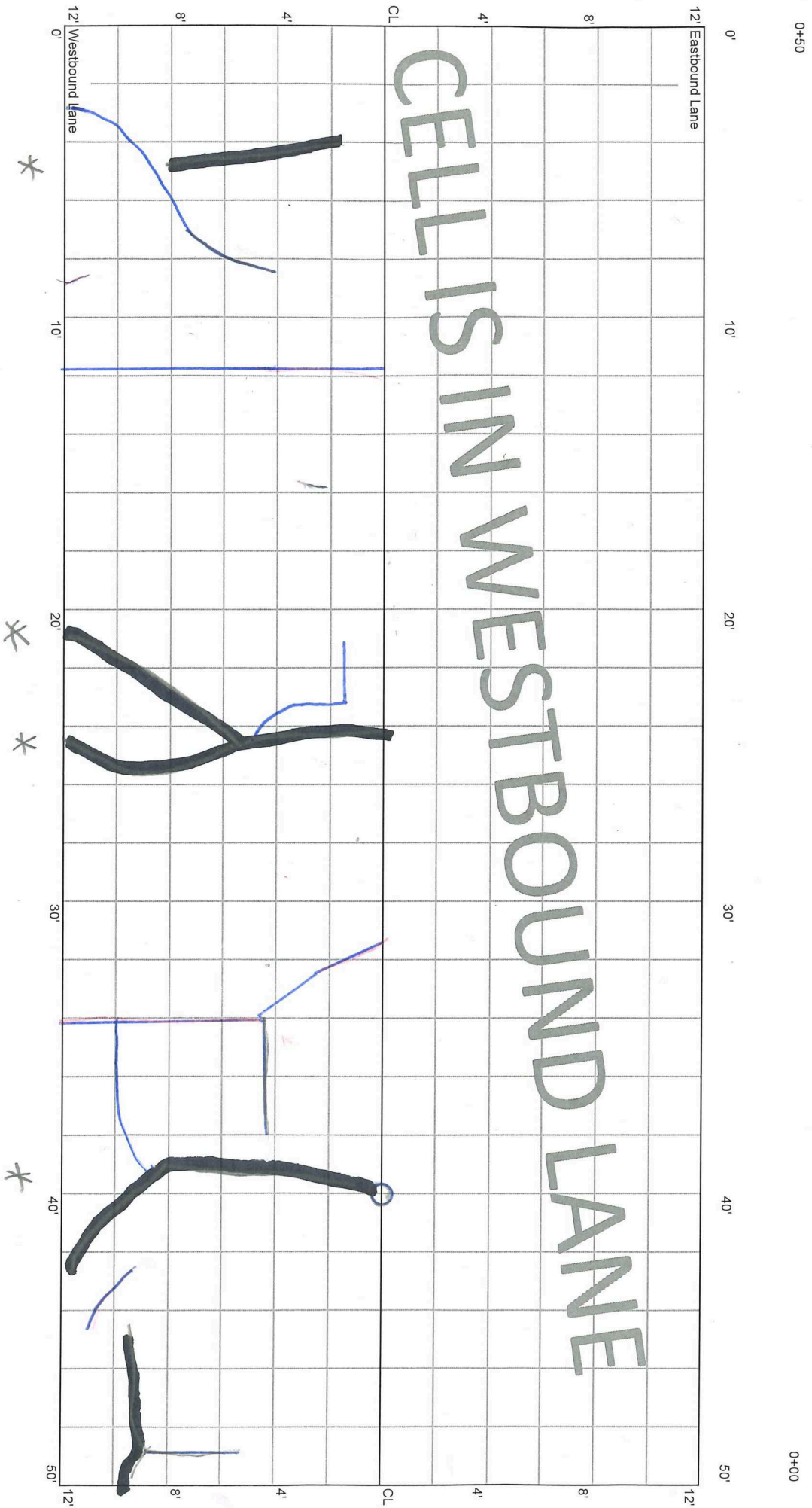

End CL Kadler

CELL 7001W
500 - 550 ft

0+00

-0+23

0'

-10'

-20'

-23'

12' Eastbound Lane

8'

4'

CL

4'

8'

12' Westbound Lane
0'

-10'

-20'

-23'

CL

8'

4'

12'

8'

4'

CELLS IN WESTBOUND LANE

END RATING: CL KADLER