

5.28.20 E.S.

10.14.20
1.4.21
File 70TH ST
8.25.21

CELL 7005E
0 - 50 ft

8.25.21 - 36 Trans. cks outside
Fog line.

22+00

22+50

Ruton outside of Fogline

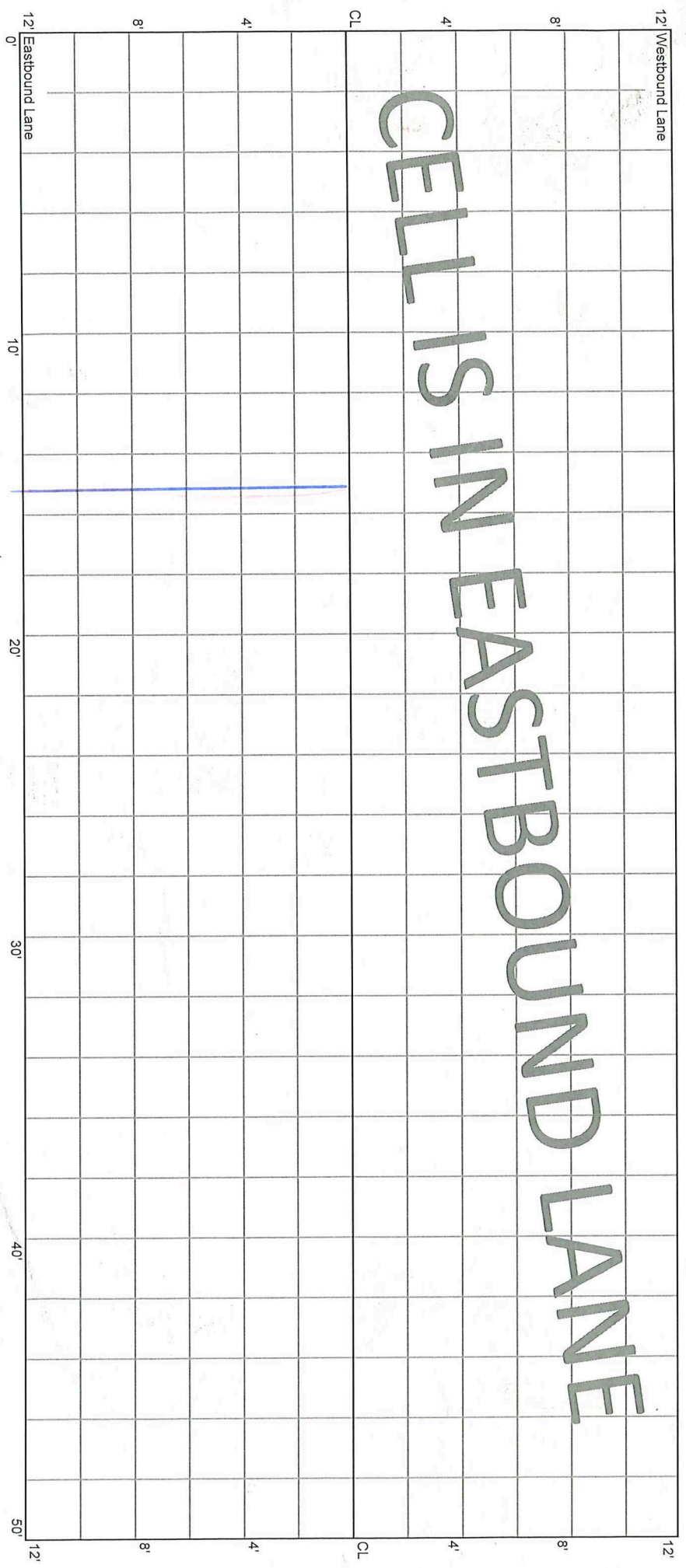

*Rout & Seal

CELL 7005E
50 - 100 ft

22+50

23+00

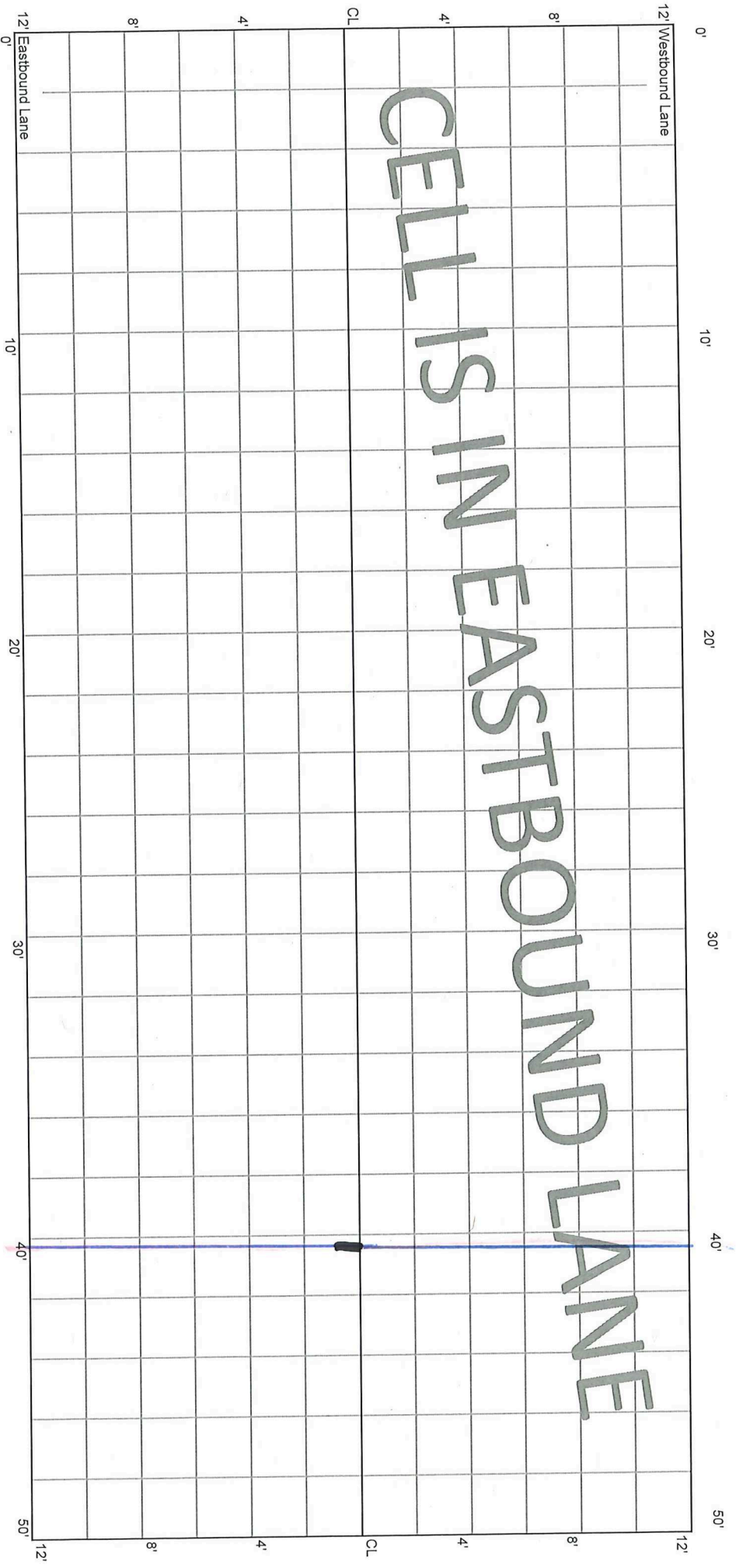

CELL 7005E
100 - 150 ft

23+00

23+50

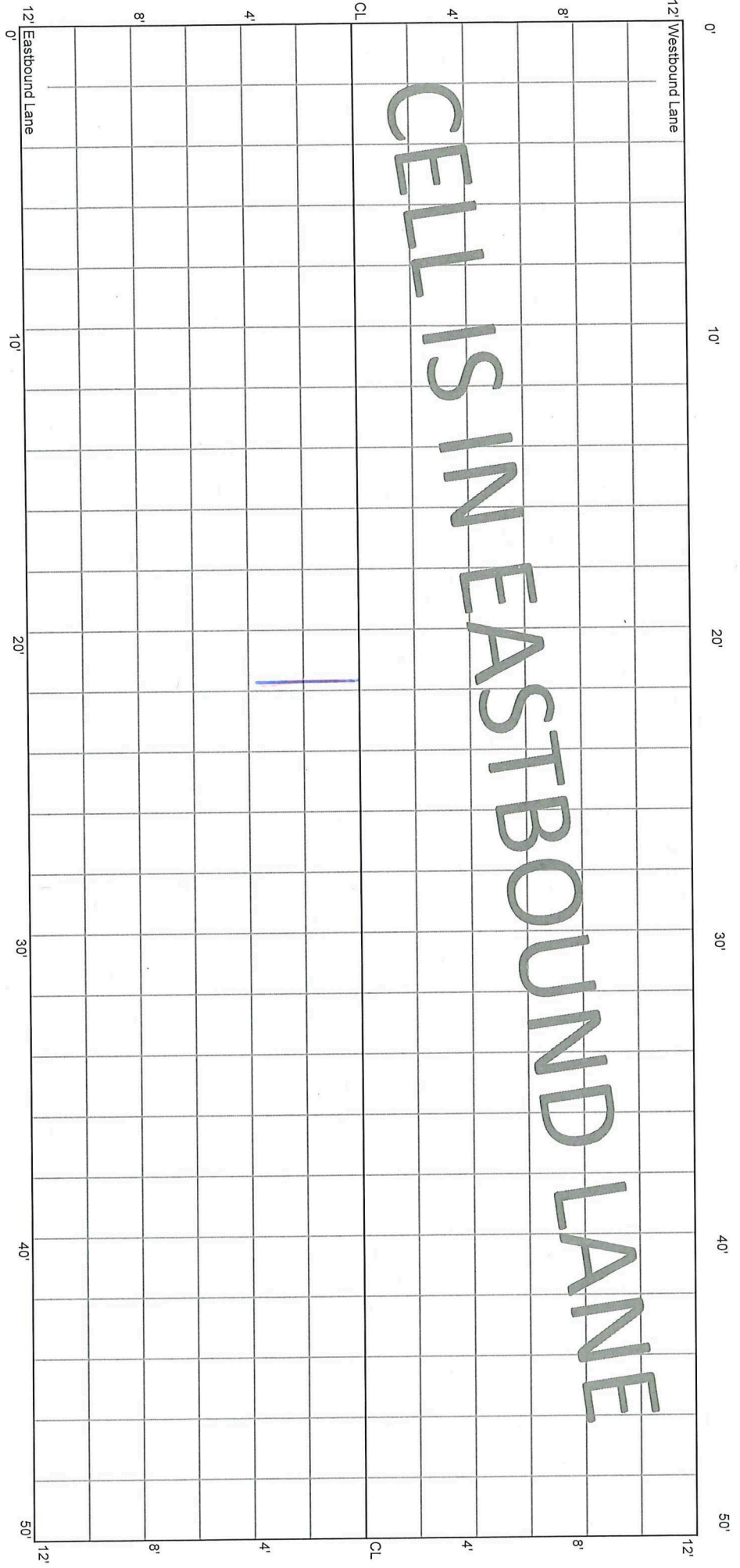

12' Westbound Lane

0' 10' 20' 30' 40' 50'

CL 4' 8' 12'

12' Eastbound Lane 0' 10' 20' 30' 40' 50' 12'

CELL 7005E
150 - 200 ft

23+50

24+00

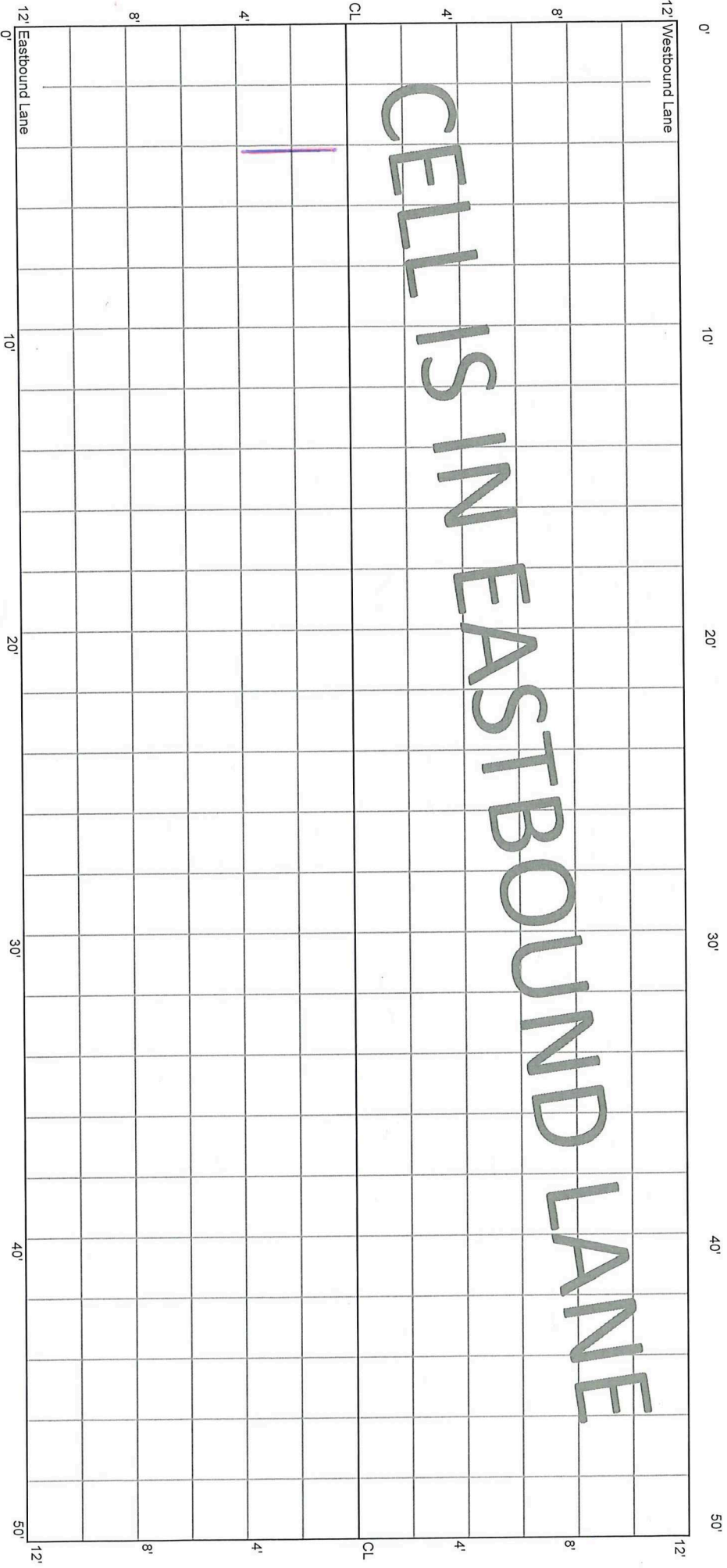

CELL 7005E
200 - 250 ft

24+00

24+50

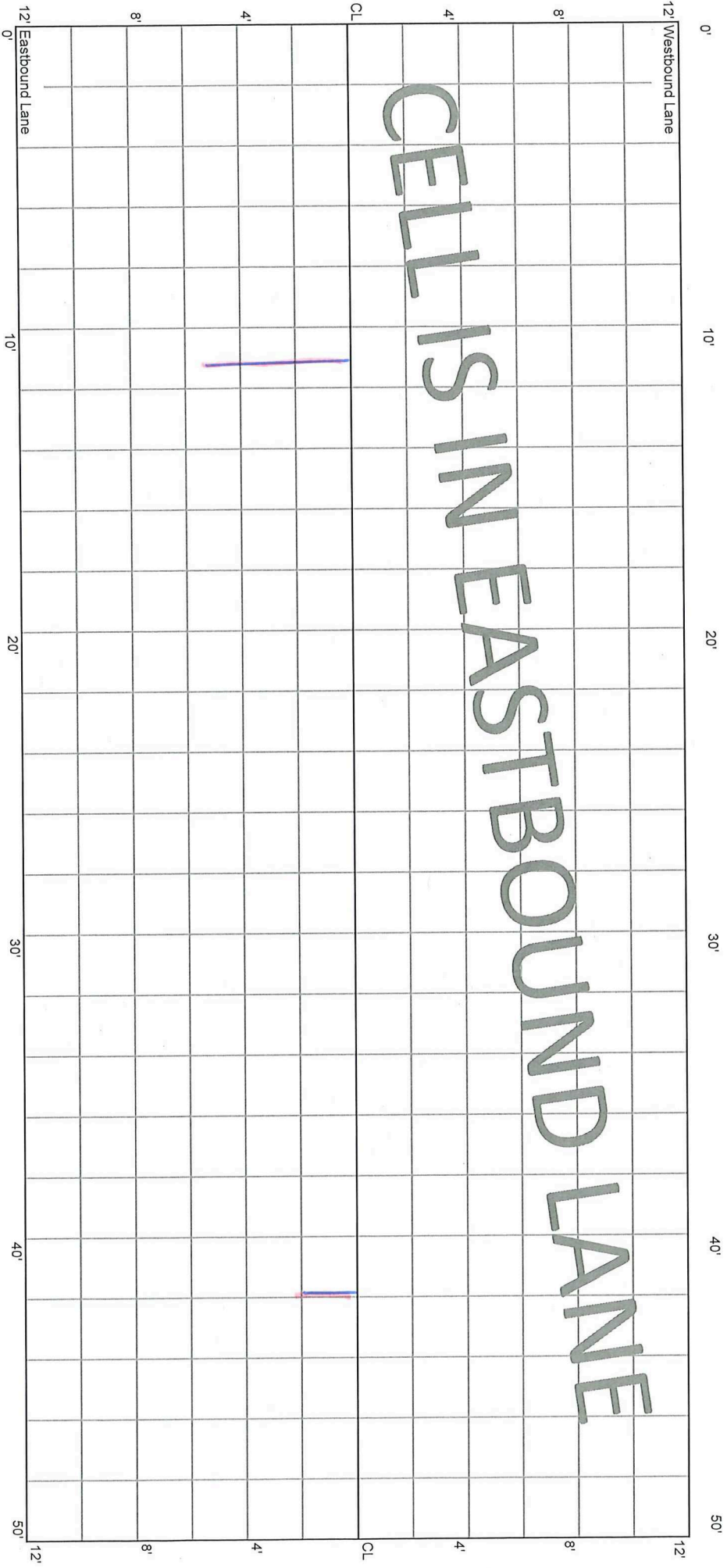

CELLS IN EASTBOUND LANE

200-221
SIL/ELQA CLK

CELL 7005E
250 - 300 ft

24+50

25+00

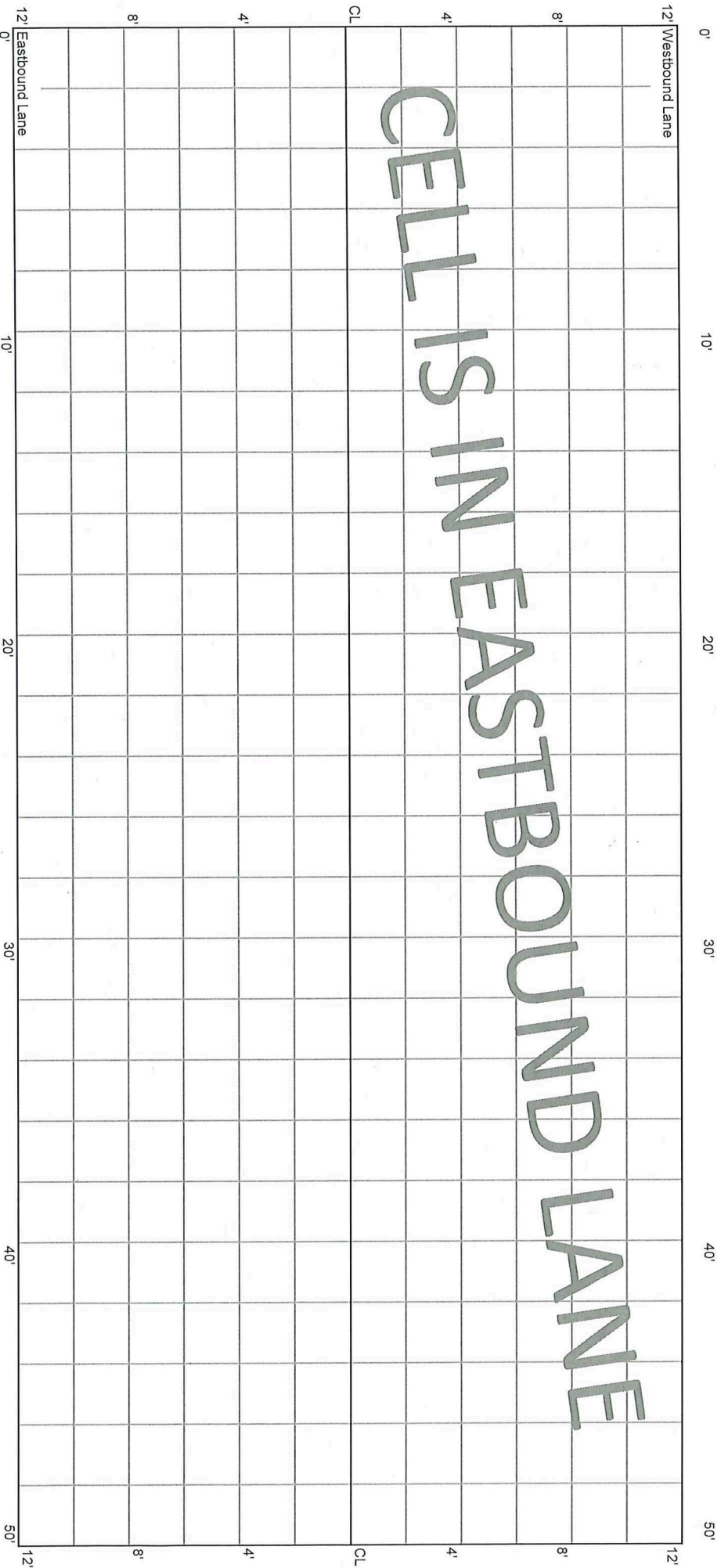

CELL 7005E
300 - 350 ft

25+00

25+50

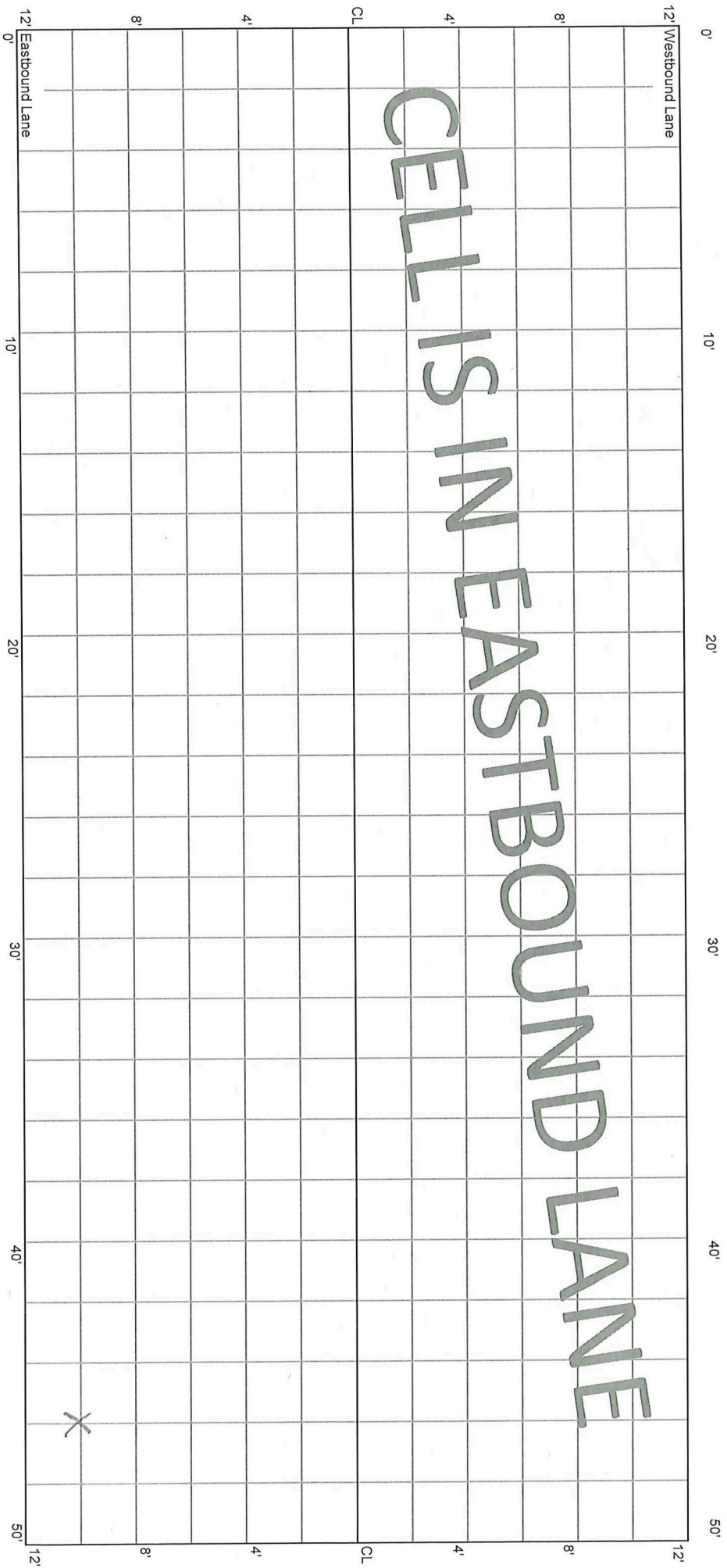

X 1/2" Defect
future pothole ?

CELL 7005E
350 - 400 ft

25+50

26+00

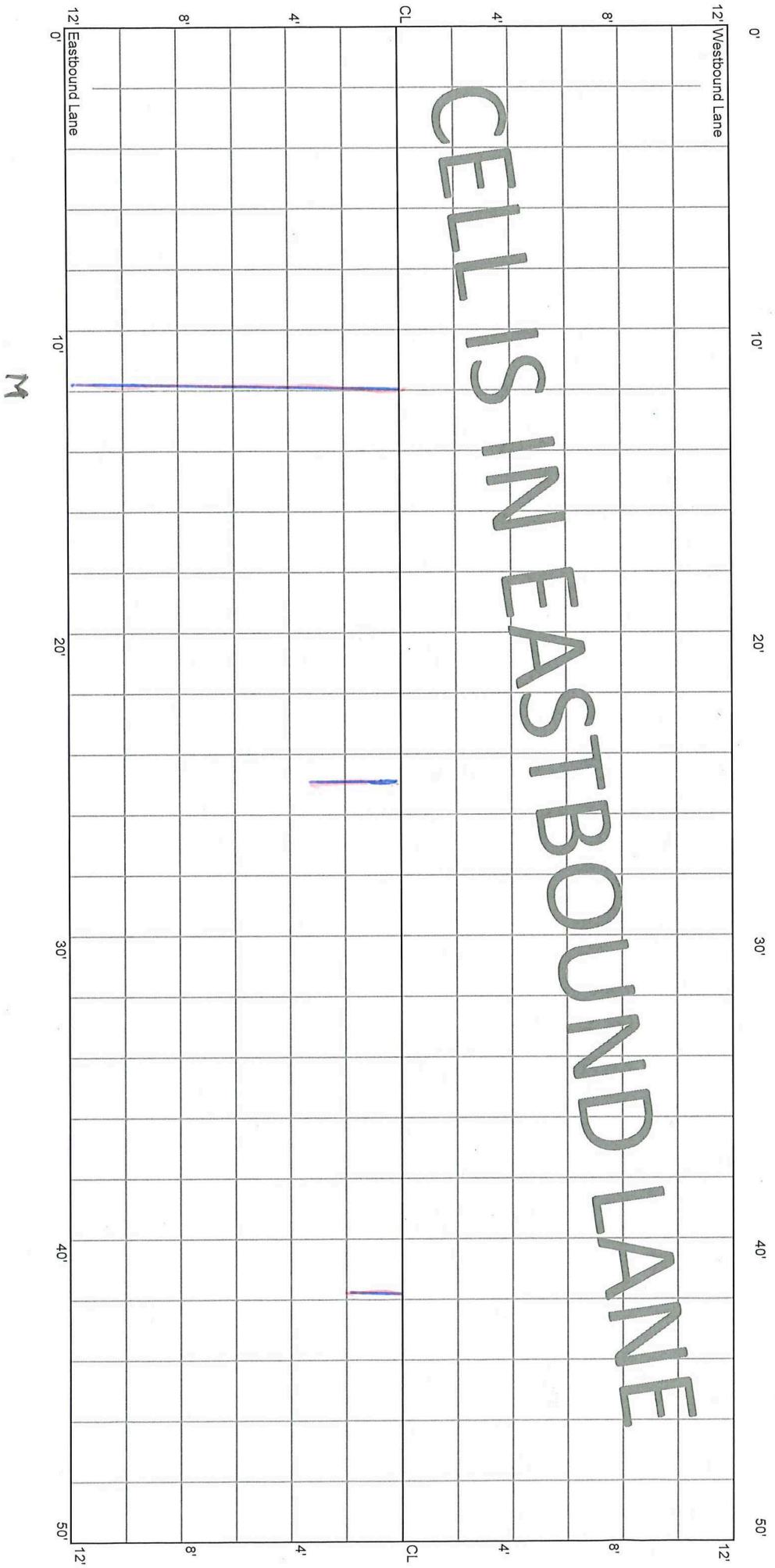

M

CELL 7005E
400 - 450 ft

26+00

26+50

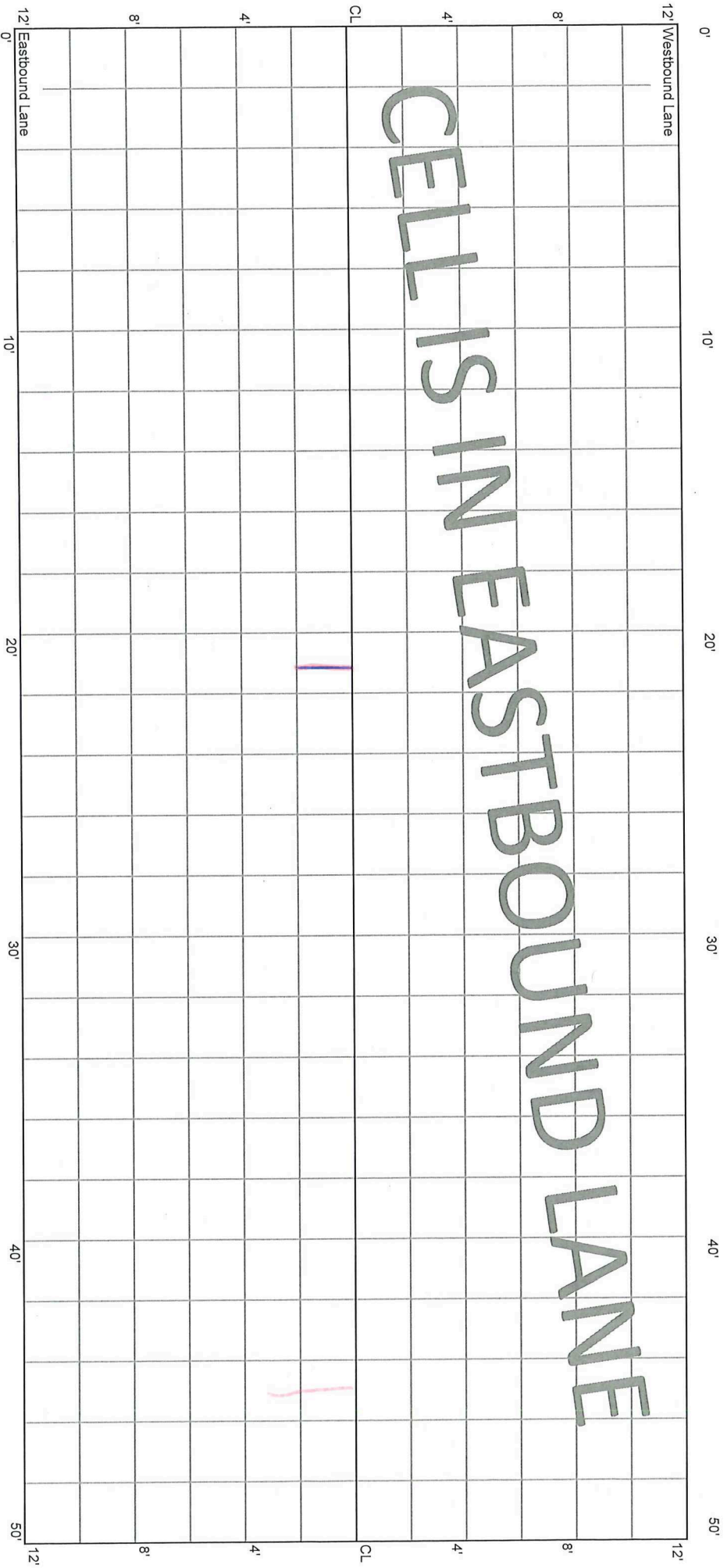

CELL 7005E
450 - 500 ft

26+50 26+58
CL KITTRIDGE

27+00

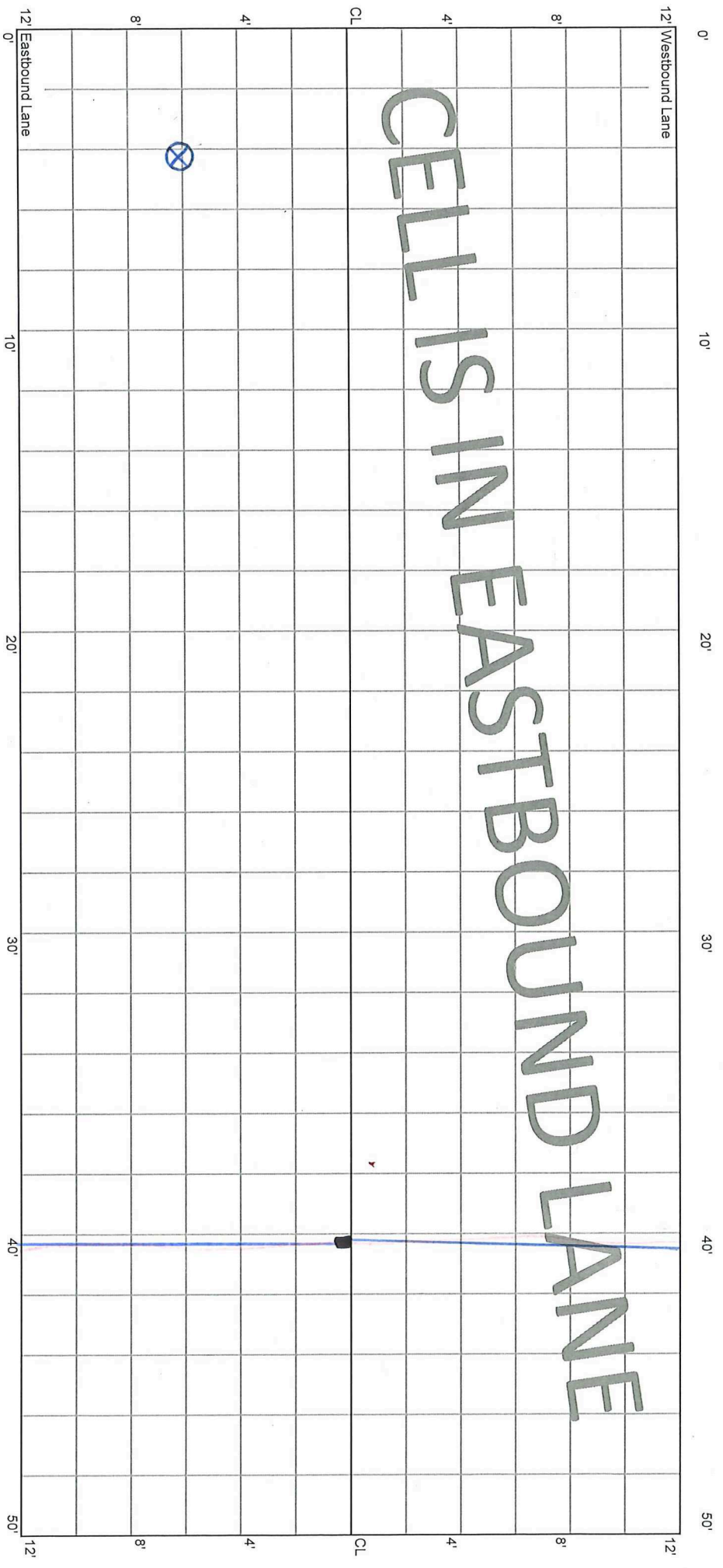

CELL IS IN EASTBOUND LANE

Wright Co
Survey Marker

CELL 7005E
500 - 550 ft

27+00

16+25

27+50

12' Westbound Lane

0' 10' 20' 25' 30' 40' 50'

CELL IS IN EASTBOUND LANE

END RATING: BEGIN TRANSITION TO
NEXT CELL

(0' oct 20)
cores

12' 0' 10' 20' 25' 30' 40' 50'

