

5.28.20 E.J.

10.14.20 | 1.3.22
1.4.21 | 8.30.22

File 70TH ST
8.25.21

CELL 7003E
0 - 50 ft

8/21 > 8ft trans crks outside
Fog line.

11+00

11+50

CELLS IN EASTBOUND LANE

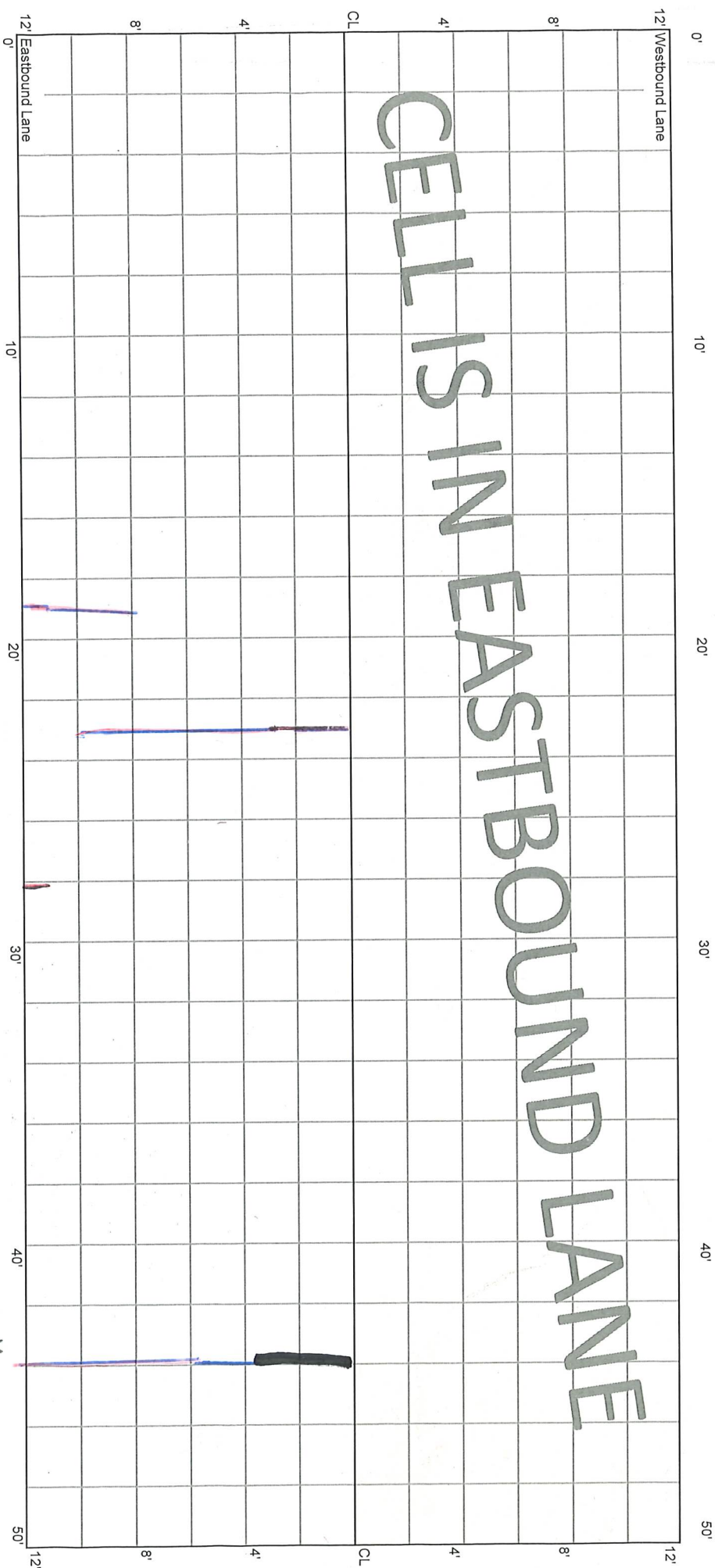

* Route Seal

CELL 7003E
50 - 100 ft

11+50

12+00

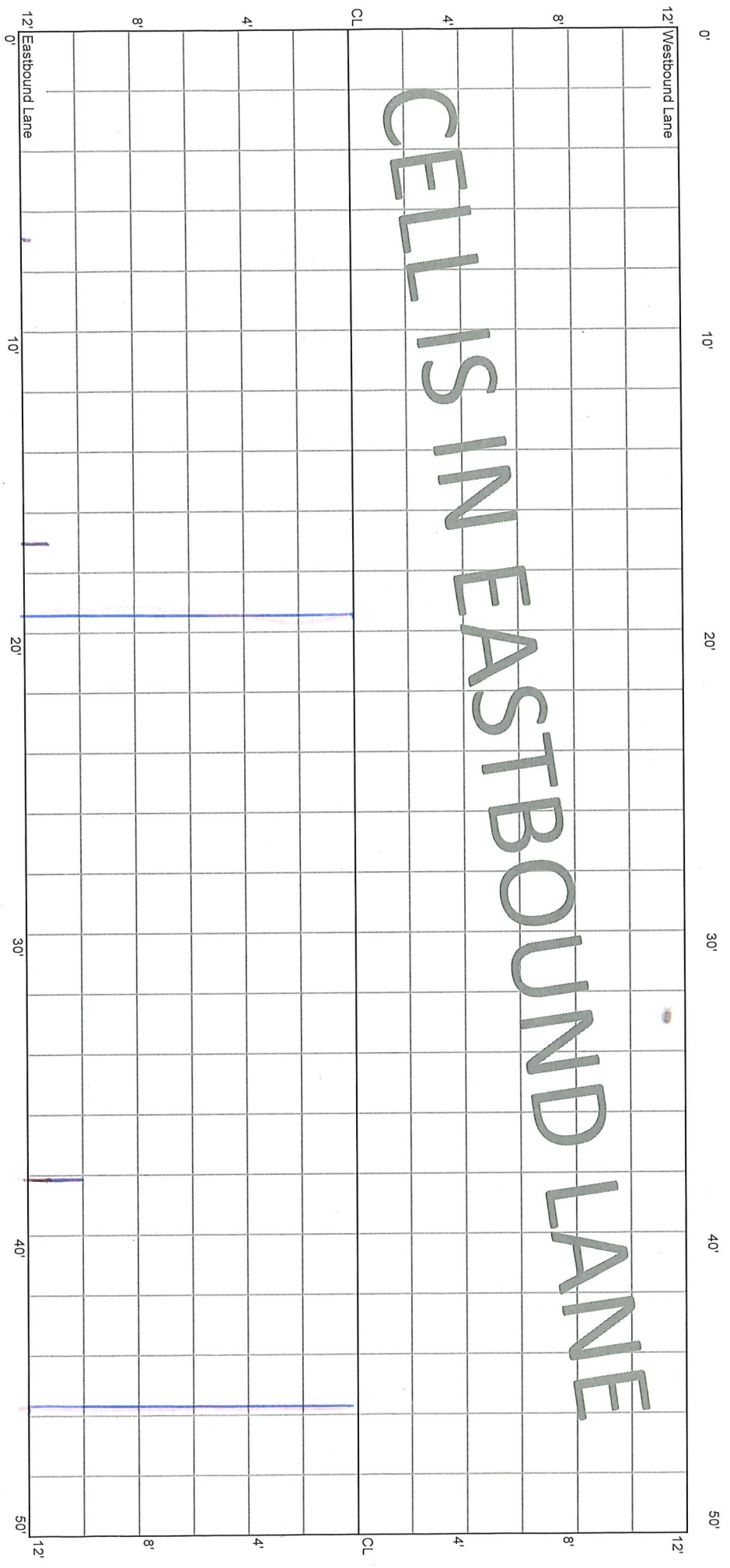

CELL 7003E
100 - 150 ft

12+00

12+50

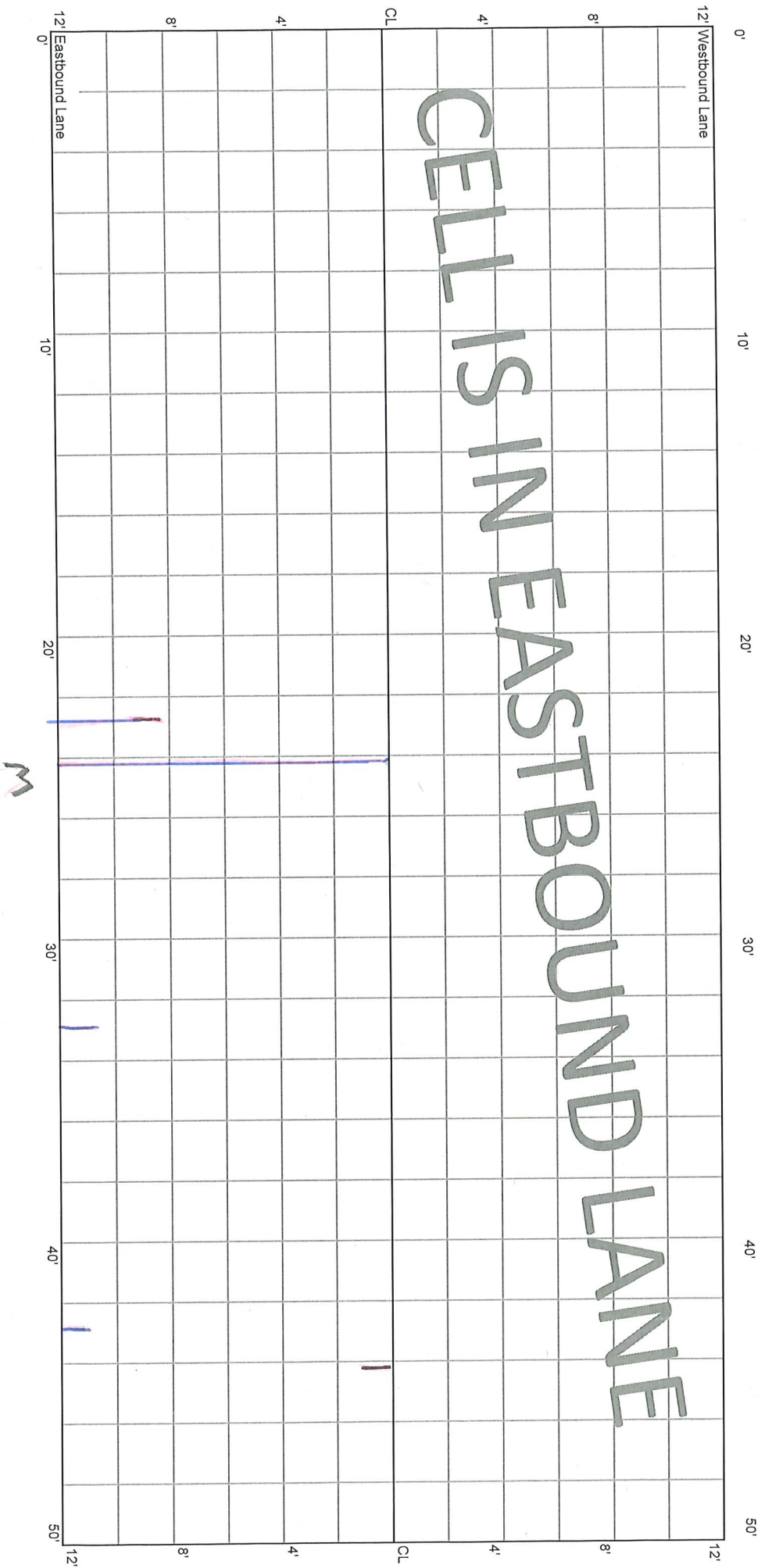

CELL 7003E
150 - 200 ft

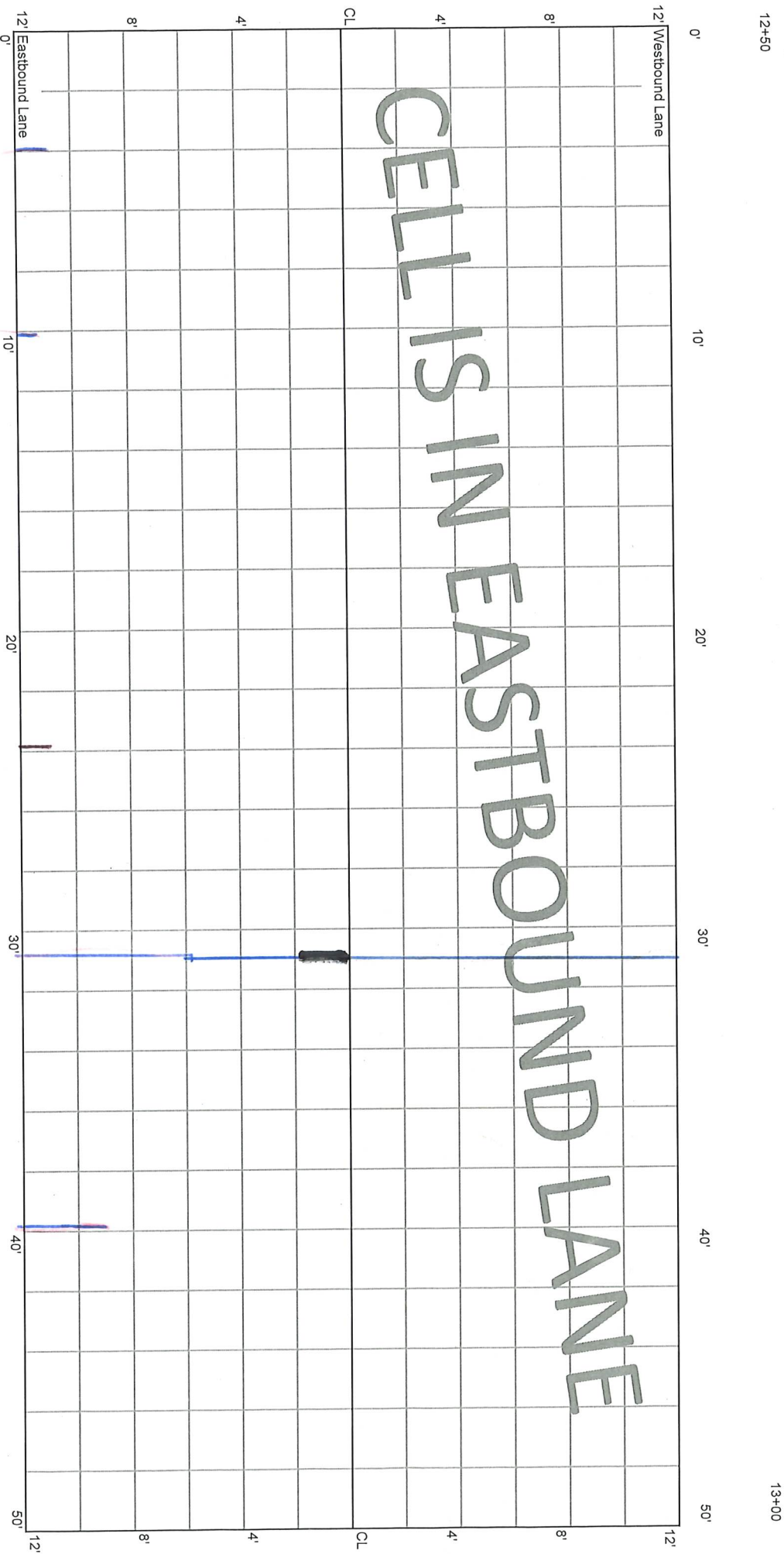

CELLS IN EASTBOUND LANE

12+50

13+00

CELL 7003E
200 - 250 ft

13+00

13+50

12' Westbound Lane

12'

CELL IS IN EASTBOUND LANE

12' Eastbound Lane

12'

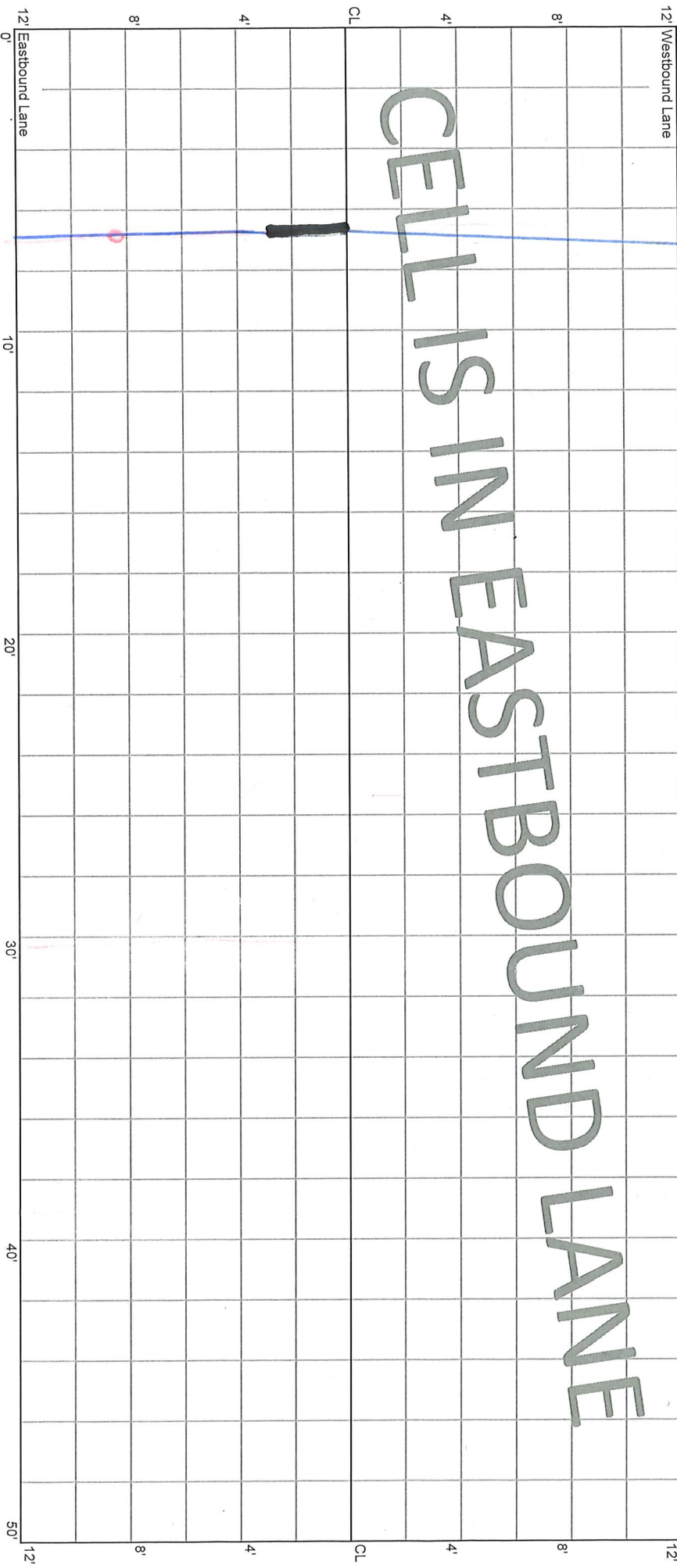

M

CELL 7003E
250 - 300 ft

13+50

14+00

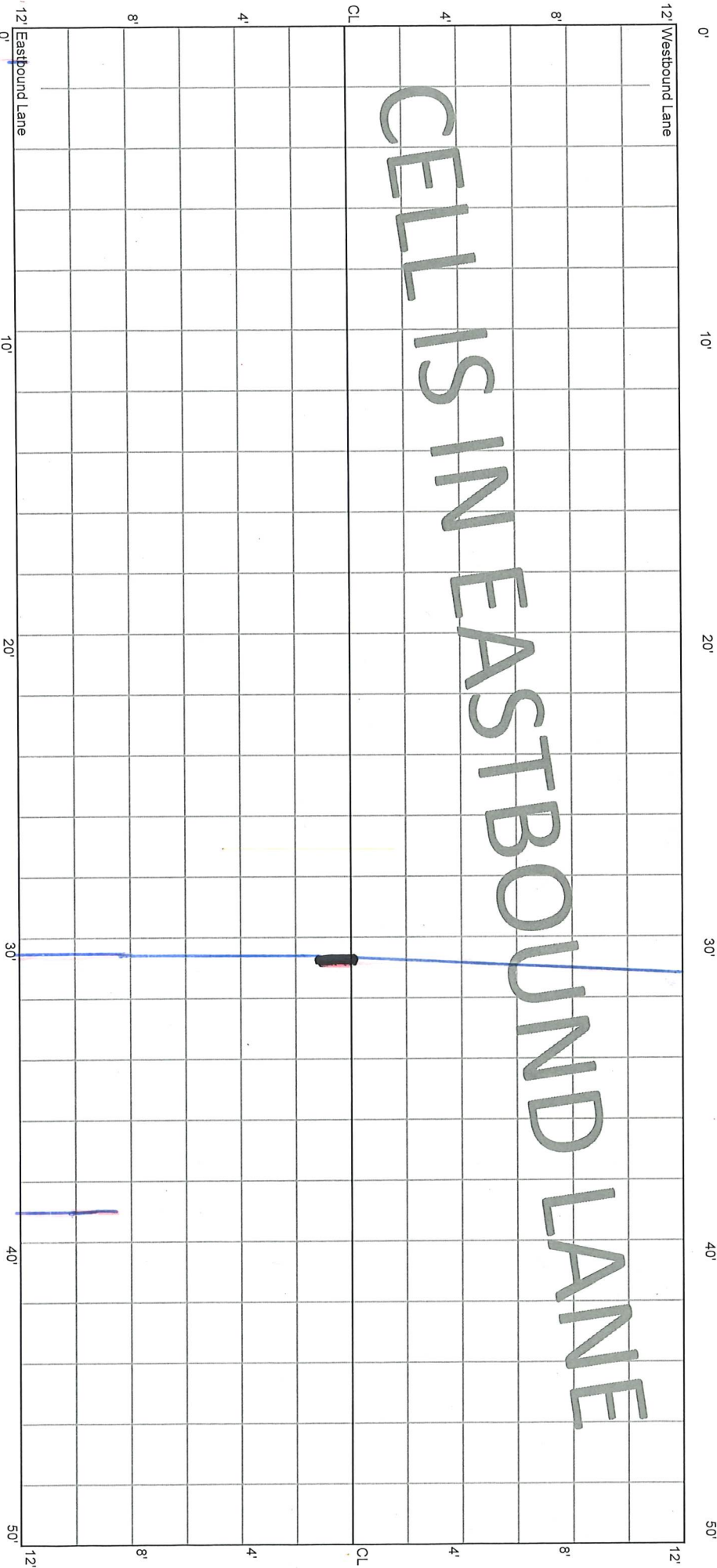

CELL IS IN EASTBOUND LANE

*
M

CELL 7003E
300 - 350 ft

14+00

14+50

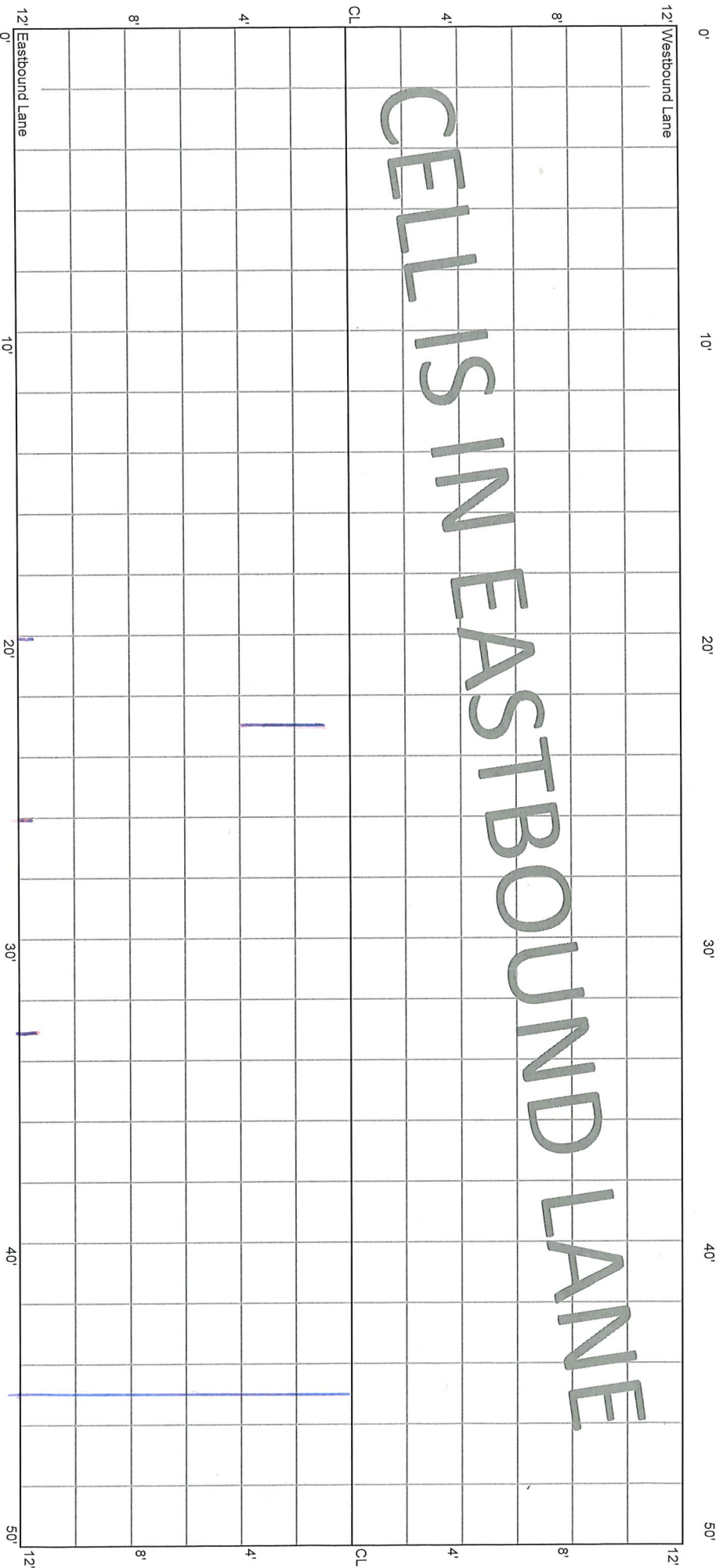

M

CELL 7003E
350 - 400 ft.

14+50

15+00

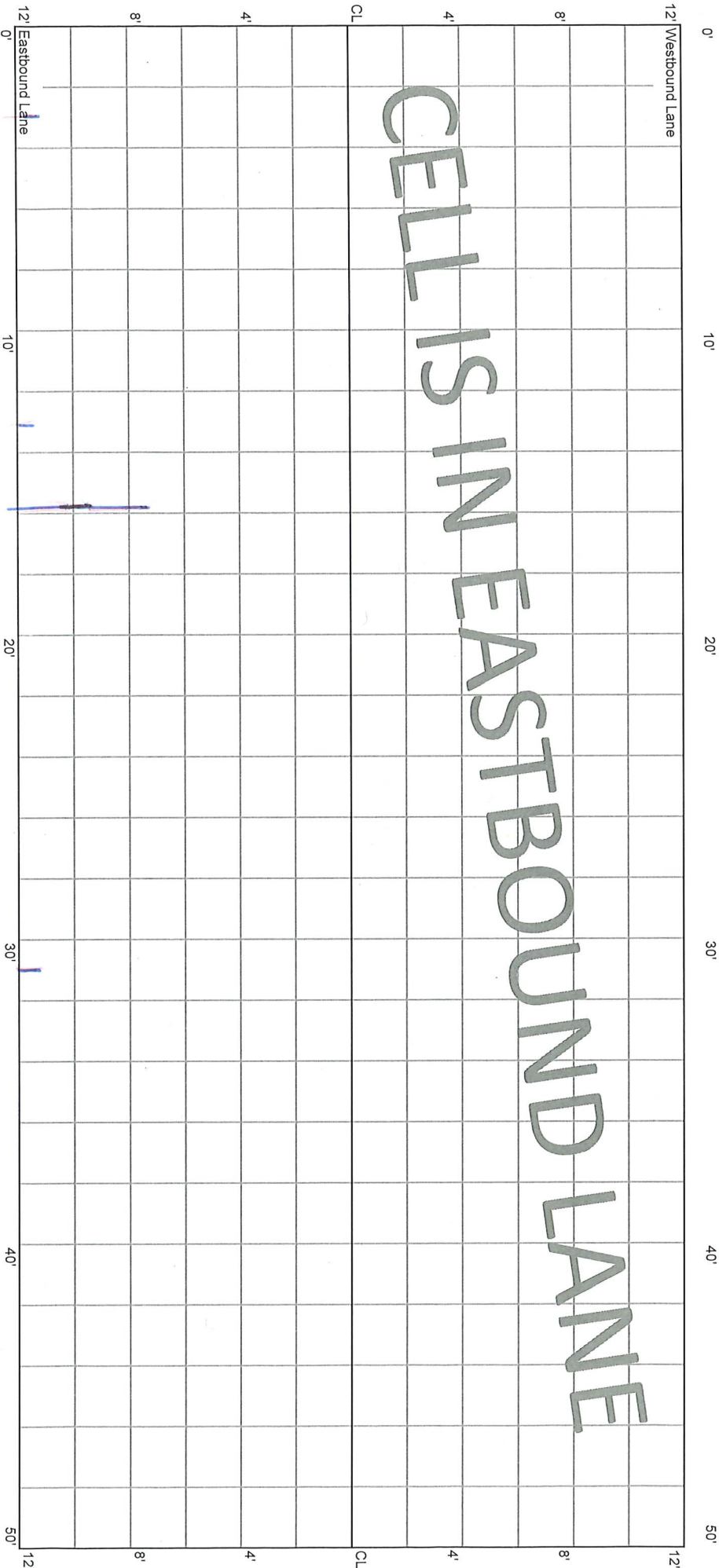

CELL 7003E
400 - 450 ft

15+00

15+50

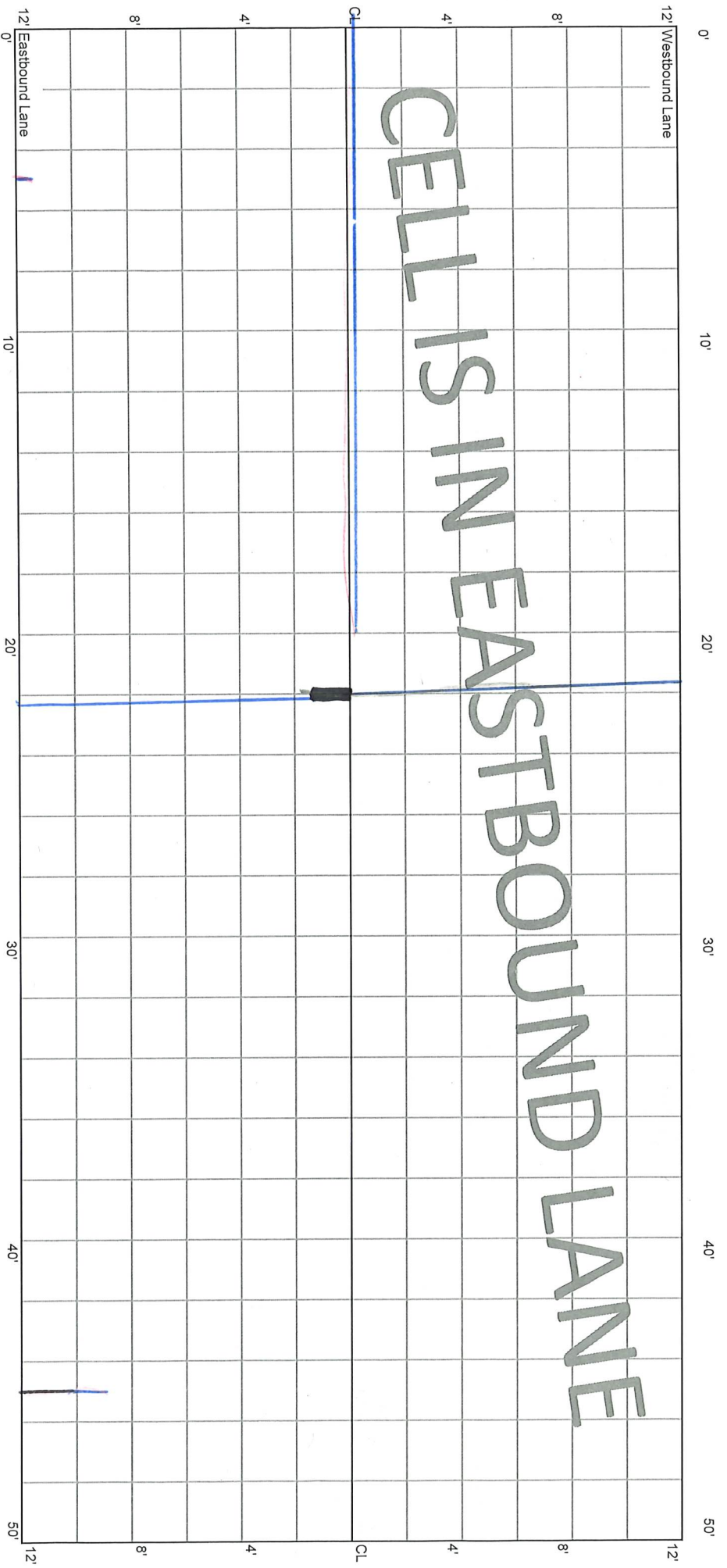

CELL IS IN EASTBOUND LANE

*M

CELL 7003E
450 - 500 ft

15+50

16+00

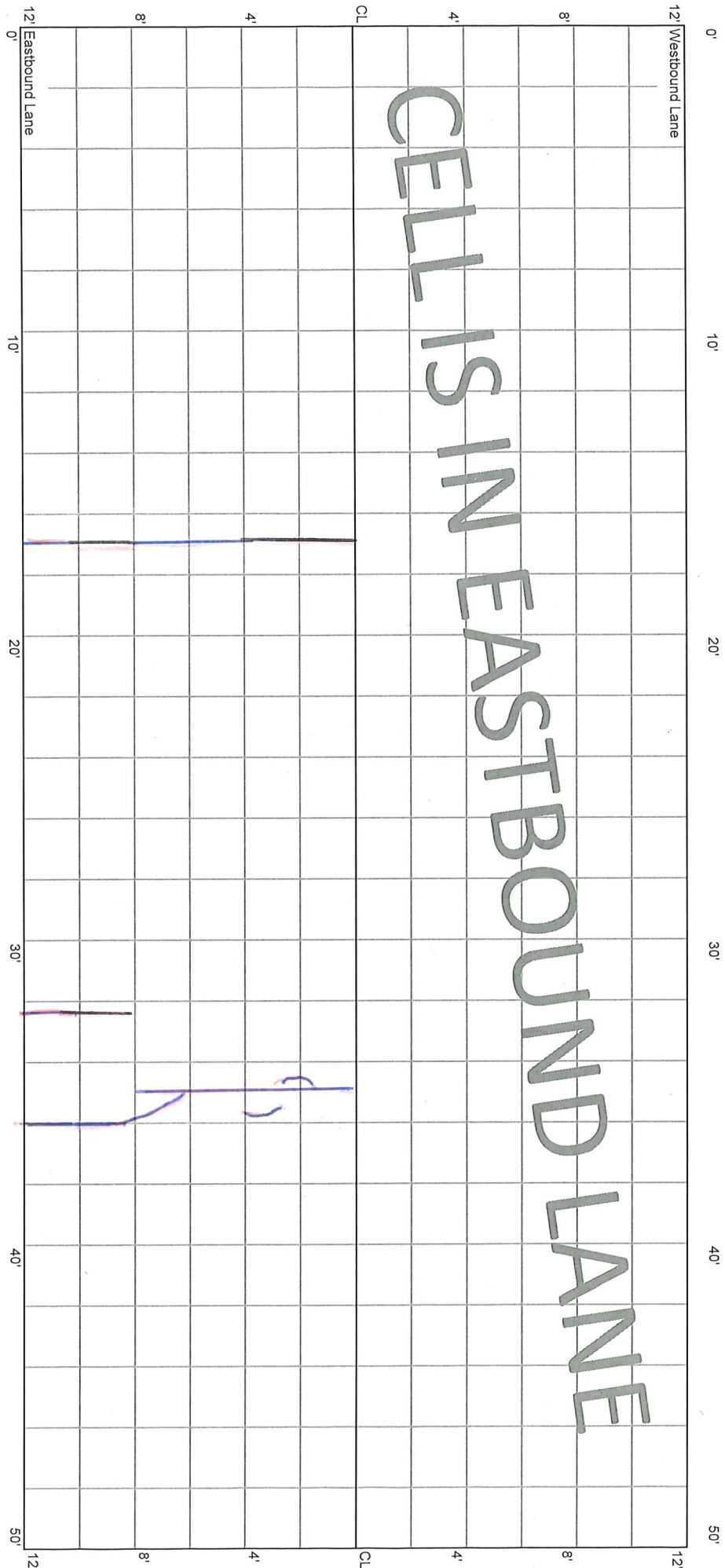

CELL IS IN EASTBOUND LANE

CELL 7003E
500 - 550 ft

16+00

16+25

16+50

12' Westbound Lane

