

5:28:30 E.J.

10.14.25

1.4.21

8.25.21

File 70TH ST

Begin CL Kadler

CELL 7001E  
0 - 50 ft

0+00

0+50

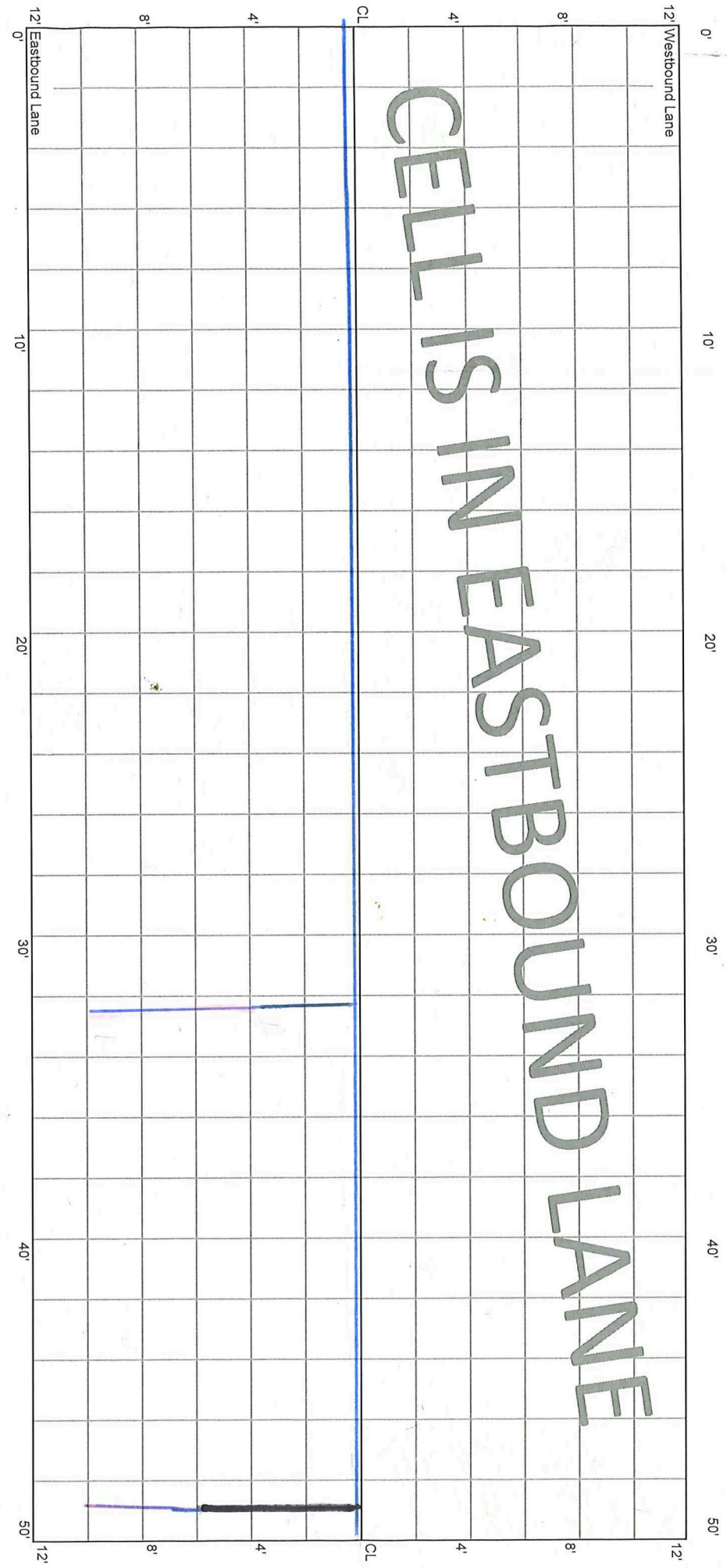

\* Rout 1 Seal

CELL 7001E  
50 - 100 ft

0+50

1+00

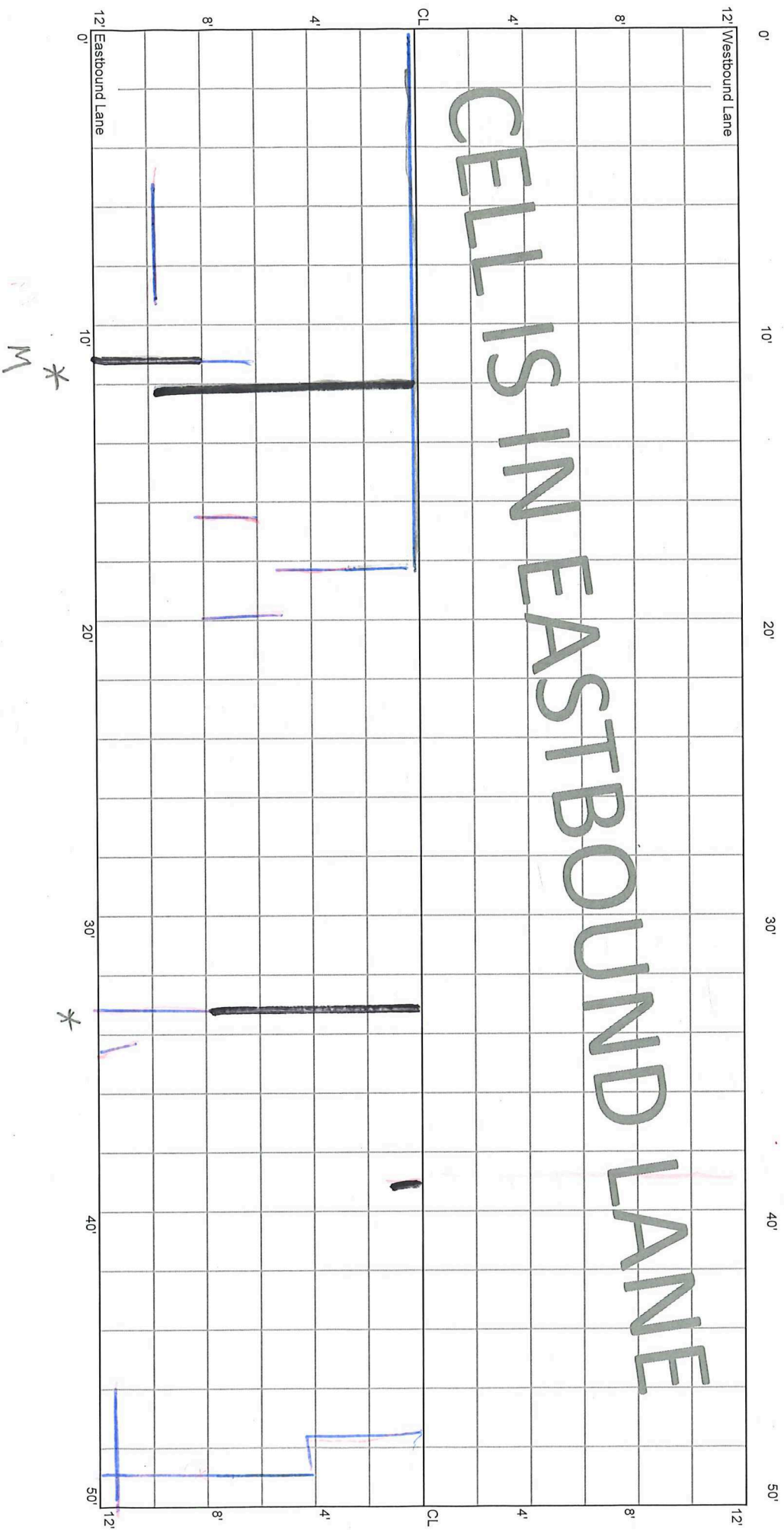

CELL 7001E  
100 - 150 ft

1+00

1+50

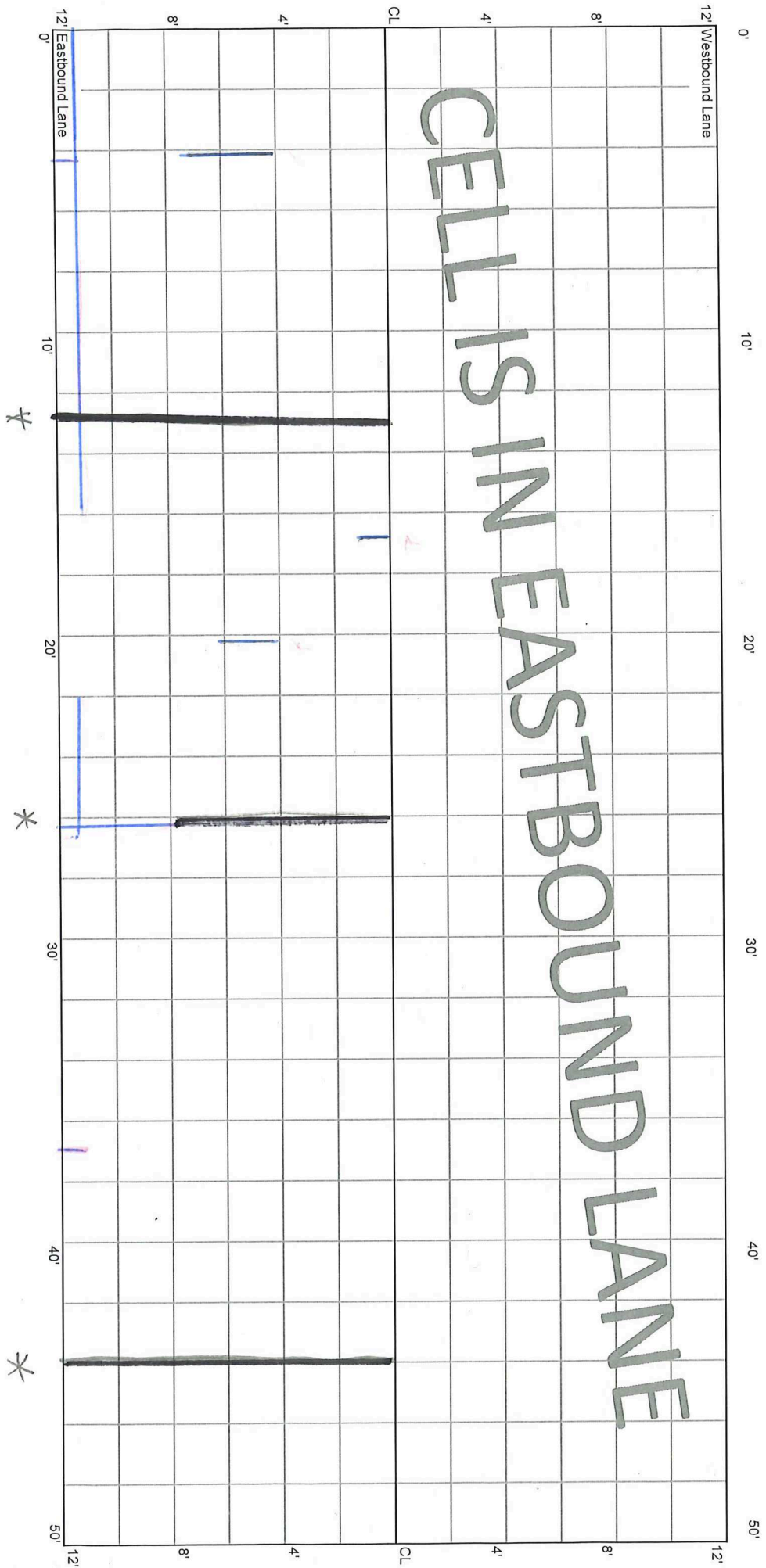

CELL 7001E  
150 - 200 ft

1+50

2+00

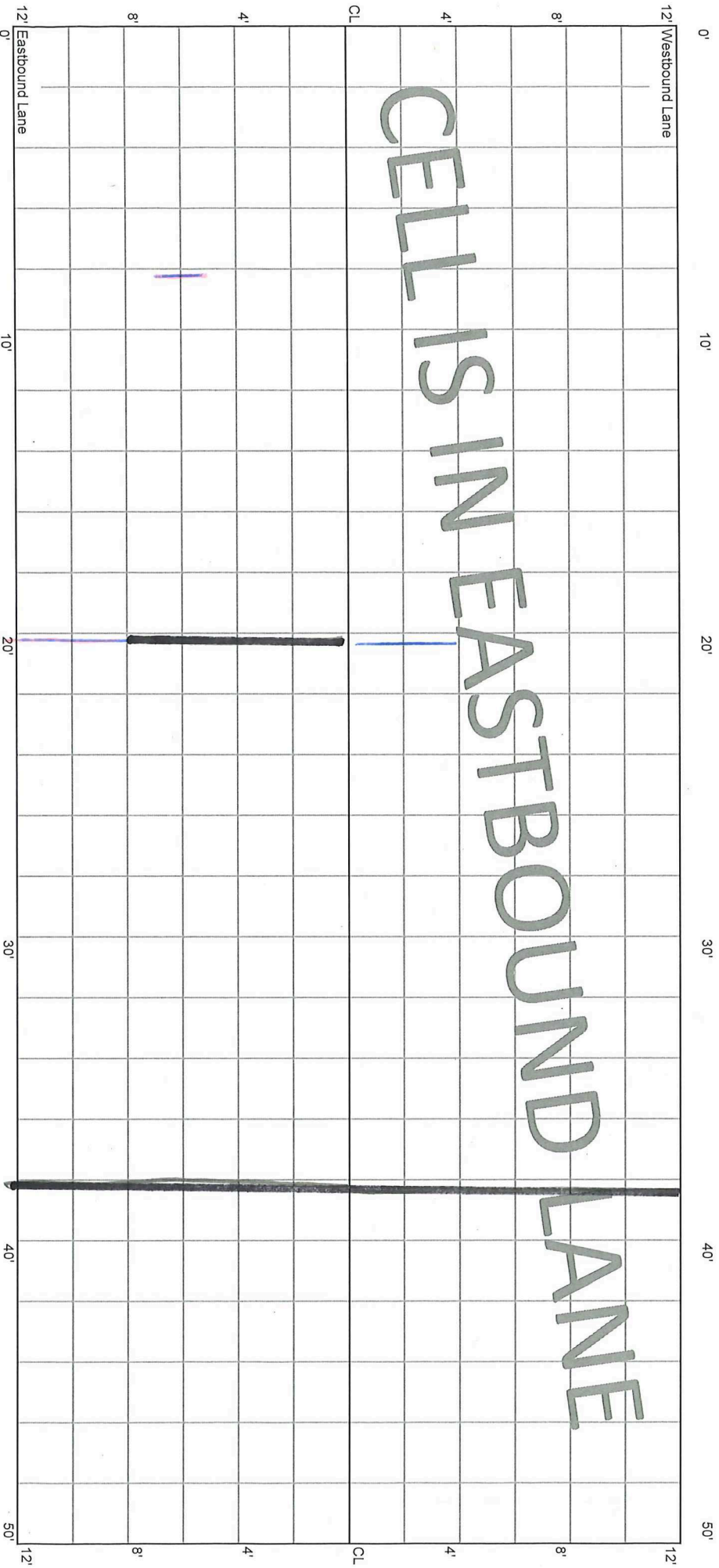

CELLS IN EASTBOUND LANE

\* 8' Seal

CELL 7001E  
200 - 250 ft

2+00

2+50

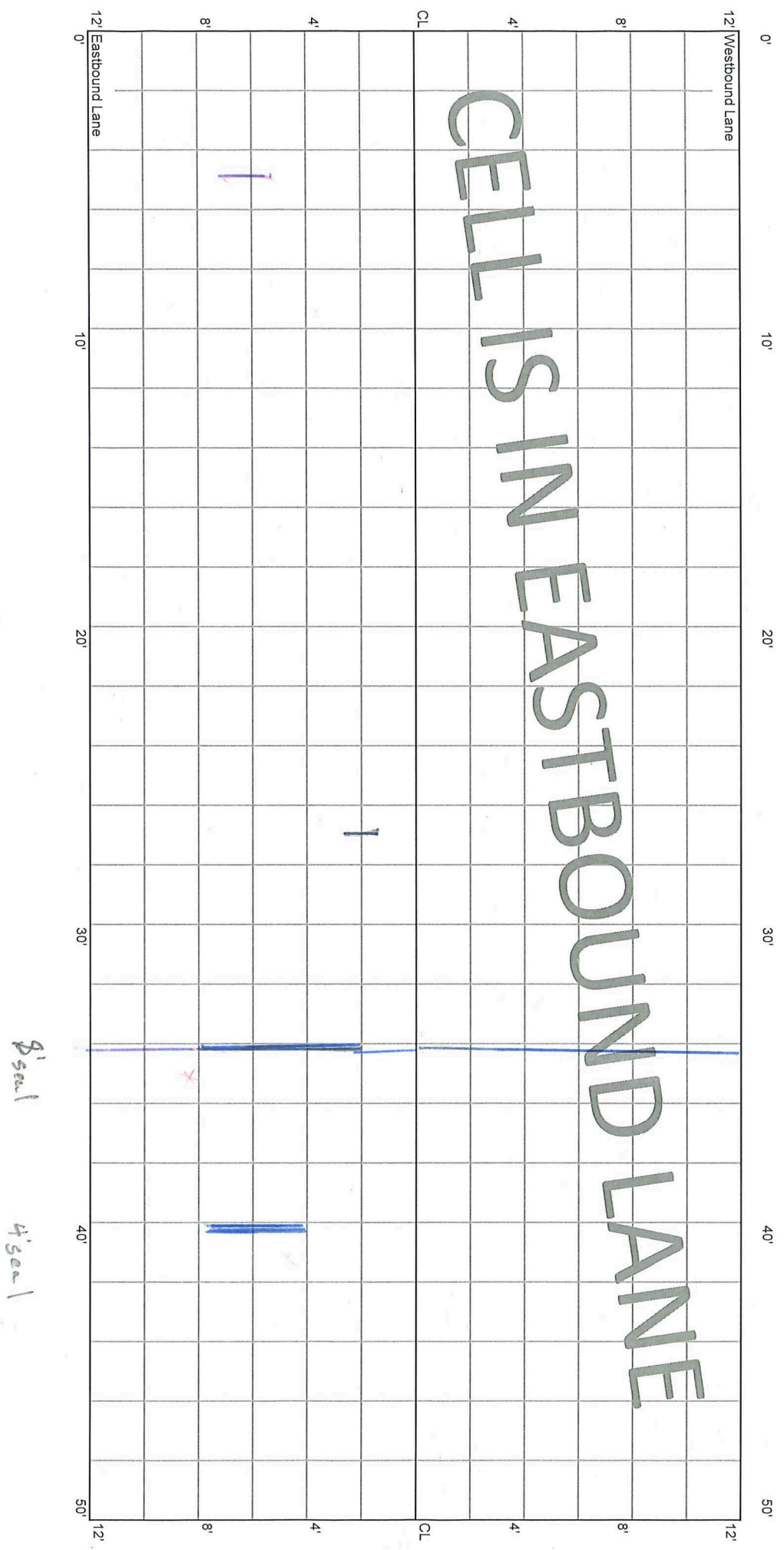

8' seal

4' seal

CELLS IN EASTBOUND LANE

CELL 7001E  
250 - 300 ft

2+50

3+00

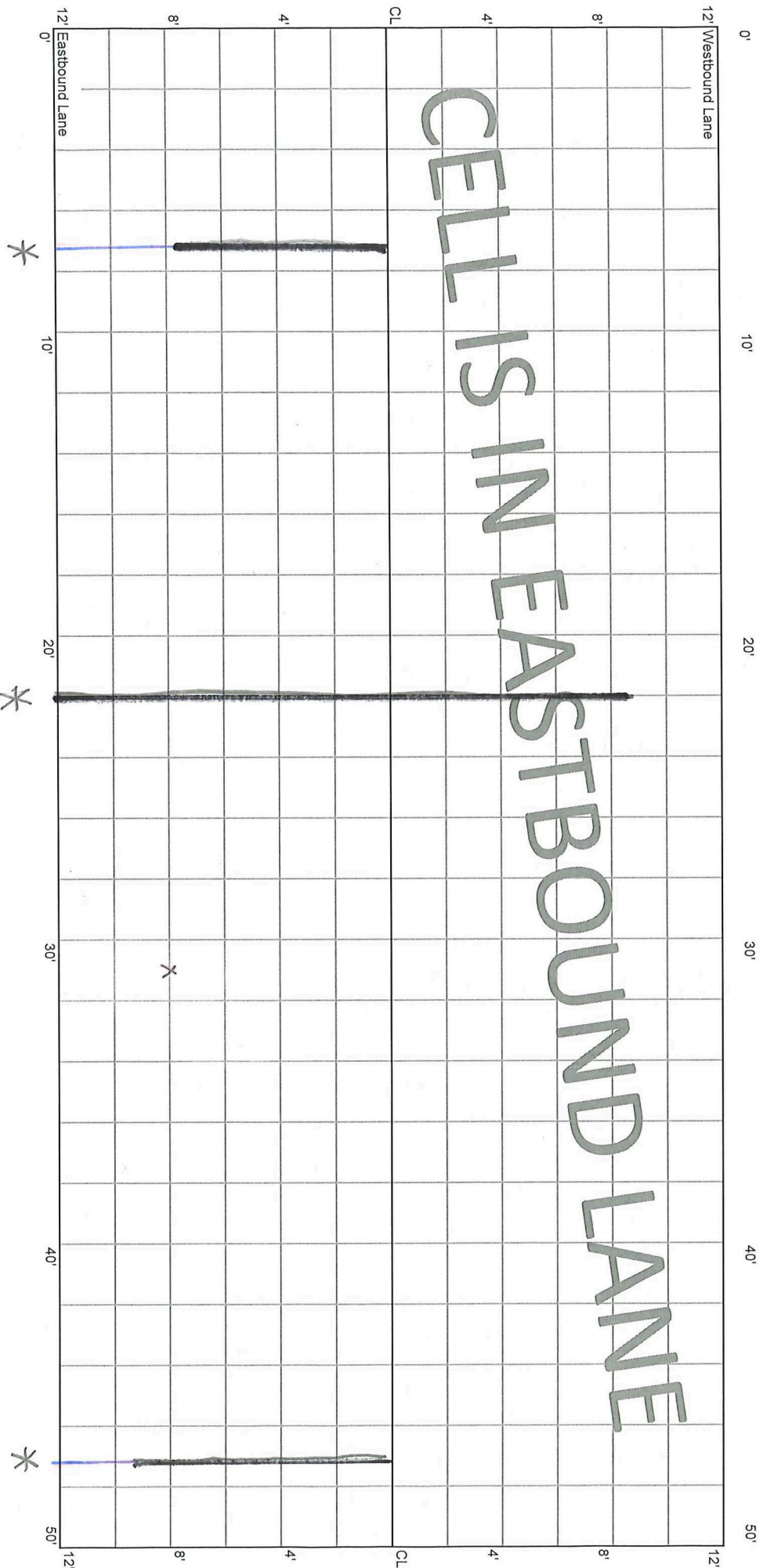

X popout

CELL 7001E  
300 - 350 ft

3+00

3+50

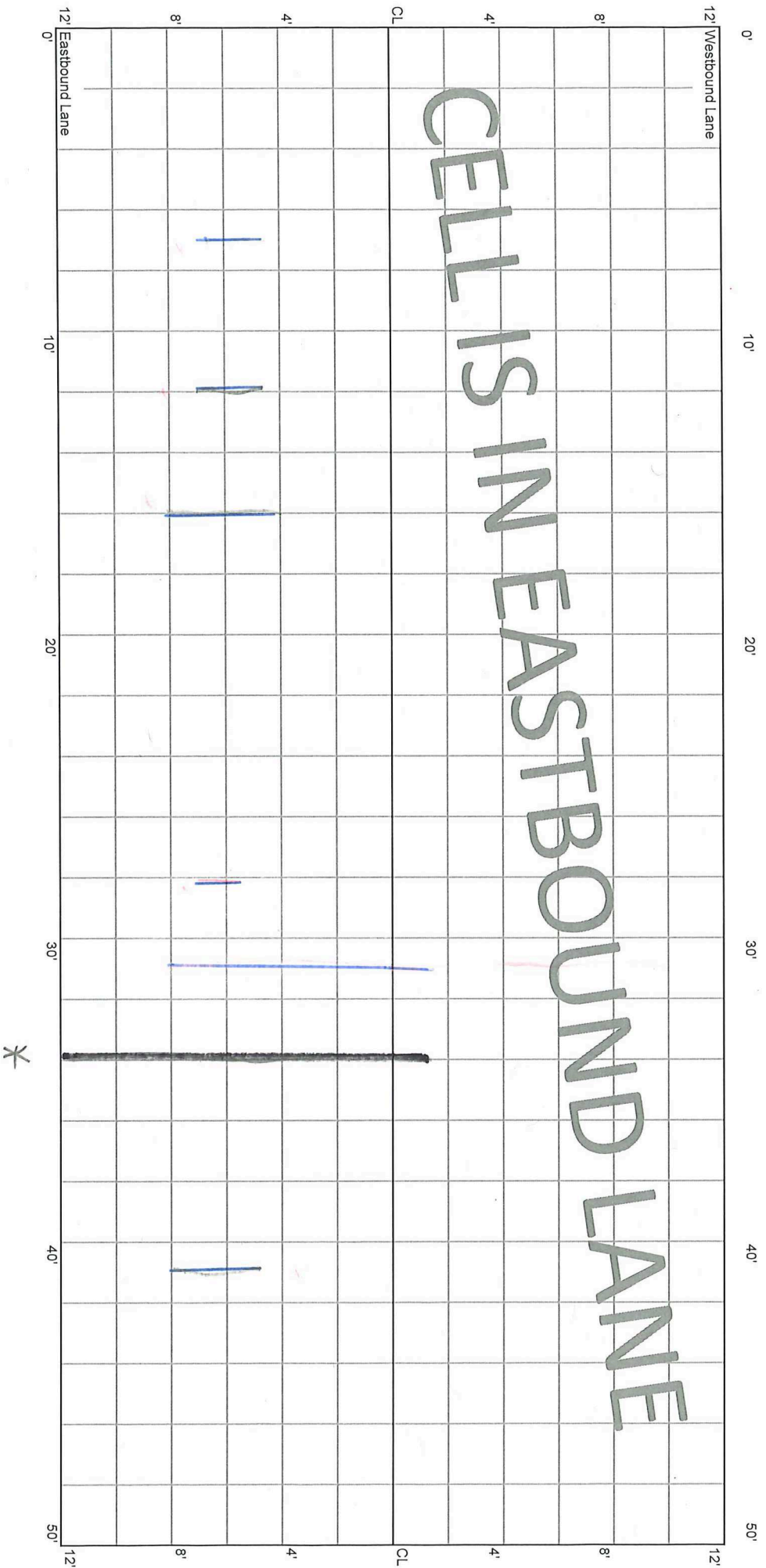

CELL 7001E  
350 - 400 ft

3+50

4+00

CELLS IN EASTBOUND LANE

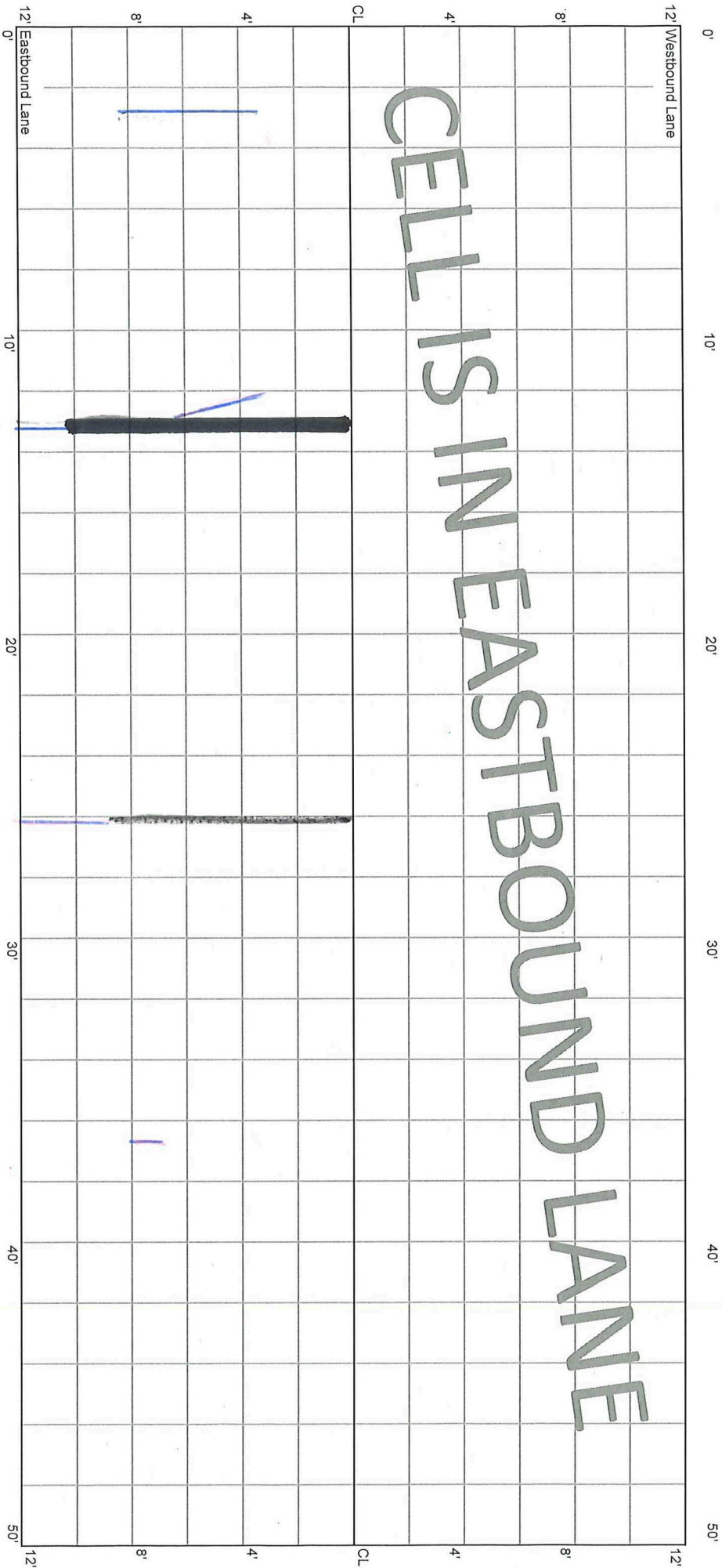

\* 10-ft

\*



CELL 7001E  
400 - 450 ft

4+00

4+50

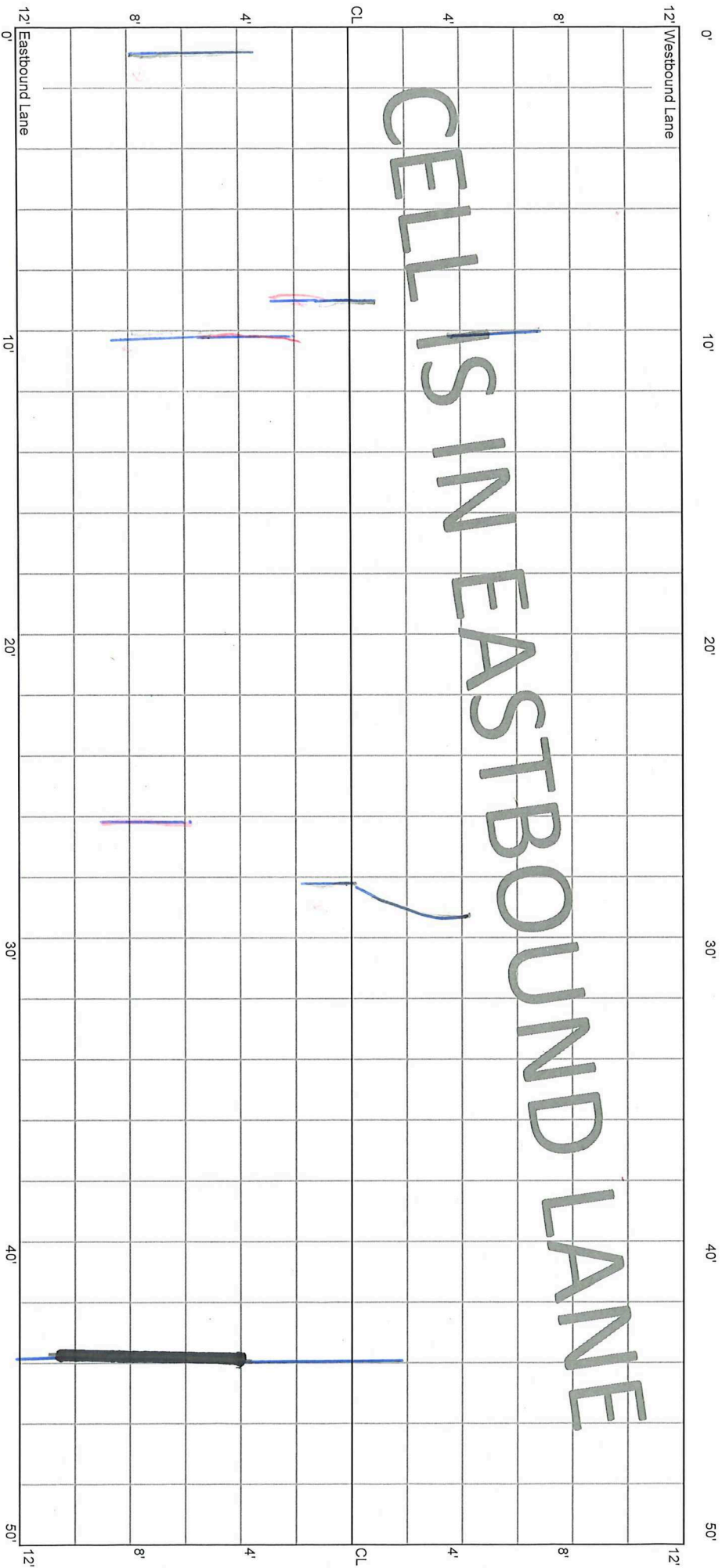

1st

1/4/10

7-ft (8.25-21)

CELL 7001E  
450 - 500 ft

4+50

5+00

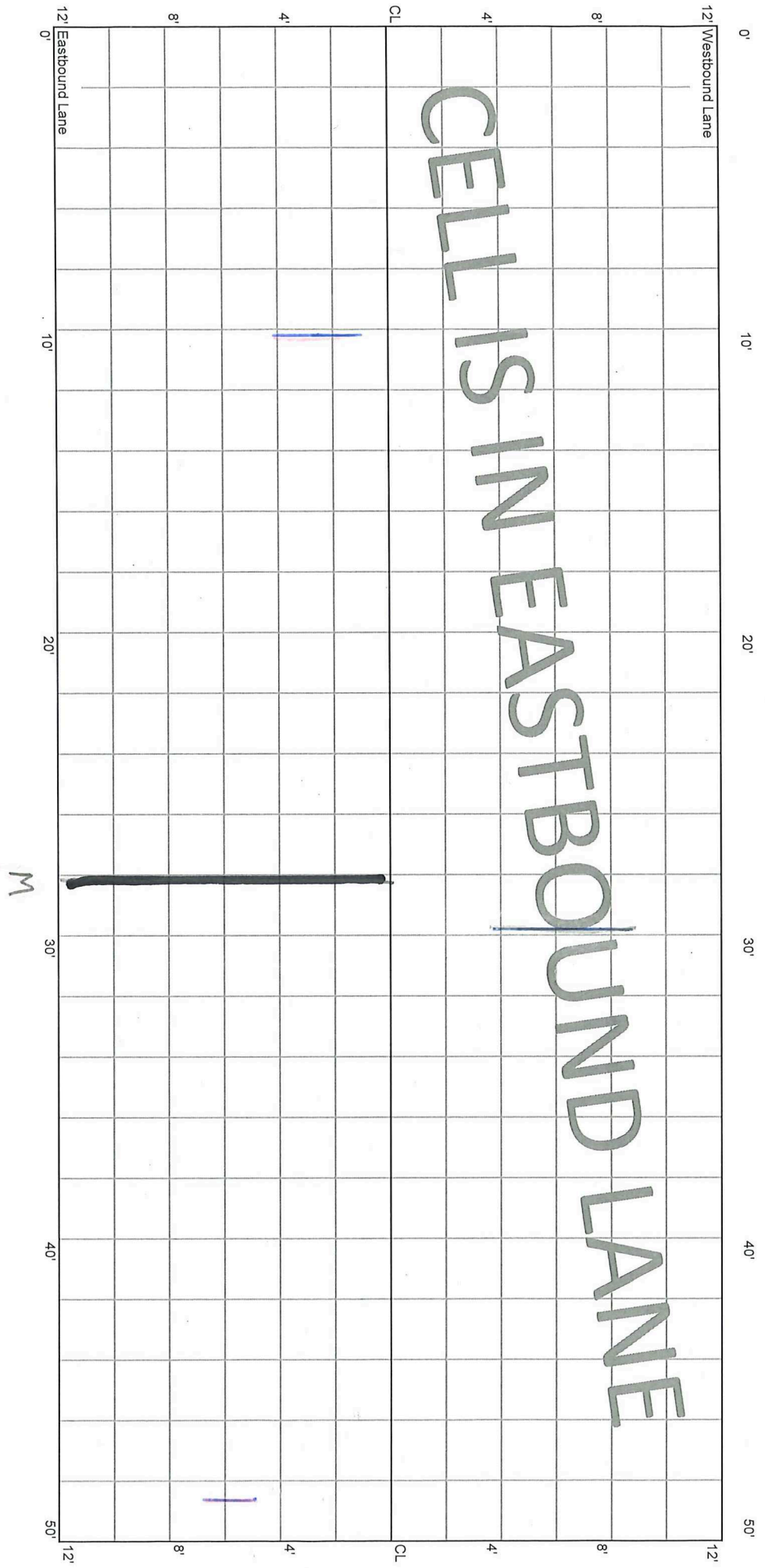

CELLS IN EASTBOUND LANE

M

CELL 7001E  
500 - 550 ft

5+00

5+25

5+50

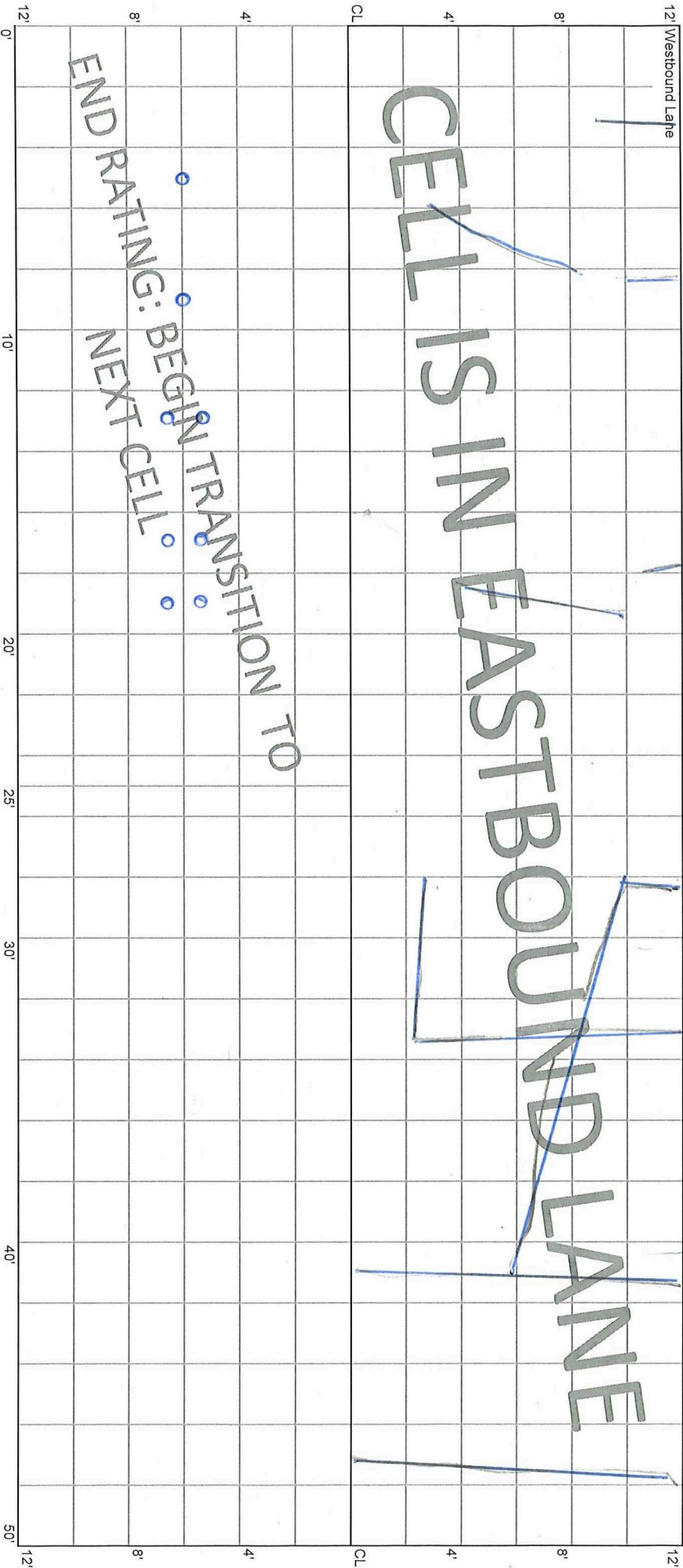

(0: Out 20  
Cores)



2