

5:28, 30 E.J.

10.14.20 | 11.3.22

1.4.21

8.25.21

File 70TH ST

Begin CL Kadler

0+00

CELL 7001E  
0 - 50 ft

0+50

CELL IS IN EASTBOUND LANE

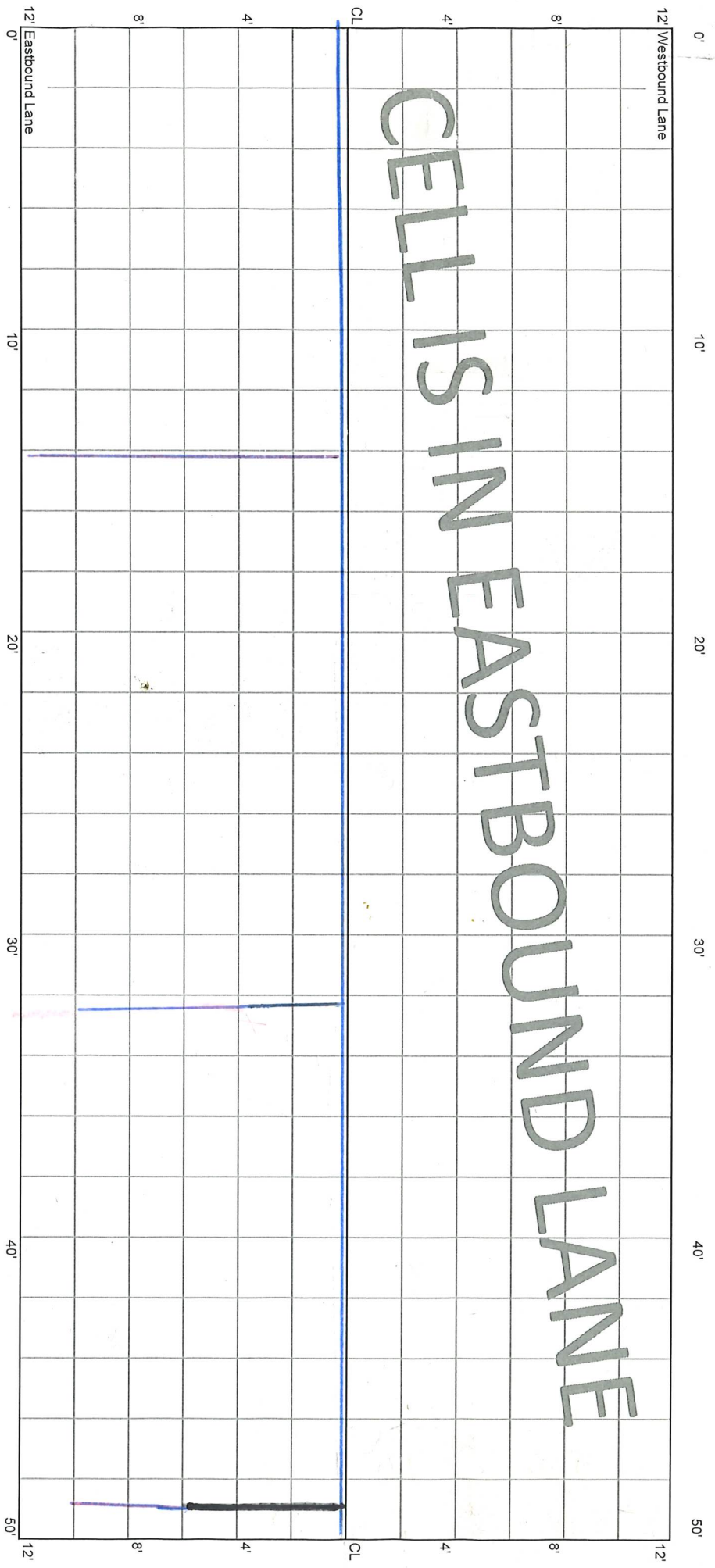

\*Rout 1 Seal

AF

CELL 7001E  
50 - 100 ft

0+50

1+00

12' Westbound Lane

12'

CELL IS IN EASTBOUND LANE

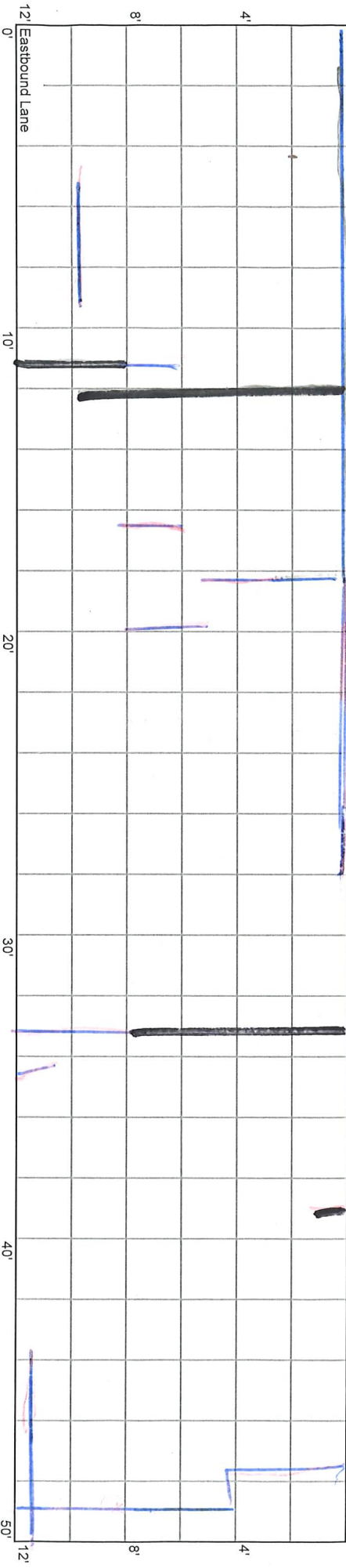

12' Eastbound Lane

12'

M\*

PK

AF, SP

CELL 7001E  
100 - 150 ft

1+00

1+50

CELL IS IN EASTBOUND LANE

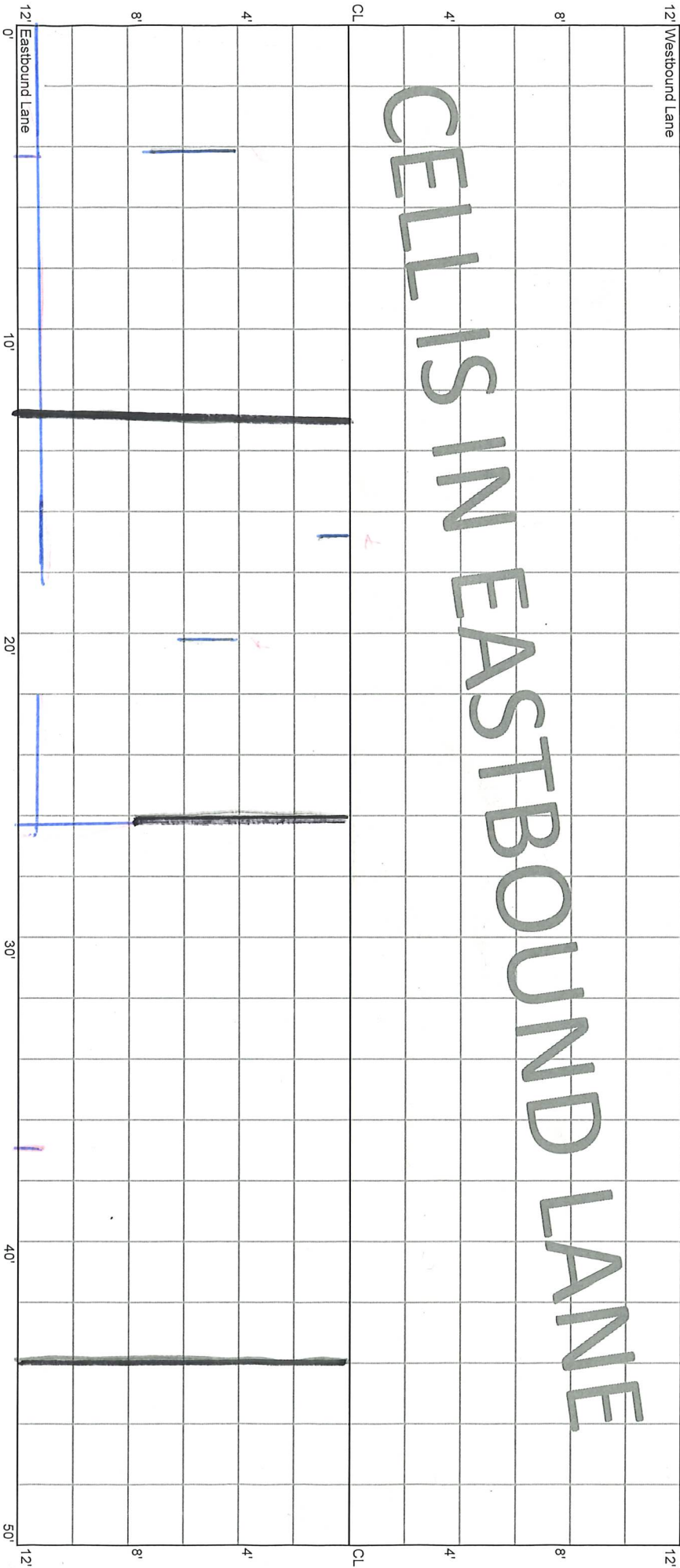

12' Westbound Lane  
0' 10' 20' 30' 40' 50'  
CL  
4' 8' 12'

AF, SP

SP

AF, SP

CELL 7001E  
150 - 200 ft

1+50

2+00

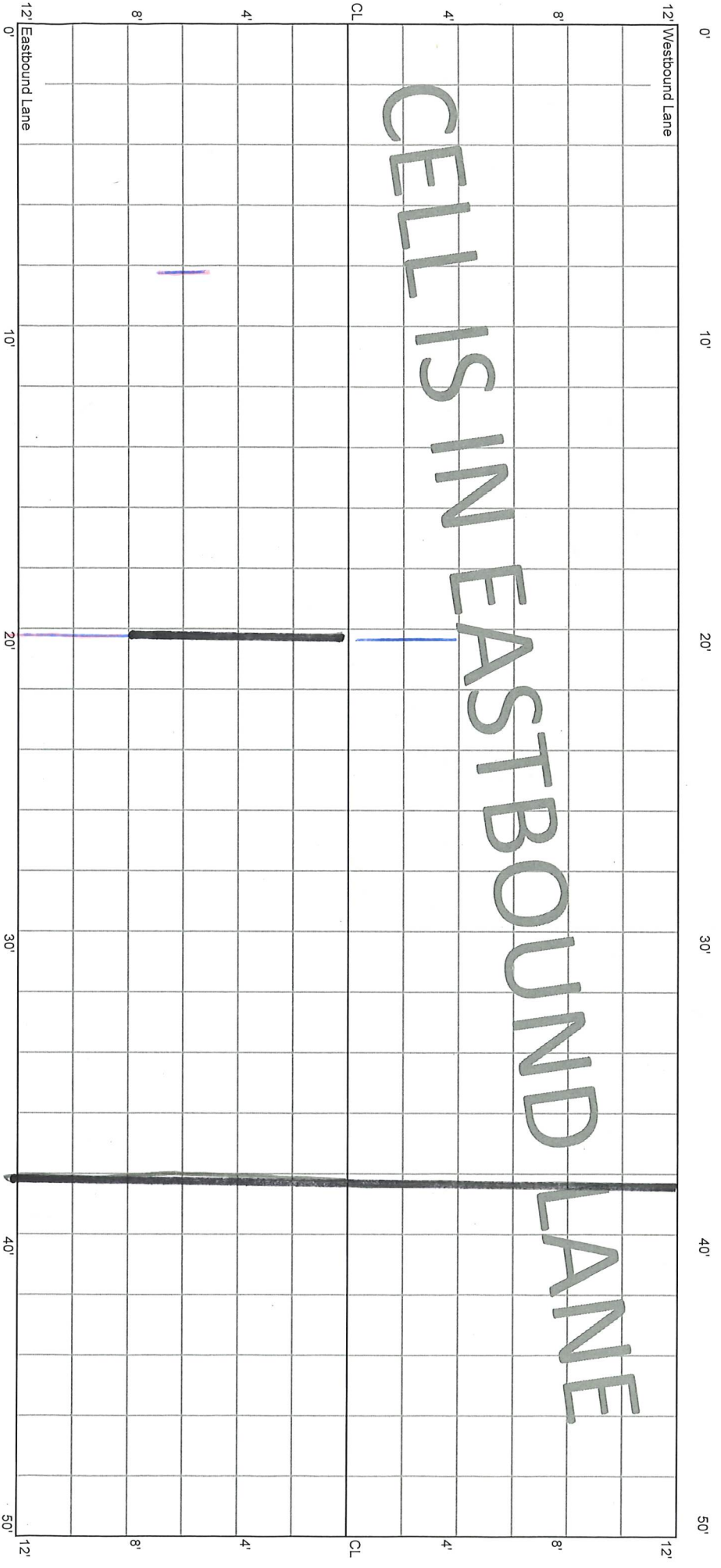

CELL IS IN EASTBOUND LANE

\*

\*

8' seal  
SP

AF

CELL 7001E  
200 - 250 ft

2+00

2+50

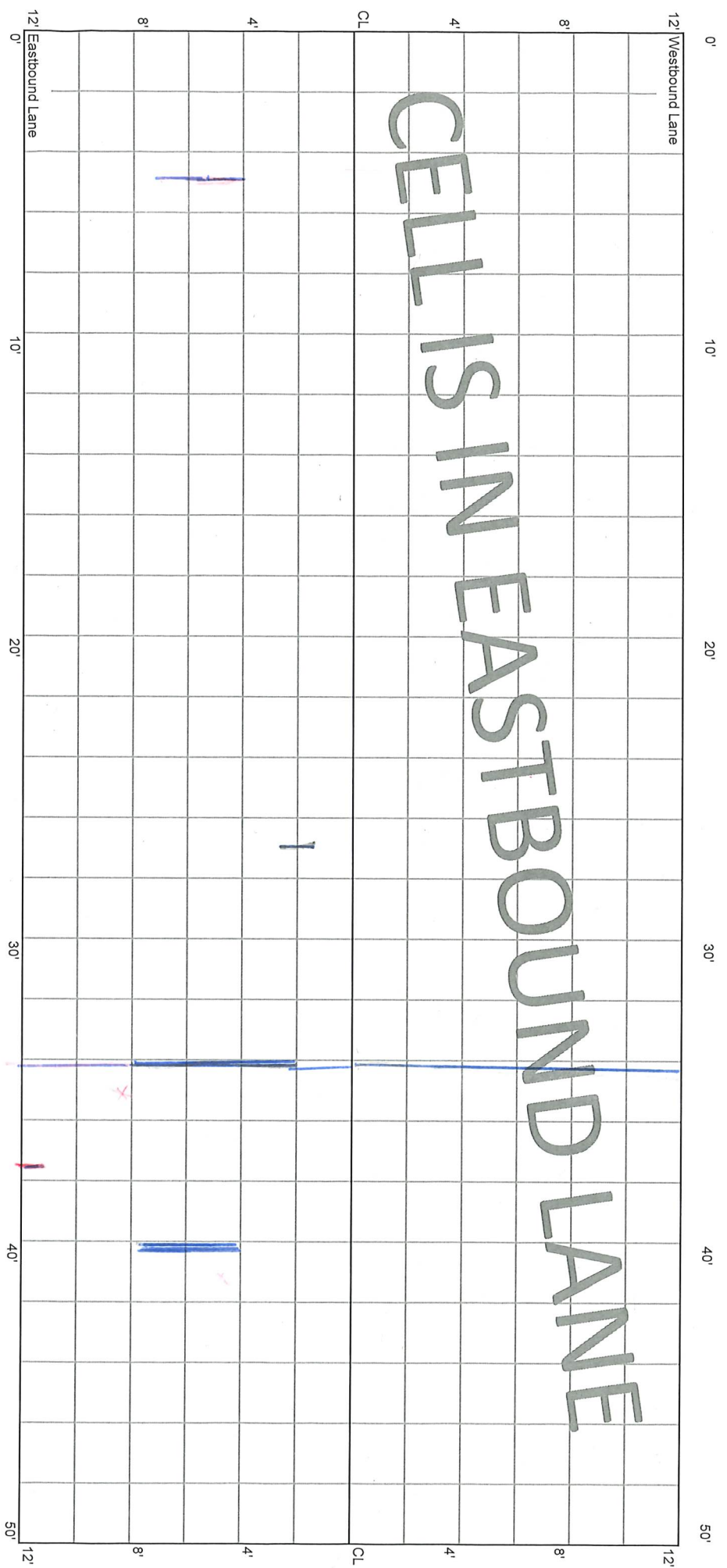

8' seal  
No 6' seal

4' seal  
No 5' seal

CELL 7001E  
250 - 300 ft

2+50

3+00

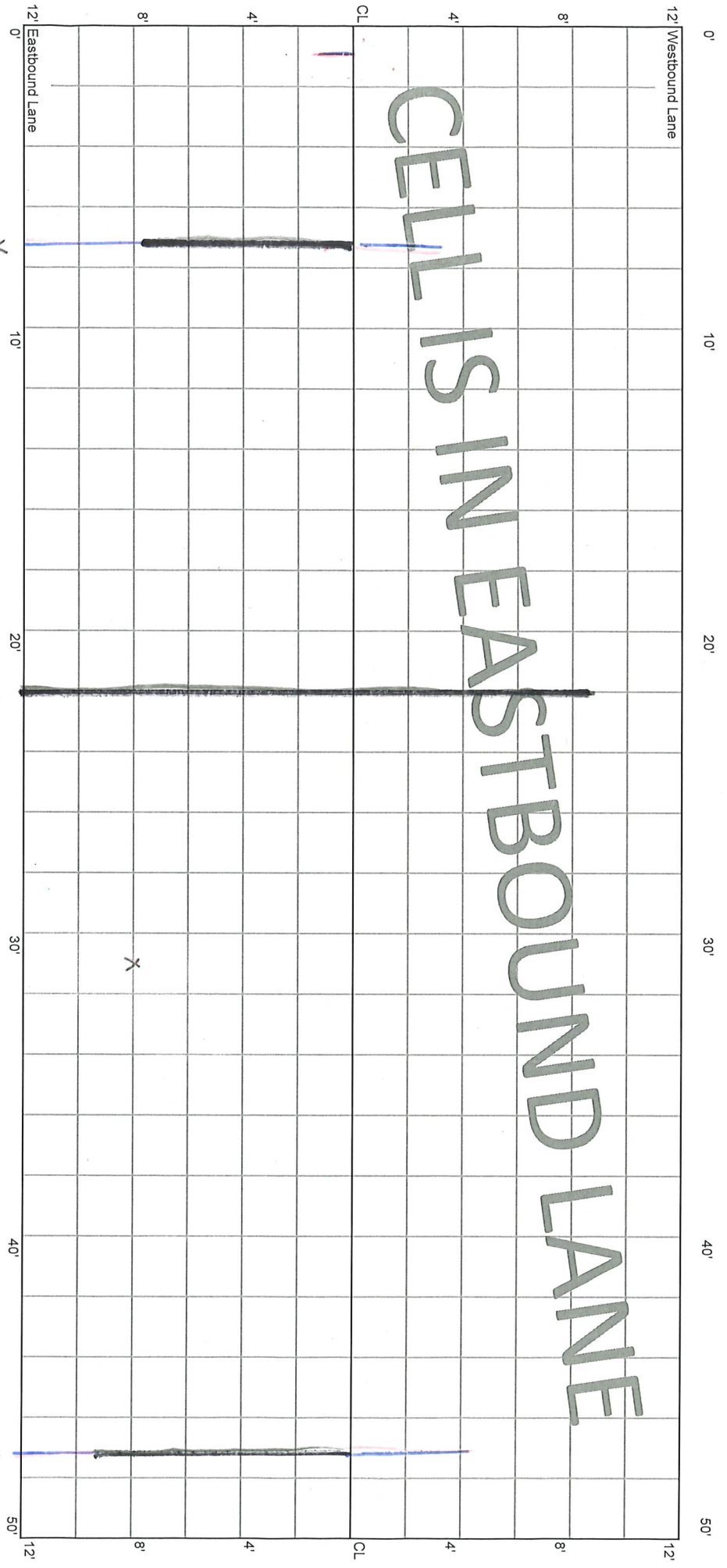

CELL IS IN EASTBOUND LANE

AF  
SP

AP

X point

AF  
SP

CELL 7001E  
300 - 350 ft

3+00

3+50

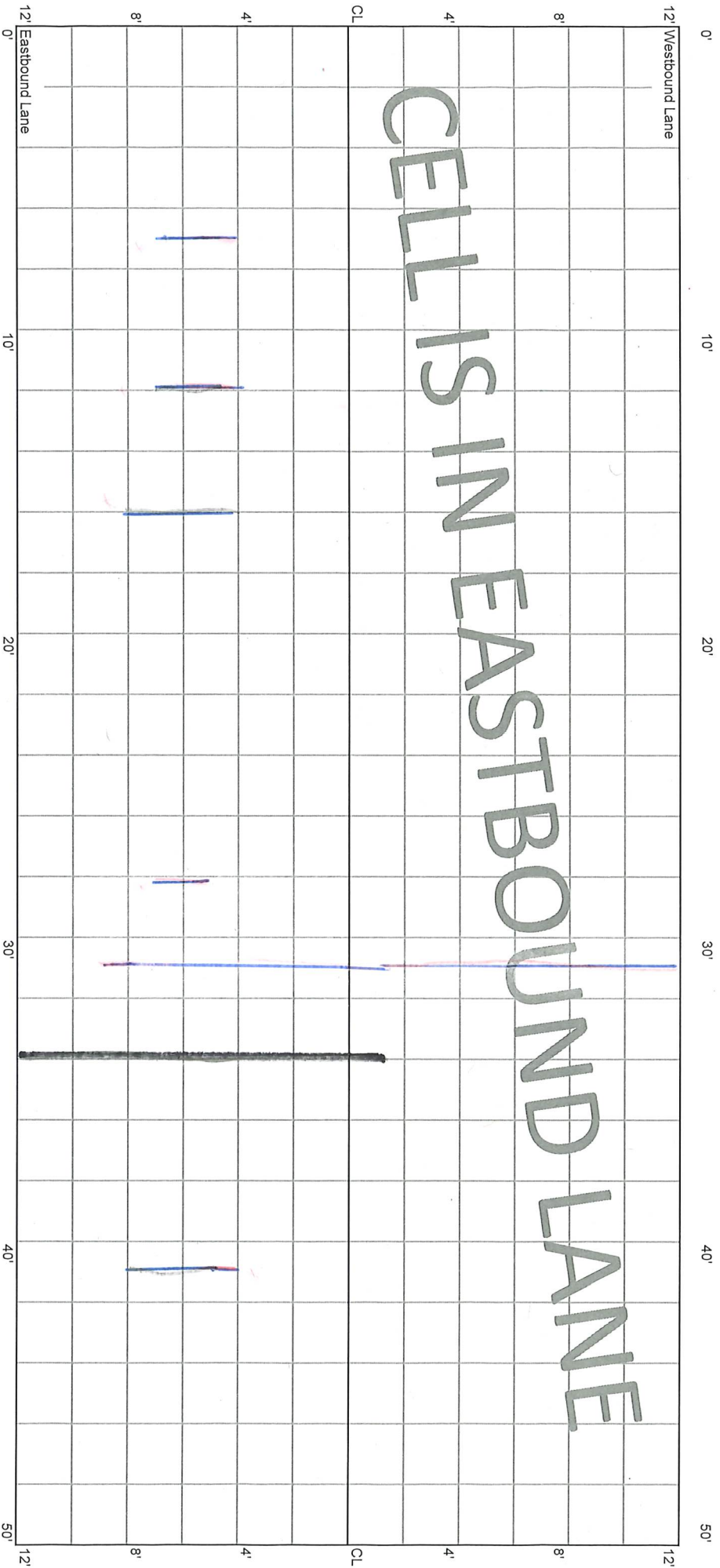

\*  
AF

CELL 7001E  
350 - 400 ft

3+50

4+00

12' Westbound Lane

0' 10' 20' 30' 40' 50'

CELL IS IN EASTBOUND LANE

CL CL

12' Eastbound Lane

0' 10' 20' 30' 40' 50'

\* 10-ft  
SP

\*  
AC

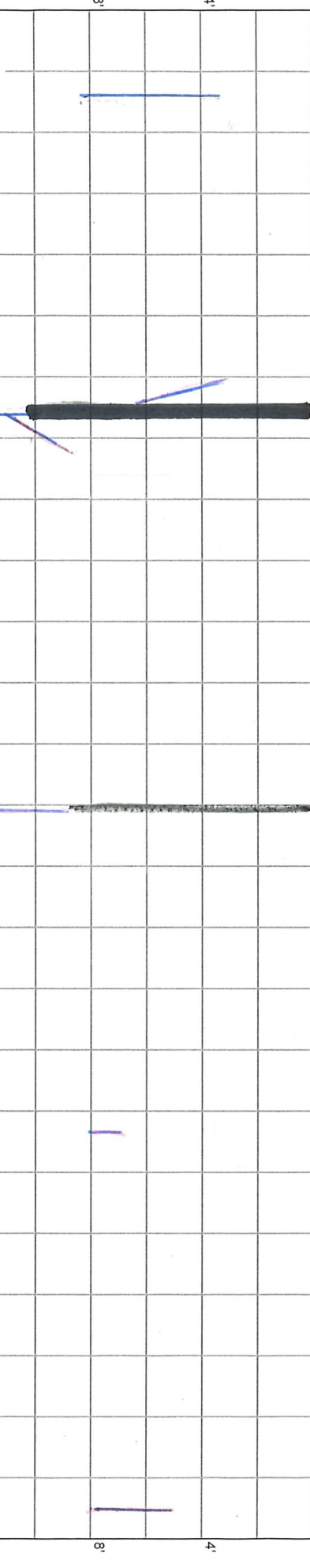



CELL 7001E  
400 - 450 ft

4+00

4+50

12' Westbound Lane

0' 10' 20' 30' 40' 50'

CELL IS IN EASTBOUND LANE

12' Eastbound Lane

0' 10' 20' 30' 40' 50'

1.5 ft

1/4 ft

7.5 ft (3.25 x 2.25)

SP, AF

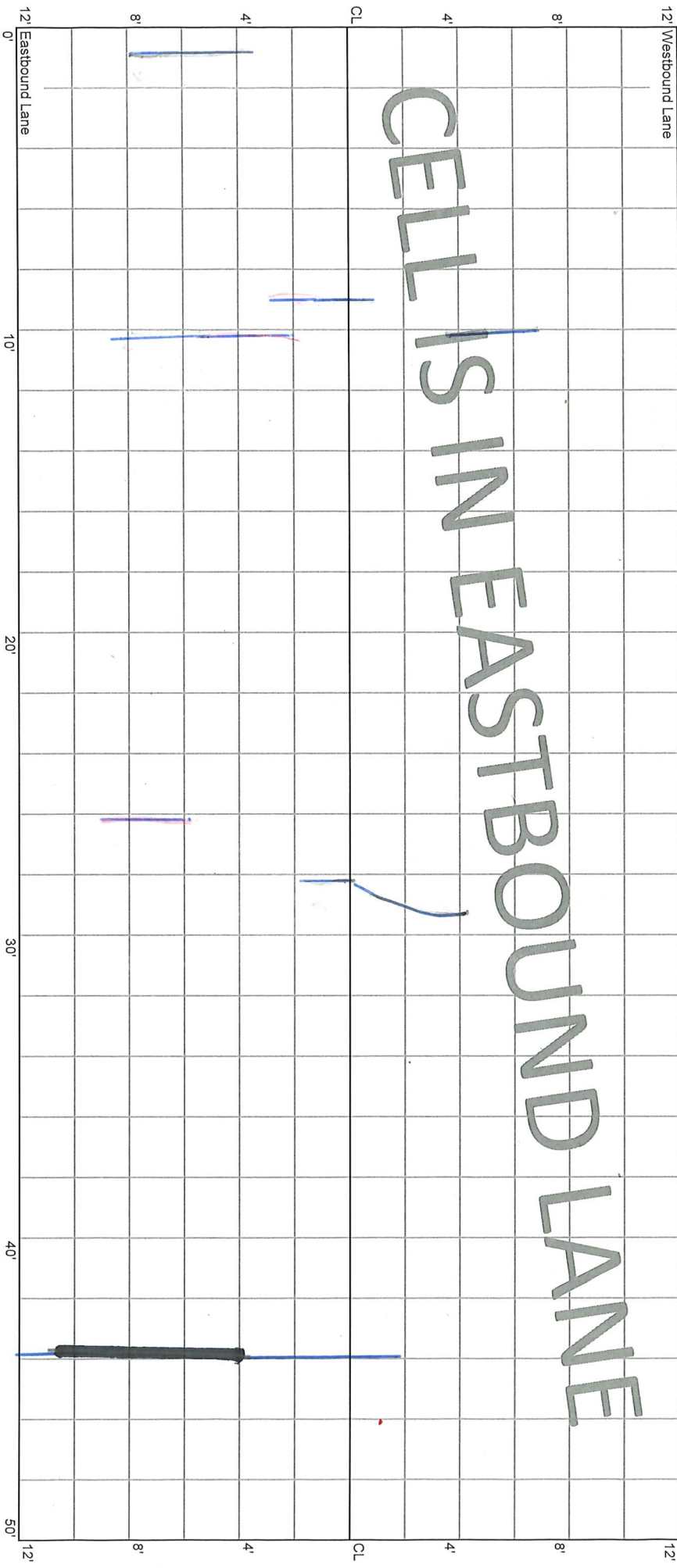

CELL 7001E  
450 - 500 ft

4+50

5+00

12' Westbound Lane

12' Eastbound Lane

CELL IS IN EASTBOUND LANE

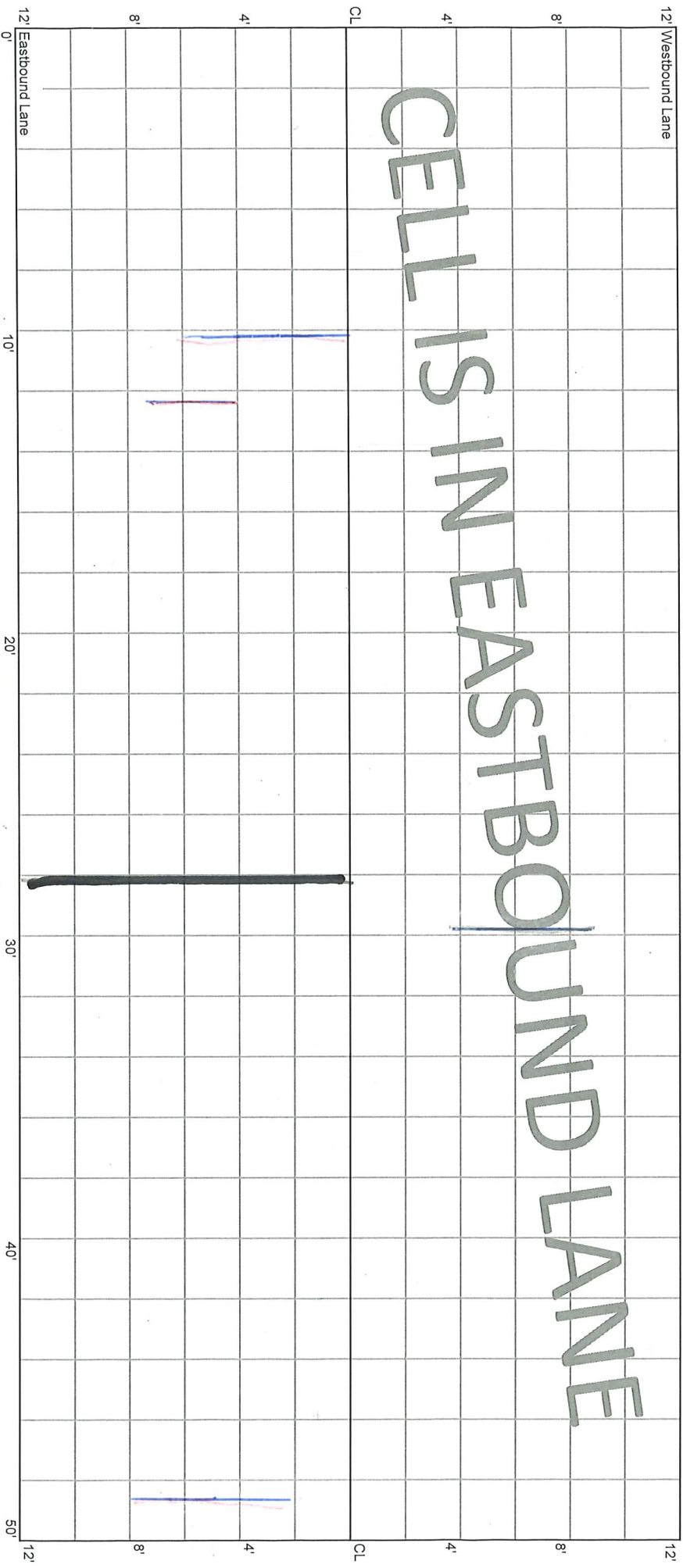

M

AF, 98

CELL 7001E  
500 - 550 ft

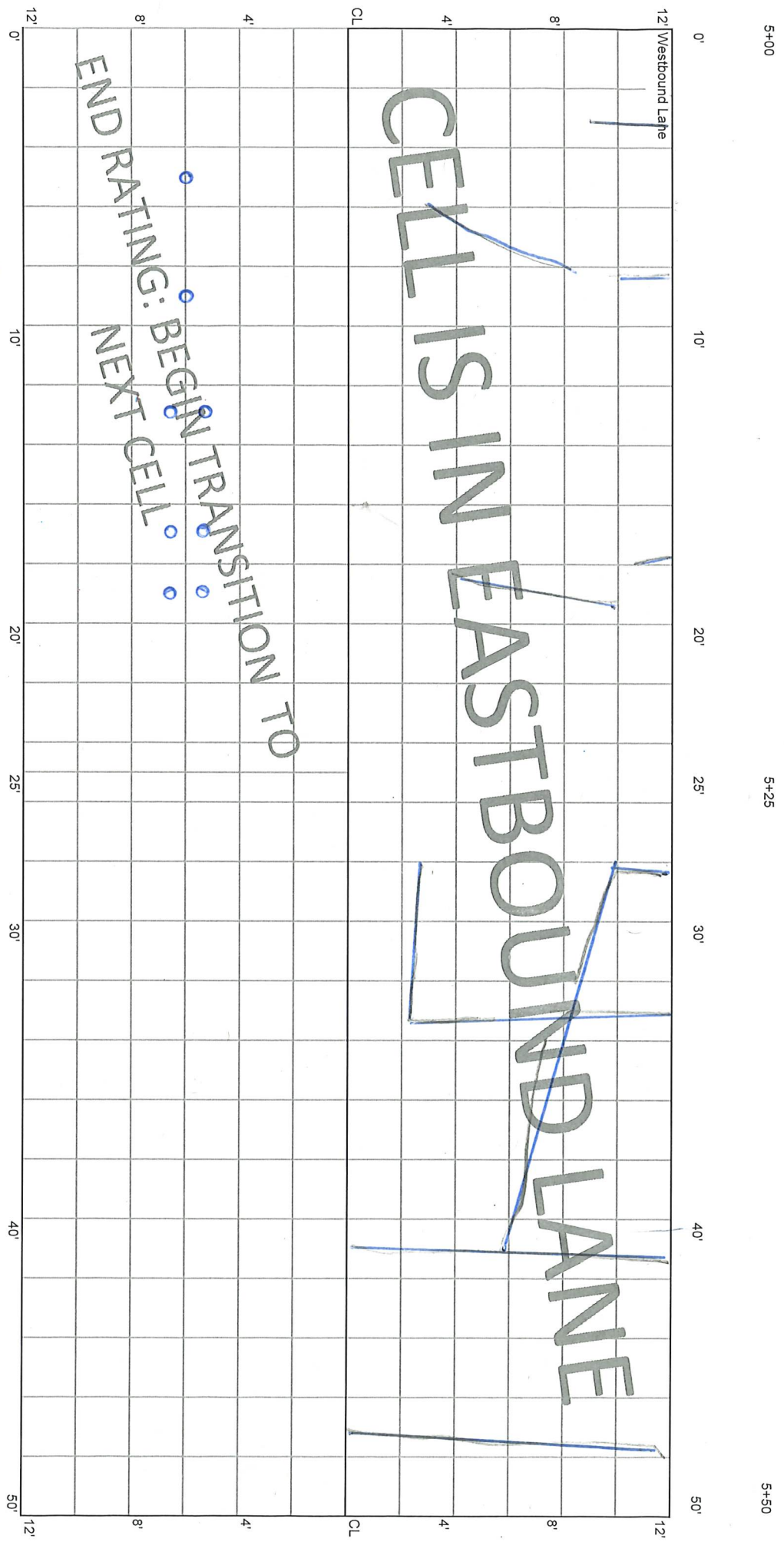

(0: 0ft 20  
Cores)



(2)