

5.28.20 E.T.

10.14.20 1.3.22

1.4.21 8.30.22

File 70TH ST 1.20.23

9.14.21 8.9.23

Cell 7013 W
CELL 7003W
0 - 50 ft

16+00

15+50

CELLS IN WESTBOUND LANE

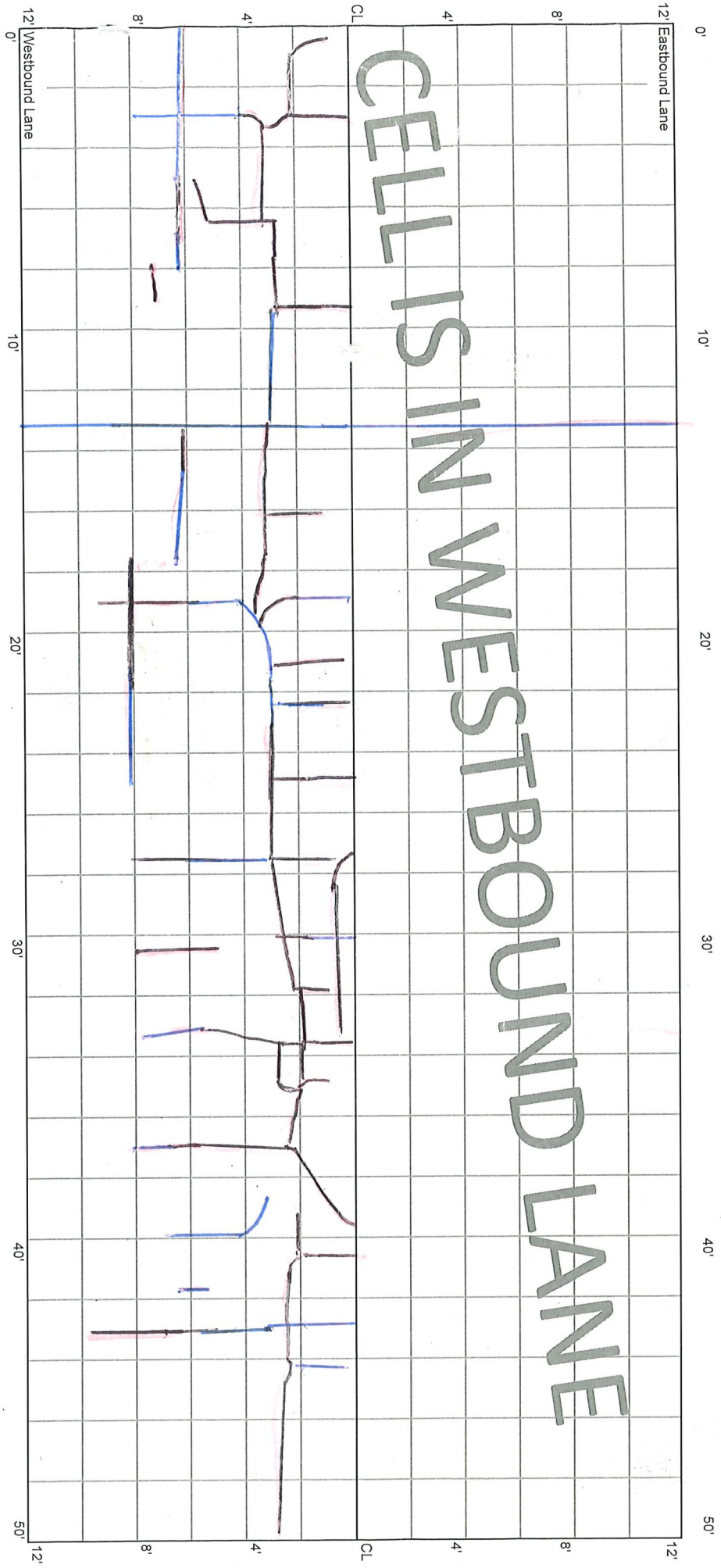

* Rout & Seal

CELL 7003W
50 - 100 ft

15+50

15+00

12' Eastbound Lane

12'

CELLS IN WESTBOUND LANE

12' Westbound Lane

12'

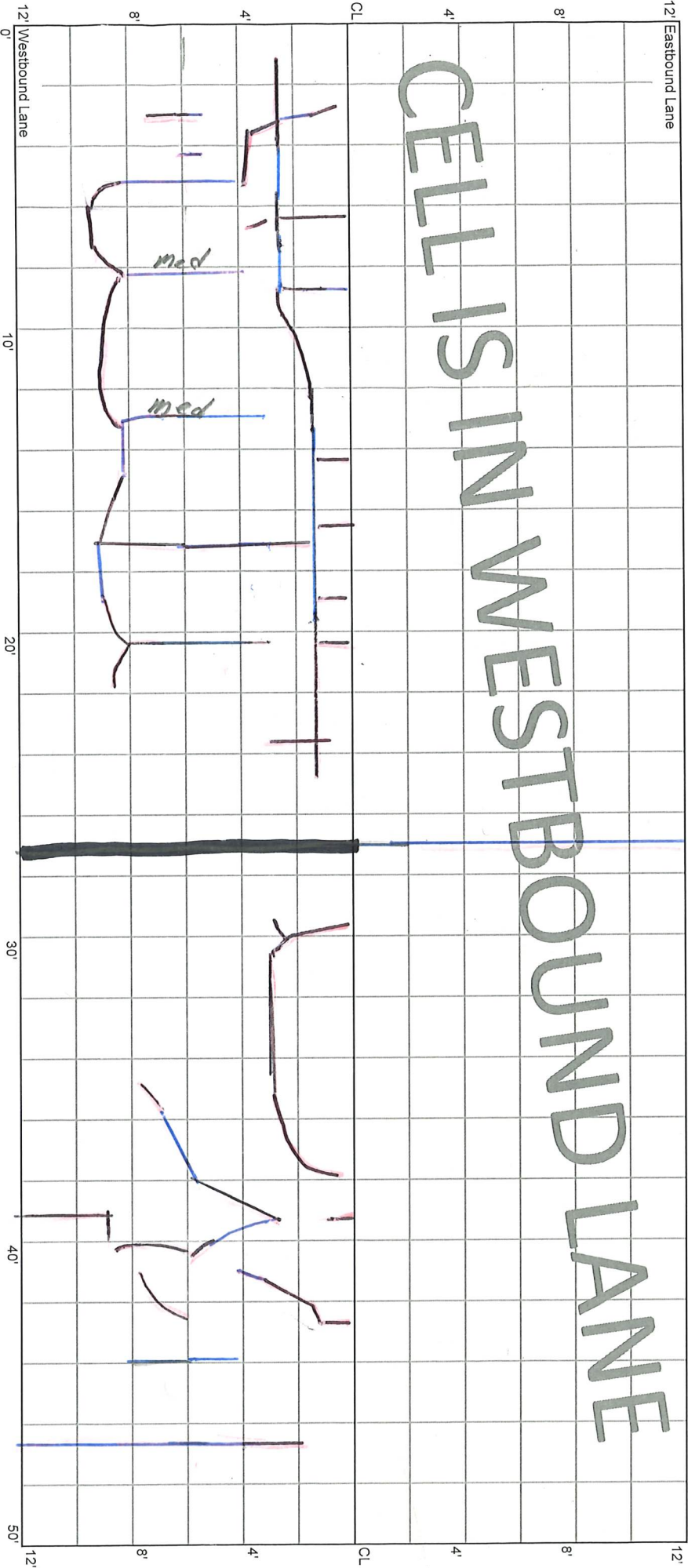

*M
AF

CELL 7003W
100 - 150 ft

15+00

14+50

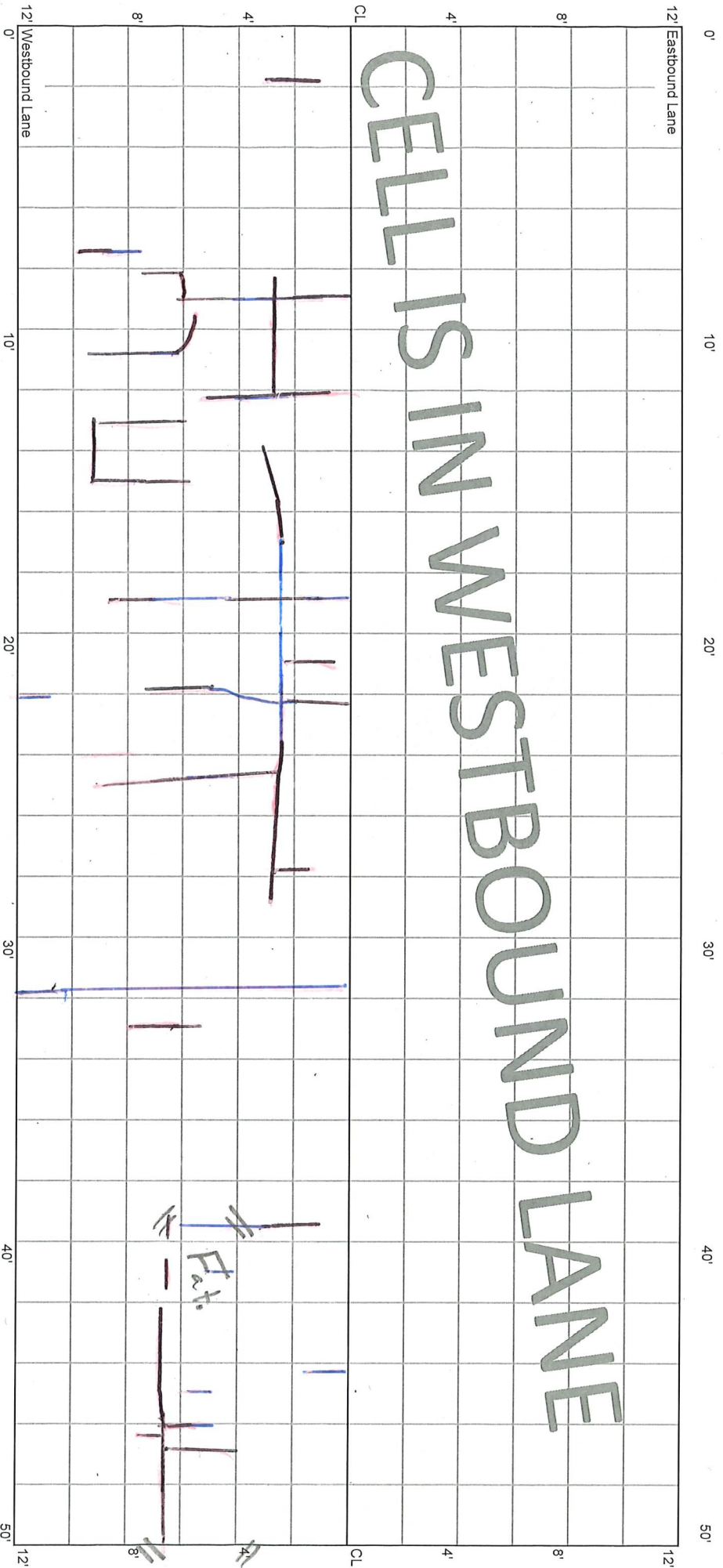

CELL 7003W
150 - 200 ft

14+50

14+00

CELLS IN WESTBOUND LANE

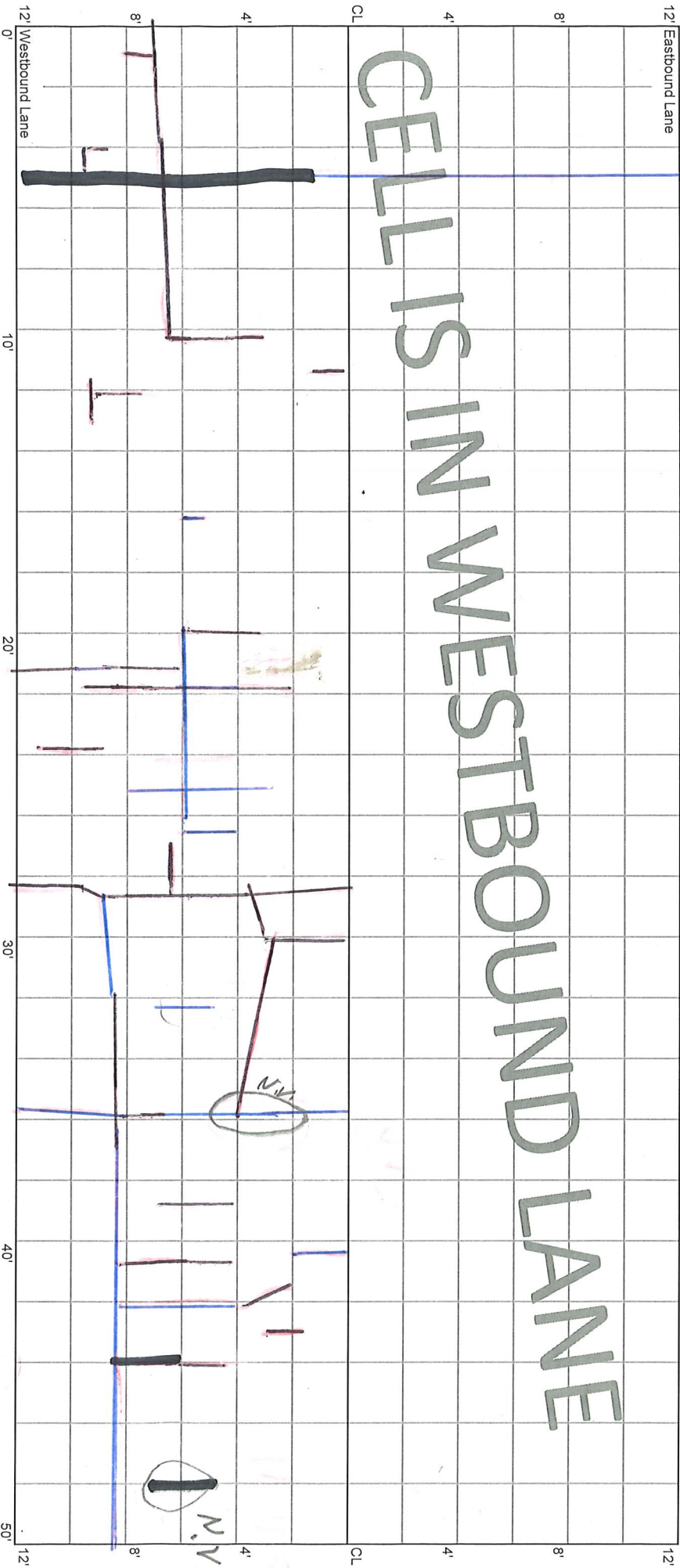

No Seal

4'

No Seal

CELL 7003W
200 - 250 ft

14+00

13+50

CELLS IN WESTBOUND LANE

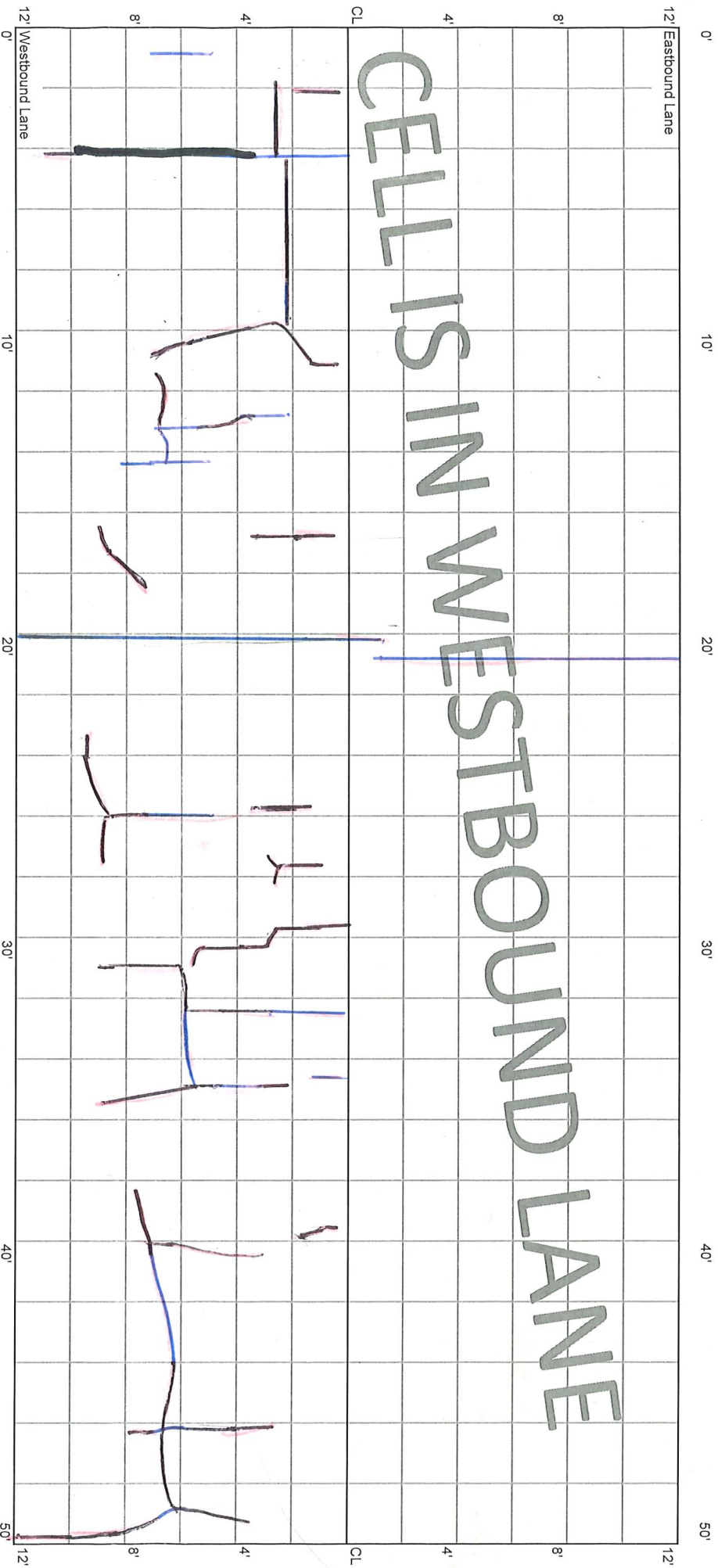

* Scaled

* AF.

Lost
6" Seal BWP

CELL 7003W
250 - 300 ft

13+50

13+00

CELLS IN WESTBOUND LANE

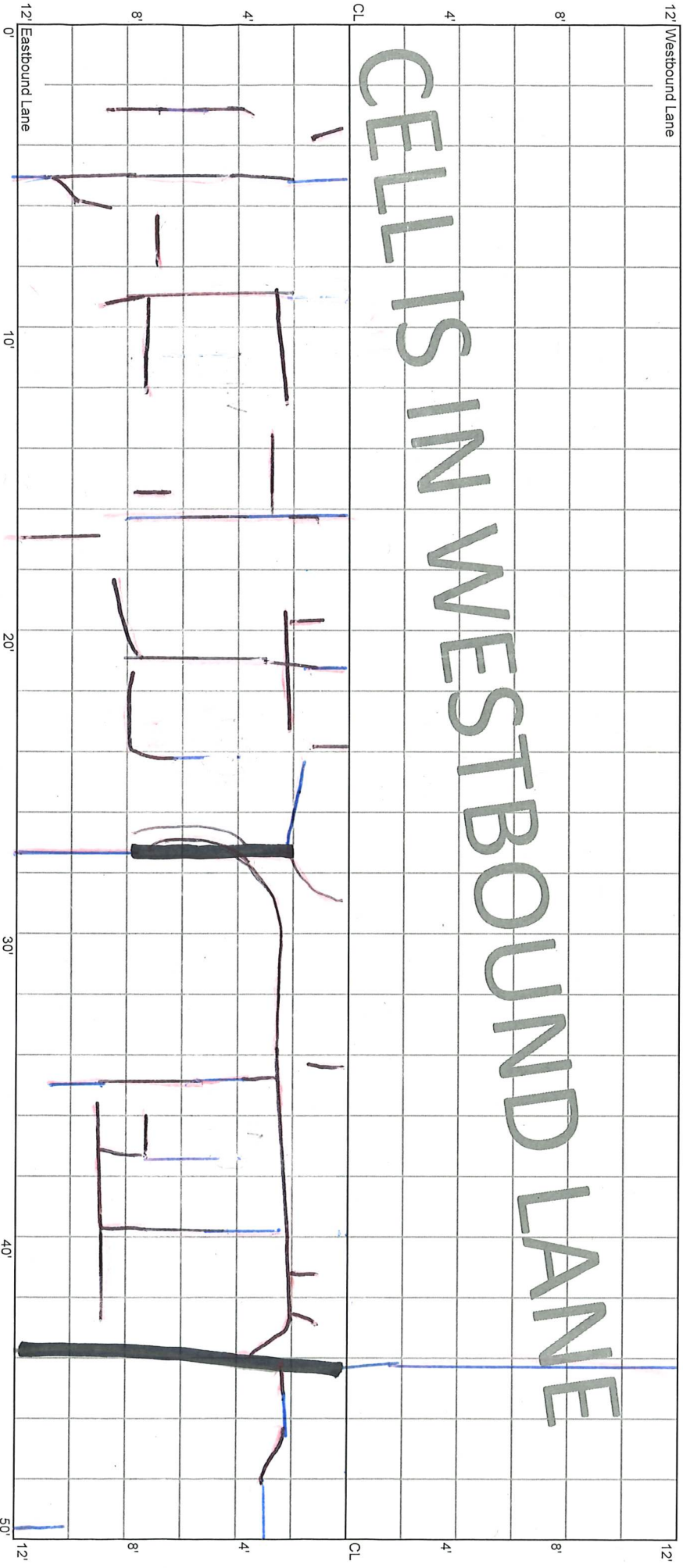

* M

* AF

662

CELL 7003W
300 - 350 ft

13+00

12+50

CELLS IN WESTBOUND LANE

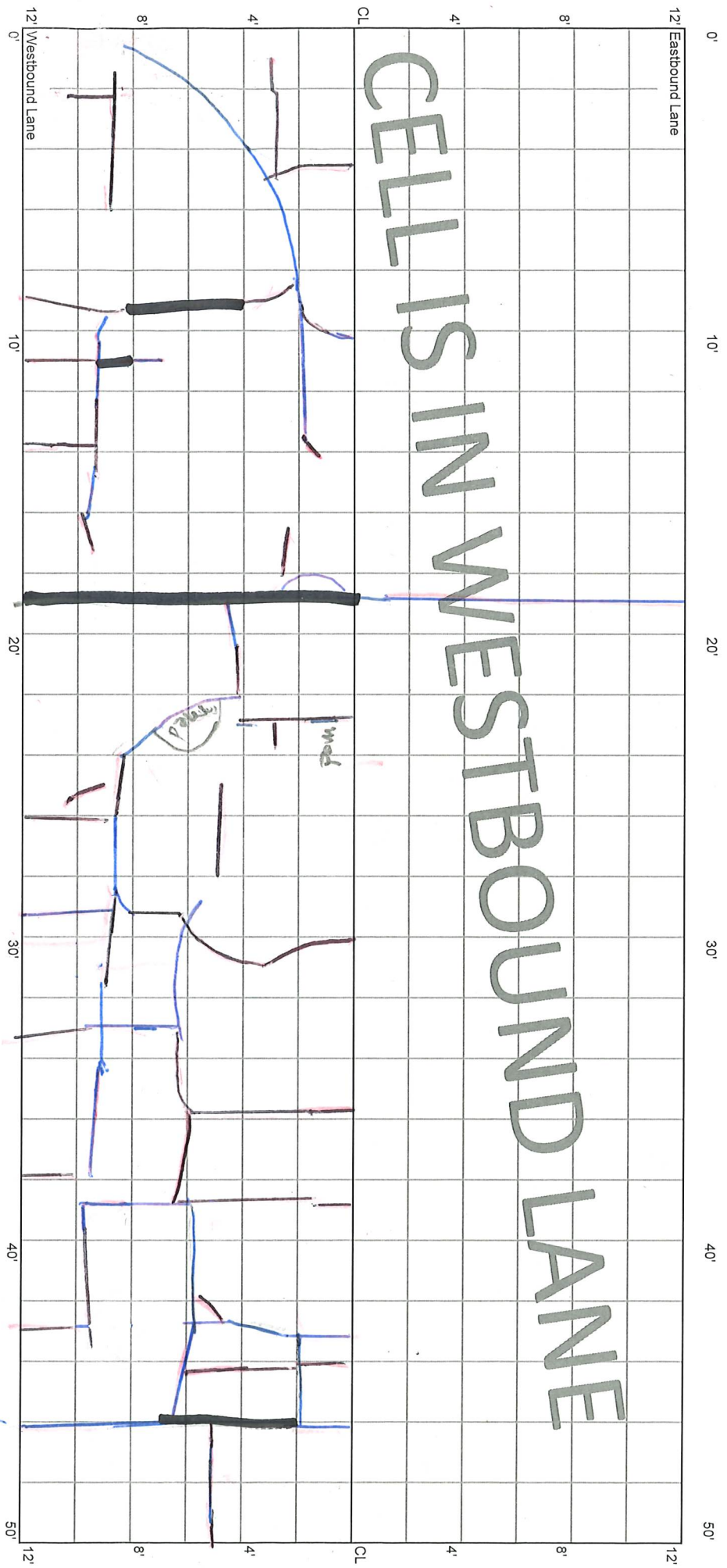

* N.S.

*

* N.S.
M

CELL 7003W
350 - 400 ft

12+50

12+00

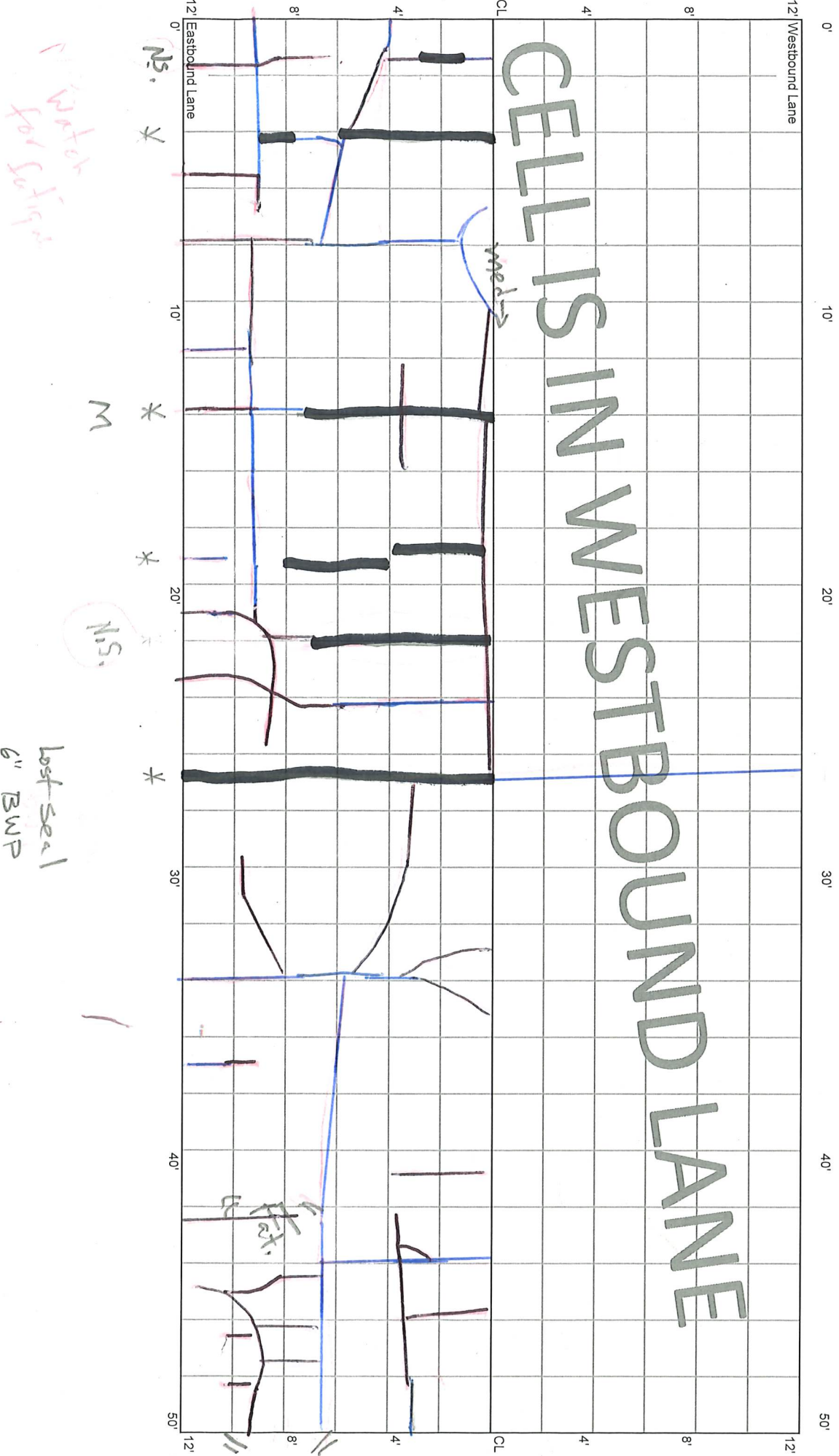

Motor for Sealing

*lost seal
6" BWP*

meds

Ext.

CELL 7003W
400 - 450 ft

12+00

11+50

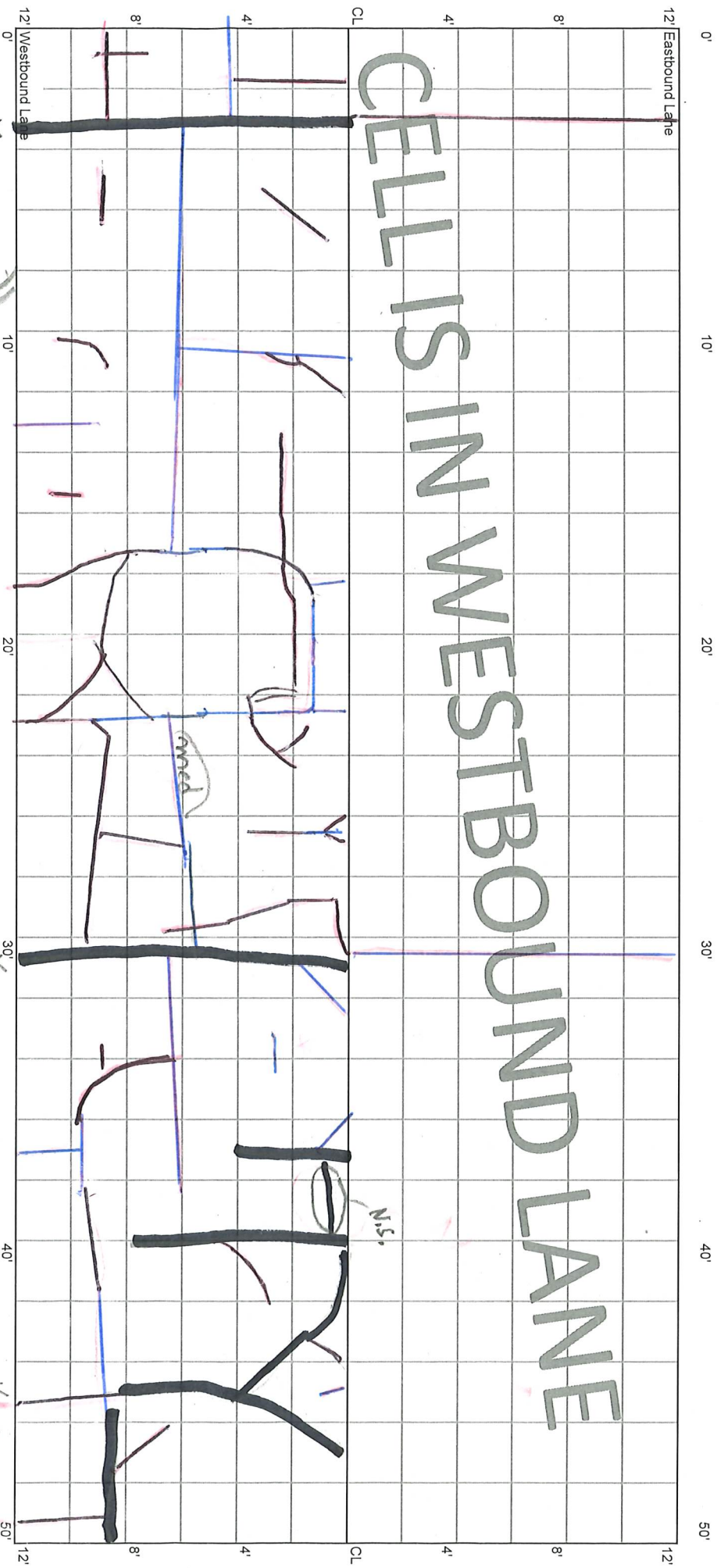

M *

water tower

manhole

N.S.

Lost Seal
6" BWP

L.S. 6" BWP

L.S. 6" LWP

M *

- L.S. 6" BWP
- (2) L.S. 3" LWP

N *

CELL 7003W
450 - 500 ft

11+50

11+00

CELLS IN WESTBOUND LANE

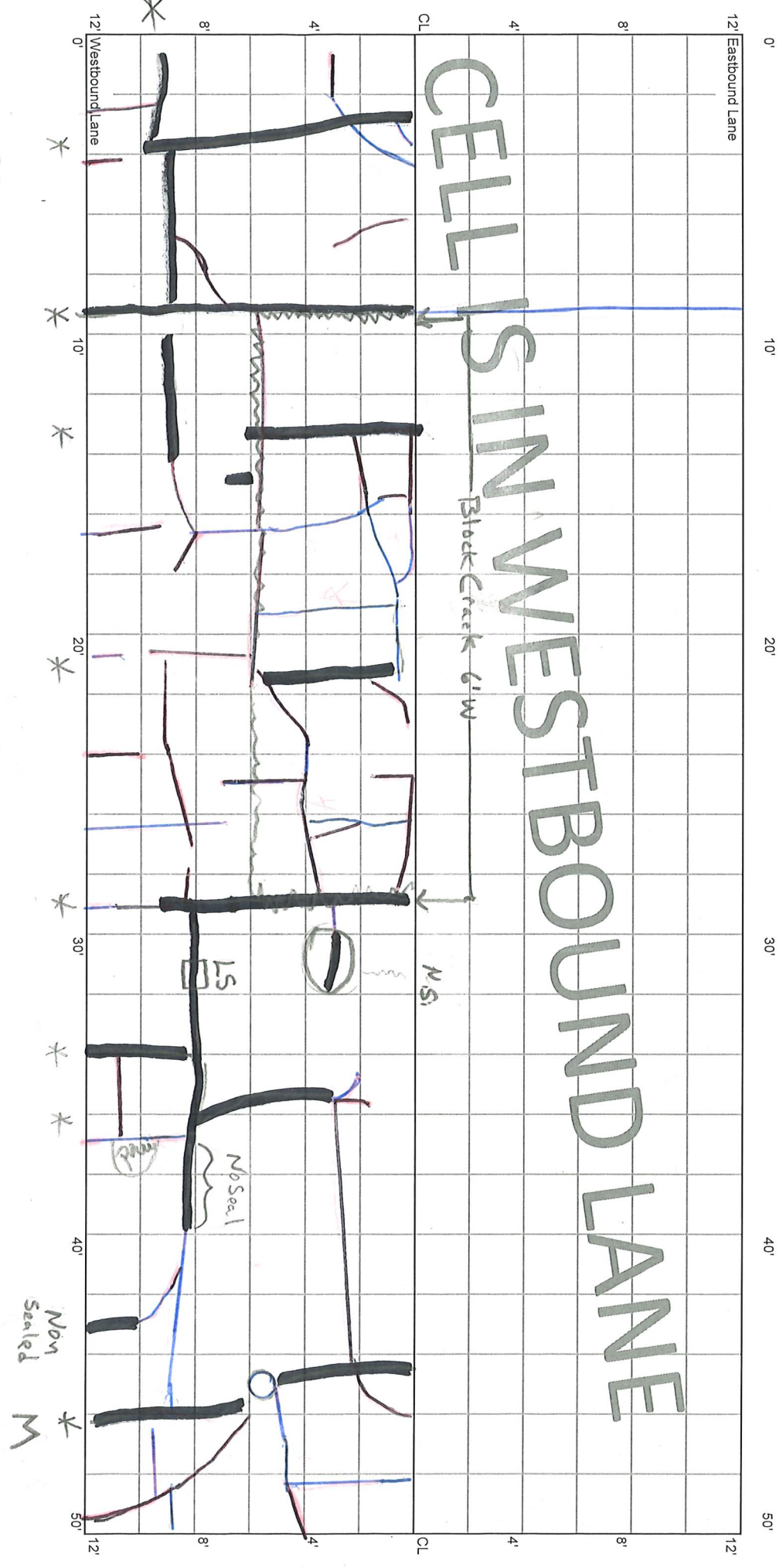

SP

LS
12" RW P

LS
12" RW P

Long.
LS (2) x 36" RW P

LS, 6" RW P
Core hole

Non Sealed

M

N.S.

No Seal

pad

CELL 7003W
500 - 550 ft

11+00

10+75

10+50

