

5.28.20 E.T.  
 10.14.20 1.3.22  
 1.4.21 8.30.22  
 8.25.21 2.2.23  
 8.9.23  
 File 70TH ST

CELL 7001W = 7011W  
 0-50 ft

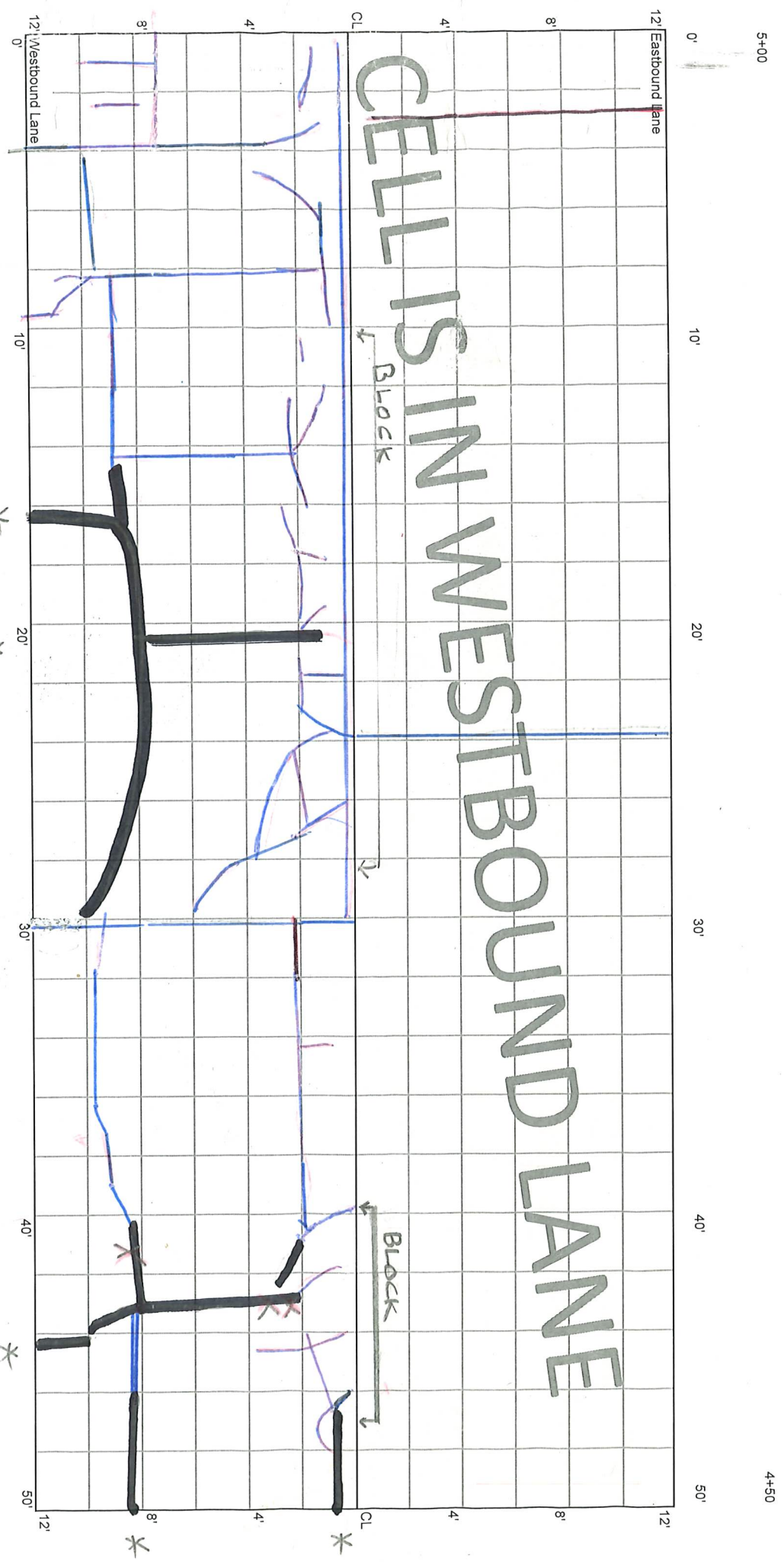

\* Root & Seal

\* AF<sub>L</sub> Stones Throughout

F-1.1k R<sup>1</sup> R<sup>2</sup>

\* AF<sub>L</sub>

2000

CELL 7001W  
50 - 100 ft

4+50

4+00

12' Eastbound Lane

12' Westbound Lane

CELLS IN WESTBOUND LANE

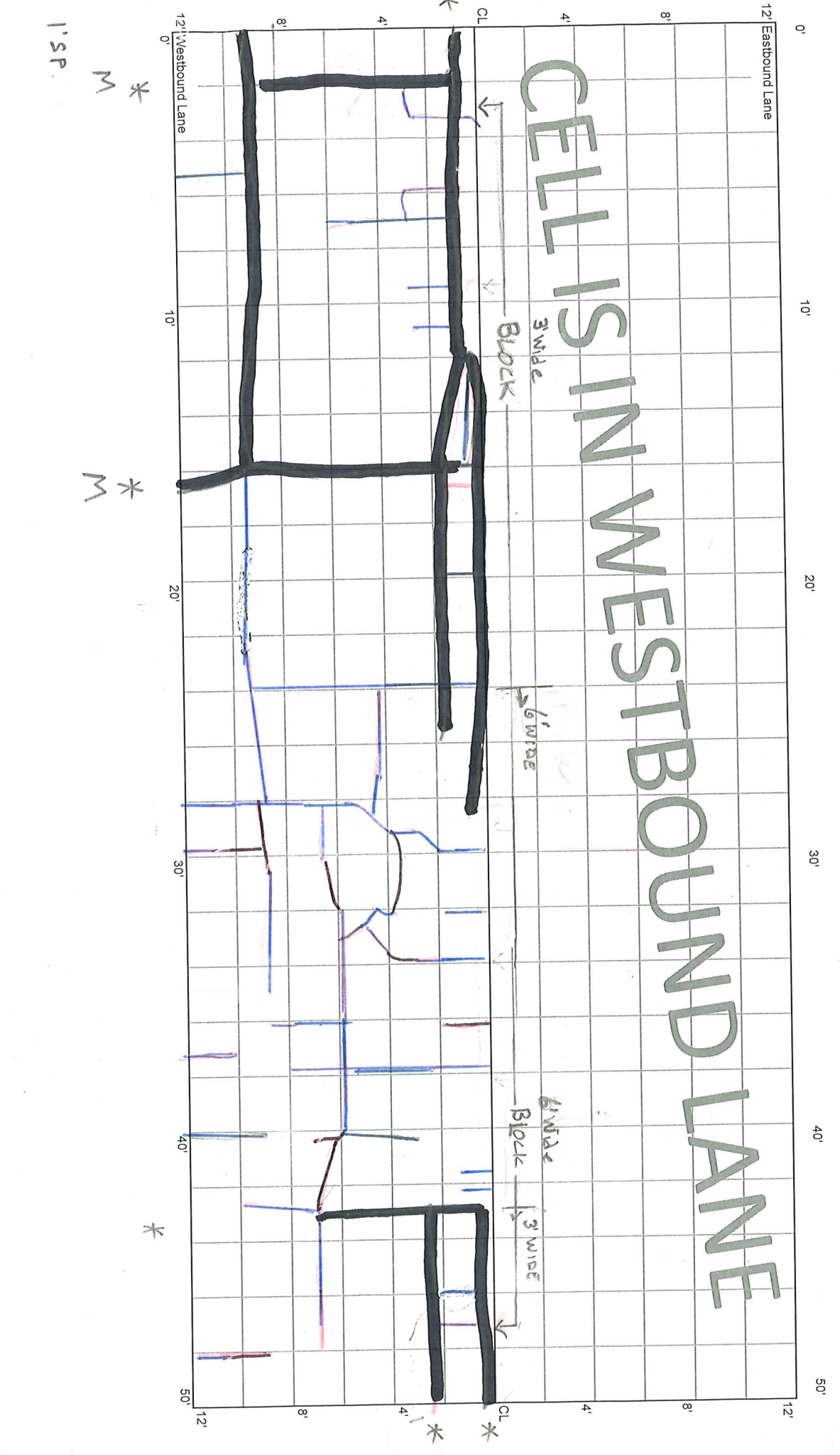

\* M

\* M

1'SP

\*

\* CL \*

CELL 7001W  
100 - 150 ft

4+00

3+50

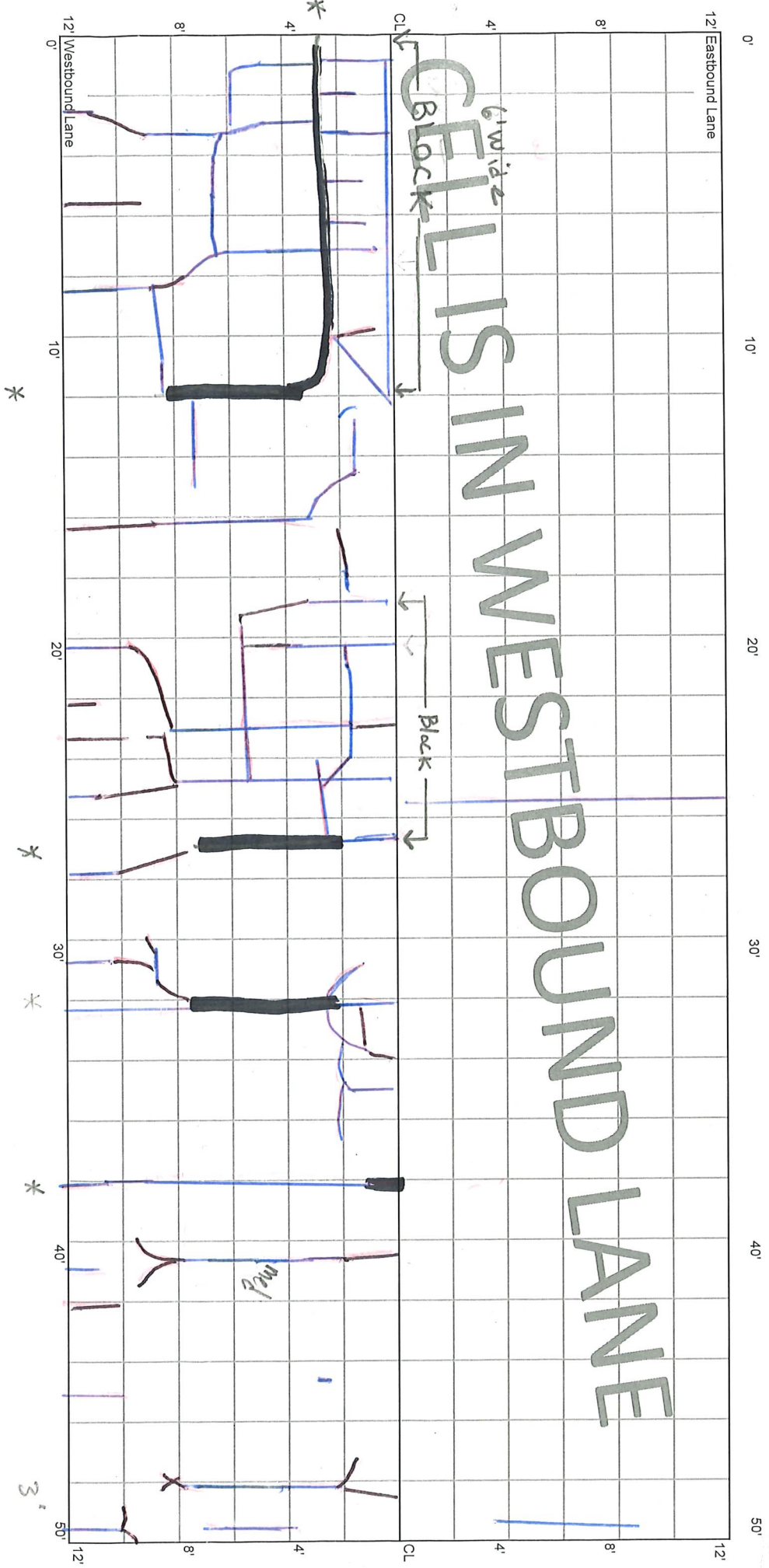

CELL 7001W  
150 - 200 ft

3+50

3+00

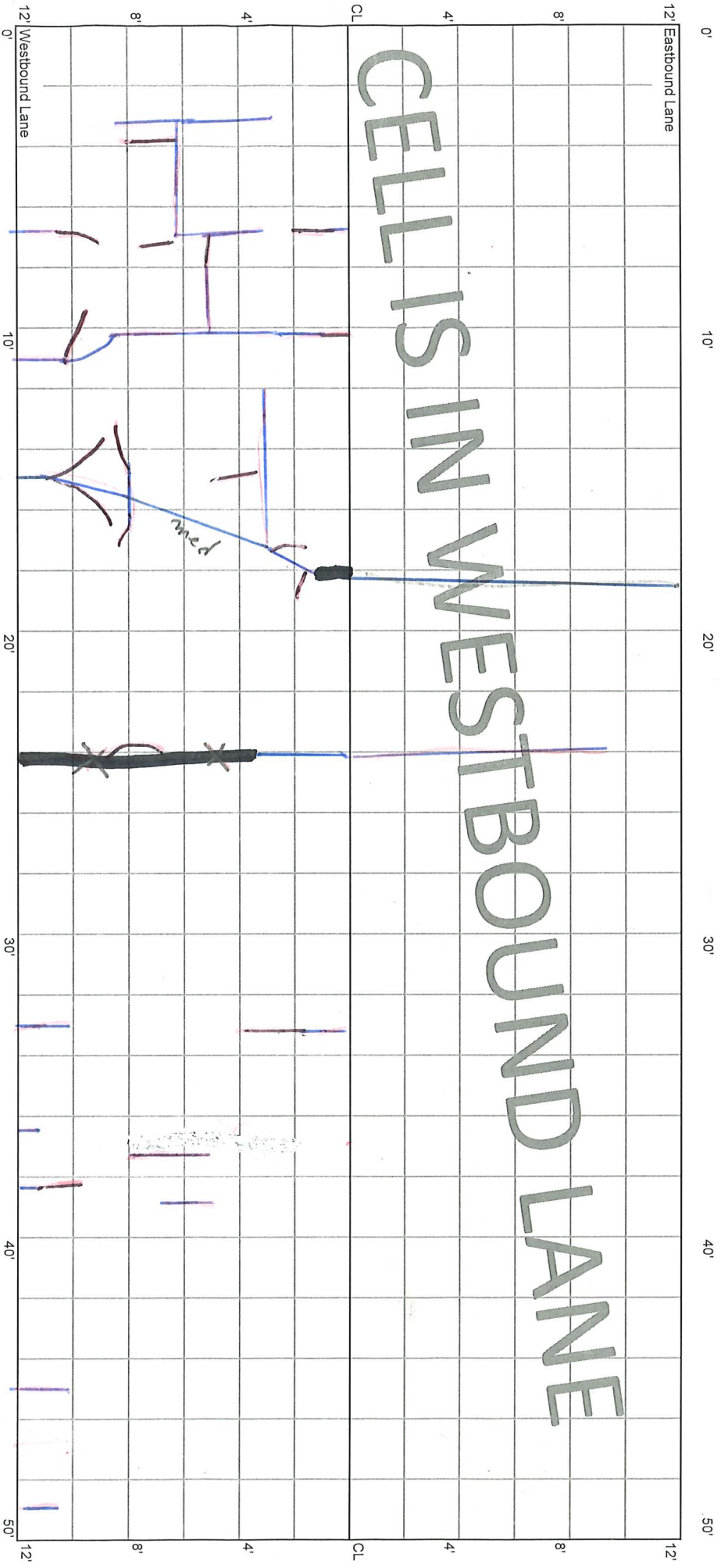

CELLS IN WESTBOUND LANE

\*

2 AF



CELL 7001W  
200 - 250 ft

3+00

2+50

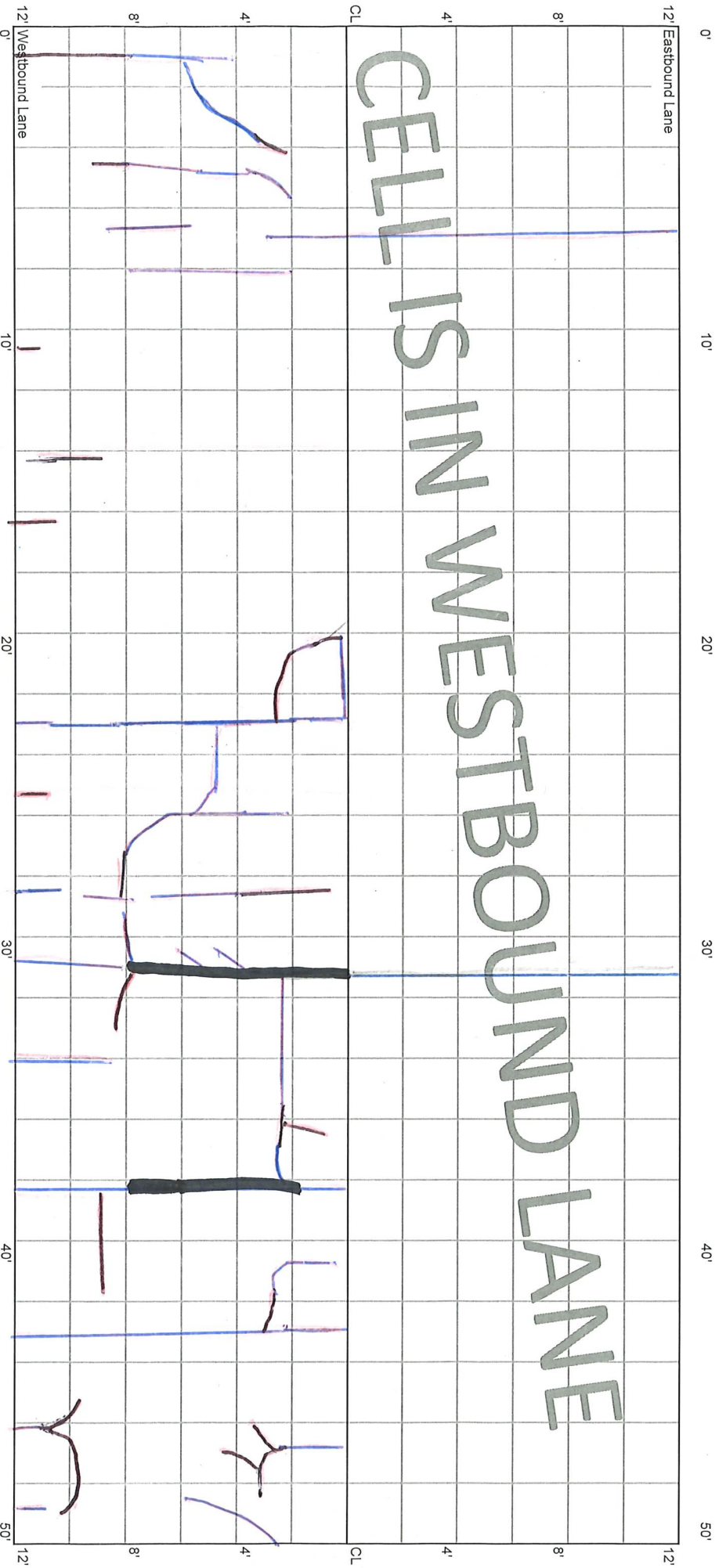

12' Eastbound Lane

12' Westbound Lane

CELLS IN WESTBOUND LANE

CELL 7001W  
250 - 300 ft

2+50

2+00

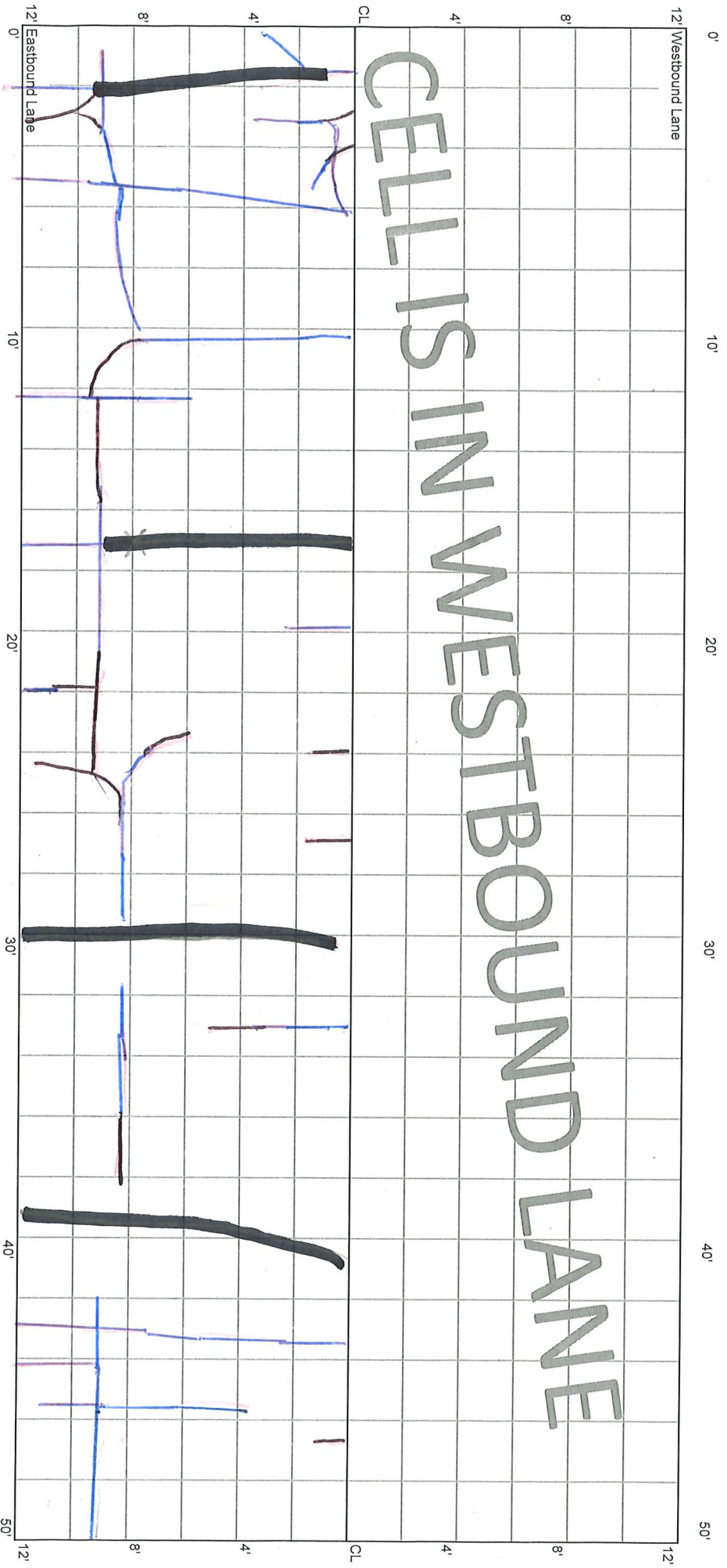

\* M  
\* IAF  
\* 4 Seal Lines

\* SP

\* AF

CELL 7001W  
300 - 350 ft

2+00

1+50

12' Eastbound Lane

12' Westbound Lane

CELLS IN WESTBOUND LANE

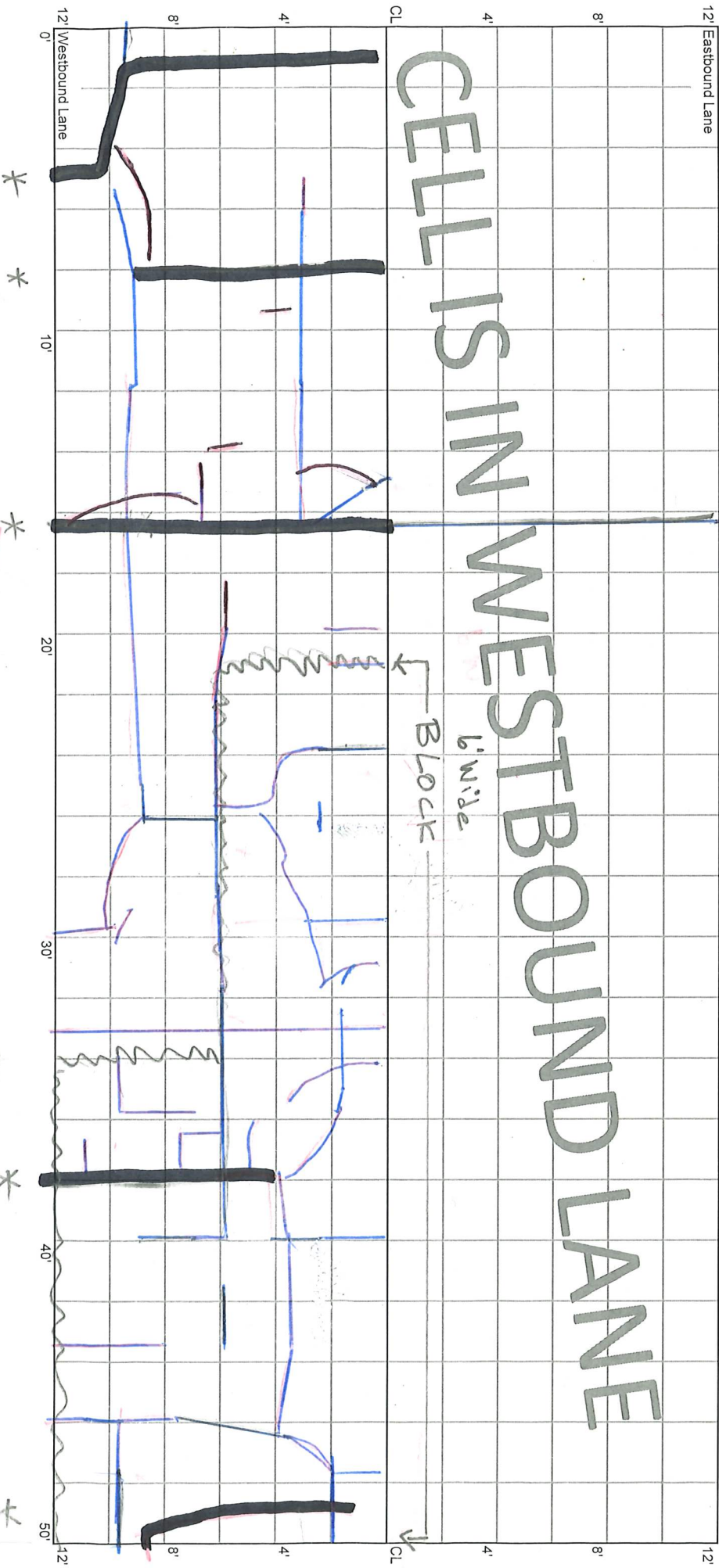

6' wide  
BLOCK

6' wide  
BLOCK

X AFL

X Dabsy/stumps

CELL 7001W  
350 - 400 ft

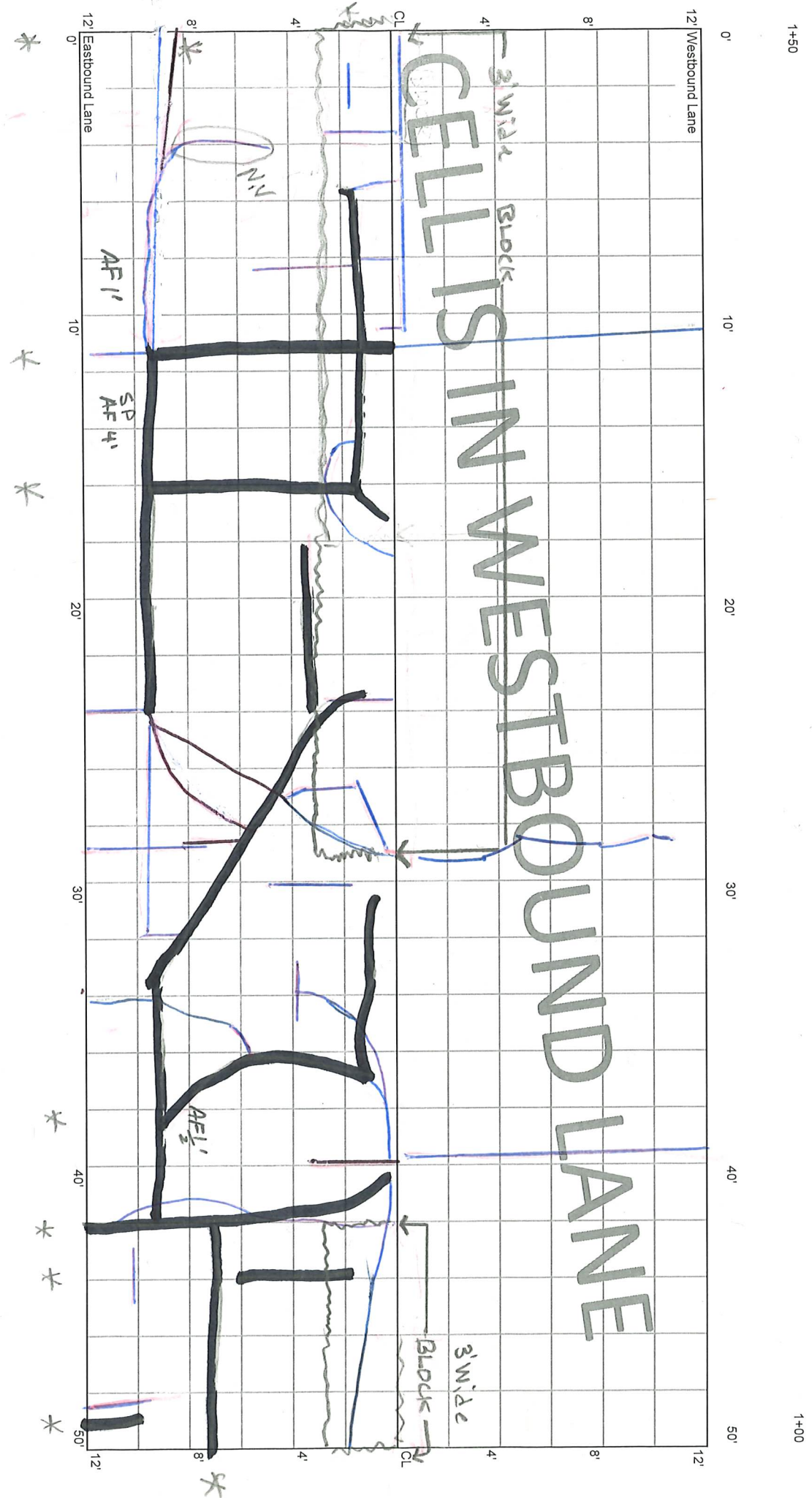

1+50

1+00



CELL 7001W  
400 - 450 ft

1+00

0+50

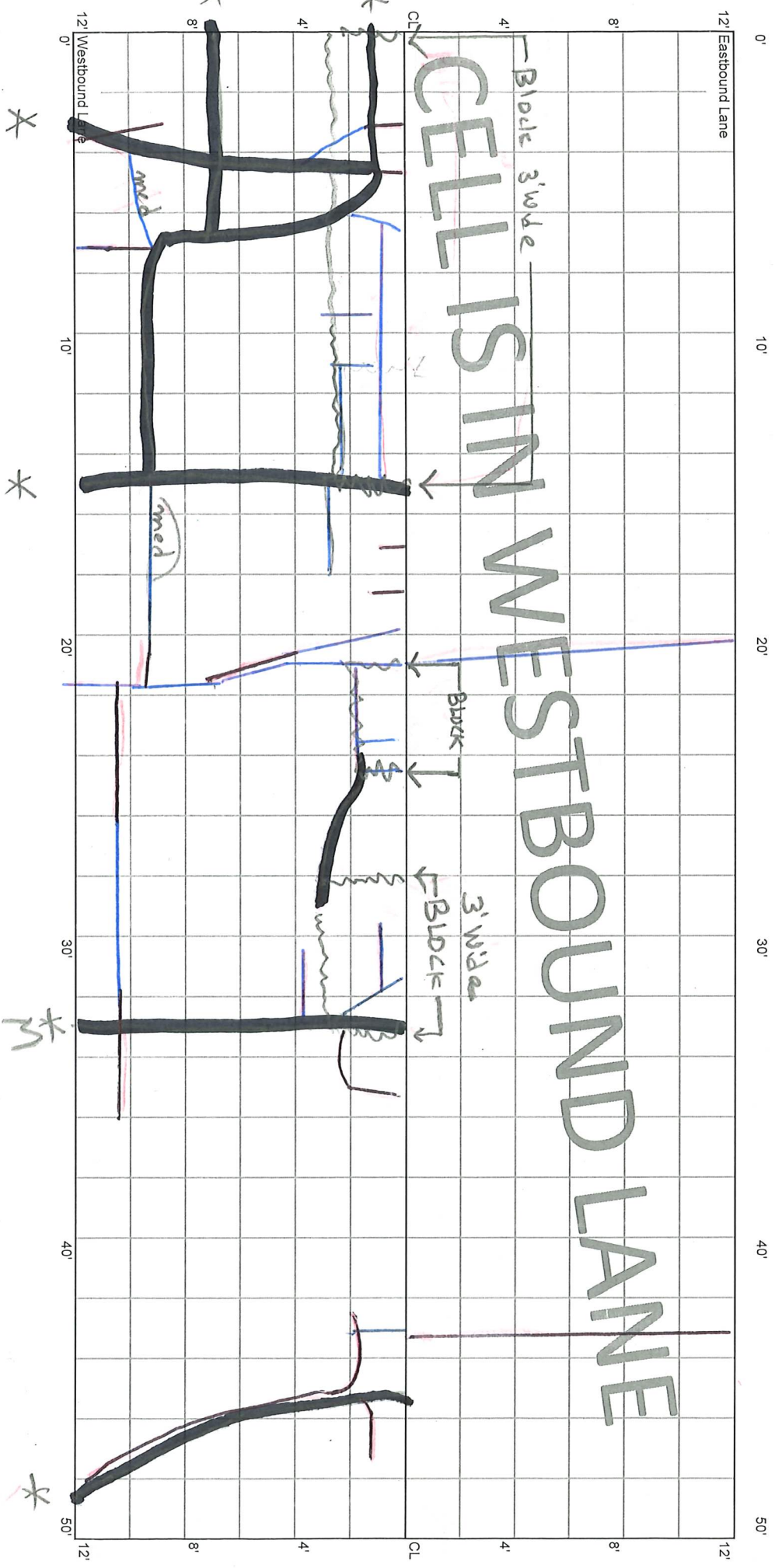

AF

CELL 7001W  
450 - 500 ft

End CL Kadler

0+50

0+00

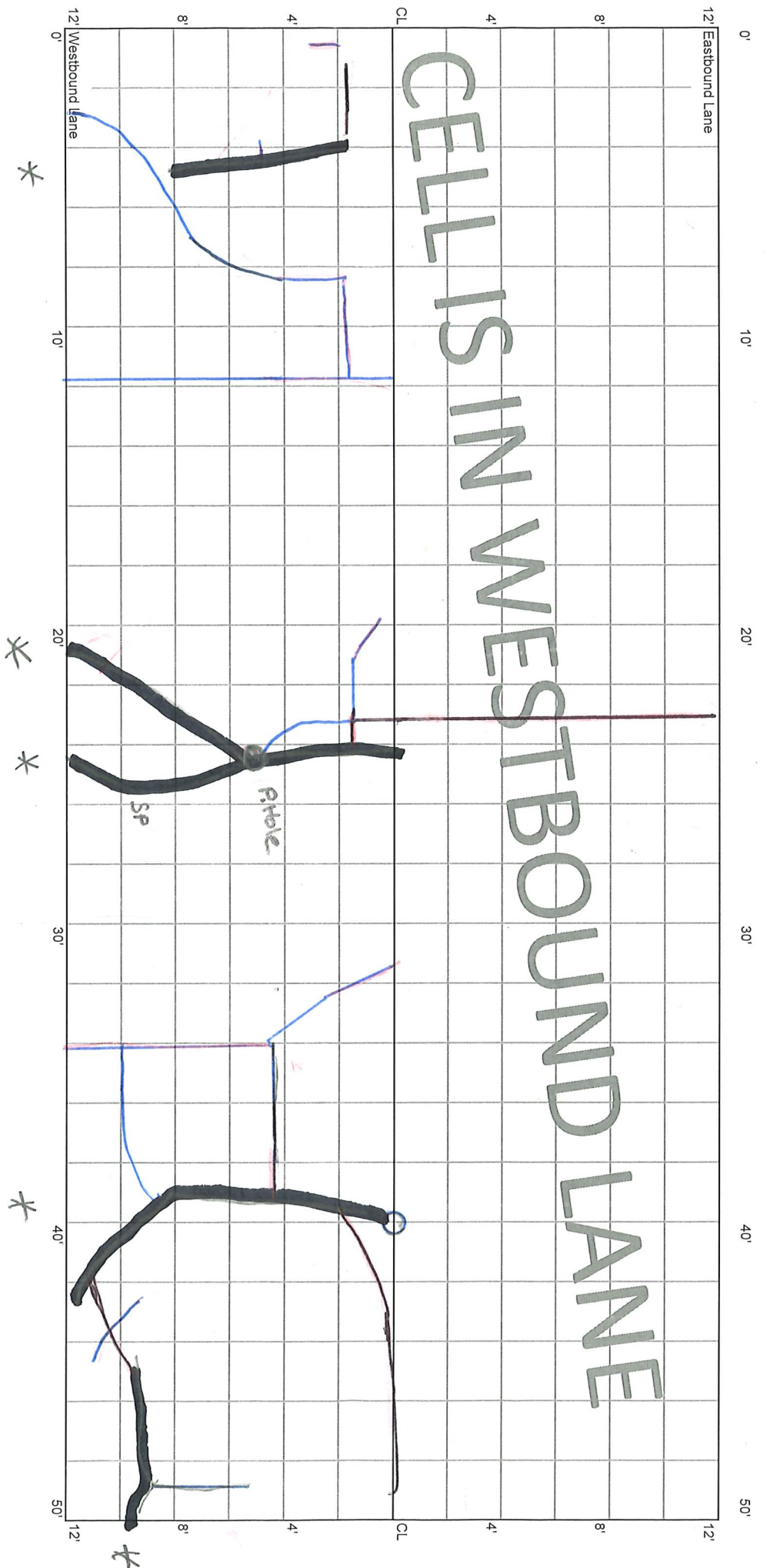

End CL Kadler

CELL 7001W  
500 - 550 ft

0+00

-0+23

0'

-10'

-20'

-23'

12' Eastbound Lane

8'

4'

CL

CELLS IN WESTBOUND LANE

4'

8'

12' Westbound Lane

0'

-10'

-20'

-23'

END RATING: CL KADLER

12'

8'

4'

CL

4'

8'